

## Legend

2018Aerials



Ellisville Overlay



Lake City Limits



Parcels



Ft White



Roads



Roads



others



Dirt



Interstate



Main



Other



Paved



Private



2018 Flood Zones



0.2 PCT ANNUAL CHANCE



A



AE



AH



SRWMD Wetlands



LidarElevations



# Columbia County, FLA - Building & Zoning Property Map

6

Printed: Tue Oct 13 2020 08:19:52 GMT-0400 (Eastern Daylight Time)

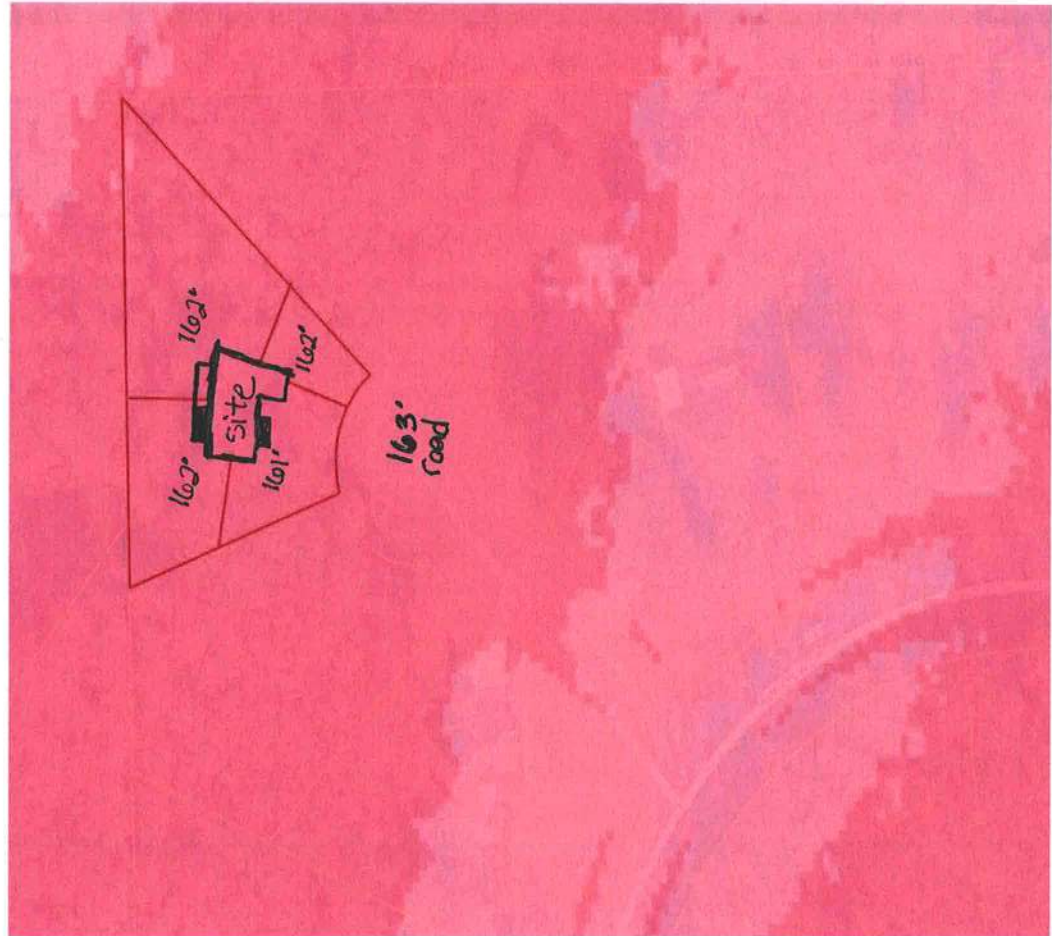

## Parcel Information

Parcel No: 28-3S-16-02372-068

Owner: D & G PROPERTIES OF

Subdivision: STAR LAKE ESTATES

Lot: 18

Acres: 0.489742935

Deed Acres:

District: District 3 Bucky Nash

Future Land Uses: Residential - Low

Flood Zones:

Official Zoning Atlas: RSF-2

All data, information, and maps are provided "as is" without warranty or any representation of accuracy, timeliness of completeness. Columbia County, FL makes no warranties, express or implied, as to the use of the information obtained here. There are no implied warranties of merchantability or fitness for a particular purpose. The requester acknowledges and accepts all limitations, including the fact that the data, information, and maps are dynamic and in a constant state of maintenance, and update.