

45

Columbia County Property Appraiser

CAMA updated: 6/7/2012

2011 Tax Year

Parcel: 13-2S-16-01603-122

<< Next Lower Parcel Next Higher Parcel >>

Tax Collector

Tax Estimator

Property Card

Parcel List Generator

Interactive GIS Map

Print

Owner & Property Info

Owner's Name	POPE JOHN W & BETTY A		
Mailing Address	397 NW CRAWFORD CT WHITE SPRINGS, FL 32096		
Site Address	397 NW CRAWFORD CT		
Use Desc. (code)	IMPROVED A (005000)		
Tax District	3 (County)	Neighborhood	13216
Land Area	30.450 ACRES	Market Area	03
Description	NOTE: This description is not to be used as the Legal Description for this parcel in any legal transaction.		
COMM NE COR OF NW1/4, RUN W 665.15 FT, S 663.29 FT FOR POB, CONT S 663.29 FT, W 2001.72 FT TO W LINE SEC 13, N 663.47 FT, E 1997.46 FT TO POB. (AKA TRACT 21 & 22 NATURE CONSERVANCY EAST UNREC) ORB 758-076, 788-466			

<< Prev Search Result: 15 of 22 Next >>

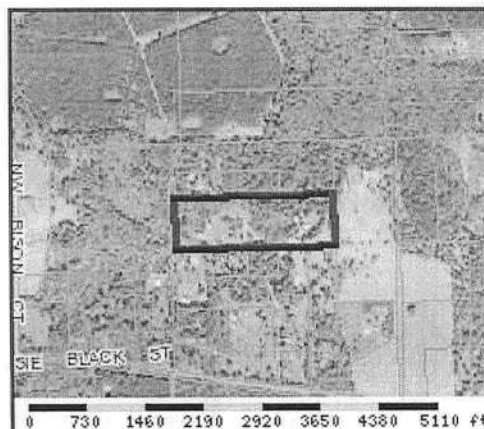

Property & Assessment Values

2011 Certified Values		
Mkt Land Value	cnt: (1)	\$8,951.00
Ag Land Value	cnt: (3)	\$5,890.00
Building Value	cnt: (2)	\$12,884.00
XFOB Value	cnt: (5)	\$2,200.00
Total Appraised Value		\$29,925.00
Just Value		\$95,419.00
Class Value		\$29,925.00
Assessed Value		\$29,925.00
Exempt Value	(code: HX)	\$21,692.00
Total Taxable Value	Cnty: \$8,233 Other: \$8,233 Schl: \$8,233	

2012 Working Values

NOTE:

2012 Working Values are NOT certified values and therefore are subject to change before being finalized for ad valorem assessment purposes.

[Show Working Values](#)

Sales History

[Show Similar Sales within 1/2 mile](#)

Sale Date	OR Book/Page	OR Code	Vacant / Improved	Qualified Sale	Sale RCode	Sale Price
3/9/1992	758/75	WD	V	Q		\$23,500.00

Building Characteristics

Bldg Item	Bldg Desc	Year Blt	Ext. Walls	Heated S.F.	Actual S.F.	Bldg Value
1	MOBILE HME (000800)	1979	AL SIDING (26)	1056	1952	\$6,651.00
2	MOBILE HME (000800)	1979	AL SIDING (26)	1288	1288	\$6,233.00
Note: All S.F. calculations are based on exterior building dimensions.						

Extra Features & Out Buildings

Code	Desc	Year Blt	Value	Units	Dims	Condition (% Good)
0070	CARPORT UF.	2008	\$300.00	0000001.000	0 x 0 x 0	(000.00)
0070	CARPORT UF	2008	\$300.00	0000001.000	0 x 0 x 0	(000.00)
0070	CARPORT UF	2008	\$200.00	0000001.000	0 x 0 x 0	(000.00)
0040	BARN,POLE	2008	\$800.00	0000001.000	0 x 0 x 0	(000.00)

0294	SHED WOOD/	2008	\$600.00	0000001.000	0 x 0 x 0	(000.00)
------	------------	------	----------	-------------	-----------	----------

Land Breakdown

Lnd Code	Desc	Units	Adjustments	Eff Rate	Lnd Value
000102	SFR/MH (MKT)	1 AC	1.00/1.00/1.00/1.00	\$4,456.57	\$4,456.00
006200	PASTURE 3 (AG)	29.45 AC	1.00/1.00/1.00/1.00	\$200.00	\$5,890.00
009910	MKT.VAL.AG (MKT)	29.45 AC	1.00/1.00/1.00/1.00	\$0.00	\$64,246.00
009945	WELL/SEPT (MKT)	1 UT - (0000000.000AC)	1.00/1.00/1.00/1.00	\$2,000.00	\$2,000.00
009945	WELL/SEPT (MKT)	1 UT - (0000000.000AC)	1.00/1.00/1.00/1.00	\$2,000.00	\$2,000.00

Columbia County Property Appraiser

CAMA updated: 6/7/2012

<< Prev

15 of 22

Next >>

DISCLAIMER

This information was derived from data which was compiled by the Columbia County Property Appraiser Office solely for the governmental purpose of property assessment. This information should not be relied upon by anyone as a determination of the ownership of property or market value. No warranties, expressed or implied, are provided for the accuracy of the data herein, it's use, or it's interpretation. Although it is periodically updated, this information may not reflect the data currently on file in the Property Appraiser's office. The assessed values are NOT certified values and therefore are subject to change before being finalized for ad valorem assessment purposes.



Trip to 397 NW Crawford Ct
 White Springs, FL 32096-7619
 12.57 miles - about 17 minutes

Notes



[142-191] N Marion Ave, Lake City, FL 32055



1. Start out going south on N Marion Ave / US-441 toward NW Justice St.

go 0.0 mi



2. Turn right onto W Duval St / US-90.

go 0.1 mi



3. Turn right onto NW Main Blvd / US-41 N. Continue to follow US-41 N.

go 9.8 mi



4. Turn right onto NW Lassie Black St.

go 2.3 mi



5. Turn left onto NW Crawford Ct.

go 0.3 mi



6. 397 NW CRAWFORD CT is on the right.

go 0.0 mi



397 NW Crawford Ct, White Springs, FL 32096-7619

Total Travel Estimate : 12.57 miles - about 17 minutes

Route Map [Hide](#)

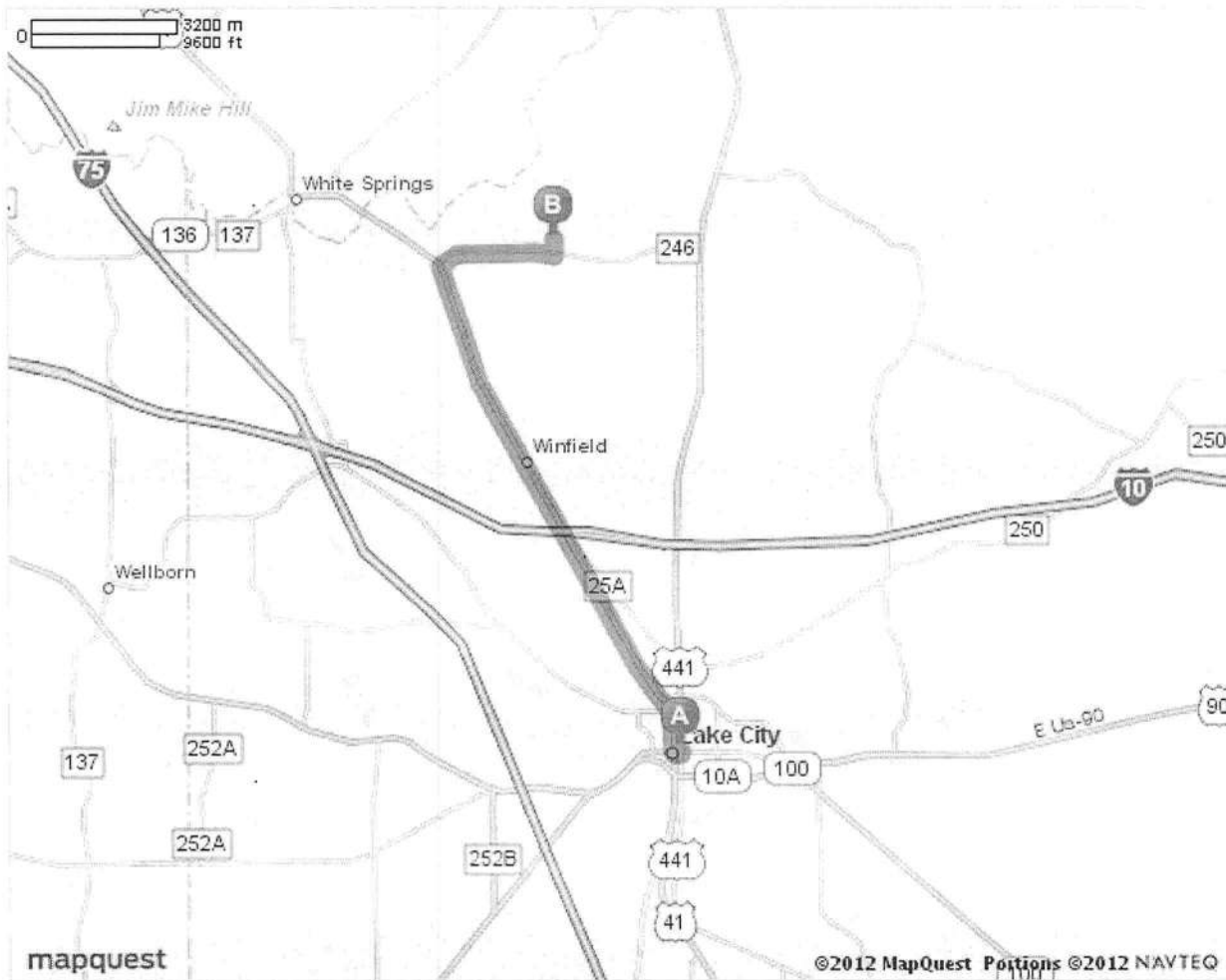

All rights reserved. Use subject to [License/Copyright](#) | [Map Legend](#)

Directions and maps are informational only. We make no warranties on the accuracy of their content, road conditions or route usability or expeditiousness. You assume all risk of use. MapQuest and its suppliers shall not be liable to you for any loss or delay resulting from your use of MapQuest. Your use of MapQuest means you agree to our [Terms of Use](#)