

1 LIGHT POLE BASE DETAIL
N.T.S.

NOTES:

- A. COORDINATE EXACT LOCATIONS WITH CIVIL AND LANDSCAPE DRAWINGS.
- B. ROCK AND ADVERSE SOIL CONDITIONS MAY BE PRESENT ON SITE. COORDINATE INSTALLATION REQUIREMENTS FOR BELOW GRADE WORK WITH GEOTECHNICAL REPORT. INCLUDE IN BID. ANY WORK RELATED TO GEOTECHNICAL CONSIDERATIONS AS IT MAY PERTAIN TO THE INSTALLATION OF SITE LIGHTING POLE BASES.

GENERAL NOTES:

- A. ALL DEVICES, EQUIPMENT, LUMINAIRES, ETC., MUST BE GROUNDED BY USE OF A PROPERLY SIZED GROUNDING CONDUCTOR. MECHANICAL/ELECTRICAL BONDS OF THE METALLIC RACEWAY SYSTEM SHALL ALSO BE MAINTAINED.
- B. BRANCH CIRCUIT WIRE SIZES (AND CONDUITS) SHALL BE INCREASED FROM THOSE INDICATED ON THE PLANS TO PREVENT EXCESSIVE VOLTAGE DROP. BRANCH CIRCUITS SHALL BE INSTALLED WITH WIRES OF SUFFICIENT SIZE SO THAT VOLTAGE DROP BETWEEN THE PANEL AND THE LOAD DOES NOT EXCEED A LIMIT OF 3%.
- C. CIRCUITS MAY BE COMBINED IN CONDUIT PROVIDED WIRE IS PROPERLY DERATED AND CONDUIT SIZED PER CODE. UNDER NO CIRCUMSTANCES SHALL MORE THAN NINE (9) CURRENT CARRYING CONDUCTORS BE RUN IN A SINGLE CONDUIT.
- D. ALL CONDUITS SHALL CONTAIN A GROUND WIRE SIZED PER NEC TABLE #250-122. WHERE CIRCUIT CONDUCTORS ARE INCREASED IN SIZE FOR VOLTAGE DROP, THE GROUND WIRE SIZE SHALL BE INCREASED PROPORTIONATELY (ACCORDING TO CIRCULAR MIL AREA) FROM THE SIZE REQUIRED BY NEC TABLE #250-122.
- E. EXPOSED CONDUITS, WHERE PERMITTED, SHALL BE RUN PARALLEL TO OR AT RIGHT ANGLES TO BUILDING STRUCTURAL MEMBERS.

KEYED NOTE SCHEDULE

1. REFER TO DETAIL 1 THIS DRAWING FOR FURTHER INFORMATION.
2. PROPOSED POLE-MOUNTED UTILITY TRANSFORMERS. COORDINATE EXACT REQUIREMENTS AND LOCATION WITH LOCAL UTILITY COMPANY, OWNER, AND CIVIL DRAWINGS.
3. PROPOSED MONUMENT SIGN. COORDINATE REQUIREMENTS WITH SIGN VENDOR AND PROVIDE ANY REQUIRED SIGN-MOUNTED DISCONNECTING MEANS.
4. PROPOSED UNDERGROUND ELECTRICAL UTILITY SERVICE FEEDER. COORDINATE EXACT REQUIREMENTS AND ROUTING WITH LOCAL UTILITY COMPANY, OWNER, CIVIL DRAWINGS AND OTHER UTILITIES. SEE DISTRIBUTION DIAGRAM ON DRAWING E3.0.
5. PROPOSED ELECTRICAL UTILITY SERVICE EQUIPMENT. REFER TO DISTRIBUTION DIAGRAM ON DRAWING E3.0 AND POWER PLANS ON DRAWINGS E2.0 & E2.1.

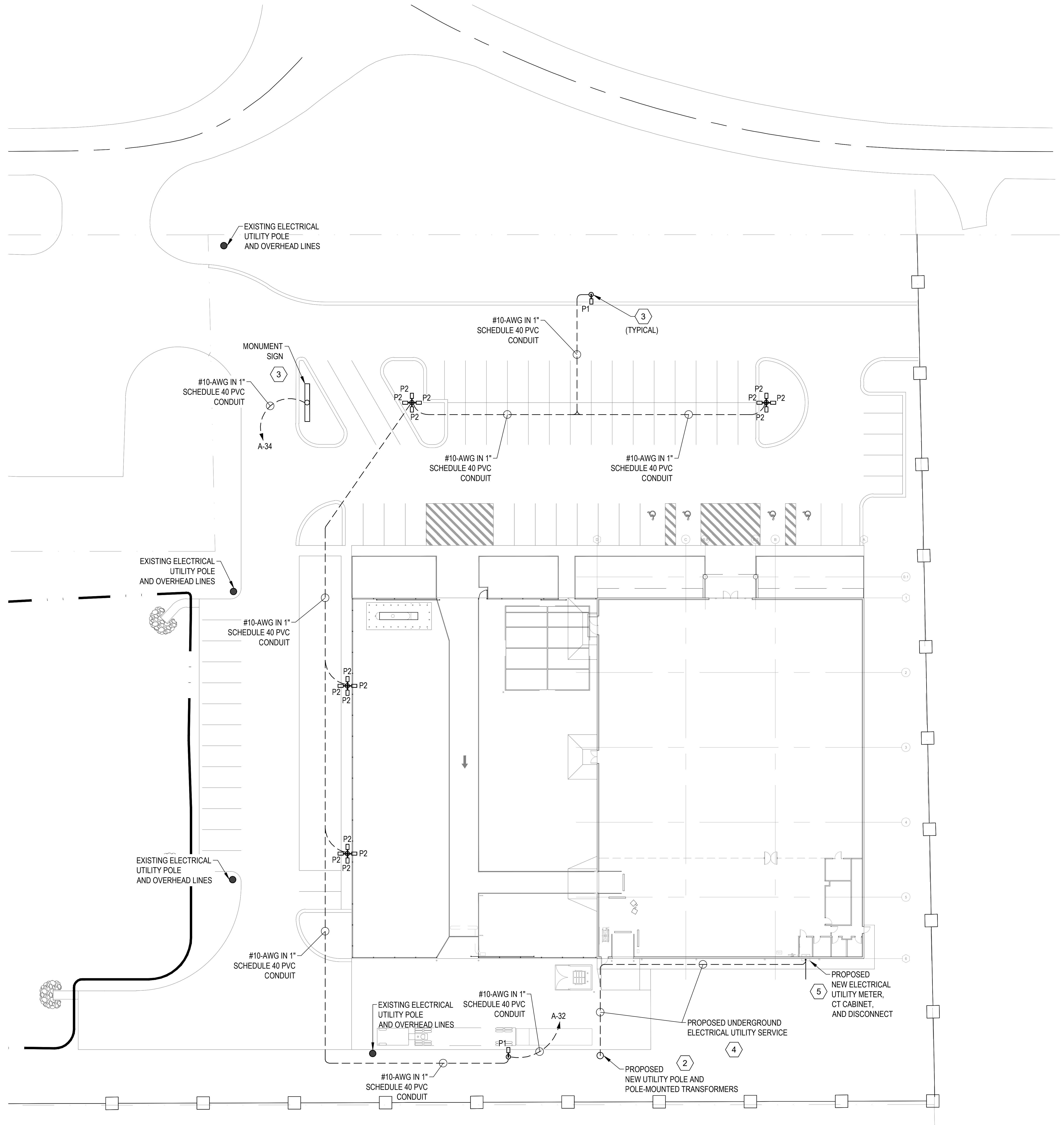

ELECTRICAL SITE PLAN
1\"/>

