

Columbia County Property Appraiser

Jeff Hampton

2022 Working Values

updated: 4/14/2022

Parcel: << 06-4S-17-08020-103 (29237) >>

Aerial Viewer Pictometry Google Maps

Owner & Property Info

Result: 1 of 1

Owner	ROWE JOHN 991 SW ROSSBOROUGH CT #101 LAKE CITY, FL 32025		
Site	991 SW ROSSBOROUGH Ct, LAKE CITY		
Description*	LOTS 3 CROSS CREEK ESTATES S/D. WD 1096-2193, SWD 1114- 1827, ASSIG AFD 1184-1522		
Area	0.083 AC	S/T/R	06-4S-17
Use Code**	SINGLE FAMILY (0100)	Tax District	1

*The Description above is not to be used as the Legal Description for this parcel in any legal transaction.

**The Use Code is a FL Dept. of Revenue (DOR) code and is not maintained by the Property Appraiser's office. Please contact your city or county Planning & Zoning office for specific zoning information.

Property & Assessment Values

2021 Certified Values		2022 Working Values	
Mkt Land	\$8,200	Mkt Land	\$8,200
Ag Land	\$0	Ag Land	\$0
Building	\$44,181	Building	\$47,609
XFOB	\$225	XFOB	\$225
Just	\$52,606	Just	\$56,034
Class	\$0	Class	\$0
Appraised	\$52,606	Appraised	\$56,034
SOH Cap [?]	\$0	SOH Cap [?]	\$1,850
Assessed	\$52,606	Assessed	\$54,184
Exempt	HX HB \$27,606	Exempt	HX HB \$29,184
Total Taxable	county:\$25,000 city:\$25,000 other:\$0 school:\$27,606	Total Taxable	county:\$25,000 city:\$25,000 other:\$0 school:\$29,184

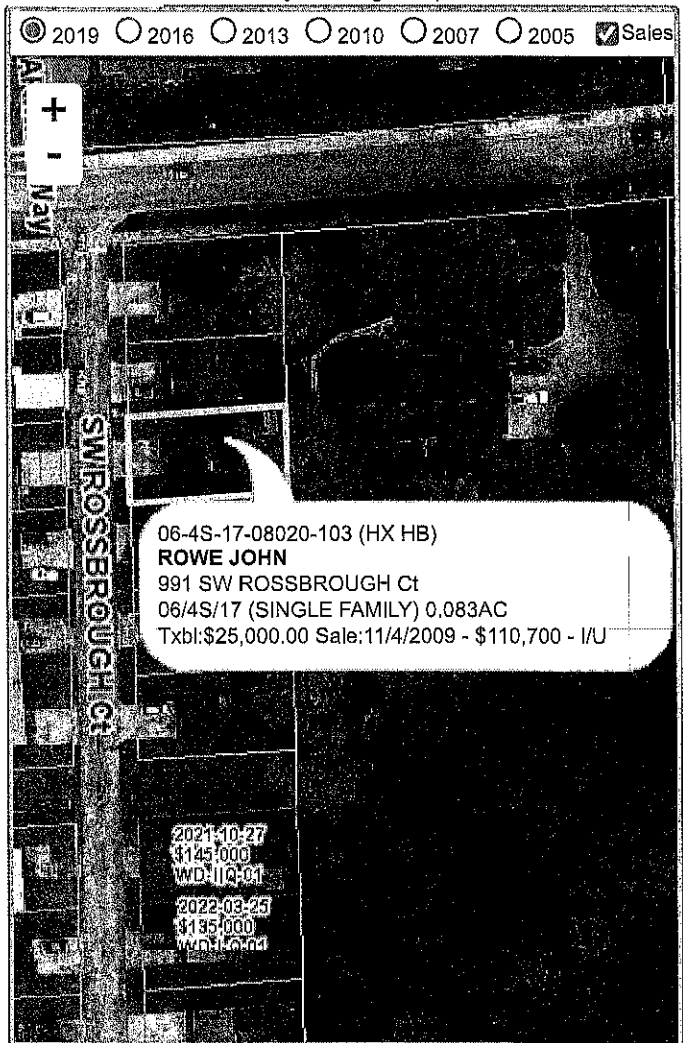
**▼ Sales History**

Sale Date	Sale Price	Book/Page	Deed	V/I	Qualification (Codes)	RCode
11/4/2009	\$110,700	1184/1522	AG	I	U	40
9/15/2006	\$125,000	1096/2193	AG	I	U	01

▼ Building Characteristics

Bldg Sketch	Description*	Year Blt	Base SF	Actual SF	Bldg Value
Sketch	DUPLEX (2700)	1992	1024	1123	\$47,609

*Bldg Desc determinations are used by the Property Appraisers office solely for the purpose of determining a property's Just Value for ad valorem tax purposes and should not be used for any other purpose.

▼ Extra Features & Out Buildings (Codes)

Code	Desc	Year Blt	Value	Units	Dims
0166	CONC,PAVMT	0	\$225.00	1.00	0 x 0

▼ Land Breakdown

Code	Desc	Units	Adjustments	Eff Rate	Land Value
0100	SFR (MKT)	1.000 LT (0.083 AC)	1.0000/1.0000 1.0000/ /	\$8,200 /LT	\$8,200

Search Result: 1 of 1