

GENERAL NOTES:

1. PROVIDE COMPLETE LIGHTNING PROTECTION SYSTEM IN ACCORDANCE WITH NFPA 780, FOR UL MASTER LABEL, INCLUDING BURIED COUNTERPOISE CONDUCTOR, BONDED TO COPPER DOWN CONDUCTORS. COPPER DOWN CONDUCTORS ARE TO BE A MAXIMUM 180" CENTER TO CENTER AT ROOF PERIMETER, CONCEALED IN 1" PVC CONDUIT IN EXTERIOR COLUMN OR WALL, DOWN TO BURIED COUNTERPOISE. PROVIDE GROUND TEST WELLS, WITH APPROPRIATE TRAFFIC RATED COVERS, FOR GROUND RODS. COORDINATE LOCATION WITH LANDSCAPING AND HARDSCAPE AROUND BUILDING, AND WITH SITE UTILITIES. ALL CONNECTIONS ARE TO BE BY EXOTHERMIC WELD. ALL CONDUCTORS FROM HIGHER TO LOWER ROOFS SHALL BE CONCEALED FROM VIEW. PROVIDE COMPLETE 1/8" SCALE = 1'-0" SCALED SHOP DRAWINGS SHOWING ALL COMPONENTS, MOUNTING DETAILS, ROOF PENETRATION DETAILS, BONDS TO ROOF EQUIPMENT, ETC. FROM ROOF LIGHTNING PROTECTION CONDUCTORS. ANY AIR TERMINALS MOUNTED IN THE INTERIOR OF THE ROOF SHALL BE BLUNT TIP TYPE. PROVIDE CONNECTION TO CHILLER OH-F HOUSING, EXTERIOR GENERATOR HOUSING, AND ALL FENCING & GATES.

2. ALL RECEPTACLES ON ROOF ARE WEATHERPROOF, GFCI, WITH CAST METAL IN-USE COVER.

800 North Magnolia Ave.
Suite 1000, Orlando, FL 32803-3251

t +1 407 843 5120
f +1 407 649 8664

10365 Hood Road South Suite 203
Jacksonville, FL 32257

t +1 904-262-8660
f +1 904-262-8623

255 S. Orange Avenue
Suite 1600
Orlando, FL 32801
P 407.841.9050

Copyright 2021
COA 15
www.Engineers.com
TLC No. 120018
THINK. LISTEN. CREATE.

Professional Seals

Wayne Edward Allred, P.E.
State of Florida
Professional Engineer
License No. 45800

This item has been electronically signed and sealed by the individual named above, using a dated Digital Signature in the space below, per F.A.C. Rule 61G15-23.004. Printed copies of this document are not considered signed and sealed, and the signature must be verified on any electronic copies.

Wayne E. Allred

Digitally signed by Wayne E. Allred
DN: cn=Wayne E. Allred, o=Wayne E. Allred, email=Wayne.Allred@Dewberry.com, c=US
Date: 2020.07.24 15:00:00 -0400
Reason: I am the author of this document.

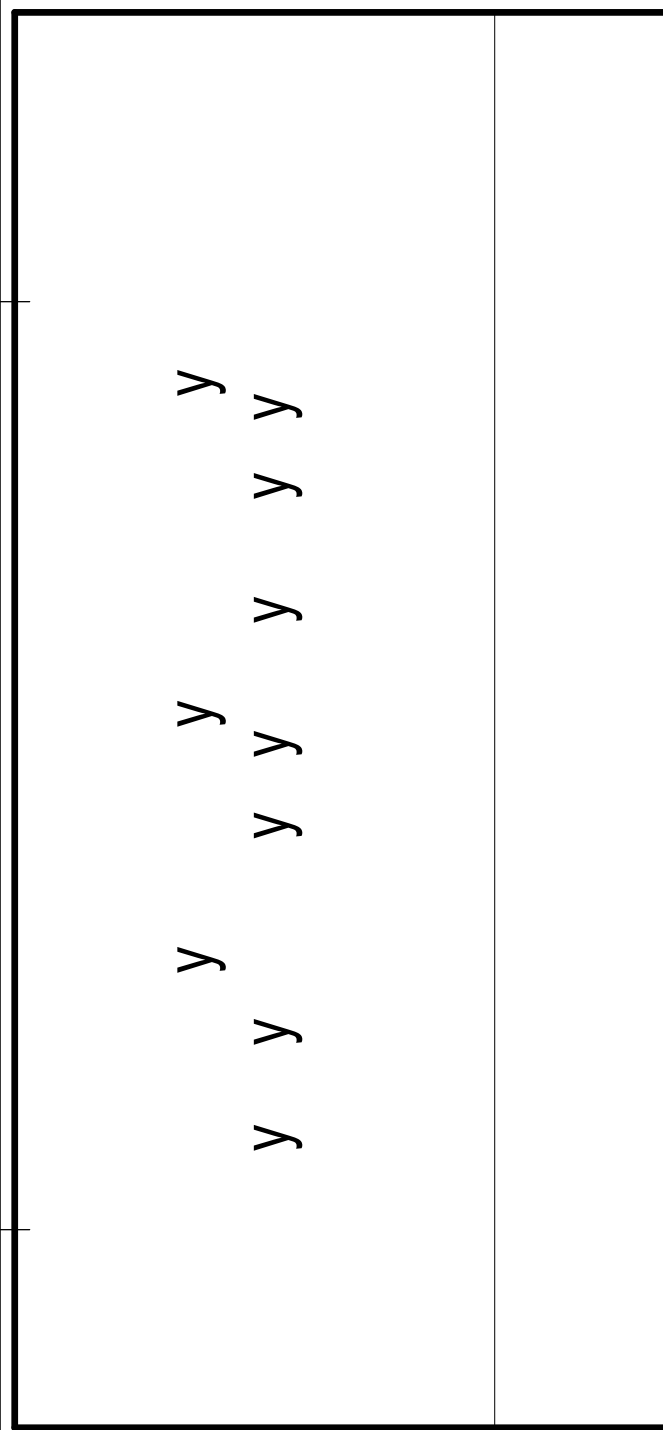
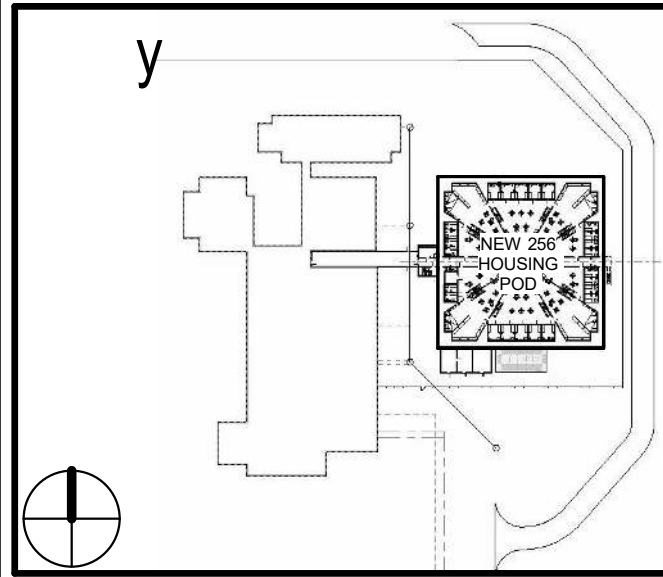

SCALE 1/8" = 1'-0"

No.	Description	Date

ISSUED FOR PERMIT 7-24-20

REVISIONS

DRAWN BY O DORIA
APPROVED BY W ALLRED
CHECKED BY L WOLFE
DATE JULY 24, 2020

TITLE

ELECTRICAL ROOF PLAN

PROJECT NO. 50101397

EP-131

SHEET NO.
DESTROY AFTER USE