

Legend

Parcels

Roads

- Roads
- others
- Dirt
- Interstate
- Main
- Other
- Paved
- Private

2018 Flood Zones

- 0.2 PCT ANNUAL CHANCE
- A
- AE
- AH

SRWMD Wetlands

- 2018Aerials

DevZones1

- others
- A-1
- A-2
- A-3
- CG
- CHI
- CI
- CN
- CSV
- ESA-2
- I
- ILW
- MUD-1
- PRD
- PRRD
- RMF-1
- RMF-2
- RO
- RR
- RSF-1
- RSF-2
- RSF-3
- RSF/MH-1
- RSF/MH-2
- RSF/MH-3
- DEFAULT

LidarElevations



Columbia County, FLA - Building & Zoning Property Map

Printed: Fri Nov 13 2020 14:53:10 GMT-0500 (Eastern Standard Time)

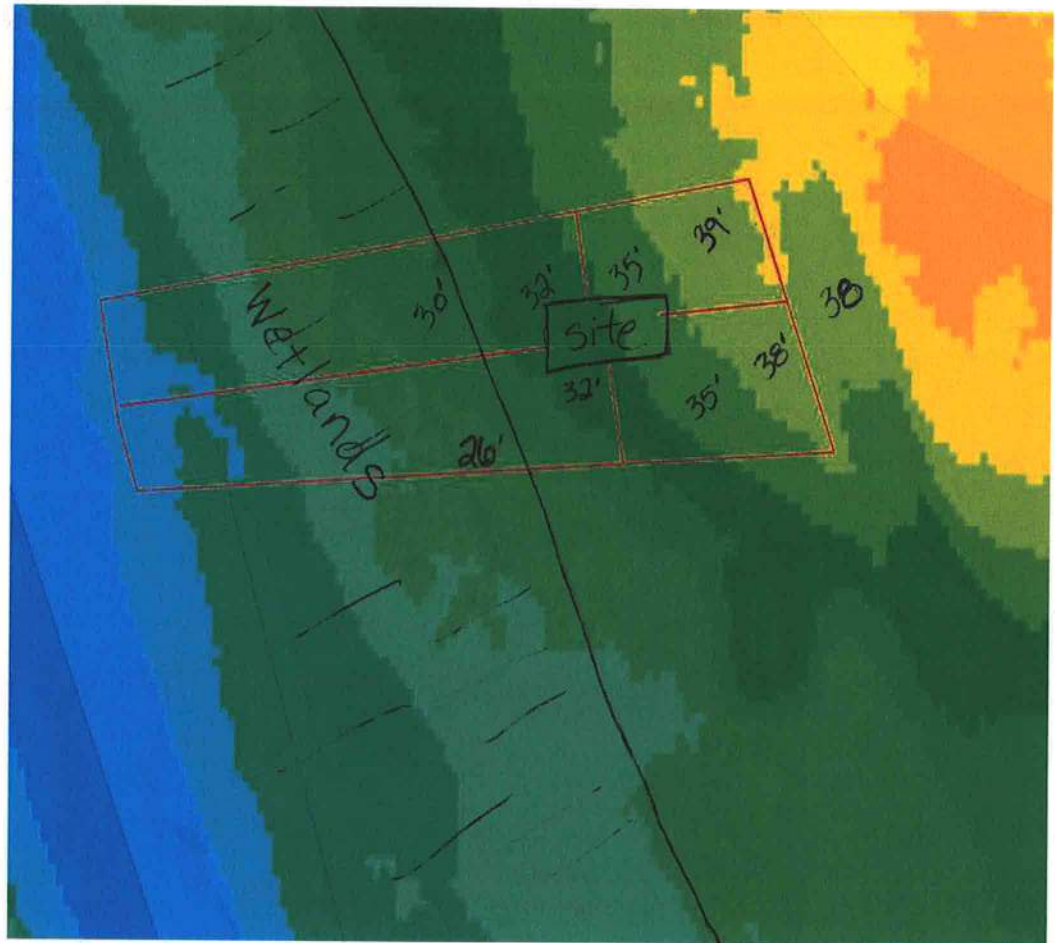

Parcel Information

Parcel No: 18-7S-16-04236-019

Owner: BIELLING TOMMY H & BARBARA V

Subdivision: CEDAR SPRING SHORES

Lot: 42

Acres: 1.14608788

Deed Acres: 1.15 Ac

District: District 2 Rocky Ford

Future Land Uses: Environmentally Sensitive Areas -1

Flood Zones: AE

Official Zoning Atlas: A-3, ESA-2

All data, information, and maps are provided "as is" without warranty or any representation of accuracy, timeliness of completeness. Columbia County, FL makes no warranties, express or implied, as to the use of the information obtained here. There are no implied warranties of merchantability or fitness for a particular purpose. The requester acknowledges and accepts all limitations, including the fact that the data, information, and maps are dynamic and in a constant state of maintenance, and update.