

FIRST FLOOR ELECTRICAL PLAN

FRONT

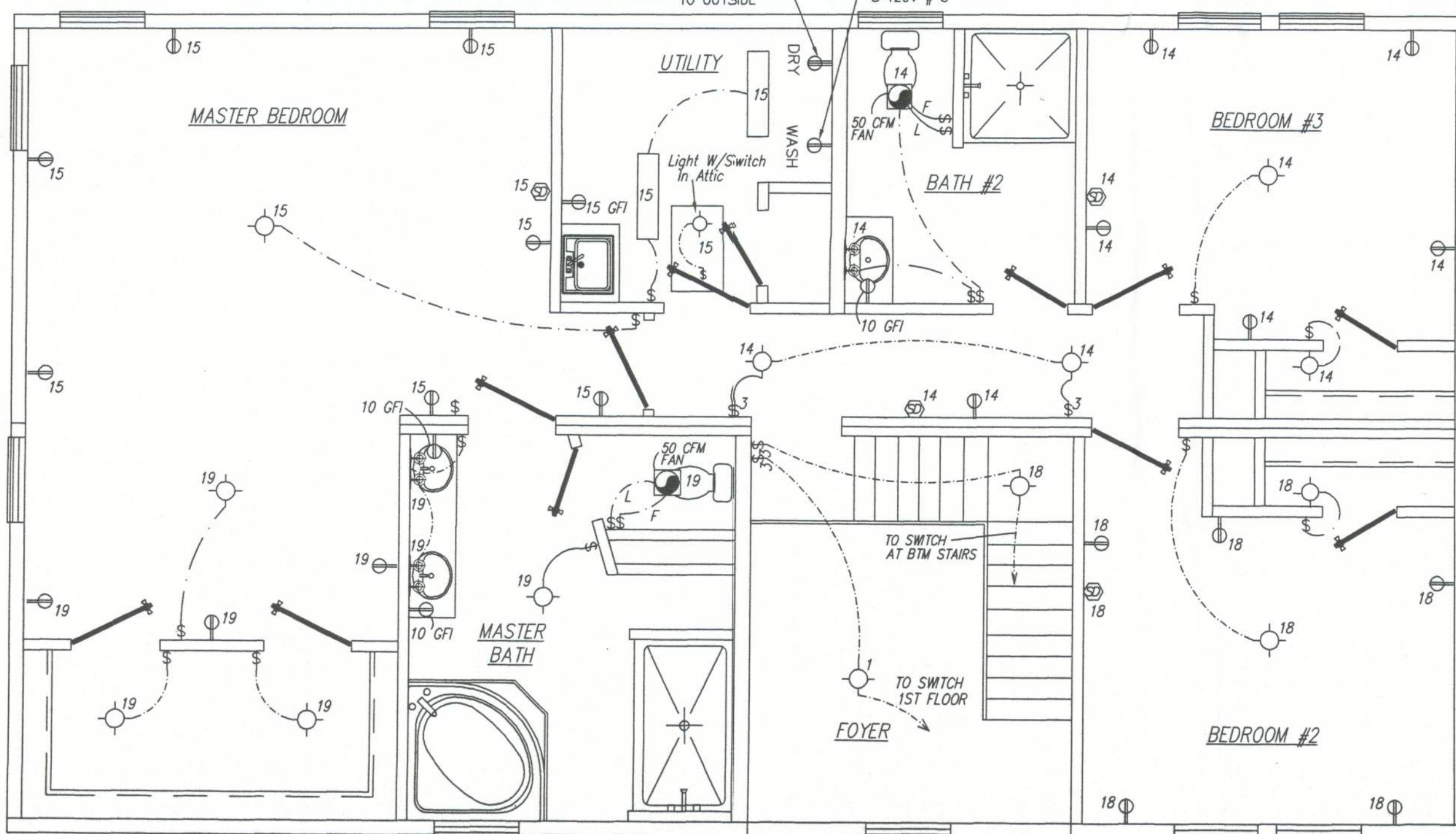

SECOND FLOOR ELECTRICAL PLAN

FRONT

PANEL SIZING

3016 Sq. Ft. @ 3 watts/Sq. Ft.	9.05 KW
3-20 AMP Appliance circuits	4.50 KW
Laundry circuit	1.50 KW
Cook Top	7.40 KW
Clothes Dryer	5.20 KW
Water Heater (worst case)	32.00 KW
Dishwasher	---
Wall Oven	3.40 KW
TOTAL	63.05 KW

First 10 KW @ 100%	10.00 KW
Remainder @ 40% (53.05)(.4)=	21.22 KW
Assumed HVAC	15.90 KW
TOTAL	47.12 KW

Calculated Load for service size
47120 w/240 volts= 196.0 Amperes
225 AMP service standard

ELECTRICAL LEDGEND

- \$ Light Switch
- ⊕ Duplex Recept
- ⊕ 240V Recept
- ⊕ Thermostat
- ⊕ Smoke Detector
- ⊕ W/Battery Backup
- ⊕ Porch light w/P
- ⊕ Incandescent Light
- ⊕ Exhaust fan w/Light
- ⊕ Panel box
- ⊕ Exhaust fan
- ⊕ Fluorescent Light
- ⊕ Range hood w/Exhaust Fan and Light

AGENCY APPROVAL

These prints comply with the Florida Manufactured Building Act of 1979 Construction Code and adhere to the following criteria:

Const. Type	VB
Occupancy	R-3
Allowable No. of Floors	2
Wind Velocity	150 (3 sec.)
Fire Rating of Ext. Walls	0
Plan No.	1R-2198-0012 f
Allow. Floor Load	40/30
Approval Date	12-17-07
Manufacturer	Townhomes
Approved for High Velocity Hurricane Zone	NO
HWC	COA # 1028

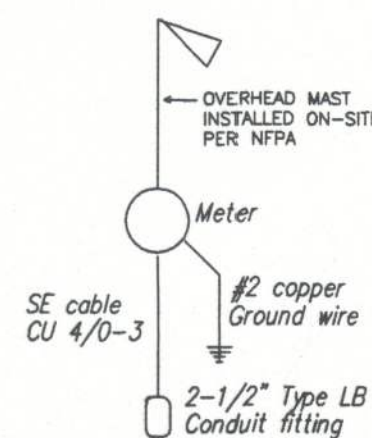
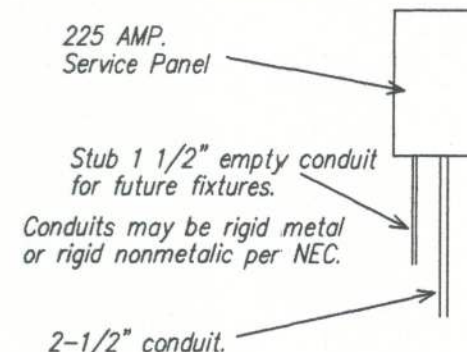

SERVICE DIAGRAM

225 AMP SERVICE

CIR	DESCRIPTION	COND.	SIZE (CU)	BRK(A)
1,2	General Lighting	14-2 w/GND	15	
3,4	Small Appliance	12-2 w/GND	20	
5	Washer	12-2 w/GND	20	
6	Cook Top	8-3 w/GND	40	2P
7,8	General Lighting	14-2 w/GND	15	
9	Dryer	10-3 w/GND	30	2P
10	Bath	12-2 w/GND	20	
12	Water Heater	10-2 w/GND	30	2P
13	Wall Oven	12-3 w/GND	20	2P
14,15	General Lighting	14-2 w/GND	15	
16	Dishwasher (opt)	12-2 w/GND	20	
17	Freezer (opt)	12-2 w/GND	20	
18,19	General Lighting	14-2 w/GND	15	
20	Small Appliance	12-2 w/GND	20	
21	Opt Water Heater*	(4)8-2 w/GND	40	2P

*Install Four 40A Circuits Each with a 40A 2P Breaker

NOTE: ALL BRANCH CIRCUITS SUPPLYING 15 AND 20 AMP OUTLETS IN BEDROOMS MUST BE PROTECTED BY AN ARC-FAULT CIRCUIT INTERRUPTER IN ACCORDANCE WITH SECTION 210.12 OF THE NEC (CIRCUITS 1, 14, 15, 18 & 19 MUST BE PROTECTED BY AN ARC-FAULT TYPE CIRCUIT BREAKER)

NOTE: HVAC SYSTEM TO BE SITE INSTALLED AND DESIGNED BY OTHERS, SUBJECT TO LOCAL BUILDING OFFICIAL REVIEW AND APPROVAL.

ELECTRICAL NOTES: NEC

- All circuits and equipment shall be grounded in accordance with the appropriate articles of the NEC.
- When light fixtures are installed in closets they shall be surface mounted or recessed. Incandescent fixtures shall have completely enclosed lamps. Surface mounted incandescent fixtures shall have minimum clearance of 12 inches and all other fixtures shall have a minimum clearance of 8 inches from "Storage Area" as defined by NEC 410-8(a).
- Where water heaters are installed they shall be provided with readily accessible disconnects adjacent to the water heaters served. The branch circuit switch or circuit breakers shall be permitted to serve as disconnecting means only where the switch or circuit breaker is within sight from the water heater or is capable of being locked in the open position.
- HVAC equipment shall be provided with readily accessible disconnects adjacent to the equipment served. A unit switch with a marked "OFF" position that is a part of the HVAC equipment and disconnects all ungrounded conductors shall be permitted as the disconnecting means where other disconnecting means are also provided by a readily accessible circuit breaker.
- Prior to energizing the electrical system the interrupting rating of the main breaker must be designed and verified by as being in compliance with section 110-9 of the NEC by local electrical consultant.
- The main electrical panel, service disconnect (main circuit breakers) and feeders are site installed, designed by others and subject to local jurisdiction review and approval.
- All circuits crossing over modular mating line(s) shall be site connected with approved accessible junction boxes, located below the floor or in the attic.
- All circuits to be copper NM except HVAC and Range circuits to be copper SE cable. (75°C).
- Light and switch to be site-installed in the crawl space near the crawl space access door (light to be connected to any of the installed general lighting circuits).
- Receptacles installed in wet locations must be in a weatherproof enclosure the integrity of which is not affected when the attachment plug cap is inserted or removed.
- Smoke detectors must be wired to activate all alarms simultaneously if any detector is activated. All smoke detectors located within twenty feet of a cooking appliance shall be the photoelectric type.
- All fans must be ducted to the exterior of the building and terminate at an approved vent cap.

TOWN HOMES LLC

P.O. BOX 1059
LAKE CITY, FLORIDA 32056

DATE: 11/21/06	REVISIONS: 11/30/07	DRAWN BY: C.A. Leblanc
CODES: FBC		
LABELS: FL		
SCALE: 1/4" = 1'-0"		
MODEL: 2901-1001 ELECTRICAL	PLAN NO. TH-2R	SHEET 4 OF 12
WILLIAM J. KALKER, JR., P.E. CONSULTING ENGINEER P.E. LICENSE #33841	33 ROCKWOOD LANE MONROE, CT 06468 (203) 261-1167	