

Columbia County Property Appraiser

Jeff Hampton

2022 Working Values

updated: 12/30/2021

Parcel: << 33-3S-16-02433-119 (9644) >>

Aerial Viewer Pictometry Google Maps

Owner & Property Info

Result: 2 of 2

Owner	KEENE CARMEN P O BOX 395 LAKE CITY, FL 32056		
Site	749 SW SUWANNEE DOWNS Dr, LAKE CITY		
Description*	LOT 19 SUWANNEE RIVER DOWNS S/D. ORB 644-392, DC 1293-298,		
Area	5.61 AC	S/T/R	33-3S-16
Use Code**	SINGLE FAMILY (0100)	Tax District	2

*The Description above is not to be used as the Legal Description for this parcel in any legal transaction.

**The Use Code is a FL Dept. of Revenue (DOR) code and is not maintained by the Property Appraiser's office. Please contact your city or county Planning & Zoning office for specific zoning information.

Property & Assessment Values

2021 Certified Values		2022 Working Values	
Mkt Land	\$32,538	Mkt Land	\$32,538
Ag Land	\$0	Ag Land	\$0
Building	\$199,627	Building	\$196,734
XFOB	\$2,700	XFOB	\$2,700
Just	\$234,865	Just	\$231,972
Class	\$0	Class	\$0
Appraised	\$234,865	Appraised	\$231,972
SOH Cap [?]	\$32,757	SOH Cap [?]	\$23,801
Assessed	\$202,108	Assessed	\$208,171
Exempt	HX HB WX SX \$100,500	Exempt	HX HB WX SX \$100,500
Total	county:\$101,608 city:\$0	Total	county:\$107,671 city:\$0
Taxable	other:\$0 school:\$176,608	Taxable	other:\$0 school:\$182,671

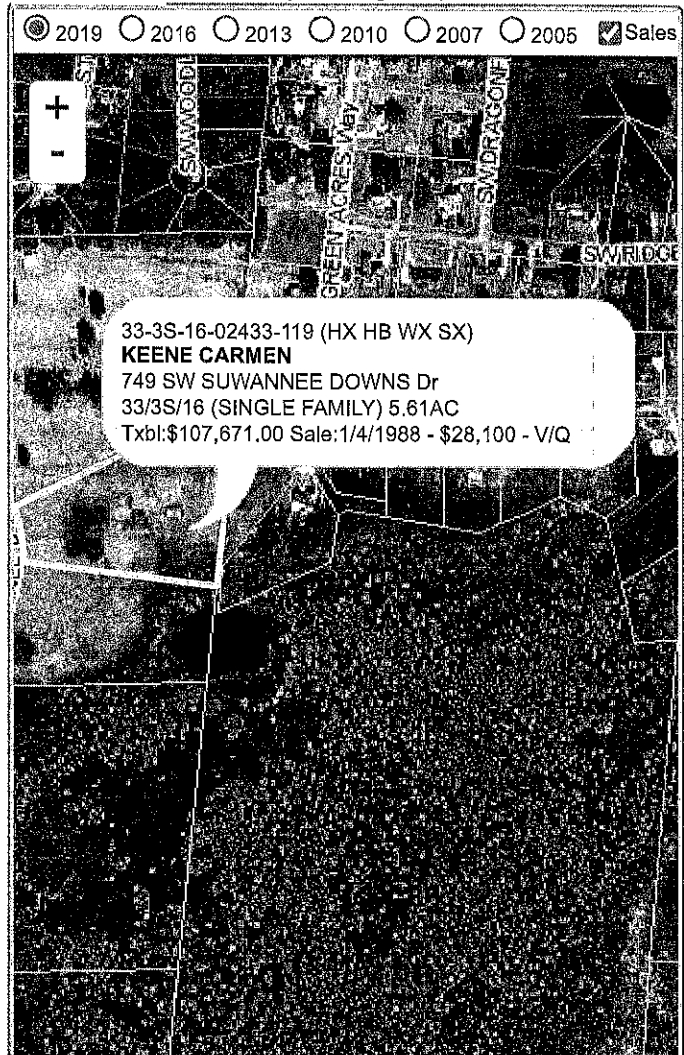

Sales History

Sale Date	Sale Price	Book/Page	Deed	V/I	Qualification (Codes)	RCode
1/4/1988	\$28,100	0644/0392	WD	V	Q	

Building Characteristics

Bldg Sketch	Description*	Year Blt	Base SF	Actual SF	Bldg Value
Sketch	SINGLE FAM (0100)	1989	2366	4411	\$196,734

*Bldg Desc determinations are used by the Property Appraisers office solely for the purpose of determining a property's Just Value for ad valorem tax purposes and should not be used for any other purpose.

Extra Features & Out Buildings (Codes)

Code	Desc	Year Blt	Value	Units	Dims
0180	FPLC 1STRY	0	\$2,000.00	1.00	0 x 0
0166	CONC,PAVMT	0	\$700.00	1.00	20 x 25

Land Breakdown

Code	Desc	Units	Adjustments	Eff Rate	Land Value
0100	SFR (MKT)	1.000 AC	1.0000/1.0000 1.0000/ /	\$5,800 /AC	\$5,800
0000	VAC RES (MKT)	4.610 AC	1.0000/1.0000 1.0000/ /	\$5,800 /AC	\$26,738