

Woods

Mobile Home Permit Worksheet

Installer: Ernest Scott Johnson License # 141/1025249Address of home being installed 189 SW Dogwood Lake Glen
Lake City FL 32024Manufacturer clayton Length x width 16x68

NOTE: if home is a single wide fill out one half of the blocking plan
if home is a triple or quad wide sketch in remainder of home
I understand Lateral Arm Systems cannot be used on any home (new or used)
where the sidewall ties exceed 5 ft 4 in.

Installer's initials ESJ

Typical pier spacing

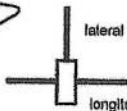
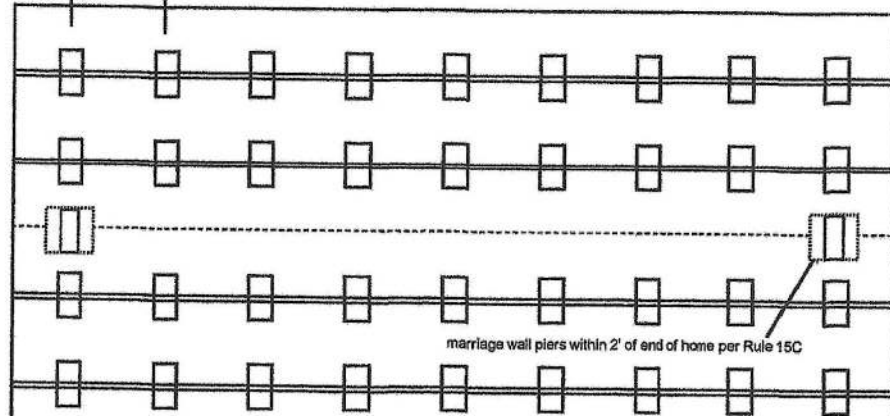
2' 6.6"Show locations of Longitudinal and Lateral Systems
(use dark lines to show these locations)

marriage wall piers within 2' of end of home per Rule 15C

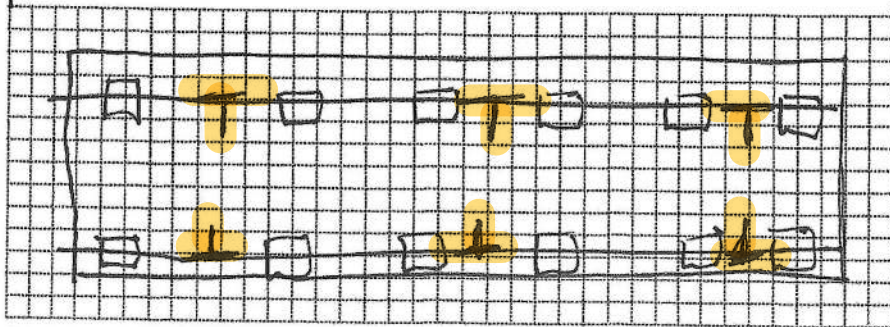

Application Number: _____ Date: _____

New Home ☒ Used Home ☐Home installed to the Manufacturer's Installation Manual
Home is installed in accordance with Rule 15-C ☒Single wide ☒ Wind Zone II ☒ Wind Zone III ☐Double wide ☐ Installation Decal # 99334Triple/Quad ☐ Serial # 29454

PIER SPACING TABLE FOR USED HOMES

Load bearing capacity	Footer size (sq in)	16" x 16" (256)	18 1/2" x 18 1/2" (342)	20" x 20" (400)	22" x 22" (484)*	24" x 24" (576)*	26" x 26" (676)
1000 psf		3'	4'	5'	6'	7'	8'
1500 psf		4' 6"	6'	7'	8'	8'	8'
2000 psf		6'	8'	8'	8'	8'	8'
2500 psf		7' 6"	8'	8'	8'	8'	8'
3000 psf		8'	8'	8'	8'	8'	8'
3500 psf		8'	8'	8'	8'	8'	8'

* interpolated from Rule 15C-1 pier spacing table.

PIER PAD SIZES

I-beam pier pad size 23x31 6.6Perimeter pier pad size oliver 1055-11 orOther pier pad sizes (required by the mfg.) 17.5x25.5

Draw the approximate locations of marriage wall openings 4 foot or greater. Use this symbol to show the piers.

List all marriage wall openings greater than 4 foot and their pier pad sizes below.

POPULAR PAD SIZES

Pad Size	Sq In
16 x 16	256
16 x 18	288
18.5 x 18.5	342
16 x 22.5	360
17 x 22	374
13 1/4 x 26 1/4	348
20 x 20	400
17 3/16 x 25 3/16	441
17 1/2 x 25 1/2	446
24 x 24	576
26 x 26	676

ANCHORS

4 ft ☒ 5 ft ☒

FRAME TIES

within 2' of end of home
spaced at 5' 4" oc ☒

OTHER TIES

	Number
Sidewall	<u>32</u>
Longitudinal	<u>0</u>
Marriage wall	<u>0</u>
Shearwall	<u>2</u>



Pier pad size Anthony Islan
03-29-2023

TIEDOWN COMPONENTS

Longitudinal Stabilizing Device (LSD)

Manufacturer

Longitudinal Stabilizing Device w/ Lateral Arms

Manufacturer Oliver 1101V

Mobile Home Permit Worksheet

POCKET PENETROMETER TEST

The pocket penetrometer tests are rounded down to _____ psf or check here to declare 1000 lb. soil _____ without testing.

X 1000 X 1000 X 1000

POCKET PENETROMETER TESTING METHOD

1. Test the perimeter of the home at 6 locations.
2. Take the reading at the depth of the footer.
3. Using 500 lb. increments, take the lowest reading and round down to that increment.

X 1000 X 1000 X 1000

TORQUE PROBE TEST

The results of the torque probe test is _____ inch pounds or check here if you are declaring 5' anchors without testing _____. A test showing 275 inch pounds or less will require 5 foot anchors.

Note: A state approved lateral arm system is being used and 4 ft. anchors are allowed at the sidewall locations. I understand 5 ft anchors are required at all centerline tie points where the torque test reading is 275 or less and where the mobile home manufacturer may require anchors with 4000 lb holding capacity.

Installer's initials EG

ALL TESTS MUST BE PERFORMED BY A LICENSED INSTALLER

Installer Name

Ernest S. Johnson

Date Tested

Assumed driver 11/11/14 uses 4 1/2" anchors

Electrical

Connect electrical conductors between multi-wide units, but not to the main power source. This includes the bonding wire between multi-wide units. Pg. _____

Plumbing

Connect all sewer drains to an existing sewer tap or septic tank. Pg. _____

Connect all potable water supply piping to an existing water meter, water tap, or other independent water supply systems. Pg. _____

Application Number: _____ Date: _____

Site Preparation

Debris and organic material removed ☒
 Water drainage: Natural ☐ Swale ☐ Pad ☒ Other _____

Fastening multi wide units

Floor: Type Fastener: lag Length: X Spacing: X
 Walls: Type Fastener: lag Length: X Spacing: X
 Roof: Type Fastener: lag Length: X Spacing: X
 For used homes a min. 30 gauge, 8" wide, galvanized metal strip will be centered over the peak of the roof and fastened with galv. roofing nails at 2" on center on both sides of the centerline.

Gasket (weatherproofing requirement)

I understand a properly installed gasket is a requirement of all new and used homes and that condensation, mold, mildew and buckled marriage walls are a result of a poorly installed or no gasket being installed. I understand a strip of tape will not serve as a gasket.

Installer's initials EG

Type gasket Pg. Factory

Installed:
 Between Floors Yes ☒
 Between Walls Yes ☒
 Bottom of ridgebeam Yes ☒

Weatherproofing

The bottomboard will be repaired and/or taped. Yes ☒ Pg. _____
 Siding on units is installed to manufacturer's specifications. Yes ☒
 Fireplace chimney installed so as not to allow intrusion of rain water. Yes ☒

Miscellaneous

Skirting to be installed. Yes ☒ No ☐
 Dryer vent installed outside of skirting. Yes ☒ N/A ☐
 Range downflow vent installed outside of skirting. Yes ☒ N/A ☐
 Drain lines supported at 4 foot intervals. Yes ☒
 Electrical crossovers protected. Yes ☒
 Other: _____

Installer verifies all information given with this permit worksheet is accurate and true based on the manufacturer's installation instructions and or Rule 15C-1 & 2

Installer Signature

Ernest S. Johnson

Date

The TIDE

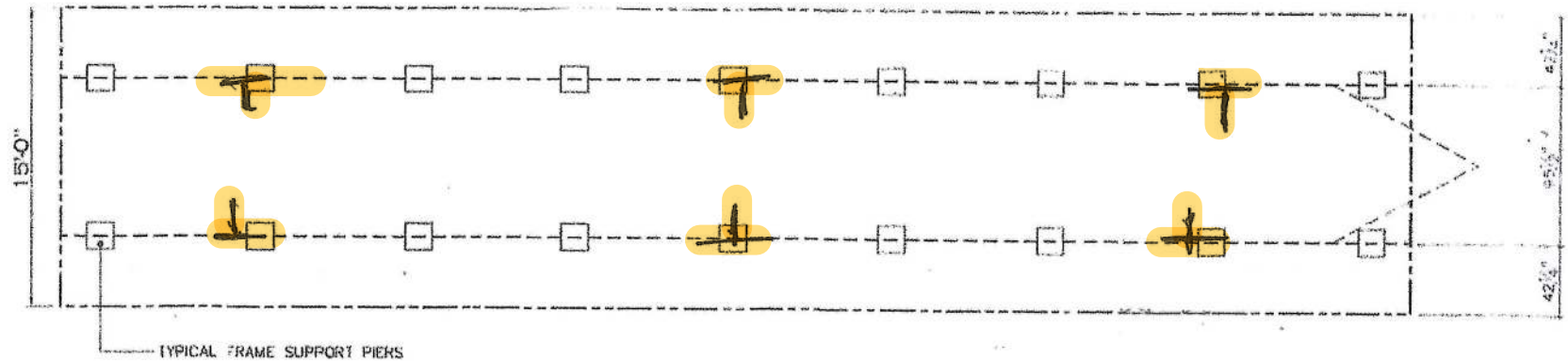

20 lb ROOF LOAD SIDEL WALL OPENING PIER LOAD 16" BOX WIDTH	SIDEL WALL OPENING (FT) REQUIRED PIER LOAD (LBS)					
	3	4	5	6	8	10
	1244	1413	1581	1750	2088	2425

*FOR 30 lb & 40 lb ROOF LOAD REFER TO TABLES 7 & 7a IN THE INSTALLATION MANUAL.

SERVICE DROP LEGEND	
[E]	ELECTRICAL DROP
[W]	WATER INLET
[D]	DWV PLUMBING DROP
[G]	GAS INLET



PIER LEGEND	
[]	PIER MAIN BEAM
[]	PIER PERIMETER
[]	PIER PORCH/RECESSED ENTRY

NOTES:

1. REFER TO TABLES 6 AND 6a IN THE INSTALLATION MANUAL FOR LOAD ON FRAME PIER FOOTINGS FOR HOMES THAT DO NOT REQUIRE PERIMETER BLOCKING REFER TO TABLES 7 AND 7a IN THE INSTALLATION MANUAL FOR LOAD ON FRAME PIER FOOTINGS FOR HOMES THAT REQUIRE PERIMETER BLOCKING REFER TO TABLES 10 AND 10a TO DETERMINE FOOTING SIZE FOR ALL PIERS.
2. REFER TO TABLE 9 FOR PIER CONFIGURATION AND MAXIMUM ALLOWABLE HEIGHTS. CROSS REFERENCE THE PIER HEIGHT WITH THE MAXIMUM ALLOWABLE FLOOR HEIGHT LISTED IN THE FRAME TIEDOWN CHARTS (TABLE 18, 19, AND 20).
3. THE MAXIMUM SPACING FOR FRAME SUPPORT PIERS FOR 8" I-BEAMS IS 8 FEET, 10" & 12" I-BEAMS IS 10 FEET.
4. SERVICE DROP LOCATIONS IDENTIFIED ARE APPROXIMATE.
5. FLOOR WIDTH SHOWN IS FOR STANDARD PRODUCT ONLY CONTACT THE MFG FACILITY FOR SPECIFICATIONS OF OPTIONS ORDERED

1,020 SQ.FT. (STD PLAN "CONDITIONED")

CMH COLUMBIA COUNTY BUILDING DEPARTMENT	15' x 42'0" (STD PLAN "CONDITIONED")	Rev. 12/18
	16' x 42'0" (STD PLAN "CONDITIONED")	CP-5016-68-2
Project Designer: Alex Whaley	16' x 68' Tide	

REV 12/22/2020 2:01 PM

Tide

