

COLUMBIA COUNTY PERMIT WORKSHEET

page 1 of 2

These worksheets must be completed and signed by the installer.
Submit the originals with the packet.

Installer RODNEY FEACIT License # 141005288

911 Address where home is being installed 538 COOPER TERR.
FT. WHITE, FL 32038

Manufacturer FOOTWOOD Length x width 16x76

NOTE: if home is a single wide fill out one half of the blocking plan
if home is a triple or quad wide sketch in remainder of home

I understand Lateral Arm Systems cannot be used on any home (new or used)
where the sidewall ties exceed 5 ft 4 in.

Installer's initials RF

Typical pier spacing

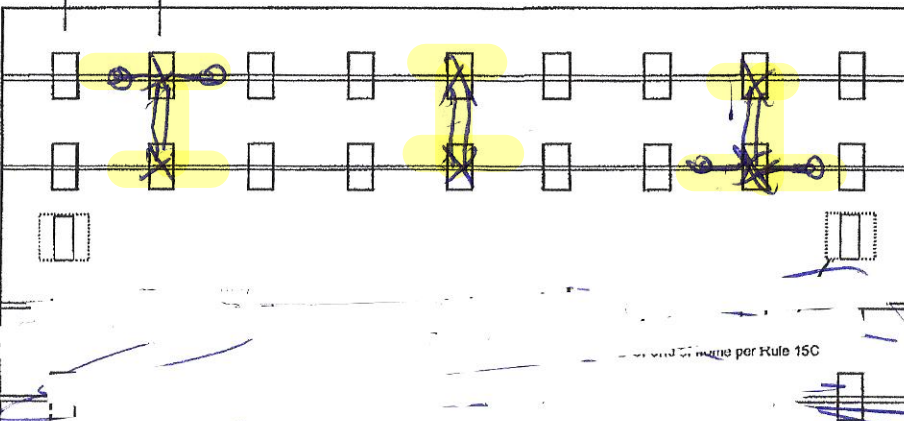
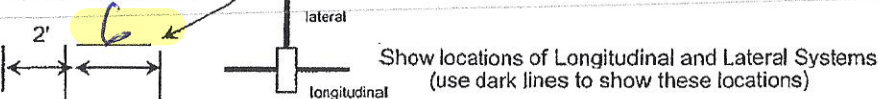

New Home ☐ Used Home ☒
Home installed to the Manufacturer's Installation Manual ☒
Home is installed in accordance with Rule 15-C ☐
Single wide ☒ Wind Zone II ☒ Wind Zone III ☐
Double wide ☐ Installation Decal # 73670
Triple/Quad ☐ Serial # 7318 A+B

PIER SPACING TABLE FOR USED HOMES

Load bearing capacity	Footer size (sq in)	16" x 16" (256)	18 1/2" x 18 1/2" (342)	20" x 20" (400)	22" x 22" (484)*	24" X 24" (576)*	26" x 26" (676)
1000 psf	3'	3'	4'	5'	6'	7'	8'
1500 psf	4' 6"	4' 6"	6'	7'	8'	8'	8'
2000 psf	6'	6'	8'	8'	8'	8'	8'
2500 psf	7' 6"	7' 6"	8'	8'	8'	8'	8'
3000 psf	8'	8'	8'	8'	8'	8'	8'
3500 psf	8'	8'	8'	8'	8'	8'	8'

* interpolated from Rule 15C-1 pier spacing table.

PIER PAD SIZES

I-beam pier pad size 17x25
Perimeter pier pad size N/A
Other pier pad sizes (required by the mfg.) 16x16

Draw the approximate locations of marriage wall openings 4 foot or greater. Use this symbol to show the piers.

List all marriage wall openings greater than 4 foot and their pier pad sizes below.

Opening	Pier pad size
<u>N/A</u>	

TIEDOWN COMPONENTS

Longitudinal Stabilizing Device (LSD)
Manufacturer
Longitudinal Stabilizing Device w/ Lateral Arms
Manufacturer OLIVER TECH

POPULAR PAD SIZES

Pad Size	Sq In
16 x 16	256
16 x 18	288
18.5 x 18.5	342
16 x 22.5	360
17 x 22	374
13 1/4 x 26 1/4	348
20 x 20	400
17 3/16 x 25 3/16	441
17 1/2 x 25 1/2	446
24 x 24	576
26 x 26	676

ANCHORS

4 ft ☒ 5 ft

FRAME TIES

within 2' of end of home spaced at 5' 4" oc

OTHER TIES

	Number
Sidewall	<u>0</u>
Longitudinal	<u>6</u>
Marriage wall	<u>0</u>
Shearwall	<u>0</u>



COLUMBIA COUNTY PERMIT WORKSHEET

page 2 of 2

POCKET PENETROMETER TEST

The pocket penetrometer tests are rounded down to 1500 psf
or check here to declare 1000 lb. soil _____ without testing.

X 1500 X 1500 X 1500

POCKET PENETROMETER TESTING METHOD

1. Test the perimeter of the home at 6 locations.
2. Take the reading at the depth of the footer.
3. Using 500 lb. increments, take the lowest reading and round down to that increment.

X 1500 X 1500 X 1500

TORQUE PROBE TEST

The results of the torque probe test is 285 inch pounds or check here if you are declaring 5" anchors without testing _____. A test showing 275 inch pounds or less will require 5 foot anchors.

Note: A state approved lateral arm system is being used and 4 ft. anchors are allowed at the sidewall locations. I understand 5 ft anchors are required at all centerline tie points where the torque test reading is 275 or less and where the mobile home manufacturer may require anchors with 4000 lb holding capacity.

RF Installer's initials

ALL TESTS MUST BE PERFORMED BY A LICENSED INSTALLER

Installer Name

ROONEY PEAGLE

Date Tested

8-21-20

Electrical

Connect electrical conductors between multi-wide units, but not to the main power source. This includes the bonding wire between multi-wide units. Pg. _____

Plumbing

Connect all sewer drains to an existing sewer tap or septic tank. Pg. _____

Connect all potable water supply piping to an existing water meter, water tap, or other independent water supply systems. Pg. _____



Site Preparation

Debris and organic material removed ☒ Swale ☐ Pad ☐ Other ☐

Fastening multi wide units

Floor: Type Fastener: N/A Length: N/A Spacing: N/A
Walls: Type Fastener: N/A Length: N/A Spacing: N/A
Roof: Type Fastener: N/A Length: N/A Spacing: N/A
For used homes a min. 30 gauge, 8" wide, galvanized metal strip will be centered over the peak of the roof and fastened with galv. roofing nails at 2" on center on both sides of the centerline.

Gasket (weatherproofing requirement)

I understand a properly installed gasket is a requirement of all new and used homes and that condensation, mold, mildew and buckled marriage walls are a result of a poorly installed or no gasket being installed. I understand a strip of tape will not serve as a gasket.

Installer's initials N/A

Type gasket Pg. N/A

Installed:
Between Floors Yes N/A
Between Walls Yes N/A
Bottom of ridgebeam Yes N/A

Weatherproofing

The bottomboard will be repaired and/or taped. Yes ☒ Pg. _____
Siding on units is installed to manufacturer's specifications. Yes ☒
Fireplace chimney installed so as not to allow intrusion of rain water. Yes ☒

Miscellaneous

Skirting to be installed. Yes ☒ No ☐
Dryer vent installed outside of skirting. Yes ☒ N/A ☐
Range downflow vent installed outside of skirting. Yes ☒ N/A ☐
Drain lines supported at 4 foot intervals. Yes ☒
Electrical crossovers protected. Yes ☒
Other: _____

Installer verifies all information given with this permit worksheet is accurate and true based on the

Installer Signature [Signature]

Date 8-21-20

BORDES 16 X 76 S/W BLOCKING DIAGRAM

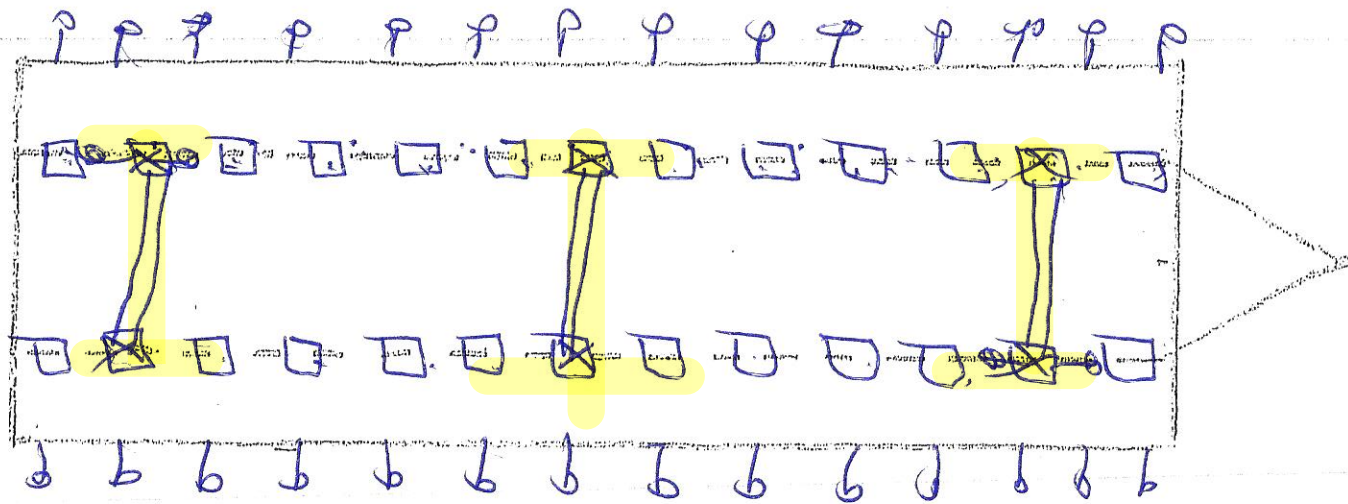
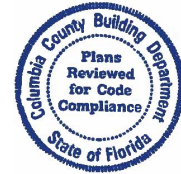

□ - PADS 17 X 25 6" c 13 PER RAIL

⊠ - LSD X 6 systems (OLIVER TECH)

⊙ - ANCHORS 4 FT @ 5' 4" o/c 14 PER SIDE

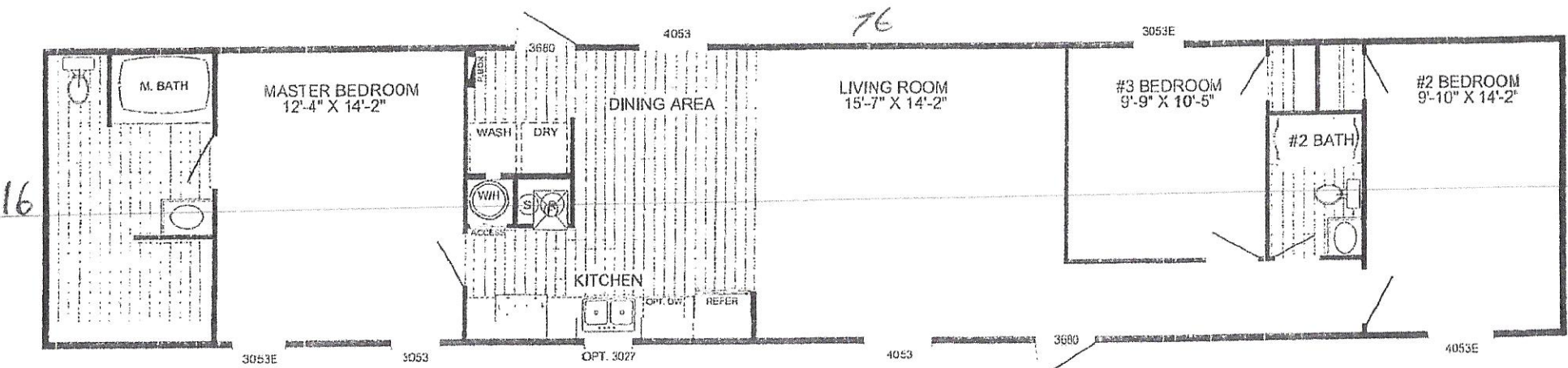

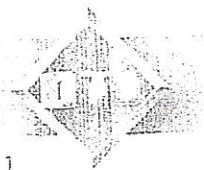
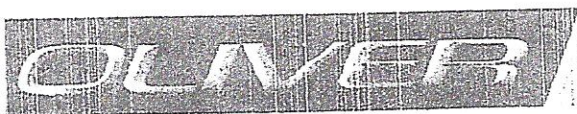

467 Swan Ave • Hohenwald, TN 38462 • (800) 284-7437 • www.olivertechnologies.com • Fax (931) 796-8811

INSTALLATION USING CONCRETE RUNNER/ FOOTER

15. A concrete runner, footer or slab may be used in place of the steel ground pan.

- The concrete shall be minimum 2500 psi mix
- A concrete runner may be either longitudinal or transverse, and must be a minimum of 8" deep with a minimum width of 16 inches longitudinally or 18 inches transverse to allow proper distance between the concrete bolt and the edge of the concrete (see below).
- Footers must have minimum surface area of 441 sq. in. (i.e. 21" square), and must be a minimum of 8" deep.
- If a full slab is used, the depth must be a 4" minimum. Special inspection of the system bracket installation is not required. Footers must allow for at least 4" from the concrete bolt to the edge of the concrete.

NOTE: The bottom of all footings, pads, slabs and runners must be per local jurisdiction:

LONGITUDINAL: (Model 1101 LC "V")



16. When using Part# 1101-W-CPCA (wetset) simply install the bracket in runner/footer OR When installing in cured concrete use Part# 101-D-CPCA (dryset). The 1101 (dryset) CA bracket is attached to the concrete using (2) 5/8"x3" concrete wedge bolts (Simpson part # S162300H 5/8" X 3" or Powers equivalent). Place the CA bracket in desired location. Mark bolt hole locations, then using a 5/8" diameter masonry bit, drill a hole to a minimum depth of 3". Make sure all dust and concrete is blown out of the holes. Place wedge bolts into drilled holes, then place 1101 (dry set) CA bracket onto wedge bolts and start wedge bolt nuts. Take a hammer and lightly drive the wedge bolts down by hitting the nut (making sure not to hit the top of threads on bolt). The sleeve of concrete wedge bolt needs to be at or below the top of concrete. Complete by tightening nuts.

LATERAL: (Model 1101 LC "V")

17. For wet set (part # 1101-W-TACA) installation simply install the anchor bolt into runner/footer. For dry set installation (part # 1101-D-TACA) mark bolt hole locations, then using a 5/8" diam. masonry bit, drill a hole to a minimum depth of 3". Make sure all dust and concrete is blown out of the hole. Place wedge bolts (Simpson part #S162300H 5/8" X 3" or Powers equivalent) into (D) concrete dry transverse connector and into drilled hole. If needed, take a hammer and lightly drive the wedge bolts down by hitting the nut (making sure not to hit the top of threads on bolt), then remove the nut. The sleeve of concrete wedge bolt needs to be at or below the top of concrete.

18. When using part# 1101 CVW (wetset) or 1101 CVD (dryset), install per steps 17 & 18.

Notes:

- LENGTH OF HOUSE IS THE ACTUAL BOX SIZE
-  = LOCATION OF TRANSVERSE BRACING ONLY
-  = LOCATION OF LONGITUDINAL BRACING ONLY
-  = TRANSVERSE AND LONGITUDINAL LOCATIONS



ALL WIDTHS AND LENGTHS UP TO 52'

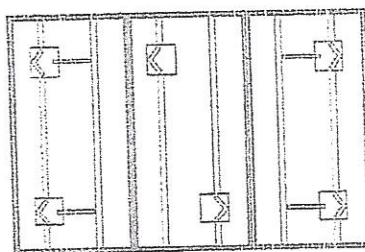
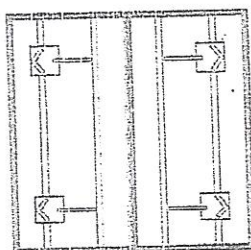
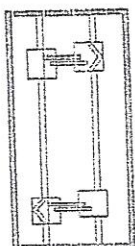

ALL WIDTHS AND LENGTHS OVER 52' TO 80"

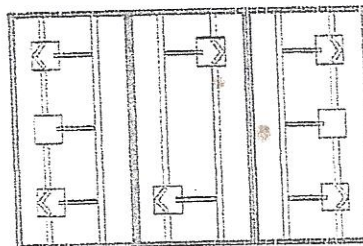
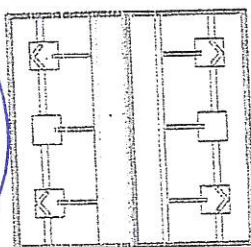
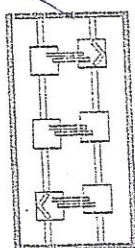

HOMES WITH 5/12 ROOF PITCH REQUIRE: PER FLORIDA REGULATIONS

6 systems for home lengths up to 52' and 8 systems for homes over 52' and up to 80'.

PATENT# 6634150 & OTHER PATENT PENDING

LATOYA BONDS 16 X 76 S/W-



STATE OF FLORIDA
INSTALLATION CERTIFICATION LABEL

73670

LABEL #

DATE OF INSTALLATION

RODNEY L. FEAGLE

NAME

IH / 1025288 / 1

4557

LICENSE #

ORDER #

CERTIFIES THAT THE INSTALLATION OF THIS MOBILE HOME IS
IN ACCORDANCE WITH FLORIDA STATUTES 320.8249, 320.8325
AND RULES OF THE HIGHWAY SAFETY AND MOTOR VEHICLES.

INSTRUCTIONS

PLEASE WRITE DATE OF
INSTALLATION AND AFFIX
LABEL NEXT TO HUD LABEL.
USE PERMANENT INK PEN
OR MARKER ONLY.
COMPLETE INFORMATION
ABOVE AND KEEP ON FILE
FOR A MINIMUM OF 2 YEARS.
YOU ARE REQUIRED TO
PROVIDE COPIES WHEN
REQUESTED.

COPY OF DECAL
TO BE PUT ON
HOME AT SET.