

## SECOND FLOOR PLAN

NOTES:

- 1) ALL EXTERIOR WALLS ARE 2x6 EXCEPT AS NOTED
- 2) ALL INTERIOR WALLS ARE 2x4 EXCEPT AS NOTED
- 3) ALL WALL THICKNESSES ARE ACTUAL 2x4+3/4"  
2x6+5/8" 2x8-1/4", ETC.,
- 4) THE SIZE AND QUANTITY OF ALL EXTERIOR STEPS ARE  
TO BE FIELD DETERMINED BY OTHERS.
- 5) ALL PLATE AND CEILING HEIGHTS ARE TAKEN FROM  
(TOP OF) HOUSE SLAB TO FINISH.
- 6) VERIFY THE KITCHEN AND VANITY LAYOUTS WITH  
THE DETAILS DONE BY OTHERS.
- 7) ALL ANGLES ARE 45° UNLESS OTHERWISE NOTED.
- 8) ALL INTERIOR AND EXTERIOR FLOOR & STEP FINISHES  
SHALL HAVE A NON-SLIP FINISH TO MEET  
ASTM C1028 STATIC COEFFICIENT OF FRICTION MIN. OF  $\phi_{6}$ .
- 9) ALL WORK IN CONTACT WITH MASSIVE CONCRETE OR FORTH  
SHALL BE PRESSURE TREATED APPROPRIATELY FOR THE CONDITION

TYPICAL  
RECESS DETAIL

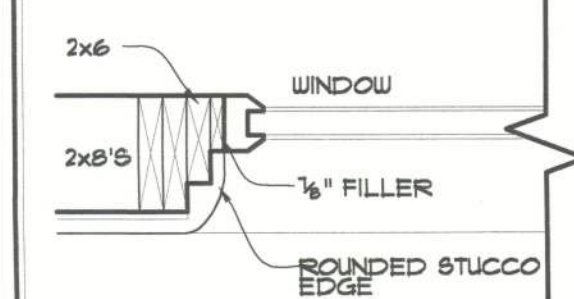

AN7005  
21 OCT 200

## HUBER RESIDENCE

THE NW 1/4 OF NE 1/4, SECTION 1  
T 5 - S, R 16 - E  
COLUMBIA COUNTY, FLORIDA

DRAWN BY:	BY, RFF, AJD
CHECKED BY:	mg
DATE:	7/13/05
SCALE:	$\frac{1}{4}'' = 1' - 0''$
JOB NUMBER:	4800
REVISED:	.
DWG NO:	

4 13

**A Joint Venture Partnership**

  
**NICHOLAS  
PAUL  
GEISLER  
ARCHITECT**  
N.C.A.R.B. Certified

1758 NW Brown Rd.  
Lake City, FL 32055  
386-755-9021



10751 Duewood Park Blvd.  
Suite #120  
Jacksonville, Florida 32256

PHONE: (904) 384-3265  
FAX: (904) 389-1250  
[www.kevingray.com](http://www.kevingray.com)

RESIDENTIAL DESIGNS BY KEVIN GRAY, INC.

## NOTICE

Contractors from these plans should not be undertaken without the issuance of plans from this office and obtain the number of responsibility to review and verify all safety, dimensions, details and specifications of the building codes, prior to commencement of any construction.

Any discrepancy or errors in notes, dimensions, details or their adherence to applicable building codes shall be brought to the attention of the building department for correction prior to commencement of any construction.

These plans are copyrighted and may not be copied or reproduced in any form, by any means or manner without the prior written permission of the building department.

©2005 Residential Design by Kevin Gray, Inc.