

FRONT

GARAGE DOOR

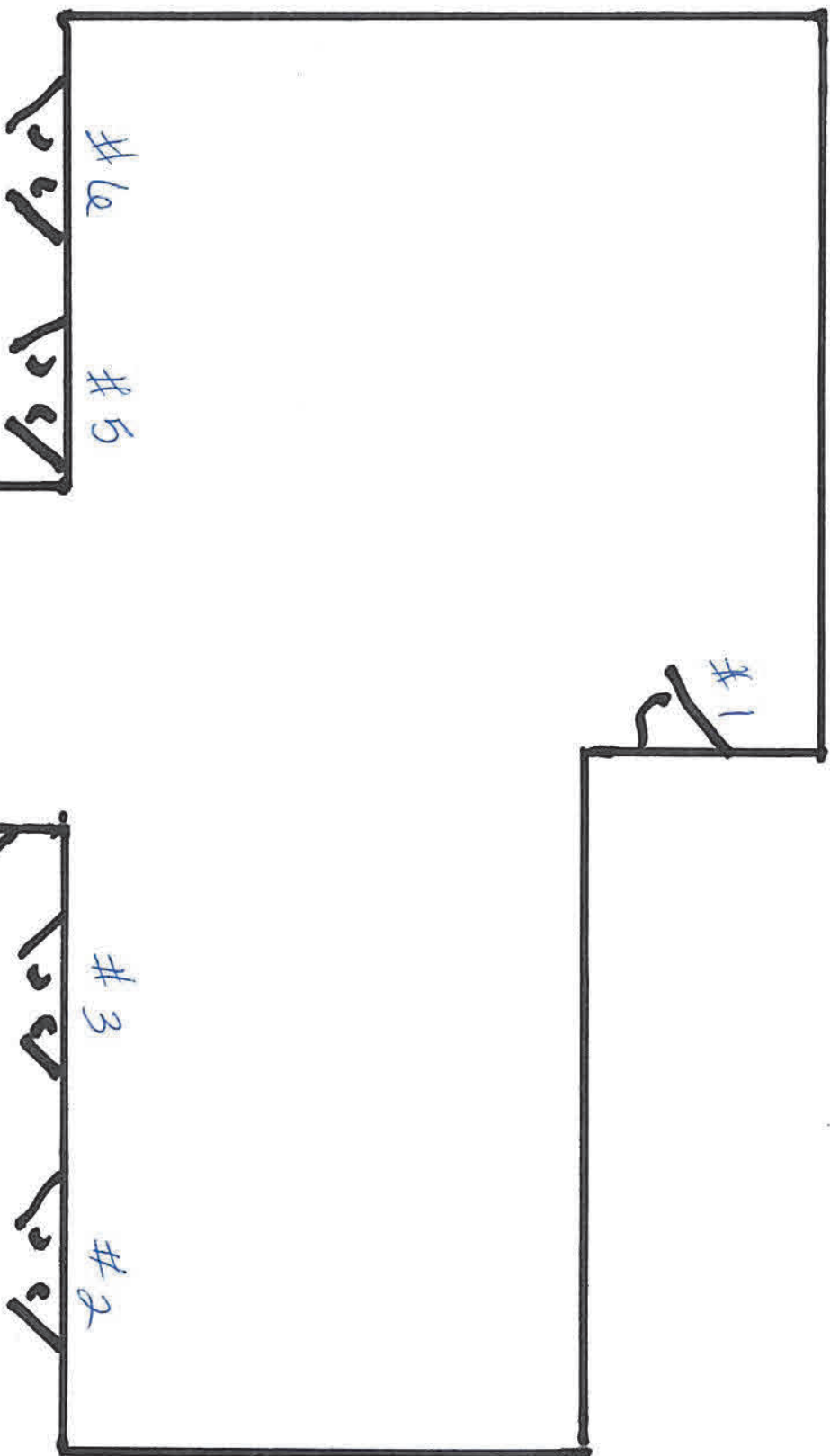

BACK

ROBERT MORRIS
391 S.W. EQUESTRIAN WAY
LAKE CITY FL
32024



COLUMBIA COUNTY PRODUCT APPROVAL SPECIFICATION SHEET

As required by Florida Statute 553.842 and Florida Administrative Code 9B-72, please provide the information and approval numbers on the building components listed below if they will be utilized on the construction project for which you are applying for a building permit. We recommend you contact your local product supplier should you not know the product approval number for any of the applicable listed products. Statewide approved products are listed online at www.floridabuilding.org.

Category/Subcategory	Manufacturer	Product Description	Approval Number(s)
1. EXTERIOR DOORS			
A. SWINGING	Jeld-Wen		13541.4, 13541.2, 15474.1
B. SLIDING			
C. SECTIONAL/ROLL UP			
D. OTHER			
2. WINDOWS			
A. SINGLE/DOUBLE HUNG			
B. HORIZONTAL SLIDER			
C. CASEMENT			
D. FIXED			
E. MULLION			
F. SKYLIGHTS			
G. OTHER			
3. PANEL WALL			
A. SIDING			
B. SOFFITS			
C. STOREFRONTS			
D. GLASS BLOCK			
E. OTHER			
4. ROOFING PRODUCTS			
A. ASPHALT SHINGLES			
B. NON-STRUCT METAL			
C. ROOFING TILES			
D. SINGLE PLY ROOF			
E. OTHER			
5. STRUCT COMPONENTS			
A. WOOD CONNECTORS			
B. WOOD ANCHORS			
C. TRUSS PLATES			
D. INSULATION FORMS			
E. LINTELS			
F. OTHERS			
6. NEW EXTERIOR			
A. ENVELOPE PRODUCTS			

The products listed below did not demonstrate product approval at plan review. I understand that at the time of inspection of these products, the following information must be available to the inspector on the jobsite; (1) copy of the product approval (2) performance characteristics which the product was tested and certified to comply with (3) copy of the applicable manufacturer's installation requirements. Further, I understand these products may have to be removed if approval cannot be demonstrated during inspection.

APPLICANT SIGNATURE

5/5/2023

DATE



Product Approval
USER: Public User

[Product Approval Menu](#) > [Product or Application Search](#) > **Application List**

► OFFICE OF THE
SECRETARY

Search Criteria

[Refine Search](#)

Code Version	2020	FL#	13541.2
Application Type	ALL	Product Manufacturer	ALL
Category	ALL	Subcategory	ALL
Application Status	ALL	Compliance Method	ALL
Quality Assurance Entity	ALL	Quality Assurance Entity Contract Expired	ALL
Product Model, Number or Name	ALL	Product Description	ALL
Approved for use in HVHZ	ALL	Approved for use outside HVHZ	ALL
Impact Resistant	ALL	Design Pressure	ALL
Other	ALL		

Search Results - Applications

FL#	Type	Manufacturer	Validated By	Status
FL13541-R18 History	Revision	JELD-WEN FL#: FL13541.2 Model: B. Design Pro / Smooth Pro Fiberglass Description: Single (X) Glazed Fiberglass Door, 3'-0" x 6'-8" and 3'-0" x 8'-0", Inswing and Outswing Category: Exterior Doors Subcategory: Swinging Exterior Door Assemblies	National Accreditation & Management Institute (804) 684-5124	Approved *

*Approved by DBPR. Approvals by DBPR shall be reviewed and ratified by the POC and/or the Commission if necessary.

[Contact Us](#) :: 2601 Blair Stone Road, Tallahassee FL 32399 Phone: 850-487-1824

The State of Florida is an AA/EEO employer. [Copyright 2007-2013 State of Florida](#). :: [Privacy Statement](#) :: [Accessibility Statement](#) :: [Refund Statement](#)

Under Florida law, email addresses are public records. If you do not want your e-mail address released in response to a public-records request, do not send electronic mail to this entity. Instead, contact the office by phone or by traditional mail. If you have any questions, please contact 850.487.1395. *Pursuant to Section 455.275(1), Florida Statutes, effective October 1, 2012, licensees licensed under Chapter 455, F.S. must provide the Department with an email address if they have one. The emails provided may be used for official communication with the licensee. However email addresses are public record. If you do not wish to supply a personal address, please provide the Department with an email address which can be made available to the public. To determine if you are a licensee under Chapter 455, F.S., please click [here](#).

Product Approval Accepts:





Product Approval
USER: Public User

[Product Approval Menu](#) > [Product or Application Search](#) > [Application List](#) > **Application Detail**

► OFFICE OF THE
SECRETARY

FL #	FL13541-R18						
Application Type	Revision						
Code Version	2020						
Application Status	Approved						
	*Approved by DBPR. Approvals by DBPR shall be reviewed and ratified by the POC and/or the Commission if necessary.						
Comments							
Archived	<input type="checkbox"/>						
Product Manufacturer	JELD-WEN						
Address/Phone/Email	3737 Lakeport Blvd Klamath Falls, OR 97601 (800) 535-3936 fbc1@jeld-wen.com						
Authorized Signature	Rylee Sumner Fricks fbc1@jeld-wen.com						
Technical Representative	JELD-WEN Corporate Customer Service						
Address/Phone/Email	3737 Lakeport Blvd. Klamath Falls, OR 97601 (800) 535-3936 customerserviceagents@jeld-wen.com						
Quality Assurance Representative							
Address/Phone/Email							
Category	Exterior Doors						
Subcategory	Swinging Exterior Door Assemblies						
Compliance Method	Certification Mark or Listing						
Certification Agency	National Accreditation & Management Institute						
Validated By	National Accreditation & Management Institute						
Referenced Standard and Year (of Standard)	<table> <thead> <tr> <th><u>Standard</u></th><th><u>Year</u></th></tr> </thead> <tbody> <tr> <td>ASTM E330</td><td>2014</td></tr> <tr> <td>TAS 202</td><td>1994</td></tr> </tbody> </table>	<u>Standard</u>	<u>Year</u>	ASTM E330	2014	TAS 202	1994
<u>Standard</u>	<u>Year</u>						
ASTM E330	2014						
TAS 202	1994						
Equivalence of Product Standards Certified By	Florida Licensed Professional Engineer or Architect FL13541_R18_Equiv_ASTM_E330_Letter_of_Equivalence_07_06_2020.pdf						
Product Approval Method	Method 1 Option A						
Date Submitted	08/03/2020						

JELD-WEN®

WINDOWS & DOORS

DESIGN PRO / SMOOTH PRO FULL LITE

NON-IMPACT

FOR USE OUTSIDE THE HIGH VELOCITY HURRICANE ZONE (HVHZ)

GENERAL NOTES:

- THE PRODUCT SHOWN HEREIN IS DESIGNED AND MANUFACTURED TO COMPLY WITH THE CURRENT INTERNATIONAL BUILDING CODE (IBC), INTERNATIONAL RESIDENTIAL CODE (IRC), AND FLORIDA BUILDING CODE (FBC), **EXCLUDING** HVHZ AND HAS BEEN EVALUATED ACCORDING TO THE FOLLOWING:
 - ASTM E330-02
 - ASTM E283-04
 - AAMA 1304-02
- ADEQUACY OF THE EXISTING STRUCTURAL CONCRETE/MASONRY OR 2X FRAMING AS A MAIN WIND FORCE RESISTING SYSTEM CAPABLE OF WITHSTANDING AND TRANSFERRING APPLIED PRODUCT LOADS TO THE FOUNDATION IS THE RESPONSIBILITY OF THE ENGINEER OR ARCHITECT OF RECORD FOR THE PROJECT OF INSTALLATION.
- THE INSTALLATION DETAILS DESCRIBED HEREIN ARE GENERIC AND MAY NOT REFLECT ACTUAL CONDITIONS FOR A SPECIFIC SITE. IF SITE CONDITIONS CAUSE INSTALLATION TO DEVIATE FROM THE REQUIREMENTS DETAILED HEREIN, A LICENSED ENGINEER OR ARCHITECT SHALL PREPARE SITE SPECIFIC DOCUMENTS FOR USE WITH THIS DOCUMENT.
- APPROVED IMPACT PROTECTIVE SYSTEM **IS REQUIRED** ON THIS PRODUCT IN AREAS REQUIRING IMPACT RESISTANCE.
- GLASS MEETS THE REQUIREMENTS OF ASTM E 1300 GLASS CHARTS. SEE SHEET 6 FOR GLAZING DETAILS.
- FULL LITE APPROVAL COVERS USE OF FRACTIONAL GLAZING, INCLUDING INTERNAL GRID, BLINDS BETWEEN GLASS, DECORATIVE, AND EXTERNAL AND INTERNAL WROUGHT IRON. VENT LITES ARE QUALIFIED FOR 6'-8" DOORS ONLY. RADIUS (SHAPED) LITES ARE QUALIFIED FOR 6'-8" DOORS AT DP +/-50 PSF ONLY.
- NOTE: AFCO H-497 SILL MEETS WATER INFILTRATION AT WATER TEST PRESSURE (WTP) OF 9.75 PSF. REMAINING SILLS NOT RATED FOR WATER INFILTRATION. IF AUTHORITY HAVING JURISDICTION REQUIRES THAT PRODUCT MEETS THIS REQUIREMENT, PRODUCT SHALL BE USED WHEN INSTALLED AT LOCATION PROTECTED BY OVERHANG SUCH THAT OVERHANG (OH) RATIO = OH LENGTH ÷ OH HEIGHT IS ≥ 1.0

TABLE OF CONTENTS		
SHEET	REVISION	SHEET DESCRIPTION
1	A	TYPICAL ELEVATIONS, DESIGN PRESSURES, AND GENERAL NOTES
2	A	TYPICAL ANCHOR LAYOUTS AND NOTES
3	-	OPTIONAL 2X BUCK ANCHORING DETAILS
4	A	VERTICAL ASSEMBLIES
5	A	HORIZONTAL ASSEMBLIES
6	A	GLAZING DETAILS
7	A	WOOD SUBSTRATES
8	A	CONCRETE SUBSTRATES
9	A	COMPONENTS & BILL OF MATERIALS

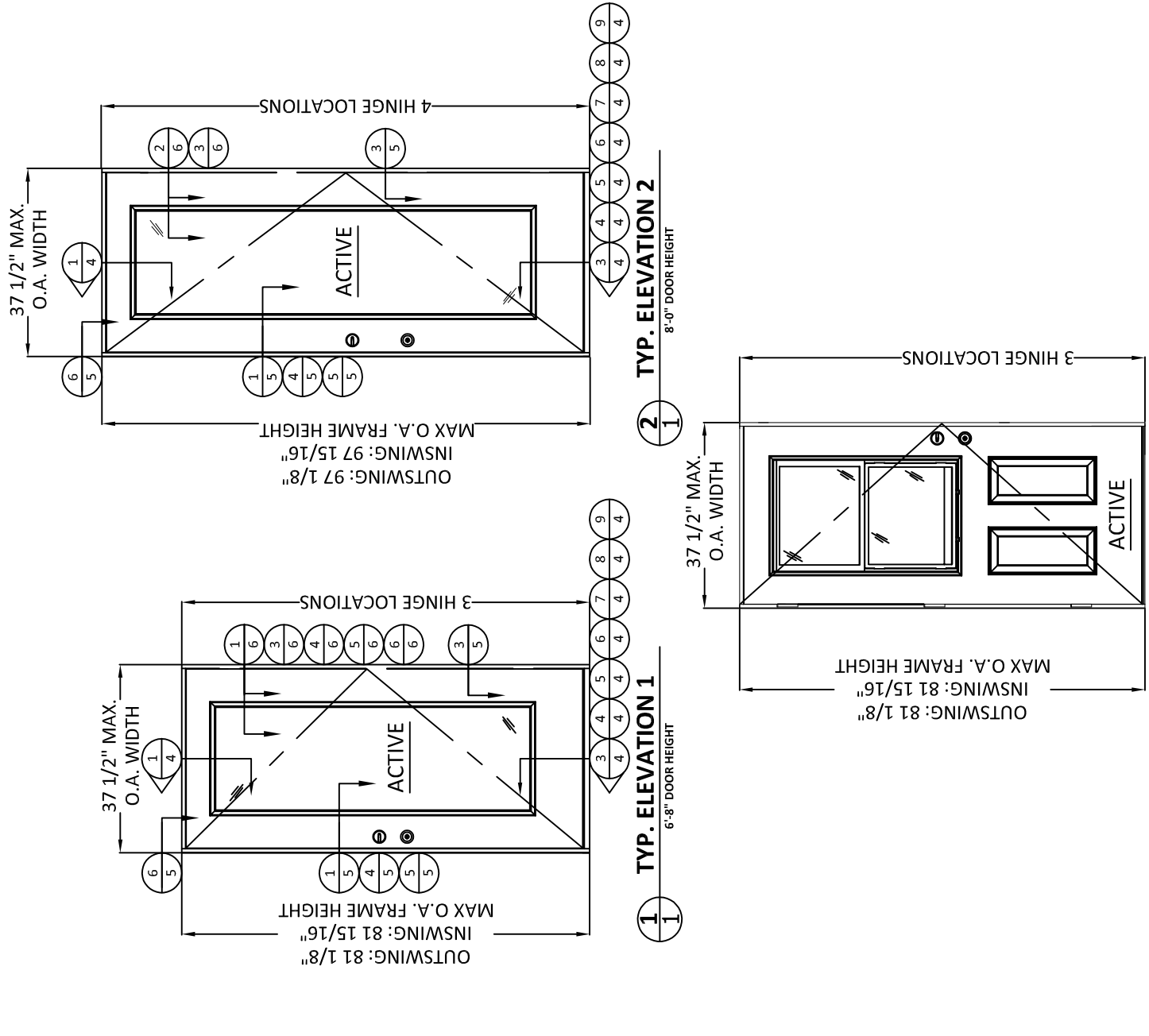

NOTE:
DOORS SHOWN ABOVE MAY BE LEFT
OR RIGHT HAND OPERATING DOORS.

3 TYP. ELEVATION 3
6'-8" DOOR WITH OPTIONAL VENT LITE
SEE SHEET 6 FOR GLAZING DETAILS

CONFIGURATION	MAX. OVERALL NOMINAL SIZE		DESIGN PRESSURE (PSF)			MISSILE IMPACT RATING
	WIDTH	HEIGHT	INSWING	OUTSWING		
X	3'-0"	6'-8"	POS. 50*	NEG. 50	POS. 50*	NON-IMPACT
X RADIUS	3'-0"	6'-8"	50*	50	50*	NON-IMPACT
X VENT	3'-0"	6'-8"	50*	50	50*	NON-IMPACT
X	3'-0"	8'-0"	50*	50	50*	NON-IMPACT

*SEE GENERAL NOTE 7, SHEET 1, FOR WATER INFILTRATION APPROVED SILLS.

PREPARED BY:



BUILDING DROPS, INC.
398 E. DANIA BEACH BLVD., STE. 338
DANIA BEACH, FL 33004
PH: (954)399-8478
FAX: (954)744-4738
WEB: www.buildingdrops.com

TITLE: *DESIGN PRO/SMOOTH PRO FULL LITE*
TYPICAL ELEVATIONS, DESIGN PRESSURES, AND GENERAL NOTES
NON-IMPACT

3737 LAKEPORT BLVD.,
KLAMATH FALLS, OR 97601
PH: (541)882-3451
FAX: (541)850-2609

JELD-WEN
WINDOWS & DOORS

REMARKS	BY	DATE
Add ADA sill, Multi-Point Lock	GL	06/05/14
Reference DWG. #A010832A	AM	09/04/19

THE INSTALLATION DETAILS DESCRIBED HEREIN ARE GENERIC AND MAY NOT REFLECT ACTUAL CONDITIONS FOR A SPECIFIC SITE. IF SITE CONDITIONS CAUSE INSTALLATION TO DEVIATE FROM THE REQUIREMENTS DETAILED HEREIN, A LICENSED ENGINEER OR ARCHITECT SHALL PREPARE SITE SPECIFIC DOCUMENTS FOR USE WITH THIS DOCUMENT.

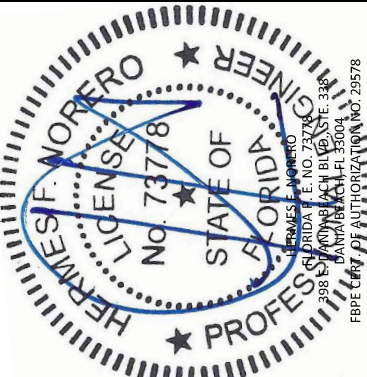

Digitally signed by Hermes F Norero
Reason: I am approving this document
Date: 2019.10.01 19:00:01 -04'00'

DATE:	02.05.14		
DWG. BY:	GL/TJM	CHK. BY:	SS/MSS
SCALE:	NTS		
DWG. #:	D015687		
SHEET:	OF 9		

PREPARED BY:



BUILDING DROPS, INC.

398 E. DANIA BEACH BLVD., STE. 338
DANIA BEACH, FL 33004
PH: (954)399-8478
FAX: (954)744-4738
WEB: www.buildingdrops.com

DESIGN PRO/SMOOTH PRO FULL LITE

ANCHORING DETAILS

OPTIONAL 2X BUCK

NON-IMPACT

TITLE:

3737 LAKEPORT BLVD.,
KLAMATH FALLS, OR 97601
PH: (541)882-3451
FAX: (541)850-2609

JELD-WEN

WINDOWS & DOORS

REMARKS

BY

DATE

Add ADA sill, Multi-Point Lock

GL

06/05/14

Reference DWG. #A010832A

AM

09/04/19

THE INSTALLATION DETAILS DESCRIBED HEREIN ARE GENERIC AND MAY NOT REFLECT ACTUAL CONDITIONS FOR A SPECIFIC SITE. IF SITE CONDITIONS CAUSE INSTALLATION TO DEVIATE FROM THE REQUIREMENTS DETAILED HEREIN, A LICENSED ENGINEER OR ARCHITECT SHALL PREPARE SITE SPECIFIC DOCUMENTS FOR USE WITH THIS DOCUMENT.

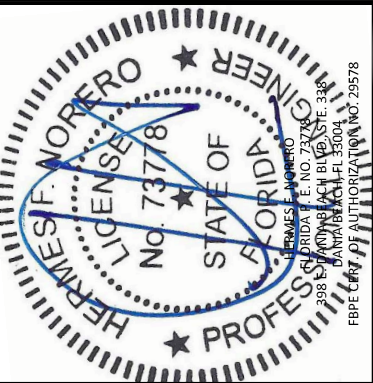

DATE:

02.05.14

DWG. BY:

GL/TJM

CHK. BY:

SS/MSS

SCALE:

NTS

DWG. #:

D015687

SHEET:

OF 9

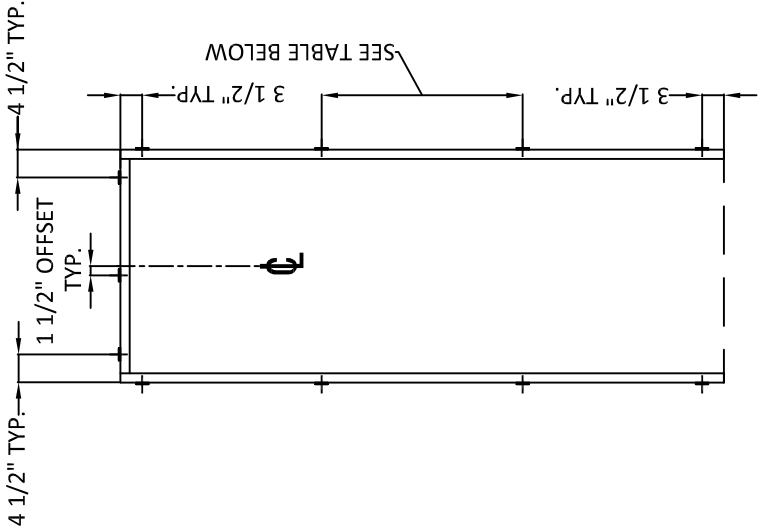

1 TYP. ANCHOR LAYOUT
3 OPTIONAL 2X BUCK IN CONCRETE/MASONRY

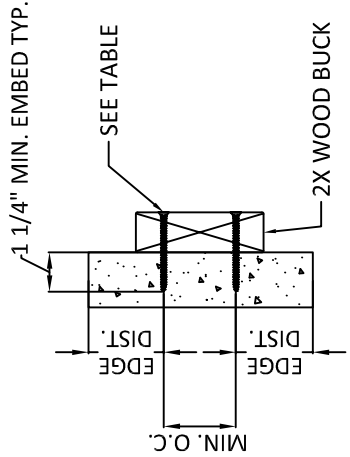

3 2X WOOD BUCK INSTALL.
3 CROSS SECTION

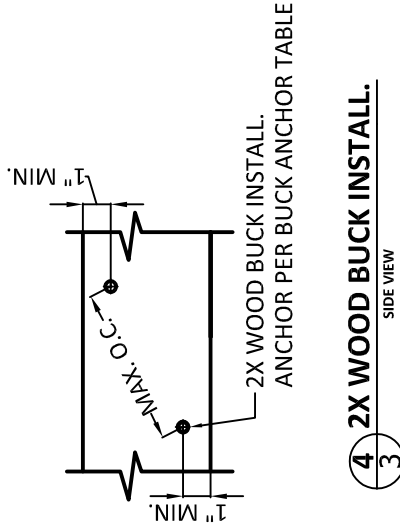

4 2X WOOD BUCK INSTALL.
3 SIDE VIEW

2X BUCK ANCHOR TABLE							
ANCHOR TYPE	ANCHOR SIZE	SUBSTRATE	MIN. EMBEDMENT	MIN. EDGE DIST. TO SUBSTRATE	MIN. CENTER TO CENTER DISTANCE	6'8" DOORS	8'0" DOORS
ITW TAPCON	1/4"	CONCRETE/CMU	1-1/4"	2-1/2"	4"	MAX. O.C. SPACING AT JAMBS	MAX. O.C. SPACING AT JAMBS
ELCO ULTRA CON	1/4"	CONCRETE/CMU	1-3/8" - CONC. 1-1/4" - CMU	1"	4"	25"	30-1/4"

- NOTES:
- 2X BUCK IS NOT FOR INSTALLATION AT SILL.
 - ANCHORS MAY BE STAGGERED AS SHOWN IN DETAIL 4/3.

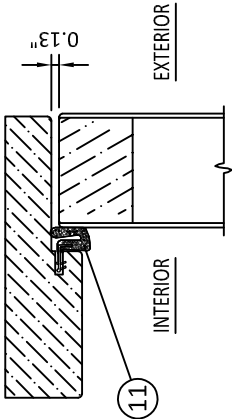

1
4

OPERABLE HEAD

OUTSWING SHOWN - INSWING SIMILAR

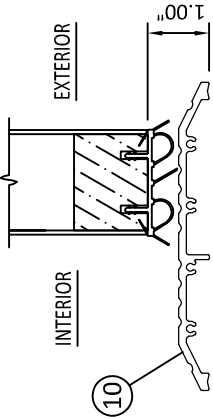

5
4

OPERABLE ADA SILL

INSWING/OUTSWING

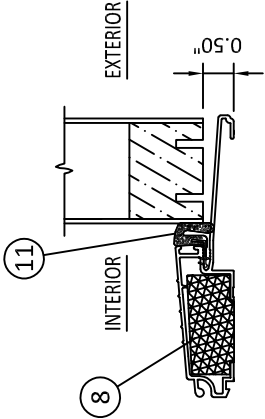

8
4

OPERABLE SILL

OUTSWING

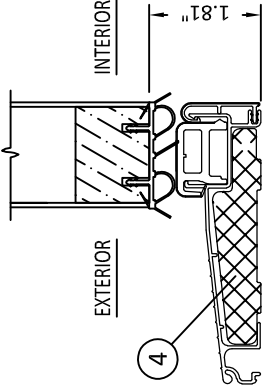

3
4

OPERABLE SILL

INSWING

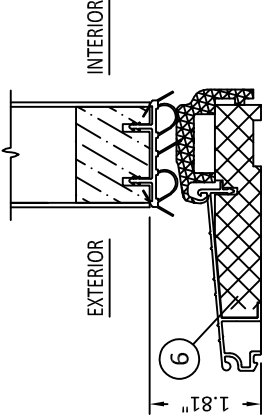

6
4

OPERABLE SILL

INSWING

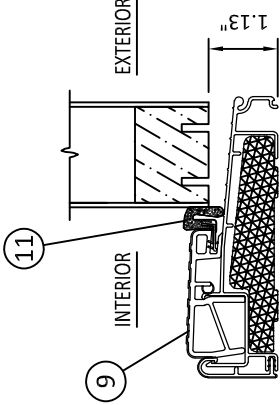

9
4

OPERABLE SILL

OUTSWING

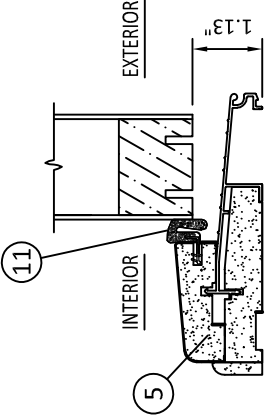

4
4

OPERABLE SILL

OUTSWING

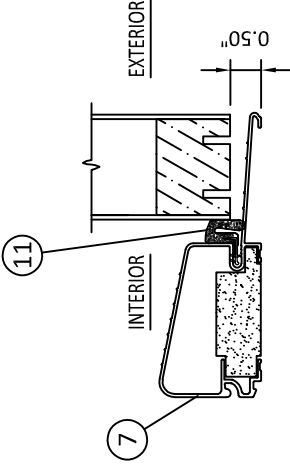

7
4

OPERABLE SILL

OUTSWING

OPTIONAL AFCO H-497

PREPARED BY:



BUILDING DROPS, INC.
398 E. DANIA BEACH BLVD., STE. 338
DANIA BEACH, FL 33004
PH: (954)399-8478
FAX: (954)744-4738
WEB: www.buildingdrops.com

TITLE:
DESIGN PRO/SMOOTH PRO FULL LITE
VERTICAL ASSEMBLIES
NON-IMPACT

3737 LAKEPORT BLVD.,
KLAMATH FALLS, OR 97601
PH: (541)882-3451
FAX: (541)850-2609

JELD-WEN
WINDOWS & DOORS

REMARKS	BY	DATE
Add ADA sill, Multi-Point Lock	GL	06/05/14
Reference DWG. #A010832A	AM	09/04/19

THE INSTALLATION DETAILS DESCRIBED HEREIN ARE GENERIC AND MAY NOT REFLECT ACTUAL CONDITIONS FOR A SPECIFIC SITE. IF SITE CONDITIONS CAUSE INSTALLATION TO DEVIATE FROM THE REQUIREMENTS DETAILED HEREIN, A LICENSED ENGINEER OR ARCHITECT SHALL PREPARE SITE SPECIFIC DOCUMENTS FOR USE WITH THIS DOCUMENT.

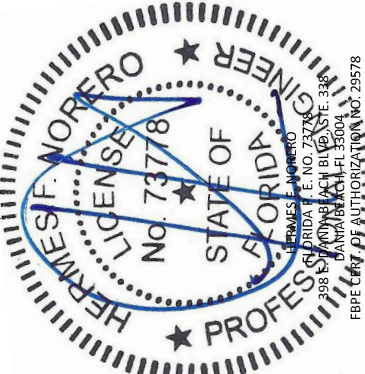

DATE: 02.05.14

DWG. BY: **GL/TJM** CHK. BY: **SS/MSS**

SCALE: **NTS**

DWG. #: **D015687**

SHEET: _____ OF 9

PREPARED BY:



BUILDING DROPS, INC.
398 E. DANIA BEACH BLVD., STE. 338
DANIA BEACH, FL 33004
PH: (954)395-8478
FAX: (954)744-4738
WEB: www.buildingdrops.com

TITLE: *DESIGN PRO/SMOOTH PRO FULL LITE*
HORIZONTAL ASSEMBLIES
NON-IMPACT

3737 LAKEPORT BLVD.,
KLAMATH FALLS, OR 97601
PH: (541)882-3451
FAX: (541)850-2609

JELD-WEN
WINDOWS & DOORS

REMARKS	BY	DATE
Add ADA sill, Multi-Point Lock	GL	06/05/14
Reference DWG. #A010832A	AM	09/04/19

THE INSTALLATION DETAILS DESCRIBED HEREIN ARE GENERIC AND MAY NOT REFLECT ACTUAL CONDITIONS FOR A SPECIFIC SITE. IF SITE CONDITIONS CAUSE INSTALLATION TO DEVIATE FROM THE REQUIREMENTS DETAILED HEREIN, A LICENSED ENGINEER OR ARCHITECT SHALL PREPARE SITE SPECIFIC DOCUMENTS FOR USE WITH THIS DOCUMENT.

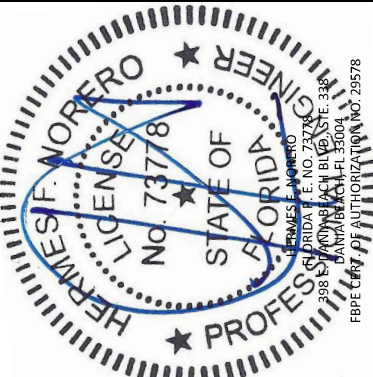

DATE:	02.05.14
DWG. BY:	CHK. BY:
GL/TJM	SS/MSS
SCALE:	NTS
DWG. #:	D015687
SHEET:	OF 9

HINGE DETAIL AT JAMB:
PLACE #9 X 2-1/2" PFH SCREW NEXT TO WEATHERSTRIP

HINGE SCHEDULE	
DOOR HEIGHT	QUANTITY
6'-8"	3
8'-0"	4

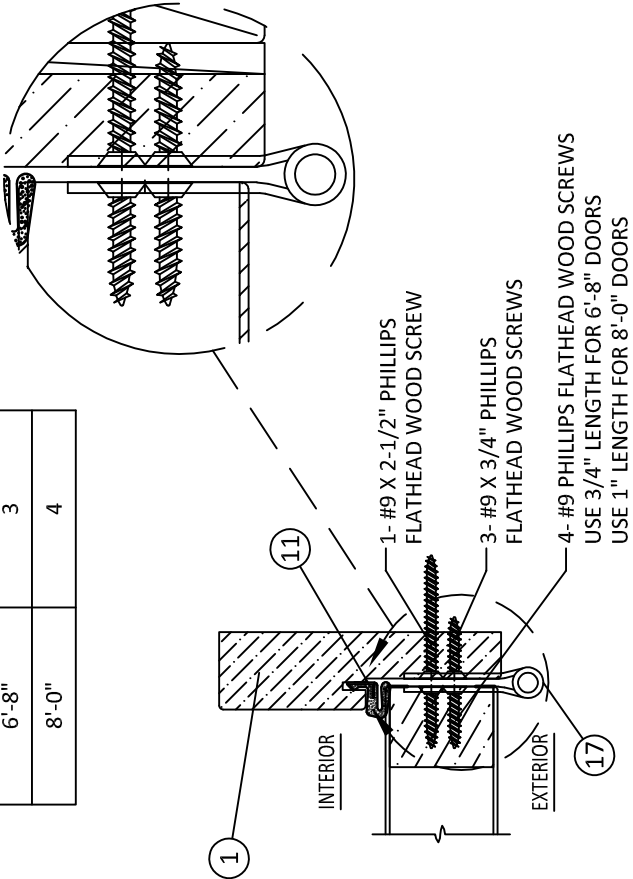

HINGE JAMB

OUTSWING SHOWN - INSWING SIMILAR

LOCK JAMB

OUTSWING SHOWN - INSWING SIMILAR

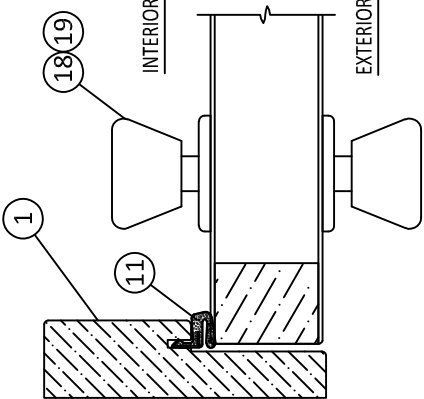

8 - #9 X 2 1/2" PFH
W/ STRIKE HARDWARE
4- MPL STRIKE PLATES

9 - #9 X 1 3/4" PFH
W/ HARDWARE
(6'-8" & 8'-0" UNITS)

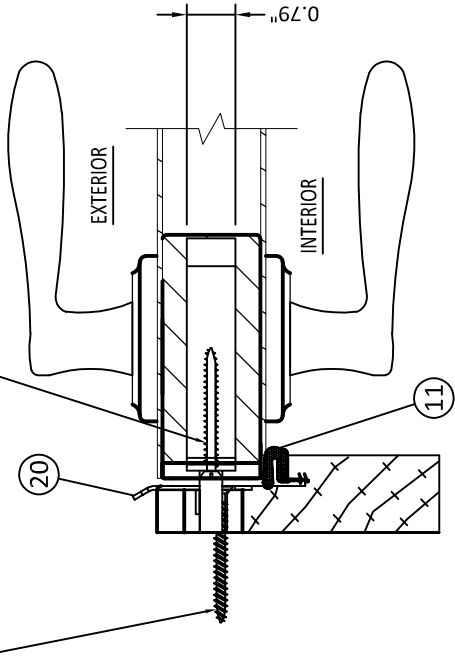

ROCKWELL MULTI-POINT LOCK JAMB

OUTSWING SHOWN - INSWING SIMILAR

3 - #8 X 2" PFH
W/ STRIKE HARDWARE
1- MPL STRIKE PLATE

13 - #8 X 1 3/8" PFH (6'-8" UNITS)
15 - #8 X 1 3/8" PFH (8'-0" UNITS)
COMES W/ HARDWARE

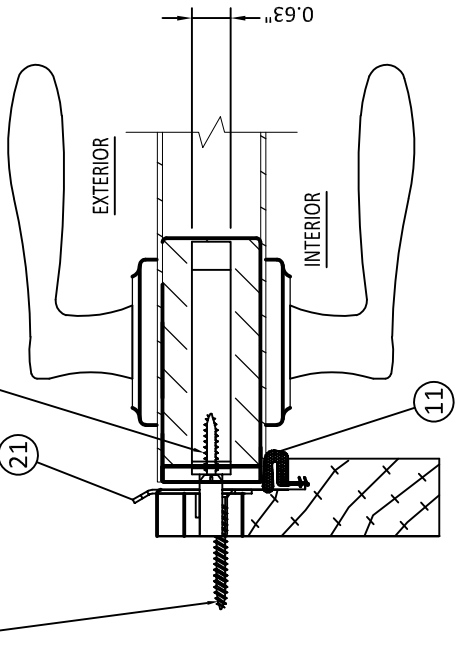

HOPPE MULTI-POINT LOCK JAMB

OUTSWING SHOWN - INSWING SIMILAR

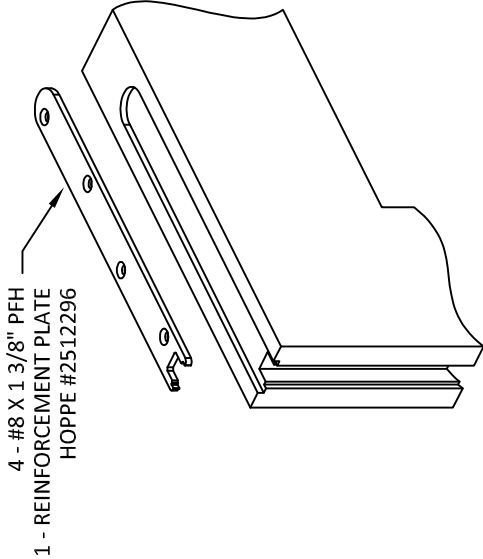

HOPPE MULTI-POINT LOCK

TOP REINFORCEMENT PLATE - ACTIVE PANEL ONLY

REMARKS	BY	DATE
Add ADA sill, Multi-Point Lock	GL	06/05/14
Reference DWG. #A010832A	AM	09/04/19
THE INSTALLATION DETAILS DESCRIBED HEREIN ARE GENERIC AND MAY NOT REFLECT ACTUAL CONDITIONS FOR A SPECIFIC SITE. IF SITE CONDITIONS CAUSE INSTALLATION TO DEVIATE FROM THE REQUIREMENTS DETAILED HEREIN, A LICENSED ENGINEER OR ARCHITECT SHALL PREPARE SITE SPECIFIC DOCUMENTS FOR USE WITH THIS DOCUMENT.		

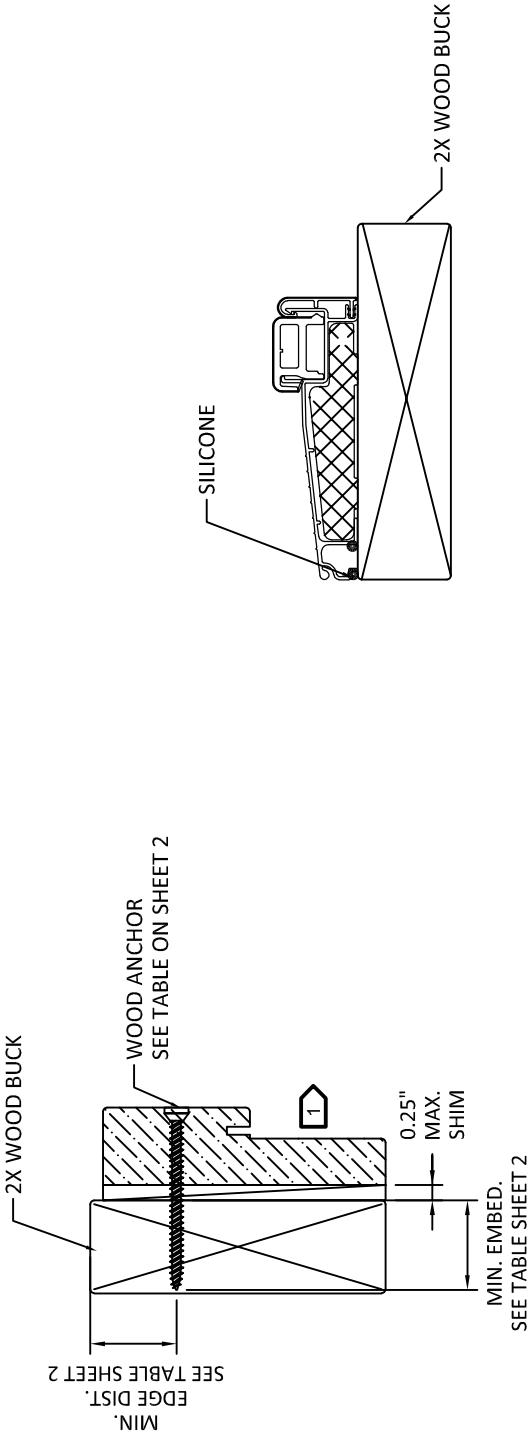
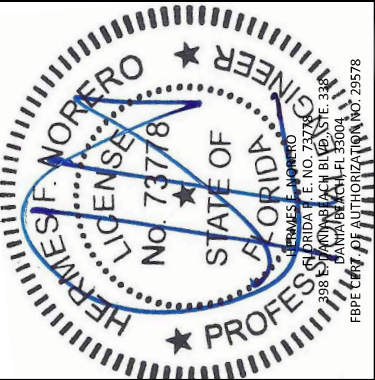

2

JAMB (TYPICAL)

7

OUTSWING SHOWN - INSWING SIMILAR

3

OPERABLE SILL

7

INSWING - NO ANCHOR REQUIRED

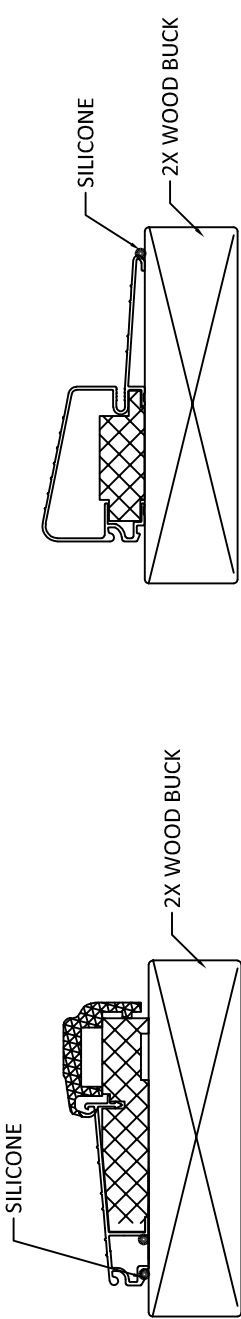

6

OPERABLE SILL

7

INSWING - NO ANCHOR REQUIRED

7

OPERABLE SILL

7

OUTSWING - NO ANCHOR REQUIRED

AFCO H-497

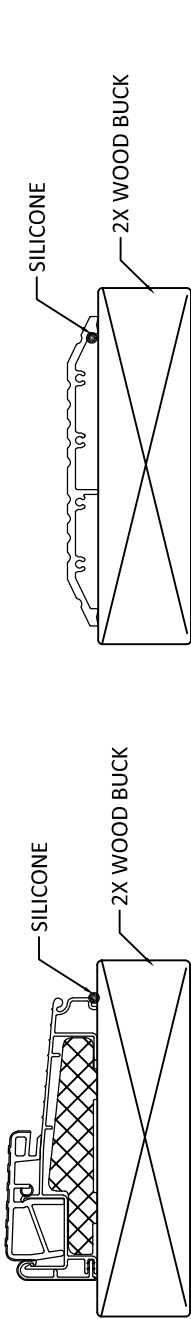

9

OPERABLE SILL

7

OUTSWING - NO ANCHOR REQUIRED

10

OPERABLE ADA SILL

7

INSWING/OUTSWING - NO ANCHOR REQUIRED

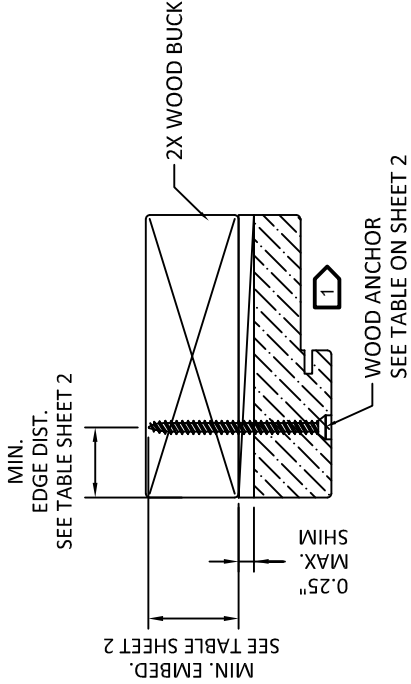

1

HEAD (TYPICAL)

7

OUTSWING SHOWN - INSWING SIMILAR

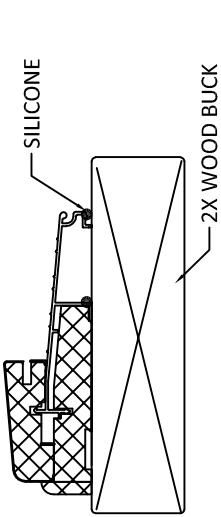

4

OPERABLE SILL

7

OUTSWING - NO ANCHOR REQUIRED

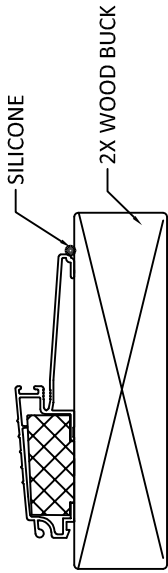

8

OPERABLE SILL

7

OUTSWING - NO ANCHOR REQUIRED

REMARKS	BY	DATE
Add ADA sill, Multi-Point Lock	GL	06/05/14
Reference DWG. #A010832A	AM	09/04/19
THE INSTALLATION DETAILS DESCRIBED HEREIN ARE GENERIC AND MAY NOT REFLECT ACTUAL CONDITIONS FOR A SPECIFIC SITE. IF SITE CONDITIONS CAUSE INSTALLATION TO DEVIATE FROM THE REQUIREMENTS DETAILED HEREIN, A LICENSED ENGINEER OR ARCHITECT SHALL PREPARE SITE SPECIFIC DOCUMENTS FOR USE WITH THIS DOCUMENT.		

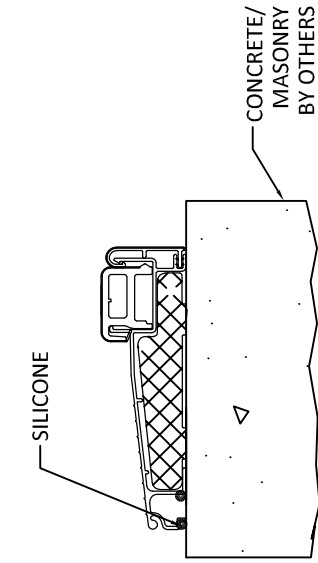
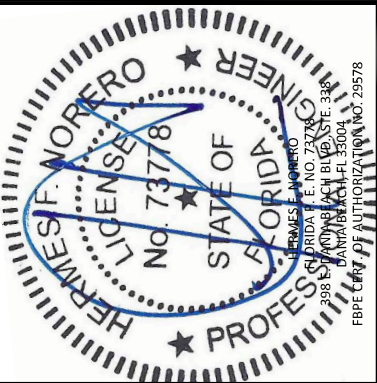

3 OPERABLE SILL

INSWING - NO ANCHOR REQUIRED

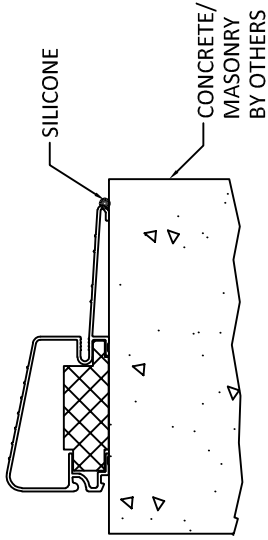

7 OPERABLE SILL

OUTSWING - NO ANCHOR REQUIRED
AFCO H-497

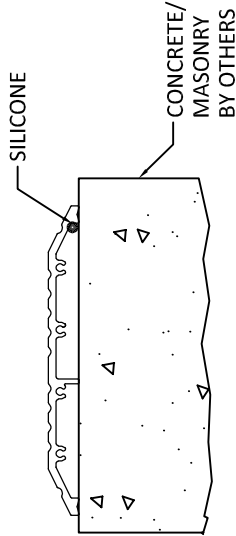

10 OPERABLE SILL

OUTSWING/INSWING - NO ANCHOR REQUIRED

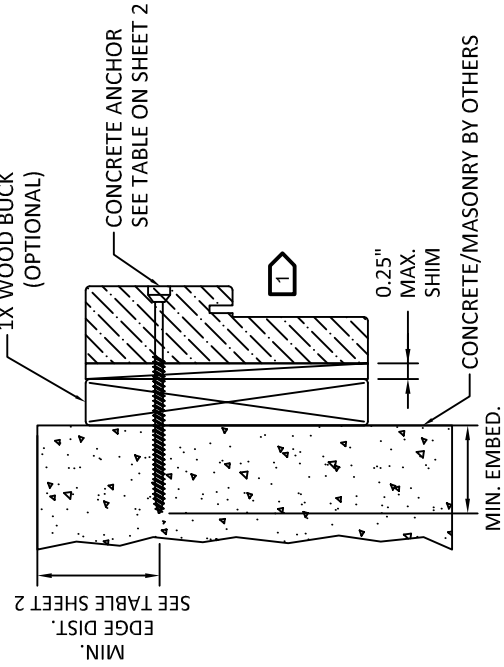

2 JAMB (TYPICAL)

OUTSWING SHOWN - INSWING SIMILAR

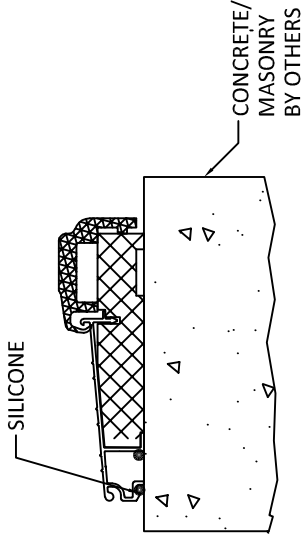

6 OPERABLE SILL

INSWING - NO ANCHOR REQUIRED

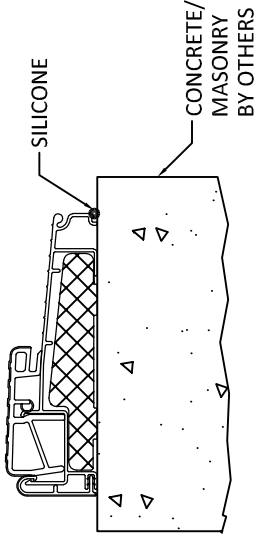

9 OPERABLE SILL

OUTSWING - NO ANCHOR REQUIRED

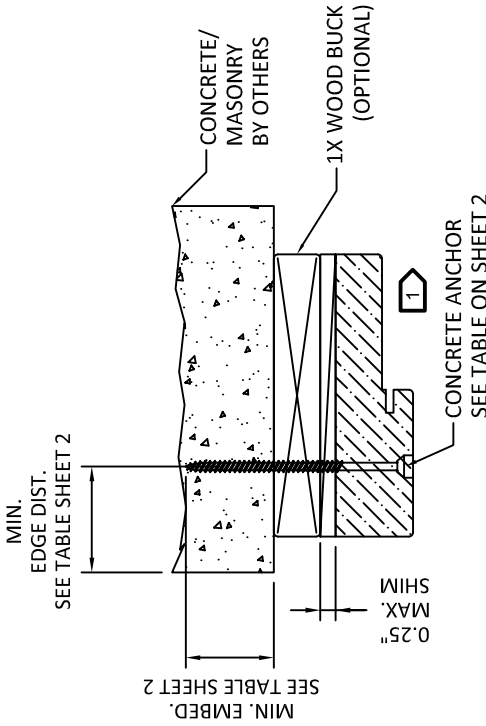

1 HEAD (TYPICAL)

OUTSWING SHOWN - INSWING SIMILAR

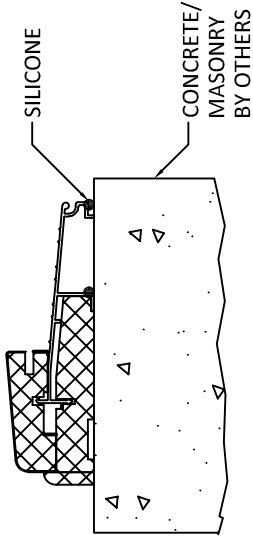

4 OPERABLE SILL

OUTSWING - NO ANCHOR REQUIRED

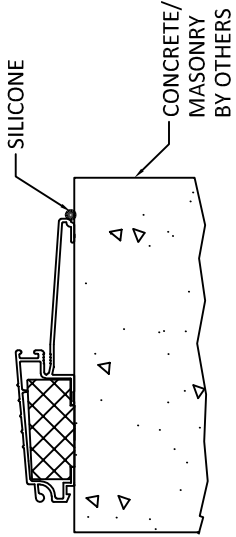

8 OPERABLE SILL

OUTSWING - NO ANCHOR REQUIRED

1 OPTIONALLY, ANCHOR CAN BE PLACED IN NARROW SECTION OF HEAD OR JAMB AS LONG AS MINIMUM EMBEDMENT AND EDGE DISTANCE ARE ACHIEVED.



Product Approval
USER: Public User

[Product Approval Menu](#) > [Product or Application Search](#) > **Application List**

OFFICE OF THE
SECRETARY

Search Criteria

[Refine Search](#)

Code Version	2020	FL#	13541.4
Application Type	ALL	Product Manufacturer	ALL
Category	ALL	Subcategory	ALL
Application Status	ALL	Compliance Method	ALL
Quality Assurance Entity	ALL	Quality Assurance Entity Contract Expired	ALL
Product Model, Number or Name	ALL	Product Description	ALL
Approved for use in HVHZ	ALL	Approved for use outside HVHZ	ALL
Impact Resistant	ALL	Design Pressure	ALL
Other	ALL		

Search Results - Applications

FL#	Type	Manufacturer	Validated By	Status
FL13541-R18 History	Revision	JELD-WEN FL#: FL13541.4 Model: D. Design Pro / Smooth Pro Fiberglass Description: Double (XX) Glazed Fiberglass Door, 6'-0" x 6'-8" and 6'-0" x 8'-0", Inswing and Outswing Category: Exterior Doors Subcategory: Swinging Exterior Door Assemblies	National Accreditation & Management Institute (804) 684-5124	Approved *

*Approved by DBPR. Approvals by DBPR shall be reviewed and ratified by the POC and/or the Commission if necessary.

[Contact Us](#) :: 2601 Blair Stone Road, Tallahassee FL 32399 Phone: 850-487-1824

The State of Florida is an AA/EEO employer. [Copyright 2007-2013 State of Florida](#). :: [Privacy Statement](#) :: [Accessibility Statement](#) :: [Refund Statement](#)

Under Florida law, email addresses are public records. If you do not want your e-mail address released in response to a public-records request, do not send electronic mail to this entity. Instead, contact the office by phone or by traditional mail. If you have any questions, please contact 850.487.1395. *Pursuant to Section 455.275(1), Florida Statutes, effective October 1, 2012, licensees licensed under Chapter 455, F.S. must provide the Department with an email address if they have one. The emails provided may be used for official communication with the licensee. However email addresses are public record. If you do not wish to supply a personal address, please provide the Department with an email address which can be made available to the public. To determine if you are a licensee under Chapter 455, F.S., please click [here](#).

Product Approval Accepts:





Product Approval
USER: Public User

[Product Approval Menu](#) > [Product or Application Search](#) > [Application List](#) > **Application Detail**

► OFFICE OF THE
SECRETARY

FL #	FL13541-R18						
Application Type	Revision						
Code Version	2020						
Application Status	Approved						
	*Approved by DBPR. Approvals by DBPR shall be reviewed and ratified by the POC and/or the Commission if necessary.						
Comments							
Archived	<input type="checkbox"/>						
Product Manufacturer	JELD-WEN						
Address/Phone/Email	3737 Lakeport Blvd Klamath Falls, OR 97601 (800) 535-3936 fbc1@jeld-wen.com						
Authorized Signature	Rylee Sumner Fricks fbc1@jeld-wen.com						
Technical Representative	JELD-WEN Corporate Customer Service						
Address/Phone/Email	3737 Lakeport Blvd. Klamath Falls, OR 97601 (800) 535-3936 customerserviceagents@jeld-wen.com						
Quality Assurance Representative							
Address/Phone/Email							
Category	Exterior Doors						
Subcategory	Swinging Exterior Door Assemblies						
Compliance Method	Certification Mark or Listing						
Certification Agency	National Accreditation & Management Institute						
Validated By	National Accreditation & Management Institute						
Referenced Standard and Year (of Standard)	<table> <thead> <tr> <th><u>Standard</u></th><th><u>Year</u></th></tr> </thead> <tbody> <tr> <td>ASTM E330</td><td>2014</td></tr> <tr> <td>TAS 202</td><td>1994</td></tr> </tbody> </table>	<u>Standard</u>	<u>Year</u>	ASTM E330	2014	TAS 202	1994
<u>Standard</u>	<u>Year</u>						
ASTM E330	2014						
TAS 202	1994						
Equivalence of Product Standards Certified By	Florida Licensed Professional Engineer or Architect FL13541_R18_Equiv_ASTM_E330_Letter_of_Equivalence_07_06_2020.pdf						
Product Approval Method	Method 1 Option A						
Date Submitted	08/03/2020						

DESIGN PRO / SMOOTH PRO FULL LITE
NON-IMPACT

FOR USE OUTSIDE THE HIGH VELOCITY HURRICANE ZONE (HVHZ)

GENERAL NOTES:

- THE PRODUCT SHOWN HEREIN IS DESIGNED AND MANUFACTURED TO COMPLY WITH THE CURRENT INTERNATIONAL BUILDING CODE (IBC), INTERNATIONAL RESIDENTIAL CODE (IRC), AND FLORIDA BUILDING CODE (FBC), **EXCLUDING** HVHZ AND HAS BEEN EVALUATED ACCORDING TO THE FOLLOWING:
 - ASTM E330-02
 - ASTM E283-04
 - AAMA 1304-02
- ADEQUACY OF THE EXISTING STRUCTURAL CONCRETE/MASONRY OR 2X FRAMING AS A MAIN WIND FORCE RESISTING SYSTEM CAPABLE OF WITHSTANDING AND TRANSFERRING APPLIED PRODUCT LOADS TO THE FOUNDATION IS THE RESPONSIBILITY OF THE ENGINEER OR ARCHITECT OF RECORD FOR THE PROJECT OF INSTALLATION.
- THE INSTALLATION DETAILS DESCRIBED HEREIN ARE GENERIC AND MAY NOT REFLECT ACTUAL CONDITIONS FOR A SPECIFIC SITE. IF SITE CONDITIONS CAUSE INSTALLATION TO DEVIATE FROM THE REQUIREMENTS DETAILED HEREIN, A LICENSED ENGINEER OR ARCHITECT SHALL PREPARE SITE SPECIFIC DOCUMENTS FOR USE WITH THIS DOCUMENT.
- APPROVED IMPACT PROTECTIVE SYSTEM **IS REQUIRED** ON THIS PRODUCT IN AREAS REQUIRING IMPACT RESISTANCE.
- GLASS MEETS THE REQUIREMENTS OF ASTM E 1300 GLASS CHARTS. SEE SHEET 6 FOR GLAZING DETAILS.
- FULL LITE APPROVAL COVERS USE OF FRACTIONAL GLAZING, INCLUDING INTERNAL GRID, BLINDS BETWEEN GLASS, DECORATIVE, AND EXTERNAL AND INTERNAL WROUGHT IRON. RADIUS (SHAPED) LITES ARE QUALIFIED FOR 6'-8" DOORS AT DP +/-50 PSF ONLY.
- NOTE: AFCO H-497 SILL MEETS WATER INFILTRATION AT WATER TEST PRESSURE (WTP) OF 9.0 PSF. REMAINING SILLS NOT RATED FOR WATER INFILTRATION. IF AUTHORITY HAVING JURISDICTION REQUIRES THAT PRODUCT MEETS THIS REQUIREMENT, PRODUCT SHALL BE USED WHEN INSTALLED AT LOCATION PROTECTED BY OVERHANG SUCH THAT OVERHANG (OH) RATIO = OH LENGTH ÷ OH HEIGHT IS ≥ 1.0

TABLE OF CONTENTS		
SHEET	REVISION	SHEET DESCRIPTION
1	A	TYPICAL ELEVATIONS, DESIGN PRESSURES, AND GENERAL NOTES
2	A	TYPICAL ANCHOR LAYOUTS AND NOTES
3	-	OPTIONAL 2X BUCK ANCHORING DETAILS
4	-	VERTICAL ASSEMBLIES
5	A	HORIZONTAL ASSEMBLIES
6	A	GLAZING DETAILS
7	-	WOOD SUBSTRATES
8	-	CONCRETE SUBSTRATES
9	A	COMPONENTS & BILL OF MATERIALS

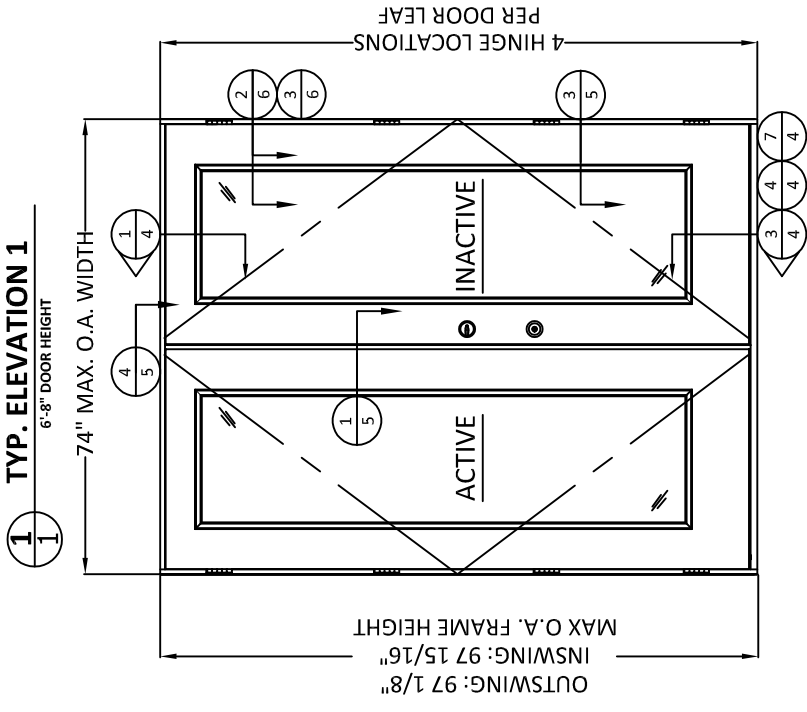
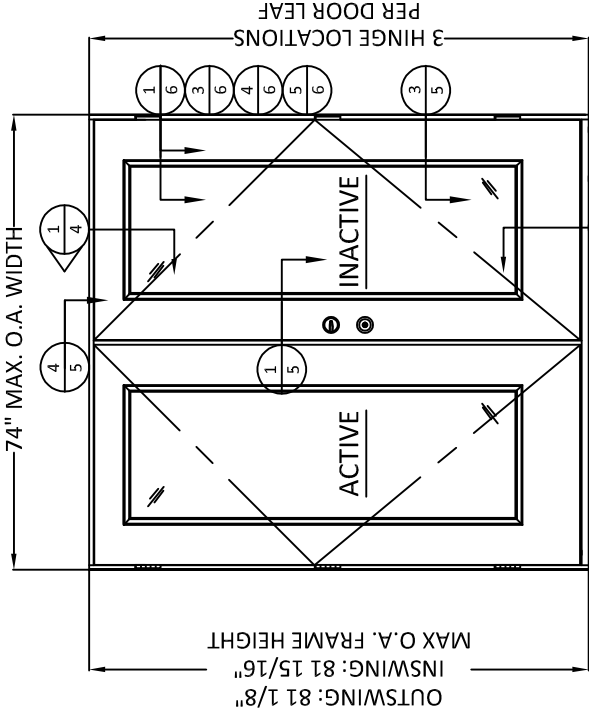

NOTE:
INACTIVE AND ACTIVE DOOR PANEL
ORIENTATION IS INTERCHANGEABLE.

CONFIGURATION	MAX. OVERALL NOMINAL SIZE		DESIGN PRESSURE (PSF)			MISSILE IMPACT RATING
	WIDTH	HEIGHT	INSWING	OUTSWING		
XX	6'-0"	6'-8"	POS. 50*	NEG. 50	POS. 50*	NON-IMPACT
XX RADIUS	6'-0"	6'-8"	50*	50*	50*	NON-IMPACT
XX	6'-0"	8'-0"	50*	50*	50*	NON-IMPACT

*SEE GENERAL NOTE 7, SHEET 1, FOR WATER INFILTRATION APPROVED SILLS.

PREPARED BY:



BUILDING DROPS, INC.
398 E. DANIA BEACH BLVD., STE. 338
DANIA BEACH, FL 33004
PH: (954)399-8478
FAX: (954)744-4738
WEB: www.buildingdrops.com

TITLE: DESIGN PRO/SMOOTH PRO FULL LITE
TYPICAL ELEVATIONS, DESIGN
PRESSURES, AND GENERAL NOTES
NON-IMPACT

3737 LAKEPORT BLVD.,
KLAMATH FALLS, OR 97601
PH: (541)882-3451
FAX: (541)850-2609

JELD-WEN
WINDOWS & DOORS

REMARKS	BY	DATE
Add Multi-Point Lock	GL	06/12/14
Reference DWG. #A010834A	AM	09/04/19

THE INSTALLATION DETAILS DESCRIBED HEREIN ARE GENERIC AND MAY NOT REFLECT ACTUAL CONDITIONS FOR A SPECIFIC SITE. THE ENGINEER HAS EXERCISED DUE CARE AND CAUTION TO DEVISE THESE DETAILS TO MEET THE REQUIREMENTS OF THE IBC, IRC, AND FLORIDA BUILDING CODE. THE ENGINEER OR ARCHITECT SHALL PREPARE SITE SPECIFIC DOCUMENTS FOR USE WITH THIS DOCUMENT.



HERMES F. NORERO
FLORIDA E. NO. 73778
398 E. DANIA BEACH BLVD., STE. 338
DANIA BEACH, FL 33004
FBPE CERT. OF AUTHORIZATION NO. 29578

Digitally signed by Hermes F Norero
Reason: I am approving this document
Date: 2019.12.12 13:19:12 -05'00'

DATE:	02.05.14		
DWG. BY:	GL/TJM	CHK. BY:	SS/MSS
SCALE:	NTS		
DWG. #:	D015689		
SHEET:	OF9		

INSTALLATION NOTES:

- ONE (1) INSTALLATION ANCHOR IS REQUIRED AT EACH ANCHOR LOCATION SHOWN.
- SHIM AS REQUIRED AT EACH INSTALLATION ANCHOR WITH LOAD BEARING SHIM(S). MAXIMUM ALLOWABLE SHIM STACK TO BE 1/4 INCH. SHIM WHERE SPACE OF 1/16 INCH OR GREATER OCCURS. SHIM(S) SHALL BE A NON-COMPRESSIBLE COMPOSITE OR BETTER.
- MINIMUM EMBEDMENT AND EDGE DISTANCE EXCLUDE WALL FINISHES, INCLUDING BUT NOT LIMITED TO STUCCO, FOAM, BRICK VENEER, AND SIDING.
- INSTALLATION ANCHORS AND ASSOCIATED HARDWARE MUST BE MADE OF CORROSION RESISTANT MATERIAL OR HAVE A CORROSION RESISTANT COATING, AND SHALL BE INSTALLED IN ACCORDANCE WITH ANCHOR MANUFACTURER'S INSTALLATION INSTRUCTIONS.
- FOR HOLLOW BLOCK AND GROUT FILLED BLOCK, DO NOT INSTALL INSTALLATION ANCHORS INTO MORTAR JOINTS. EDGE DISTANCE IS MEASURED FROM FREE EDGE OF BLOCK OR EDGE OF MORTAR JOINT INTO FACE SHELL OF BLOCK.
- FOR 2X STUD CONSTRUCTION, ANCHORING OF THESE PRODUCTS SHALL BE THE SAME AS FOR 2X BUCK CONCRETE/MASONRY CONSTRUCTION.
- INSTALLATION ANCHOR CAPACITIES FOR PRODUCTS HEREIN ARE BASED ON SUBSTRATE MATERIALS WITH THE FOLLOWING PROPERTIES:
 - WOOD - MINIMUM SPECIFIC GRAVITY OF 0.55.
 - CONCRETE - MINIMUM COMPRESSIVE STRENGTH OF 3000 PSI.
 - GROUT-FILLED CMU- UNIT STRENGTH CONFORMS TO ASTM C-90 WITH MINIMUM COMPRESSIVE STRENGTH OF 2000 PSI AND GROUT CONFORMS TO ASTM C 476, MINIMUM GROUT COMPRESSIVE STRENGTH OF 2000 PSI.
 - HOLLOW BLOCK CMU - UNIT STRENGTH CONFORMS TO ASTM C-90 WITH MINIMUM COMPRESSIVE STRENGTH OF 2000 PSI.
- SEE SHEETS 7 AND 8 FOR MORE DETAILS OF THE INSTALLATION REQUIREMENTS, INCLUDING ANCHOR LOCATIONS, EDGE DISTANCES, EMBEDMENTS, AND SHIM SPACING.
- OPTIONALLY, ANCHORS CAN BE PLACED IN NARROW SECTION OF HEAD OR JAMB AS LONG AS MINIMUM EMBEDMENT AND EDGE DISTANCE ARE ACHIEVED.

ANCHOR TABLE								
ANCHOR TYPE	ANCHOR SIZE	SUBSTRATE	MIN. EMBEDMENT	MIN. EDGE DISTANCE	6'8" DOORS		8'0" DOORS	
					MAX. O.C. SPACING AT JAMBS	# OF ANCHORS AT HEAD/SILL CLUSTERS	MAX. O.C. SPACING AT JAMBS	# OF ANCHORS AT HEAD/SILL CLUSTERS
WOOD SCREW	#10	2X WOOD BUCK OR FRAMING	1-1/2"	3/4"	17-1/2"	4	17-1/4"	4
ITW TAPCON	3/16"	CONCRETE/CMU	1-1/4"	2-1/2"	17-1/2"	4	17-1/4"	4
ELCO ULTRACON	1/4"	CONCRETE/CMU	1-3/8" - CONC. 1-1/4" - CMU	1"	17-1/2"	4	17-1/4"	4
ITW TAPCON	3/16"	CONCRETE/CMU	1-1/4"	1"	11-5/8"	8	14-3/8"	6

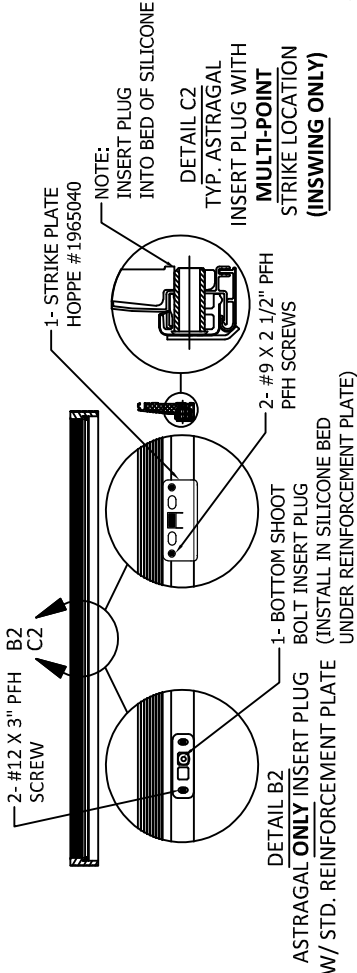

A INSWING SILL SECTION VIEW
SEE DETAIL B2 OR C2 ABOVE

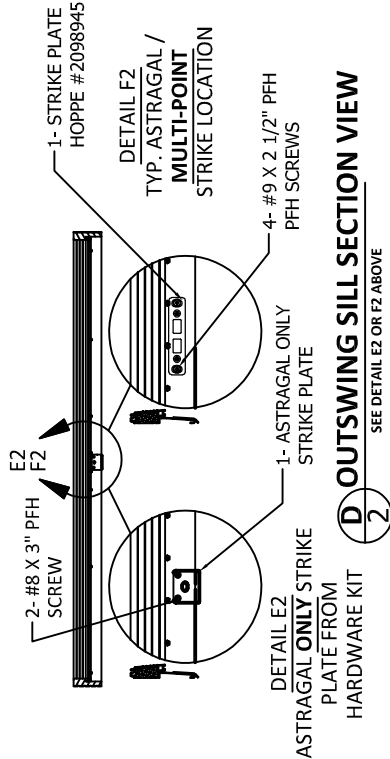

D OUTSWING SILL SECTION VIEW
SEE DETAIL E2 OR F2 ABOVE

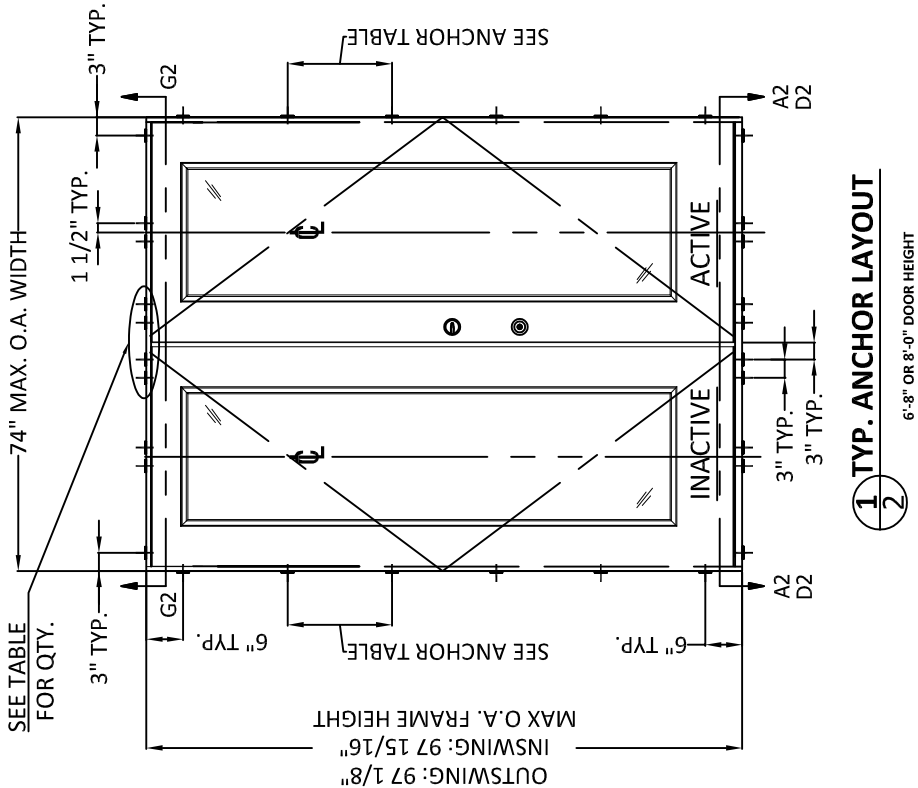

1 TYP. ANCHOR LAYOUT
2 6'-8" OR 8'-0" DOOR HEIGHT

NOTE:
INACTIVE AND ACTIVE DOOR PANEL
ORIENTATION IS INTERCHANGEABLE.

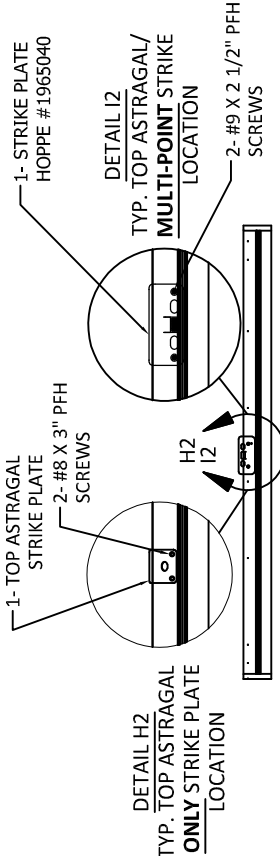

G HEAD SECTION VIEW
INSWING SHOWN OUTSWING SIMILAR

PREPARED BY:



BUILDING DROPS, INC.
398 E. DANIA BEACH BLVD., STE. 338
DANIA BEACH, FL 33004
PH: (954)395-8478
FAX: (954)744-4738
WEB: www.buildingdrops.com

TITLE: *DESIGN PRO/SMOOTH PRO FULL LITE*
NON-IMPACT
ANCHOR LAYOUTS AND NOTES

3737 LAKEPORT BLVD.,
KLAMATH FALLS, OR 97601
PH: (541)882-3451
FAX: (541)850-2609

JELD-WEN
WINDOWS & DOORS

REMARKS	BY	DATE
Add Multi-Point Lock	GL	06/12/14
Reference DWG. #A010834A	AM	09/04/19

THE INSTALLATION DETAILS DESCRIBED HEREIN ARE GENERIC AND MAY NOT REFLECT ACTUAL CONDITIONS FOR A SPECIFIC PROJECT. THE CONTRACTOR SHALL USE JELD-WEN INFORMATION TO PREPARE THE REQUIREMENTS FOR THE PROJECT. THE CONTRACTOR SHALL PREPARE SITE SPECIFIC DOCUMENTS TO BE SUBMITTED WITH THIS DOCUMENT.

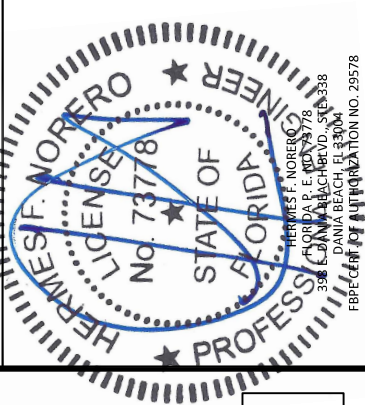

DATE: **02.05.14**

DWG. BY: **GL/TJM** CHK. BY: **SS/MSS**

SCALE: **NTS**

DWG. #: **D015689**

SHEET: **OF 9**

PREPARED BY:



BUILDING DROPS, INC.
398 E. DANIA BEACH BLVD., STE. 338
DANIA BEACH, FL 33004
PH: (954)399-8478
FAX: (954)744-4738
WEB: www.buildingdrops.com

TITLE: *DESIGN PRO/SMOOTH PRO FULL LITE*
OPTIONAL 2X BUCK
NON-IMPACT
ANCHORING DETAILS

3737 LAKEPORT BLVD.,
KLAMATH FALLS, OR 97601
PH: (541)882-3451
FAX: (541)850-2609



REMARKS	BY	DATE
Add Multi-Point Lock	GL	06/12/14
Reference DWG. #A010834A	AM	09/04/19

THE INSTALLATION DETAILS DESCRIBED HEREIN ARE GENERIC AND NOT MEANT TO BE USED AS A SUBSTITUTE FOR THE SPECIFIC SITE. IF SITE CONDITIONS CAUSE INSTALLATION TO DEVIATE FROM THE REQUIREMENTS DETAILED HEREIN, A LICENSED ENGINEER OR ARCHITECT SHALL PREPARE SITE SPECIFIC DOCUMENTS FOR USE WITH THIS DOCUMENT.

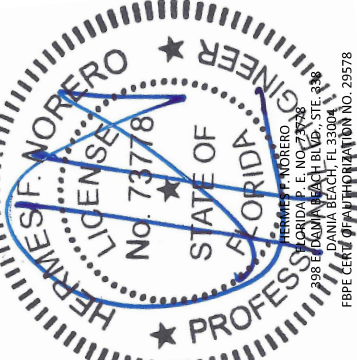

DATE: 02.05.14

DWG. BY: **GL/TJM** CHK. BY: **SS/MSS**

SCALE: **NTS**

DWG. #: **D015689**

SHEET: **OF9**

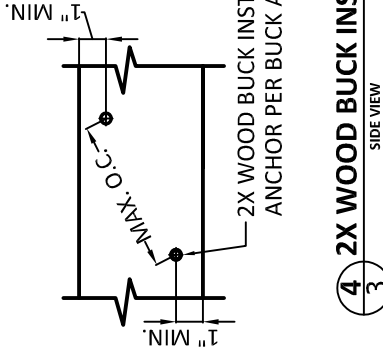
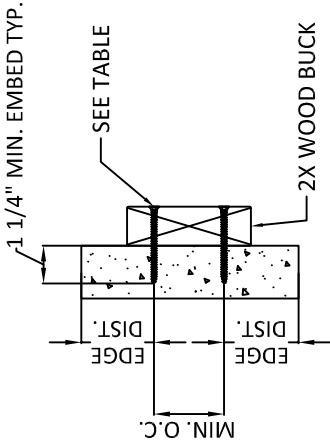
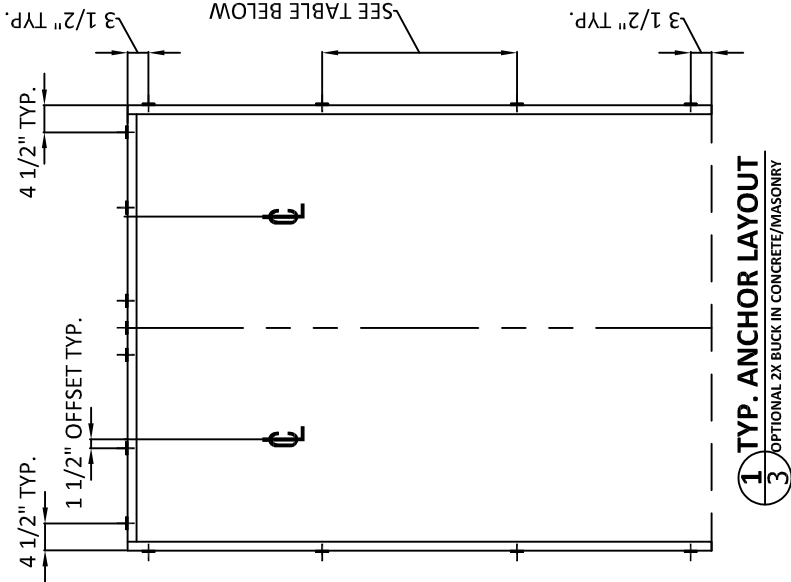

3 2X WOOD BUCK INSTALL. CROSS SECTION

4 2X WOOD BUCK INSTALL. SIDE VIEW

2X BUCK ANCHOR TABLE							
ANCHOR TYPE	ANCHOR SIZE	SUBSTRATE	MIN. EMBEDMENT	MIN. EDGE DIST. TO SUBSTRATE	MIN. CENTER TO CENTER DISTANCE	6'8" DOORS	8'0" DOORS
ITW TAPCON	1/4"	CONCRETE/CMU	1-1/4"	2-1/2"	4"	MAX. O.C. SPACING AT JAMBS	MAX. O.C. SPACING AT JAMBS
ELCO ULTRA CON	1/4"	CONCRETE/CMU	1-3/8" - CONC. 1-1/4" - CMU	1"	4"	25"	30-1/4"

NOTES:

- 2X BUCK IS NOT FOR INSTALLATION AT SILL. THRESHOLD SHALL BE FASTENED IN ACCORDANCE WITH ANCHOR LOCATIONS SHOWN ON SHEET 2.
- ANCHORS MAY BE STAGGERED AS SHOWN IN DETAIL 4/3.

HINGE SCHEDULE	
DOOR HEIGHT	QUANTITY
6'-8"	3
8'-0"	4

HINGE DETAIL AT JAMB:
PLACE #9 X 2-1/2" PFH SCREW NEXT TO WEATHERSTRIP

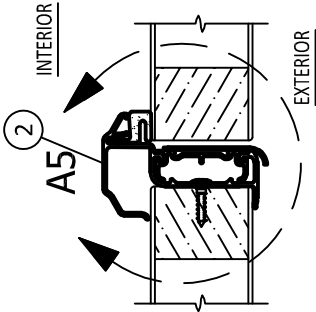
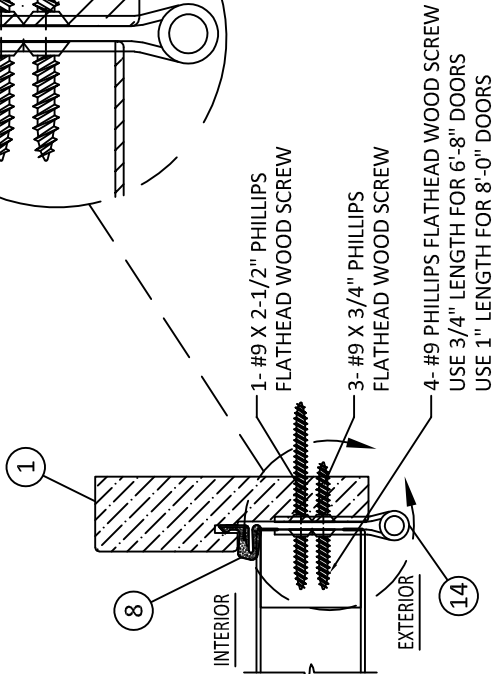
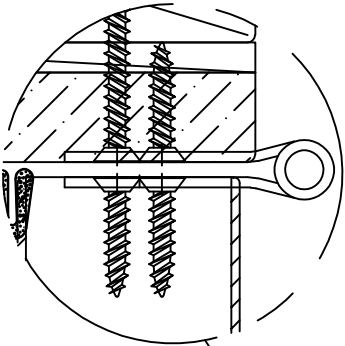

1
5 MEETING STILE
OUTSWING SHOWN - INSWING SIMILAR

3
5 HINGE JAMB
OUTSWING SHOWN - INSWING SIMILAR

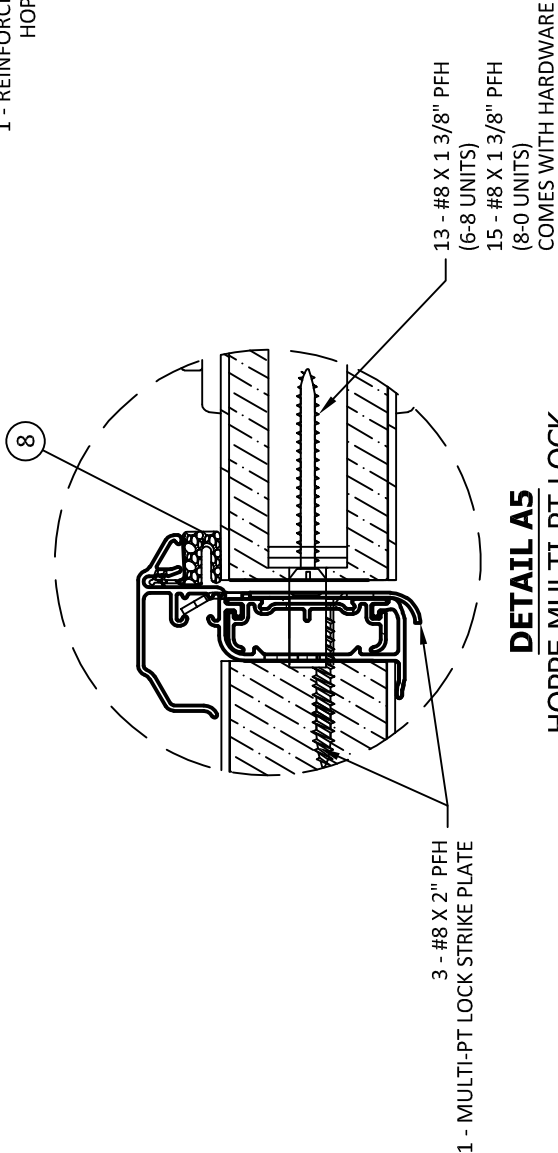
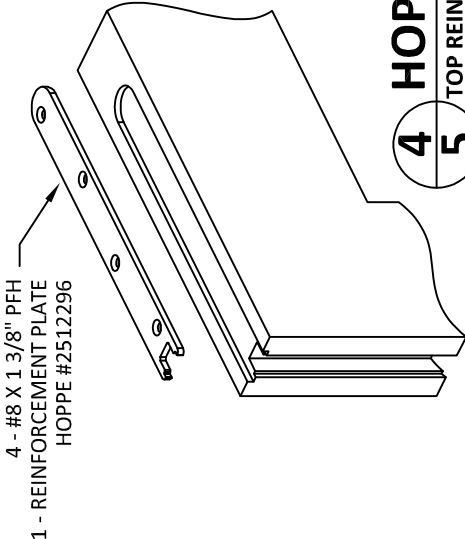

4
5 HOPPE MULTI-POINT LOCK
TOP REINFORCEMENT PLATE - ACTIVE PANEL ONLY

PREPARED BY:



BUILDING DROPS, INC.
398 E. DANIA BEACH BLVD., STE. 338
DANIA BEACH, FL 33004
PH: (954)399-8478
FAX: (954)744-4738
WEB: www.buildingdrops.com

TITLE: *DESIGN PRO/SMOOTH PRO FULL LITE*
HORIZONTAL ASSEMBLIES
NON-IMPACT

3737 LAKEPORT BLVD.,
KLAMATH FALLS, OR 97601
PH: (541)882-3451
FAX: (541)850-2609

JELD-WEN
WINDOWS & DOORS

REMARKS	BY	DATE
Add Multi-Point Lock	GL	06/12/14
Reference DWG. #A010834A	AM	09/04/19
THE INSTALLATION DETAILS DESCRIBED HEREIN ARE GENERIC AND MAY NOT REFLECT ACTUAL CONDITIONS FOR A SPECIFIC SITE. IF SITE CONDITIONS CAUSE INSTALLATION TO DEVIATE FROM THE DETAILS DESCRIBED HEREIN, THE ARCHITECT, ENGINEER OR ARCHITECT SHALL PREPARE SITE SPECIFIC DOCUMENTS TO REVISE THIS DOCUMENT.		

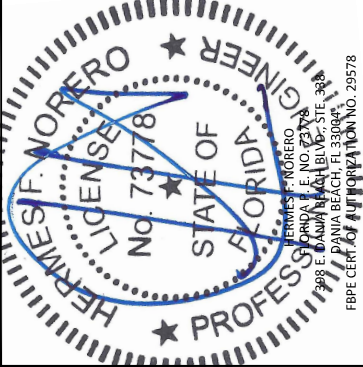

DATE: 02.05.14	
DWG. BY: GL/TJM	CHK. BY: SS/MSS
SCALE: NTS	
DWG. #: D015689	
SHEET:	OF 9

PREPARED BY:



BUILDING DROPS, INC.
398 E. DANIA BEACH BLVD., STE. 338
DANIA BEACH, FL 33004
PH: (954)399-8478
FAX: (954)744-4738
WEB: www.buildingdrops.com

DESIGN PRO/SMOOTH PRO FULL LITE
NON-IMPACT
GLAZING DETAILS

3737 LAKEPORT BLVD.,
KLAMATH FALLS, OR 97601
PH: (541)882-3451
FAX: (541)850-2609

JELD-WEN
WINDOWS & DOORS

REMARKS	BY	DATE
Add Multi-Point Lock	GL	06/12/14
Reference DWG. #A010834A	AM	09/04/19

THE INSTALLATION DETAILS DESCRIBED HEREIN ARE GENERIC AND MAY NOT REFLECT ACTUAL CONDITIONS FOR A SPECIFIC SITE. THE REQUIREMENTS SET FORTH IN THIS DOCUMENT ARE BASED ON THE REQUIREMENTS DETAILED HEREIN. A LICENSED ENGINEER OR ARCHITECT SHALL PREPARE SITE SPECIFIC DOCUMENTS **CONSISTENT** WITH THIS DOCUMENT.

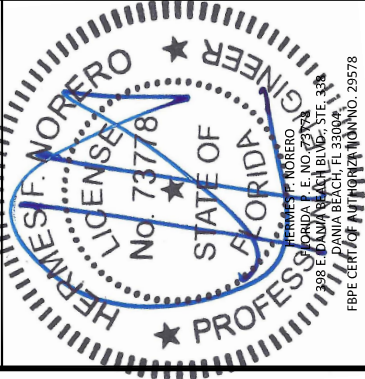

DATE: 02.05.14

DWG. BY: **GL/TJM** CHK. BY: **SS/MSS**

SCALE: NTS

DWG. #: D015689

SHEET: OF 9

6

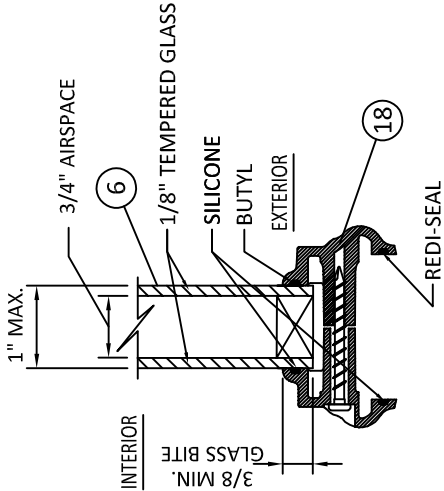

1 6'-8" GLAZING DETAIL
20 1/2" MAX. D.L.O. WIDTH
62 1/2" MAX. D.L.O. HEIGHT

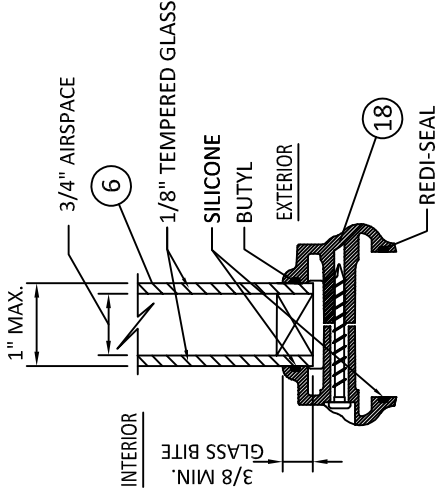

2 8'-0" GLAZING DETAIL
20 1/2" MAX. D.L.O. WIDTH
78 1/2" MAX. D.L.O. HEIGHT

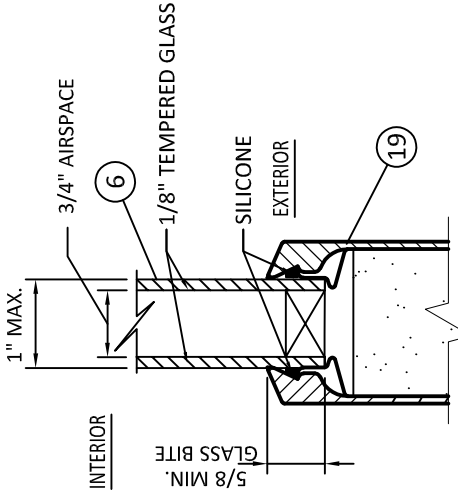

3 FLUSH GLAZE DETAIL
23 7/8" MAX. D.L.O. WIDTH
78 7/8" MAX. D.L.O. HEIGHT

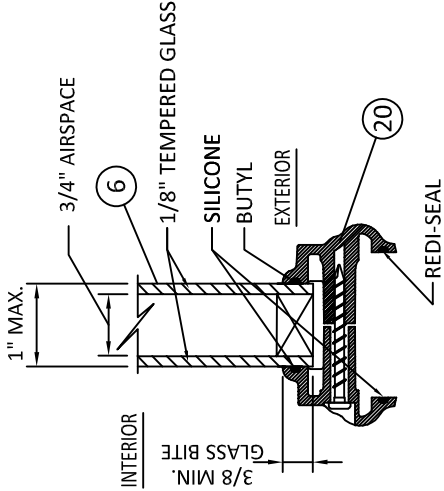

4 GLAZING DETAIL
FOR OVAL, SUNBURST, AND ROUND TOPS
ONLY IN 6'8" UNITS AT DP+/- 50 PSF

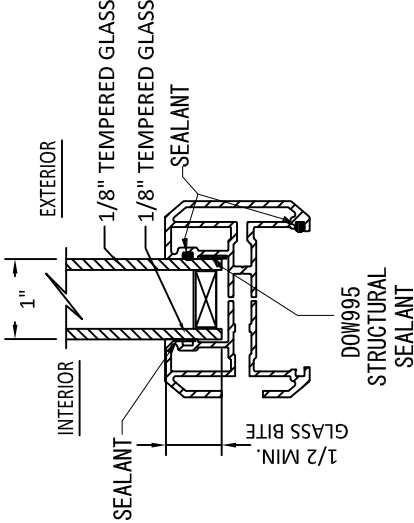

5 GLAZING DETAIL OPTION
20 1/2" MAX D.L.O. WIDTH
78 1/2" MAX D.L.O. HEIGHT

- 3-O X 6-8 - DP 50
- 6-O X 6-8 - DP 50
- 3-O X 8-0 - DP 50
- 6-O X 8-0 - DP 45

NOTE:
FRACTIONAL GLAZING, INCLUDING INTERNAL GRID, BLINDS
BETWEEN GLASS, DECORATIVE, EXTERNAL AND INTERNAL
WROUGHT IRON AND RADIUS (SHAPED) LITES ARE APPROVED
IN ALL GLAZING DETAILS SHOWN ABOVE.

PREPARED BY:

BUILDING DROPS, INC.
398 E. DANIA BEACH BLVD., STE. 338
DANIA BEACH, FL 33004
PH: (954)399-8478
FAX: (954)744-4738
WEB: www.buildingdrops.com

DESIGN PRO/SMOOTH PRO FULL LITE
NON-IMPACT
WOOD INSTALLATION

3737 LAKEPORT BLVD.,
KLAMATH FALLS, OR 97601
PH: (541)882-3451
FAX: (541)850-2609

TITLE:

REMARKS	BY	DATE
Add Multi-Point Lock	GL	06/12/14
Reference DWG. #A010834A	AM	09/04/19

THE INSTALLATION DETAILS DESCRIBED HEREIN ARE GENERIC AND MAY NOT REFLECT ACTUAL CONDITIONS FOR A SPECIFIC SITE. IF THE END USER CAUSES MODIFICATION TO DEViate FROM THE REQUIREMENTS OF THE SPECIFICATION, THE ENGINEER OR ARCHITECT SHALL PREPARE SITE SPECIFIC DOCUMENTS FOR USE WITH THIS DOCUMENT.

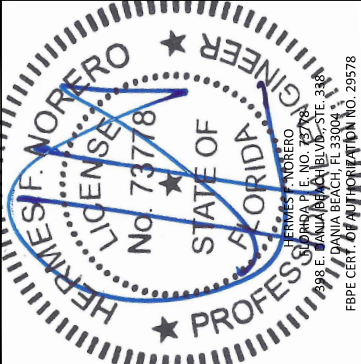

DATE: 02.05.14

DWG. BY: GL/TJM
CHK. BY: SS/MSS

SCALE: NTS

DWG. #: D015689

SHEET: OF 9

7

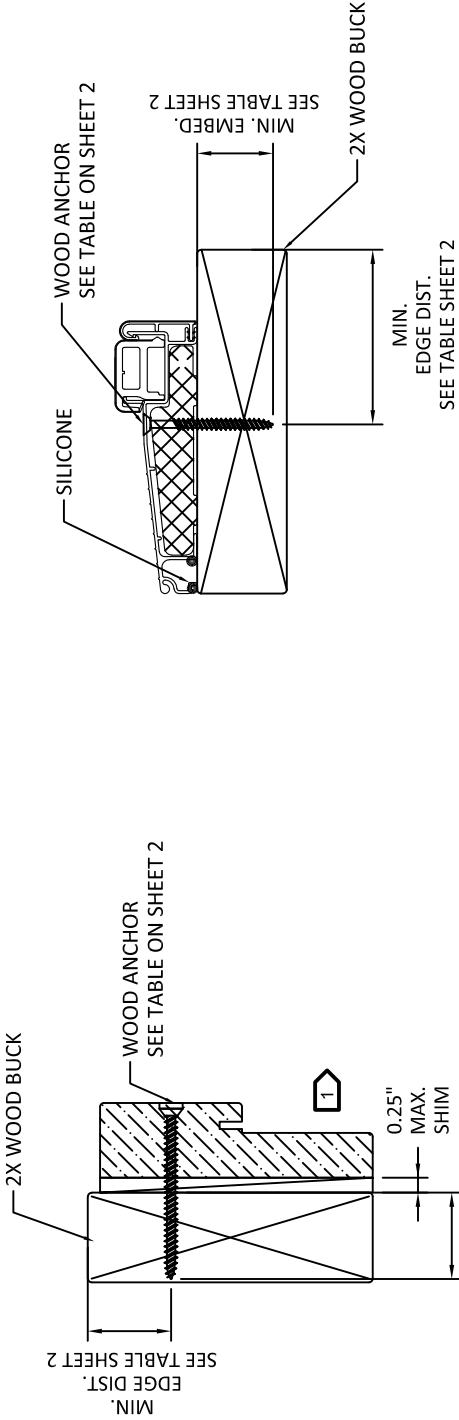

1 HEAD (TYPICAL)

OUTSWING SHOWN - INSWING SIMILAR

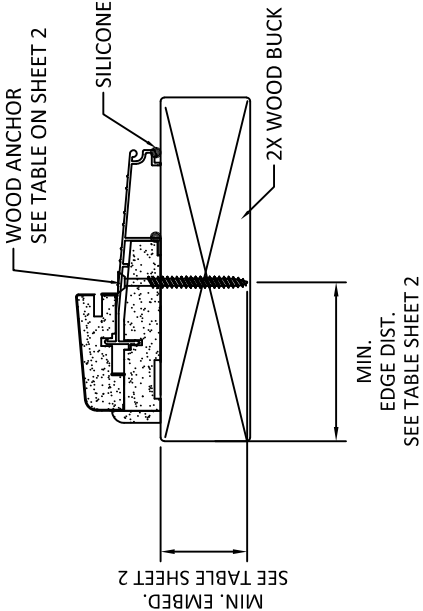

2 JAMB (TYPICAL)

OUTSWING SHOWN - INSWING SIMILAR

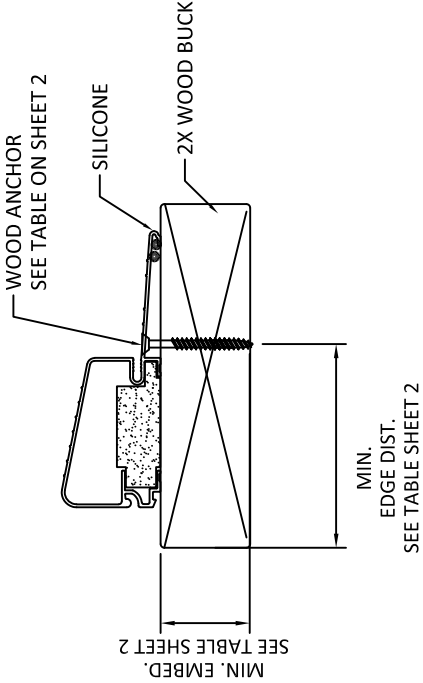

3 OPERABLE SILL

INSWING

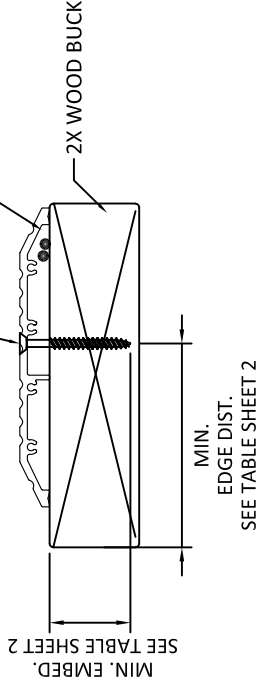

4 OPERABLE SILL

OUTSWING

5 OPERABLE SILL

HIGH BUMP OUTSWING
AFCO H-497

6 OPERABLE SILL

ADA SILL

1 OPTIONALLY, ANCHOR CAN BE PLACED IN NARROW SECTION OF HEAD OR JAMB AS LONG AS MINIMUM EMBEDMENT AND EDGE DISTANCE ARE ACHIEVED.

BILL OF MATERIALS		
ITEM#	DESCRIPTION	MATERIAL
1	FRAME HEAD/JAMBS	FINGER-JOINTED PINE
		SOLID PINE
		LAMINATED VENEER LUMBER
		COMPOSITE
2	ASTRAGAL, ENDURA ULTIMATE HURRICANE (SEE SHEET 2 FOR HARDWARE AND FASTENING DETAILS)	6063-T6 ALUMINUM
3	(NOT USED)	-
4	THRESHOLD	-
5	THRESHOLD	-
6	1" O.A. IG TEMPERED NON-IMPACT GLASS	-
7	AFCO H-497 THRESHOLD	-
8	WEATHERSTRIP	URETHANE FOAM & POLYETHYLENE
9	NON-COMPRESSION SHIM (0.25" MAX. THK.)	COMPOSITE
10	2X WOOD (S.G. MUST BE 0.55 OR GREATER)	WOOD
11	1X WOOD (S.G. MUST BE 0.55 OR GREATER)	WOOD
12	#10 WOOD INSTALLATION SCREW W/ 1 1/2" MIN. EMBEDMENT	STEEL
13	CONC./CMU ANCHOR (SEE ANCHOR TABLE SHEETS 2 & 3)	STEEL
14	BUTT HINGE (SEE SCHEDULE SHEET 5)	-
15	LOCK SERIES 400	STEEL
16	DEADBOLT SERIES 780	STEEL
17	HOPPE MULTI-POINT HARDWARE HLS9000 (SEE SHEET 2 FOR HARDWARE AND FASTENING DETAILS)	STEEL
18	ODL LIPLITE KIT (NI)	PLASTIC
19	FLUSH GLAZING LEG	FIBERGLASS
20	ODL LIPLITE KIT (RADIUS LITES)	PLASTIC
21	FLAT LITE KIT	ALUMINUM
22	PU DOOR CORE	-
23	ADA THRESHOLD	-

1 FRAME HEAD/JAMBS
VARIES, SEE BOM ABOVE

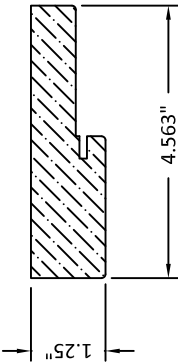

2 ENDURA ASTRAGAL
ALUMINUM

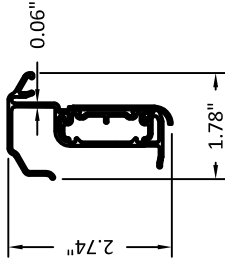

4 THRESHOLD

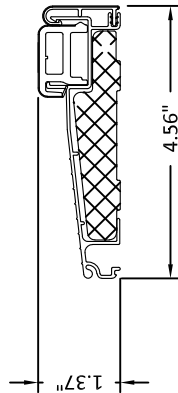

5 THRESHOLD

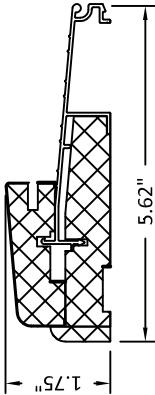

7 AFCO H-497 THRESHOLD

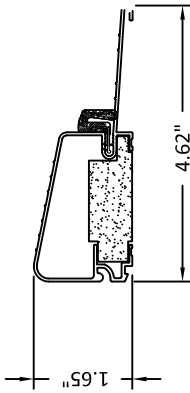

17 HOPPE MULTI-POINT LOCK

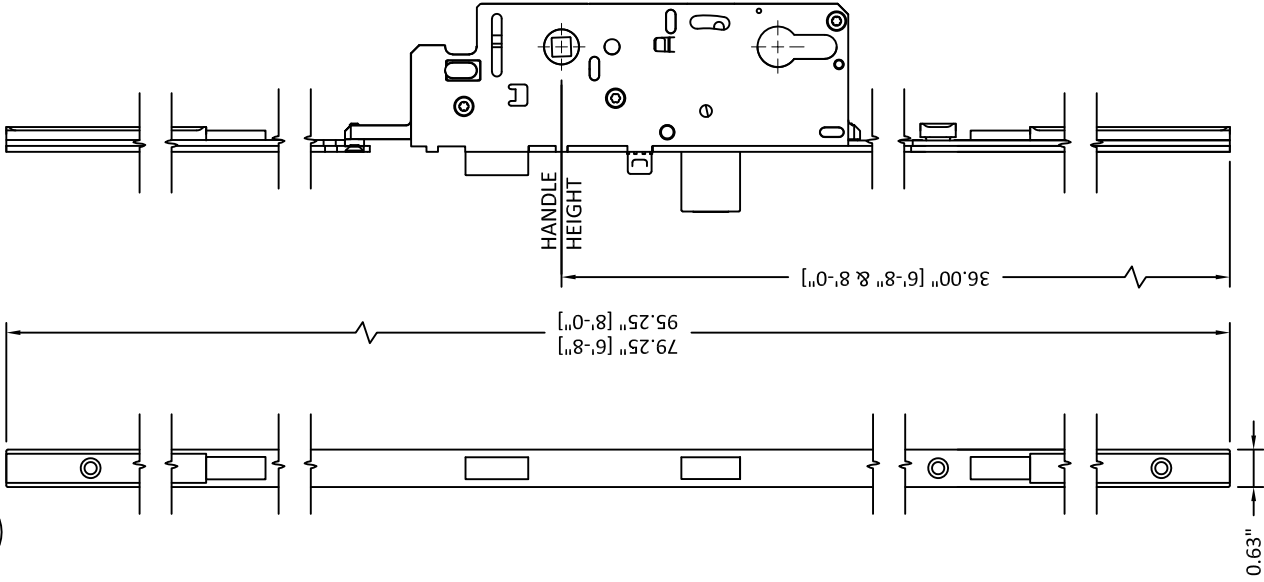

23 ADA SILL

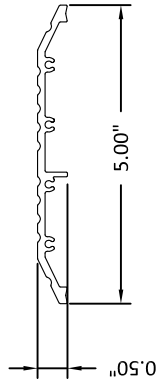

PREPARED BY:

BUILDING DROPS, INC.
398 E. DANIA BEACH BLVD., STE. 338
DANIA BEACH, FL 33004
PH: (954)399-8478
FAX: (954)744-4738
WEB: www.buildingdrops.com

*DESIGN PRO/SMOOTH PRO FULL LITE
NON-IMPACT*

COMPONENTS AND BILL OF MATERIALS

3737 LAKEPORT BLVD.,
KLAMATH FALLS, OR 97601
PH: (541)882-3451
FAX: (541)850-2609

...updateType updateType=pdf;url=...;2012.2.pdf

REMARKS

Add Multi-Point Lock

Reference DWG. #A010834A

THE INSTALLATION DETAILS DESCRIBED HEREIN ARE GENERIC
AND MAY NOT REFLECT ACTUAL CONDITIONS FOR A SPECIFIC
SITE. IF SITE CONDITIONS CAUSE INSTALLATION TO DEVIATE
FROM THE REQUIREMENTS DETAILED HEREIN, A LICENSED
ENGINEER OR ARCHITECT SHALL PREPARE SITE SPECIFIC
DOCUMENTS TO BE USED WITH THIS DOCUMENT.

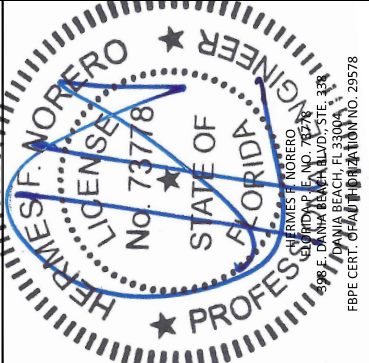

DATE: 02.05.14

DWG. BY: GL/TJM
CHK. BY: SS/MSS

SCALE: NTS

DWG. #: D015689

SHEET: OF 9

FLORIDA DEPARTMENT OF
Business & Professional Regulation



[DBPR HOME](#) | [ABOUT DBPR](#) | [DBPR DIVISIONS](#) | [CONTACT DBPR](#)

[BCIS Home](#) | [Log In](#) | [User Registration](#) | [Hot Topics](#) | [Submit Surcharge](#) | [Stats & Facts](#) | [Publications](#) | [Contact Us](#) | [BCIS Site Map](#) | [Links](#) | [Search](#)



Product Approval
USER: Public User

[Product Approval Menu](#) > [Product or Application Search](#) > **Application List**

OFFICE OF THE
SECRETARY

Search Criteria

[Refine Search](#)

Code Version	2020	FL#	15474.1
Application Type	ALL	Product Manufacturer	ALL
Category	ALL	Subcategory	ALL
Application Status	ALL	Compliance Method	ALL
Quality Assurance Entity	ALL	Quality Assurance Entity Contract Expired	ALL
Product Model, Number or Name	ALL	Product Description	ALL
Approved for use in HVHZ	ALL	Approved for use outside HVHZ	ALL
Impact Resistant	ALL	Design Pressure	ALL
Other	ALL		

Search Results - Applications

FL#	Type	Manufacturer	Validated By	Status
FL15474-R5 History	Revision	Jeld-Wen FL#: FL15474.1 Model: Contours Steel, Wood Edge Description: 12'-0" x 8'-0", Glazed Inswing and Outswing Door with Sidelites Category: Exterior Doors Subcategory: Swinging Exterior Door Assemblies	National Accreditation & Management Institute (804) 684-5124	Approved *

*Approved by DBPR. Approvals by DBPR shall be reviewed and ratified by the POC and/or the Commission if necessary.

[Contact Us](#) :: 2601 Blair Stone Road, Tallahassee FL 32399 Phone: 850-487-1824

The State of Florida is an AA/EEO employer. [Copyright 2007-2013 State of Florida](#). :: [Privacy Statement](#) :: [Accessibility Statement](#) :: [Refund Statement](#)

Under Florida law, email addresses are public records. If you do not want your e-mail address released in response to a public-records request, do not send electronic mail to this entity. Instead, contact the office by phone or by traditional mail. If you have any questions, please contact 850.487.1395. *Pursuant to Section 455.275(1), Florida Statutes, effective October 1, 2012, licensees licensed under Chapter 455, F.S. must provide the Department with an email address if they have one. The emails provided may be used for official communication with the licensee. However email addresses are public record. If you do not wish to supply a personal address, please provide the Department with an email address which can be made available to the public. To determine if you are a licensee under Chapter 455, F.S., please click [here](#).

Product Approval Accepts:



JELD-WEN DOOR
INSTALLATION DETAILS
STEEL 24 GA. WOOD EDGE
FULL LITE NON-IMPACT
UP TO 12'-0" X 8'-0"
OUTSWING/INSWING

GENERAL NOTES

1. THIS PRODUCT IS DESIGNED TO COMPLY WITH CURRENT INTERNATIONAL BUILDING CODE (I.B.C.), & INTERNATIONAL RESIDENTIAL CODE (I.R.C.) AND THE CURRENT FLORIDA BUILDING CODES (FBC), EXCLUDING HVHZ AND HAS BEEN EVALUATED IN ACCORDANCE TO ASTM E283-04, E330-02, E331-00 AND AAMA 1304-02.
2. 1X AND 2X WOOD BUCKS BY OTHERS AND MUST BE ANCHORED PROPERLY TO TRANSFER LOADS TO THE STRUCTURE. BUCK MATERIAL MUST HAVE A SPECIFIC GRAVITY OF 0.55 OR GREATER.

3. PRODUCT ANCHOR TYPES AND SPACING ARE SHOWN ON SHEET 7. DIMENSIONS SHOWN FOR ANCHOR SPACING ARE ALWAYS FROM EDGE OF UNIT FRAME. ANCHOR EMBEDMENT TO BASE MATERIAL SHALL BE BEYOND WALL DRESSING OR STUCCO.

4. THIS DOCUMENT SUPERCEDES OTHER ANCHOR INSTALLATION INSTRUCTIONS FOR NON-IMPACT RATED DOORS. FOR OTHER IMPORTANT INSTALLATION INSTRUCTIONS, REFER TO JELD-WEN DOCUMENT #J1106 (INSTALLATION INSTRUCTIONS FOR PRE-HUNG ENTRY DOORS) FOUND ON THE JELD-WEN WEBSITE: JELD-WEN.COM/LEARN/RESOURCES/INSTALLATION & FINISHING/.

5. FLORIDA APPROVED SHUTTERS ARE NEEDED WHEN IMPACT PROTECTION IS REQUIRED.

6. FOR DESIGN PRESSURE RATINGS, SEE TABLE 1, SHEET 1.

7. ALL FASTENERS IN WOOD SHALL BE COUNTERSUNK 3/16" DEEP.

EXAMPLE: 3/16" —



COMPONENT LIST

ITEM	DESCRIPTION	MATERIAL	QTY.
1	NON-COMPRESSION SHIM (0.25" MAX. THK.)	WOOD	AS REQ.
2	2x WOOD SUB BUCK (S.G. MUST BE 0.55 OR GREATER)	WOOD	AS REQ.
3	1x WOOD SUB BUCK (S.G. MUST BE 0.55 OR GREATER)	WOOD	AS REQ.
4	#10 WOOD INSTALLATION SCREW W/ 1 1/2" MIN. EMBEDMENT	STEEL	AS REQ.
5	3/16" ITW TAPCON ANCHOR W/ 1 1/4" MIN. EMBEDMENT	STEEL	AS REQ.
6	#9 X 2 1/2" PHILLIPS FLATHEAD WOOD SCREW	STEEL	2 OR 4
7	#8 X 2" PHILLIPS FLATHEAD WOOD SCREW	STEEL	AS REQ.
8	#9 X 3/4" PHILLIPS FLATHEAD WOOD SCREW	STEEL	30 OR 60
9	1" O.A. IG NON-IMPACT FRAME GLAZED BY ODL	Polypropylene	1 OR 4
10	LOCK SERIES 400	STEEL	1
11	DEADBOLT SERIES 660	STEEL	1
12	FLAT LITE KIT	ALUMINUM	1
13	ADA THRESHOLD	ALUMINUM	1

* NOTE: IF PRODUCT IS CONSTRUCTED USING THE OUTSWING ENDURA FOB4566 (SHOWN BELOW), THEN PRODUCT DOES NOT REQUIRE OVERHANG PROTECTION. OTHERWISE, REMAINING SILLS LISTED ON SHEETS 3 THRU. 6 HAVE NOT BEEN RATED FOR WATER INFILTRATION. IF AUTHORITY HAVING JURISDICTION VALIDATES THAT PRODUCT MEETS THIS AND/OR OTHER REQUIREMENTS, LISTED PRODUCT MAY BE USED WHEN INSTALLED AT LOCATION PROTECTED BY OVERHANG SUCH THAT OVERHANG (OH) RATIO = OH LENGTH ÷ OH HEIGHT IS ≥ 1.0



ENDURA FOB4566
OVERHANG RATIO
OVERHANG SUCH THAT OVERHANG (OH) RATIO =
OH LENGTH ÷ OH HEIGHT IS ≥ 1.0

DOUBLE DOOR W/ FULL 3-0 SIDELITES (OXXO)

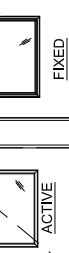
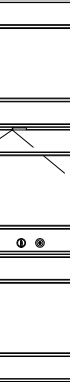
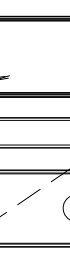
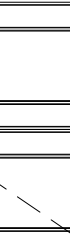
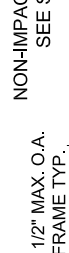
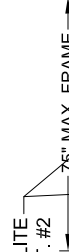
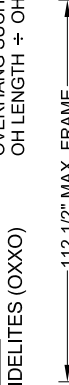
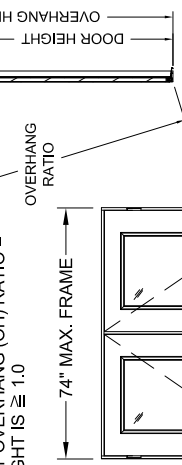

SHEET #	DESCRIPTION
1	GENERAL NOTES, B.O.M. & ELEVATIONS
2	OUTSWING/INSWING BOX MULLING DETAILS
3	OUTSWING VERTICAL AND HORIZONTAL SECTIONS IN WOOD
4	OUTSWING VERT. AND HORIZ. SECTIONS IN MASONRY/CONCRETE
5	INSWING VERTICAL AND HORIZONTAL SECTIONS IN WOOD
6	INSWING VERT. AND HORIZ. SECTIONS IN MASONRY/CONCRETE
7	OUTSWING AND INSWING ANCHORING DETAILS

NO.	DATE	BY	REVISIONS
1	01/30/20		DWG NUM. CHANGE FROM TB JW152012FL TO D015859J
			ADA THRESHOLD ADDED

SHEET #	DESCRIPTION
1	GENERAL NOTES, B.O.M. & ELEVATIONS
2	OUTSWING/INSWING BOX MULLING DETAILS
3	OUTSWING VERTICAL AND HORIZONTAL SECTIONS IN WOOD
4	OUTSWING VERT. AND HORIZ. SECTIONS IN MASONRY/CONCRETE
5	INSWING VERTICAL AND HORIZONTAL SECTIONS IN WOOD
6	INSWING VERT. AND HORIZ. SECTIONS IN MASONRY/CONCRETE
7	OUTSWING AND INSWING ANCHORING DETAILS

TABLE 1

DESIGN PRESSURE RATING:

SIZE	QUALIFIES: FULL LITE ACTIVE PANELS WITH NON-IMPACT GLASS SIDELITES 5
MAX. PANEL WIDTH = 35 3/4"	
	8-0 TALL SYSTEMS:
	(XX) (XOX) (X) (OX) (XO) (OXO)
OUTSWING	+ 35 *
INSWING	- 35 *
OUTSWING	+ 35 *
INSWING	- 35 *

JELD-WEN
WINDOWS & DOORS

3737 Lakeport Blvd.
Klamath Falls, OR 97601
Phone: (541) 882-3411
Fax: (541) 850-2609

24 GA. STEEL W.E. 12-0 X 8-0 FULL LITE
WITH NON-IMPACT FULL SIDELITES

GENERAL NOTES, ELEVATIONS, DP RATINGS
PART OR ASSEMBLY
AND B.O.M.

DATE: 2/23/2012

SCALE: NONE

DWG. BY: G.LUBBECKE

CHK. BY: S.SAFFELL

DRAWING NO.:

D015859

SHEET 1 OF 7

Digitally signed by Hermes F Norero
Reason: I am approving this document
Date: 2020.09.26 09:01:52 +02'00'

HERMES F NORERO
FLORIDA P.E. NO. 73778
398 E. DANIA BEACH BLVD, STE. 338
DANIA BEACH, FL 33004
FBPE CERT. OF AUTH. NO. 29578

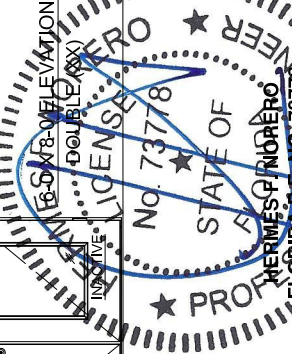

7- #8 X 2"
PFH SCREW AT
EACH MULLION TYP.

APPLY DAP ALEX PLUS SILICONE
OR EQUIV. BETWEEN
JAMBS BEFORE MULLING

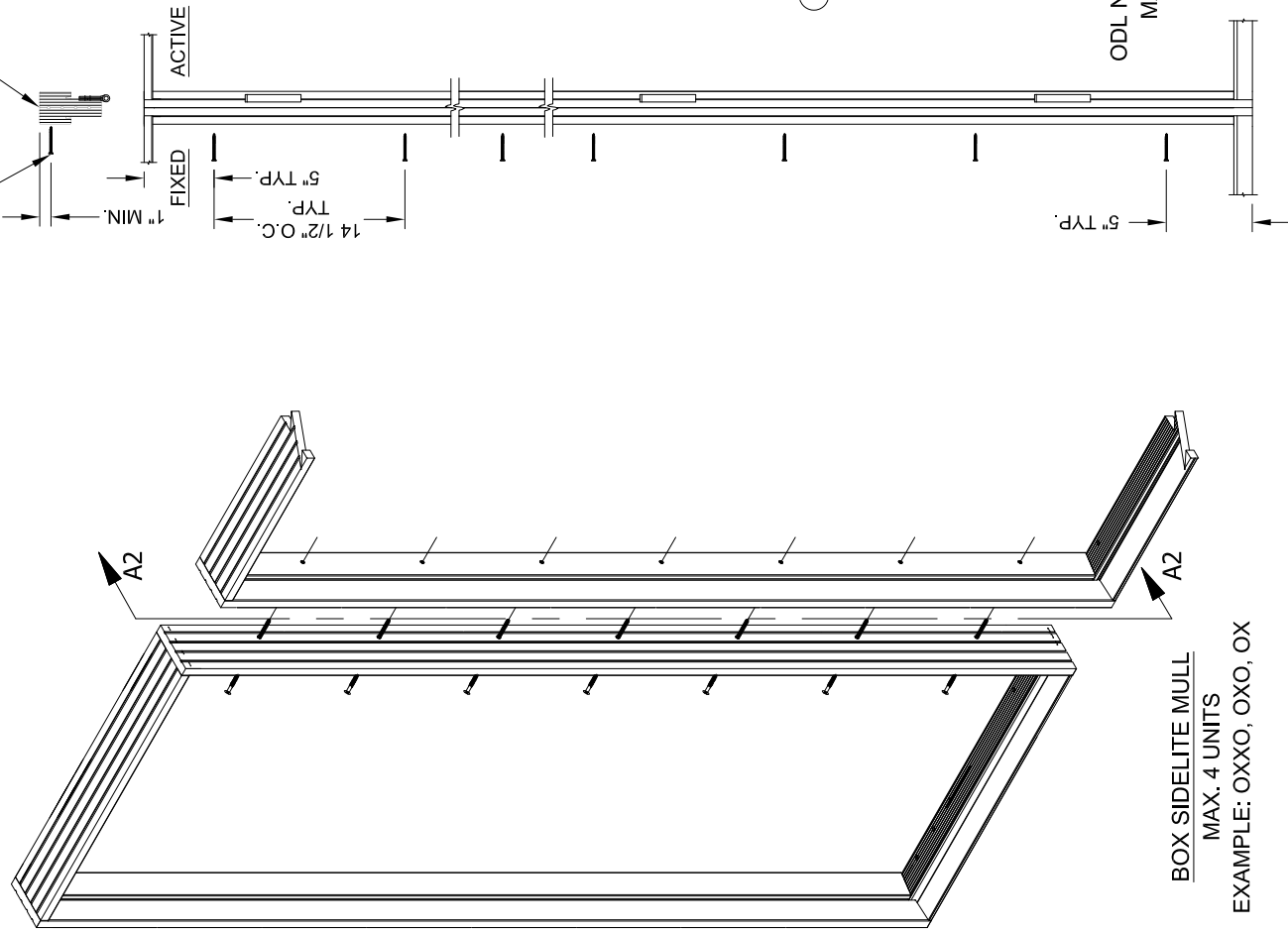

BOX SIDELITE MULL
MAX. 4 UNITS
EXAMPLE: OXO, OXO, OX

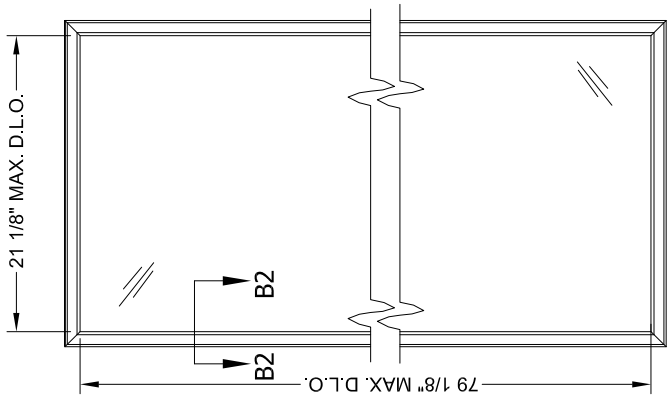

ODL LIP-LITE NON-IMPACT
3-0 X 8-0 SHOWN

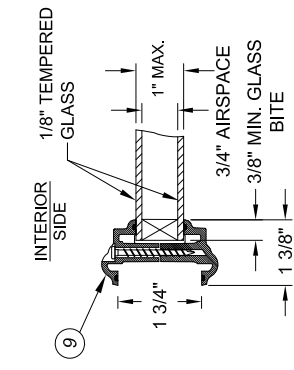

DETAIL B2
ODL NON-IMPACT GLAZING DETAIL
MAX. D.L.O: 21 1/8" X 79 1/8"

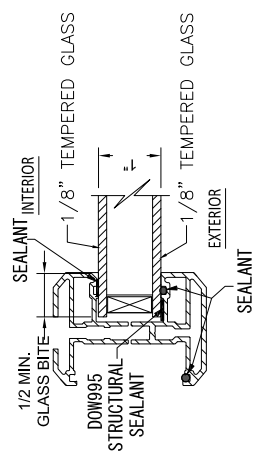

DETAIL

20 1/2" MAX. D.L.O. WIDTH
62 5/8" MAX. D.L.O. HEIGHT



DETAIL A2
(7) FASTENER LOCATIONS AT
DOUBLE-BACK JAMB ATTACHMENT

JELD-WEN
WINDOWS & DOORS

3737 Lakeport Blvd.
Klamath Falls, OR 97601
Phone: (541) 882-3451
Fax: (541) 850-2609

24 GA. STEEL W.E. 12-0 X 8-0 FULL LITE
WITH NON-IMPACT FULL SIDELITES
PART OR ASSEMBLY
MULLING DETAILS AND GLAZING OPTIONS

DATE: 2/23/2012	DATE: 2/23/2012
SCALE: NONE	SCALE: NONE
DESIGNED BY: G.LUBBECKE	DESIGNED BY: G.LUBBECKE
CHECK BY: S.SAFFELL	CHECK BY: S.SAFFELL
DRAWING NO: D015859	DRAWING NO: D015859
SHEET 2 OF 7	SHEET 2 OF 7

FLORIDA P.E. NO: 73778
HERMES P. NORERO
398 E. DANIA BEACH BLVD, STE 338
DANIA BEACH, FL 33004
FBPE CERT. OF AUTH. NO. 29578

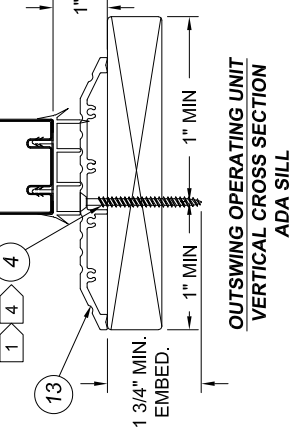
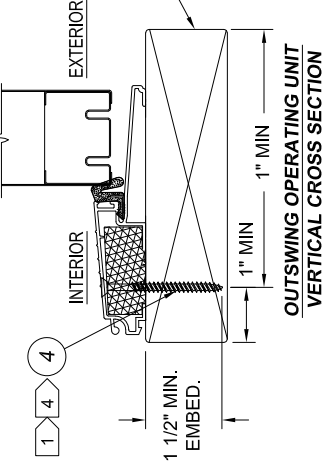
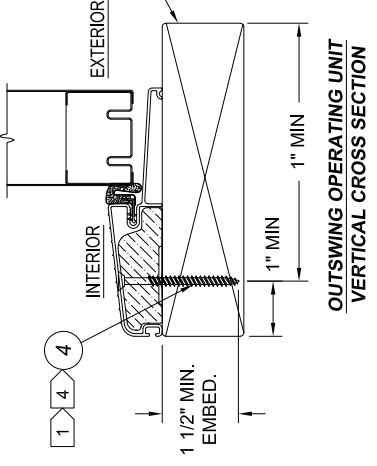
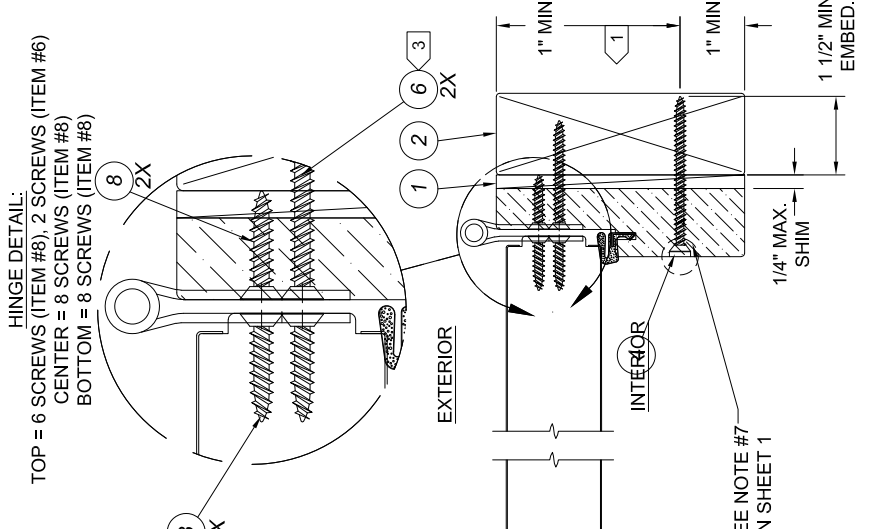
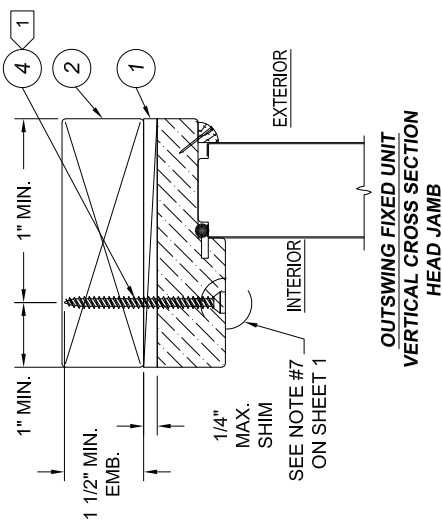
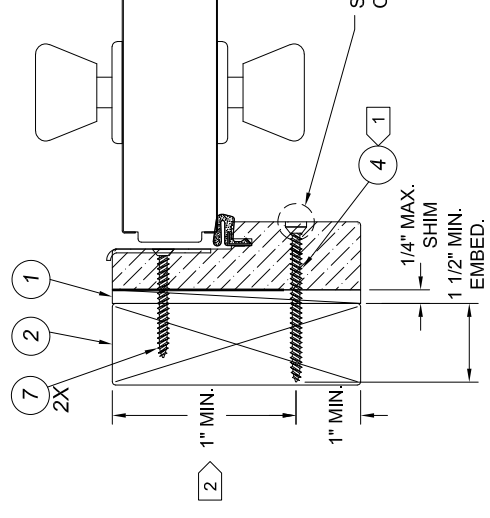
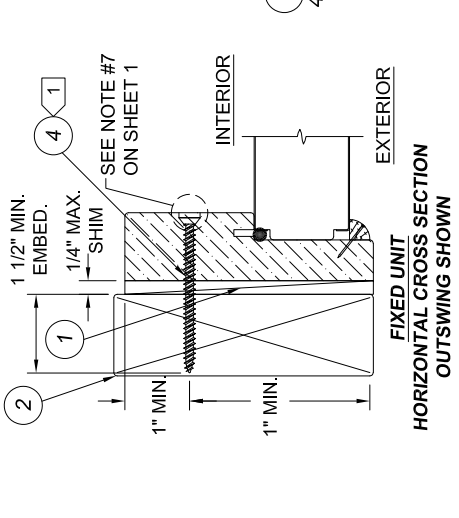
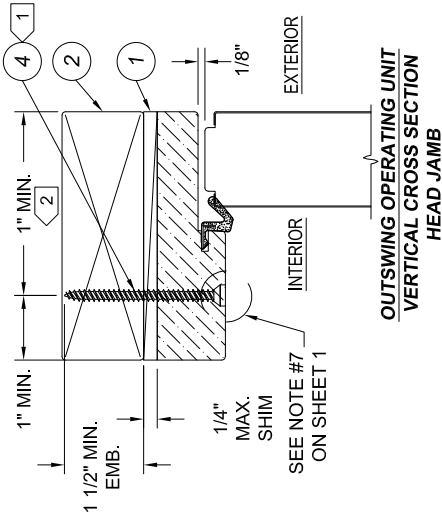

- NOTES:
- 1 FOR PLACEMENT OF ITW TAPCON ANCHORS IN 2X BUCK OR 1X BUCK CONCRETE/MASONRY OPENINGS, SEE SHEET 4.
 - 2 OPTIONALLY, ANCHOR CAN BE PLACED IN NARROW SECTION OF HEAD OR JAMB AS LONG AS MINIMUM EMBEDMENT AND EDGE DISTANCE ARE ACHIEVED.
 - 3 ITEM #6, (#9 X 2 1/2") TWO SCREWS TO BE INSTALLED IN TOP HINGE AT JOB SITE, CLOSEST TO WEATHERSTRIPE.
 - 4 AT SILL, PLACE ANCHOR IN SILL BASE MATERIAL FOR MAXIMUM SUPPORT.

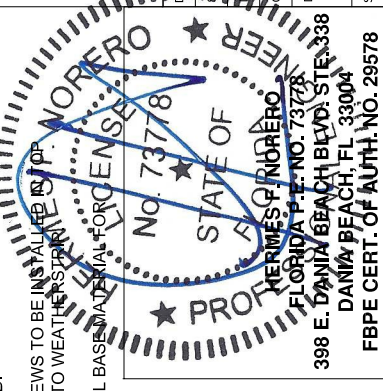

JELD-WEN
 3737 Lakeport Blvd.
 Klamath Falls, OR 97601
 Phone: (541) 882-3451
 Fax: (541) 850-2609

24 GA. STEEL W.E. 12-0 X 8-0 FULL LITE WITH NON-IMPACT FULL SIDELITES		OUTSWING VERTICAL AND HORIZONTAL SECTIONS IN WOOD	
PART OR ASSEMBLY		DATE: 2/23/2012	
SCALE: NONE		DRAWN BY: G.LUBBECKE	
CHECK BY: S.SAFFELL		DRAWING NO.:	
D015859		SHEET 3 OF 7	

OUTSWING LATCH JAMB AT FRAME
HORIZONTAL CROSS SECTION

OUTSWING HINGE JAMB AT FRAME
HORIZONTAL CROSS SECTION

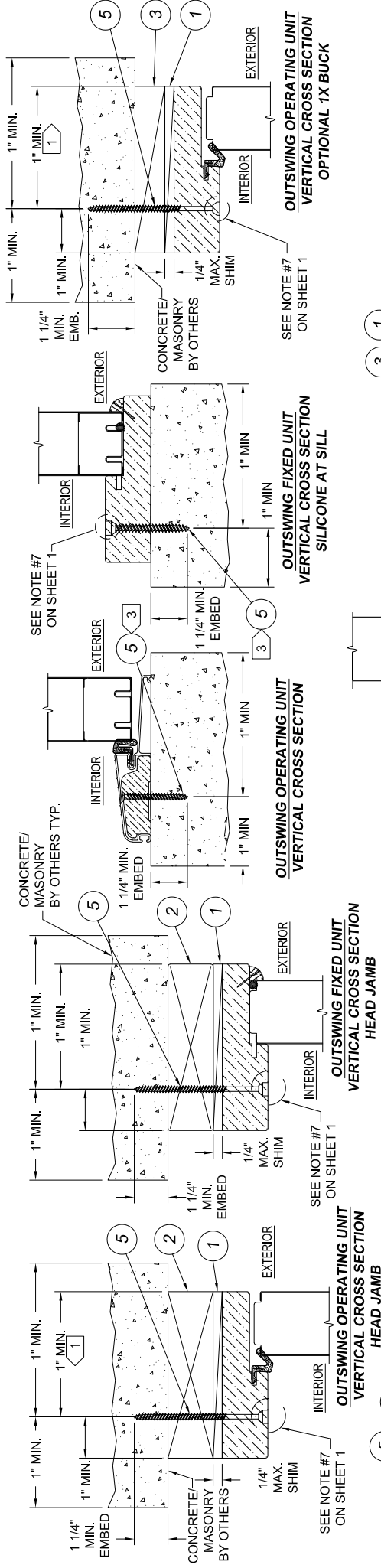

HINGE DETAIL:
 TOP = 6 SCREWS (ITEM #8) 2 SCREWS (ITEM #6)
 CENTER TOP = 8 SCREWS (ITEM #8)
 CENTER BOTTOM = 8 SCREWS (ITEM #8)
 BOTTOM = 8 SCREWS (ITEM #8)

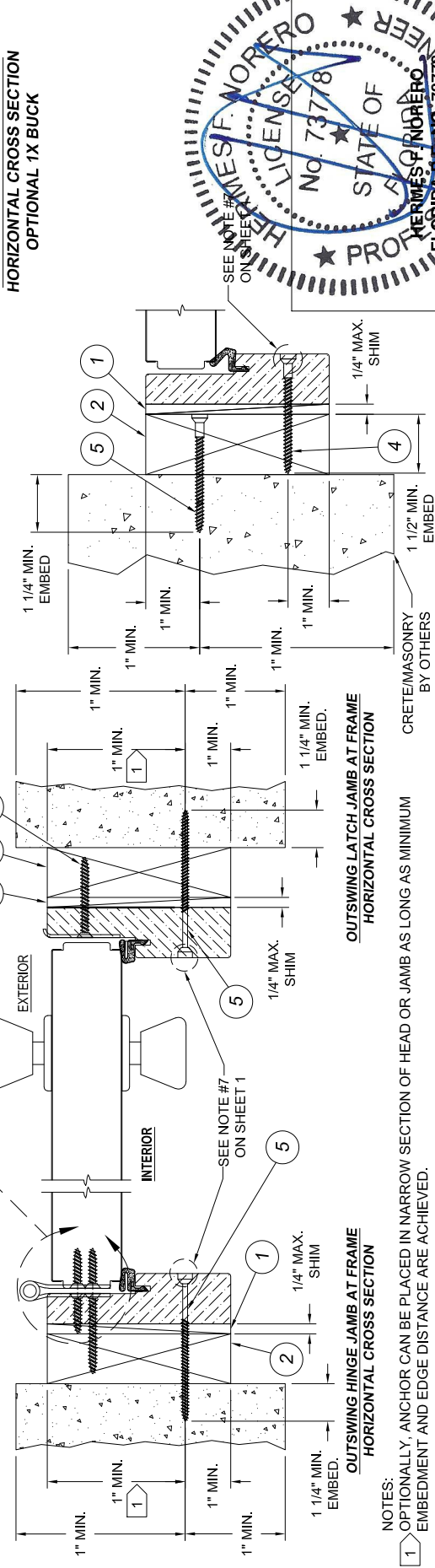
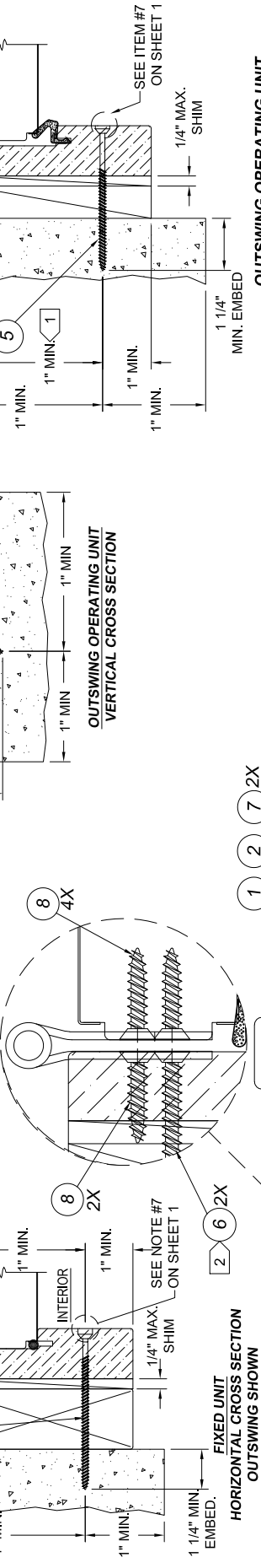

NOTES:
 1 OPTIONALLY, ANCHOR CAN BE PLACED IN NARROW SECTION OF HEAD OR JAMB AS LONG AS MINIMUM EMBEDMENT AND EDGE DISTANCE ARE ACHIEVED.
 2 ITEM #6, (#9 X 2 1/2") TWO SCREWS TO BE INSTALLED IN TOP HINGE AT JOB SITE, CLOSEST TO WEATHERSTRIP.
 3 AT SILL, PLACE ANCHOR IN SILL BASE MATERIAL FOR MAXIMUM SUPPORT.

JELD-WEN
 3737 Lakeport Blvd.
 Klamath Falls, OR 97601
 Phone: (541) 882-3451
 Fax: (541) 850-2609

24 GA. STEEL W.E. 12-0 X 8-0 FULL LITE
 WITH NON-IMPACT FULL SIDELITES
 PART OR ASSEMBLY
 DATE: 2/23/2012
 SCALE: NONE
 DRAWN BY: G.LUBBECKE
 CHECK BY: S.SAFFELL
 DRAWING NO.: D015859
 SHEET 4 OF 7

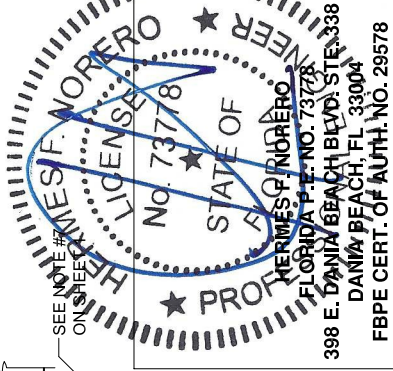

OPTIONAL MASONRY/CONCRETE INSTALL
 CROSS SECTION OF HEAD JAMB OR SIDE JAMB

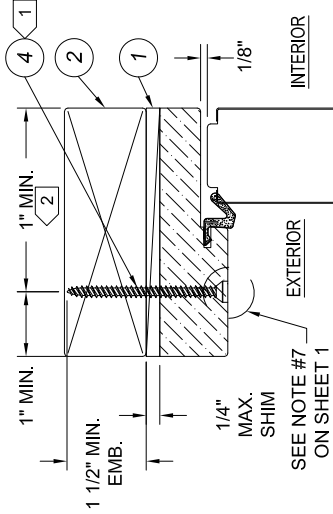

**INSWING OPERATING UNIT
VERTICAL CROSS SECTION
HEAD JAMB**

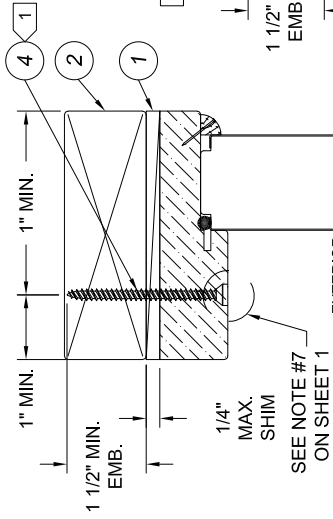

**INSWING FIXED UNIT
VERTICAL CROSS SECTION
HEAD JAMB**

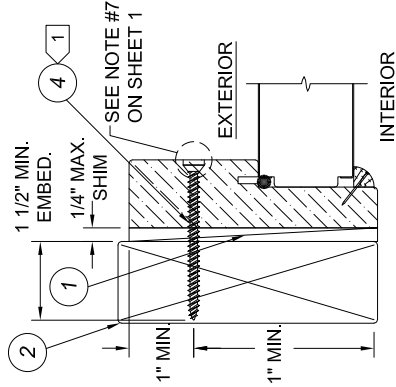

**FIXED UNIT
HORIZONTAL CROSS SECTION
INSWING SHOWN**

HINGE DETAIL:
TOP = 6 SCREWS (ITEM #8), 2 SCREWS (ITEM #6)
CENTER TOP = 8 SCREWS (ITEM #8)
CENTER BOTTOM = 8 SCREWS (ITEM #8)
BOTTOM = 8 SCREWS (ITEM #8)

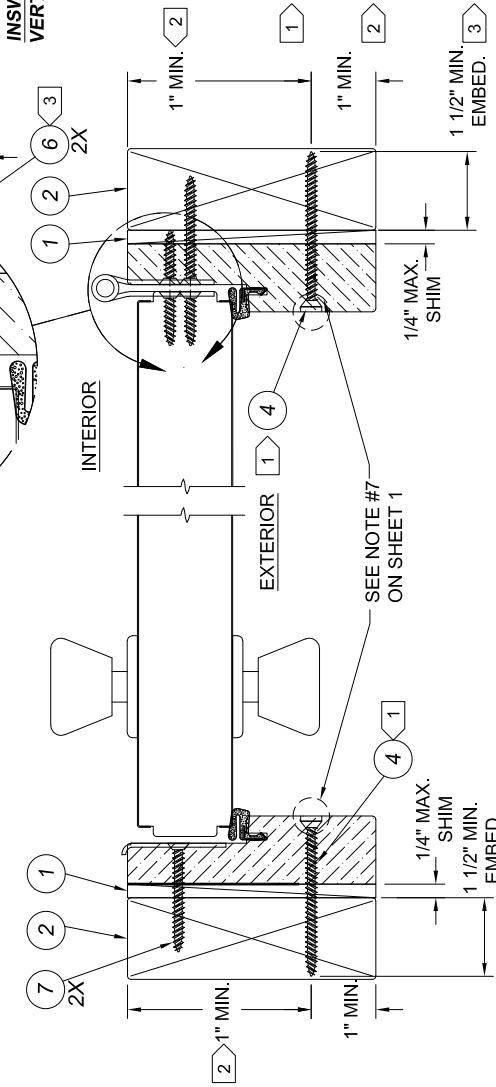
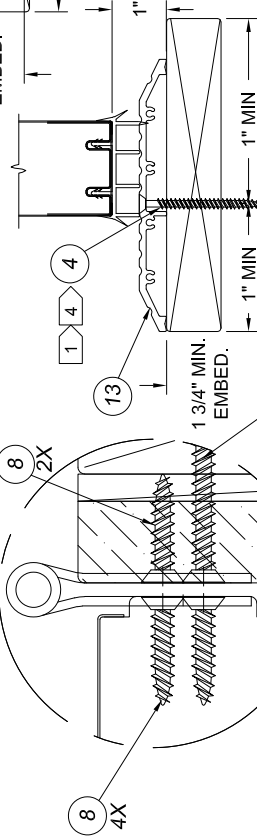

**INSWING LATCH JAMB AT FRAME
HORIZONTAL CROSS SECTION**

**INSWING HINGE JAMB AT FRAME
HORIZONTAL CROSS SECTION**

- NOTES:**
- FOR PLACEMENT OF ITW TAPCON ANCHORS IN 2X BUCK OR 1X BUCK CONCRETE/MASONRY OPENINGS, SEE SHEET 6
 - OPTIONALLY, ANCHOR CAN BE PLACED IN NARROW SECTION OF HEAD OR JAMB AS LONG AS MINIMUM EMBEDMENT AND EDGE DISTANCE ARE ACHIEVED.
 - ITEM #6, (#9 X 2 1/2") TWO SCREWS TO BE INSTALLED IN TOP HINGE AT JOB SITE, CLOSEST TO WEATHERSTRIP.
 - AT SILL, PLACE ANCHOR IN SILL BASE MATERIAL FOR MAXIMUM SUPPORT.

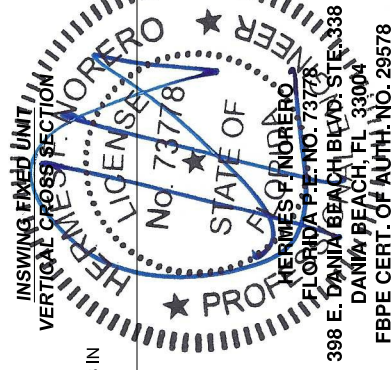

24 GA. STEEL W.E. 12-0 X 8-0 FULL LITE
WITH NON-IMPACT FULL SIDELITES

PART OR ASSEMBLY

DATE: 2/23/2012
SCALE: NONE
DRAWN BY: G.LUBBECKE
CHK. BY: S.SAFFELL
DRAWING NO.: D015859

INSWING VERTICAL AND HORIZONTAL SECTIONS

JELD-WEN
WINDOWS & DOORS

3737 Lakeport Blvd.
Klamath Falls, OR 97601
Phone: (541) 882-3451
Fax: (541) 850-2609

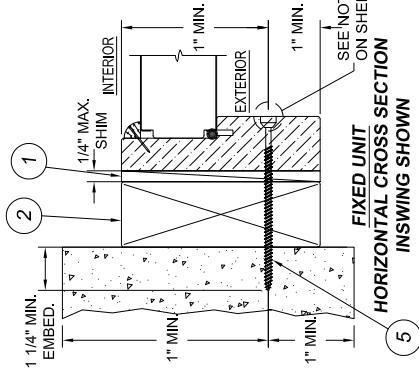
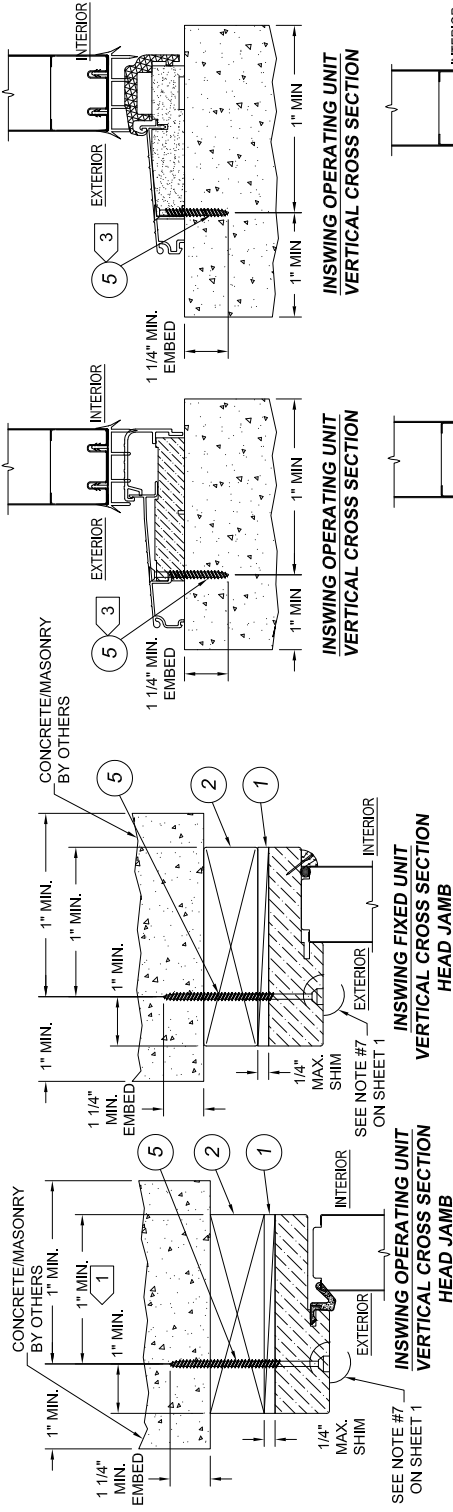

HINGE DETAIL:
TOP = 6 SCREWS (ITEM #8), 2 SCREWS (ITEM #6)
CENTER = 8 SCREWS (ITEM #8)
BOTTOM = 8 SCREWS (ITEM #8)

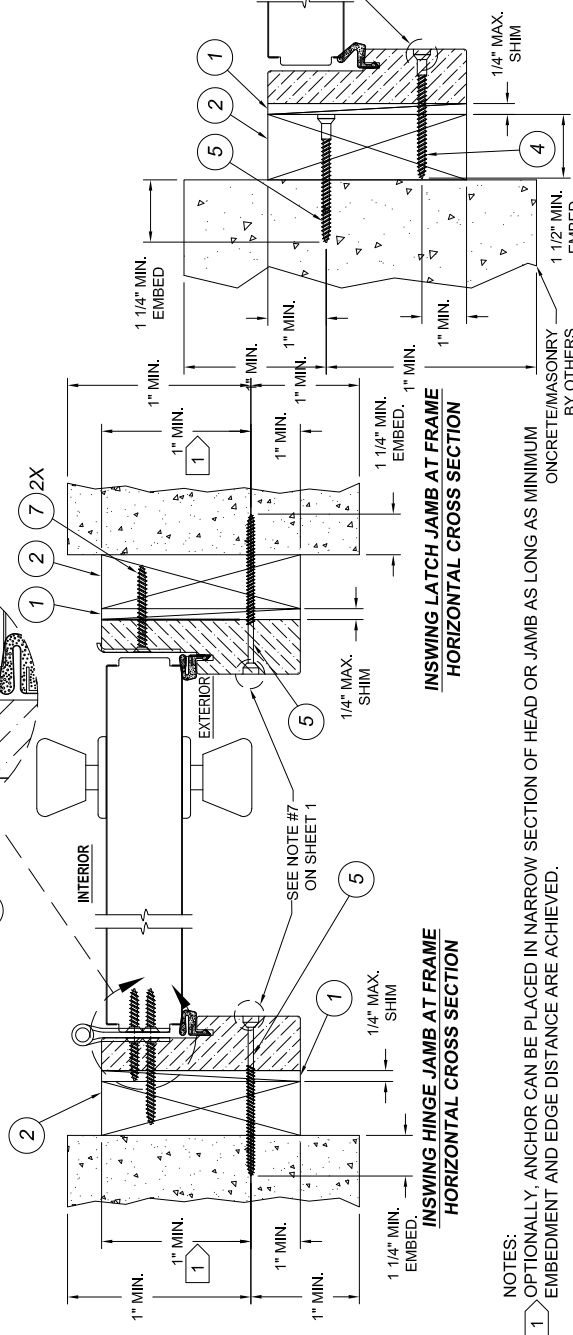
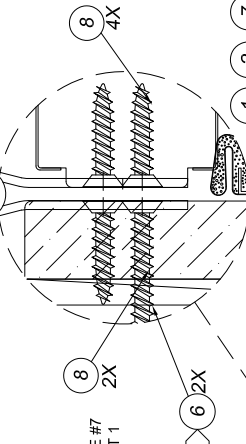

NOTES:

- 1 OPTIONALLY, ANCHOR CAN BE PLACED IN NARROW SECTION OF HEAD OR JAMB AS LONG AS MINIMUM EMBEDMENT AND EDGE DISTANCE ARE ACHIEVED.
- 2 ITEM #6, (#9 X 2 1/2") TWO SCREWS TO BE INSTALLED IN TOP HINGE AT JOB SITE, CLOSEST TO WEATHERSTRIP.
- 3 AT SILL, PLACE ANCHOR IN SILL BASE MATERIAL FOR MAXIMUM SUPPORT.

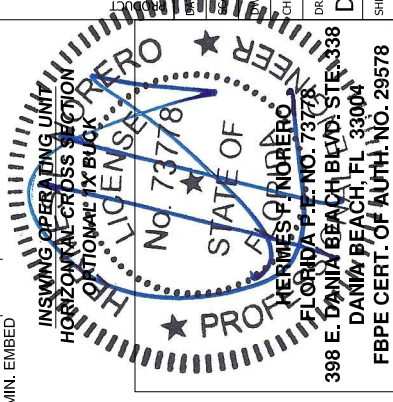
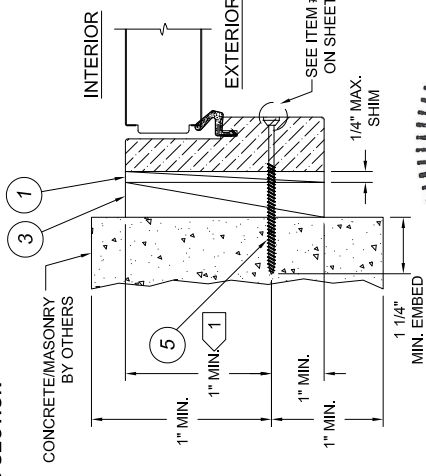
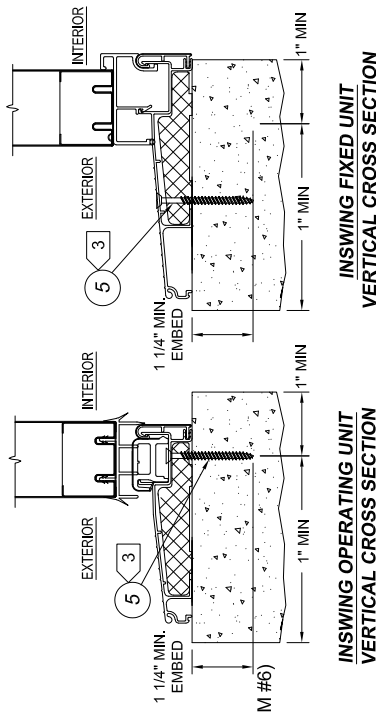
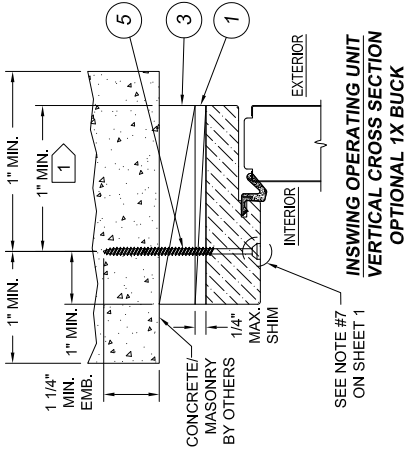

24 GA. STEEL W.E. 12-0 X 8-0 FULL LITE
WITH NON-IMPACT FULL SIDELITES

INSWING VERTICAL AND HORIZONTAL SECTIONS
PART OR ASSEMBLY

DATE: 2/23/2012
SCALE: NONE
DRAWN BY: G.LUBBECKE
CHK BY: S.SAFFELL
DRAWING NO.: D015859

JELD-WEN
WINDOWS & DOORS

3737 Lakeport Blvd.
Klamath Falls, OR 97601
Phone: (541) 882-3451
Fax: (541) 850-2609

NOTE:
SHIM FOR SUPPORT AT OR NEAR
EACH ANCHOR IS REQUIRED

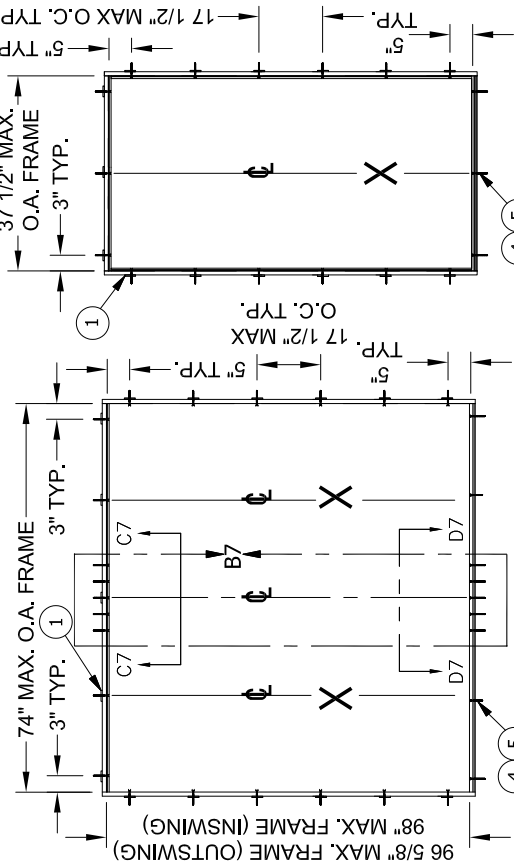
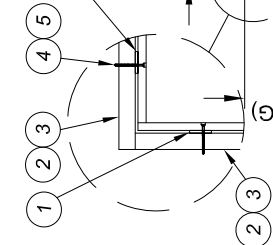

6-0 X 8-0 OUTSWING/INSWING
(30) ANCHOR LOCATIONS
(FROM EDGE OF FRAME)

3-0 X 8-0 OUTSWING/INSWING
(18) ANCHOR LOCATIONS
(FROM EDGE OF FRAME)

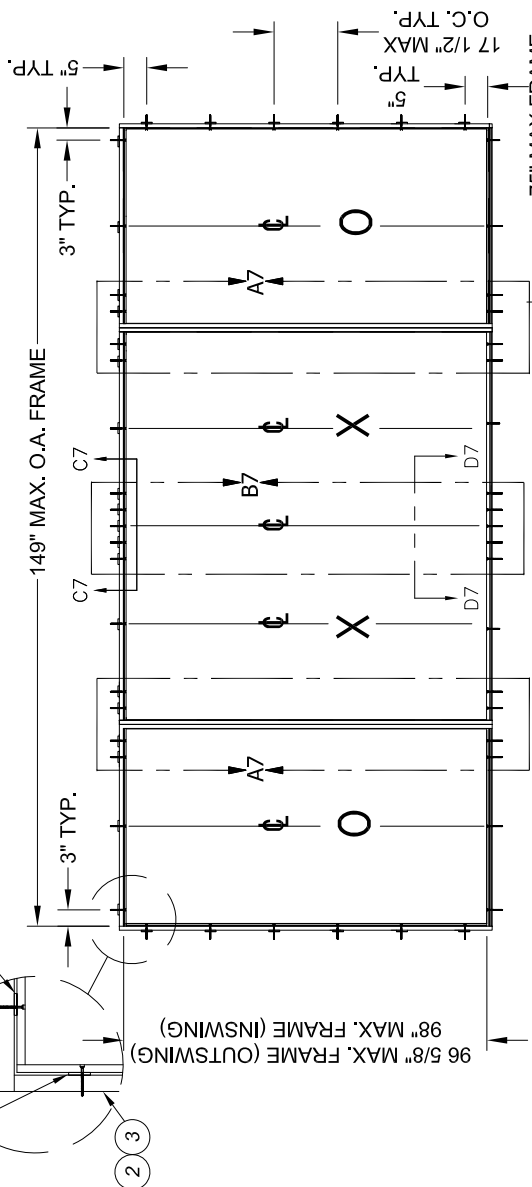

12-0 X 8-0 OUTSWING/INSWING
(50) ANCHOR LOCATIONS
(FROM EDGE OF FRAME)

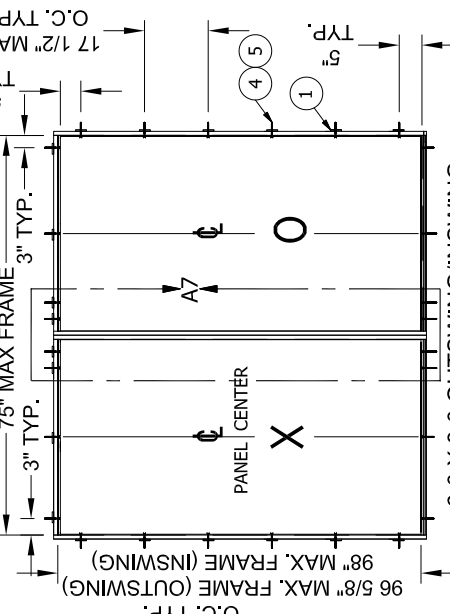

6-0 X 8-0 OUTSWING/INSWING
(28) ANCHOR LOCATIONS (FROM EDGE OF FRAME)

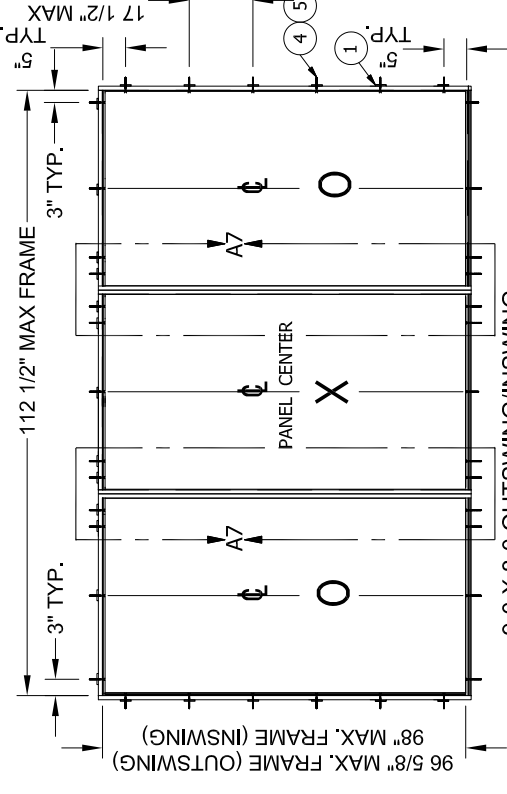

9-0 X 8-0 OUTSWING/INSWING
(38) ANCHOR LOCATIONS
(FROM EDGE OF FRAME)

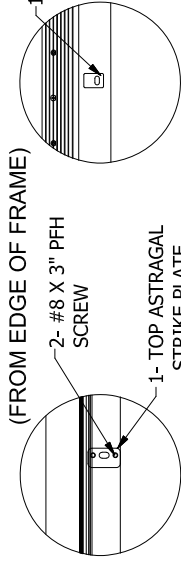

OUTSWING OR INSWING
DETAIL C7-C7

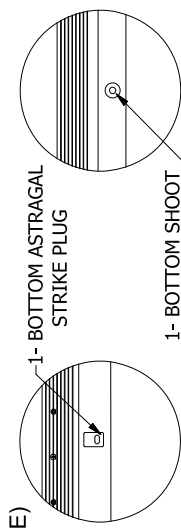

OUTSWING ONLY
DETAIL D7-D7

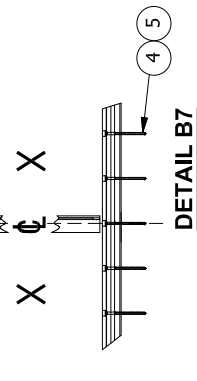

INSWING ONLY
DETAIL D7-D7 (10) ANCHOR LOCATIONS
AT ASTRALG

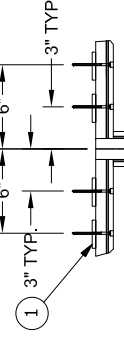

(8) ANCHOR LOCATIONS AT MULL
(LEFT MULL SHOWN,
RIGHT MULL OPPOSITE SHOWN)

24 GA. STEEL W.E. 12-0 X 8-0 FULL LITE
WITH NON-IMPACT FULL SIDELITES
PART OR ASSEMBLY
DATE: 2/23/2012
SCALE: NONE
DRAWN BY: G.LUBBECKE
CHK. BY: S.SAFFELL
DRAWING NO.: D015859
3737 Lakeport Blvd.
Klamath Falls, OR 97601
Phone: (541) 882-3451
Fax: (541) 850-2609

JELD-WEN
WINDOWS & DOORS

