

FLOOR PLAN
SCALE: 1/4" = 1'

DESIGN SPECIFICATIONS

- DESIGN CODES:
 - 2020 FLORIDA BUILDING CODE (FBC) - RESIDENTIAL
 - ASCE 7-10, 2005
 - ND5, ACI, ATIC, AWPA, APA, ICC 600-08
 - OCCUPANCY: RESIDENTIAL GROUP R-3 (ONE- AND TWO-FAMILY DWELLINGS)
- DESIGN LOADS:
 - ROOF CONVENTIONAL FRAMING:
 - LL 20 PSF CEILING JOISTS
 - DL 10 PSF RAFTERS
 - DL 10 PSF CEILING JOISTS
 - DL 30 PSF ATTICS WITH STORAGE
 - DL 10 PSF ATTICS W/O STORAGE
 - FLOORS:
 - LL 40 PSF TOP CHORD
 - LL 0 PSF BOTTOM CHORD
 - DL 10 PSF TOP CHORD
 - DL 5 PSF BOTTOM CHORD
- NUMBER OF STORIES: 1
- TYPE OF CONSTRUCTION: TYPE V-6, UNPROTECTED, UNSPRINKLERED
- WIND ZONE INFORMATION
- BUILDING: ENCLOSED STRUCTURE
- ULTIMATE DESIGN WIND SPEED: 130 MPH
- NOMINAL DESIGN WIND SPEED: 110 MPH
- BUILDING RISK CATEGORY: II
- WIND EXPOSURE CATEGORY: C
- INTERNAL PRESSURE COEFFICIENT: 0.18 Cgpi ±

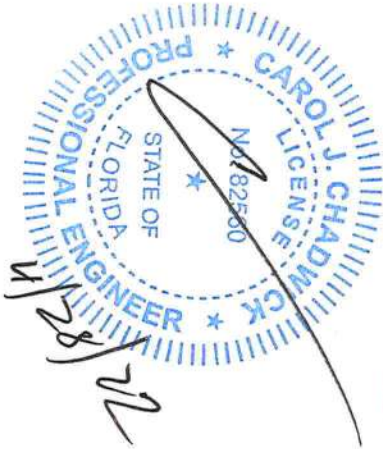

Digitally signed by
Carol Chadwick
DN: c=US,
o=Florida,
dnQualifier=A0141
0D0000017EB6D92
4CE0005954C,
cn=Carol Chadwick
Date: 2022.03.17
08:43:41 -0400

PROJECT NO.	FL22070
DATE	MAR. 16, 2022
REVISION DATE	
SHEET	S-1

TOLSTOV RESIDENCE
FLOOR PLAN
163 SW CROCKET WAY, LAKE CITY, FL

PREPARED FOR
SEVA & JULIA TOLSTOV
305.965.2914
786.985.9872
sevamiami@hotmail.com
juliastolstov@gmail.com

DATE	REVISION DESCRIPTION



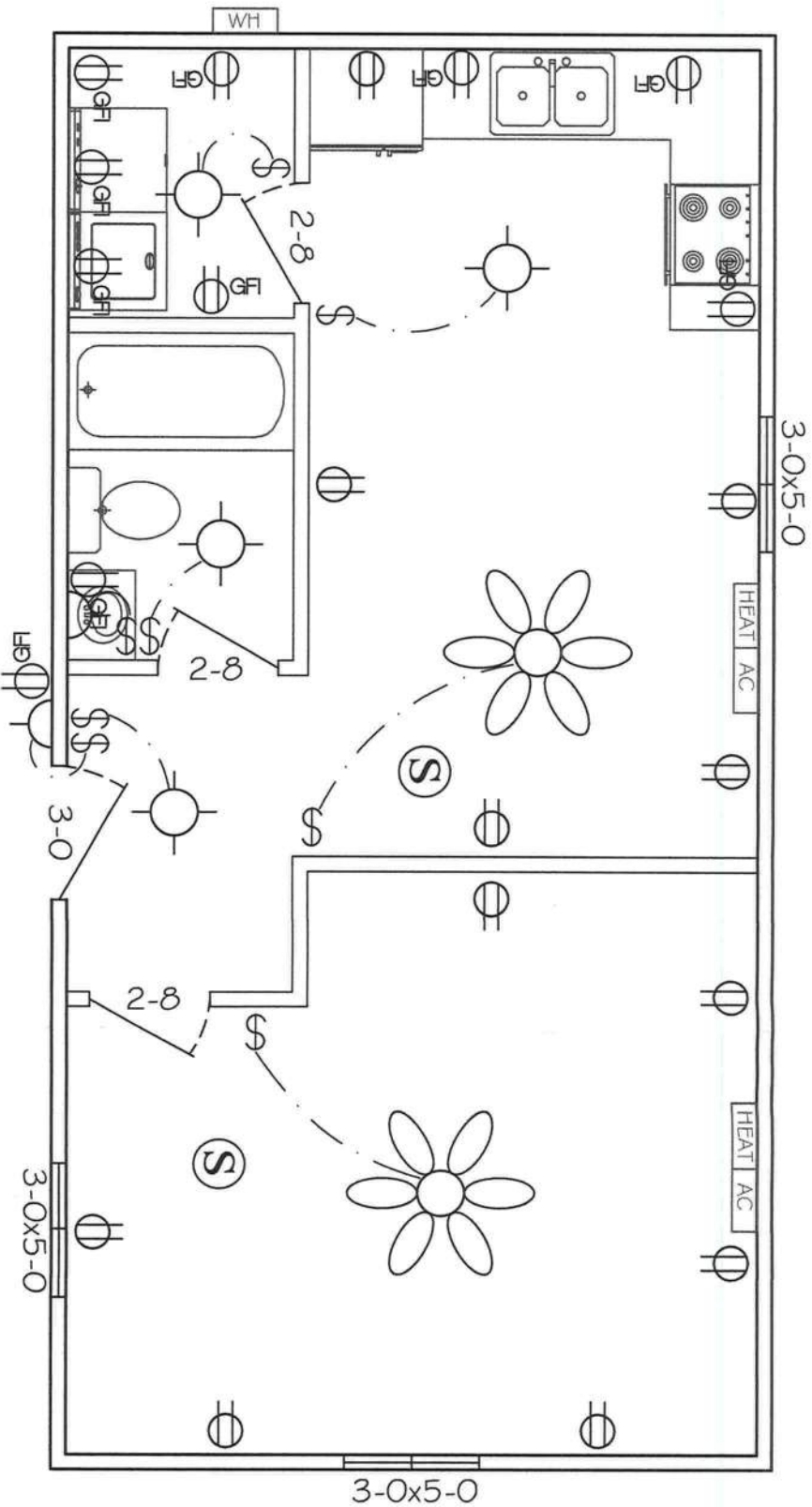

ELECTRIC PLAN
SCALE: 1/4" = 1'

- LEGEND
- DUPLEX WALL RECEPTACLE
 - GFI DUPLEX WALL RECEPTACLE
 - SPST WALL SWITCH
 - LIGHT
 - PENDENT LIGHT
 - UNDER-CABINET LIGHT
 - 120V SMOKE DETECTOR
 - CEILING FAN

- ALL ELECTRICAL TO BE INSTALLED CURRENT NEC CODE.
1. PROVIDE INTERIOR SWITCH AND EXTERIOR LIGHT IN THE VICINITY OF DOORS.
 2. PROVIDE RECEPTACLE OUTLET 6' FROM OPENING, END OF WALL AND 6' ON CENTER AT AIR CONDENSER UNIT AND NEAR GARAGE DOOR OPENING.
 3. PROVIDE AN OUTSIDE GFI WATER PROTECTED RECEPTACLE OUTLET NEAR EXCESS DOORS.
 4. BATHROOM OUTLETS TO BE GFCI WITH A SEPARATE 20 AMP CIRCUIT.
 5. PROVIDE SMOKE DETECTOR AS BY BIDS CODE IN THE BEDROOMS AND HALLWAYS WITHIN 10 FEET OF EACH ROOM.
 6. ALL BRANCH CIRCUITS THAT SUPPLY 120V, 1 SINGLE PHASE IS AND 30 AMPERE ARECUT CIRCUIT INTERRUPTER LISTED TO PROVIDE PROTECTION OF THE ENTIRE BRANCH CIRCUIT.
 7. LIGHT FIXTURE IN CLOSET SHALL BE SURFACE-MOUNTED INCANDESCENT FIXTURE WITH COMPLETELY ENCLOSED LAMP ON THE WALL ABOVE DOOR OR ON CEILING WITH MIN 12" CLEAR TO STORAGE AREA.
 8. FLUORESCENT GENERAL LIGHTING 8' REQUIRED IN BATHROOM AND KITCHEN.
 9. LIGHT FIXTURES IN TUB OR SHOWER ENCLOSURES MUST HAVE LABEL.
 10. RECESSED CEILING FIXTURES MUST BE IC RATED.
 11. ALL RECEPTACLES AT KITCHEN COUNTER SHALL BE GFCI.
 12. PROVIDE TWO MINIMUM SEPARATE 20-AMP CIRCUITS TO KITCHEN APPLIANCES.
 13. EACH SEPARATE KITCHEN COUNTER SPACE 12" OR WIDER SHALL HAVE A RECEPTACLE OUTLET.
 14. KITCHEN RECEPTACLE OUTLET SHALL BE INSTALLED 60" THAT NO POINT ALONG THE WALL IS MORE THAN 24" FROM A RECEPTACLE OUTLET.
 15. ISLAND AND PENINSULA COUNTER TOPS 12" OR WIDER SHALL HAVE AT LEAST ONE RECEPTACLE OUTLET FOR EACH 4' OF COUNTER TOP.
 16. NOT LESS THAN 75% OF THE LAMP IN PERMANENTLY INSTALLED LIGHTING FIXTURES SHALL BE HIGH-EFFICACY LAMPS OR NOT LESS THAN 75% OF THE PERMANENTLY INSTALLED LIGHTING FIXTURES SHALL CONTAIN ONLY HIGH-EFFICACY LAMPS.
 17. ALL CIRCUITS IN GARAGE AREA TO BE GFI RATED 25 VOLT SINGLE PHASE 30 AMPERE.

Professional Engineer Seal for Carol J. Chadwick, State of Florida, License No. 82560. The seal is circular with the text "CAROL J. CHADWICK", "FLORIDA", "PROFESSIONAL ENGINEER", and "LICENSE No. 82560". A signature is written over the seal.

Digitally signed by Carol Chadwick
DN: c=US,
o=Florida,
dnQualifier=A0141
0D0000017B609
24CE0005954C,
cn=Carol
Chadwick
Date: 2022.03.17
08:44:22 -0400

PROJECT NO. FL22070	TOLSTOV RESIDENCE ELECTRIC PLAN 163 SW CROCKET WAY, LAKE CITY, FL	PREPARED FOR SEVA & JULIA TOLSTOV 305.965.2914 786.985.9872 sevamiami@hotmail.com juliastolstov@gmail.com	DATE	REVISION DESCRIPTION		
DATE MAR. 16, 2022						
REVISION DATE						
SHEET 5-3						

