



STATE OF FLORIDA  
DEPARTMENT OF HEALTH  
ONSITE SEWAGE TREATMENT AND DISPOSAL  
SYSTEM

APPLICATION FOR CONSTRUCTION PERMIT

CR # 10-7563

PERMIT NO. 20-0412  
DATE PAID: 5/24/20  
FEE PAID: 370.00  
RECEIPT #: 1507239

APPLICATION FOR:

☒ New System ☐ Existing System ☐ Holding Tank ☐ Innovative  
☐ Repair ☐ Abandonment ☐ Temporary ☐

APPLICANT: WILLARD BAUGHN

AGENT: WOODMAN PARK CONSTRUCTION

TELEPHONE: (386) 755-2411

MAILING ADDRESS: PO BOX 1755

LAKE CITY

FL 32056

TO BE COMPLETED BY APPLICANT OR APPLICANT'S AUTHORIZED AGENT. SYSTEMS MUST BE CONSTRUCTED BY A PERSON LICENSED PURSUANT TO 489.105(3)(m) OR 489.552, FLORIDA STATUTES. IT IS THE APPLICANT'S RESPONSIBILITY TO PROVIDE DOCUMENTATION OF THE DATE THE LOT WAS CREATED OR PLATTED (MM/DD/YY) IF REQUESTING CONSIDERATION OF STATUTORY GRANDFATHER PROVISIONS.

PROPERTY INFORMATION

LOT: 15 BLOCK: 5 SUBDIVISION: WILSON SPRINGS PH 1 PLATTED: \_\_\_\_\_

PROPERTY ID #: 06-7S-16-04149-515 ZONING: RES I/M OR EQUIVALENT: ☐ NO ☐

PROPERTY SIZE: 1.620 ACRES WATER SUPPLY: ☒ PRIVATE PUBLIC ☐ <=2000GPD ☐ >2000GPD

IS SEWER AVAILABLE AS PER 381.0065, FS? ☐ NO ☐ DISTANCE TO SEWER: N/A FT

PROPERTY ADDRESS: 419 MEMORIAL DR. FT. WHITE

DIRECTIONS TO PROPERTY: SR 47 SOUTH TO FT. WHITE, TURN RIGHT ON WILSON SPRINGS RD. TURN LEFT AT POPE'S STORE GO THRU S CURVE SITE ON RIGHT.

BUILDING INFORMATION ☒ RESIDENTIAL ☐ COMMERCIAL

Unit No.	Type of Establishment	No. of Bedrooms	Building Area Sqft	Commercial/Institutional System Design Table 1, Chapter 64E-6, FAC
1	<u>HOUSE</u>	<u>2</u>	<u>1,144</u>	
2				
3				
4				

☐ Floor/Equipment Drains ☐ Other (Specify) \_\_\_\_\_

SIGNATURE: [Signature] DATE: 5-28-20

**Application for Onsite Sewage Disposal System  
Construction Permit. Part II Site Plan**  
Permit Application Number: 20-0472

**ALL CHANGES MUST BE APPROVED BY THE COUNTY HEALTH UNIT**

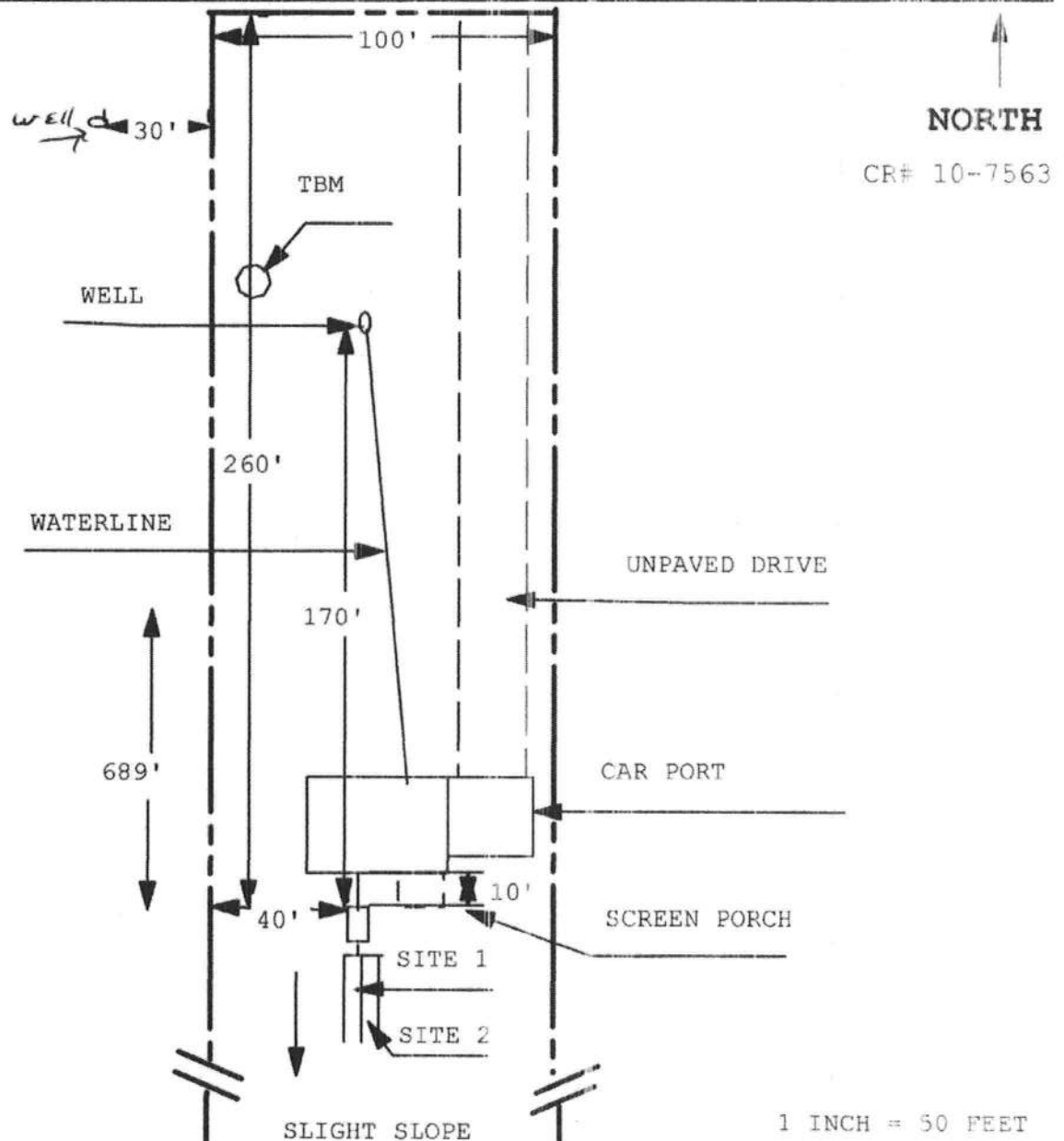

Site Plan Submitted By Pamela R. Ray Date 4/1/20  
Plan Approved [Signature] Not Approved [Signature] Date 6/1/20  
By [Signature] Columbia CPHU

Notes: \_\_\_\_\_