

## Florida Product Approval Codes

### Roll-Up Doors:

8Wide Janus International Corporation Model 750: 21450.12 EXP 12/31/2022

### Walk-In Door:

Elixir Door & Metal Company blank (no window): 17996.5 EXP 08/26/2025

### Window:

Kinro 993.8 EXP 10/19/2026

### Roof Deck:

Capital Metal Supply Inc. Ag Panel: 20147.2 EXP 03/04/2025

### Wall Panel:

Capital Metal Supply Inc. Ag Panel: 20148.2 EXP 03/04/2025

If you have any questions on concern, please contact Donald Little at 386-961-0006 or at tubularbuildingsystems@gmail.com.



12/31/2022

Outside measurement of foundation  
Equals Basic Building Dimension  
plus Seven (7) inches

40'7"

Outside edge of foundation / footing

40'  
Basic Building  
Dimension  
to outside of Base Rail

BUILDING SLAB

14'  
Basic Building  
Dimension  
to outside of Base Rail

See Corner  
Detail Sheet 3

Building  
Base Rail

3-1/2" wide x 1-1/2" high Notch  
in Concrete outside  
of basic building  
dimensions

Outside measurement of foundation  
Equals Basic Building Dimension  
plus Seven (7) inches

14'7"

## IMPORTANT - NOTES

Record Measurements  
in these spaces provided

All basic building dimensions  
are to the outside of the  
frame Base Rail and DO NOT  
INCLUDE the 3-1/2" x 1-1/2"  
notch in the concrete footing

See Sheet 3 of 3  
for Detail of Building  
corner configuration

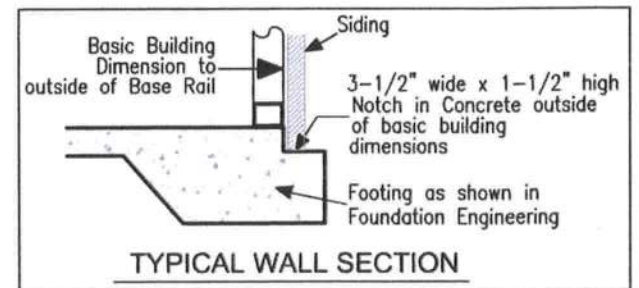

# TYPICAL BUILDING FOUNDATION MEASUREMENTS

*SHEET 1 of 3*

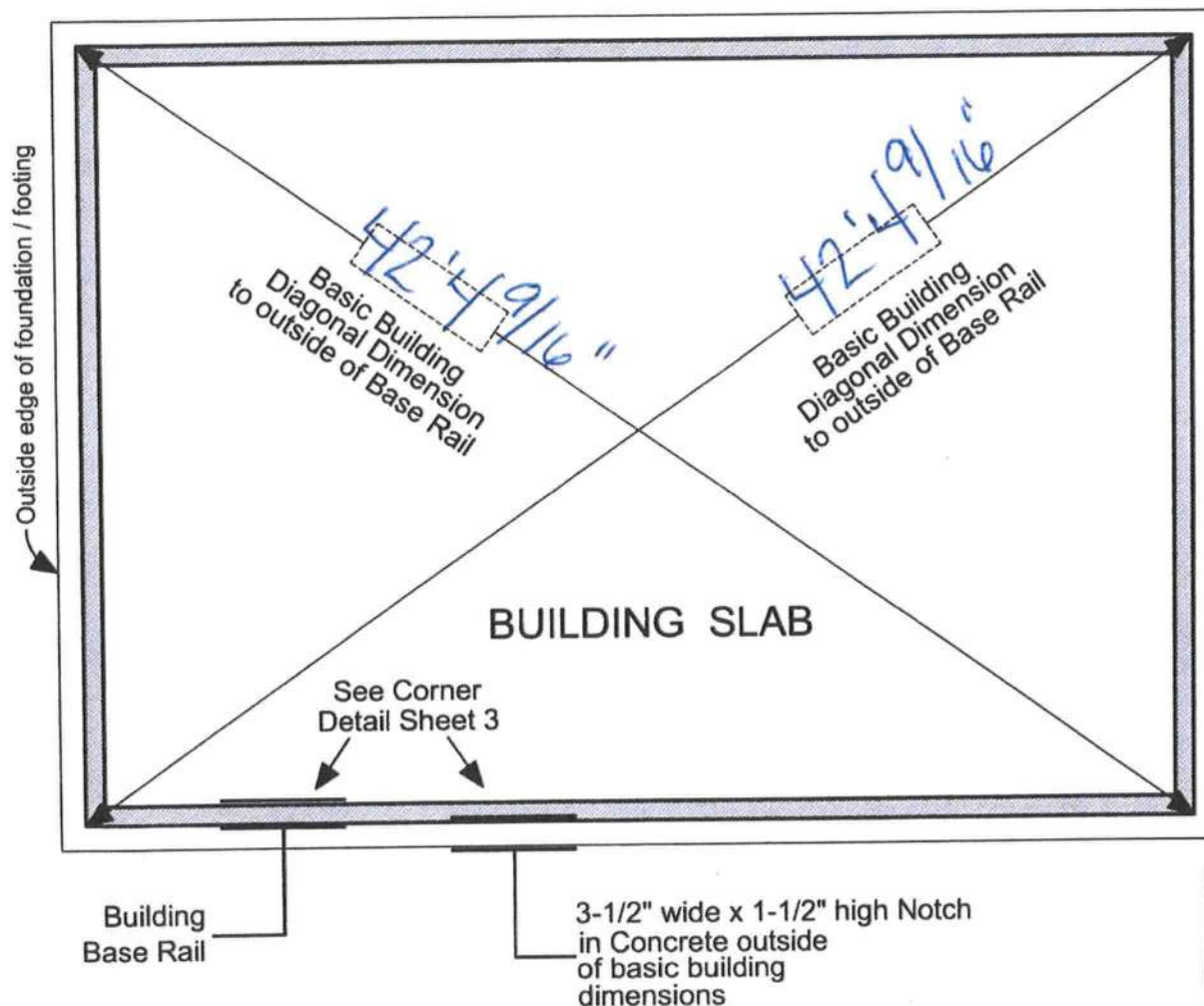

## IMPORTANT - NOTES

Record Measurements in these spaces provided

All basic building diagonal dimensions are to the outside corner of the frame Base Rail and DO NOT INCLUDE the 3-1/2" x 1-1/2" notch in the concrete footing

See Sheet 3 of 3 for Detail of Building corner configuration

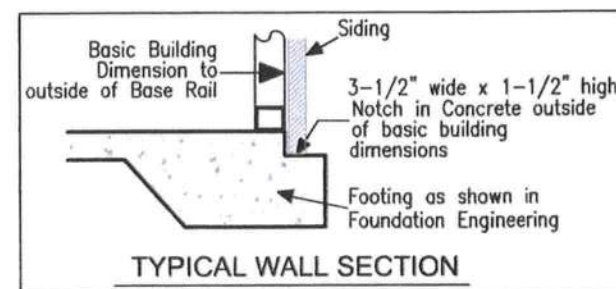

# TYPICAL BUILDING FOUNDATION MEASUREMENTS DIAGONALS

*SHEET 2 of 3*

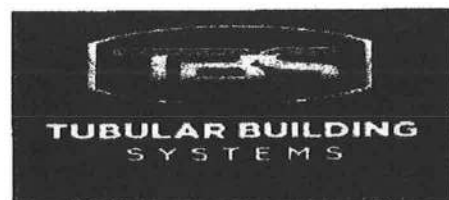
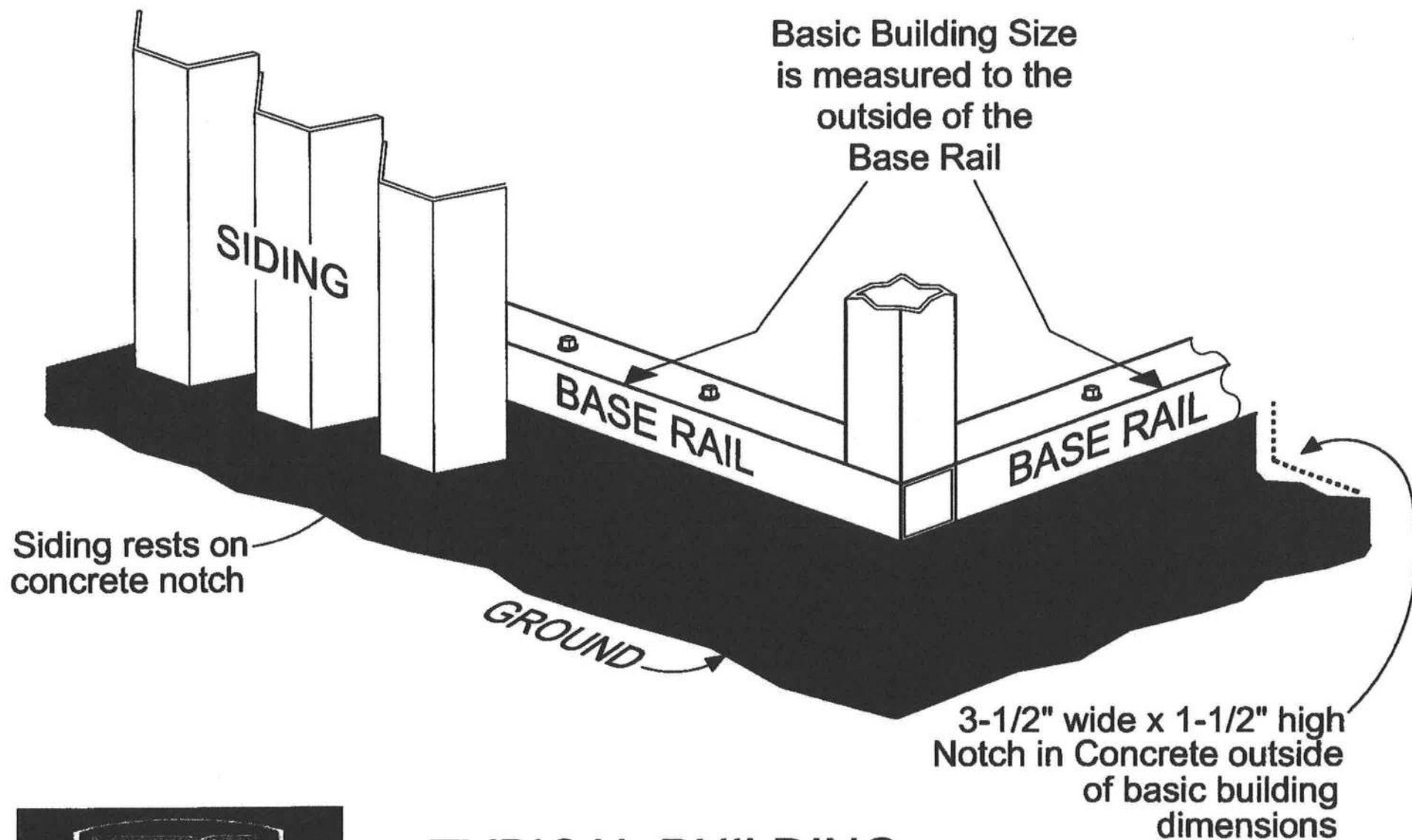

## TYPICAL BUILDING CORNER DETAIL