

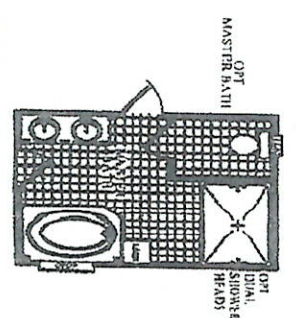

Gary Strickland

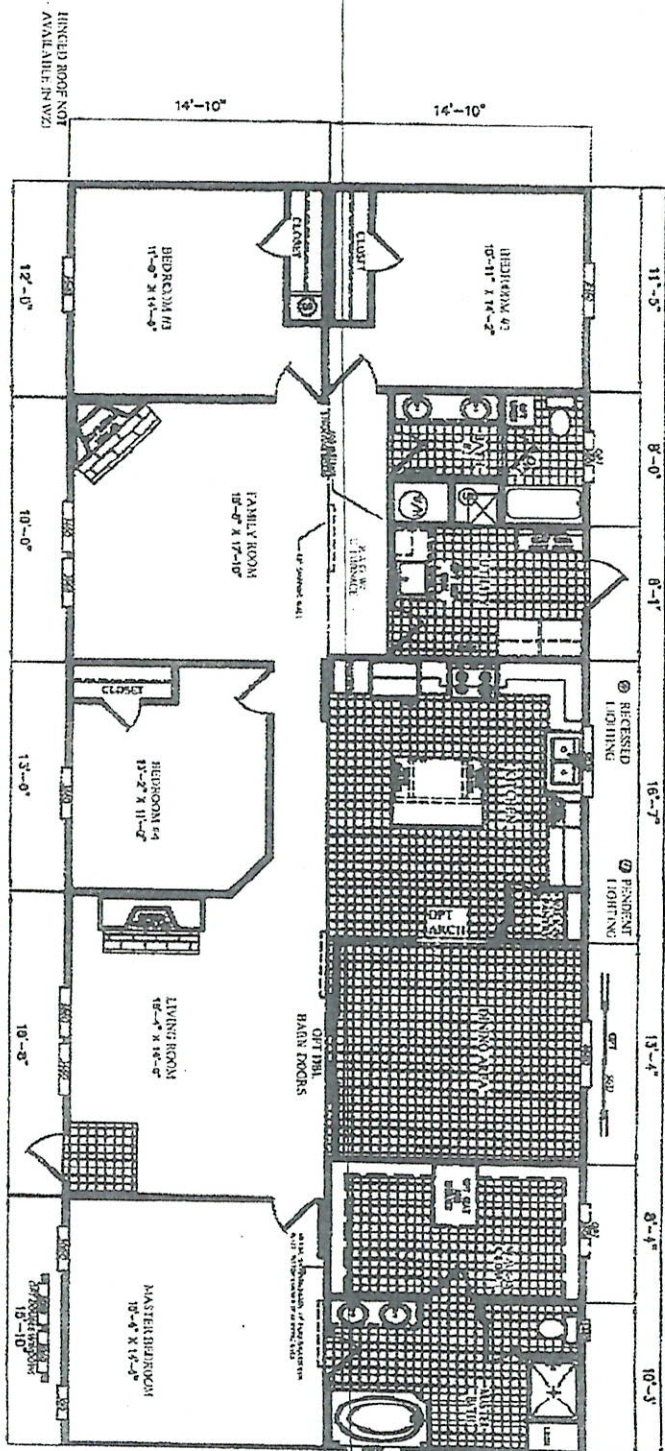

HITCH-END



• HINGED ROOF NOT AVAILABLE IN WZ3

DATE:	07/21/2016
REVISED:	E 08/09/2016
REFERENCE:	M241
AREA	
TOTAL:	2265 ft ²
LIVING SPACE:	2265 ft ²
PORCH:	0 ft ²
UNIT SPECIFICATIONS:	
FREEDOM 32' X 80' 4 BEDROOM / 2 BATH	
DRAWING/MODEL NUMBER:	
3276241FDM	
	

Pier	Per Foot (lbs)	Required Footing Area (sq. ft.) for soil pressure specified				
		1600 PSF	1500 PSF	2000 PSF	2500 PSF	3000 PSF
A	1336	262	169	125	99	82
B	5342	903	581	428	339	281
C	7568	1250	810	597	473	391
D	6578	1117	718	529	419	347
E	3116	547	352	259	205	170
F	1781	333	215	158	125	104
G	1781	333	215	158	125	104

* NOTES:

- TYPICAL PIER PAD SIZES AT THE STEEL BEAMS ARE BASED ON 1500 PSF SOIL BEARING CAPACITY.
- SEE INSTALLATION MANUAL FOR ALTERNATE PAD SIZES OR PIER SPACINGS.
- USE TABLE TO DETERMINE PAD SIZES FOR MATING LINE FOOTINGS.

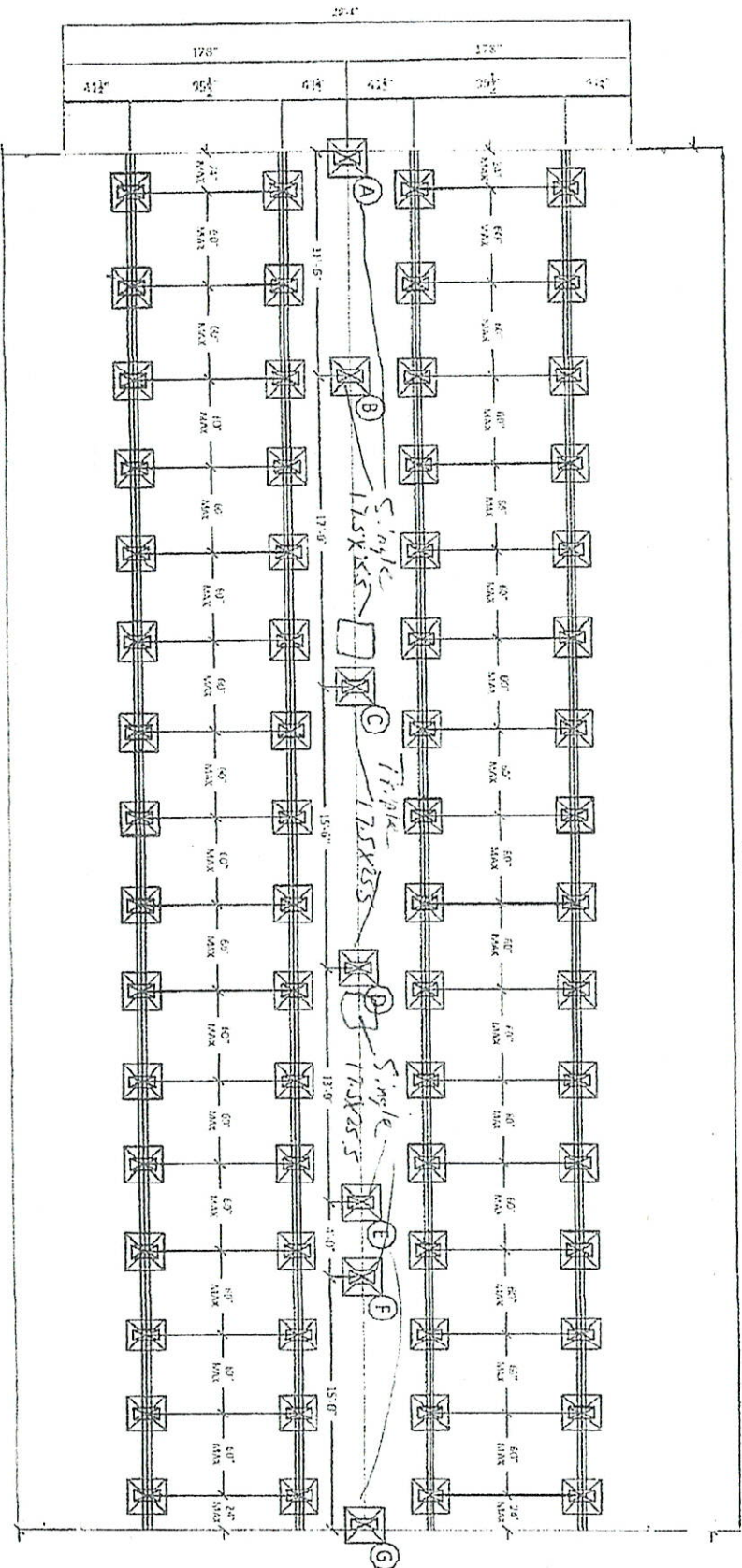

76-0

Scotbilt

HEAVY DUTY

2885 FORT OLD ROAD
WADSWORTH, GA 30187
PHONE 770.422.2172
FAX 770.422.2172
WWW.SCOTBIT.COM

MULTIPIER PIERING DIAGRAM
NOTE: BEAM SPACING NOT TO EXCEED 17'-0"
DRAWN BY: M. J. JONES

DATE: 09/05/2017
VERSION: A
DRAWN BY: 09/09/2017

SERIAL NUMBER:
SCALE: NTS
DRAWN BY: TH

DRAWING MODEL NUMBER:
3276241FDM-P60

PERMIT NUMBER

PERMIT WORKSHEET

page 2 of 2

POCKET PENETROMETER TEST

The pocket penetrometer tests are rounded down to or check here to declare 1000 lb. soil without testing.

x 1000 x 1000 x 1000

POCKET PENETROMETER TESTING METHOD

1. Test the perimeter of the home at 6 locations.
2. Take the reading at the depth of the footer.
3. Using 500 lb. increments, take the lowest reading and round down to that increment.

x 1000 x 1000 x 1000

TORQUE PROBE TEST

The results of the torque probe test is _____ inch pounds or check here if you are declaring 5' anchors without testing _____. A test showing 275 inch pounds or less will require 5 foot anchors.

Note: A state approved lateral arm system is being used and 4 ft. anchors are allowed at the sidewall locations. I understand 5 ft. anchors are required at all centerline tie points where the torque test reading is 275 or less and where the mobile home manufacturer may require anchors with 4000 lb. holding capacity.

Installer's initials

ALL TESTS MUST BE PERFORMED BY A LICENSED INSTALLER

Installer Name

Date Tested

Electrical

Connect electrical conductors between multi-wide units, but not to the main power source. This includes the bonding wire between multi-wide units. Pg. _____

Plumbing

Connect all sewer drains to an existing sewer tap or septic tank. Pg. _____

Connect all potable water supply piping to an existing water meter, water tap, or other independent water supply systems. Pg. _____

Site Preparation

Debris and organic material removed

Water drainage: Natural

Swale

Pad

Other

Fastening multi wide units

Floor: Type Fastener: 1/4 x 5 Length: 7 Spacing: 20
Walls: Type Fastener: 1/4 x 5 Length: 4 Spacing: 20
Roof: Type Fastener: 1/4 x 5 Length: 7 Spacing: 20

For used homes a min. 30 gauge, 8" wide, galvanized metal strip will be centered over the peak of the roof and fastened with galv. roofing nails at 2" on center on both sides of the centerline.

Gasket (weatherproofing requirement)

I understand a properly installed gasket is a requirement of all new and used homes and that condensation, mold, mildew and buckled marriage walls are a result of a poorly installed or no gasket being installed. I understand a strip of tape will not serve as a gasket.

Installer's initials

Type gasket

P11

Installed:

Between Floors Yes

Between Walls Yes

Bottom of ridgebeam Yes

Weatherproofing

The bottomboard will be repaired and/or taped. Yes _____ Pg. _____
Siding on units is installed to manufacturer's specifications. Yes _____
Fireplace chimney installed so as not to allow intrusion of rain water. Yes _____

Miscellaneous

Skirting to be installed Yes _____ No _____

Dryer vent installed outside of skirting. Yes _____ N/A _____

Range downflow vent installed outside of skirting. Yes _____ N/A _____

Drain lines supported at 4 foot intervals. Yes _____

Electrical crossovers protected. Yes _____

Other: _____

Installer verifies all information given with this permit worksheet is accurate and true based on the manufacturer's installation instructions and or Rule 15C-1 & 2

Installer Signature

Ernest S. Johnson

Date

PERMIT WORKSHEET

page 1 of 2

PERMIT NUMBER

Installer Ernest S Johnson License # TH1025249

Address of home being installed _____

Manufacturer Scott Bilt Length x width 76 x 32

NOTE: if home is a single wide fill out one half of the blocking plan if home is a triple or quad wide sketch in remainder of home

I understand Lateral Arm Systems cannot be used on any home (new or used) where the sidewall ties exceed 5 ft 4 in.

Installer's initials [Signature]

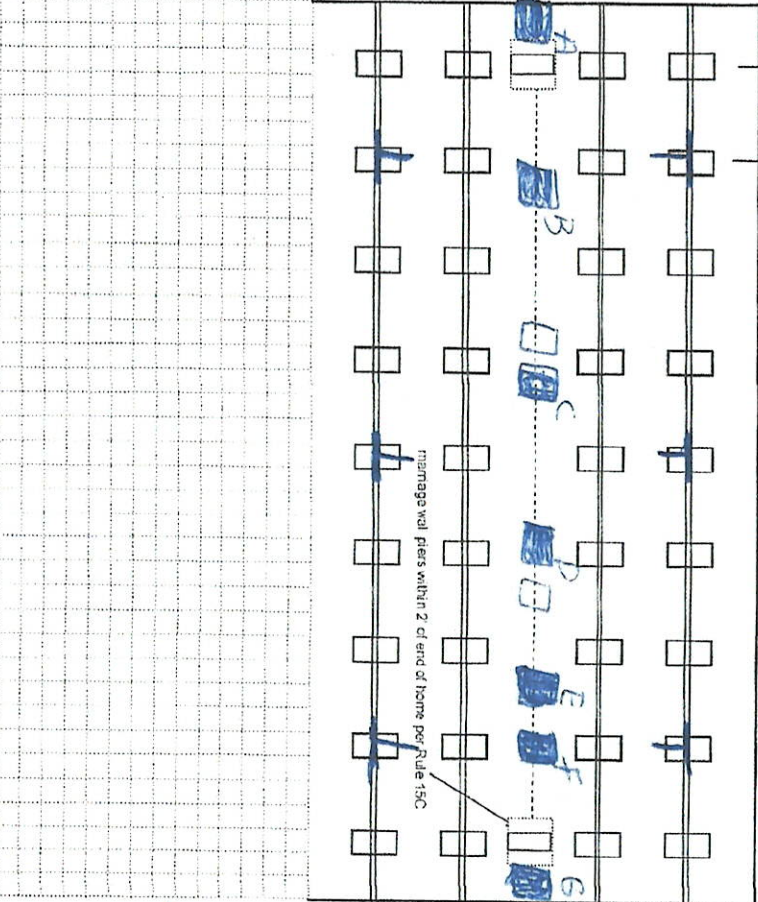

New Home ☒ Used Home ☐

Home installed to the Manufacturer's Installation Manual

Home is installed in accordance with Rule 15-C

Single wide ☐ Wind Zone II ☒ Wind Zone III ☐

Double wide ☒ Installation Decal # 71891

Triple/Quad ☐ Serial # SRNCA1201266DAB

Roof System: ☒ Typical ☐ Hinged

PIER SPACING TABLE FOR USED HOMES

Load bearing capacity (sq in)	16' x 16' (256)	18 1/2' x 18 (342)	20' x 20' (400)	22' x 22' (484)	24' x 24' (576)	26' x 26' (676)
1000 dsf	3'	4'	5'	6'	7'	8'
1500 dsf	4'	5'	6'	7'	8'	9'
2000 dsf	5'	6'	7'	8'	9'	10'
2500 dsf	6'	7'	8'	9'	10'	11'
3000 dsf	7'	8'	9'	10'	11'	12'
3500 dsf	8'	9'	10'	11'	12'	13'

* Interpolated from Rule 15C-1 pier spacing table.

PIER PAD SIZES

I-beam pier pad size 23X31 1/2
Perimeter pier pad size 21 1/2 X 25 1/2
Other pier pad sizes (required by the mfg.) _____

Draw the approximate locations of marriage wall openings 4 foot or greater. Use this symbol to show the piers.

List all marriage wall openings greater than 4 foot and their pier pad sizes below.

POPULAR PAD SIZES

Pad Size	Sq In
16 x 16	256
16 x 18	288
18.5 x 18.5	342
16 x 22.5	360
17 x 22	374
13 1/4 x 26 1/4	348
20 x 20	400
17 3/16 x 25 3/16	441
17 1/2 x 25 1/2	446
24 x 24	576
26 x 26	676

ANCHORS

4 ft ☒ 5 ft ☒

FRAME TIES

within 2' of end of home spaced at 5' 4" oc ☒

OTHER TIES

Number 30
Sidewall 10
Longitudinal 10
Marriage wall 10
Shearwall 10

TIEDOWN COMPONENTS

Opening 71.5 X 25.5 Pier pad size E 17.5 X 25.5
B 17.5 X 25.5
C 17.5 X 25.5 F 17.5 X 25.5
D 17.5 X 25.5 G 17.5 X 25.5
S 17.5 X 25.5

Oliver 1101 V