

## GENERAL NOTES

- BUILDING MUST COMPLY WITH ALL FEDERAL, STATE, LOCAL, FIRE, ADA, AND HEALTH DEPARTMENT CODES.
- WALLS: FINISHED GYPSUM BD WITH ALL JOINTS TAPED, MUDD, SANDED, AND PAINTED. SEE ROOM FINISH SCHEDULE ON SHEET A3 FOR MORE INFORMATION.
- PROVIDE DOUBLE STUDS AND BLOCKING TO SUPPORT EQUIPMENT AND/OR MISCELLANEOUS ITEMS WHERE INSTALLED. I.E. TYPICAL CASEWORK, TOILET PAPER HOLDERS, GRAB BARS, ETC.
- CAULK AND SEAL EXTERIOR JOINT BETWEEN ALL UNLIKE MATERIALS.
- TRIM - DOORS, DOOR FRAMES, COLUMNS, PAINTED TO MATCH ADJ. WALLS.
- DOORS: ALL EXTERIOR DOORS SHALL HAVE WEATHER STRIPPING AND SNUG SEAL AROUND DOOR. ALL EXTERIOR DOORS WILL HAVE CYLINDER REPLACED BY DOLLAR GENERAL AREA MANAGER WITH INSTAKEY SYSTEM.
- CONTRACTOR SHALL LEAVE A COMPLETE SET OF AS-BUILT PLANS LOCATED IN A 4" PVC PIPE, 36" LONG MOUNTED HORIZONTALLY OVER THE DOOR INSIDE THE MANAGER'S OFFICE AT THE END OF THE PROJECT.
- CONTRACTOR SHALL VERIFY ALL DIMENSIONS AND COORDINATE ALL TRADES.
- CONTRACTOR SHALL VERIFY ALL EQUIPMENT LOCATIONS AND DIMENSIONS OF EQUIPMENT. ANY EQUIPMENT FURNISHED BY THE OWNER OR TENANT SHALL BE RECEIVED, STORED, AND INSTALLED BY THE CONTRACTOR. CONTRACTOR SHALL COORDINATE WITH OWNER FOR INSTALLATION.
- IF DIMENSIONS ARE IN QUESTION - THE CONTRACTOR SHALL BE RESPONSIBLE FOR OBTAINING CLARIFICATION FROM ARCHITECT AND/OR DOLLAR GENERAL STORE DESIGN DEPARTMENT BEFORE CONTINUING WITH CONSTRUCTION.
- MAINTAIN A CLEAN AND NEAT WORK SITE ON A DAILY BASIS.
- THESE DRAWINGS ARE NOT TO BE SCALED.
- IT IS THE RESPONSIBILITY OF THE GENERAL CONTRACTOR TO FIELD VERIFY EXISTING CONDITIONS AND DIMENSIONS PRIOR TO STARTING CONSTRUCTION.
- THE GENERAL CONTRACTOR IS RESPONSIBLE FOR ALL COORDINATION BETWEEN SUBCONTRACTORS BASED ON THE ENTIRE SET OF DOCUMENTS. IN CASE OF INCONSISTENCIES OR DISCREPANCIES BETWEEN DRAWINGS, THE MOST STRINGENT NOTE OR CONDITION SHALL APPLY, AND THE CONTRACTOR SHALL NOTIFY THE ARCHITECT IMMEDIATELY OF SUCH DISCREPANCIES.
- DOOR LOCATIONS NOT DIMENSIONED ARE 4" TO THE FRAME FROM A CORNER OR CENTERED IN THE WALL.
- INTERIOR DIMENSIONS ARE FROM FACE OF GYP BD. TO FACE OF GYP. BD. UNLESS NOTED OTHERWISE.
- CORNER GUARDS SHALL BE INSTALLED AS INDICATED AND AS REQUESTED BY DOLLAR GENERAL.
- ALL MATERIALS AND CONSTRUCTION SHALL CONFORM TO THE REQUIREMENTS OF ALL APPLICABLE BUILDINGS, ELECTRICAL, MECHANICAL, PLUMBING, FIRE PROTECTION.
- IF DISCREPANCIES OR CONFLICTS ARE FOUND BETWEEN THE PLANS AND ACTUAL BUILDING CONDITIONS, THE CONTRACTOR SHALL NOTIFY THE ARCHITECT IMMEDIATELY PRIOR TO PROCEEDING.
- CONTRACTOR RESPONSIBLE FOR PROVIDING BLOCKING IN WALLS AT MILLWORK, CABINETRY & FIXTURE LOCATIONS. COORDINATE BLOCKING REQUIREMENT WITH DOLLAR GENERAL.
- PORTABLE FIRE EXTINGUISHERS MUST BE PROVIDED PER NFPA STANDARD NO. 10 AND THE 2004 IFC SECTION 906.
- PER THE IBC 501.2 THE STREET ADDRESS FOR THE STRUCTURE MUST BE VISIBLE FROM THE ROAD. NUMBER MUST BE A MIN. OF 4 INCH IN HEIGHT (6 INCHES OR MORE PREFERRED) AND HAVE A MIN. STROKE WIDTH OF 1/8". THE NUMBERS MUST BE IN CONTRASTING COLOR TO THE BUILDING MATERIALS. THE ADDRESS MAY BE LOCATED ON BOTH THE BUILDING AND THE STREET FRONT SIGN FOR THE BUILDING.

## FLOOR PLAN LEGEND

- NEW WALL
- EXISTING WALL
- DOOR KEY

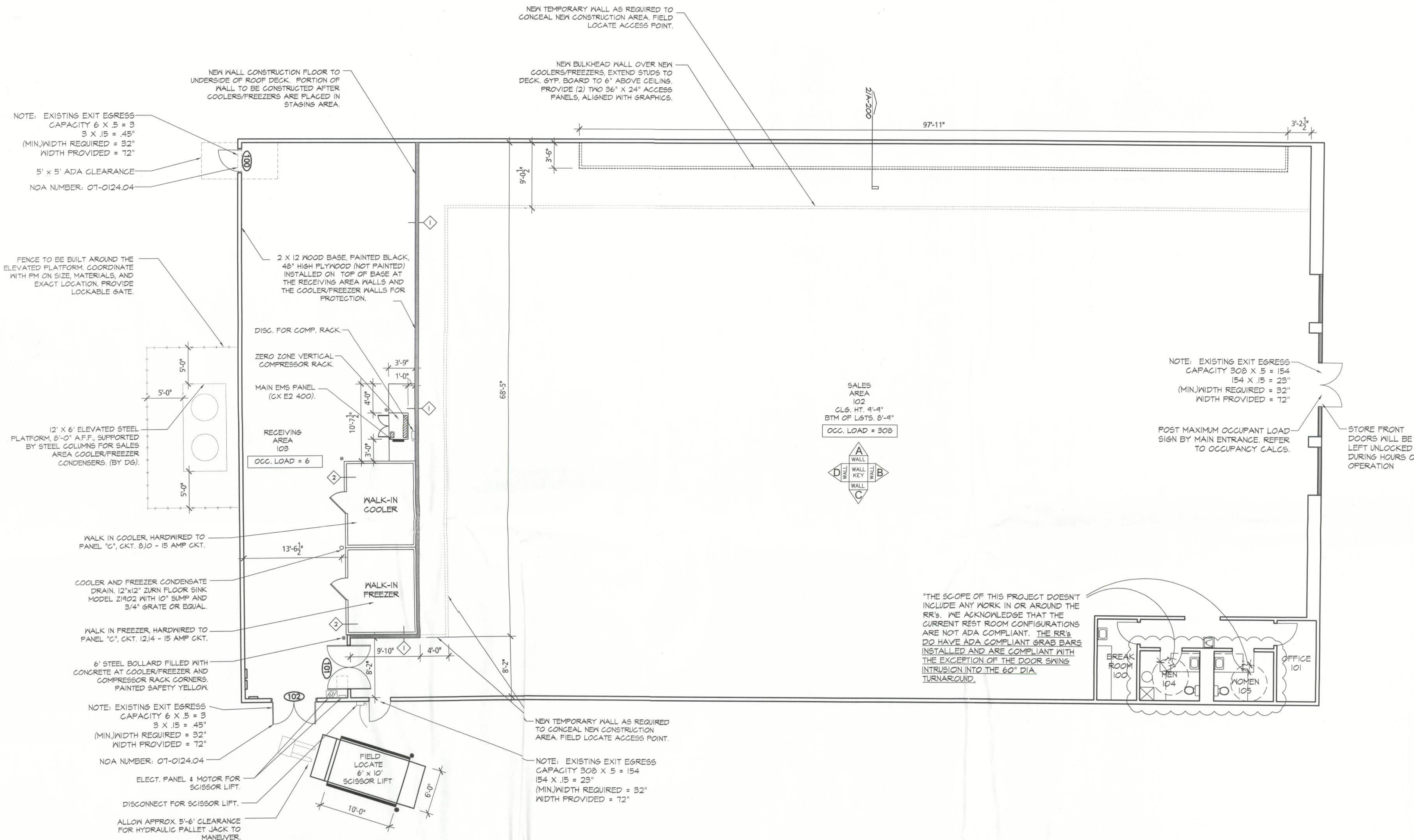

## 1 ARCHITECTURAL PLAN

SCALE: 1/8" = 1'-0"