

Brown

## Mobile Home Permit Worksheet

Installer: Ernest Scott Johnson License # 14/1025249  
 Address of home being installed TBD SW King St.  
Lake City FL  
 Manufacturer Palm Harbor Homes Length x width 30x60

**NOTE:** if home is a single wide fill out one half of the blocking plan  
 if home is a triple or quad wide sketch in remainder of home  
 I understand Lateral Arm Systems cannot be used on any home (new or used)  
 where the sidewall ties exceed 5 ft 4 in.

Installer's initials ESJ

Typical pier spacing

2' 6-6

lateral

longitudinal

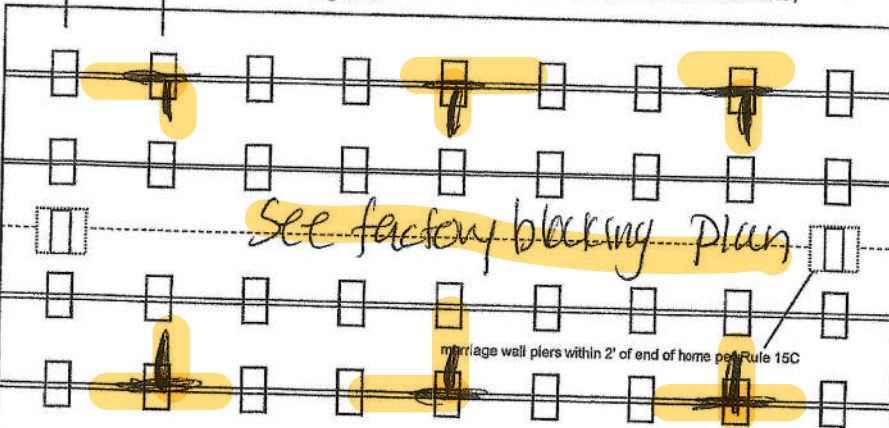
Show locations of Longitudinal and Lateral Systems  
 (use dark lines to show these locations)

Anthony Iskan  
 06-08-2023

Application Number: \_\_\_\_\_

Date: \_\_\_\_\_

New Home ☒ Used Home ☐Home installed to the Manufacturer's Installation Manual  
 Home is installed in accordance with Rule 15-CSingle wide ☐ Wind Zone II ☒ Wind Zone III ☐Double wide ☒ Installation Decal # 94274Triple/Quad ☐ Serial # PHH340FL22-23226AB

## PIER SPACING TABLE FOR USED HOMES

Load bearing capacity	Footer size (sq in)	16' x 16' (256)	18 1/2' x 18 1/2' (342)	20' x 20' (400)	22' x 22' (484)*	24' x 24' (576)*	26' x 26' (676)
1000 psf		3'	4'	5'	6'	7'	8'
1500 psf		4' 6"	6'	7'	8'	9'	10'
2000 psf		6'	8'	9'	10'	11'	12'
2500 psf		7' 6"	9'	10'	11'	12'	13'
3000 psf		8'	10'	11'	12'	13'	14'
3500 psf		8'	10'	11'	12'	13'	14'

\* interpolated from Rule 15C-1 pier spacing table.

## PIER PAD SIZES

I-beam pier pad size 23x31 6-6  
 Oliver 1055-11  
 Perimeter pier pad size or 17.5x25.5

Other pier pad sizes  
 (required by the mfg.) \_\_\_\_\_

Draw the approximate locations of marriage wall openings 4 foot or greater. Use this symbol to show the piers.

List all marriage wall openings greater than 4 foot and their pier pad sizes below.

Opening

Pier pad size

See factory blocking plan

## TIEDOWN COMPONENTS

Longitudinal Stabilizing Device (LSD)

Manufacturer

Longitudinal Stabilizing Device w/ Lateral Arms

Manufacturer

Oliver 1101V

## POPULAR PAD SIZES

Pad Size	Sq In
16 x 16	256
16 x 18	288
18.5 x 18.5	342
16 x 22.5	360
17 x 22	374
13 1/4 x 26 1/4	348
20 x 20	400
17 3/16 x 25 3/16	441
17 1/2 x 25 1/2	446
24 x 24	576
26 x 26	676

## ANCHORS

4 ft ☒ 5 ft ☒

## FRAME TIES

within 2' of end of home  
 spaced at 5' 4" oc

## OTHER TIES

Sidewall 49  
 Longitudinal 0  
 Marriage wall 8  
 Shearwall 2



# Mobile Home Permit Worksheet

## POCKET PENETROMETER TEST

The pocket penetrometer tests are rounded down to \_\_\_\_\_ psf or check here to declare 1000 lb. soil \_\_\_\_\_ without testing.

## POCKET PENETROMETER TESTING METHOD

1. Test the perimeter of the home at 6 locations.
2. Take the reading at the depth of the footer.
3. Using 500 lb. increments, take the lowest reading and round down to that increment.



## TORQUE PROBE TEST

The results of the torque probe test is \_\_\_\_\_ inch pounds or check here if you are declaring 5' anchors without testing. A test showing 275 inch pounds or less will require 5 foot anchors.

**Note:** A state approved lateral arm system is being used and 4 ft. anchors are allowed at the sidewall locations. I understand 5 ft anchors are required at all centerline tie points where the torque test reading is 275 or less and where the mobile home manufacturer may require anchors with 4000 lb holding capacity.

Installer's initials

## ALL TESTS MUST BE PERFORMED BY A LICENSED INSTALLER

Installer Name

Ernest S Johnson

Date Tested

Assumed Oliver uses 4x5' anchors

## Electrical

Connect electrical conductors between multi-wide units, but not to the main power source. This includes the bonding wire between multi-wide units. Pg. \_\_\_\_\_

## Plumbing

Connect all sewer drains to an existing sewer tap or septic tank. Pg. \_\_\_\_\_

Connect all potable water supply piping to an existing water meter, water tap, or other independent water supply systems. Pg. \_\_\_\_\_

Application Number: \_\_\_\_\_

Date: \_\_\_\_\_

## Site Preparation

Debris and organic material removed ☒ Water drainage: Natural ☐ Swale ☐ Pad ☒ Other ☐

## Fastening multi wide units

Floor: Type Fastener: lags Length: 7 Spacing: 20  
Walls: Type Fastener: lags Length: 7 Spacing: 10  
Roof: Type Fastener: lags Length: 7 Spacing: 20  
For used homes a min. 30 gauge, 8" wide, galvanized metal strip will be centered over the peak of the roof and fastened with galv. roofing nails at 2" on center on both sides of the centerline.

## Gasket (weatherproofing requirement)

I understand a properly installed gasket is a requirement of all new and used homes and that condensation, mold, mildew and buckled marriage walls are a result of a poorly installed or no gasket being installed. I understand a strip of tape will not serve as a gasket.

Installer's initials

Type gasket Pg. factory or RU

Installed:  
Between Floors Yes ☒  
Between Walls Yes ☒  
Bottom of ridgebeam Yes ☒

## Weatherproofing

The bottomboard will be repaired and/or taped. Yes ☒ Pg. \_\_\_\_\_  
Siding on units is installed to manufacturer's specifications. Yes ☒  
Fireplace chimney installed so as not to allow intrusion of rain water. Yes ☒

## Miscellaneous

Skirting to be installed. Yes ☒ No ☐  
Dryer vent installed outside of skirting. Yes ☒ N/A ☐  
Range downflow vent installed outside of skirting. Yes ☒ N/A ☐  
Drain lines supported at 4 foot intervals. Yes ☒  
Electrical crossovers protected. Yes ☒  
Other: \_\_\_\_\_

Installer verifies all information given with this permit worksheet is accurate and true based on the manufacturer's installation instructions and or Rule 15C-1 & 2

Installer Signature

Ernest S Johnson

Date





OPTIONAL EASTON  
FARMHOUSE PACKAGE  
SHOWN THROUGHOUT

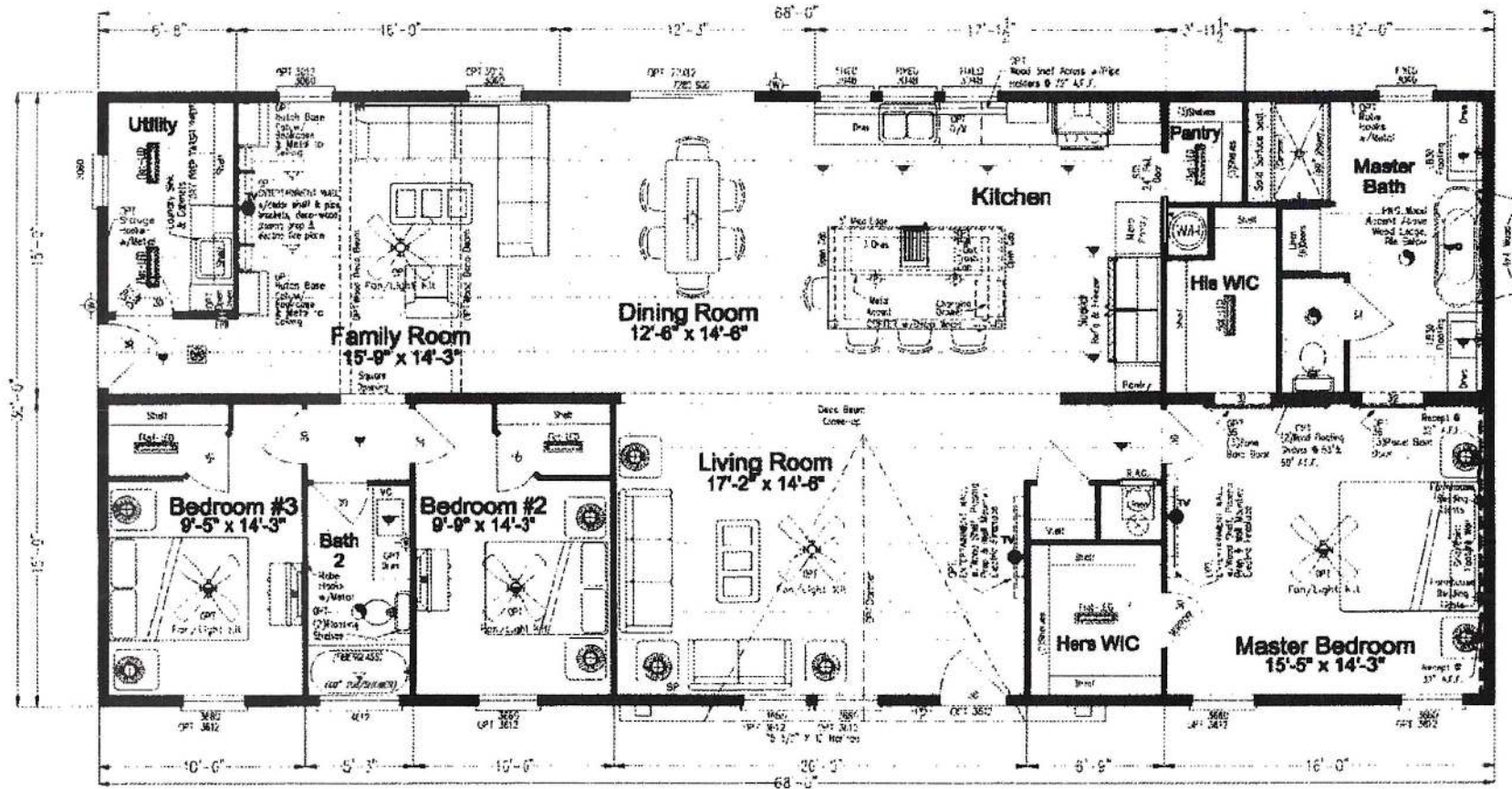
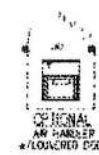
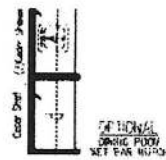

# Easton Farmhouse

Model 340LS30683A

Approx. 2,040 SQ. FT.

30" x 68"

3 Bedrooms, 2 Baths

Expansive Family Room

Walk-In Pantry in Kitchen

Large Master Suite w/

Dual Walk-In Closets,

Luxury Soaker Tub &

Shower w/ Bench Seat

Copyright © Palm Harbor Homes, Inc. Because Palm Harbor Homes has a continuous product updating and improvement process, prices, plans, dimensions, features, materials, specifications and availability are subject to change without notice or obligation. Please refer to working drawings for actual dimensions. Renderings and floor plans are artist depictions only and may vary from the completed home. Square footage calculations and room dimensions are approximate and subject to industry standards.