



STATE OF FLORIDA  
DEPARTMENT OF HEALTH  
ONSITE SEWAGE TREATMENT AND DISPOSAL  
SYSTEM

APPLICATION FOR CONSTRUCTION PERMIT

CR # 10-7851

PERMIT NO. 20-0912  
DATE PAID: 11/25/20  
FEE PAID: 370.00  
RECEIPT #: 160777

APPLICATION FOR:

☒ New System ☐ Existing System ☐ Holding Tank ☐ Innovative  
☐ Repair ☐ Abandonment ☐ Temporary ☐

APPLICANT: DERRICK & KRISTI HALL

AGENT: S & S CONSTRUCTION

TELEPHONE: (386) 234-0318

MAILING ADDRESS: 1539 CR 6E

JASPER

FL 32052

TO BE COMPLETED BY APPLICANT OR APPLICANT'S AUTHORIZED AGENT. SYSTEMS MUST BE CONSTRUCTED BY A PERSON LICENSED PURSUANT TO 489.105(3)(m) OR 489.552, FLORIDA STATUTES. IT IS THE APPLICANT'S RESPONSIBILITY TO PROVIDE DOCUMENTATION OF THE DATE THE LOT WAS CREATED OR PLATTED (MM/DD/YY) IF REQUESTING CONSIDERATION OF STATUTORY GRANDFATHER PROVISIONS.

PROPERTY INFORMATION

LOT: 37 BLOCK: N/A SUBDIVISION: COBBELSTONE UNIT II PLATTED: \_\_\_\_\_

PROPERTY ID #: 24-3S-16-02275-132 ZONING: RES I/M OR EQUIVALENT: ☐ NO ☐

PROPERTY SIZE: 2.060 ACRES WATER SUPPLY: ☒ PRIVATE PUBLIC ☐  $\leq 2000$  GPD ☐  $> 2000$  GPD

IS SEWER AVAILABLE AS PER 381.0065, FS? ☐ NO ☐ DISTANCE TO SEWER: N/A FT

PROPERTY ADDRESS: NW AMBLESIDE DR. LAKE CITY

DIRECTIONS TO PROPERTY: 90 WEST, TURN RIGHT ON LAKE JEFFERY RD. TURN LEFT ON NE BRIDGEWATER TRACE. TURN LEFT ON AMBLESIDE DR. LOT ON RIGHT JUST PAST NW AMBER CT.

BUILDING INFORMATION ☒ RESIDENTIAL ☐ COMMERCIAL

Unit No.	Type of Establishment	No. of Bedrooms	Building Area Sqft	Commercial/Institutional System Design Table 1, Chapter 64E-6, FAC
----------	-----------------------	-----------------	--------------------	--

1	HOUSE	3	2,148	
---	-------	---	-------	--

2				
---	--	--	--	--

3				
---	--	--	--	--

4				
---	--	--	--	--

☐ Floor/Equipment Drains ☐ Other (Specify) \_\_\_\_\_

SIGNATURE: [Signature] DATE: 11-19-20

DH 4015, 08/09 (Obsoletes previous editions which may not be used)  
Incorporated 64E-6.001, FAC

Page 1 of 4

47682

20-0922

NO WELLS WITHIN 100'

1 INCH = 70 FEET

NORTH

CR# 10-7851

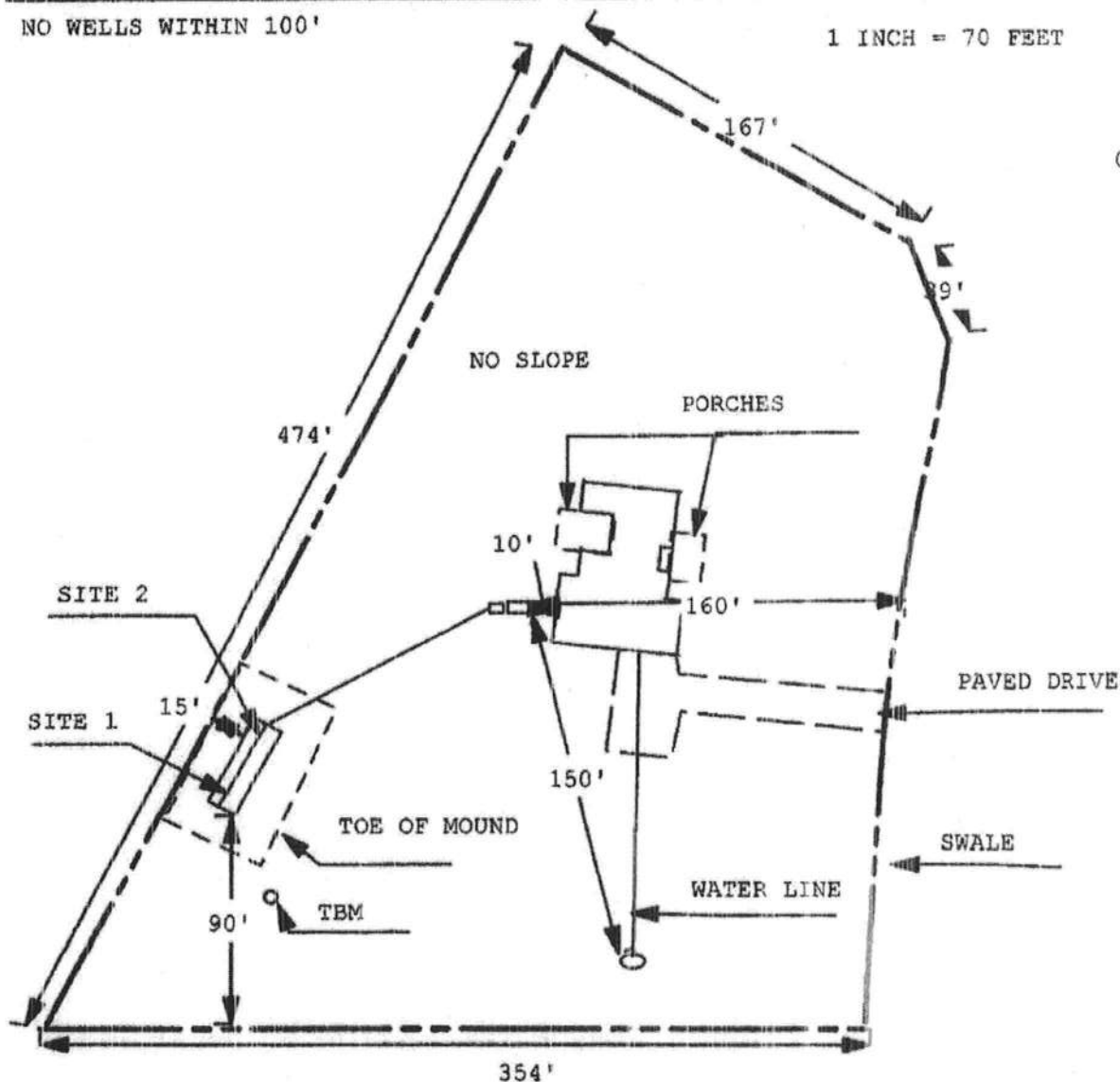

Site Plan Submitted By Paul Hays Date 11/18/20  
Plan Approved ✓ Not Approved \_\_\_\_\_ Date 11/23/20  
By Sen [Signature] 632 Columbia CPHU  
Notes: \_\_\_\_\_