

**FOUNDATION PLAN**  
SCALE: 1/4 IN. = 1 FT.

**FOUNDATION NOTES:**

- CONTRACTOR SHALL EXAMINE ROOF TRUSS PLAN (BY SUPPLIER) TO DETERMINE ANY ADDITIONAL BEARING REQUIREMENTS BEFORE FINALIZING THE FOUNDATION PLAN.
- ALL CONCRETE IS 2500 PSI STRENGTH (MIN.)
- VERIFY DIMENSIONS WITH FLOOR PLAN
- SITE ANALYSIS AND PREPARATION DATA IS NOT A PART OF THIS PLAN AND IS THE RESPONSIBILITY OF THE CONTRACTOR / OWNER.

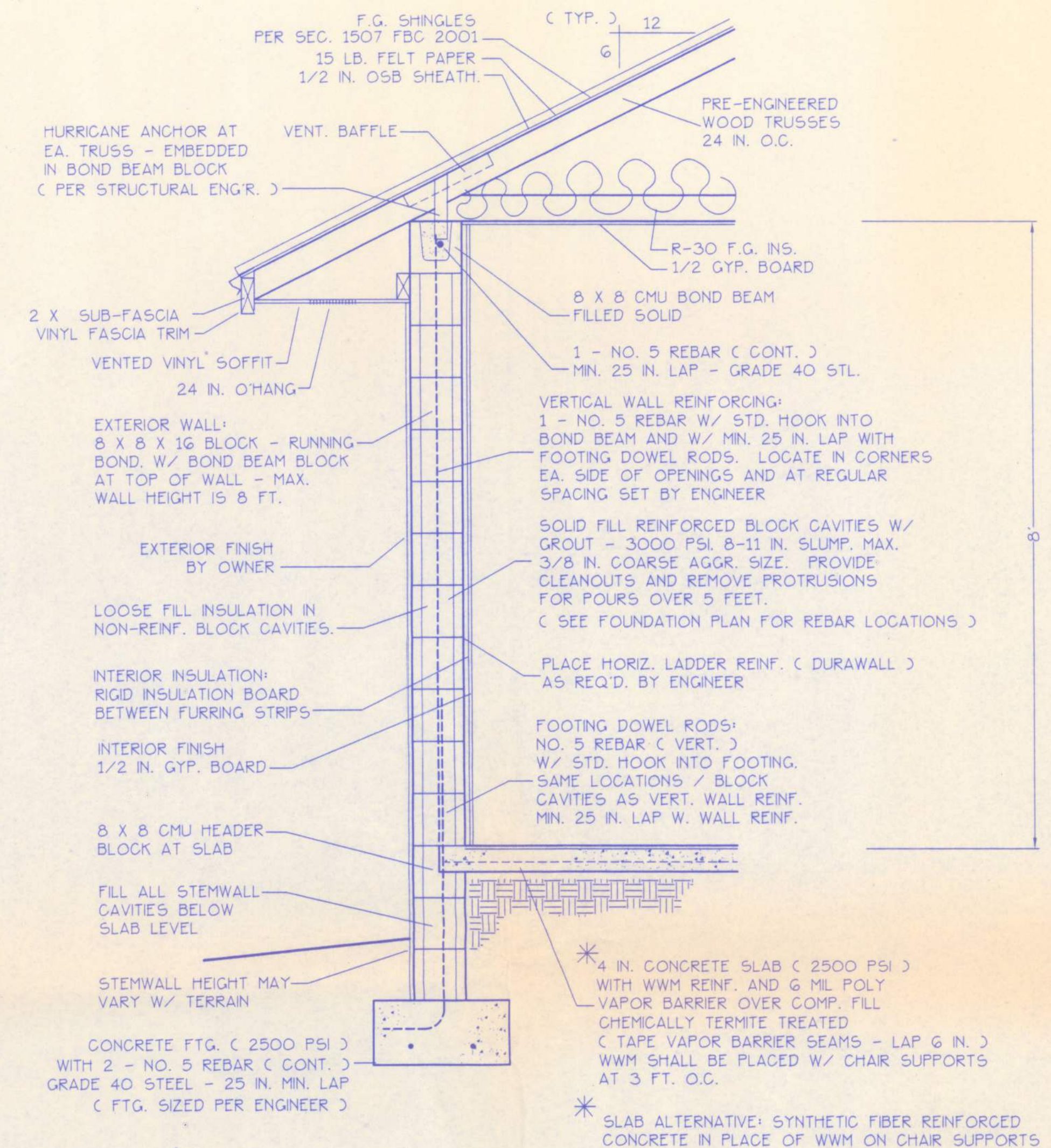

**WALL SECTION NOTES:**

- This Typical Wall Section is for Estimating purposes only.
- All data shown in this Wall Section shall be subject to review and final input by the Structural Engineer.

**DESIGN WALL SECTION**  
NON-STRUCTURAL DATA

SCALE: 3/4 IN. = 1 FT.

WINDLOAD ENGINEER: Mark Disosway, PE No.53915, POB 868, Lake City, FL 32056, 386-754-5419

CERTIFICATION: These plans and "Windload Engineering", Sheet S-1, attached, comply with Florida Building Code 2001, Section 1606 wind loads, to the best of my knowledge.

LIMITATION: This design is valid for one building, at specified location, permitted within 90 days of signature date. In case of conflict, structural requirements, scope of work, and builder responsibilities on sheet S-1 control.

LOTS 11, 12 & 13 PRICE CREEK  
Location: ACRES UNIT 1 - COLUMBIA CO. Job No. \_\_\_\_\_

411036  
M. Disosway  
08NOV04

**A-3**

FILE: 04-047	<b>DICKS RESIDENCE</b>	SHEET: 3 OF 4
DATE: 11-3-04		CAD FILE: 04047
DRAWN: T A D	PREPARED BY: TIM DELBENE Drafting + Technical Services	REV:
CHECK: T A D	192 SW Sagewood Dr. Lake City, FL 32024 Phone (386) 755-5891	REV: