

Legend

Roads

- Roads
- others
- Dirt
- Interstate
- Main
- Other
- Paved
- Private
- LidarElevations



SRWMD Wetlands



Parcels

2018 Flood Zones

0.2 PCT ANNUAL CHANCE

A

Columbia County, FLA - Building & Zoning Property Map

Printed: Wed Apr 15 2020 08:57:57 GMT-0400 (Eastern Daylight Time)

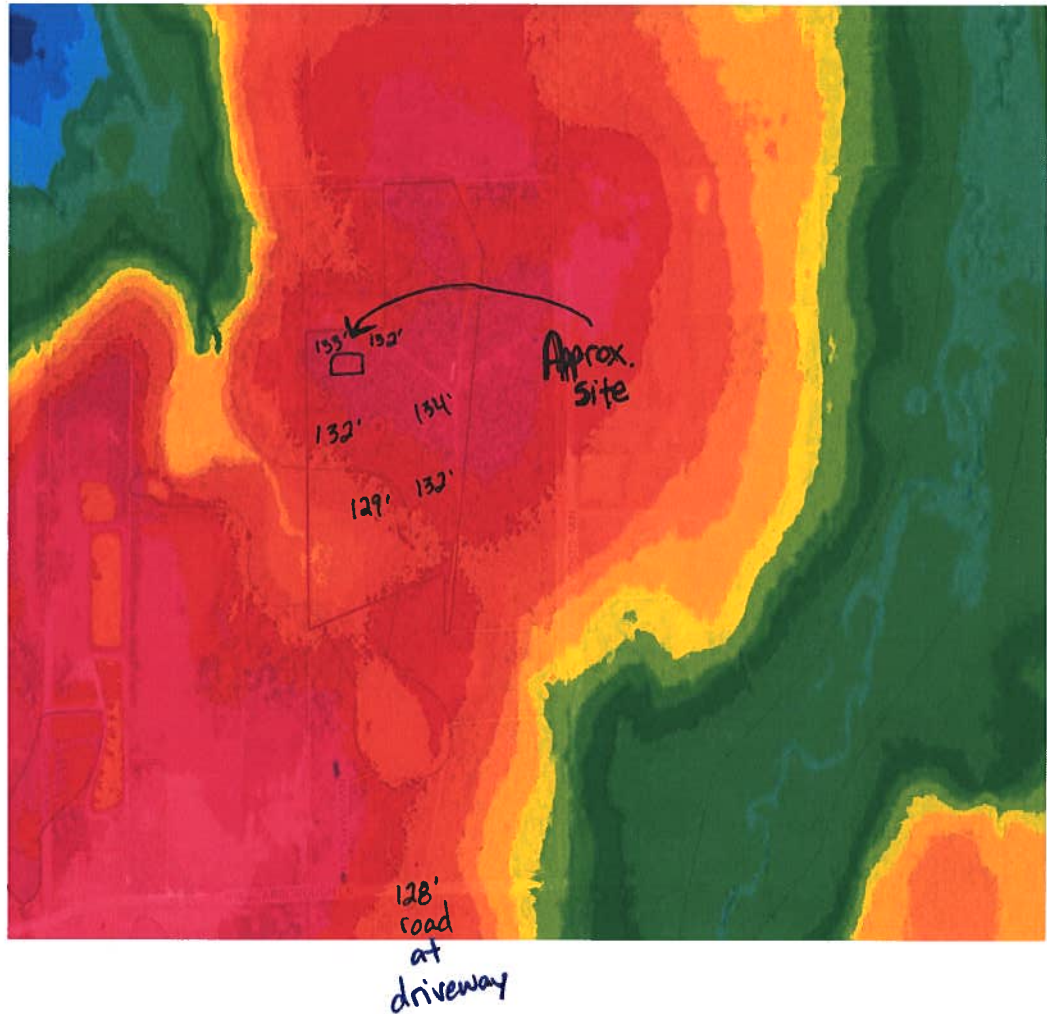

Parcel Information

Parcel No: 27-2S-16-01754-001

Owner: NEWTON JESSIE R

Subdivision:

Lot:

Acres: 24.72381

Deed Acres: 24 Ac

District: District 1 Ronald Williams

Future Land Uses: Agriculture - 3

Flood Zones: A,

Official Zoning Atlas: A-3

All data, information, and maps are provided "as is" without warranty or any representation of accuracy, timeliness of completeness. Columbia County, FL makes no warranties, express or implied, as to the use of the information obtained here. There are no implied warranties of merchantability or fitness for a particular purpose. The requester acknowledges and accepts all limitations, including the fact that the data, information, and maps are dynamic and in a constant state of maintenance, and update.