

### ROOF SHEATHING FASTENING

- 4" O.C. GABLE END
  - 6" O.C. EDGES (ALL ZONES)
  - 6" O.C. INTERMEDIATE FRAMING (ZONE 3)
  - 12" O.C. INTERMEDIATE FRAMING (ZONES 1 & 2)
- SEE FIGURE R903.2.3.1, SECTION R903.1, 2017 FLORIDA BUILDING CODE - RESIDENTIAL, SIXTH EDITION FOR ROOF SHEATHING NAILING ZONES

### ROOF NOTES

OVERLAP ROOFING UNDERLAMENT (N/A) OVER HIPS AND RIDGES  
 BUTT ON NAILS ARE USED TO FASTEN UNDERLAMENT TO ROOF DECK  
 WHEN SHINGLES NOT INSTALLED GABLE END  
 DRAIN EDGE INSTALLED OVER THE UNDERLAMENT AT RAKES AND UNDER  
 THE UNDERLAMENT AT EAVES  
 ALL ROOF PENETRATIONS ARE PROPERLY FLASHED W/ FLASHING OF THE  
 CORRECT SIZE FOR THE PENETRATION  
 METAL ROOFING ATTACHED W/ CORRECT FASTENERS PER CODE AND  
 MANUFACTURER'S SPECS  
 1" SPACE IS MAINTAINED BETWEEN THE END OF THE GUTTER AND THE  
 WALL CLADDING

### SOFFIT VENT CALCULATION

**FORMULA**

1 SQUARE INCH FOR EVERY 300 SQUARE INCHES OF CEILING

1.44 SQUARE INCHES = 1 SQUARE FOOT

CEILING AREA = 10' x 10' = 100 SQ. FT.

BUILDING SQ. IN / 300 = SQ. IN. OF VENT REQUIRED

100 SQ. IN. / 300 = .33 SQ. FT. OF VENT REQUIRED

PER SEC. 903.2.3.1, SECTION R903.1, 2017 FLORIDA BUILDING CODE - RESIDENTIAL, SIXTH EDITION VENTILATION MUST BE PROVIDED BY VENTILATIONS LOCATED A MIN. 3'-0" ABOVE EAVE

**BASE OF CALCULATION:**

61 CFT ROOF VENTS - 515 CMCO W/ 36 SQ IN. OPEN PER LINEAL FT.

61 CFT ROOF VENTS - 67 13-1/8" FULL VENT FINISHED W/ 9-1/2 SQ IN. OPEN PER LINEAL FT.

CALCULATED LINEAL FOOT OF SOFFIT VENT SHALL NOT INCLUDE VENTS LOCATED IN SOFFIT LOCATED LESS THAN 5' FROM PROPERTY LINE

REQUIRED		PROVIDED	
ROOF VENT (SQ. FT.)	ROOF VENT (SQ. IN.)	LINEAL FOOT (FT.)	LINEAL FOOT (SQ. IN.)
0.33	47.52	1.1	158.4

ROOF VENT (SQ. FT.) = 0.33 SQ. FT.

ROOF VENT (SQ. IN.) = 47.52 SQ. IN.

LINEAL FOOT (FT.) = 1.1 FT.

LINEAL FOOT (SQ. IN.) = 158.4 SQ. IN.

### SOFFIT VENT SPECIFICATIONS

- Double 2" prefinished soffit have a 6-20 sq. inch vent, lock rating
- Triple 4" center vent soffit have a 1-35 sq. inch vent, lock rating
- Triple 4" full vent soffit have a 5-60 sq. inch vent, lock rating
- Triple 4" double vent soffit have a 1-35 sq. inch vent, lock rating
- Triple 4" center vent soffit have a 4-70 sq. inch vent, lock rating
- Double 2" center vent soffit have a 2-65 sq. inch vent, lock rating
- Triple 3-1/2" double vent soffit have a 9-19 sq. inch vent, lock rating

### LVL detail connection

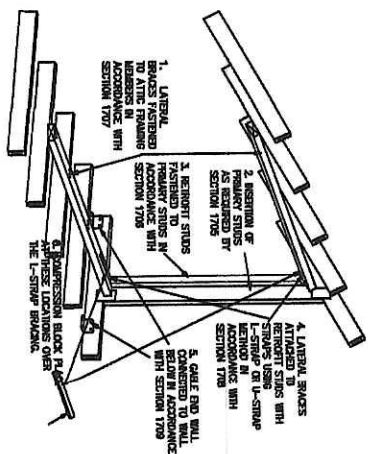
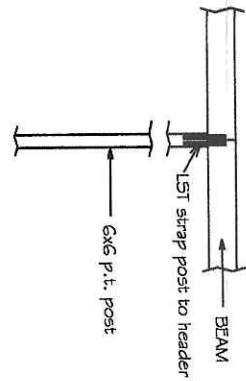

THIS GABLE END BRACING IS TO BE USED IN CONNECTION WITH THE L-STRAP POST METHOD IN ORDER TO SHOW STRAP, COMPRESSION BLOCKS ARE NOT SHOWN. THE METHOD FOR A CONVENTIONALLY FRAMED GABLE END IS SHOWN. NOT ALL DETAILS ARE SHOWN.

**GABLE END BRACING**

NOT TO SCALE

### NOTE

Simpson Strong-Tie Co. Strong-Drive SDWC TRUSS Screws may be used for uplift connection in lieu of straps. Strong-Drive SDWC Screws to be installed per manufacturer's specifications.

Simpson Strong-Tie Co. Titen HD Heavy-Duty Screw Anchors 5/8" x 8", maximum spacing of 6'-0" o.c., may be used in lieu of 5/8"x1'-0" anchor bolts with 3/4"x1/8" washer. Titen HD Heavy-Duty Screw Anchors shall be installed per manufacturer's specifications.



Digitally signed by  
 Carol Chadwick  
 DN: cn=Carol  
 ou=Unaffiliated,  
 o=0171349DA7000  
 1621F, c=Carol  
 Chadwick  
 Date: 2021.09.15  
 08:2004-0400

PROJECT NO.	PL21231	PREPARED FOR	INGRID GEIGER
DATE	SEP. 14, 2021	366.719.1409	ingridgeiger@gmail.com
REVISION DATE			
SHEET	5-2		

## SMITH/MENDEZ CARPORT FRAMING DETAILS

