

## DEMOLITION NOTES

1. THE GENERAL CONTRACTOR SHALL FURNISH ALL LABOR AND MATERIALS REQUIRED TO COMPLETE DEMOLITION, REMOVAL OR REUSE OF ALL ITEMS SHOWN ON DRAWINGS.
2. THE GENERAL CONTRACTOR SHALL PROTECT AT ALL TIMES THE PROPERTY OF THE BLDG. OWNER. THIS INCLUDES BUT IS NOT LIMITED TO WINDOWS, FLOORS, CEILING, TOILETS, DOORS, TRIM AND ELECTRICAL EQUIPMENT.
3. THE GENERAL CONTRACTOR SHALL PROVIDE ALL NECESSARY SHORING, BRACING, AND TEMPORARY PARTITIONS TO PROTECT THE EXISTING BUILDING WHILE DEMOLITION AND CONSTRUCTION IS IN PROGRESS.
4. PATCH AND REPAIR EXISTING CONSTRUCTION IMPACTED BY DEMOLITION TO RESTORE FINISH TO "LIKE NEW" CONDITION UNLESS DIRECTED OTHERWISE.
5. TAKE PRECAUTION AGAINST ELECTRICAL AND FIRE HAZARDS DURING DEMOLITION. DO NOT INTERRUPT POWER IN OCCUPIED SPACES WITHOUT PRIOR NOTICE AND APPROVAL BY THE BLDG. OWNER.
6. REMOVE AND DISPOSE OF ALL EXCESS AND EXPOSED ELECTRICAL WIRING FROM THE SURFACE OF ALL WALLS, CEILING, AND FLOORS PER ALL APPLICABLE CODES.
7. CUT, CAP, AND PATCH ALL EXISTING FLOOR RECEPTACLES AND PLUMBING AND GAS LINES THAT PENETRATE THE FLOOR PER ALL APPLICABLE CODES.
8. THE CONTRACTOR SHALL PATCH AND REPAIR CEILING, WALLS, & FLOORS DAMAGED FROM DEMOLITION OR NEW CONSTRUCTION ACTIVITIES. CONTRACTOR SHALL FILL VOIDS WITH LIKE MATERIALS IN EXISTING CONSTRUCTION, DUE TO THE REMOVAL OF THE BUILDING COMPONENTS INDICATED.
9. USE TEMPORARY RESET PLAN PROVIDED BY DOLLAR GENERAL TO TEMPORARILY RESET THE FIXTURES FOR THE CONSTRUCTION PHASE. MINIMUM AISLE WIDTH OF 4', PREFERRED WORKING SPACE OF 8' AT CONSTRUCTION AREAS (BEFORE WALL MOVES). IDENTIFICATION FOR ALL FIXTURE CHANGES (REMOVAL OR INSTALLATION)
10. UNLESS OTHERWISE NOTED IN THE SCOPE OF WORK, ALL EXISTING GRAPHICS SHOULD BE CAREFULLY REMOVED AND STORED IN THE RECEIVING AREA FOR SAFE KEEPING. THEY WILL BE REUSED AT THE END OF THE PROJECT.
11. ALL FIXTURES SHOULD BE MOVED USING THE APPROPRIATE STYLE GONDOLA MOVERS. NOTE: IF FIXTURE BASE PLATE MUST BE REMOVED, GC SHOULD REINSTALL BASE PLATE IMMEDIATELY AFTER FIXTURE MOVE HAS TAKEN PLACE.
12. ONCE FIXTURES ARE MOVED, CONSTRUCT TEMPORARY WALL USING THE FOLLOWING OUTLINES: METAL FRAMING, STUDS @4' O.C., ANCHOR TO FLOOR WITH TAP-CON SCREWS (AVOID HIGH IMPACT FASTENING METHODS TO PREVENT CHIPPING OF TILE OR CONCRETE. ANCHOR TO CEILING GRID AT TOP. HANG CURTAIN WALL (4MIL OR THICKER) FROM CEILING TO FLOOR, LEAVING SALES FLOOR ACCESS FROM RECEIVING AREA UN-ANCHORED AT FLOOR, WHERE WALL FIXTURES REMAIN, LINE BOTTOM OF WALL TO 4' A.F.F. WITH 1/2" PLYWOOD OR OSB.
13. RETAIN ALL DEMO LIGHTS FOR REUSE AS SHOWN BY NEW FLOOR PLAN AND REFLECTIVE CEILING PLAN.

## DEMO PLAN LEGEND

- ITEMS TO REMAIN  
- - - - - ITEMS TO BE REMOVED

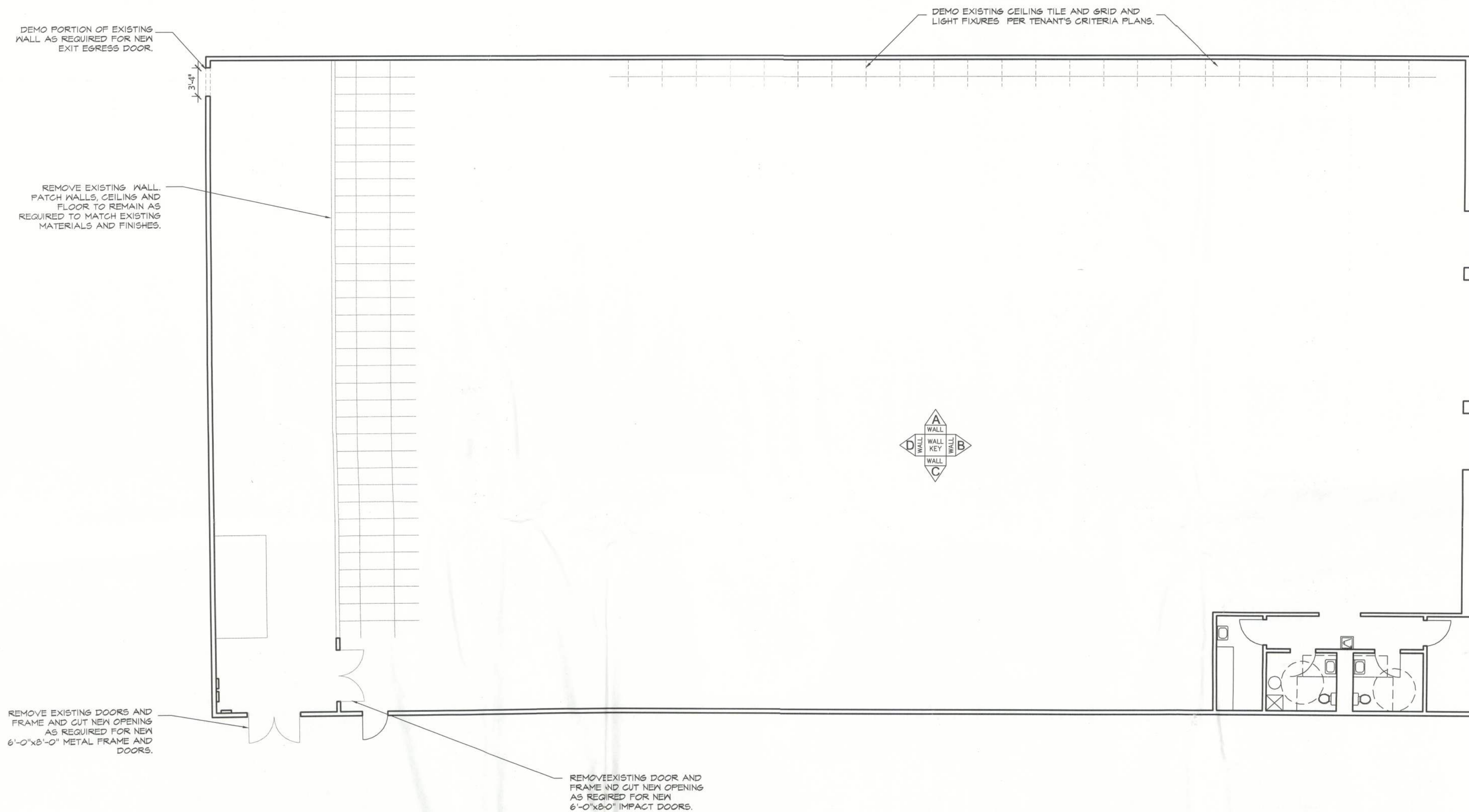

## 1 DEMOLITION PLAN

SCALE: 1/8" = 1'-0"