

See Deed

CARD 001 of 001
BY JEFF

TOTAL

AE	LAND CODE	DESC	ZONE	ROAD	UD1	UD3	FRONT	DEPTH	FIELD CK:					UNITS	UT	PRICE	ADJ	UT	PR	LAND	VALUE
			TOPO	UTIL	UD2	UD4	BACK	DT	ADJUSTMENTS												
Y	000000	VAC RES	A-1	0002					1.00	1.00	1.00	1.00		5.010	AC	5600.000		5600.00		28,056	
			0002	0003																	
Y	009945	WELL/SEPT							1.00	1.00	1.00	1.00		1.000	UT	2000.000		2000.00		2,000	

45
30633

District No. 1 - Ronald Williams
District No. 2 - Rusty DePratter
District No. 3 - Bucky Nash
District No. 4 - Stephen E. Bailey
District No. 5 - Scarlet P. Frisina

BOARD OF COUNTY COMMISSIONERS • COLUMBIA COUNTY



MEMORANDUM

Date: 5 December 2012
To: Mobil Home Move-on Permit File 30633
From: Brian L. Kepner, Land Development Regulation Administrator 
Re: 1 Foot Above the Road

The distance from the graded/grass paved road (SW Grant Glen) to the proposed location of the mobile home is 350 feet as indicated on the site plan submitted as part of the Mobile Home Move-on Permit application. The slope of the property runs southwest to northeast from approximately 97 feet to 80 feet. The proposed location of the mobile home is approximately between the 90 and 85 foot contour lines. The property continues to slope downward to the northeast approximately 410 feet to an area of 100 year flood zone A at approximately the 75 foot contour line and possibly a little lower. The proposed location of the mobile home has no practical relationship with requiring the mobile home to be set 1 foot above the road for prevention of water damage to the mobile home because (1) the 350 feet distance from the mobile home to the grass/graded road, (2) the continued sloping of the property towards the flood zone A approximately 410 feet further to the northeast, and (3) the requirements of State Statutes which require the pad to be sloped in such a way to prevent water from collecting under the mobile home. The mobile home will be allowed standard set up and in accordance with all applicable codes.

BOARD MEETS FIRST THURSDAY AT 7:00 P.M.
AND THIRD THURSDAY AT 7:00 P.M.



Permit # 30633

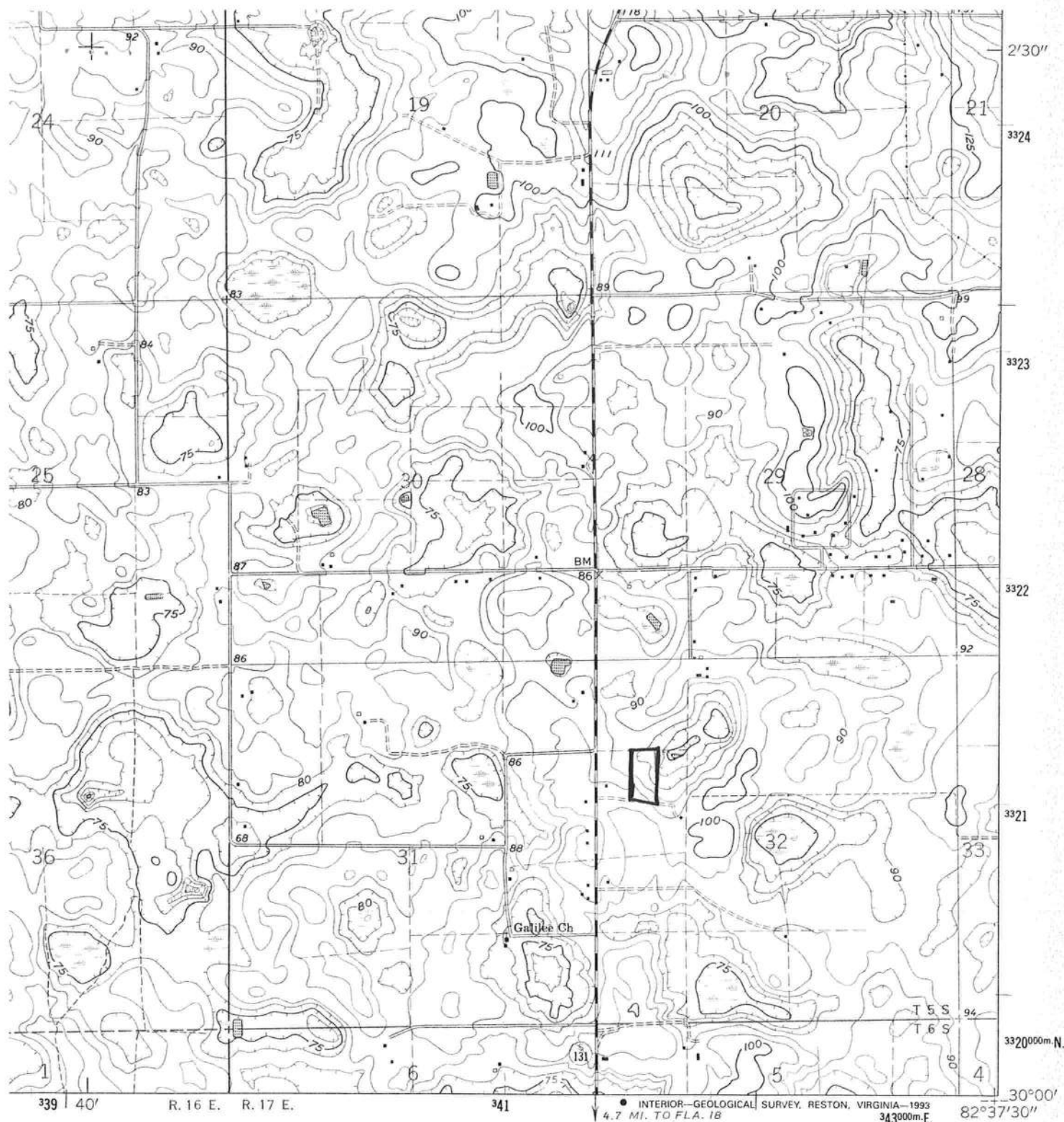

11LE

Permit # 30633



QUADRANGLE LOCATION

Revisions shown in purple and woodland compiled in cooperation with State of Florida agencies from aerial photographs taken 1990 and other sources. Contours not revised. This information not field checked. Map edited 1993.

ROAD CLASSIFICATION

- Primary highway, hard surface
- Light-duty road, hard or improved surface
- Secondary highway, hard surface
- Unimproved road
- Interstate Route
- U. S. Route
- State Route

(MIKESVILLE)
44431 NE

COLUMBIA, FLA.
30082-A6-TF-024

1963
REVISED 1993
DMA 4444 II SW-SERIES V847