

# Window/Door/Shutter Worksheet

\* Design pressures are to be calculated as per  
FBC R301.

Permit Number: \_\_\_\_\_

Site Address: 1190 NW Oakland Ave, Lake City, FL

Company Name: AB&H Construction LLC

OPENING NUMBER	ROOM NAME	Window/Door/Shutter TYPE	OPENING WIDTH	OPENING HEIGHT	FL or NOA #	DESIGN PRESSURES +/-
1	Bedroom 3	Double Hung	28	54	FL5419	
2	Bedroom 3	Double Hung	28	54	FL5419	
3	Kitchen	Double Hung	28	32	FL5419	
4	Living Room	Double Hung	35 3/4	54	FL5419	
5	Living Room	Double Hung	35 3/4	54	FL5419	
6	Living Room	Double Hung	35 3/4	54	FL5419	
7	Bedroom 1	Double Hung	35 3/4	54	FL5419	
8	Bedroom 1	Double Hung	28	54	FL5419	
9	Bathroom	Double Hung	22 1/2	34	FL5419	
10	Bedroom 2	Double Hung	28	54	FL5419	
11	Kitchen	Swinging Door	36	80	FL22513	
12	Living Room	Swinging Door	36	80	FL22513	



# CUSTOMER COPY

## QUOTE / ORDER #1450240

Date Entered: 2/11/2021  
 Date Printed: 2/11/2021  
 Printed By: Tyler Faulk

SOLD TO:

SHIP TO:

Phone:  
Fax:

Phone:  
Fax:

PO NUMBER	QUOTE NAME	PROJECT NAME
	RCS-DUNMORE	RCS-DUNMORE

Line/Item #	Qty.	Description	Unit Price	Ext. Price
100-1	2	StormBreaker Plus Windows Double Hung 28" X 54"	\$451.68	\$903.36

RO:  
28.5 x 54.5  
Room ID:  
Custom  
BACK  
BEDROOM  
1,2  
Ply Gem  
SIMONTON  
WINDOWS & DOORS

54" Operation = Operating, Frame = Replacement,  
 Ext. Color = White, Int. Color = White, Glass  
 Package = Standard Glass Options, ProSolar Low E,  
 Argon, Intercept, Laminated All Inside .090 PVB,  
 1"IGU, Glass Thickness = 1/8 in - 1/8 out DS,  
 Upper = Annealed, Lower = Annealed, Locks = 2,  
 White, Cam, Sill Extender, Screen Coverage = Half,  
 Fiberglass, Extruded, Wrap Screens Separate, U-  
 Factor = 0.3, SHGC = 0.28, VT = 0.49, STC = 36,  
 Meets Energy Star Zones = North Central, DP = 60,  
 AAMA, TDI = WIN-271, Florida Approval Code =  
 5419

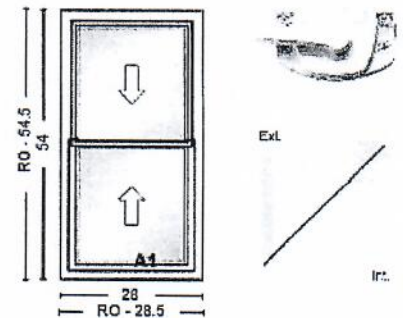

Initials: \_\_\_\_\_

Line/Item #	Qty.	Description	Unit Price	Ext. Price
200-1	1	StormBreaker Plus Windows Double Hung 28" X 32"	\$330.50	\$330.50

RO:  
28.5 x 32.5  
Room ID:  
Kitchen  
3  
Ply Gem  
SIMONTON  
WINDOWS & DOORS

32" Operation = Operating, Frame = Replacement,  
 Ext. Color = White, Int. Color = White, Glass  
 Package = Standard Glass Options, ProSolar Low E,  
 Argon, Intercept, Laminated All Inside .090 PVB,  
 1"IGU, Glass Thickness = 1/8 in - 1/8 out DS,  
 Upper = Annealed, Lower = Annealed, Locks = 2,  
 White, Cam, Sill Extender, Screen Coverage = Half,  
 Fiberglass, Extruded, Wrap Screens Separate, U-  
 Factor = 0.3, SHGC = 0.28, VT = 0.49, STC = 36,  
 Meets Energy Star Zones = North Central, DP = 60,  
 AAMA, TDI = WIN-271, Florida Approval Code =  
 5419

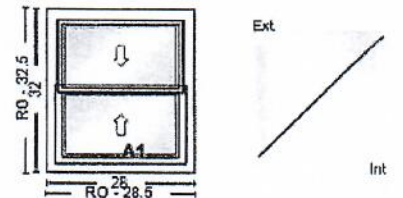

Initials: \_\_\_\_\_



PO NUMBER	QUOTE NAME	PROJECT NAME
	RCS-DUNMORE	RCS-DUNMORE

LineItem #	Qty.	Description	Unit Price	Ext. Price
300-1	2	StormBreaker Plus Windows Double Hung 35.75" X 54" Operation = Operating, Frame = Replacement, Ext. Color = White, Int. Color = White, Glass Package = Standard Glass Options, ProSolar Low E, Argon, Intercept, Laminated All Inside .090 PVB, 1"IGU, Glass Thickness = 1/8 in - 1/8 out DS, Upper = Annealed, Lower = Annealed, Locks = 2, White, Cam, Sill Extender, Screen Coverage = Half, Fiberglass, Extruded, Wrap Screens Separate, U-Factor = 0.3, SHGC = 0.28, VT = 0.49, STC = 36, Meets Energy Star Zones = North Central, DP = 60, AAMA, TDI = WIN-271, Florida Approval Code = 5419	\$495.75	\$991.50

RO:  
36.25 x 54.5  
Room ID:  
Custom  
L R - SIDE

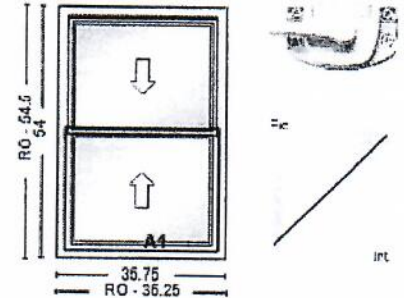

Initials: \_\_\_\_\_

LineItem #	Qty.	Description	Unit Price	Ext. Price
400-1	1	StormBreaker Plus Windows Double Hung 35.75" X 54" Operation = Operating, Frame = Replacement, Ext. Color = White, Int. Color = White, Glass Package = Standard Glass Options, ProSolar Low E, Argon, Intercept, Laminated All Inside .090 PVB, 1"IGU, Glass Thickness = 1/8 in - 1/8 out DS, Upper = Annealed, Lower = Annealed, Locks = 2, White, Cam, Sill Extender, Screen Coverage = Half, Fiberglass, Extruded, Wrap Screens Separate, U-Factor = 0.3, SHGC = 0.28, VT = 0.49, STC = 36, Meets Energy Star Zones = North Central, DP = 60, AAMA, TDI = WIN-271, Florida Approval Code = 5419	\$495.75	\$495.75

RO:  
36.25 x 54.5  
Room ID:  
Custom  
L R- FRONT

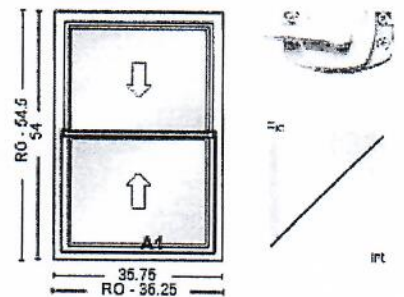

Initials: \_\_\_\_\_

PO NUMBER

QUOTE NAME

PROJECT NAME

RCS-DUNMORE

RCS-DUNMORE

Line/Item #	Qty.	Description	Unit Price	Ext. Price
500-1	1	StormBreaker Plus Windows Double Hung 35.75" X 54"	\$495.75	\$495.75

RO:

36.25 x 54.5

Room ID:

Bedroom 1

54" Operation = Operating, Frame = Replacement,  
Ext. Color = White, Int. Color = White, Glass  
Package = Standard Glass Options, ProSolar Low E,  
Argon, Intercept, Laminated All Inside .090 PVB,  
1"IGU, Glass Thickness = 1/8 in - 1/8 out DS,  
Upper = Annealed, Lower = Annealed, Locks = 2,  
White, Cam, Sill Extender, Screen Coverage = Half,  
Fiberglass, Extruded, Wrap Screens Separate, U-  
Factor = 0.3, SHGC = 0.28, VT = 0.49, STC = 36,  
Meets Energy Star Zones = North Central, DP = 60,  
AAMA, TDI = WIN-271, Florida Approval Code =  
5419

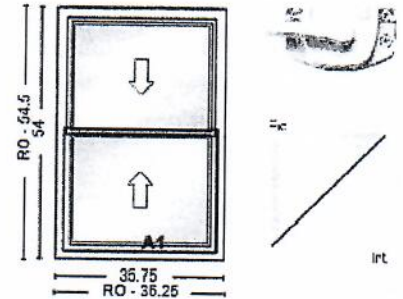

Initials: \_\_\_\_\_

Line/Item #	Qty.	Description	Unit Price	Ext. Price
600-1	1	StormBreaker Plus Windows Double Hung 28" X 54"	\$451.68	\$451.68

RO:

28.5 x 54.5

Room ID:

Custom

BR 1- SIDE

54" Operation = Operating, Frame = Replacement,  
Ext. Color = White, Int. Color = White, Glass  
Package = Standard Glass Options, ProSolar Low E,  
Argon, Intercept, Laminated All Inside .090 PVB,  
1"IGU, Glass Thickness = 1/8 in - 1/8 out DS,  
Upper = Annealed, Lower = Annealed, Locks = 2,  
White, Cam, Sill Extender, Screen Coverage = Half,  
Fiberglass, Extruded, Wrap Screens Separate, U-  
Factor = 0.3, SHGC = 0.28, VT = 0.49, STC = 36,  
Meets Energy Star Zones = North Central, DP = 60,  
AAMA, TDI = WIN-271, Florida Approval Code =  
5419

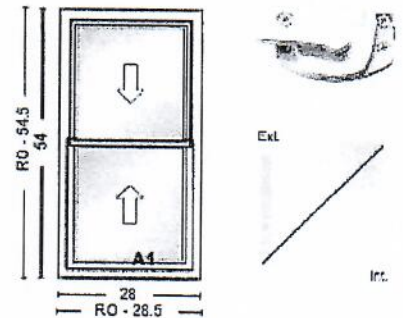

Initials: \_\_\_\_\_



PO NUMBER	QUOTE NAME	PROJECT NAME
	RCS-DUNMORE	RCS-DUNMORE

LineItem #	Qty.	Description	Unit Price	Ext. Price
700-1	1	StormBreaker Plus Windows Double Hung 22.5" X 34" Operation = Operating, Frame = Replacement, Ext. Color = White, Int. Color = White, Glass Package = Standard Glass Options, ProSolar Low E, Argon, Intercept, Laminated All Inside .090 PVB, 1"IGU, Glass Thickness = 1/8 in - 1/8 out DS, Upper = Annealed, Lower = Annealed, Locks = 2, White, Cam, Sill Extender, Screen Coverage = Half, Fiberglass, Extruded, Wrap Screens Separate, U-Factor = 0.3, SHGC = 0.28, VT = 0.49, STC = 36, Meets Energy Star Zones = North Central, DP = 60, AAMA, TDI = WIN-271, Florida Approval Code = 5419	\$313.98	\$313.98

RO:  
23 x 34.5  
Room ID:  
Bathroom

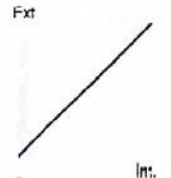
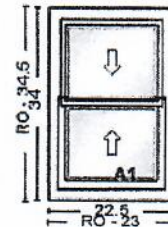

Initials: \_\_\_\_\_

LineItem #	Qty.	Description	Unit Price	Ext. Price
800-1	1	StormBreaker Plus Windows Double Hung 28" X 54" Operation = Operating, Frame = Replacement, Ext. Color = White, Int. Color = White, Glass Package = Standard Glass Options, ProSolar Low E, Argon, Intercept, Laminated All Inside .090 PVB, 1"IGU, Glass Thickness = 1/8 in - 1/8 out DS, Upper = Annealed, Lower = Annealed, Locks = 2, White, Cam, Sill Extender, Screen Coverage = Half, Fiberglass, Extruded, Wrap Screens Separate, U-Factor = 0.3, SHGC = 0.28, VT = 0.49, STC = 36, Meets Energy Star Zones = North Central, DP = 60, AAMA, TDI = WIN-271, Florida Approval Code = 5419	\$451.68	\$451.68

RO:  
28.5 x 54.5  
Room ID:  
Bedroom 2

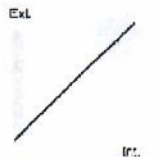
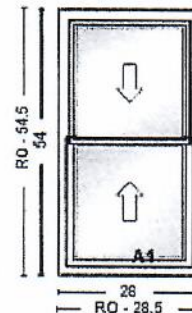

Initials: \_\_\_\_\_

10 Total Qty Units	SUB-TOTAL:	\$4,434.20
Comment: <div style="border: 1px solid black; height: 100px; width: 300px;"></div>	TOTAL TAX:	\$0.00
	TOTAL LABOR:	\$0.00
	TOTAL FREIGHT:	\$0.00
	DIST/CLR DISC:	(\$0.00)
	TOTAL:	\$4,434.20
	DEPOSIT PAID:	(\$0.00)
	AMOUNT DUE:	\$4434.20

Submitted by: \_\_\_\_\_ Accepted by: \_\_\_\_\_ Date: \_\_\_\_\_

Thank You !!!!!

FLORIDA DEPARTMENT OF  
**Business & Professional Regulation**



DBPR HOME ABOUT DBPR DBPR DIVISIONS CONTACT DBPR

BCIS Home | Log In | User Registration | Hot Topics | Submit Surcharge | Stats & Facts | Publications | Contact Us | BCIS Site Map | Links | Search



**Product Approval**  
USER: Public User

[Product Approval Menu](#) > **Application Detail**

OFFICE OF THE  
SECRETARY

FL #

Application Type

Code Version

Application Status

**FL22513-R1**

Affirmation

2017

Approved

Comments

Archived



Product Manufacturer

Address/Phone/Email

Masonite International

1955 Powis Road

West Chicago, IL 60185

(800) 663-3667

sschreiber@masonite.com

Authorized Signature

Steve Schreiber

sschreiber@masonite.com

Technical Representative

Address/Phone/Email

Quality Assurance Representative

Address/Phone/Email

Category

Subcategory

Exterior Doors

Swinging Exterior Door Assemblies

Compliance Method

Certification Mark or Listing

Certification Agency

Validated By

National Accreditation & Management Institute

National Accreditation & Management Institute

Referenced Standard and Year (of Standard)

**Standard**

**Year**

TAS 201

1994

TAS 202

1994

TAS 203

1994

Equivalence of Product Standards

Certified By

☒ I affirm that there are no changes in the new Florida Building Code which affect my product(s) and my product(s) are in compliance with the new Florida Building Code.

Documentation from approved Evaluation or Validation Entity ☐ Yes ☐ No ☐ N/A

## Product Approval Method

Method 1 Option A

Date Submitted	11/21/2017
Date Validated	11/21/2017
Date Pending FBC Approval	
Date Approved	11/26/2017
Date Revised	04/16/2018

## Summary of Products

FL #	Model, Number or Name	Description
22513.1	HPC Wood-edge Steel Side-Hinged Door Unit	6'-8" Glazed I/S or O/S Single or Double Door w/ or w/o Sidelites
<b>Limits of Use</b> <b>Approved for use in HVHZ:</b> Yes <b>Approved for use outside HVHZ:</b> Yes <b>Impact Resistant:</b> No <b>Design Pressure:</b> +50/-50 <b>Other:</b> Evaluated for use in locations adhering to the Florida Building Code, including the High Velocity Hurricane Zone, and where pressure requirements do not exceed the design pressures listed. 12'-0" x 6'-8" max nominal size. When impact resistance is required, hurricane protective system is required. Door top rails stamped "HPC". See DWG-MA-FL0212 for details.		<b>Certification Agency Certificate</b> <a href="#">FL22513_R1_C_CAC_NI013747.01.pdf</a> <b>Quality Assurance Contract Expiration Date</b> 06/30/2021 <b>Installation Instructions</b> <a href="#">FL22513_R1_II_FL0212.pdf</a> Verified By: National Accreditation & Management Institute Created by Independent Third Party: <b>Evaluation Reports</b> <a href="#">FL22513_R1_AE_514008.pdf</a> Created by Independent Third Party: Yes
22513.2	Wood-edge Steel Side-Hinged Door Unit	8'-0" Opaque I/S or O/S Single Door Unit
<b>Limits of Use</b> <b>Approved for use in HVHZ:</b> Yes <b>Approved for use outside HVHZ:</b> Yes <b>Impact Resistant:</b> Yes <b>Design Pressure:</b> +70/-70 <b>Other:</b> Evaluated for use in locations adhering to the Florida Building Code, including the High Velocity Hurricane Zone, and where pressure requirements do not exceed the design pressures listed. 3'-0" x 8'-0" max nominal size. When impact resistance is required, hurricane protective system not required. See DWG-MA-FL0215 for details.		<b>Certification Agency Certificate</b> <a href="#">FL22513_R1_C_CAC_NI013747.04.pdf</a> <b>Quality Assurance Contract Expiration Date</b> 06/30/2021 <b>Installation Instructions</b> <a href="#">FL22513_R1_II_FL0215.pdf</a> Verified By: National Accreditation & Management Institute Created by Independent Third Party: <b>Evaluation Reports</b> <a href="#">FL22513_R1_AE_514009.pdf</a> Created by Independent Third Party: Yes
22513.3	Wood-edge Steel Side-Hinged Door Unit	8'-0" Opaque I/S Single or Double Door w/ or w/o Sidelites
<b>Limits of Use</b> <b>Approved for use in HVHZ:</b> Yes <b>Approved for use outside HVHZ:</b> Yes <b>Impact Resistant:</b> Yes <b>Design Pressure:</b> +45/-50 <b>Other:</b> Evaluated for use in locations adhering to the Florida Building Code, including the High Velocity Hurricane Zone, and where pressure requirements do not exceed the design pressures listed. 12'-0" x 8'-0" max nominal size. When impact resistance is required, hurricane protective system not required on opaque panels, but is required on glazed sidelites. See DWG-MA-FL0215 for details.		<b>Certification Agency Certificate</b> <a href="#">FL22513_R1_C_CAC_NI013747.04.pdf</a> <b>Quality Assurance Contract Expiration Date</b> 06/30/2021 <b>Installation Instructions</b> <a href="#">FL22513_R1_II_FL0215.pdf</a> Verified By: National Accreditation & Management Institute Created by Independent Third Party: <b>Evaluation Reports</b> <a href="#">FL22513_R1_AE_514007.pdf</a> Created by Independent Third Party: Yes
22513.4	Wood-edge Steel Side-Hinged Door Unit	8'-0" Opaque O/S Single or Double Door w/ or w/o Sidelites
<b>Limits of Use</b> <b>Approved for use in HVHZ:</b> Yes <b>Approved for use outside HVHZ:</b> Yes <b>Impact Resistant:</b> Yes <b>Design Pressure:</b> +50/-45 <b>Other:</b> Evaluated for use in locations adhering to the Florida Building Code, including the High Velocity Hurricane Zone, and where pressure requirements do not exceed the design pressures listed. 12'-0" x 8'-0" max nominal size. When impact resistance is required, hurricane protective system not required on opaque panels, but is required on glazed sidelites. See DWG-MA-FL0215 for details.		<b>Certification Agency Certificate</b> <a href="#">FL22513_R1_C_CAC_NI013747.04.pdf</a> <b>Quality Assurance Contract Expiration Date</b> 06/30/2021 <b>Installation Instructions</b> <a href="#">FL22513_R1_II_FL0215.pdf</a> Verified By: National Accreditation & Management Institute Created by Independent Third Party: <b>Evaluation Reports</b> <a href="#">FL22513_R1_AE_514007.pdf</a> Created by Independent Third Party: Yes



22513.5	Wood-edge Steel Side-Hinged Door Unit	8'-0" 3/4-Lite Glazed I/S or O/S Single or Double Door w/ or w/o Sidelites
<b>Limits of Use</b> <b>Approved for use in HVHZ:</b> Yes <b>Approved for use outside HVHZ:</b> Yes <b>Impact Resistant:</b> No <b>Design Pressure:</b> +40/-40 <b>Other:</b> Evaluated for use in locations adhering to the Florida Building Code, including the High Velocity Hurricane Zone, and where pressure requirements do not exceed the design pressures listed. 12'-0" x 8'-0" max nominal size. When impact resistance is required, hurricane protective system is required. See DWG-MA-FL0217 for details.		<b>Certification Agency Certificate</b> <a href="#">FL22513_R1_C_CAC_NI013747.06.pdf</a> <b>Quality Assurance Contract Expiration Date</b> 06/30/2021 <b>Installation Instructions</b> <a href="#">FL22513_R1_II_FL0217.pdf</a> Verified By: National Accreditation & Management Institute Created by Independent Third Party: <b>Evaluation Reports</b> <a href="#">FL22513_R1_AE_514007.pdf</a> Created by Independent Third Party: Yes
22513.6	Wood-edge Steel Side-Hinged Door Unit	6'-8" Opaque I/S or O/S Single Door
<b>Limits of Use</b> <b>Approved for use in HVHZ:</b> Yes <b>Approved for use outside HVHZ:</b> Yes <b>Impact Resistant:</b> Yes <b>Design Pressure:</b> +70/-70 <b>Other:</b> Evaluated for use in locations adhering to the Florida Building Code, including the High Velocity Hurricane Zone, and where pressure requirements do not exceed the design pressures listed. 3'-0" x 6'-8" max nominal size. When impact resistance is required, hurricane protective system not required. See DWG-MA-FL0211 for details.		<b>Certification Agency Certificate</b> <a href="#">FL22513_R1_C_CAC_NI013747.pdf</a> <b>Quality Assurance Contract Expiration Date</b> 06/30/2021 <b>Installation Instructions</b> <a href="#">FL22513_R1_II_FL0211.pdf</a> Verified By: National Accreditation & Management Institute Created by Independent Third Party: <b>Evaluation Reports</b> <a href="#">FL22513_R1_AE_514010.pdf</a> Created by Independent Third Party: Yes
22513.7	Wood-edge Steel Side-Hinged Door Unit	6'-8" Opaque I/S or O/S Single or Double Door w/ or w/o Sidelites
<b>Limits of Use</b> <b>Approved for use in HVHZ:</b> Yes <b>Approved for use outside HVHZ:</b> Yes <b>Impact Resistant:</b> Yes <b>Design Pressure:</b> +55/-55 <b>Other:</b> Evaluated for use in locations adhering to the Florida Building Code, including the High Velocity Hurricane Zone, and where pressure requirements do not exceed the design pressures listed. 12'-0" x 6'-8" max nominal size. When impact resistance is required, hurricane protective system not required on opaque panels, but is required on glazed sidelites. See DWG-MA-FL0211 for details.		<b>Certification Agency Certificate</b> <a href="#">FL22513_R1_C_CAC_NI013747.pdf</a> <b>Quality Assurance Contract Expiration Date</b> 06/30/2021 <b>Installation Instructions</b> <a href="#">FL22513_R1_II_FL0211.pdf</a> Verified By: National Accreditation & Management Institute Created by Independent Third Party: <b>Evaluation Reports</b> <a href="#">FL22513_R1_AE_514008.pdf</a> Created by Independent Third Party: Yes
22513.8	Wood-edge Steel Side-Hinged Door Unit	6'-8" 3/4-Lite Glazed I/S or O/S Single or Double Door w/ or w/o Sidelites
<b>Limits of Use</b> <b>Approved for use in HVHZ:</b> Yes <b>Approved for use outside HVHZ:</b> Yes <b>Impact Resistant:</b> No <b>Design Pressure:</b> +50/-50 <b>Other:</b> Evaluated for use in locations adhering to the Florida Building Code, including the High Velocity Hurricane Zone, and where pressure requirements do not exceed the design pressures listed. 12'-0" x 6'-8" max nominal size. When impact resistance is required, hurricane protective system is required. See DWG-MA-FL0214 for details.		<b>Certification Agency Certificate</b> <a href="#">FL22513_R1_C_CAC_NI013747.03.pdf</a> <b>Quality Assurance Contract Expiration Date</b> 06/30/2021 <b>Installation Instructions</b> <a href="#">FL22513_R1_II_FL0214.pdf</a> Verified By: National Accreditation & Management Institute Created by Independent Third Party: <b>Evaluation Reports</b> <a href="#">FL22513_R1_AE_514008.pdf</a> Created by Independent Third Party: Yes

[Back](#)
[Next](#)
[Contact Us](#) : 2601 Blair Stone Road, Tallahassee FL 32399 Phone: 850-487-1824

 The State of Florida is an AA/EEO employer. [Copyright 2007-2013 State of Florida](#) : [Privacy Statement](#) : [Accessibility Statement](#) : [Refund Statement](#)

Under Florida law, email addresses are public records. If you do not want your e-mail address released in response to a public-records request, do not send electronic mail to this entity. Instead, contact the office by phone or by traditional mail. If you have any questions, please contact 850.487.1395. \*Pursuant to Section 455.275(1), Florida Statutes, effective October 1, 2012, licensees licensed under Chapter 455, F.S., must provide the Department with an email address if they have one. The emails provided may be used for official communication with the licensee. However email addresses are public record. If you do not wish to supply a personal address, please provide the Department with an email address which can be made available to the public. To determine if you are a licensee under Chapter 455, F.S., please click [here](#).

Product Approval Accepts:





## WOOD-EDGE STEEL DOOR UNIT 6'-8" DOUBLE DOOR WITH / WITHOUT SIDELITES

### GENERAL NOTES

- EVALUATED FOR USE IN LOCATIONS ADHERING TO THE FLORIDA BUILDING CODE AND WHERE PRESSURE REQUIREMENTS AS DETERMINED BY ASCE 7 MINIMUM DESIGN LOADS FOR BUILDINGS AND OTHER STRUCTURES, DOES NOT EXCEED THE DESIGN PRESSURES LISTED.
- HURRICANE PROTECTIVE SYSTEM (SHUTTERS) IS NOT REQUIRED ON OPAQUE PANELS, BUT IS REQUIRED ON GLAZED SIDELITES.
- WHEN INSTALLED IN THE WIND-BORNE DEBRIS REGION, EXCLUDING THE HIGH VELOCITY HURRICANE ZONE (HVHZ), HURRICANE PROTECTIVE SYSTEM IS NOT REQUIRED ON OPAQUE PANELS OR PANELS WITH IMPACT GLASS, BUT IS REQUIRED ON PANELS WITH NON-IMPACT GLASS.
- POLYURETHANE CORE FLAME SPREAD INDEX OF 50 AND SMOKE DEVELOPED INDEX OF 60 PER ASTM E84.
- PLASTICS TESTING:

TEST DESCRIPTION	DESIGNATION	LITE FRAME
SELF IGNITION TEMP	ASTM D1929	842 °F > 850 °F
RATE OF BURNING	ASTM D635	1.28 IN/MIN
SMOKE DENSITY	ASTM D2843	70.2%
TENSILE STRENGTH*	ASTM D638	1.8% DIFF

\* COMPARATIVE TENSILE STRENGTH AFTER WEATHERING  
4500 HOURS XENON ARC METHOD 1

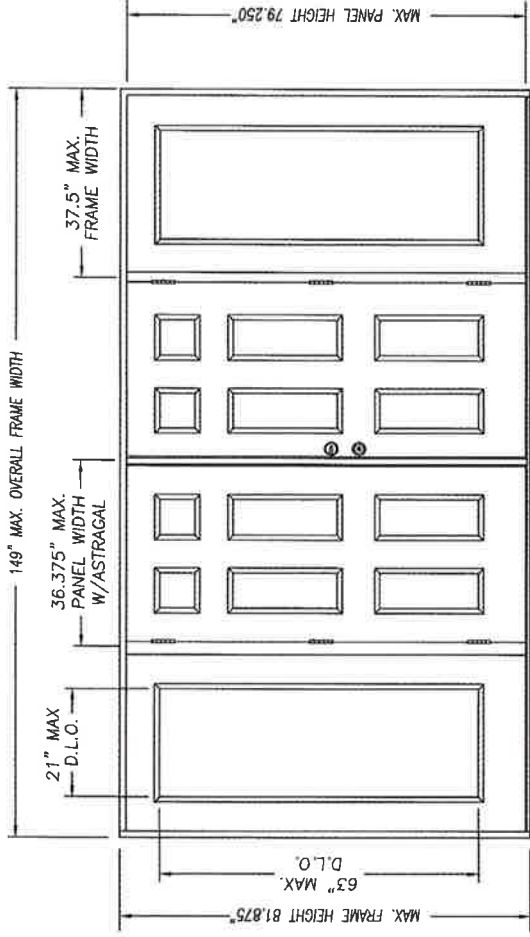

DOUBLE DOOR UNIT W/ SIDELITES

Addendum to NAMA

Certification No.: NCO13747  
Reviewed By: [Signature]  
Date Reviewed: 6/3/17

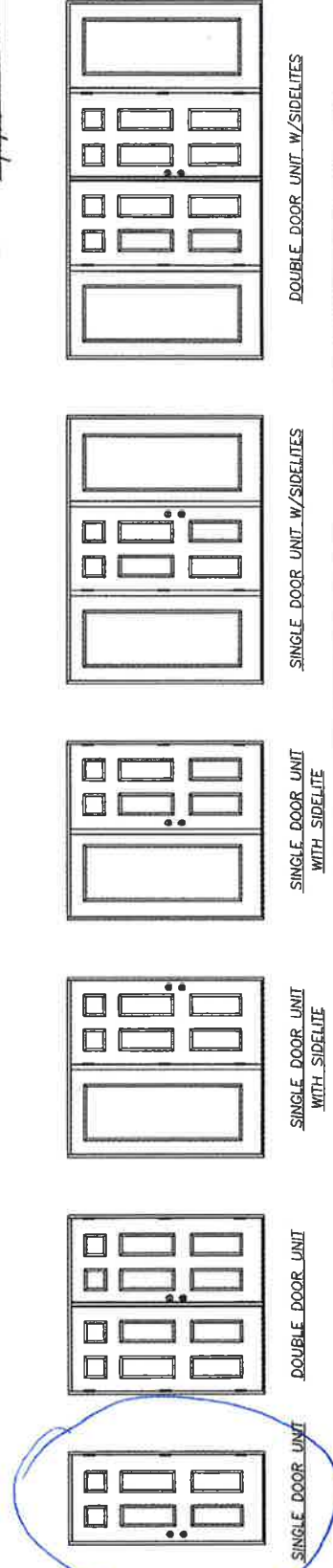

SHEET #	DESCRIPTION
1	TYPICAL ELEVATIONS & GENERAL NOTES
2	ANCHORING LOCATIONS & DETAILS
3	ANCHORING LOCATIONS & DETAILS

TABLE OF CONTENTS

CONFIG	MAX WIDTH	DESIGN PRESSURE RATING				WHERE WATER INFILTRATION PERFORMANCE IS REQUIRED TO BE 15% OF DESIGN PRESSURE			
		INSWING	OUTSWING	INSWING	OUTSWING	BUMPER O/S	Z-SERIES O/S	HIGH DAM O/S	
X	37.5"	+70.0 / -70.0	+70.0 / -70.0	N/A	N/A	+20.0 / -20.0	+30.0 / -30.0	+50.0 / -50.0	
XX	74"	+55.0 / -55.0	+55.0 / -55.0	N/A	N/A	+20.0 / -20.0	+30.0 / -30.0	+50.0 / -50.0	
OX or XO	75"	+55.0 / -55.0	+55.0 / -55.0	N/A	N/A	+20.0 / -20.0	+30.0 / -30.0	+50.0 / -50.0	
OXO	112.5"	+55.0 / -55.0	+55.0 / -55.0	N/A	N/A	+20.0 / -20.0	+30.0 / -30.0	+50.0 / -50.0	
OXOX	149"	+55.0 / -55.0	+55.0 / -55.0	N/A	N/A	+20.0 / -20.0	+30.0 / -30.0	+50.0 / -50.0	

[Signature]

KURT BALHAZOR  
FLORIDA P.E.  
#56533

MASONITE INTERNATIONAL CORP.  
1955 POWIS ROAD  
WEST CHICAGO, IL 60185

PRODUCT: EXTERIOR DOOR PRODUCT  
WOOD-EDGE STEEL DOOR  
PART OR ASSEMBLY:  
TYPICAL ELEVATIONS  
& GENERAL NOTES

NO. DATE REVISIONS

DATE: 5/26/17  
SCALE: N.T.S.  
DWG. BY: SWS  
CHK. BY:  
DRAWING NO.:  
DWG-MA-FL0211-17  
SHEET 1 of 3

MASONITE INTERNATIONAL CORP.  
1955 POWIS ROAD  
WEST CHICAGO, IL 60185

PRODUCT: EXTERIOR DOOR PRODUCT  
PART OR ASSEMBLY: 6"-8" WOOD-EDGE STEEL OPAQUE DOUBLE DOOR UNIT  
ANCHORING LOCATIONS & DETAILS

REVISIONS

DATE

NO.

DATE: 5/26/17

SCALE: N.T.S.

DWG. BY: SWS

CHK. BY:

DRAWING NO.:

DWG-MA-FLD211-17

SHEET 2 OF 3

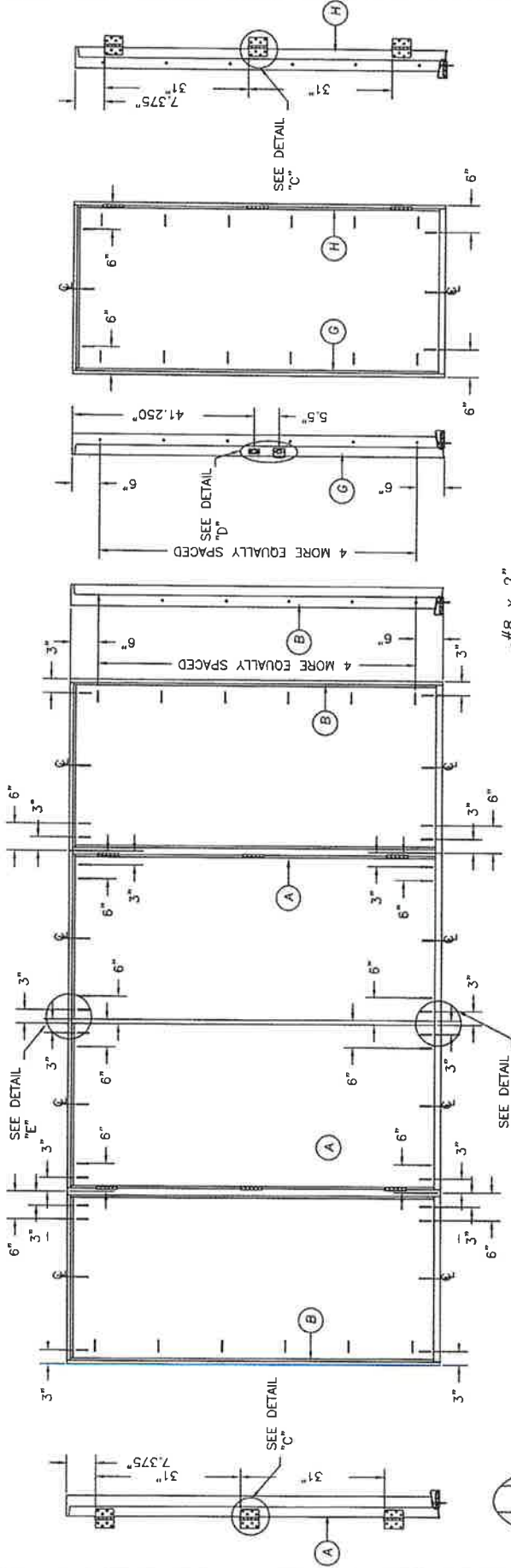

ASTRAGAL RETAINER BOLT HOLE  
MUST BE DRILLED THROUGH  
THE THRESHOLD & INTO THE  
STRUCTURE DEEP ENOUGH  
FOR A 1.375" THROW



DETAIL "F" ASTRAGAL

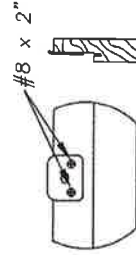

DETAIL "E" ASTRAGAL  
ATTACH ASTRAGAL RETAINER BOLT  
STRIKE PLATE TO FRAME  
AS SHOWN.

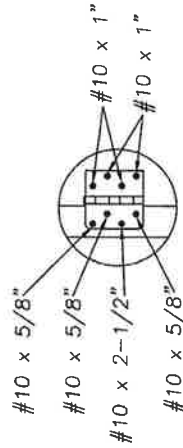

DETAIL "C"

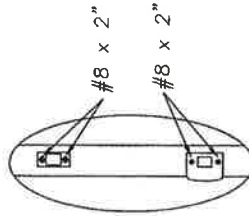

DETAIL "D"



BUMPER O/S THRESHOLD



INSWING THRESHOLD



HIGH DAM O/S THRESHOLD

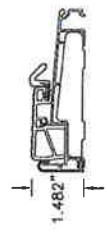

Z-SERIES O/S THRESHOLD

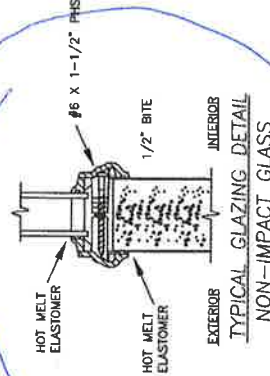

Adendum to NAMA  
Certification No.: NED13747  
Reviewed by: [Signature]  
Date Reviewed: 6/5/17



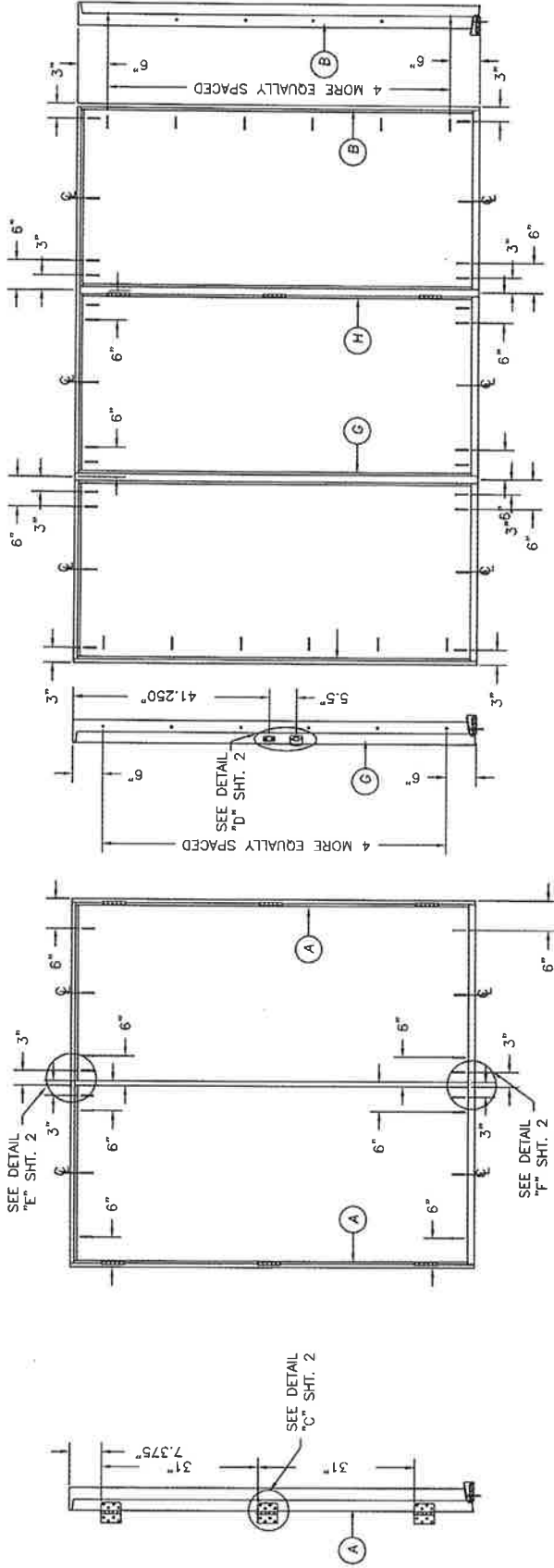

## HARDWARE SCHEDULE

- |    |   |
|----|---|
| 1. | KWIKSET SERIES 400 GRADE 3 CYLINDRICAL LATCH AND SERIES 980 GRADE 1 DEADLOCK HARDWARE TO BE INSTALLED AT 5-1/2" CENTERLINE. |
| 2. | 4" X 4" FULL MORTISE BUTT HINGES.   |

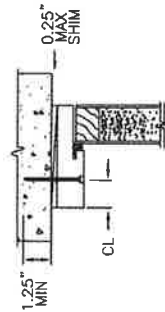

### TYPICAL MASONRY ANCHOR INSTALLATION



COMBINATION WOOD MULLION (BOXED)

(3) #10X2-1/2"  
WOOD SCREWS  
EACH END



INTEGRAL WOOD  
MULLION (CHS)

Addendum to NAMI  
 Certification No. NCO13747  
 Reviewed By: [Signature]  
 Date Reviewed: 6/5/17

ATTACHMENT DETAIL

1. ANCHOR ANALYSIS FOR LOADING CONDITIONS PREPARED, SIGNED AND SEALED BY ROBERTO LOMAS, PE (FLORIDA #62514) WITH THE LOWEST (LEAST) FASTENER RATING FROM THE DIFFERENT FASTENERS BEING CONSIDERED FOR USE. JAMB, HEAD, AND THRESHOLD FASTENERS ANALYZED FOR THIS UNIT INCLUDE #10 WOOD SCREWS OR 1/4" TAPCONS. A PHYSICAL SHIM MUST BE PLACED IN SHIM SPACE AT EACH ANCHOR LOCATION. TAPCON EDGE DISTANCE MIN 2-1/2". WOOD SCREW EDGE DISTANCE MIN 3/4".
2. THE WOOD SCREW SINGLE SHEAR DESIGN VALUES COME FROM ANSI/AF&PA NDA FOR SOUTHERN PINE LUMBER AND ACHIEVEMENT OF 1-1/2" MINIMUM EMBEDMENT. THE TAPCON MUST ACHIEVE MINIMUM EMBEDMENT OF 1-1/4".
3. WOOD BUCKS BY OTHERS MUST BE ANCHORED PROPERLY TO TRANSFER LOADS TO STRUCTURE.
4. MINIMUM DESIGN VALUE STRENGTH OF ANCHORS 155 LBS.

# L. Roberto Lomas P.E.

1432 Woodford Rd.

Lewisville, NC 27023

434-688-0609

[rlomas@rlomaspe.com](mailto:rlomas@rlomaspe.com)

Manufacturer: Masonite

Report #: 514010

Date: 05/01/2017

**Test Report:** N/A

**Product:** Single door 3' x 6'8" (Wood Frame)

## Scope:

This analysis provides calculations, quantities, and spacing requirements for installing product to substrate, and it applies only to the product described herein. These calculations comply with requirements of the Florida Building Code.

## Anchor capacity in shear condition:

Solid members w/ & w/out gap:

### a. With threads present in shear plane

Fastener type: #10 wood screw		(NDS 2012, TR12)	
Nominal diameter:	D: 0.190 in	Gap:	g: 0.0000 in
Root diameter:	Dr: 0.152 in	Moment arm:	0.0000 in
Minimum required penetration:	p: 1.140 in	Screw bending yield strength:	F <sub>yb</sub> = 80,000 psi
Side member:	Douglas Fir-Larch (G=0.50)	Main member:	Spruce-Pine-Fir (G=0.42)
Side member thickness:	t <sub>s</sub> = 1.000 in	Main member thickness:	t <sub>m</sub> = 1.500 in
Side member dowel bearing strength:	F <sub>es</sub> = 4,650 psi	Main member dowel bearing strength:	F <sub>em</sub> = 3,350 psi
Side member dowel bearing length:	l <sub>s</sub> = 1.000 in	Main member dowel bearing length:	l <sub>m</sub> = 1.140 in

Mode I <sub>m</sub>	Mode I <sub>s</sub>	Mode II	Mode III <sub>m</sub>	Mode III <sub>s</sub>	Mode IV
q <sub>m</sub> = 636.5 lbs/in	q <sub>s</sub> = 884 lbs/in	A: 0.0007	A: 0.00096	A: 0.00107	A: 0.0014
P = 725.61 lbs	P = 884 lbs	B: 1.07	B: 0.57	B: 0.5	B: 0.000
K <sub>D</sub> = 2.400	K <sub>D</sub> = 2.400	C: -427.67	C: -253.62	C: -267.7	C: -93.6
Z <sub>m</sub> = 302 lbs	Z <sub>s</sub> = 368 lbs	P = 331 lbs	M <sub>s</sub> = 46.8 in-lbs	M <sub>m</sub> = 46.8 in-lbs	P = 263 lbs
		K <sub>D</sub> = 2.400	P = 297 lbs	P = 319 lbs	K <sub>D</sub> = 2.400
Min. Design value:	Z = 110 lbs	Z = 138 lbs	K <sub>D</sub> = 2.400	K <sub>D</sub> = 2.400	Z = 110 lbs
Duration Factor:	C <sub>D</sub> = 1.6		Z = 124 lbs	Z = 133 lbs	
Allowable Design Value (ZC <sub>D</sub> ):	Z' = 175 lbs/anchor				

Solid members w/ & w/out gap:

### a. With threads present in shear plane

Fastener type: #10 wood screw		(NDS 2012, TR12)	
Nominal diameter:	D: 0.190 in	Gap:	g: 0.0000 in
Root diameter:	Dr: 0.152 in	Moment arm:	0.0000 in
Minimum required penetration:	p: 1.140 in	Screw bending yield strength:	F <sub>yb</sub> = 80,000 psi
Side member:	Douglas Fir-Larch (G=0.50)	Main member:	Steel strap/clip
Side member thickness:	t <sub>s</sub> = 1.000 in	Main member thickness:	t <sub>m</sub> = 0.048 in
Side member dowel bearing strength:	F <sub>es</sub> = 4,650 psi	Main member dowel bearing strength:	F <sub>em</sub> = 61,850 psi
Side member dowel bearing length:	l <sub>s</sub> = 1.000 in	Main member dowel bearing length:	l <sub>m</sub> = 1.140 in

Mode I <sub>m</sub>	Mode I <sub>s</sub>	Mode II	Mode III <sub>m</sub>	Mode III <sub>s</sub>	Mode IV
q <sub>m</sub> = 11752 lbs/in	q <sub>s</sub> = 884 lbs/in	A: 0.0003	A: 0.00059	A: 0.00033	A: 0.0006
P = 13397 lbs	P = 884 lbs	B: 1.07	B: 0.57	B: 0.5	B: 0.000
K <sub>D</sub> = 2.400	K <sub>D</sub> = 2.400	C: -4038.9	C: -3864.9	C: -267.7	C: -93.6
Z <sub>m</sub> = 5582 lbs	Z <sub>s</sub> = 368 lbs	P = 2287 lbs	M <sub>s</sub> = 46.8 in-lbs	M <sub>m</sub> = 46.8 in-lbs	P = 392 lbs
		K <sub>D</sub> = 2.400	P = 2126 lbs	P = 420 lbs	K <sub>D</sub> = 2.400
Min. Design value:	Z = 163 lbs	Z = 953 lbs	K <sub>D</sub> = 2.400	K <sub>D</sub> = 2.400	Z = 163 lbs
Duration Factor:	C <sub>D</sub> = 1.6		Z = 886 lbs	Z = 175 lbs	
Allowable Design Value (ZC <sub>D</sub> ):	Z' = 262 lbs/anchor				

Fastener type: 1/4" ITW Tapcon		N.O.A. 16-1222.06	
Substrate: Hollow block		Minimum embedment:	1.25 in
Edge distance:	4.00 in	Tabulated shear design value:	Z = 202 lbs
Edge distance:	2.00 in	Tabulated shear design value:	Z = 161 lbs
Actual edge distance:	2.50 in	Reduction factor:	0.85
Spacing:	4.00 in	Tabulated shear design value:	Z = 202 lbs
Spacing:	2.00 in	Tabulated shear design value:	Z = 164 lbs
Actual spacing:	3.00 in	Reduction factor:	0.91
Allowable Design Value (Zf <sub>AN</sub> ):	Z' = 155 lbs/anchor		
Minimum anchor capacity:	155 lbs/anchor		

Note: Anchors with the least capacity is used for calculations to qualify anchors with higher capacity.

## Anchor calculations, minimum required anchors

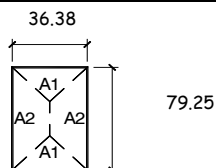

		Design pressure: 85.0 psf						
Zone	Area (ft <sup>2</sup> )	Load (lbs)	Ind. (in)	Max. O.C. (in)	Anchor			Result
					Cap. (lbs)	Qty	Load (lbs)	
A <sub>1</sub>	2.3	195	N/A	N/A	155	2	98	OK
A <sub>2</sub>	7.7	656	6.00	18.00	155	5	131	OK

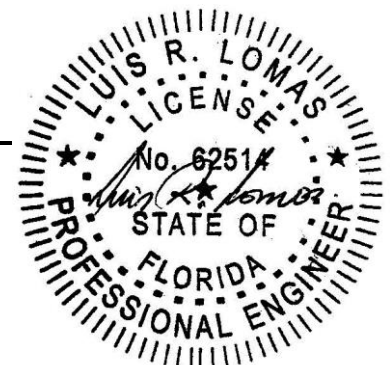

Luis R. Lomas P.E.  
FL No.: 62514  
5/2/2017

**Anchor Locations:**

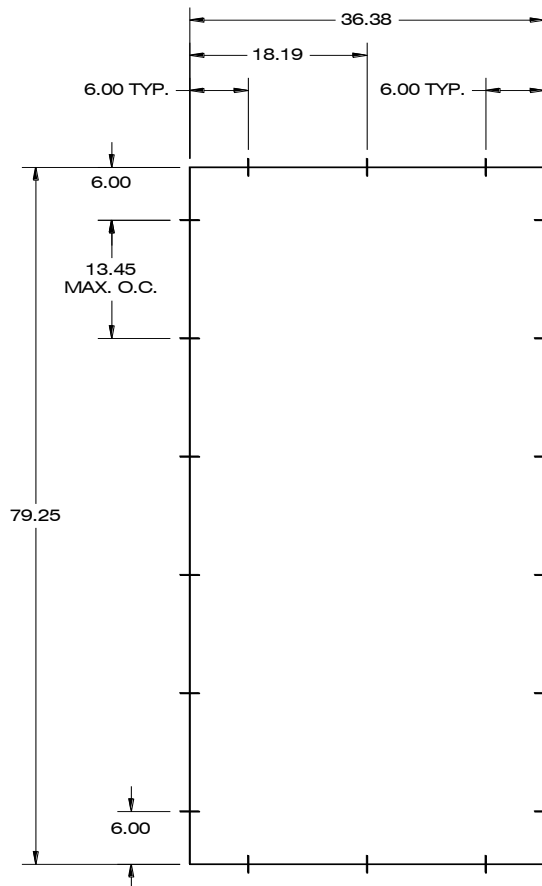

**Installation instructions:**

1. FOR ANCHORING THROUGH FRAME INTO WOOD FRAMING OR 2X BUCK USE #10 WOOD SCREWS WITH SUFFICIENT LENGTH TO ACHIEVE A 1 1/4" MINIMUM EMBEDMENT INTO SUBSTRATE WITH 1/2" MINIMUM EDGE DISTANCE. LOCATE ANCHORS AS SHOWN BELOW.
2. FOR ANCHORING THROUGH FRAME INTO MASONRY/CONCRETE USE 3/16" TAPCONS WITH SUFFICIENT LENGTH TO ACHIEVE A 1 1/4" MINIMUM EMBEDMENT INTO SUBSTRATE WITH 2 1/2" MINIMUM EDGE DISTANCE. LOCATE ANCHORS AS SHOWN BELOW.
3. FOR ANCHORING THROUGH FRAME INTO METAL STRUCTURE USE #10 SMS OR SELF DRILLING SCREWS WITH SUFFICIENT LENGTH TO ACHIEVE 3 THREADS MINIMUM BEYOND STRUCTURE INTERIOR WALL WITH 1/2" MINIMUM EDGE DISTANCE. LOCATE ANCHORS AS SHOWN BELOW.
4. ALL FASTENERS TO BE CORROSION RESISTANT.
5. INSTALLATION ANCHORS SHALL BE INSTALLED IN ACCORDANCE WITH ANCHOR MANUFACTURER'S INSTALLATION INSTRUCTIONS AND ANCHORS SHALL NOT BE USED IN SUBSTRATES WITH STRENGTHS LESS THAN THE MINIMUM STRENGTH SPECIFIED BELOW:
  - A. WOOD: MINIMUM SPECIFIC GRAVITY OF G=0.42
  - B. CONCRETE: MINIMUM COMPRESSIVE STRENGTH OF 2,000 PSI.
  - C. MASONRY: HOLLOW/FILLED BLOCK PER ASTM C90 WITH Fm=2,000PSI MINIMUM.
  - D. METAL STRUCTURE: STEEL 18GA (.048") FY=33KSI/FU=52KSI OR ALUMINUM 6063-T5 FU=30KSI .052" THICK MINIMUM
6. ANCHOR LOCATIONS SHOWN IN THIS DOCUMENT ARE THE MINIMUM REQUIRED FOR THE DESCRIBED PRODUCT EXPOSED AT THE DESIGN PRESSURE INDICATED HEREIN.

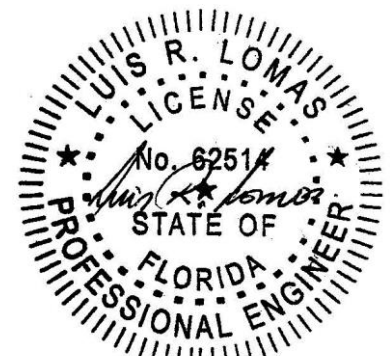

Luis R. Lomas P.E.

FL No.: 62514

5/2/2017





**Product Approval**  
USER: Public User

[Product Approval Menu](#) > **Application Detail**

OFFICE OF THE SECRETARY	FL #	FL5419-R20											
	Application Type	Revision											
	Code Version	2020											
	Application Status	Approved											
		*Approved by DBPR. Approvals by DBPR shall be reviewed and ratified by the POC and/or the Commission if necessary.											
	Comments												
	Archived	<input type="checkbox"/>											
	Product Manufacturer	Simonton/Ply Gem Windows											
	Address/Phone/Email	5020 Weston Parkway Suite 300 Cary, NC 27513 (800) 542-9118 Ext 413596 luanne.harris@cornerstone-bb.com											
	Authorized Signature	Luanne Harris luanne.harris@cornerstone-bb.com											
Technical Representative	Luanne Harris												
Address/Phone/Email	3948 Townsfair Way Suite 200 Columbus, OH 43219 (614) 532-3596 luanne.harris@simonton.com												
Quality Assurance Representative	AAMA												
Address/Phone/Email	1827 Walden Office Square Suite 550 Schaumburg, IL 60173 (847) 303-5664 webmaster@aamanet.org												
Category	Windows												
Subcategory	Double Hung												
Compliance Method	Certification Mark or Listing												
Certification Agency	American Architectural Manufacturers Association												
Validated By	American Architectural Manufacturers Association												
Referenced Standard and Year (of Standard)	<table><tr><th>Standard</th><th>Year</th></tr><tr><td>AAMA 450</td><td>2010</td></tr><tr><td>AAMA 506</td><td>2016</td></tr><tr><td>AAMA/WDMA/CSA 101/I.S.2/A440</td><td>2008</td></tr><tr><td>AAMA/WDMA/CSA 101/I.S.2/A440</td><td>2011</td></tr><tr><td>ASTM E 1886</td><td>2012</td></tr></table>	Standard	Year	AAMA 450	2010	AAMA 506	2016	AAMA/WDMA/CSA 101/I.S.2/A440	2008	AAMA/WDMA/CSA 101/I.S.2/A440	2011	ASTM E 1886	2012
Standard	Year												
AAMA 450	2010												
AAMA 506	2016												
AAMA/WDMA/CSA 101/I.S.2/A440	2008												
AAMA/WDMA/CSA 101/I.S.2/A440	2011												
ASTM E 1886	2012												

Equivalence of Product Standards  
Certified By

Florida Licensed Professional Engineer or Architect  
[FL5419 R20 Equiv FL5419 Equivalency.pdf](#)

Product Approval Method

Method 1 Option A

Date Submitted

11/16/2020

Date Validated

12/14/2020

Date Pending FBC Approval

Date Approved

12/21/2020

#### Summary of Products

FL #	Model, Number or Name	Description
5419.1	07-09 / 07-10 / 07-20 (Retrofit Installation)	StormBreaker Plus 300VL, 8000, PerfeXion Impact, Impact Vinyl Double Hung
<b>Limits of Use</b> <b>Approved for use in HVHZ:</b> No <b>Approved for use outside HVHZ:</b> Yes <b>Impact Resistant:</b> Yes <b>Design Pressure:</b> N/A <b>Other:</b> 53x76 (+55/-60 PSF), 53x76 (+/-50 PSF), 37x84 (+/-60 PSF), 37x76 (+65/-70) - Missile Impact Rating: D		<b>Certification Agency Certificate</b> <a href="#">FL5419 R20 C CAC 07-09 07-20 DH Impact 37x84 R PG60.pdf</a> <a href="#">FL5419 R20 C CAC 07-09 07-20 DH Impact 53x76 R PG55.pdf</a> <a href="#">FL5419 R20 C CAC 07-09 07-20 DH Impact 37x76 R PG65.pdf</a> <a href="#">FL5419 R20 C CAC 07-09-07-20 DH Impact 53x76 R PG50.pdf</a> <a href="#">FL5419 R20 C CAC 07-09-10-20 and 08-09-10-20 Waiver.pdf</a> <b>Quality Assurance Contract Expiration Date</b> 04/23/2022 <b>Installation Instructions</b> <a href="#">FL5419 R20 II IN0364-R12 07-09 07-10 07-20 DH-Impact.pdf</a> Verified By: American Architectural Manufacturers Association Created by Independent Third Party: <b>Evaluation Reports</b> <a href="#">FL5419 R20 AE EvalReport-IN0364-R12.pdf</a> Created by Independent Third Party: Yes
5419.2	07-20 (Nailing Fin Installation)	StormBreaker Plus 300VL, 8000, PerfeXion Impact Vinyl Double Hung Twin
<b>Limits of Use</b> <b>Approved for use in HVHZ:</b> No <b>Approved for use outside HVHZ:</b> Yes <b>Impact Resistant:</b> Yes <b>Design Pressure:</b> +50/-50 <b>Other:</b> 73 x 74 - Missile Impact Rating: D		<b>Certification Agency Certificate</b> <a href="#">FL5419 R20 C CAC 07-20 DH Twin IMP 43x74-R50.pdf</a> <b>Quality Assurance Contract Expiration Date</b> 03/24/2025 <b>Installation Instructions</b> <a href="#">FL5419 R20 II IN0523 SBP 07-20 DH-Twin 2X.pdf</a> Verified By: American Architectural Manufacturers Association Created by Independent Third Party: <b>Evaluation Reports</b> Created by Independent Third Party:
5419.3	07-20 (Nailing Fin Installation)	StormBreaker Plus 300VL, 8000, PerfeXion Impact Vinyl Double Hung
<b>Limits of Use</b> <b>Approved for use in HVHZ:</b> No <b>Approved for use outside HVHZ:</b> Yes <b>Impact Resistant:</b> Yes <b>Design Pressure:</b> N/A <b>Other:</b> 53x76 (+/-50), 53x76 (+55/-60), 37x84 (+/-60), 37x76 (+65/-70) - Missile Impact Rating: D		<b>Certification Agency Certificate</b> <a href="#">FL5419 R20 C CAC 07-09 07-20 DH Impact 37x84 R PG60.pdf</a> <a href="#">FL5419 R20 C CAC 07-09 07-20 DH Impact 53x76 R PG55.pdf</a> <a href="#">FL5419 R20 C CAC 07-09 07-20 DH Impact 37x76 R PG65.pdf</a> <a href="#">FL5419 R20 C CAC 07-09-07-20 DH Impact 53x76 R PG50.pdf</a> <b>Quality Assurance Contract Expiration Date</b> 04/23/2022

		<b>Installation Instructions</b> <a href="#">FL5419_R20_II_IN0589 SBP 07-20 DH 2X.pdf</a> Verified By: American Architectural Manufacturers Association Created by Independent Third Party: <b>Evaluation Reports</b> Created by Independent Third Party:
5419.4	42-19	ProFinish Brickmould 600 with SafePoint Storm Vinyl Double Hung
<b>Limits of Use</b> <b>Approved for use in HVHZ:</b> No <b>Approved for use outside HVHZ:</b> Yes <b>Impact Resistant:</b> Yes <b>Design Pressure:</b> +50/-50 <b>Other:</b> 36 x 63, 36 x 74 and 38 x 72 - Missile Impact Rating: C		<b>Certification Agency Certificate</b> <a href="#">FL5419_R20_C_CAC_42-19 DH Impact Annealed 36x63 R PG50.pdf</a> <a href="#">FL5419_R20_C_CAC_42-19 DH Impact Annealed 36x74 R PG50.pdf</a> <a href="#">FL5419_R20_C_CAC_42-19 DH Impact Annealed 38x72 R PG50.pdf</a> <b>Quality Assurance Contract Expiration Date</b> 09/14/2024 <b>Installation Instructions</b> <a href="#">FL5419_R20_II_IN0540-R3.pdf</a> Verified By: American Architectural Manufacturers Association Created by Independent Third Party: <b>Evaluation Reports</b> <a href="#">FL5419_R20_AE_EvalReport-IN0540-R3.pdf</a> Created by Independent Third Party: Yes
5419.5	42-19	ProFinish Brickmould 600 with SafePoint Storm Vinyl Double Hung Twin
<b>Limits of Use</b> <b>Approved for use in HVHZ:</b> No <b>Approved for use outside HVHZ:</b> Yes <b>Impact Resistant:</b> Yes <b>Design Pressure:</b> +50/-50 <b>Other:</b> 73 x 74 - Missile Impact Rating: C		<b>Certification Agency Certificate</b> <a href="#">FL5419_R20_C_CAC_42-19 DH Twin Impact Annealed 73x74 R PG50.pdf</a> <b>Quality Assurance Contract Expiration Date</b> 10/05/2024 <b>Installation Instructions</b> <a href="#">FL5419_R20_II_IN0550 42-19 Impact DH Twin 2X.pdf</a> Verified By: American Architectural Manufacturers Association Created by Independent Third Party: <b>Evaluation Reports</b> Created by Independent Third Party:

[Back](#) [Next](#)

Contact Us :: [2601 Blair Stone Road, Tallahassee FL 32399](#) Phone: 850-487-1824

The State of Florida is an AA/EEO employer. [Copyright 2007-2013 State of Florida](#). :: [Privacy Statement](#) :: [Accessibility Statement](#) :: [Refund Statement](#)

Under Florida law, email addresses are public records. If you do not want your e-mail address released in response to a public-records request, do not send electronic mail to this entity. Instead, contact the office by phone or by traditional mail. If you have any questions, please contact 850.487.1395. \*Pursuant to Section 455.275(1), Florida Statutes, effective October 1, 2012, licensees licensed under Chapter 455, F.S. must provide the Department with an email address if they have one. The emails provided may be used for official communication with the licensee. However email addresses are public record. If you do not wish to supply a personal address, please provide the Department with an email address which can be made available to the public. To determine if you are a licensee under Chapter 455, F.S., please click [here](#).

Product Approval Accepts:





REV. #	REVISIONS:	REVISED BY:	DATE:
8	ADDED 53x76 SIZE DP50	L.A.T.	6/30/15
9	ADDED TEST REPORT NUMBER TO NOTE 15.	LMH	4/19/17
10	REMOVED PRE-DRILLED HOLES.	LMH	10/27/17
11	UPDATED SIZE CHART-DESIGN PRESSURES.	LMH	7/10/19
12	UPDATED SIZE CHART-NEW TESTING	LMH	11/09/20

12/14/2020  
 Lucas A. Turner, FLPE #58201  
 Turner Eng. & Cons., Inc.  
 FBPE COA #29779  
 2428 Old Natchez Trc. Trl.  
 Camden, TN 38320  
 Ph. 941-380-1574



Lucas Turner  
 2020.12.14  
 103053 -06'00"

MODEL DESIGNATION: Simonton Double Hung Series 07-09 / 07-10 / 07-20 Vinyl Impact Window  
 MAXIMUM OVERALL NOMINAL SIZE: See Size Chart  
 DESIGN PRESSURE RATING: See Size Chart  
 USABLE CONFIGURATIONS: X X  
 GENERAL DESCRIPTION: The head, sill, and side jambs are extruded PVC. The wall thickness through which the anchor screw penetrates is a minimum of 0.070".

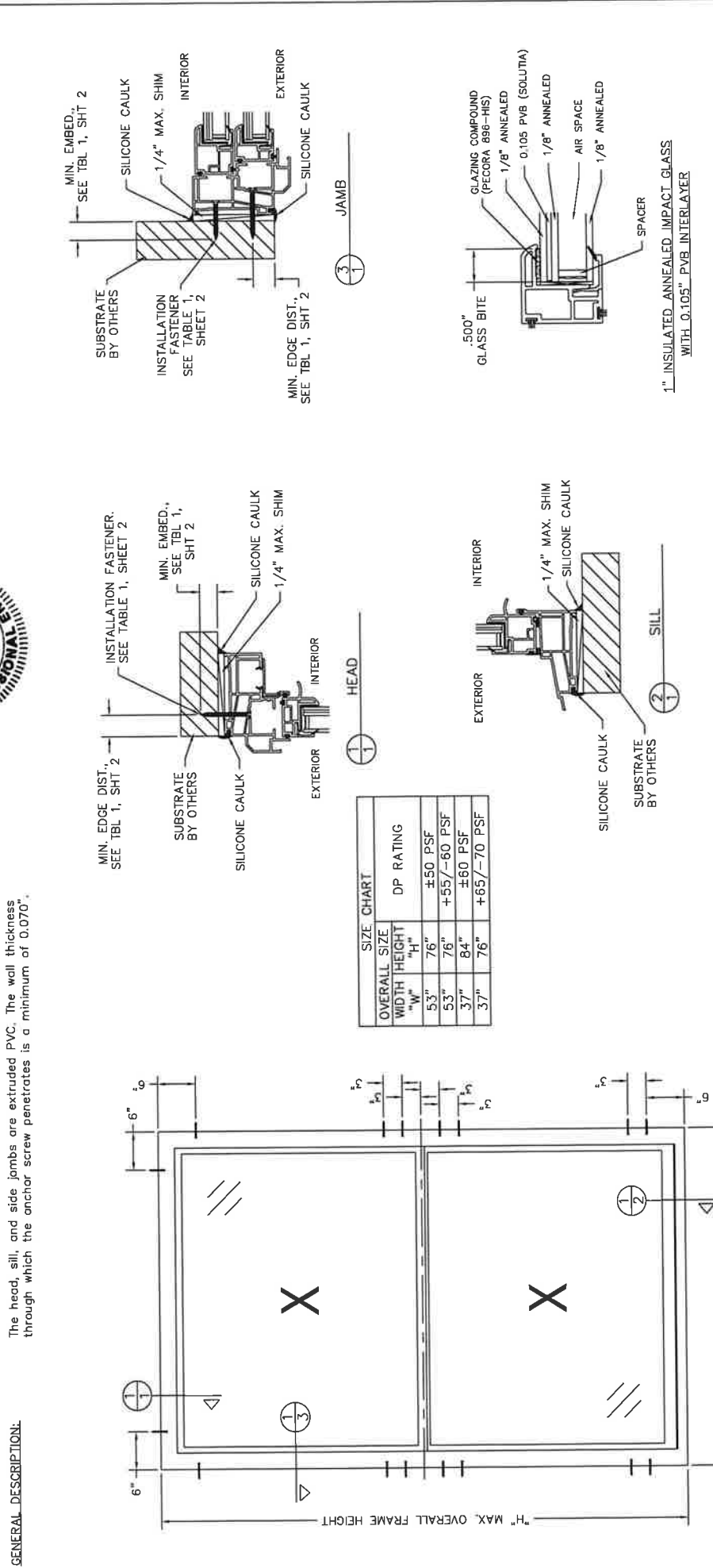

**DISCLOSURE STATEMENT**  
 This document is the property of Simonton Windows, which retains all proprietary and other rights to its subject matter. This document is provided to the recipient on the express condition that it is not to be reproduced, copied, or used for any purpose other than the repair of goods for which it was provided, without the written consent of Simonton Windows. This restriction does not limit the recipient's right to utilize information contained in this document which is properly obtained from another source.

**FILE: FL 5419**

**MATERIAL:**  
 RMS FINISH: SEE TBL 1, SHT 2  
 ALLOY & TEMPER: SEE TBL 1, SHT 2  
 WEIGHT: SEE TBL 1, SHT 2  
 SURFACE AREA: SEE TBL 1, SHT 2  
 FINISH TREATMENT: SEE TBL 1, SHT 2

**Dimensional Tolerances Unless Otherwise Specified**

Dimensional Tolerances Unless Otherwise Specified	Angular	Decimals	Angles
X ± .03			
XX ± .01			
XXX ± .005			

**SCALE:** FIT 1 of 2  
**SERIES:** 07-09 / 07-10 / 07-20 IMPACT DOUBLE HUNG  
**TITLE:** ELEVATION, INSTALLATION DETAILS, SIND, GLAZING DETAIL

**SIMONTON®**  
 W I N D O W S  
 1 Cochran Avenue  
 Pottsville, WV 26415  
 PHONE: 800-368-7777  
 FAX: 304-833-7777  
 E-MAIL: SALES@SIMONTONWINDOWS.COM  
 WEBSITE: WWW.SIMONTONWINDOWS.COM

**SIZE/DRAWING NO.:** REV. 12  
**DATE:** 11/13/08  
**CHECKED BY:** DATE: 11/13/08  
**APPROVED BY:** DATE: 11/13/08

REV. #	REVISIONS	REVISED BY	DATE
8	ADDED 53X76 SIZE DP50	L.A.T.	6/30/15
9	ADDED TEST REPORT NUMBER TO NOTE 15.	LWH	4/16/17
10	REMOVED PRE-DRILLED HOLES. ADDED NOTES 15 & 17 - AAMA 900.	LWH	10/27/17
11	UPDATED SIZE CHART-DESIGN PRESSURES.	LWH	7/10/19
12	UPDATED SIZE CHART-NEW TESTING	LWH	11/09/20

12/14/2020  
 Lucas A. Turner, FLPE #58201  
 Turner Eng. & Cons., Inc.  
 FBPE COA #29779  
 2428 Old Natchez Trc. T11  
 Camden, TN 38320  
 Ph. 941-380-1574

**NOTES:**  
 1. THIS INSTALLATION HAS BEEN EVALUATED FOR USE IN LOCATIONS ADHERING TO THE TEXAS & FLORIDA BUILDING CODES AND WHERE PRESSURE REQUIREMENTS AS DETERMINED BY ASCE 7 MINIMUM DESIGN LOADS FOR BUILDINGS AND OTHER STRUCTURES DO NOT EXCEED THE DESIGN PRESSURE RATINGS HEREIN, FOR USE OUTSIDE THE H.V.H.Z.

2. ALL INTERIOR AND EXTERIOR PERIMETER SURFACES OF THE WINDOW MUST BE CAULKED.  
 3. ANCHOR TYPE, SIZE, SPACING, AND EMBEDMENT SHALL BE AS SPECIFIED IN THESE DRAWINGS.  
 4. ANCHOR EMBEDMENT TO SUBSTRATE SHALL BE BEYOND WALL DRESSING OR STUCCO. FOR CONCRETE/CMU OPENINGS EMBEDMENT SHALL BE BEYOND WOOD BUCKS, IF USED, AND INTO SUBSTRATE. INSTALLATIONS TO SOLID CONCRETE OR GROUT-FILLED CMU MAY INCLUDE BUT DO NOT REQUIRE 1X WOOD BUCKS BETWEEN PRODUCT AND SUBSTRATE. INSTALLATIONS TO HOLLOW CMU REQUIRE THE USE OF 1X BUCKS BETWEEN PRODUCT AND SUBSTRATE.

5. WOOD OR MASONRY OPENINGS, BUCKS, AND BUCK FASTENERS, BY OTHERS, SHALL BE PROPERLY DESIGNED AND INSTALLED TO TRANSFER WIND LOADS TO THE STRUCTURE. SUBSTRATES SHALL MEET THE MINIMUM STRENGTH REQUIREMENTS AS SHOWN IN TABLE I, THIS SHEET. CONCRETE OR MASONRY SUBSTRATES SHALL NOT BE CRACKED.  
 6. THE RESPONSIBILITY FOR SELECTION OF SIMONTON PRODUCTS TO MEET ANY APPLICABLE LOCAL LAWS, BUILDING CODES, ORDINANCES, OR OTHER SAFETY REQUIREMENTS RESTS SOLELY WITH THE ARCHITECT, BUILDING OWNER, OR CONTRACTOR.

7. SHIMS ARE REQUIRED WHERE GAPS OF GREATER THAN 1/16" EXIST BETWEEN OPENING AND FRAME. MAX. SHIM STACK IS 1/4". SHIMS SHALL BE LOAD-BEARING AND CAPABLE OF TRANSFERRING LOADS TO THE SUBSTRATE.  
 8. WHEN USED IN AREAS REQUIRING IMPACT PROTECTION, THIS PRODUCT DOES NOT REQUIRE THE USE OF APPROVED IMPACT RESISTANT SHUTTERS OR OTHER EXTERNAL PROTECTION.

9. SEALING AND FLASHING BY OTHERS SHOULD BE APPLIED USING THE ASTM E 2112 METHODOLOGY APPROPRIATE FOR THE OPENING INTO WHICH THE DOOR IS BEING INSTALLED. OVERALL WATER PENETRATION RESISTANCE OF THE INSTALLED PRODUCT IS THE RESPONSIBILITY OF OTHERS.  
 10. GLAZING SHALL COMPLY WITH ASTM E 1300-04.

11. FOR INSTALLATION TO METAL SUBSTRATES, ANCHORS SHALL BE LONG ENOUGH TO BE FULLY THREADED THROUGH THE METAL THICKNESS WITH AN ADDITIONAL 3/16" MIN. OF THREADS BEYOND.  
 12. A MINIMUM CENTER-TO-CENTER SPACING OF 3" SHALL BE MAINTAINED BETWEEN ALL ELCO ULTRACONS IN ANY DIRECTION.

13. ALL FASTENERS PENETRATING INTO PRESSURE TREATED WOOD SHALL BE CAPABLE OF PREVENTING CORROSION DUE TO REACTION WITH PRESSURE TREATMENT CHEMICALS. ANY DISSIMILAR MATERIALS THAT COME INTO CONTACT SHALL BE PROTECTED TO PREVENT REACTIONS IN ACCORDANCE WITH CODE REQUIREMENTS.  
 14. A WIND LOAD DURATION FACTOR  $C_d = 1.6$  WAS USED FOR THE ANALYSIS OF WOOD SCREWS ONLY.

15. WINDOWS SHALL BE CONSTRUCTED AS SPECIFIED IN TEST REPORTS A8088.01-501-47-R0, A9235.01-501-47-R0, A9261.01-501-47-R1, C7745.01-109-47-R0, D0296.01-501-47-R0, D0963.01-501-47-R0, D0964.01-501-47-R0, D0964.01-501-47-R0, D819.01-109-47-R0, D8118.01-109-47-R0 AND D8120.01-109-47-R0 BY ARCHITECTURAL TESTING, INC AND T259-10 BY FARABAUGH ENGINEERING & TESTING INC.  
 16. USE A BACKER ROD ON ALL JOINTS >3/4" DEEP AND/OR WIDER THAN 1/4". FINISHED CAULK JOINT SHOULD BE A MINIMUM OF 3/8" DEEP.

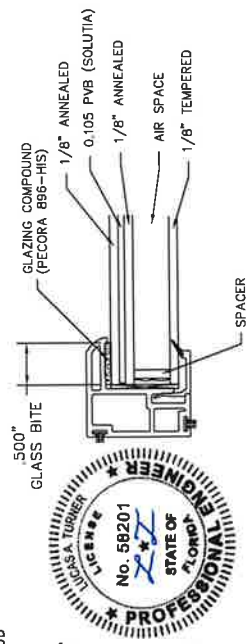

1" INSULATED TEMPERED/ANNEALED IMPACT GLASS  
 WITH 0.105" PVB INTERLAYER  
 37" X 76" AND 53" X 76" DOUBLE HUNG (OPTIONAL)

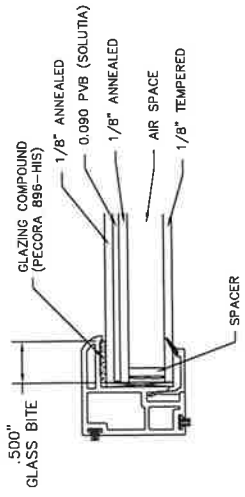

1" INSULATED TEMPERED/ANNEALED IMPACT GLASS  
 WITH 0.090" PVB INTERLAYER  
 37" X 84" DOUBLE HUNG (OPTIONAL)

TABLE 1: INSTALLATION FASTENERS TABLE

ID	SUBSTRATE TYPE	ANCHOR TYPE	MIN. EMBED	MIN. EDGE DIST.
A	CONCRETE (2.85 KSI MIN.)	3/16" ELCO ULTRACON	1"	1"
B	HOLLOW OR GROUT-FILLED CMU (ASTM C90)	3/16" ELCO ULTRACON	1-1/4"	2 1/2"
C	2X MIN. SOUTHERN PINE WOOD (G=0.55)	3/16" ELCO ULTRACON	1-3/8"	3/4"
D	2X MIN. SOUTHERN PINE WOOD (G=0.55)	#10 WOOD SCREW	1-3/8"	3/4"
E	1/8" GAUGE (0.060") MIN. STEEL STUD, 33KSI YIELD MIN.	#10-16 TTW TEK'S SELF-DRILLING SCREW	SEE NOTE 11	1/2"
F	1/8" ALUM. 6063-T5 MIN. OR 1/8" STEEL 36 KSI MIN.	#10 GRADE 5 SELF-TAPPING/DRILLING SCREW	SEE NOTE 11	1/2"

**DISCLOSURE STATEMENT**  
 This document is the property of Simonton Windows, which retains all proprietary and other rights to its subject matter. This document is provided to the recipient on the expressed condition that it is not to be reproduced, copied, or otherwise used in any way without the prior written consent of Simonton Windows. The recipient's rights to utilize information contained in this document which is properly obtained from another source.

MATERIAL:	FINISH TREATMENT:
WMS FINISH:	PERIMETER:
EXCEPT AS NOTED	
ALLOY & TEMPER:	
WEIGHT:	
SURFACE AREA:	
VOLUME:	
PERIMETER:	
DECIMALS	0' 30 min.
ANGLES	XXX ± .005
TOLERANCES	
UNLESS OTHERWISE SPECIFIED	

**SIMONTON**  
 W I N D O W S  
 1 Cochran Avenue  
 Pensacola, WV 26415

SIZE: DRAWING NO. REV. B INO354 12

DATE: 11/13/08

CHECKED BY: DATE:

APPROVED BY: DATE:

SHEET: 2 of 2

SERIES: 07-09 / 07-10 / 07-20 IMPACT DOUBLE HUNG

TITLE: NOTES, ANCHOR TABLE, & OPTIONAL GLAZING DETAILS

**A.L.I**

(Validator / Operations Administrator)

**AAMA  
CERTIFICATION PROGRAM****AUTHORIZATION FOR PRODUCT CERTIFICATION****Simonton Windows  
1 Cochrane Dr.  
Pennsboro, WV 26415****Attn: Tina Seese**

This authorization is based on the successful completion of tests, and the reporting to the AAMA Validator of the results of the tests by an AAMA Accredited Laboratory. The product information below will be added to the next update of the AAMA Certified Products Directory.

SPECIFICATIONS		RECORD OF PRODUCT TESTED			
AAMA/WDMA/CSA 101/I.S.2/A440-08 R-PG60*-940x2134 (37x84)-H	AAMA 506				
COMPANY AND CODE	Missile Level: D Rating: <b>+60/-60, 37x84</b> Wind Zone: <b>4</b>	CPD NO.	SERIES MODEL & PRODUCT DESCRIPTION	MAXIMUM SIZE TESTED	
<b>Simonton Windows Code: SIM</b>	Rating above conforms to the requirements of: <b>ASTM E1886 and E1996</b>	<b>11750</b>	<b>07-09/07-20 STORMBREAKER PLUS DH (PVC)(X/X)(OG) (INS PVB LAM GL) (MODIF)(REINF)(TILT) (ASTM)</b>	<u>FRAME (mm)</u> <b>940 x 2134 (3'1" x 7'0")</b>	<u>SASH (mm)</u> <b>857 x 1048 (2'10" x 3'5")</b>

This Certification will expire **April 23, 2022 (extended from April 23, 2017 per AAMA 103-15)** and requires validation until then by continued listing in the current AAMA Certified Products Directory.

Structural Test &amp; Report By:

**Architectural Testing, Inc.**Report No: **C7745.01-109-47**Date of Report: **June 19, 2013**

Missile Impact Test &amp; Report By:

**Architectural Testing, Inc.**Report No: **D8119.01-109-47; ref. D0963.01-501-47**Date of Report: **June 9, 2014**Evaluated for Certification: **January 6, 2017**  
Associated Laboratories, Inc.Authorized for Certification: **January 6, 2017**  
American Architectural Manufacturers Association

JGS/JTS

ACP-14 (Rev. 6/16)



**A.L.I**

(Validator / Operations Administrator)

**AAMA  
CERTIFICATION PROGRAM****AUTHORIZATION FOR PRODUCT CERTIFICATION****Simonton Windows**  
**1 Cochrane Dr.**  
**Pennsboro, WV 26415****Attn: Tina Seese**

This authorization is based on the successful completion of tests, and the reporting to the AAMA Validator of the results of the tests by an AAMA Accredited Laboratory. The product information below will be added to the next update of the AAMA Certified Products Directory.

SPECIFICATIONS		RECORD OF PRODUCT TESTED			
<b>AAMA/WDMA/CSA 101/I.S.2/A440-08 R-PG55-1346x1930 (53x76)-H Negative Design Pressure = -60 psf</b>	<b>AAMA 506</b>				
COMPANY AND CODE	Missile Level: D Rating: <b>+55/-60, 53x76</b> Wind Zone: 4	CPD NO.	SERIES MODEL & PRODUCT DESCRIPTION	MAXIMUM SIZE TESTED	
<b>Simonton Windows Code: SIM</b>	Rating above conforms to the requirements of: <b>ASTM E1886 and E1996</b>	<b>11730</b>	<b>07-09/07-20 STORMBREAKER PLUS DH (PVC)(X/X)(OG) (INS 0.105" PVB LAM GL) (MODIF)(REINF)(TILT) (ASTM)</b>	<u><b>FRAME (mm)</b></u> <b>1346 x 1930 (4'5" x 6'4")</b>	<u><b>SASH (mm)</b></u> <b>1267 x 946 (4'2" x 3'1")</b>

This Certification will expire **November 6, 2022 (extended from November 6, 2017 per AAMA 103-15)** and requires validation until then by continued listing in the current AAMA Certified Products Directory.

Structural Test &amp; Report By:

**Architectural Testing, Inc.**Report No: **D0965.01-501-47**Date of Report: **November 15, 2013**

Missile Impact Test &amp; Report By:

**Architectural Testing, Inc.**Report No: **D8120.01-109-47; ref. D0964.01-501-47**Date of Report: **June 10, 2014; November 15, 2013**Evaluated for Certification: **April 26, 2017**  
Associated Laboratories, Inc.Authorized for Certification: **April 26, 2017**

American Architectural Manufacturers Association

JGS/JTS

ACP-14 (Rev. 6/16)



**AAMA CERTIFICATION PROGRAM**  
An FGIA Product Certification Program

**AUTHORIZATION FOR PRODUCT CERTIFICATION**



**Simonton Windows**  
**1 Cochrane Dr.**  
**Pennsboro, WV 26415**

**Attn: Tina Seese**

This authorization is based on the successful completion of tests, and the reporting to the AAMA Validator of the results of the tests by an AAMA Accredited Laboratory. The product information below will be added to the next update of the AAMA Certified Products Directory.

SPECIFICATIONS		RECORD OF PRODUCT TESTED			
<b>AAMA/WDMA/CSA 101/I.S.2/A440-08</b> <b>R-PG65*-940x1930 (37x76)-H</b> Negative Design Pressure = -70 psf	<b>AAMA 506-06</b>				
COMPANY AND CODE	Missile Level: D Rating: <b>+65/-70, 37x76</b> Wind Zone: <b>4</b>	CPD NO.	SERIES MODEL & PRODUCT DESCRIPTION	MAXIMUM SIZE TESTED	
<b>Simonton Windows</b> <b>Code: SIM</b>	Rating above conforms to the requirements of: <b>ASTM E1886</b> <b>and E1996</b>	<b>12079</b>	<b>07-09/07-20</b> <b>STORMBREAKER PLUS DH</b> <b>(PVC)(X/X)(OG)</b> <b>(INS 0.105" PVB LAM GL)</b> <b>(MODIF)(REINF)(TILT)(ASTM)</b>	<u>FRAME (mm)</u> <b>940 x 1930</b> <b>(3'1" x 6'4")</b>	<u>SASH (mm)</u> <b>857 x 946</b> <b>(2'10" x 3'1")</b>

This Certification will expire **August 6, 2022 (extended from August 6, 2017 per AAMA 103-19)** and requires validation until then by continued listing in the current AAMA Certified Products Directory.

**Structural Test & Report By:**

**Architectural Testing, Inc. & Farabaugh Engineering & Testing, Inc.**

Report No: **D0296.01-501-47; ref. T259-10**

Date of Report: **August 20, 2013; August 3, 2010**

**Missile Impact Test & Report By:**

**Architectural Testing, Inc.**

Report No: **D8118.01-109-47; ref. D0962.01-501-47**

Date of Report: **June 9, 2014; November 15, 2013**

Evaluated for Certification: **November 12, 2020**

  
Associated Laboratories, Inc.

Authorized for Certification: **November 12, 2020**

  
Fenestration and Glazing Industry Alliance



(Validator / Operations Administrator)

**A.L.I**

(Validator / Operations Administrator)

**AAMA  
CERTIFICATION PROGRAM****AUTHORIZATION FOR PRODUCT CERTIFICATION****Simonton Windows  
1 Cochrane Dr.  
Pennsboro, WV 26415****Attn: Tina Seese**

This authorization is based on the successful completion of tests, and the reporting to the AAMA Validator of the results of the tests by an AAMA Accredited Laboratory. The product information below will be added to the next update of the AAMA Certified Products Directory.

SPECIFICATIONS		RECORD OF PRODUCT TESTED			
AAMA/WDMA/CSA 101/I.S.2/A440-08 R-PG50-1346x1930 (53x76)-H	AAMA 506-06				
COMPANY AND CODE	Missile Level: D Rating: +50/-50, 53x76 Wind Zone: 4	CPD NO.	SERIES MODEL & PRODUCT DESCRIPTION	MAXIMUM SIZE TESTED	
Simonton Windows Code: SIM	Rating above conforms to the requirements of: <b>ASTM E1886 and E1996</b>	6644	07-09/07-20 STORMBREAKER PLUS DH (PVC)(X/X)(OG) (INS TEMP/0.105" PVB LAM GL) (MODIF)(REINF)(TILT)(ASTM)	<u>FRAME (mm)</u> 1346 x 1930 (4'5" x 6'4")	<u>SASH (mm)</u> 1267 x 946 (4'2" x 3'1")

This Certification will expire **July 28, 2024 (extended from July 28, 2019 per AAMA 103-19)** and requires validation until then by continued listing in the current AAMA Certified Products Directory.

Structural Test &amp; Report By:

**Farabaugh Engineering & Testing, Inc. & Architectural Testing, Inc.**Report No: **T259-10 & A9235.01-501-47**Date of Report: **August 3, 2010 & May 12, 2011**

Missile Impact Test &amp; Report By:

**Architectural Testing, Inc.**Report No: **A8088.01-501-47; ref. A9261.01-501-47 Rev.1**Date of Report: **April 5, 2011; May 23, 2011 (Revised May 24, 2012)**Evaluated for Certification: **April 16, 2019**  
Associated Laboratories, Inc.Authorized for Certification: **April 16, 2019**

American Architectural Manufacturers Association

JGS/JTS

ACP-14 (Rev. 6/16)





(Validator / Operations Administrator)

**AAMA  
CERTIFICATION PROGRAM  
WAIVER OF RETEST REQUEST**



February 24, 2015

Simonton Windows  
1 Cochrane Drive  
Pennsboro, WV 26415

Attn: Tiffany Davies  
Coastal Code Specialist

Dear Tiffany,

Per your written request, you are hereby granted a waiver of retest to modify the sash frames on your Series 07-09 Picture, Double Hung and Horizontal Slider and 08-09 Awning and Casement product lines. The new frame codes will be identified as -10 and -20.

The test results and drawings included with your waiver request provide evidence of performance equivalence for the Series -10 flange frame and the Series -20 J-channel frame. The installation fasteners and locations are to remain unchanged.

Sincerely,

Brad Schultz  
Associated Laboratories, Inc.

Jason Seals  
AAMA Certification Program

**Evaluation Report IN0364-R12**  
December 5, 2020

**Product Description:** Double Hung Series 07-09 / 07-10 / 07-20 Vinyl Impact Window

**Manufacturer:** Simonton Windows, 1 Cochrane Ave., Pennsboro, WV

**Statement of Compliance:** This report evaluates the above-listed product per the requirements of FAC Product Approval Rule Chapter 61G20-3.005 (4). This product complies with the requirements of the 6<sup>th</sup> Edition (2017) Florida Building Code and 7<sup>th</sup> Edition (2020) Florida Building Code outside the High Velocity Hurricane Zone. The product testing standards performed are outlined below.

**Technical Documentation:**

- 1) This report, prepared by Lucas A. Turner, P.E., at 2428 Old Natchez Trc Trl, Camden, TN
- 2) Installation drawing IN0364-R12, signed and sealed by Lucas A. Turner, P.E.
- 3) Test Reports A8088.01-501-47-r0, A9235.01-501-47-r0, A9261.01-501-47-r1, C7745.01-109-47-r0, D0296.01-501-47-r0, D0962.01-501-47-r0, D0963.01-501-47-r0, D0964.01-501-47-r0, D8119.01-109-47-r0, D8118.01-109-47-r0, D8120.01-109-47, and D0965.01-501-47-r0, from Architectural Testing, Inc., Springdale and York, PA, and T259-10 from Farabaugh Engineering & Testing, Inc., McKeesport, PA, with testing performed in equivalence with: AAMA/WDMA/CSA 101/I.S.2/A440-08, ASTM E1886-12, ASTM E1996-17, and AAMA 506-06/11/16
- 4) Supplemental Calculations to support IN0364-R12, signed and sealed by Lucas A. Turner, P.E.

**Installation:** Units must be installed according to installation drawing IN0364-R12.

**Limitations of Use:** This product:

- May be used in the configurations, product sizes, and with glazing as indicated in IN0364-R12
- Is large missile impact resistant (missile level D, wind zone 4) and does not require the use of shutters in windborne debris regions
- May not be used in the High Velocity Hurricane Zone
- Requires white SimEx, Inc. PVC extrusions with current listing as an AAMA Certified Profile Licensee under AAMA 303

**Certification of Independence:** I do not have, nor do I intend to acquire, nor will I acquire, a financial interest in Simonton Windows or in any company manufacturing or distributing products for which this report is being issued. I do not have, nor do I intend to acquire, nor will I acquire, a financial interest in any other entity involved in the testing or approval process of this product.

Lucas Turner  
2020.12.05  
14:16:51  
-06'00'



22  
12/5/2020  
Lucas A. Turner, P.E.  
FL PE #58201