

Columbia County Property Appraiser

updated: 4/17/2020

Parcel: 06-7S-16-04149-515

<< Next Lower Parcel Next Higher Parcel >>

Tax Collector

Tax Estimator

Property Card

Parcel List Generator

2019 TRIM (pdf)

Interactive GIS Map

Print

Owner & Property Info

Search Result: 1 of 1

| | | | |
|---|---|--------------|------|
| Owner's Name | BAUGHN WILLARD | | |
| Mailing Address | 4452 NW WISTERIA DR LAKE CITY, FL 32-55 | | |
| Site Address | | | |
| Use Desc. (code) | VACANT (000000) | | |
| Tax District | 3 (County) | Neighborhood | 6716 |
| Land Area | 1.620 ACRES | Market Area | 02 |
| Description | NOTE: This description is not to be used as the Legal Description for this parcel in any legal transaction. | | |
| LOT 15 BLOCK 5 WILSON SPRINGS COMMUNITY PHASE 1-A. ORB 962-1828, COMM NE COR OF SE1/4 RUN S 1218.72 FT, SW 142.34 FT, TO POB. SE 183.22 FT, TO A POINT ON THE W LINE OF SEC 6 CONT SE 522.62 FT, TO POINT ON THE NW'ERLY R/W LINE OF SW MEMORIAL DR. SW ALONG R/W 100.10 FT, NW 374.40 FT. TO POINT ON THE E LINE OF SEC 1 CONT NW 314.86 FT, NE 103.15 FT. TO POB. WD 1289-386 | | | |

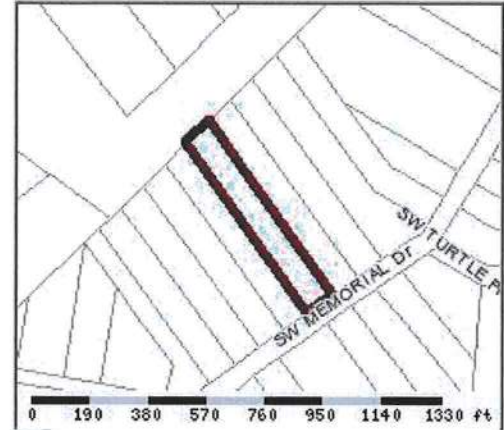

Property & Assessment Values

| 2019 Certified Values | | |
|------------------------------|--|-------------|
| Mkt Land Value | cnt: (0) | \$14,547.00 |
| Ag Land Value | cnt: (2) | \$0.00 |
| Building Value | cnt: (0) | \$0.00 |
| XFOB Value | cnt: (0) | \$0.00 |
| Total Appraised Value | | \$14,547.00 |
| Just Value | | \$14,547.00 |
| Class Value | | \$0.00 |
| Assessed Value | | \$14,547.00 |
| Exempt Value | | \$0.00 |
| Total Taxable Value | Cnty: \$14,547 Other: \$14,547 Schl: \$14,547 | |

| 2020 Working Values | | | (...Hide Values) |
|------------------------------|--|-------------|------------------|
| Mkt Land Value | cnt: (0) | \$14,547.00 | |
| Ag Land Value | cnt: (2) | \$0.00 | |
| Building Value | cnt: (0) | \$0.00 | |
| XFOB Value | cnt: (0) | \$0.00 | |
| Total Appraised Value | | \$14,547.00 | |
| Just Value | | \$14,547.00 | |
| Class Value | | \$0.00 | |
| Assessed Value | | \$14,547.00 | |
| Exempt Value | | \$0.00 | |
| Total Taxable Value | Cnty: \$14,547 Other: \$14,547 Schl: \$14,547 | | |

NOTE: 2020 Working Values are NOT certified values and therefore are subject to change before being finalized for ad valorem assessment purposes.

Sales History

Show Similar Sales within 1/2 mile

| Sale Date | OR Book/Page | OR Code | Vacant / Improved | Qualified Sale | Sale RCode | Sale Price |
|-----------|--------------|---------|-------------------|----------------|------------|-------------|
| 2/4/2015 | 1289/386 | WD | V | Q | 01 | \$12,000.00 |
| 9/16/2002 | 962/1828 | WD | V | Q | | \$12,000.00 |

Building Characteristics

| Bldg Item | Bldg Desc | Year Blt | Ext. Walls | Heated S.F. | Actual S.F. | Bldg Value |
|-----------|-----------|----------|------------|-------------|-------------|------------|
| NONE | | | | | | |

Extra Features & Out Buildings

| Code | Desc | Year Blt | Value | Units | Dims | Condition (% Good) |
|------|------|----------|-------|-------|------|--------------------|
| NONE | | | | | | |

Land Breakdown

| Lnd Code | Desc | Units | Adjustments | Eff Rate | Lnd Value |
|----------|---------------|------------------------|---------------------|-------------|-------------|
| 000000 | VAC RES (MKT) | 1 LT - (0000001.620AC) | 1.00/1.00/1.00/1.00 | \$12,547.36 | \$12,547.00 |
| 009946 | WELL (MKT) | 1 UT - (0000000.000AC) | 1.00/1.00/1.00/1.00 | \$2,000.00 | \$2,000.00 |

Columbia County Property Appraiser

updated: 4/17/2020