

# Columbia County, FLA - Building & Zoning Property Map

Printed Fri Dec 13 2024 09:39:09 GMT-0500 (Eastern Standard Time)

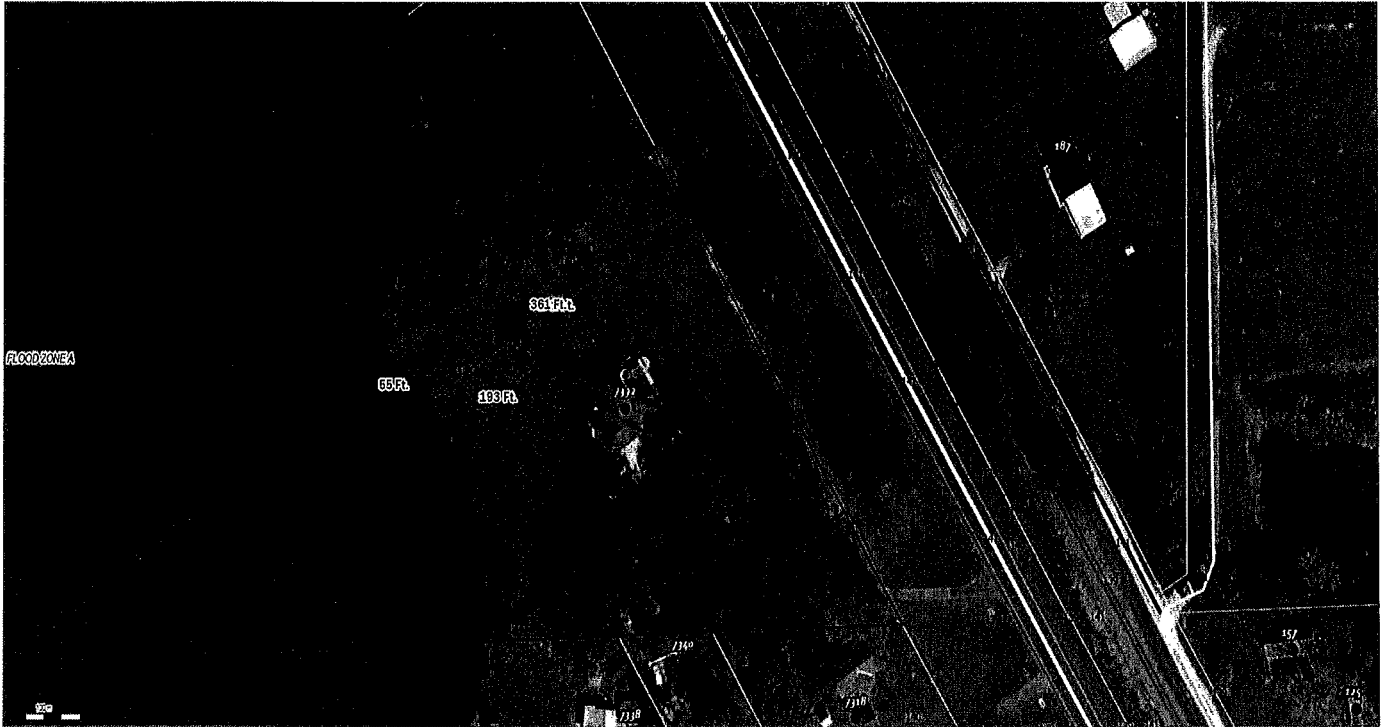

Parcel No: 27-2S-16-01770-140  
Owner: SCOTT WILLIAM, SCOTT CARMEN  
Subdivision: COUNTRY LANE ESTATES  
Lot: 40  
Acres: 5.1381917  
Deed Acres: 5.01 Ac  
District: District 1 Ronald Williams  
Future Land Uses: Agriculture - 3  
Flood Zones: A,  
Official Zoning Atlas: A-3

All data, information, and maps are provided "as is" without warranty or any representation of accuracy, timeliness of completeness. Columbia County, FL makes no warranties, express or implied, as to the use of the information obtained here. There are no implied warranties of merchantability or fitness for a particular purpose. The requester acknowledges and accepts all limitations, including the fact that the data, information, and maps are dynamic and in a constant state of maintenance, and update.