

Mobile Home Permit Worksheet

Installer: William Price License # 114-1041936

Address of home being installed 7160 SW Maxwell
Jacksonville FL 32024

Manufacturer Clayton Length x width 56x28

NOTE: if home is a single wide fill out one half of the blocking plan
if home is a triple or quad wide sketch in remainder of home
I understand Lateral Arm Systems cannot be used on any home (new or used)
where the sidewall ties exceed 5 ft 4 in.

Installer's initials WLP

Typical pier spacing

2' 5'

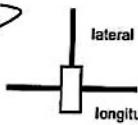

Show locations of Longitudinal and Lateral Systems
(use dark lines to show these locations)

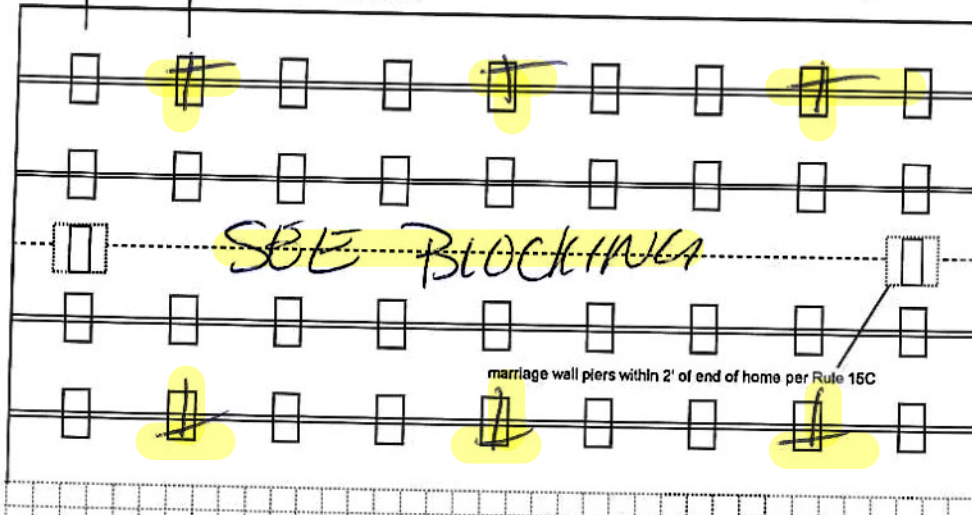

WYHOLU Oliver
System



Application Number: _____ Date: _____

New Home ☒ Used Home ☐

Home installed to the Manufacturer's Installation Manual ☒
Home is installed in accordance with Rule 15-C ☒

Single wide ☐ Wind Zone II ☒ Wind Zone III ☐

Double wide ☒ Installation Decal # 119209

Triple/Quad ☐ Serial # TB1

PIER SPACING TABLE FOR USED HOMES

Load bearing capacity	Footer size (sq in)	16" x 16" (256)	18 1/2" x 18 1/2" (342)	20" x 20" (400)	22" x 22" (484)*	24" x 24" (576)*	26" x 26" (676)
1000 psf		3'	4'	5'	6'	7'	8'
1500 psf		4' 6"	6'	7'	8'	8'	8'
2000 psf		6'	8'	8'	8'	8'	8'
2500 psf		7' 6"	8'	8'	8'	8'	8'
3000 psf		8'	8'	8'	8'	8'	8'
3500 psf		8'	8'	8'	8'	8'	8'

* Interpolated from Rule 15C-1 pier spacing table.

PIER PAD SIZES

I-beam pier pad size 17x25

Perimeter pier pad size 14x16

Other pier pad sizes (required by the mfg.) _____

Draw the approximate locations of marriage wall openings 4 foot or greater. Use this symbol to show the piers.

List all marriage wall openings greater than 4 foot and their pier pad sizes below.

Opening Large Pier pad size 23x31

TIEDOWN COMPONENTS

ongitudinal Stabilizing Device (LSD)
Manufacturer _____
Longitudinal Stabilizing Device w/ Lateral Arms
Manufacturer Oliver Tech

POPULAR PAD SIZES

Pad Size	Sq In
16 x 16	256
16 x 18	288
18.5 x 18.5	342
16 x 22.5	360
17 x 22	374
13 1/4 x 26 1/4	348
20 x 20	400
17 3/16 x 25 3/16	441
17 1/2 x 25 1/2	446
24 x 24	576
26 x 26	676

ANCHORS

4 ft XV 5 ft

FRAME TIES

within 2' of end of home spaced at 5' 4" oc XV

OTHER TIES

Number _____
Sidewall _____
Longitudinal _____
Marriage wall _____
Shearwall _____

Mobile Home Permit Worksheet

POCKET PENETROMETER TEST

The pocket penetrometer tests are rounded down to _____ psf or check here to declare 1000 lb. soil _____ without testing.

x 1000 x 1000 x 1000

POCKET PENETROMETER TESTING METHOD

1. Test the perimeter of the home at 6 locations.
2. Take the reading at the depth of the footer.
3. Using 500 lb. increments, take the lowest reading and round down to that increment.

x 1000 x 1000 x 1000

TORQUE PROBE TEST

The results of the torque probe test is _____ inch pounds or check here if you are declaring 5' anchors without testing _____. A test showing 275 inch pounds or less will require 5 foot anchors.

Note: A state approved lateral arm system is being used and 4 ft. anchors are allowed at the sidewall locations. I understand 5 ft anchors are required at all centerline tie points where the torque test reading is 275 or less and where the mobile home manufacturer may requires anchors with 4000 lb holding capacity.

Installer's initials WLD

ALL TESTS MUST BE PERFORMED BY A LICENSED INSTALLER

Installer Name _____

Date Tested _____

Electrical

Connect electrical conductors between multi-wide units, but not to the main power source. This includes the bonding wire between multi-wide units. Pg. ✓

Plumbing

Connect all sewer drains to an existing sewer tap or septic tank. Pg. ✓

Connect all potable water supply piping to an existing water meter, water tap, or other independent water supply systems. Pg. _____



Application Number: _____ Date: _____

Site Preparation

Debris and organic material removed 90%
Water drainage: Natural Swale Pad ✓ Other _____

Fastening multi wide units

Floor: Type Fastener 1/2" x 6" Length: _____ Spacing: 18"
Walls: Type Fastener 1/2" x 6" Length: _____ Spacing: 18"
Roof: Type Fastener 1/2" x 6" Length: _____ Spacing: 18"
For used homes a min. 30 gauge, 8" wide, galvanized metal strip will be centered over the peak of the roof and fastened with galv. roofing nails at 2" on center on both sides of the centerline.

Gasket (weatherproofing requirement)

I understand a properly installed gasket is a requirement of all new and used homes and that condensation, mold, mildew and buckled marriage walls are a result of a poorly installed or no gasket being installed. I understand a strip of tape will not serve as a gasket.

Installer's initials WLD

Type gasket FORM
Pg. 41
Installed: ✓
Between Floors Yes ✓
Between Walls Yes ✓
Bottom of ridgebeam Yes ✓

Weatherproofing

The bottomboard will be repaired and/or taped. Yes ✓ Pg. _____
Siding on units is installed to manufacturer's specifications. Yes ✓
Fireplace chimney installed so as not to allow intrusion of rain water. Yes ✓

Miscellaneous

Skirting to be installed. Yes ✓ No _____
Dryer vent installed outside of skirting. Yes ✓ N/A ✓
Range downflow vent installed outside of skirting. Yes ✓ N/A ✓
Drain lines supported at 4 foot intervals. Yes ✓
Electrical crossovers protected. Yes ✓
Other: _____

Installer verifies all information given with this permit worksheet is accurate and true based on the manufacturer's installation instructions and or Rule 15C-1 & 2

Installer Signature [Signature] Date 8/7/25



- Tie down - 48' anchor 5'4" o/c
- - Support pier typ - 17x25 abs or 23x31 abs or triple stacked 17x25 abs
- ▨ - Support pier typ - 17x25 abs w/ 8x8 16 5' o/c
- > Double frame tie - 48' anchor 5' from end then 12' o/c
- ✱ Lower System
- * All perimeter doors - 16x16
- * All perimeter shear wall anchors 5' o/c

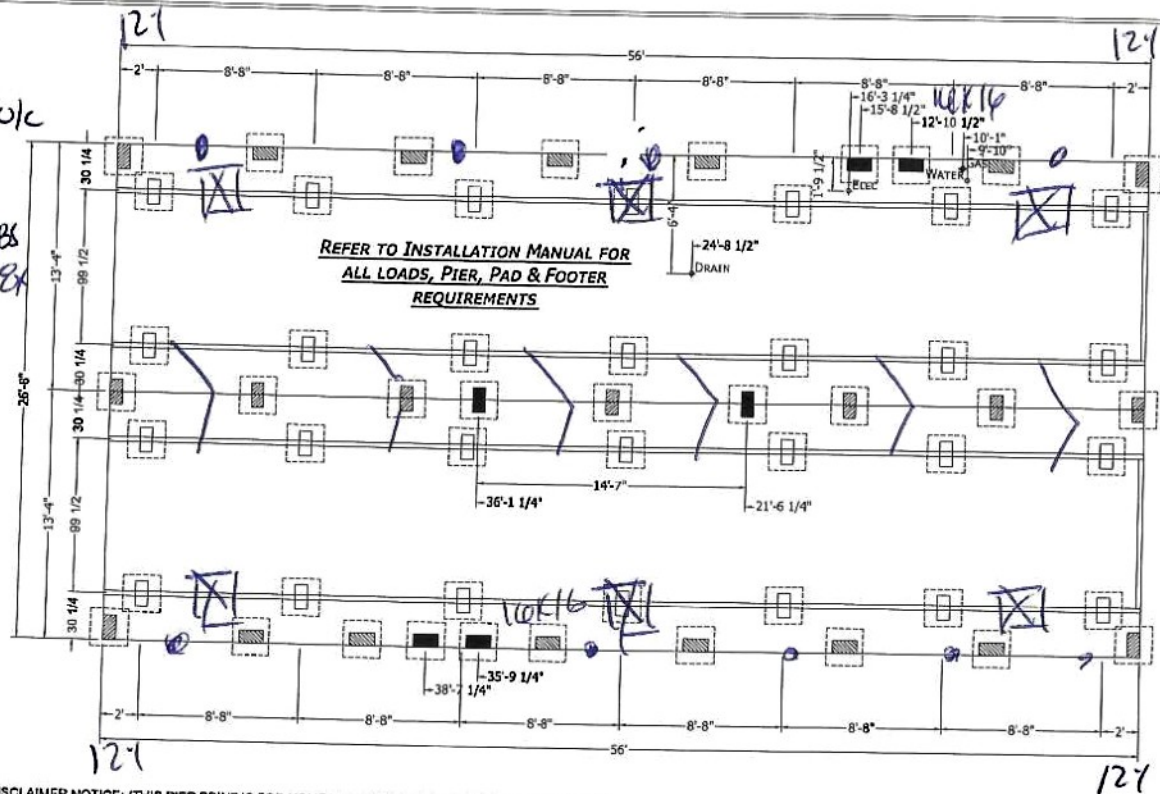

MANUFACTURER DISCLAIMER NOTICE: (THIS PIER PRINT IS FOR HOMES PRODUCED ON OR AFTER JUNE 1ST 2006)
PLEASE READ AND UNDERSTAND THE FOLLOWING INFORMATION. THE MANUFACTURER DOES NOT DO FOUNDATION INSTALLATION OF HOMES. IT WILL BE THE RESPONSIBILITY OF THE DEALER/SITE CONTRACTOR TO INSURE THAT ALL SITE WORK WILL CORRELATE WITH THE UNIT ORDERED.

NOTICE TO HOME INSTALLERS: MANUFACTURED HOMES WEIGH SEVERAL TONS. DO NOT ATTEMPT TO INSTALL ANY HOME ON SITE WITHOUT HAVING EXPERIENCE, KNOWLEDGE, AND UNDERSTANDING OF ALL INSTALLATION REQUIREMENTS. FAILURE TO MEET THESE REQUIREMENTS MAY RESULT IN SERIOUS INJURY OR DEATH TO AN INEXPERIENCED INSTALLER. INSTALLERS: PLEASE READ AND UNDERSTAND THE SET-UP AND INSTALLATION MANUAL SUPPLIED WITH THE HOME BEFORE ATTEMPTING ANY INSTALLATION OF ANY MANUFACTURED HOME.

- 1) THE MANUFACTURER ASSUMES NO RESPONSIBILITY FOR ACTUAL FOUNDATION DESIGN AND CONSTRUCTION.
- 2) ADDITIONAL BLOCKING IS REQUIRED AT EACH SIDE OF EXTERIOR DOORS AND AT EACH SIDE OF SIDEWALL OPENINGS GREATER THAN 4 FEET IN WIDTH (E.G., PATIO DOORS, PICTURE WINDOWS, ETC.).
- 3) FOR PIER REQUIREMENTS AT ENDWALL SEE FIGURE 8 IN THE INSTALLATION MANUAL.
- 4) ALL DWV, PLUMBING, GAS SUPPLY, ETC., DIMENSIONS ON PRINT MAY BE + OR - 12".

- 5) IT WILL BE THE RESPONSIBILITY OF THE SITE CONTRACTOR TO VERIFY THE PROPER LOCATION OF COLUMN SUPPORT BLOCKING AND TO VERIFY THE PROPER MATING LINE GROWTH DIMENSIONS BASED UPON ACTUAL SITE CONDITIONS AND REQUIREMENTS (DOUBLE WIDES ONLY).
- 6) ALLOW 1/2" AT MATING LINE FOR MATE UP GROWTH.
- 7) SEE SET-UP AND INSTALLATION MANUAL FOR PERIMETER BLOCKING REQUIREMENTS.

PERMANENT FOUNDATIONS: CHECK LOCAL BUILDING CODES AND REGULATIONS AND CONSULT A REGISTERED PROFESSIONAL OR STRUCTURAL ENGINEER WHEN YOU ARE SITING YOUR HOME ON A PERMANENT FOUNDATION (SUCH AS A FULL BASEMENT, CRAWL SPACE, OR LOAD BEARING PERIMETER FOUNDATION).

- = FRAME PIER
- = POINT LOAD PIER
- ▨ = PERIMETER PIER

**CHAMPION
HOME BUILDERS**

750 W. BIG BEAVER ROAD, SUITE 1000, TROY, MI 48064
PHONE: 248-614-8900

MODIFICATIONS

PROJECT:
2856H32P01
56'-0" x 26'-8"
3 BD 2 BT

DRAWN BY: B. CAMPBELL
DATE: 02-10-22
SCALE: 5/32" = 1'-0"

TITLE:
**PIER
FOUNDATION
PLAN**

FILENAME: 285-2856H32P01 5-24-2022

SHEET:
PR-101

\$

PROPRIETARY AND CONFIDENTIAL
THESE DRAWINGS AND SPECIFICATIONS ARE ORIGINAL
PROPERTY AND CONFIDENTIAL MATERIALS OF CHAMPION
COPYRIGHT © 1974-2022 BY CHAMPION

Burnett

Prime Series

1,493 SQ. FT. (Approximate) 3 Bedrooms, 2 Baths



Last Updated: 6-21-24

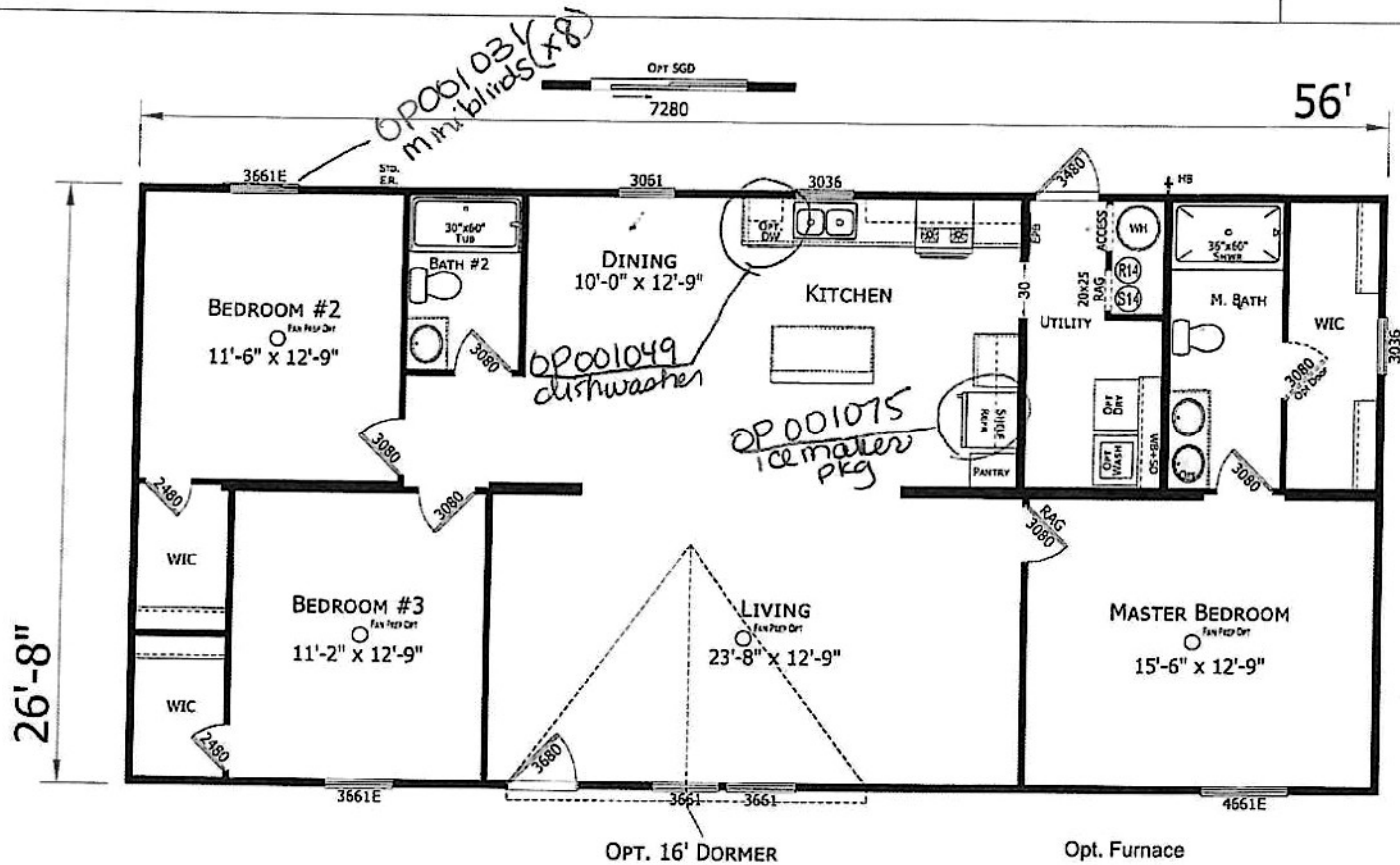

CHAMPION HOMES CENTER
1915A SE SR100
Lake City, Florida 32025

FactoryHomeSale.com | 1-800-965-3052

IMPORTANT: Champion Homes reserves the right to modify, cancel or substitute products or features of this event at any time without prior notice or obligation. Pictures and other promotional materials are representative and may depict or contain floor plans, square footages, elevations, options, upgrades, extra design features, decorations, floor coverings, specialty light fixtures, custom paint and wall coverings, window treatments, landscaping, sound and alarm systems, furnishings, appliances, and other designer/decorator features and amenities that are not included as part of the home and/or may not be available at all locations. Home, pricing and community information is subject to change, and homes to prior sale, at any time without notice or obligation. ©2021 Champion Homes. All rights reserved.

MANUFACTURED BY:



I authorize Champion Homes Center to build my house, per this plan.

Jerry Newbern

7/10/2025

2C20C11A9BA74AB...

DocuSigned by:

7/10/2025

X

Martha Newbern

Customer Signature/Date

2C20C11A9BA74AB...

Newbern

28x50

SCC
Columbia

License Number: IH / 1041936 / 1 Name: WILLIAM R PRICE

Order #: 6570

Label #: 119209

Manufacturer:

Homeowner:

Year Model:

(Check Size of Home)

Address:

Length & Width:

Single

Double

Triple

City/State/Zip:

Type Longitudinal System:

HUD Label #:

Phone #:

Type Lateral Arm System:

Soil Bearing / PSF:

Date Installed:

New Home: _____ Used Home: _____

Torque Probe / in-lbs:

Installed Wind Zone:

Data Plate Wind Zone:

Permit #:

Note:

STATE OF FLORIDA
INSTALLATION CERTIFICATION LABEL

119209

LABEL #

DATE OF INSTALLATION

WILLIAM R PRICE

NAME

IH / 1041936 / 1

6570

LICENSE #

ORDER #

CERTIFIES THAT THE INSTALLATION OF THIS MOBILE HOME IS
IN ACCORDANCE WITH FLORIDA STATUTES 320.8249, 320.8325
AND RULES OF THE HIGHWAY SAFETY AND MOTOR VEHICLES.

INSTRUCTIONS

PLEASE WRITE DATE OF
INSTALLATION AND AFFIX
LABEL NEXT TO HUD LABEL.
USE PERMANENT INK PEN
OR MARKER ONLY.
COMPLETE INFORMATION
ABOVE AND KEEP ON FILE
FOR A MINIMUM OF 2 YEARS.
YOU ARE REQUIRED TO
PROVIDE COPIES WHEN
REQUESTED.

