

106.87  
N 47° 10' 14" W

41.18  
N 62° 32' 00" W

79'-11 1/2"

50'-5"

WELL

54'-4"

20'-0"

SEPTIC

204.40  
N 24° 13' 30"

184.26

S 31° 46' 15" W

NEW SINGLE STORY RESIDENCE

60'-2"

CONCRETE DRIVEWAY

WISE ESTATES BLOCK C LOT 21  
0.58 ACRES

45'-0"

119.71  
S 58° 42' 50" W

SW MELBA GLEN



16 GA. GALV. RES. TOP ROLLER BRACKET  
ATTACHED W/ (2) 5/16" x 1-3/4"  
LAG BOLTS PER BRACKET  
ADJUSTABLE SLIDE BRACKET ATTACHED  
W/ (2) 1/4" x 1/2" BOLT & NUT PER BRACKET

TEST No. SEC-580-011 ON OCTOBER 12, 1995 INCLUDED GLASS WINDOWS IN THE DOOR BEING USED. THE TEST PRESSURES WERE +48.4 PSF AND -54.7 PSF. BY COMPARISON, EIGHT (8) WINDOWS MAY BE INSTALLED IN (1) ONE SECTION OF THE 18' X 7' AND 18' X 8' MODEL 600 AND 950 DOORS.

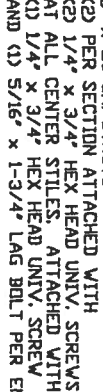

4-MOLDED INSIDE FRAME

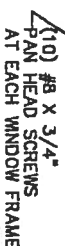

SPUCE TRACKS AT THIS LOCATION  
W/ (4) 1/4"-20 TRACK SPUCE BOLTS & NUTS  
SECURE TO JAMB WITH (3) 5/16" DIA. x 1-3/4"  
LAG BOLTS

**BUILDING PLANS EXAMINER  
REVIEWED FOR  
CODE COMPLIANCE  
KEEP THIS PLAN ON JOB**

MAY 17 2001

JOSE GALT & SONS, INC. Building & Logging Inspection Unit - Jacksonville, FL  
 Examiner Signature: Tommy Lee Moore  
 License No. 18801520



51

SECTION A-A (SIDE VIEW)

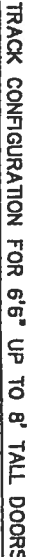

### JAMB BRACKET LOCATIONS

**RATED FOR 100 MPH FASTEST-MILE BASIC WIND SPEEDS**

STOP MOULDING  
-W/FLEXIBLE SEAL  
(SUPPLIED BY INSTALLER)

20 GA. GALV. STEEL  
END STYLE



## TRACK MOUNTING DETAIL

VERTICAL JAMB ATTACHMENT TO WOOD FRAME STRUCTURE  
5/16" X 3" LAG SCREWS STARTING 6" FROM ENDS THEN 16" O.C.

VERTICAL JAMB ATTACHMENT TO 2,000 PSI CONCRETE  
HILLT KIRK BOLT 3/8" X 4" STARTING 6" FROM ENDS THEN 24" O.C.

HILLT SLEEVE ANCHOR 3/8" X 2-3/4" STARTING 6" FROM ENDS THEN 24" O.C.

HILLT SLEEVE ANCHOR 3/8" X 2-3/4" STARTING 6" FROM ENDS THEN 16" O.C.

HILLT/RAKSET TAPCON 1/4" X 2-3/4" STARTING 6" FROM ENDS, USE PAINS OF FASTENERS (3" APART) AT 16" O.C.

VERTICAL JAMB ATTACHMENT TO C-90 BLOCK  
HILLT SLEEVE ANCHOR 3/8" X 2-3/4" STARTING 6" FROM ENDS THEN 16" O.C.

HILLT/RAKSET TAPCON 1/4" X 2-3/4" STARTING 6" FROM ENDS, USE PAINS OF FASTENERS (3" APART) AT 16" O.C.

1. DOORS AS HARDWARE WILL BE DESIGNED, MANUFACTURED AND INSTALLED WITH STANDARDS AS SET FORTH BY DYSMA.
2. DOOR SECTIONS SHALL BE 25 GA. (0.017") MIN. ROLL FORMED LIGHT COMMERCIAL QUALITY, 6-40 GALVANEATION.
3. DOORS UP TO 7'-0" HIGH CONSIST OF (4) SECTIONS AS SHOWN, DOORS UP TO 8'-0" HIGH CONSIST OF (6) SECTIONS AS SHOWN.
4. SUPPORTING STRUCTURAL ELEMENTS SHALL BE DESIGNED BY A REGISTERED PROFESSIONAL ENGINEER FOR WIND LOADS INDICATED ON THIS DRAWING IN ADDITION TO OTHER LOADINGS.
5. THE METHOD OF TESTING WAS IN SUBSTANTIAL COMPLIANCE WITH THE PROCEDURE DESCRIBED IN ASTM E330-90, AND THE SOUTHERN BUILDING CODE SECTION 1606 WIND LOAD DESIGN CRITERIA. THE PRESSURES SHOWN ON THE DRAWINGS WERE CALCULATED USING THE FOLLOWING PARAMETERS:

DESIGN LOADS  
+23.6 PSF  
-24.5 PSF

TEST LOADS  
+35.4 PSF  
-36.8 PSF

# Annarr CANTIERI

500 GRAY ST. E. V.A. VINELAND, N.J. 08359  
MODEL #600 STRATFORD  
MODEL #950 HERITAGE III

DATE	TIME	LOCATION	STATUS
04/05/01	04:00	01	01

[illegible]

PREMDOR (ENTERGY BRAND) DOUBLE DOOR  
WITH SIDELITES IN WOOD FRAMES  
WITH BUMPER THRESHOLD (INSWING)

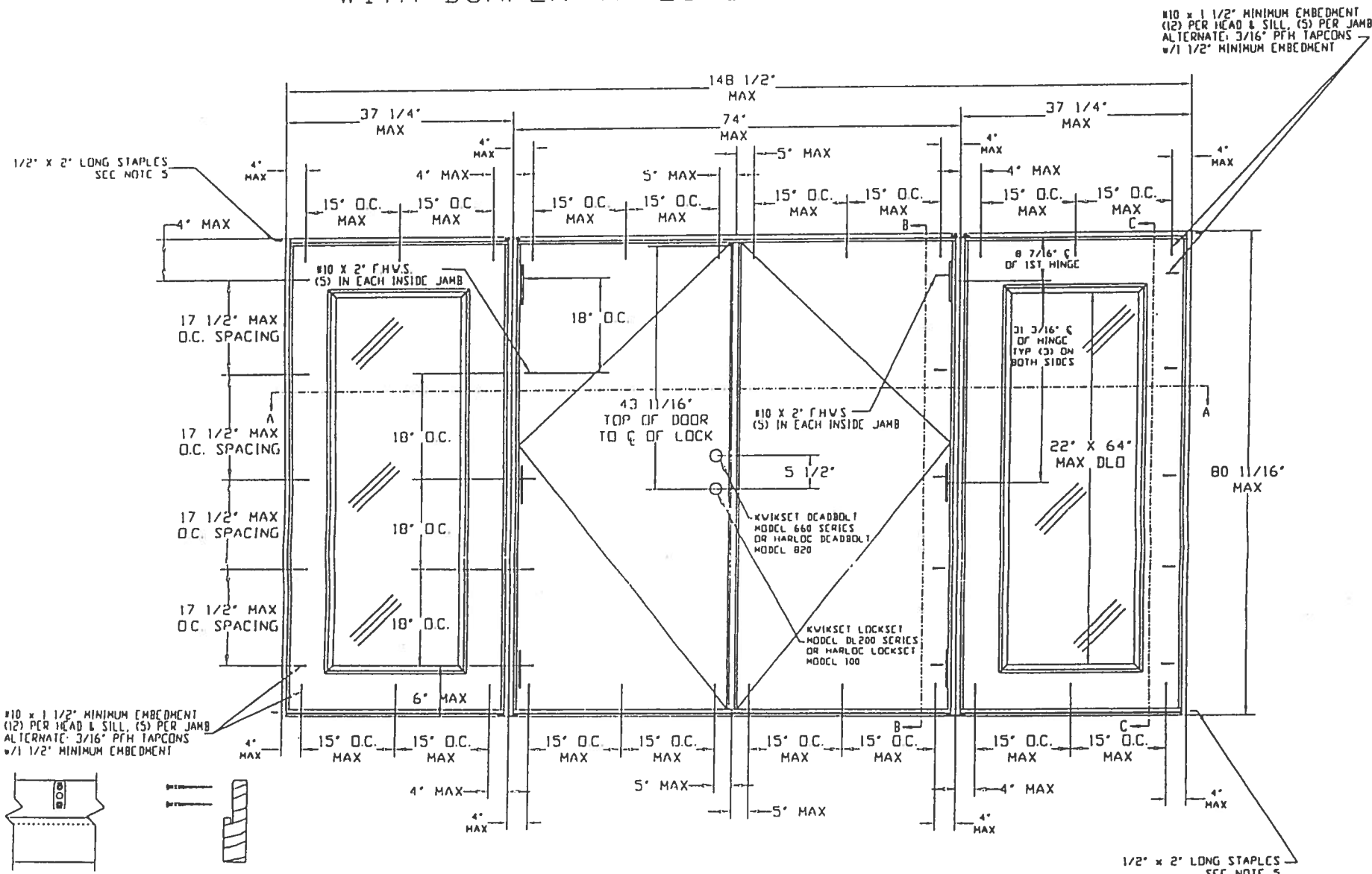

ATTACH ASTRAGAL THROW BOLT  
STRIKE PLATE TO THE HEADER  
AND THRESHOLD WITH #10 x 1 3/4\"/>

NOTES:  
1. WOOD BUCKS BY OTHERS. MUST BE ANCHORED  
PROPERLY TO TRANSFER LOADS TO THE STRUCTURE.  
2. THE PRECEDING DRAWINGS ARE INTENDED TO  
QUALIFY THE FOLLOWING INSTALLATIONS.  
3. WOOD FRAME CONSTRUCTION WHERE DOOR  
SYSTEM IS ANCHORED TO A MINIMUM TWO BY WOOD  
PENING.  
4. MASONRY OR CONCRETE CONSTRUCTION WHERE  
DOOR SYSTEM IS ANCHORED TO A MINIMUM TWO BY  
STRUCTURAL WOOD BUCK.  
5. MASONRY OR CONCRETE CONSTRUCTION WHERE  
DOOR SYSTEM IS ANCHORED DIRECTLY TO CONCRETE  
OR MASONRY WITH OR WITHOUT A NON-STRUCTURAL  
WOOD BUCK.  
6. ALL ANCHORING SCREWS TO BE #10 WITH  
MINIMUM 1 1/2\"/>  
7. UNIT MUST BE INSTALLED WITH 'MIAMI-DADE COUNTY  
APPROVED' SHUTTERS.  
8. THREE STAPLES PER SIDE JAMB INTO HEADER ON SIDELITES  
AND DOOR, THREE STAPLES PER JAMB INTO THRESHOLD ON  
SIDELITES AND DOOR.  
9. LATEX SEALANT TO BE APPLIED AT SIDE BY SIDE  
JAMBS AND SIDELITES.  
10. DOOR/SIDELITE HEADER, DOOR/SIDELITE JAMBS, AND SIDELITE BASE  
CORNERS ARE COPED AND BUTT JOINED.  
11. DOORS SHALL BE PRE-PAINTED WITH A WATER-BASED EPOXY RUST  
INHIBITIVE PRIMER PAINT WITH A DRY FILM THICKNESS OF 0.8 TO 1.2 MIL.  
12. FRAMES SHALL BE PRE-PAINTED WITH AN ACRYLIC LATEX WATER-BASED/  
WATER-REDUCIBLE WHITE PRIMER WITH A DRY FILM THICKNESS OF 0.8 TO 1.2 MIL.

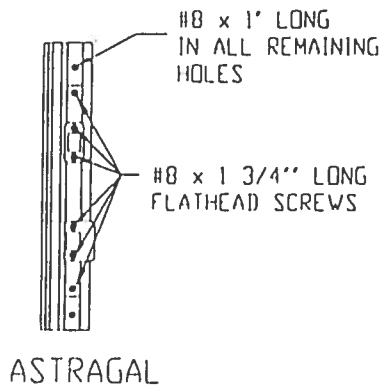

ASTRAGAL

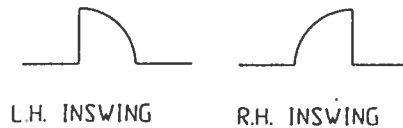

DESIGN PRESSURE RATINGS		
	WHERE WATER INFILTRATION REQUIREMENT IS NEEDED *	WHERE WATER INFILTRATION REQUIREMENT IS NOT NEEDED
Positive	NOT APPROVED *	+55.0 psf
Negative	NOT APPROVED *	-55.0 psf

\* UNITS SHALL BE INSTALLED ONLY AT LOCATIONS PROTECTED BY A CANOPY OR  
OVERHANG SUCH THAT THE ANGLE BETWEEN THE EDGE OF CANOPY OR OVERHANG  
TO SILL IS LESS THAN 45 DEGREES. UNLESS UNIT IS INSTALLED IN  
NON-HABITABLE AREAS WHERE THE UNIT AND THE AREA ARE DESIGNED TO  
ACCEPT WATER INFILTRATION.

APPROVED AS COMPLYING WITH THE  
SOUTH FLORIDA BUILDING CODE  
DATE JUN 05 2001  
BY *Manuel Terry*  
PRODUCT CONTROL DIVISION  
BUILDING CODE COMPLIANCE OFFICE  
ACCEPTANCE NO. 01-0314.23

LIMITS: UNLESS NOTED, FRAC. : DEC. : ANG. :		C	DADE COUNTY MODIFICATIONS		11/11/00	JD
EXTRUSIONS: UNLESS NOTED, STD. COM'L. TOL'S.		B	ADDED PAGE 5 (DOOR OPTIONS)		10-1-98	RS
ENGINEER:		A	ADD OTHER DOOR CONFIGURATIONS		12/18/97	RS
DR. BY R.S.		LTR.	REVISIONS		DATE	BY
DATE 7-29-97		PART NAME: ENTERGY METAL EDGE DOUBLE DOOR W/ SIDELITES		SCALE: N.T.S.		
PREMDOR ENTRY SYSTEMS		31-1029-EM-I		SHEET 1 OF 6		
911 E. JEFFERSON						
PITTSBURG, KS. 66762						
				REVISION LETTER		C



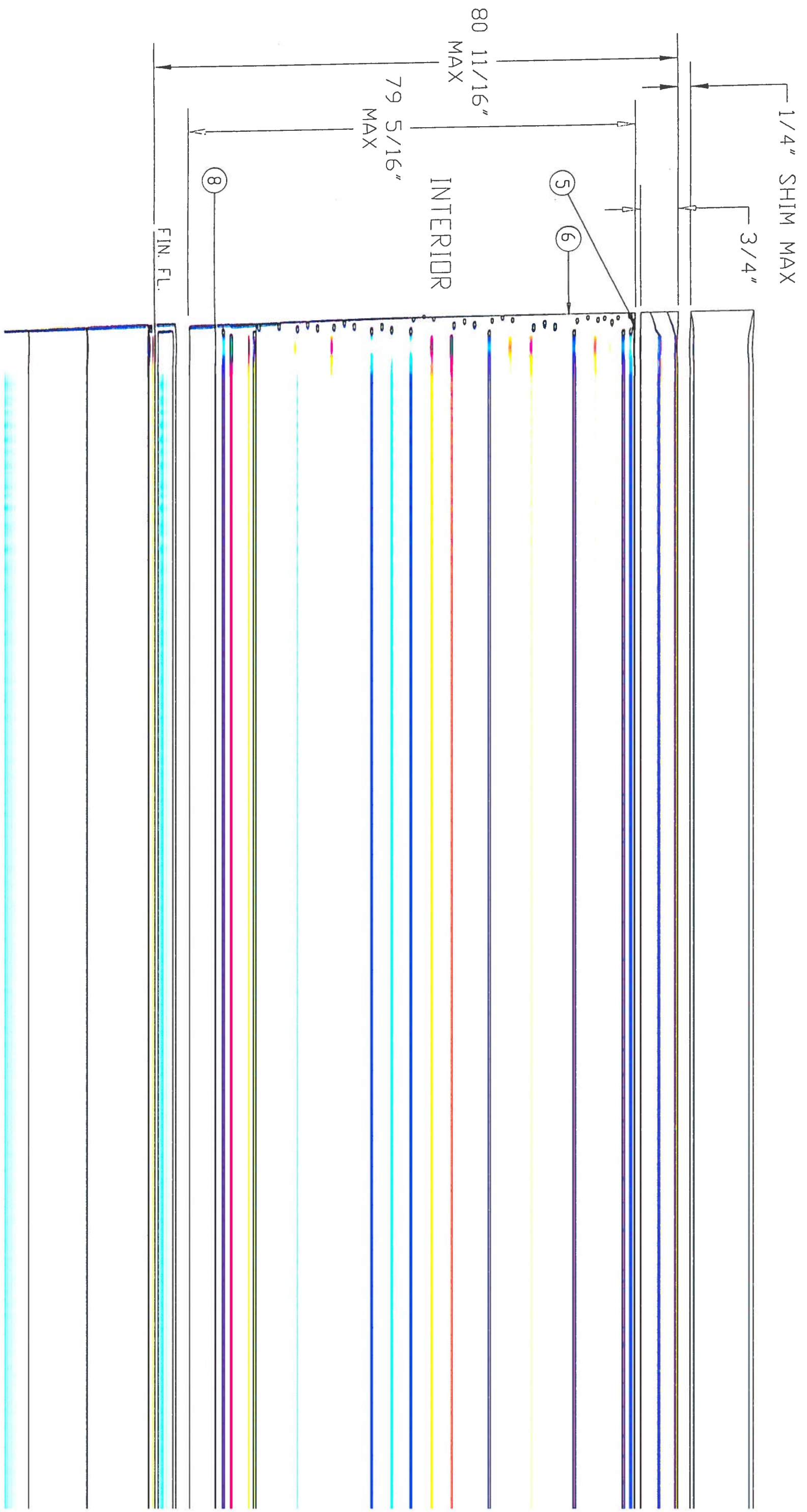

# SECTION B