



STATE OF FLORIDA  
DEPARTMENT OF ENVIRONMENTAL PROTECTION  
ONSITE SEWAGE TREATMENT AND DISPOSAL  
SYSTEM (OSTDS)

PERMIT NO. 23-0526  
DATE PAID: 7/19/23  
FEE PAID: 60.00  
RECEIPT #: AP

APPLICATION FOR CONSTRUCTION PERMIT

APPLICATION FOR:

☐ New System ☒ Existing System ☐ Holding Tank ☐ Innovative  
☐ Repair ☐ Abandonment ☐ Temporary ☐

APPLICANT: Corbin Sattler EMAIL: meat@driscollengineer  
Cornerstone Const. & Design ing.com

AGENT: \_\_\_\_\_ TELEPHONE: 352-331-1513

MAILING ADDRESS: PO Box 357517, Gainesville, FL 32635

TO BE COMPLETED BY APPLICANT OR APPLICANT'S AUTHORIZED AGENT. SYSTEMS MUST BE CONSTRUCTED BY A PERSON LICENSED PURSUANT TO 489.105(3) (m) OR 489.552, FLORIDA STATUTES. IT IS THE APPLICANT'S RESPONSIBILITY TO PROVIDE DOCUMENTATION OF THE DATE THE LOT WAS CREATED OR PLATTED (MM/DD/YY) IF REQUESTING CONSIDERATION OF STATUTORY GRANDFATHER PROVISIONS.

PROPERTY INFORMATION

OSTDS REMEDIATION PLAN? ☒ Y / ☐ N

LOT: \_\_\_\_\_ BLOCK: \_\_\_\_\_ SUBDIVISION: \_\_\_\_\_ PLATTED: \_\_\_\_\_

PROPERTY ID #: 25-55-15-04A-007 ZONING: \_\_\_\_\_ I/M OR EQUIVALENT: ☒ Y / ☐ N

PROPERTY SIZE: 10.63 ACRES WATER SUPPLY: ☒ PRIVATE PUBLIC ☐  $\leq 2000$  GPD ☐  $> 2000$  GPD

IS SEWER AVAILABLE AS PER 381.0065, FS? ☒ Y / ☐ N DISTANCE TO SEWER: 400 FT

PROPERTY ADDRESS: 306 SW Darwin Ave, Lake City, FL 32024

DIRECTIONS TO PROPERTY: see attached map

BUILDING INFORMATION

☒ RESIDENTIAL ☐ COMMERCIAL

Unit No. Type of Establishment No. of Bedrooms Building Area Sqft Commercial/Institutional System Design Table I, Chapter 62-6, FAC

1 Barn — 4800 Residential Barn

2 \_\_\_\_\_

3 \_\_\_\_\_

4 \_\_\_\_\_

☐ Floor/Equipment Drains ☐ Other (Specify) \_\_\_\_\_

SIGNATURE: \_\_\_\_\_ DATE: 7-19-23

DEP 4015, 06-21-2022 (Supersedes previous editions which may not be used)

Incorporated 62-6.004, FAC



23.0526

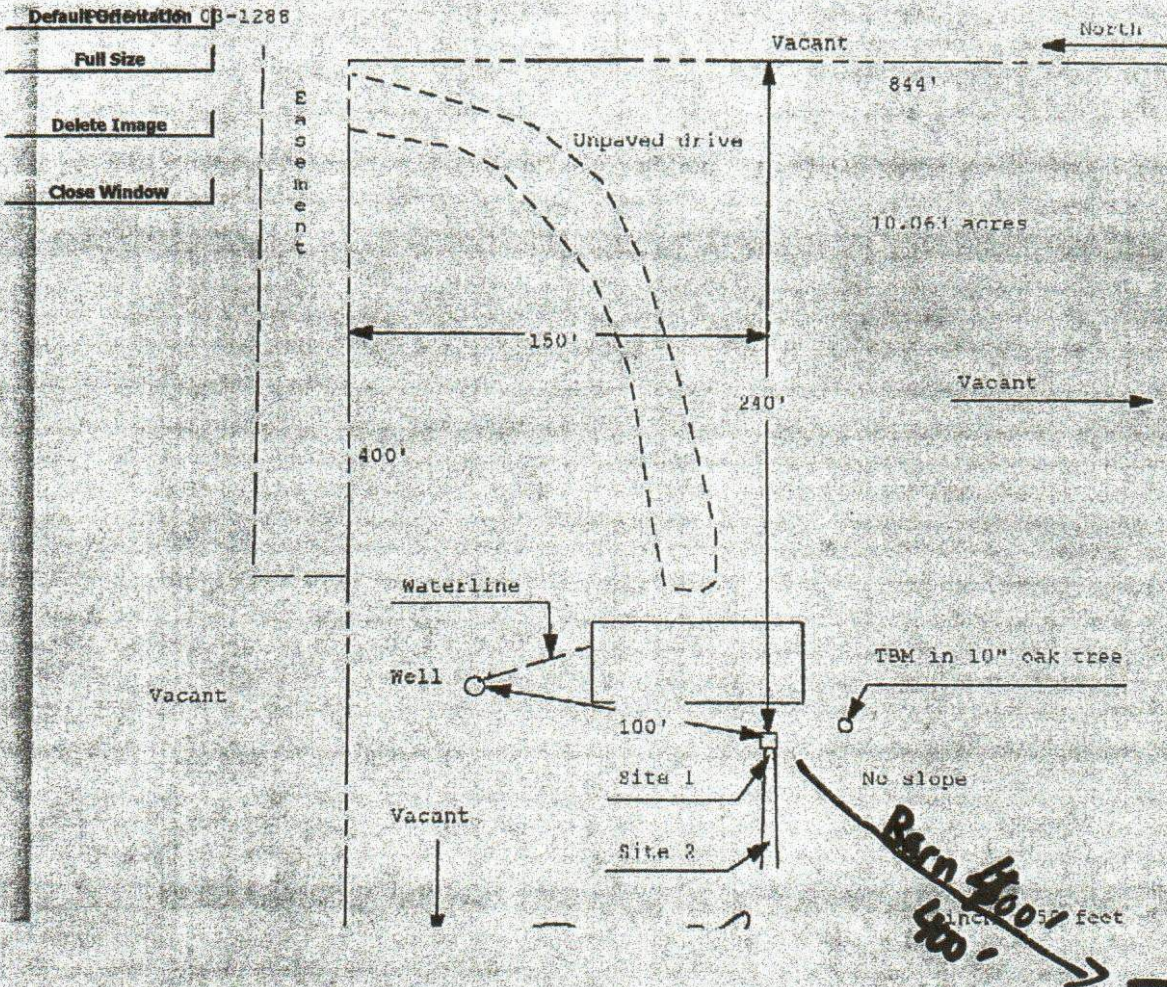

**APPROVED**

*Sally Ford EP Director Columbia 7.27.23*