

PERMIT APPLICATION / MANUFACTURED HOME INSTALLATION APPLICATION

* NEED ASSIGNED PARCEL A - (PA)

For Office Use Only

(Revised 7-1-15)

AP# 1805-31

Zoning Official JH 5-11-18

Building Official JH 5-11-18

Flood Zone X

Date Received 5-10-18

By LH

Permit # 37268

Comments

SFLP 1810 Approved 5-3-18

Zoning A-3

Land Use Plan Map Category Ag

FEMA Map#

Elevation

Finished Floor Above Road River

☒ Recorded Deed or ☐ Property Appraiser PO

Site Plan

LEH # 18-0323

In Floodway

☒ Existing well

☐ Land Owner Affidavit

☒ Installer Authorization

☐ FW Comp. letter

☒ Well letter OR

☒ DOT Approval

☐ Parent Parcel #

☒ App Fee Paid

☐ Ellisville Water Sys

☒ Assessment

☒ Out County

☒ In County

☒ Sub VF Form

☒ 911 App

Property ID # 34-45-16-03269-001

Subdivision

Lot#

New Mobile Home

Used Mobile Home ☒

MH Size 14x66

Year 1995

Applicant

Akeidria Bailey

Phone #

386-697-4092

Address

1928 SW King St

Lake City FL 32024

Name of Property Owner

Akeidria Bailey

Phone#

386-292-2890

911 Address

1928

SW King St

LAKE CITY

386-697-4092

32024

Circle the correct power company -

(Circle One) -

FL Power & Light

Suwannee Valley Electric

Clay Electric

Duke Energy

Name of Owner of Mobile Home

Akeidria Bailey

Phone #

386-292-2890

Address

2036

King St Lake City FL

386-697-4092

Relationship to Property Owner

Akeidria Bailey

Self

Current Number of Dwellings on Property

0

Lot Size

Do you : Have

Existing Drive (Currently using)

Private Drive (Blue Road Sign)

Total Acreage

1

Is this Mobile Home Replacing an Existing Mobile Home

NO

Driving Directions to the Property

Take a right on

King St

come down

3/4 mile

Just past Bishop Ave

Left side

will be your second drive way on

Name of Licensed Dealer/Installer

Glenn Williams Jr

Phone #

386-344-3669

Installers Address

660 Se Putnam St LAKE CITY FL

32025

License Number

1H1054858

Installation Decal #

46602

He attempted to LV MSG

Mobile Home Permit Worksheet

Application Number: _____

Date: _____

Installer: Alan Williams License # 1H1054188
 Address of home TRD
 being installed _____

Manufacturer Fleetwood Length x width 14 x 66

NOTE: if home is a single wide fill out one half of the blocking plan
 if home is a triple or quad wide sketch in remainder of home
 I understand Lateral Arm Systems cannot be used on any home (new or used)
 where the sidewall ties exceed 5 ft 4 in.

Installer's initials AW

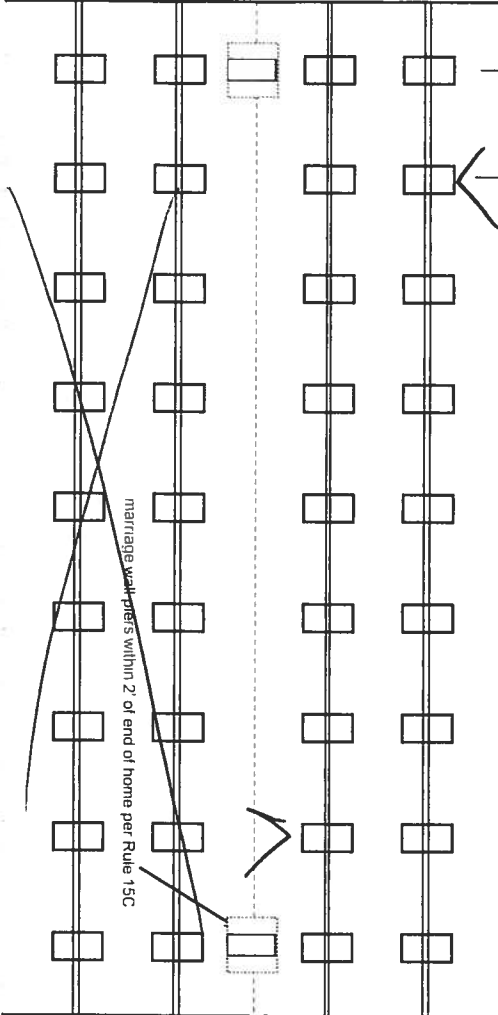
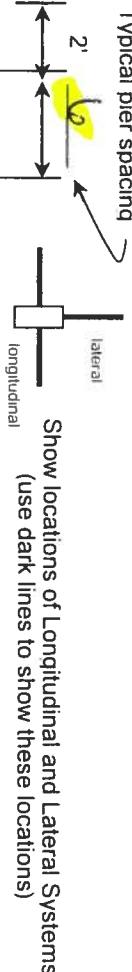

New Home ☐ Used Home ☒
 Home installed to the Manufacturer's Installation Manual
 Home is installed in accordance with Rule 15-C ☒

Single wide ☒ Wind Zone II ☒ Wind Zone III ☐

Double wide ☐ Installation Decal # 411601

Triple/Quad ☐ Serial # FICA 121615A

PIER SPACING TABLE FOR USED HOMES

Load bearing capacity (sq in)	Footer size (256)	18" x 18" (342)	20" x 20" (400)	22" x 22" (484)*	24" x 24" (576)*	26" x 26" (676)
1000 psf	3'	4'	5'	6'	7'	8'
1500 psf	4'6"	6'	7'	8'	8'	8'
2000 psf	6'	8'	8'	8'	8'	8'
2500 psf	7'6"	8'	8'	8'	8'	8'
3000 psf	8'	8'	8'	8'	8'	8'
3500 psf	8'	8'	8'	8'	8'	8'

* interpolated from Rule 15C-1 pier spacing table.

PIER PAD SIZES

I-beam pier pad size 18.5 x 18.5
 Perimeter pier pad size 18.5 x 18.5
 Other pier pad sizes (required by the mfg.) _____

Draw the approximate locations of marriage wall openings 4 foot or greater. Use this symbol to show the piers.

Pad Size	Sq in
16 x 16	256
16 x 18	288
18.5 x 18.5	342
16 x 22.5	360
17 x 22	374
13 1/4 x 26 1/4	348
20 x 20	400
17 3/16 x 25 3/16	441
17 1/2 x 25 1/2	446
24 x 24	576
26 x 26	676

List all marriage wall openings greater than 4 foot and their pier pad sizes below.

Opening _____ Pier pad size _____

NA

FRAME TIES

within 2' of end of home spaced at 5' 4" oc

TIEDOWN COMPONENTS

OTHER TIES

Longitudinal Stabilizing Device (LSD)
 Manufacturer OLIVER

Number 24
 Sidewall Longitudinal Marriage wall Shearwall

Mobile Home Permit Worksheet

Application Number: _____

Date: _____

POCKET PENETROMETER TEST

The pocket penetrometer tests are rounded down to 1500 psf or check here to declare 1000 lb. soil _____ without testing.

x 1500 x 1500 x 1500

POCKET PENETROMETER TESTING METHOD

1. Test the perimeter of the home at 6 locations.
2. Take the reading at the depth of the footer.
3. Using 500 lb. increments, take the lowest reading and round down to that increment.

x 1500 x 2000 x 1500

TORQUE PROBE TEST

The results of the torque probe test is 290 inch pounds or check here if you are declaring 5' anchors without testing. A test showing 275 inch pounds or less will require 5 foot anchors.

Note: A state approved lateral arm system is being used and 4 ft. anchors are allowed at the sidewall locations. 1 understand 5 ft anchors are required at all centerline tie points where the torque test reading is 275 or less and where the mobile home manufacturer may require anchors with 4000 lb holding capacity.

Installer's initials _____

ALL TESTS MUST BE PERFORMED BY A LICENSED INSTALLER

Installer Name _____

Glen Williams

Date Tested _____

4-17-18

Electrical _____

Connect electrical conductors between multi-wide units, but not to the main power source. This includes the bonding wire between multi-wide units. Pg. _____

Plumbing _____

Connect all sewer drains to an existing sewer tap or septic tank. Pg. _____

Connect all potable water supply piping to an existing water meter, water tap, or other independent water supply systems. Pg. _____

Site Preparation

Debris and organic material removed _____ Swale _____ Pad ☒ Other _____

Fastening multi wide units

Floor: Type Fastener: _____ Length: _____ Spacing: _____
Walls: Type Fastener: N Length: ✓ Spacing: A
Roof: Type Fastener: _____ Length: _____ Spacing: _____

For used homes a min. 30 gauge, 8 wide, galvanized metal strip will be centered over the peak of the roof and fastened with galv. roofing nails at 2" on center on both sides of the centerline.

Gasket (weatherproofing requirement)

I understand a properly installed gasket is a requirement of all new and used homes and that condensation, mold, mildew and buckled marriage walls are a result of a poorly installed or no gasket being installed. I understand a strip of tape will not serve as a gasket.

Installer's initials _____

Type gasket N/A

Installed: Between Floors Yes _____
Between Walls Yes N/A
Bottom of ridgebeam Yes N/A

Weatherproofing

The bottomboard will be repaired and/or taped. Yes _____ Pg. _____
Siding on units is installed to manufacturer's specifications. Yes _____
Fireplace chimney installed so as not to allow intrusion of rain water. Yes _____

Miscellaneous

Skirting to be installed. Yes _____ No ✓
Dryer vent installed outside of skirting. Yes _____ N/A
Range downflow vent installed outside of skirting. Yes ✓ N/A
Drain lines supported at 4 foot intervals. Yes _____
Electrical crossovers protected. Yes _____
Other: _____

Installer verifies all information given with this permit worksheet is accurate and true based on the manufacturer's installation instructions and or Rule 15C-1 & 2

Installer Signature _____

Glen Williams

Date _____

4-17-18

OLIVER TECHNOLOGIES, INC.
FLORIDA INSTALLATION INSTRUCTIONS FOR THE
MODEL 1101 "V" SERIES ALL STEEL FOUNDATION SYSTEM
MODEL 1101"V" (STEPS 1-15)
LONGITUDINAL ONLY: FOLLOW STEPS 1-9
FOR ADDING LATERAL ARM : Follow Steps 10-15
FOR CONCRETE APPLICATIONS: Follow Steps 16-19

ENGINEERS STAMP

ENGINEERS STAMP

1. SPECIAL CIRCUMSTANCES: If the following conditions occur - **STOP! Contact Oliver Technologies at 1-800-284-7437** :
- a) Pier height exceeds 48" b) Length of home exceeds 76' c) Roof eaves exceed 16" d) Sidewall height exceed 96"
 - e) Location is within 1500 feet of coast

INSTALLATION OF GROUND PAN

2. Remove weeds and debris in an approximate two foot square to expose firm soil for each ground pan (C) .
3. Place ground pan (C) directly below chassis I-beam . Press or drive pan firmly into soil until flush with or below soil.
- SPECIAL NOTE:** The longitudinal "V" brace system serves as a pier under the home and should be loaded as any other pier. It is recommended that after leveling piers, and one-third inch (1/3") before home is lowered completely on to piers, complete steps 4 through 9 below then remove jacks.

INSTALLATION OF LONGITUDINAL "V" BRACE SYSTEM

NOTE: WHEN INSTALLING THE LONGITUDINAL SYSTEM ONLY, A MINIMUM OF 2 SYSTEMS PER FLOOR SECTION IS REQUIRED. SOIL TEST PROBE SHOULD BE USED TO DETERMINE CORRECT TYPE OF ANCHOR PER SOIL CLASSIFICATION. IF PROBE TEST READINGS ARE BETWEEN 175 & 275 A 5 FOOT ANCHOR MUST BE USED. IF PROBE TEST READINGS ARE BETWEEN 276 & 350 A 4 FOOT ANCHOR MAY BE USED. USE GROUND ANCHORS WITH DIAGONAL TIES AND STABILIZER PLATES EVERY 5'4" . VERTICAL TIES ARE ALSO REQUIRED ON HOMES SUPPLIED WITH VERTICAL TIE CONNECTION POINTS (PER FLORIDA REG.) .

4. Select the correct square tube brace (E) length for set - up (pier) height at support location. (The 18" tube is always used as the bottom part of the longitudinal arm). Note: Either tube can be used by itself, cut and drilled to length as long as a 40 to 45 degree angle is maintained.

PIER HEIGHT
(Approx. 45 degrees Max.)

1.25" ADJUSTABLE
Tube Length

1.50" ADJUSTABLE
Tube Length

7 3/4" to 25"	22"	18"
24 3/4" to 32 1/4"	32"	18"
33" to 41"	44"	18"
40" to 48"	54"	18"

5. Install (2) of the 1.50" square tubes (E {18" tube}) into the "U" bracket (J), insert carriage bolt and leave nut loose for final adjustment.
6. Place I-beam connector (F) loosely on the bottom flange of the I-beam.
7. Slide the selected 1.25" tube (E) into a 1.50" tube (E) and attach to I-beam connectors (F) and fasten loosely with bolt and nut.
8. Repeat steps 6 through 7 to create the "V" pattern of the square tubes loosely in place. The angle is not to exceed 45 degree and not below 40 degrees.
9. After all bolts are tightened, secure 1.25" and 1.50" tubes using four(4) 1/4" - 14 x 3/4" self-tapping screws in pre-drilled holes.

INSTALLATION OF LATERAL TELESCOPING TRANSVERSE ARM SYSTEM

THE MODEL 1101 "V" (LONGITUDINAL & LATERAL PROTECTION) ELIMINATES THE NEED FOR MOST STABILIZER PLATES & FRAME TIES.

NOTE: THE USE OF THIS SYSTEM REQUIRES VERTICAL TIES SPACED AT 5'4".

FOUR FOOT (4') GROUND ANCHOR MAY BE USED EXCEPT WHERE THE HOME MANUFACTURER SPECIFIES DIFFERENT.

10. Install remaining vertical tie-down straps and 4' ground anchors per home manufacturer's instructions. **NOTE:** Centerline anchors to be sized according to soil torque condition. Any manufacturer's specifications for sidewall anchor loads in excess of 4,000 lbs. require a 5' anchor per Florida Code.
11. **NOTE:** Each system is required to have a frame tie and stabilizer attached at each lateral arm stabilizing location. This frame tie & stabilizer plate needs to be located within 18" from of center ground pan.
12. Select the correct square tube brace (H) length for set-up lateral transverse at support location. The lengths come in either 60" or 72" lengths. (With the 1.50" tube as the bottom tube, and the 1.25" tube as the inserted tube.)
13. Install the 1.50 transverse brace (H) to the ground pan connector (D) with bolt and nut.
14. Slide 1.25" transverse brace into the 1.50" brace and attach to adjacent I-beam connector (I) with bolt and nut.
15. Secure 1.50" transverse arm to 1.25" transverse arm using four (4) 1/4" - 14 x 3/4" self-tapping screws in pre-drilled holes.



OLIVER TECHNOLOGIES, INC.
1-800-284-7437

Telephone 931-796-4555
Fax 931-796-8811
www.olivertechnologies.com

INSTALLATION USING CONCRETE RUNNER / FOOTER

16. A concrete runner, footer or slab may be used in place of the steel ground pan.
- The concrete shall be minimum 2500 psi mix
 - A concrete runner may be either longitudinal or transverse, and must be a minimum of 8" deep with a minimum width of 16 inches longitudinally or 18 inches transverse to allow proper distance between the concrete bolt and the edge of the concrete (see below).
 - Footers must have minimum surface area of 441 sq. in. (i.e. 21" square), and must be a minimum of 8" deep.
 - If a full slab is used, the depth must be a 4" minimum at system bracket location, all other specifications must be per local jurisdiction. Special inspection of the system bracket installation is not required. Footers must allow for at least 4" from the concrete bolt to the edge of the concrete.

NOTE: The bottom of all footings, pads, slabs and runners must be per local jurisdiction.

LONGITUDINAL: (Model 1101 LC "V")

17. When using Part # 1101-W-CPCA (wetset), simply install the bracket in runner/footer OR When installing in cured concrete use Part # 101-D-CPCA (dryset). The 1101 (dryset) CA bracket is attached to the concrete using (2) 5/8"x3" concrete wedge bolts (Simpson part # S162300H 5/8" X 3" or Powers equivalent). Place the CA bracket in desired location. Mark bolt hole locations, then using a 5/8" diameter masonry bit, drill a hole to a minimum depth of 3". Make sure all dust and concrete is blown out of the holes. Place wedge bolts into drilled holes, then place 1101 (dry set) CA bracket onto wedge bolts and start wedge bolt nuts. Take a hammer and lightly drive the wedge bolts down by hitting the nut (making sure not to hit the top of threads on bolt). The sleeve of concrete wedge bolt needs to be at or below the top of concrete. Complete by tightening nuts.

LATERAL: (Model 1101 TC "V")

18. For wet set (part # 1101-W-TACA) installation simply install the anchor bolt into runner/footer. For dry set installation (part # 1101-D-TACA) mark bolt hole locations, then using a 5/8" diam. masonry bit, drill a hole to a minimum depth of 3". Make sure all dust and concrete is blown out of the hole. Place wedge bolts (Simpson part #S162300H 5/8" X 3" or Powers equivalent) into (D) concrete dry transverse connector and into drilled hole. If needed, take a hammer and lightly drive the wedge bolts down by hitting the nut (making sure not to hit the top of threads on bolt), then remove the nut. The sleeve of concrete wedge bolt needs to be at or below the top of concrete.
19. When using part # 1101 CVW (wetset) or 1101 CVD (dryset), install per steps 17 & 18.

Notes:

- LENGTH OF HOUSE IS THE ACTUAL BOX SIZE
- = STABILIZER PLATE AND FRAME TIE LOCATION (needs to be located within 18 inches of center of ground pan or concrete)
- ☐ = LOCATION OF LONGITUDINAL BRACING ONLY
- ☐ = TRANSVERSE & LONGITUDINAL LOCATIONS

REQUIRED NUMBER AND LOCATION OF MODEL 1101 "V" OR 1101 C "V" BRACES FOR UP TO 4/12 ROOF PITCH

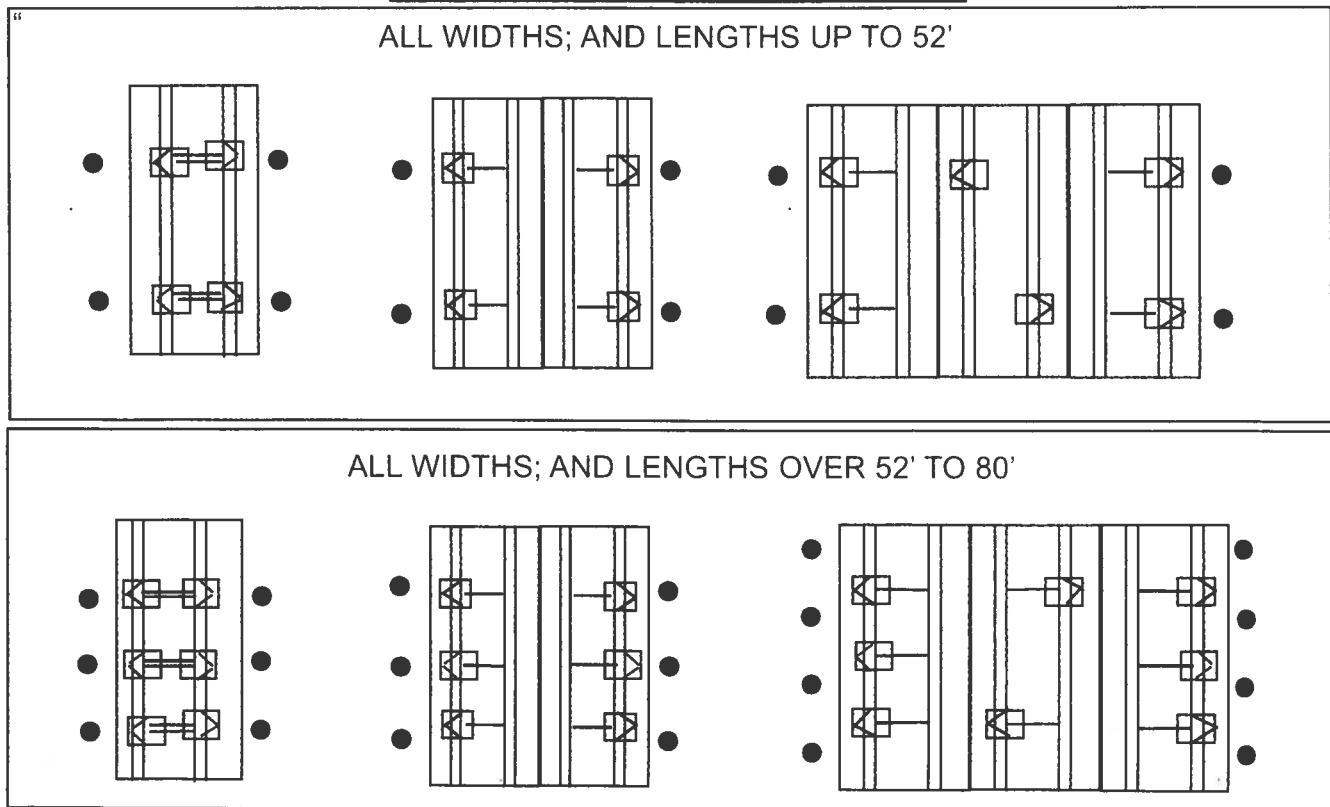

HOMES WITH 5/12 ROOF PITCH REQUIRE: PER FLORIDA REGULATIONS

6 systems for home lengths up to 52' and 8 systems for homes over 52' and up to 80'. One stabilizer plate and frame tie required at each lateral bracing system.

Florida approved 4" ground anchors may be used in all locations except where home manufacturers specifications for sidewall straps are in excess of 4,000 lbs. These locations require a 5" anchor. Per Florida Code.

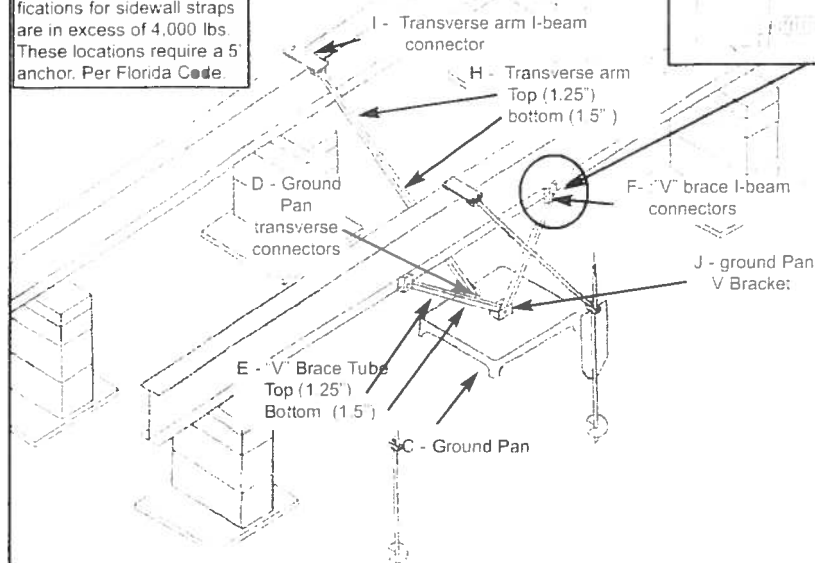

- C = GROUND PAN
- D = GROUND PAN CONNECTOR U BRACKETS TRANSVERSE
- E = TELESOPING V BRACE TUBE ASSEMBLY W/ 1.5 BOT- TOM TUBE AND 1.25 TUBE INSERT
- F = "V" BRACE I-BEAM CONNec- TORS ASSEMBLY
- H = TELESOPING TRANSVERSE ARM ASSEMBLY
- I = TRANSVERSE ARM I-BEAM CONNECTOR
- J = V PAN BRACKET

Model # 1101 "V"

Longitude dry concrete bracket part # 1101 D-CPCA

Wet bracket part # 1101 W-CPCA not shown

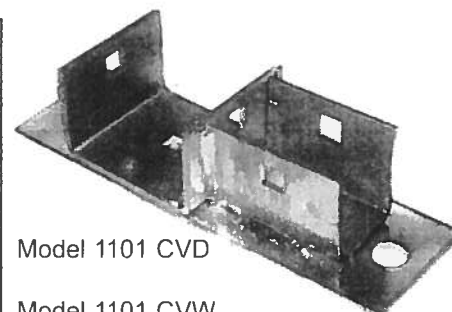
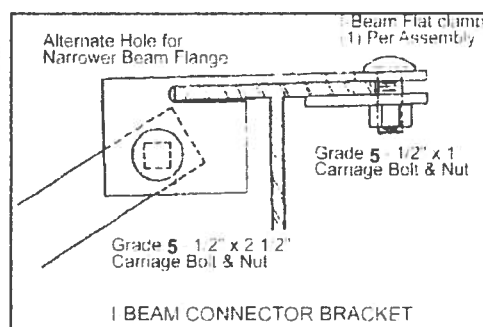
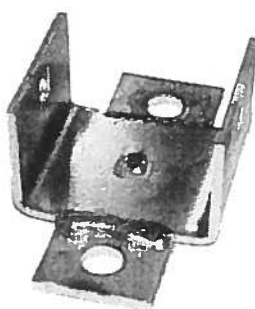

Model 1101 CVD

Model 1101 CVW not shown

Florida approved 4" ground anchors may be used in all locations except where home manufacturers specifications for sidewall straps are in excess of 4,000 lbs. These locations require a 5" anchor. Per Florida Code.

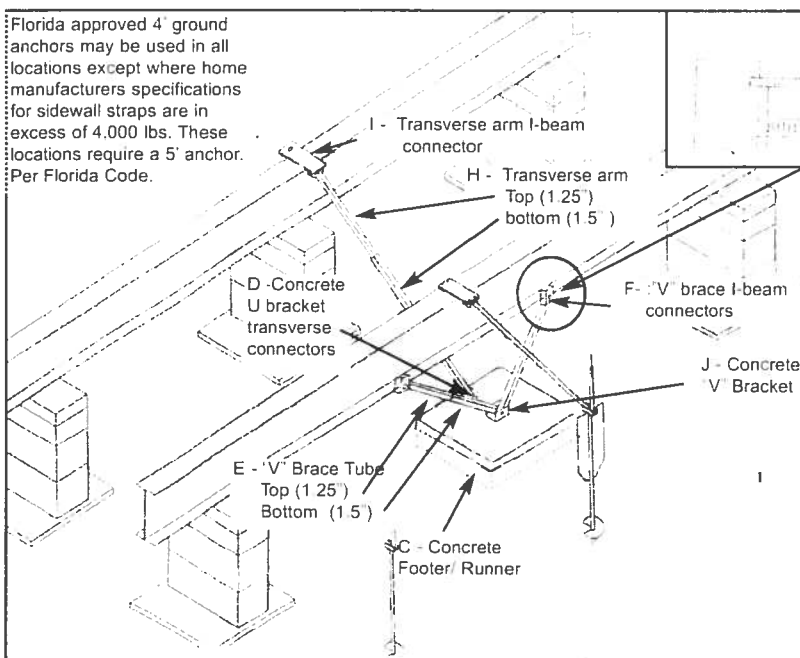

- C = CONCRETE FOOTER/RUNNER
- D = CONCRETE U BRACKET TRANSVERSE CONNECTOR (connects with grade 5 -1/2" x 2 1/2" carriage bolt & nut)
- E = TELESOPING V BRACE TUBE ASSEMBLY W/ 1.5 BOT- TOM TUBE AND 1.25 TUBE INSERT
- F = "V" BRACE I-BEAM CONNECTOR ASSEMBLY (connects with grade 5 - 1/2" x 4" carriage bolt & nut)
- H = TELESOPING TRANSVERSE ARM ASSEMBLY
- I = TRANSVERSE ARM I-BEAM CONNECTOR (connects with grade 5 -1/2" x 2 1/2" carriage bolt & nut)
- J = CONCRETE "V" BRACKET (connects with grade 5 - 1/2" x 4" carriage bolt & nut)

Model # 1101 C "V"



OLIVER TECHNOLOGIES, INC.
1-800-284-7437

Telephone 931-796-4555
Fax. 931-796-8811
www.olivertechnologies.com

CODE ENFORCEMENT DEPARTMENT

COLUMBIA COUNTY, FLORIDA

OUT OF COUNTY MOBILE HOME INSPECTION REPORT

**Data Plate is in Master Bedroom Closet.*

COUNTY THE MOBILE HOME IS BEING MOVED FROM SwanNee

OWNERS NAME Alexandra Bailey PHONE _____ CELL (386) 497-4092

INSTALLER Glenn Williams PHONE _____ CELL 386-344-3669

INSTALLERS ADDRESS 140 Se Putnam St Lake City Fl 37025

MOBILE HOME INFORMATION

MAKE Fleetwood YEAR 1995 SIZE 14 x 66

COLOR White SERIAL No. _____

WIND ZONE 2 SMOKE DETECTOR yes (2)

INTERIOR:

FLOORS Good

DOORS Fair

WALLS Good

CABINETS Good

ELECTRICAL (FIXTURES/OUTLETS) Good

EXTERIOR:

WALLS / SIDING Good

WINDOWS Good

DOORS _____

INSTALLER: APPROVED ☒ NOT APPROVED _____

INSTALLER OR INSPECTORS PRINTED NAME _____

Installer/Inspector Signature Glenn Williams License No. 1H1K54858 Date 4-17-18

NOTES: _____

ONLY THE ACTUAL LICENSE HOLDER OR A BUILDING INSPECTOR CAN SIGN THIS FORM.

NO WIND ZONE ONE MOBILE HOMES WILL BE PERMITTED. MOBILE HOMES PRIOR TO 1977 ARE PRE-HUD AND THE WIND ZONE MUST BE PROVEN TO BE PERMITTED.

BEFORE THE MOBILE HOME CAN BE MOVED INTO COLUMBIA COUNTY THIS FORM MUST BE COMPLETED AND RETURNED TO THE COLUMBIA COUNTY BUILDING DEPARTMENT.

ONCE MOVED INTO COLUMBIA COUNTY AN INSPECTOR MUST COMPLETE A PRELIMINARY INSPECTION ON THE MOBILE HOME. CALL 386-758-1008 TO SET UP THIS INSPECTION. NO PERMIT WILL BE ISSUED BEFORE THIS IS DONE.

Code Enforcement Approval Signature [Signature] Date 5-11-18

SFLP18-10

FAMILY RELATIONSHIP AFFIDAVIT

STATE OF FLORIDA
COUNTY OF COLUMBIA

BEFORE ME the undersigned Notary Public personally appeared, Bernard Bailey the Owner of the parent parcel which has been subdivided for and Akeisha Bailey, the Immediate Family Member of the Owner, which is intended for the Immediate Family Members primary residence use. The Immediate Family Member is related to the Owner as grandchild. Both individuals being first duly sworn according to law, depose and say:

1. Affiant acknowledges Immediate Family Member is defined as parent, grandparent, step-parent, adopted parent, sibling, child, step-child, adopted child or grandchild.
2. Both the Owner and the Immediate Family Member have personal knowledge of all matters set forth in this Affidavit.
3. The Owner holds fee simple title to certain real property situated in Columbia County, and more particularly described by reference with the Columbia County Property Appraiser Parent Tract Tax Parcel No. 03269-000.
4. The Immediate Family Member holds fee simple title to certain real property divided from the Owners' parent parcel situated in Columbia County and more particularly described by reference to the Columbia County Property Appraiser Tax Parcel No. R-03269-001.
5. No person or entity other than the Owner and Immediate Family Member to whom permit is being issued, including persons residing with the family member claims or is presently entitled to the right of possession or is in possession of the property, and there are no tenancies, leases or other occupancies that affect the property.
6. This Affidavit is made for the specific purpose of inducing Columbia County to recognize a family division for an Immediate Family Member being in compliance with the density requirements of the Columbia County's Comprehensive Plan and Land Development Regulations (LDR's).
7. This Affidavit and Agreement is made and given by Affiants with full knowledge that the facts contained herein are accurate and complete, and with full knowledge that the penalties under Florida law for perjury include conviction of a felony of the third degree.

We Hereby Certify that the facts represented by us in this Affidavit are true and correct and we accept the terms of the Agreement and agree to comply with it.

Bernard Bailey
Owner

Bernard Bailey
Typed or Printed Name

Bernard Bailey

Akeidria Bailey
Immediate Family Member

Akeidria Bailey
Typed or Printed Name

Subscribed and sworn to (or affirmed) before me this 17th day of April, 2017
by Akeidria Bailey (owner) who is personally known to me or has produced
400-017-95566-0 as identification.

Shanetha Taylor
Notary Public

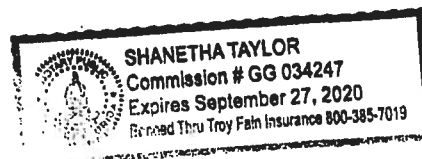

Subscribed and sworn to (or affirmed) before me this 8 day of May, 2018
by Bernard Bailey (Family Member) who is personally known to me or has
produced FL DL as identification.

[Signature]
Notary Public



APPROVED:
COLUMBIA COUNTY, FLORIDA

By: Laura Nettles

Name: Laura Nettles

Title: Planning Tech.



SITE PLAN CHECKLIST

- ___ 1) Property Dimensions
- ___ 2) Footprint of proposed and existing structures (including decks), label these with existing addresses
- ___ 3) Distance from structures to all property lines
- ___ 4) Location and size of easements
- ___ 5) Driveway path and distance at the entrance to the nearest property line
- ___ 6) Location and distance from any waters; sink holes; wetlands; and etc.
- ___ 7) Show slopes and or drainage paths
- ___ 8) Arrow showing North direction

SITE PLAN EXAMPLE

Revised 7/1/15

NOTE:

This site plan can be copied and used with the 911 Addressing Dept. application forms.

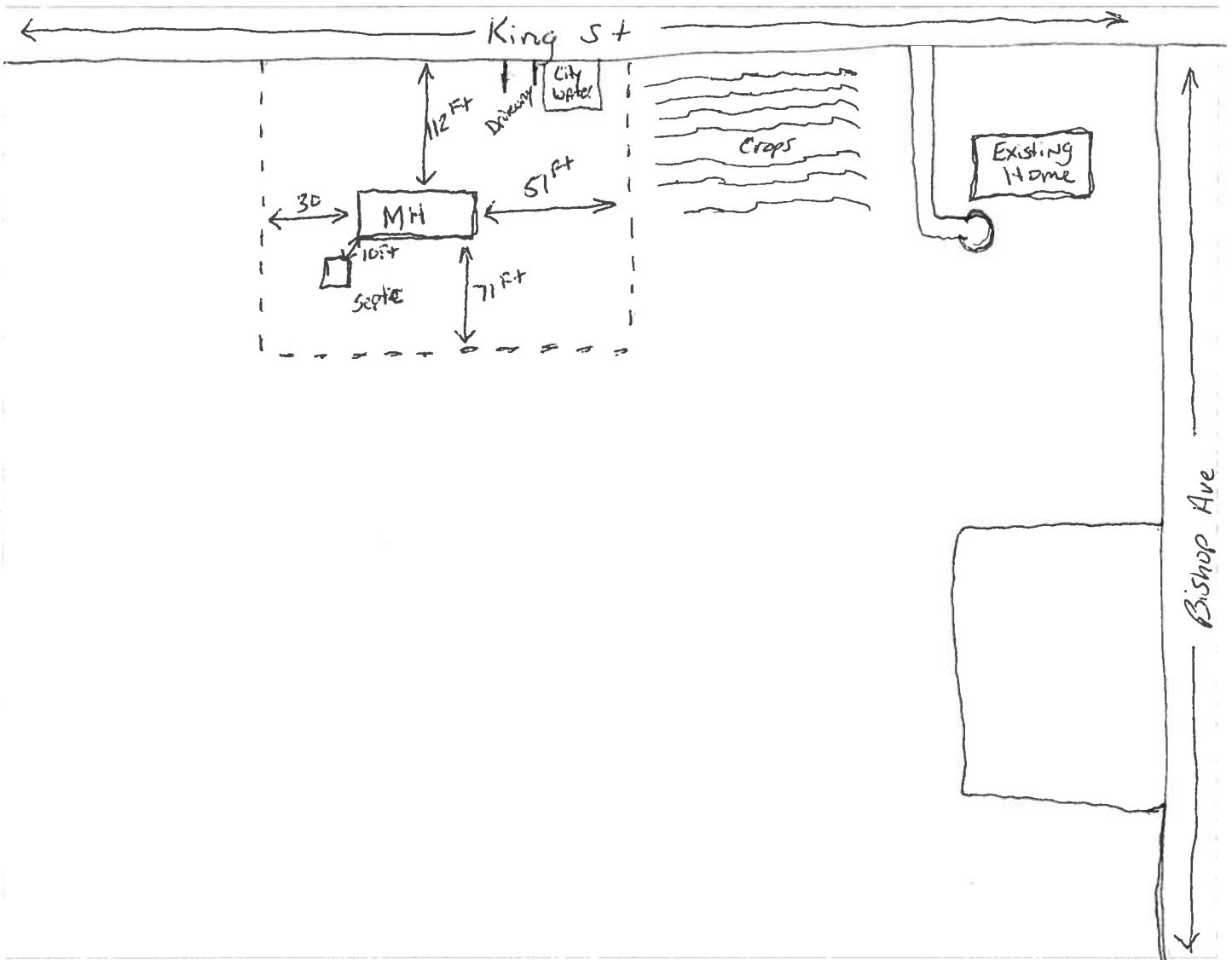
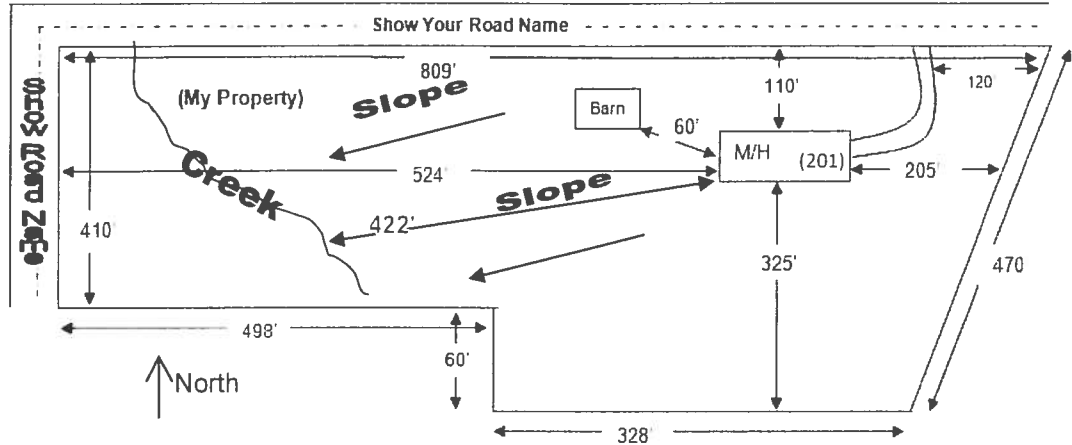

Legend

2016Aerials

Parcels

Roads

Roads

others

Dirt

Interstate

Main

Other

Paved

Private

Addresses

Water Lines

Others

CANAL / DITCH

CREEK

STREAM / RIVER

Flood Zones

0.2 PCT ANNUAL CHANCE

A

AE

AH

DevelopmentZones

others

A-1

A-2

A-3

CG

CHI

CI

CN

CSV

ESA-2

I

ILW

MUD-I

PRD

PRRD

RMF-1

RMF-2

RO

RR

RSF-1

RSF-2

RSF-3

RSF/MH-1

RSF/MH-2

RSF/MH-3

DEFAULT

Building Permits

others

☆ Addition or Remodel

☆ Air Conditioner Replacement or Repair

☆ Culvert

☆ Culvert Waiver

☆ Demolition

☆ Electrical Service Upgrade or Change

☆ Mobile Home

☆ New Commercial Construction

☆ New Residential Construction

☆ ReRoof or Repair

☆ Sign Permit

☆ Solar Power System

☆ Swimming Pool and Spa

☆ Utility Pole

DEFAULT

DONTIMPORT

Building Permits

others

☆ Addition or Remodel

☆ Air Conditioner Replacement or Repair

☆ Culvert

Columbia County, FLA - Building & Zoning Property Map

Printed: Fri May 11 2018 09:44:02 GMT-0400 (Eastern Daylight Time)

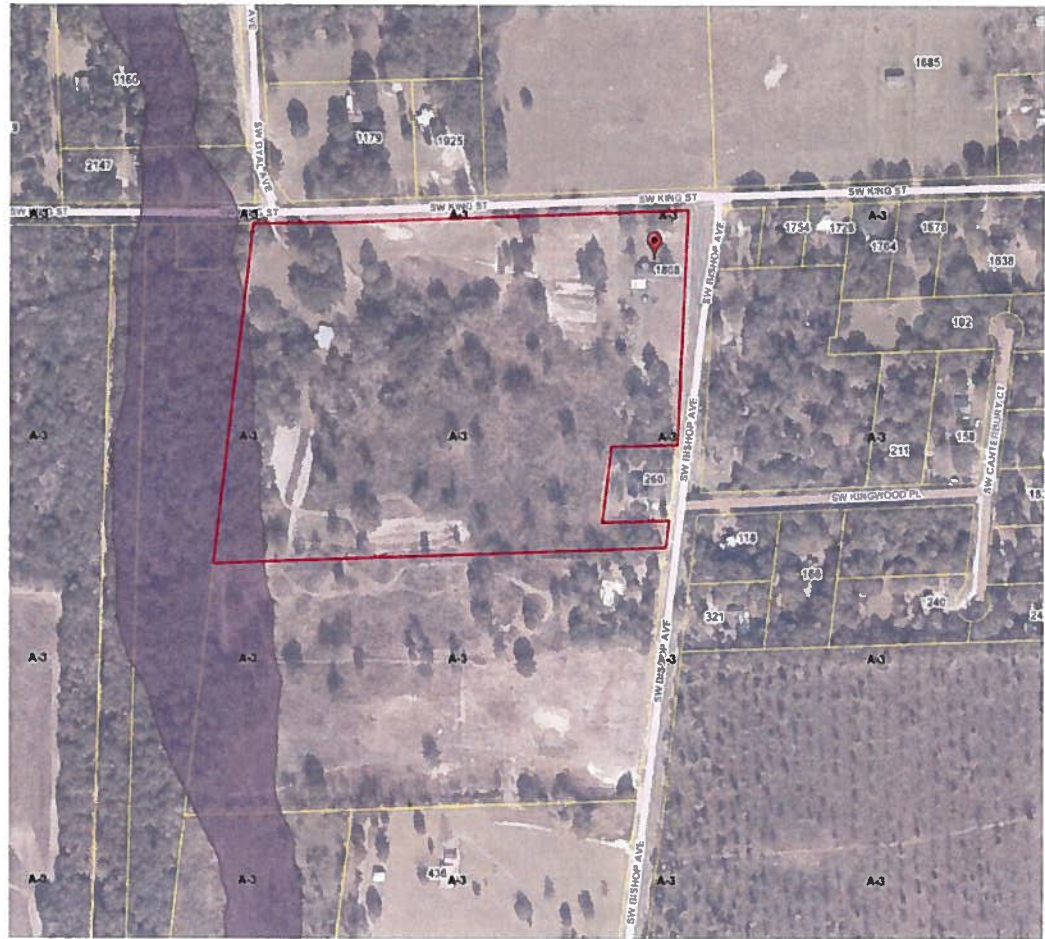



MOBILE HOME INSTALLATION SUBCONTRACTOR VERIFICATION FORM

APPLICATION NUMBER 1805-31 CONTRACTOR Glenn Williams PHONE 386-344-3669

THIS FORM MUST BE SUBMITTED PRIOR TO THE ISSUANCE OF A PERMIT

In Columbia County one permit will cover all trades doing work at the permitted site. It is REQUIRED that we have records of the subcontractors who actually did the trade specific work under the permit. Per Florida Statute 440 and Ordinance 89-6, a contractor shall require all subcontractors to provide evidence of workers' compensation or exemption, general liability insurance and a valid Certificate of Competency license in Columbia County.

Any changes, the permitted contractor is responsible for the corrected form being submitted to this office prior to the start of that subcontractor beginning any work. Violations will result in stop work orders and/or fines.

ELECTRICAL 	Print Name <u>Akeidria Bailey</u> License #: <u>owner</u> Qualifier Form Attached <input type="checkbox"/>	Signature <u>Akeidria Bailey</u> Phone #: <u>(386) 697-4092</u>
MECHANICAL/ A/C 	Print Name <u>Akeidria Bailey</u> License #: <u>owner</u> Qualifier Form Attached <input type="checkbox"/>	Signature <u>Akeidria Bailey</u> Phone #: <u>(386) 697-4092</u>

F. S. 440.103 Building permits; identification of minimum premium policy.--Every employer shall, as a condition to applying for and receiving a building permit, show proof and certify to the permit issuer that it has secured compensation for its employees under this chapter as provided in ss. 440.10 and 440.38, and shall be presented each time the employer applies for a building permit.

This Instrument Prepared by & return to:
Name: BERNARD BAILEY
Address: 2036 SW KING STREET
LAKE CITY FL 32024

Inst: 201812005914 Date: 03/23/2018 Time: 1:41PM
Page 1 of 2 B: 1356 P: 1327 P: DeWitt Cason, Clerk of Court
Columbia County, FL: BD
Deputy Clerk Due Stamp Deed: \$0.00

Parcel ID: # 03269-000

SPICE ABOUT THIS LINE FOR PROCESSING DATA

SPICE ABOUT THIS LINE FOR RECORDING DATA

THIS WARRANTY DEED Made the 22nd day of March, A.D. 2018, by BARNARD BAILEY and LILLIAN BAILEY, HIS WIFE, hereinafter called the grantors, to AKEIDRIA BAILEY, whose post office address is 2036 SW KING STREET, Lake City, FL 32024, hereinafter called the grantee

(Whoever used herein the terms "grantors" and "grantee" include all the parties to this instrument, singular and plural, the heirs, legal representatives and assigns of individuals, and the successors and assigns of corporations, wherever the context so admits or requires.)

Witnesseth: That the grantors, for and in consideration of the sum of \$10.00 and other valuable consideration, receipt whereof is hereby acknowledged, do hereby grant, bargain, sell, alien, remise, release, convey and confirm unto the grantee all that certain land situate in **Columbia County, State of Florida**, viz:

See Attached Exhibit A

Together with all the tenements, hereditaments and appurtenances thereto belonging or in anywise appertaining

To Have and to Hold the same in fee simple forever

And the grantors hereby covenant with said grantee that they are lawfully seized of said land in fee simple, that they have good right and lawful authority to sell and convey said land, and hereby fully warrant the title to said land and will defend the same against the lawful claims of all persons whomsoever, and that said land is free of all encumbrances, except taxes accruing subsequent to December 31, 2018.

In Witness Whereof, the said grantors have signed and sealed these presents, the day and year first above written

Signed, sealed and delivered in the presence of

Witness Signature Mary Ann Tomlinson

Printed Name

Witness Signature Tyler Rogers

Printed Name

BARNARD BAILEY

Address:
2036 SW KING STREET, Lake City, FL 32024

LILLIAN BAILEY

Address:
2036 SW KING STREET, Lake City, FL 32024

STATE OF FLORIDA
COUNTY OF COLUMBIA

The foregoing instrument was acknowledged before me this 22nd day of March, 2018, by BARNARD BAILEY and LILLIAN BAILEY, who are known to me or who have produced Driver's License as identification

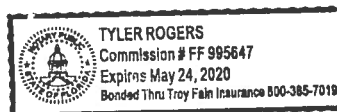

Notary Public
My commission expires

Exhibit "A"

PART OF THE NE ¼ OF THE NE ¼ OF SECTION 34, TOWNSHIP 4 SOUTH, RANGE 16 EAST, COLUMBIA COUNTY, FLORIDA, MORE PARTICULARLY DESCRIBED AS FOLLOWS:

COMMENCE AT A CONCRETE MONUMENT, LS 1079, MARKING THE INTERSECTION OF THE WEST LINE OF THE NE ¼ OF THE NE ¼ OF SECTION 34, TOWNSHIP 4 SOUTH, RANGE 16 EAST, COLUMBIA COUNTY, FLORIDA, AND THE SOUTH RIGHT-OF-WAY LINE OF SW KING STREET AS SHOWN ON A PRIOR SURVEY BY LAUREN E. BRITT, LS 1079, DATED AUGUST 13, 1989, WORK ORDER NO. 1-8816, AND THENCE S.89°49'20"E., ALONG SAID RIGHT-OF-WAY LINE AS MONUMENTED, 462.37 FEET TO A 5/8" IRON ROD, LS 4708, AND THE POINT OF BEGINNING OF THE HEREIN DESCRIBED LANDS; THENCE CONTINUE S.89°49'20"E., 197.64 FEET TO A CONCRETE MONUMENT; THENCE S.08°51'02"W., 222.95 FEET TO A 5/8" IRON ROD, LS 4708; THENCE N.89°49'20"W., 197.64 FEET TO A 5/8" IRON ROD, LS 4708; THENCE N.08°51'02"E., 222.95 TO THE POINT OF BEGINNING. DESCRIBED LANDS CONTAIN 1.00 ACRES, MORE OR LESS.

District No. 1 - Ronald Williams
District No. 2 - Rusty DePratter
District No. 3 - Bucky Nash
District No. 4 - Everett Phillips
District No. 5 - Tim Murphy



BOARD OF COUNTY COMMISSIONERS • COLUMBIA COUNTY

Address Assignment and Maintenance Document

To maintain the county wide Addressing Policy you must make application for a 9-1-1 Address at the time you apply for a building permit. The established standards for addressing and posting numbers to all principal buildings, dwellings, businesses and industries are contained in Columbia County Ordinance 2001-9. The addressing system is to enable Emergency Services Agencies to locate you in an emergency, and to assist the United States Postal Service and the public in the timely and efficient provision of services to residents and businesses of Columbia County

Date/Time Issued: **5/30/2018 2:44:30 PM**
Address: **1928 SW KING St**
City: **LAKE CITY**
State: **FL**
Zip Code **32024**

Parcel ID **03269-001**

REMARKS: Address for proposed structure on parcel.

NOTICE: THIS ADDRESS WAS ISSUED BASED ON LOCATION AND ACCESS INFORMATION RECEIVED FROM THE REQUESTER. SHOULD, AT A LATER DATE, THE LOCATION AND/OR ACCESS INFORMATION BE FOUND TO BE IN ERROR OR CHANGED, THIS ADDRESS IS SUBJECT TO CHANGE.

Address Issued By: **Signed:/ Matt Crews**

Columbia County GIS/911 Addressing Coordinator

**COLUMBIA COUNTY
911 ADDRESSING / GIS DEPARTMENT**

**263 NW Lake City Ave., Lake City, FL 32055 Telephone: (386) 758-1125
Email: gis@columbiacountyfla.com**

Mobile Home

Applicant: glenn williams, jr. (386.344.3669) Application Date: 5/23/2018

Action ▼

1. JOB LOCATION

Completed Inspections

Add Inspection

Release Power

2. CONTRACTOR

[Schedule Inspection \(ScheduleInspection.aspx?id=38038\)](#)

3. MOBILE HOME DETAILS

Inspection	Date	By	Notes
Passed: Mobile Home - In County Pre-Mobile Home before set-up	5/24/2018	TROY CREWS	

4. APPLICANT

5. REVIEW

The completion date must be set To release Certifications to the public.

6. FEES/PAYMENT

Permit Completion Date
(Releases Occupancy and Completion Forms)

7. DOCUMENTS/REPORTS

Incomplete Requested Inspections

8. NOTES/DIRECTIONS

Inspection	Date	By	Notes
------------	------	----	-------

STATE OF FLORIDA
DEPARTMENT OF HEALTH
APPLICATION FOR CONSTRUCTION PERMIT

Permit Application Number

18-03223

Scale: Each block represents 10 feet

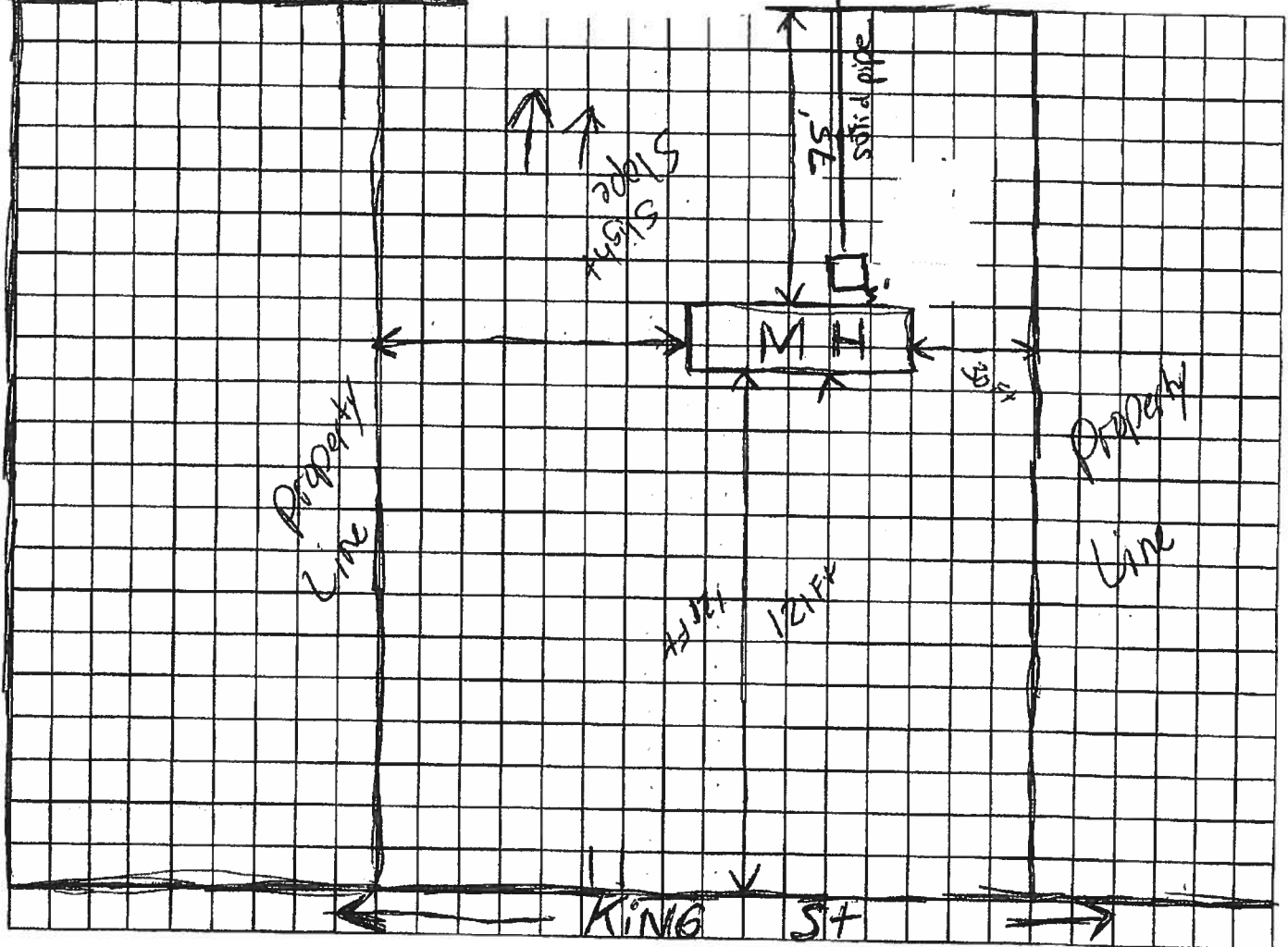

Notes:

Site Plan submitted by: Glenn Williams / Akedina Bailey

Owner.

Plan Approved ☒ Not Approved ☐

By: Salbi Ind ENV MD

Col.

Date 4-16-18

County Health Department

ALL CHANGES MUST BE APPROVED BY THE COUNTY HEALTH DEPARTMENT

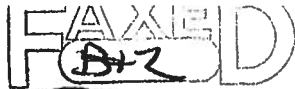

STATE OF FLORIDA
DEPARTMENT OF HEALTH
ONSITE SEWAGE TREATMENT AND DISPOSAL
SYSTEM
APPLICATION FOR CONSTRUCTION PERMIT

880 107809625

PERMIT NO. 18-0323
DATE PAID: 4/17/18
FEE PAID: 425.00
RECEIPT #: 1339809

APPLICATION FOR:

☒ New System ☐ Existing System ☐ Holding Tank ☐ Innovative
☐ Repair ☐ Abandonment ☐ Temporary ☐

APPLICANT: Akeidria BaileyAGENT: Glen WilliamsTELEPHONE: 386-292-2891

MAILING ADDRESS: _____

TO BE COMPLETED BY APPLICANT OR APPLICANT'S AUTHORIZED AGENT. SYSTEMS MUST BE CONSTRUCTED BY A PERSON LICENSED PURSUANT TO 489.105(3) (m) OR 489.552, FLORIDA STATUTES. IT IS THE APPLICANT'S RESPONSIBILITY TO PROVIDE DOCUMENTATION OF THE DATE THE LOT WAS CREATED OR PLATTED (MM/DD/YY) IF REQUESTING CONSIDERATION OF STATUTORY GRANDFATHER PROVISIONS.

PROPERTY INFORMATION

LOT: _____ BLOCK: _____ SUBDIVISION: _____ PLATTED: _____

*PROPERTY ID #: 34-45-14-03209-000 ZONING: _____ I/M OR EQUIVALENT: ☐ Y ☒ N

PROPERTY SIZE: 1 ACRES WATER SUPPLY: ☐ PRIVATE ☒ PUBLIC ☐ <=2000GPD ☐ >2000GPD

IS SEWER AVAILABLE, AS PER 381.0065, FS? ☐ Y ☒ N

DISTANCE TO SEWER: 85 FT

PROPERTY ADDRESS: 2036 King St Lake City FL 32055

DIRECTIONS TO PROPERTY: Travel South on SR-47; turn right on to King St, go 1 mile property on the Left.

BUILDING INFORMATION

☒ RESIDENTIAL ☐ COMMERCIAL

Unit No	Type of Establishment	No. of Bedrooms	Building Area Sqft	Commercial/Institutional System Design Table 1, Chapter 64E-6, FAC
1	<u>mobile Home</u>	<u>2</u>	<u>924</u>	
2				
3				
4				

☐ Floor/Equipment Drains ☐ Other (Specify) _____

SIGNATURE: Akeidria BaileyDATE: 04.10.18



COLUMBIA COUNTY BUILDING DEPARTMENT
135 NE Hernando Ave, Suite B-21, Lake City, FL 32055
Phone: 386-758-1008 Fax: 386-758-2160

37268

MOBILE HOME INSTALLERS LETTER OF AUTHORIZATION

I, GLENN Williams, Jr., give this authority for the job address show below
Installer License Holder Name

only, 1928 SW King St, and I do certify that
Job Address

the below referenced person(s) listed on this form is/are under my direct supervision and control and is/are authorized to purchase permits, call for inspections and sign on my behalf.

Printed Name of Authorized Person	Signature of Authorized Person	Authorized Person is... (Check one)
Akeidria Bailey		<input type="checkbox"/> Agent <input type="checkbox"/> Officer <input checked="" type="checkbox"/> Property Owner
		<input type="checkbox"/> Agent <input type="checkbox"/> Officer <input type="checkbox"/> Property Owner
		<input type="checkbox"/> Agent <input type="checkbox"/> Officer <input type="checkbox"/> Property Owner

I, the license holder, realize that I am responsible for all permits purchased, and all work done under my license and I am fully responsible for compliance with all Florida Statutes, Codes, and Local Ordinances.

I understand that the State Licensing Board has the power and authority to discipline a license holder for violations committed by him/her or by his/her authorized person(s) through this document and that I have full responsibility for compliance granted by issuance of such permits.

License Holders Signature (Notarized)
IH1054858 License Number
6.22.18 Date

NOTARY INFORMATION:

STATE OF: Florida COUNTY OF: COLUMBIA

The above license holder, whose name is GLENN Williams, personally appeared before me and is known by me or has produced identification (type of I.D.) on this 22nd day of JUNE, 2018.

NOTARY'S SIGNATURE

(Seal/Stamp)

