

SUBJECT PARCEL DESCRIPTION
LOT 16 OF RIVER RISE RESIDENTIAL, SUBDIVISION UNIT 1, A SUBDIVISION, ACCORDING TO THE PLAT THEREOF AS RECORDED IN PLAT BOOK 8, PAGES 51, OF THE PUBLIC RECORDS OF COLUMBIA COUNTY, FLORIDA.

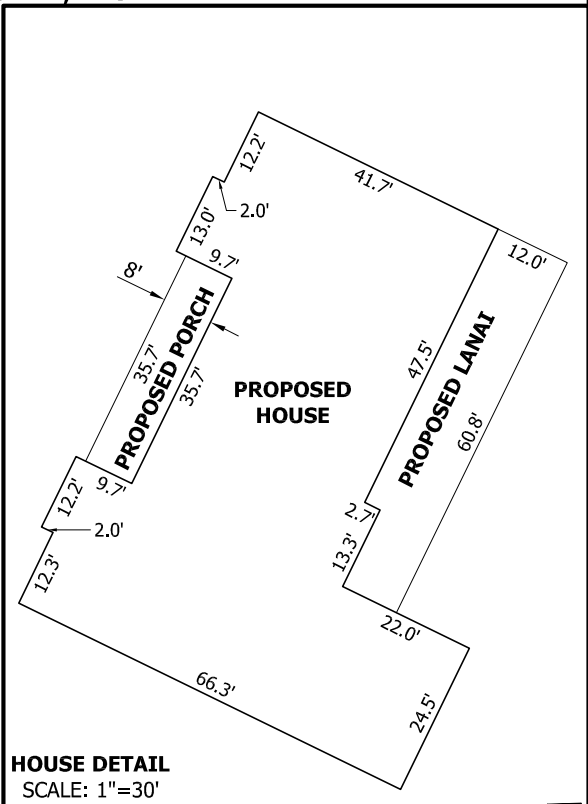

- CERTIFIED TO:**
1. LELAND M. BALLARD AND AUBREY BALLARD
 2. ROBERT HOLLAND CATO, JR. AND SHERRY BAKER CATO
 3. UNIVERSITY LENDING GROUP, LLC, ISAOA/ATIMA
 4. BRENT E. BARIS, P.A.
 5. OLD REPUBLIC NATIONAL TITLE INSURANCE COMPANY

SURVEYOR'S NOTES

1. BEARINGS SHOWN HEREON ARE ASSUMED AND REFERENCED TO THE EAST RIGHT-OF-WAY LINE OF SW GREY WAY AS BEARING N01° 36' 17"W.
2. THE BOUNDARY SURVEY SHOWN HEREON IS BASED ON ACTUAL FIELD MEASUREMENTS AND OBSERVATIONS DATED MARCH 8, 2022.
3. THIS SURVEY MAP OR THE COPIES THEREOF ARE NOT VALID WITHOUT THE SIGNATURE AND THE ORIGINAL RAISED SEAL OF A FLORIDA LICENSED SURVEYOR AND MAPPER.
4. ALL MEASURED BEARINGS AND DISTANCES WERE IN SUBSTANTIAL AGREEMENT WITH RECORD DATA UNLESS OTHERWISE NOTED.
5. PROPERTY LINE TIES ARE PERPENDICULAR MEASURE UNLESS OTHERWISE NOTED.
6. PRIMARY BUILDING SETBACK REQUIREMENTS ARE 30' FRONT, 25' REAR AND 25' SIDES PER PLAT. RESIDENTIAL BUILDING SETBACKS NOTED IN O.R. 1074, PAGE 540, ARTICLE VII, SECTION 4 ARE 100' FRONT AND 50' SIDE & REAR. SETBACK REQUIREMENTS SHOULD BE VERIFIED.

- LEGEND**
- INDICATES 5/8" REBAR & CAP FOUND STAMPED "LB 6683"
 - ⊙ INDICATES NAIL & DISK FOUND STAMPED "LB 6683"
 - O.R. INDICATES OFFICIAL RECORDS BOOK
 - I.D. INDICATES IDENTIFICATION
 - U.E. INDICATES PUBLIC UTILITIES EASEMENT
 - B.S.L. INDICATES BUILDING SETBACK LINE
 - R/W INDICATES RIGHT-OF-WAY
 - (P) INDICATES PLAT DATA WHEN DIFFERENT THAN MEASURED

FLOOD ZONE NOTE
THE HEREON DESCRIBED SUBJECT PARCEL APPEARS TO LIE IN FLOOD ZONE X ON THE FEDERAL EMERGENCY MANAGEMENT ACT FIRM, COMMUNITY PANEL MAP NUMBER 12023C0513C DATED FEBRUARY 4, 2009.

TAX PARCEL 16-7S-17-10006-212
OWNER: MCALHANY, PATRICIA S. REVOCABLE TRUST
O.R. 1452, PAGE 2656

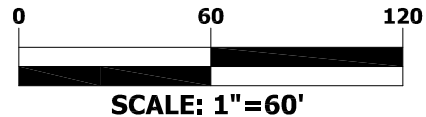

PLOT PLAN

STONECYPHER SURVEYING INC.
1225 NW 16TH AVENUE GAINESVILLE, FLORIDA 32601
Tel.: (352) 379-0948
E-mail: dws@stone-survey.com
Professional Surveying & Mapping
Certificate of Authorization No.: LB 7810

| | | | | | |
|--|-------|--|---------------|-----------|-------------------|
| BOOK/PAGE | 39/70 | DATE | 6-8-2022 | SCALE | 1"=60' |
| DRAWN | MRJ | DATE | MARCH 8, 2022 | PROJECT # | 22-0021 |
| CHECKED | DWS | MITCHELL R. JARRELLS PROFESSIONAL SURVEYOR & MAPPER FLA. LICENSE NO. 6438 | | | |
| BOUNDARY SURVEY COLUMBIA COUNTY TAX PARCEL: 16-7S-17-10006-214 LOT 16, RIVER RISE RESIDENTIAL SUBDIVISION UNIT 1 PER PLAT BOOK 8, PAGE 51 | | | | | |
| DRAWING # BALLARD.SURVEY.DWG | | | | | SHEET # 1 OF 1 |