

# Mobile Home Permit Worksheet

Installer: Robert Sheppard License # JH/1005386  
 Address of home being installed 260 SW Vista Ter.  
LAKE Ocky, FL  
 Manufacturer Champion Length x width 56 x 28

**NOTE:** If home is a single wide fill out one half of the blocking plan  
 if home is a triple or quad wide sketch in remainder of home  
 I understand Lateral Arm Systems cannot be used on any home (new or used)  
 where the sidewall ties exceed 5 ft 4 in.

Typical pier spacing 5 Installer's initials RS  
 lateral  
 longitudinal  
 Show locations of Longitudinal and Lateral Systems  
 (use dark lines to show these locations)

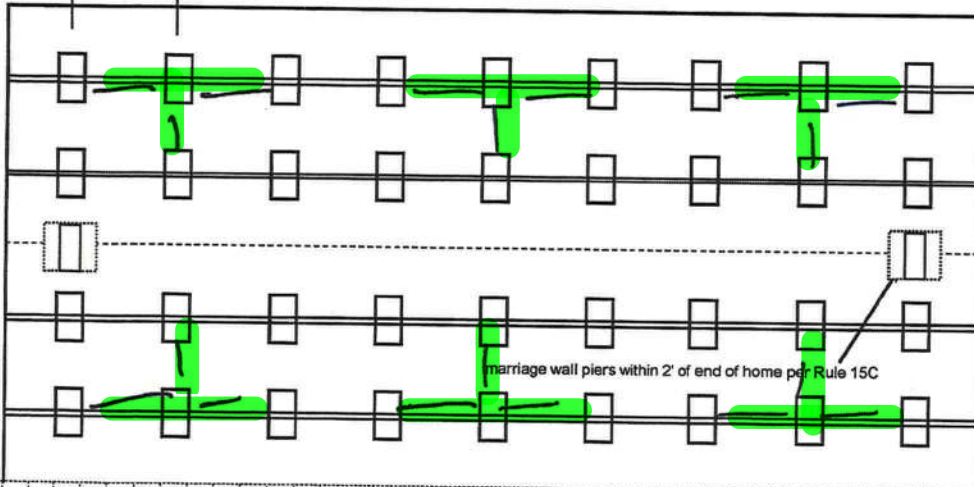

Anthony Islan

11/15/2021

Application Number: \_\_\_\_\_ Date: \_\_\_\_\_

New Home ☒ Used Home ☐

Home installed to the Manufacturer's Installation Manual  
 Home is installed in accordance with Rule 15-C ☒

Single wide ☐ Wind Zone II ☒ Wind Zone III ☐

Double wide ☒ Installation Decal # \_\_\_\_\_

Triple/Quad ☐ Serial # F1261-00-A-B202932 AB

## PIER SPACING TABLE FOR USED HOMES

Load bearing capacity	Footer size (sq in)	16" x 16" (256)	18 1/2" x 18 1/2" (342)	20" x 20" (400)	22" x 22" (484)*	24" x 24" (576)*	26" x 26" (676)
1000 psf		3'	4'	5'	6'	7'	8'
1500 psf		4' 6"	6'	7'	8'	8'	8'
2000 psf		6'	8'	8'	8'	8'	8'
2500 psf		7' 6"	8'	8'	8'	8'	8'
3000 psf		8'	8'	8'	8'	8'	8'
3500 psf		8'	8'	8'	8'	8'	8'

\* interpolated from Rule 15C-1 pier spacing table.

### PIER PAD SIZES

I-beam pier pad size 17x35

Perimeter pier pad size 16x16

Other pier pad sizes (required by the mfg.) \_\_\_\_\_

Draw the approximate locations of marriage wall openings 4 foot or greater. Use this symbol to show the piers.

List all marriage wall openings greater than 4 foot and their pier pad sizes below.

Opening Pier pad size

\_\_\_\_\_  
 \_\_\_\_\_  
 \_\_\_\_\_

### TIEDOWN COMPONENTS

Longitudinal Stabilizing Device (LSD)

Manufacturer \_\_\_\_\_

Longitudinal Stabilizing Device w/ Lateral Arms

Manufacturer Oliver

### POPULAR PAD SIZES

Pad Size	Sq In
16 x 16	256
16 x 18	288
18.5 x 18.5	342
16 x 22.5	360
17 x 22	374
13 1/4 x 26 1/4	348
20 x 20	400
17 3/16 x 25 3/16	441
17 1/2 x 25 1/2	446
24 x 24	576
26 x 26	676

### ANCHORS

4 ft ☒ 5 ft

### FRAME TIES

within 2' of end of home  
 spaced at 5' 4" oc

### OTHER TIES

	Number
Sidewall	<u>26</u>
Longitudinal	<u>6</u>
Marriage wall	<u>8</u>
Shearwall	<u>4</u>



# Mobile Home Permit Worksheet

Application Number: \_\_\_\_\_ Date: \_\_\_\_\_

## POCKET PENETROMETER TEST

The pocket penetrometer tests are rounded down to \_\_\_\_\_ psf or check here to declare 1000 lb. soil without testing.

x 1000 x 1000 x 1000

## POCKET PENETROMETER TESTING METHOD

1. Test the perimeter of the home at 6 locations.
2. Take the reading at the depth of the footer.
3. Using 500 lb. increments, take the lowest reading and round down to that increment.

x 1000 x 1000 x 1000

## TORQUE PROBE TEST

The results of the torque probe test is 285 inch pounds or check here if you are declaring 5' anchors without testing \_\_\_\_\_. A test showing 275 inch pounds or less will require 5 foot anchors.

**Note:** A state approved lateral arm system is being used and 4 ft. anchors are allowed at the sidewall locations. I understand 5 ft anchors are required at all centerline tie points where the torque test reading is 275 or less and where the mobile home manufacturer may require anchors with 4000 lb holding capacity.

RS Installer's initials

## ALL TESTS MUST BE PERFORMED BY A LICENSED INSTALLER

Installer Name Robert Sheppard

Date Tested 11/10/21

## Electrical

Connect electrical conductors between multi-wide units, but not to the main power source. This includes the bonding wire between multi-wide units. Pg. 29

## Plumbing

Connect all sewer drains to an existing sewer tap or septic tank. Pg. 28

Connect all potable water supply piping to an existing water meter, water tap, or other independent water supply systems. Pg. 28

## Site Preparation

Debris and organic material removed ☒  
Water drainage: Natural \_\_\_\_\_ Swale \_\_\_\_\_ Pad ☒ Other \_\_\_\_\_

## Fastening multi wide units

Floor: Type Fastener: Lags Length: 6 Spacing: 16  
Walls: Type Fastener: screws Length: 4 Spacing: 16  
Roof: Type Fastener: Lags Length: 5 Spacing: 16  
For used homes a min. 30 gauge, 8" wide, galvanized metal strip will be centered over the peak of the roof and fastened with galv. roofing nails at 2" on center on both sides of the centerline.

## Gasket (weatherproofing requirement)

I understand a properly installed gasket is a requirement of all new and used homes and that condensation, mold, mildew and buckled marriage walls are a result of a poorly installed or no gasket being installed. I understand a strip of tape will not serve as a gasket.

Installer's initials RS

Type gasket Factory  
Pg. \_\_\_\_\_

Installed:  
Between Floors Yes ☒  
Between Walls Yes ☒  
Bottom of ridgebeam Yes ☒

## Weatherproofing

The bottomboard will be repaired and/or taped. Yes ☒ Pg. \_\_\_\_\_  
Siding on units is installed to manufacturer's specifications. Yes ☒  
Fireplace chimney installed so as not to allow intrusion of rain water. Yes ☒

## Miscellaneous

Skirting to be installed. Yes ☒ No \_\_\_\_\_  
Dryer vent installed outside of skirting. Yes \_\_\_\_\_ N/A ☒  
Range downflow vent installed outside of skirting. Yes \_\_\_\_\_ N/A ☒  
Drain lines supported at 4 foot intervals. Yes ☒  
Electrical crossovers protected. Yes ☒  
Other : \_\_\_\_\_

Installer verifies all information given with this permit worksheet is accurate and true based on the manufacturer's installation instructions and or Rule 15C-1 & 2

Installer Signature Robert Sheppard Date 11/10/21

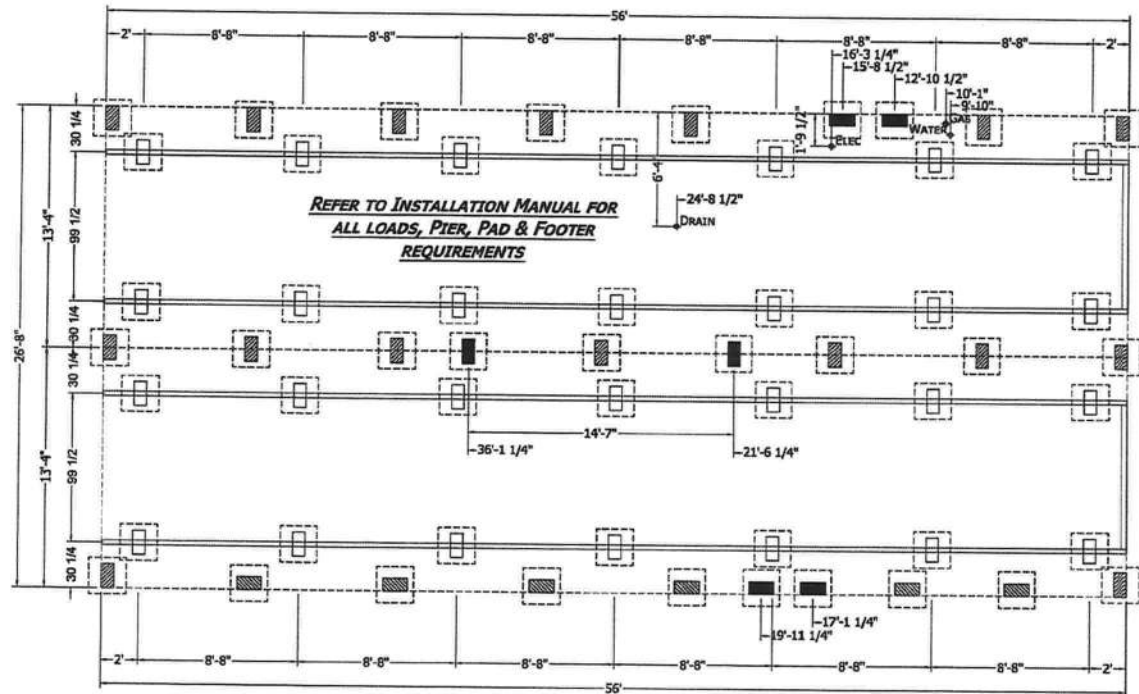

**MANUFACTURER DISCLAIMER NOTICE: (THIS PIER PRINT IS FOR HOMES PRODUCED ON OR AFTER JUNE 1ST 2008)**  
PLEASE READ AND UNDERSTAND THE FOLLOWING INFORMATION. THE MANUFACTURER DOES NOT DO FOUNDATION INSTALLATION OF HOMES. IT WILL BE THE RESPONSIBILITY OF THE DEALER/SITE CONTRACTOR TO INSURE THAT ALL SITE WORK WILL CORRELATE WITH THE UNIT ORDERED.

NOTICE TO HOME INSTALLERS: MANUFACTURED HOMES WEIGH SEVERAL TONS. DO NOT ATTEMPT TO INSTALL ANY HOME ON SITE WITHOUT HAVING EXPERIENCE, KNOWLEDGE, AND UNDERSTANDING OF ALL INSTALLATION REQUIREMENTS. FAILURE TO MEET THESE REQUIREMENTS MAY RESULT IN SERIOUS INJURY OR DEATH TO AN INEXPERIENCED INSTALLER. INSTALLERS: PLEASE READ AND UNDERSTAND THE SET-UP AND INSTALLATION MANUAL SUPPLIED WITH THE HOME BEFORE ATTEMPTING ANY INSTALLATION OF ANY MANUFACTURED HOME.

= FRAME PIER

= POINT LOAD PIER

= PERIMETER PIER

- 1) THE MANUFACTURER ASSUMES NO RESPONSIBILITY FOR ACTUAL FOUNDATION DESIGN AND CONSTRUCTION.
- 2) ADDITIONAL BLOCKING IS REQUIRED AT EACH SIDE OF EXTERIOR DOORS AND AT EACH SIDE OF SIDEWALL OPENINGS GREATER THAN 4 FEET IN WIDTH (I.E., PATIO DOORS, PICTURE WINDOWS, ETC.).
- 3) FOR PIER REQUIREMENTS AT ENDWALL SEE FIGURE 8 IN THE INSTALLATION MANUAL.
- 4) ALL DWV, PLUMBING, GAS SUPPLY, ETC., DIMENSIONS ON PRINT MAY BE + OR - 12".

- 5) IT WILL BE THE RESPONSIBILITY OF THE SITE CONTRACTOR TO VERIFY THE PROPER LOCATION OF COLUMN SUPPORT BLOCKING AND TO VERIFY THE PROPER MATING LINE GROWTH DIMENSIONS BASED UPON ACTUAL SITE CONDITIONS AND REQUIREMENTS (DOUBLE WIDES ONLY).
- 6) ALLOW 1/2" AT MATING LINE FOR MATE UP GROWTH.
- 7) SEE SET-UP AND INSTALLATION MANUAL FOR PERIMETER BLOCKING REQUIREMENTS.

PERMANENT FOUNDATIONS: CHECK LOCAL BUILDING CODES AND REGULATIONS AND CONSULT A REGISTERED PROFESSIONAL OR STRUCTURAL ENGINEER WHEN YOU ARE SITTING YOUR HOME ON A PERMANENT FOUNDATION (SUCH AS A FULL BASEMENT, CRAWL SPACE, OR LOAD BEARING PERIMETER FOUNDATION).

**CHAMPION**  
**HOME BUILDERS**

795 W. BIG BEAVER ROAD, SUITE 1000 TROY, MI 48064  
PHONE: 248-614-4000

MODIFICATIONS

PROJECT:  
**2856H32P01**  
**56'-0" x 26'-8"**  
**3 BD 2 BT**

DRAWN BY: B.CAMPBELL  
DATE: 06-10-20  
SCALE: 5/32" = 1'-0"

TITLE:  
**PIER**  
**FOUNDATION**  
**PLAN**

FILENAME: 261-2856H32P01 6-16-2020

SHEET:  
**PR-101**

PROPRIETARY AND CONFIDENTIAL  
THESE DRAWINGS AND SPECIFICATIONS ARE ORIGINAL  
PROPERTY AND CONFIDENTIAL MATERIALS OF CHAMPION  
COPYRIGHT © 2016-2020 BY CHAMPION

#12

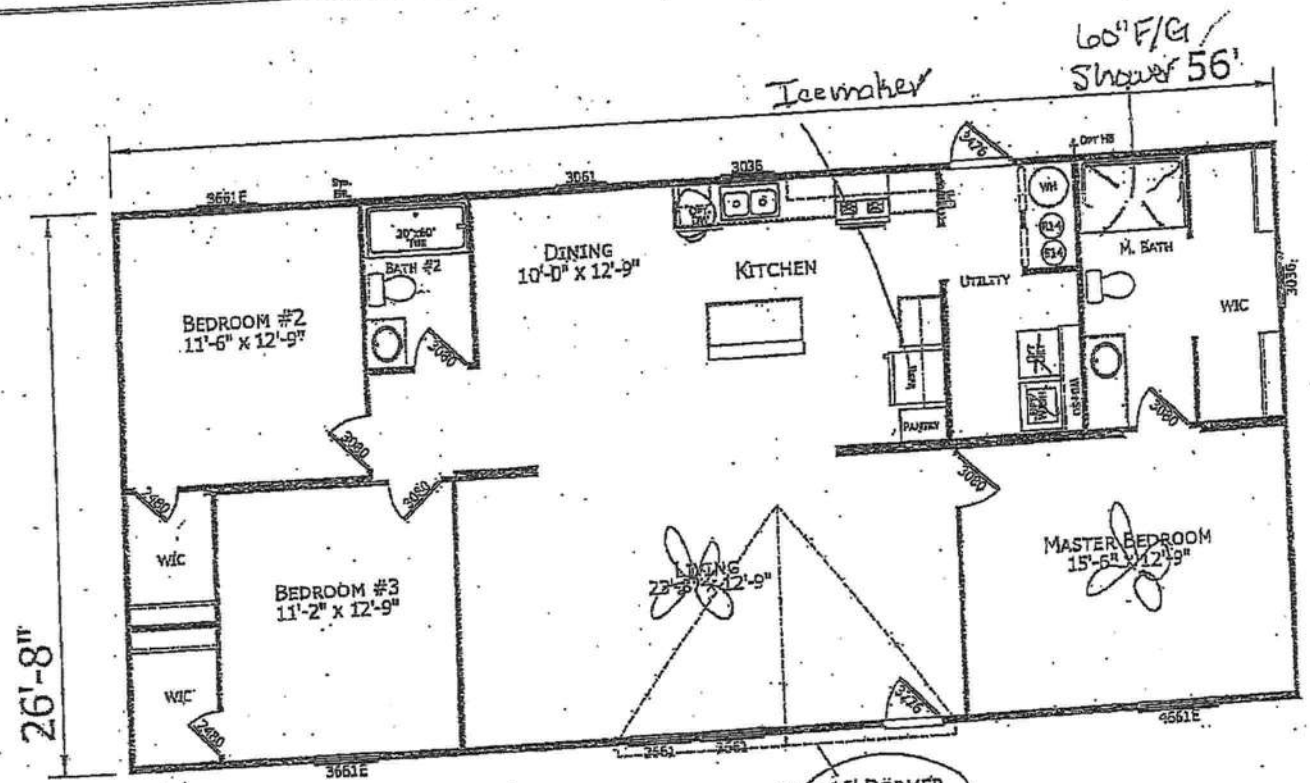

2856H32P01  
 3 BEDROOM 2 BATH  
 56'-0" X 26'-8"  
 1493 SQ. FT. TOTAL  
 06-16-2020

<b>CHAMPION</b> HOME BUILDERS <small>285 W. 400 S. 2000 E. SUITE 1000, DENTON, TX 76205-4400</small>	1. Approved by Client 2. Approved for Local City/County	3/13/2020 BC 4/14/2020 BC PROJECT: 2856H32P01 56'-0" X 26'-8" 3 BD 2 BT DRAWN BY: J. CAMPBELL DATE: 06-10-20 SCALE: 3/16" = 1'-0"	TITLE: LITERATURE PLAN FILE NAME: 2856H32P01 6-11-2020	SHEET: L-101 <small>PROPRIETARY AND CONFIDENTIAL          THIS DRAWING AND ANY INFORMATION CONTAINED HEREIN IS THE PROPERTY OF CHAMPION HOME BUILDERS. NO PART OF THIS DRAWING IS TO BE REPRODUCED OR TRANSMITTED IN ANY FORM OR BY ANY MEANS, ELECTRONIC OR MECHANICAL, WITHOUT PERMISSION IN WRITING FROM CHAMPION HOME BUILDERS.</small>
--	--	--	---	--