



STATE OF FLORIDA
DEPARTMENT OF HEALTH
ONSITE SEWAGE TREATMENT AND DISPOSAL
SYSTEM

PERMIT #: **12-SC-2968315**
APPLICATION #: **AP2119132**
DATE PAID: _____
FEE PAID: _____
RECEIPT #: _____
DOCUMENT #: **PR2140804**

CONSTRUCTION PERMIT FOR: OSTDS Existing Modification

APPLICANT: ES **24-0632 FRANKLIN LLC

PROPERTY ADDRESS: 921 NW SPRADLEY Lake City, FL 32055

LOT: _____ BLOCK: _____ SUBDIVISION: _____

PROPERTY ID #: 04597-000 [SECTION, TOWNSHIP, RANGE, PARCEL NUMBER]
[OR TAX ID NUMBER]

SYSTEM MUST BE CONSTRUCTED IN ACCORDANCE WITH SPECIFICATIONS AND STANDARDS OF SECTION 381.0065, F.S., AND CHAPTER 64E-6, F.A.C. DEPARTMENT APPROVAL OF SYSTEM DOES NOT GUARANTEE SATISFACTORY PERFORMANCE FOR ANY SPECIFIC PERIOD OF TIME. ANY CHANGE IN MATERIAL FACTS, WHICH SERVED AS A BASIS FOR ISSUANCE OF THIS PERMIT, REQUIRE THE APPLICANT TO MODIFY THE PERMIT APPLICATION. SUCH MODIFICATIONS MAY RESULT IN THIS PERMIT BEING MADE NULL AND VOID. ISSUANCE OF THIS PERMIT DOES NOT EXEMPT THE APPLICANT FROM COMPLIANCE WITH OTHER FEDERAL, STATE, OR LOCAL PERMITTING REQUIRED FOR DEVELOPMENT OF THIS PROPERTY.

SYSTEM DESIGN AND SPECIFICATIONS

T [1,050] GALLONS / GPD Septic CAPACITY
A [] GALLONS / GPD N/A CAPACITY
N [] GALLONS GREASE INTERCEPTOR CAPACITY [MAXIMUM CAPACITY SINGLE TANK:1250 GALLONS]
K [] GALLONS DOSING TANK CAPACITY [] GALLONS @ [] DOSES PER 24 HRS #Pumps []

D [500] SQUARE FEET _____ SYSTEM
R [] SQUARE FEET N/A SYSTEM
A TYPE SYSTEM: [X] STANDARD [] FILLED [] MOUND []
I CONFIGURATION: [X] TRENCH [] BED []

N
F LOCATION OF BENCHMARK: Nail in oak E of site

I ELEVATION OF PROPOSED SYSTEM SITE [12.00] [INCHES] FT [] [ABOVE / BELOW] BENCHMARK/REFERENCE POINT

E BOTTOM OF DRAINFIELD TO BE [40.00] [INCHES] FT [] [ABOVE / BELOW] BENCHMARK/REFERENCE POINT

L

D FILL REQUIRED: [0.00] INCHES EXCAVATION REQUIRED: [] INCHES

O The system is sized for 4 bedrooms with a maximum occupancy of 8 persons (2 per bedroom), for a total estimated flow of 400 gpd.

T Add 160 sqft of drainfield to existing 340sqft for a total of 500 sqft at same elev. as original

E

R

SPECIFICATIONS BY: William D Bishop II TITLE: Master Septic Contractor

APPROVED BY: Kyle B Roberts TITLE: Environmental Manager Columbia CHD

DATE ISSUED: 08/19/2024 EXPIRATION DATE: 02/19/2026

DEP 4015, 06-21-2022 (Obsoletes previous editions which may not be used)

Incorporated 62-6.004, FAC



STATE OF FLORIDA
DEPARTMENT OF ENVIRONMENTAL PROTECTION
ONSITE SEWAGE TREATMENT AND DISPOSAL
SYSTEM (OSTDS)

PERMIT NO. 94-0632
DATE PAID: 8/13/24
FEE PAID: 205.00
RECEIPT #: 2119132

APPLICATION FOR CONSTRUCTION PERMIT

APPLICATION FOR:

☒ New System ☐ Existing System ☐ Holding Tank ☐ Innovative
☒ Repair ☐ Abandonment ☐ Temporary ☒ Modis

APPLICANT: ES Franklin LLC

EMAIL: rockyford@

AGENT: A & B Construction

Windsream.net
TELEPHONE: 386-497-2311

MAILING ADDRESS: 546 SW Darton St, Ft. White, FL 32038

TO BE COMPLETED BY APPLICANT OR APPLICANT'S AUTHORIZED AGENT. SYSTEMS MUST BE CONSTRUCTED BY A PERSON LICENSED PURSUANT TO 489.105(3)(m) OR 489.552, FLORIDA STATUTES. IT IS THE APPLICANT'S RESPONSIBILITY TO PROVIDE DOCUMENTATION OF THE DATE THE LOT WAS CREATED OR PLATTED (MM/DD/YY) IF REQUESTING CONSIDERATION OF STATUTORY GRANDFATHER PROVISIONS.

PROPERTY INFORMATION

OSTDS REMEDIATION PLAN? [Y / N]

LOT: NA BLOCK: NA SUBDIVISION: NA PLATTED: _____

PROPERTY ID # 29-18-17-04597-000 ZONING: _____ I/M OR EQUIVALENT: [Y / N]

PROPERTY SIZE 65.18 ACRES WATER SUPPLY: ☒ PRIVATE PUBLIC [] <=2000GPD [] >2000GPD

IS SEWER AVAILABLE AS PER 381.0065, FS? [Y / ☒ N] DISTANCE TO SEWER: NA FT

PROPERTY ADDRESS: 921 NW Spradley Rd, Lake City, FL.

DIRECTIONS TO PROPERTY: TR onto US-441 N, TL onto NW Spradley Rd.

BUILDING INFORMATION

☒ RESIDENTIAL [] COMMERCIAL

Unit No	Type of Establishment	No. of Bedrooms	Building Area Sqft	Commercial/Institutional System Design Table I, Chapter 62-6, FAC
1	<u>New addition</u>	<u>1</u>	<u>364</u>	
2	<u>Existing house</u>	<u>3</u>	<u>1120</u>	<u>Build 1260</u>
3			<u>1484 total</u>	
4				

[] Floor/Equipment Drains [] Other (Specify) _____

SIGNATURE: William L. Bishop II

DATE: 7-29-24

STATE OF FLORIDA
DEPARTMENT OF ENVIRONMENTAL PROTECTION
APPLICATION FOR CONSTRUCTION PERMIT

Permit Application Number 24-0632

Es Franklin LLC

PART II - SITEPLAN

Scale: Each block represents 10 feet and 1 inch = 40 feet.

See
Attached

Notes: _____

Site Plan submitted by

William A. Bishop II

master contractor

Plan Approved ☒

Not Approved ☐

Date 8/19/24

By

[Signature]

ESL

Columbia

County Health Department

ALL CHANGES MUST BE APPROVED BY THE COUNTY HEALTH DEPARTMENT

DEP 4015, 08-21-2022 (Obsoletes previous editions which may not be used)

Incorporated: 62-6.004.F.A.C.

↑N

24-0622 ES Franklin

lin = 40 ft.

7-29-24

1 acre of 65.18

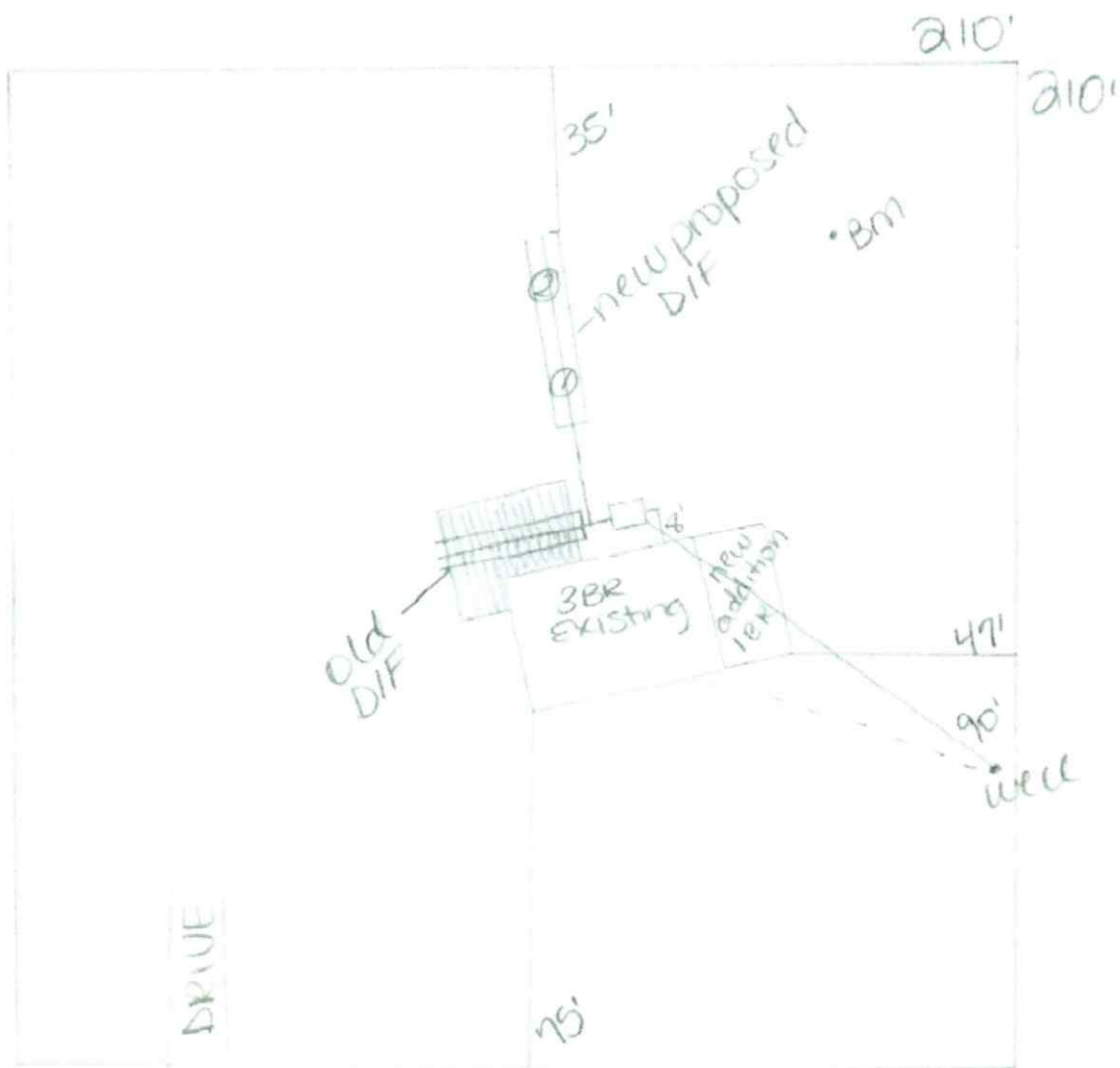
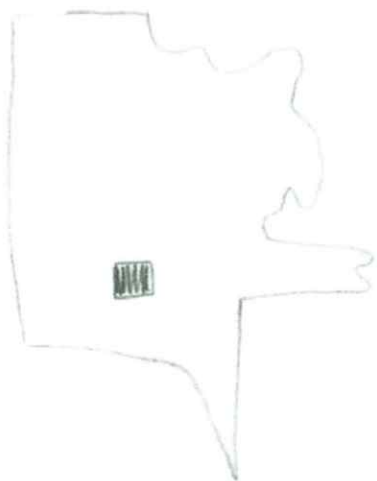

NW Spradley Rd.

William Bishop II