

COLUMBIA COUNTY

Property Appraiser

Parcel 03-4S-17-07570-109

Owners

MCCARTY LARRY
MCCARTY SHARON E
364 SE SABLE LN
LAKE CITY, FL 32025

Parcel Summary

Location	364 SE SABLE LN
Use Code	0100: SINGLE FAMILY
Tax District	2: COUNTY
Acreage	.6500
Section	03
Township	4S
Range	17
Subdivision	SUZANNE
Exemptions	01: HOMESTEAD (196.031a&b) (100%)

Legal Description

THAT PORTION OF LOT 3 UNIT 5 SUZANNE S/D DESC AS FOLLOWS: COMM NW COR OF SAID LOT 3, RUN N 73 DEG E 69.11 FT FOR POB, CONT NE 73 DEG ALONG N LINE OF LOT 102.40 FT, SE'LY ALONG ARC OF A CURVE 55.63 FT, S 141.23 FT, S 66 DEG W 30.85 FT, S 27 DEG W 64.19 FT, W 62.15 FT, S 35 DEG W 42.98 FT, N 255.07 FT TO POB.

916-1249, 981-668, WD 1053-1289, WD 1435-324, DC 1458-975, WD 1462-1298

Working Values

	2025
Total Building	\$250,420



	2025
Total Extra Features	\$4,322
Total Market Land	\$23,125
Total Ag Land	\$0
Total Market	\$277,867
Total Assessed	\$125,655
Total Exempt	\$50,722
Total Taxable	\$74,933
SOH Diff	\$152,212

Value History

	2024	2023	2022	2021	2020	2019
Total Building	\$237,748	\$220,074	\$192,626	\$164,442	\$152,156	\$141,939
Total Extra Features	\$4,322	\$4,322	\$4,322	\$4,322	\$4,322	\$4,322
Total Market Land	\$23,125	\$23,125	\$18,750	\$13,125	\$13,125	\$13,125
Total Ag Land	\$0	\$0	\$0	\$0	\$0	\$0
Total Market	\$265,195	\$247,521	\$215,698	\$181,889	\$169,603	\$159,386
Total Assessed	\$122,114	\$118,557	\$215,698	\$154,337	\$152,206	\$148,784
Total Exempt	\$50,000	\$50,000	\$0	\$50,000	\$50,000	\$50,000
Total Taxable	\$72,114	\$68,557	\$215,698	\$104,337	\$102,206	\$98,784
SOH Diff	\$143,081	\$128,964	\$0	\$27,552	\$17,397	\$10,602

Document/Transfer/Sales History

Instrument / Official Record	Date	Q/U	Reason	Type	V/I	Sale Price	Ownership
<u>WD</u> 1462/1298	2022-03-04	<u>Q</u>	<u>01</u>	WARRANTY DEED	Improved	\$239,900	Grantor: LOCKLEAR DARREL M Grantee: MCCARTY LARRY
<u>WD</u> 1435/324	2021-04-06	<u>U</u>	<u>11</u>	WARRANTY DEED	Improved	\$100	Grantor: FELTON MARY E FKA MARY E LOCKLEAR Grantee: FELTON MARY E
<u>WD</u> 0981/0668	2003-04-21	<u>Q</u>	<u>06</u>	WARRANTY DEED	Vacant	\$100	Grantor: MARY E FELTON FNA MARY E LOCKLEAR Grantee: JERRY R & MARY E FELTON
<u>WD</u> 0916/1249	2000-12-15	<u>Q</u>		WARRANTY DEED	Vacant	\$19,000	Grantor: AINSLEE A HOOD Grantee: MARY LOCKLEAR

Instrument / Official Record	Date	Q/U	Reason	Type	V/I	Sale Price	Ownership
WD 0723/0411	1990-06-26	U	35	WARRANTY DEED	Vacant	\$70,000	Grantor: DESOTO DEVELOPERS Grantee: A A HOOD
WD 0691/0663	1989-06-29	U	35	WARRANTY DEED	Vacant	\$8,333	Grantor: ZECKER Grantee: DESOTO DEVELOPERS
WD 0591/0013	1986-05-01	Q	01	WARRANTY DEED	Vacant	\$50,000	

Buildings

Building # 1, Section # 1, 150345, SFR

Type	Model	Heated Area	Gross Area	Repl Cost New	YrBlt	Year Eff	Other % Dpr	Normal % Dpr	% Cond	Value
0100	01	1855	2907	\$316,987	2003	2003	0.00%	21.00%	79.00%	\$250,420

Structural Elements

Type	Description	Code	Details
EW	Exterior Wall	19	COMMON BRK
RS	Roof Structure	08	IRREGULAR
RC	Roof Cover	03	COMP SHNGL
IW	Interior Wall	05	DRYWALL
IF	Interior Flooring	14	CARPET
IF	Interior Flooring	08	SHT VINYL
AC	Air Conditioning	03	CENTRAL
HT	Heating Type	04	AIR DUCTED
BDR	Bedrooms	3.00	
BTH	Bathrooms	2.00	
FR	Frame	02	WOOD FRAME
STR	Stories	1.	1.
AR	Architectual Type	05	CONV
COND	Condition Adjustment	03	03
KTCH	Kitchen Adjustment	01	01

Sub Areas

Type	Gross Area	Percent of Base	Adjusted Area
BAS	1,855	100%	1,855

Type	Gross Area	Percent of Base	Adjusted Area
FEP	324	80%	259
FGR	643	55%	354
FOP	85	30%	26

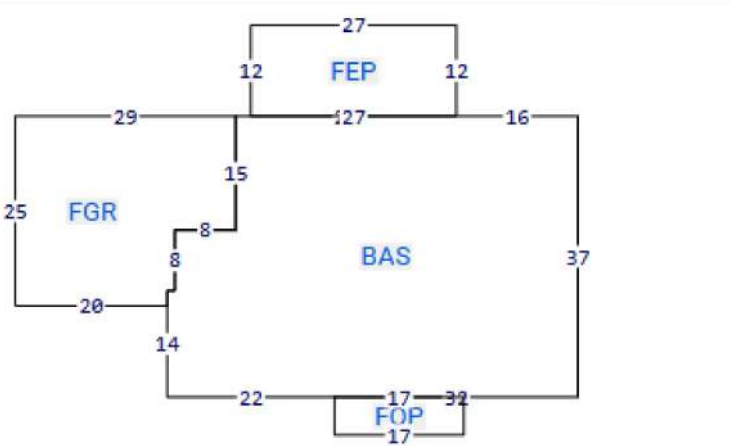

Extra Features

Code	Description	Length	Width	Units	Unit Price	AYB	% Good Condition	Final Value
0190	FPLC PF			1.00	\$1,200.00	2003	100%	\$1,200
0166	CONC,PAVMT			1561.00	\$2.00	2003	100%	\$3,122

Land Lines

Code	Description	Zone	Front	Depth	Units	Rate/Unit	Acreage	Total Adj	Value
0100	SFR	RSF-1	.00	.00	1.00	\$18,500.00/LT	0.65	1.25	\$23,125

Personal Property

None

Permits

Date	Permit	Type	Status	Description
	20195	SFR	COMPLETED	SFR

TRIM Notices

2024
2023
2022

Disclaimer

All parcel data on this page is for use by the Columbia County Assessor for assessment purposes only. The summary data on this page may not be a complete representation of the parcel or of the improvements thereon. Building information, including unit counts and number of

permitted units, should be verified with the appropriate building and planning agencies. Zoning information should be verified with the appropriate planning agency. All parcels are reappraised each year. This is a true and accurate copy of the records of the Columbia County Assessor's Office as of May 19, 2025.