

FOUNDATION PLAN

SCALE: 1/4" = 1'-0"

FOUNDATION NOTES	
FN-1	DIMENSIONS ON FOUNDATION & STRUCTURAL SHEETS ARE NOT EXACT. REFER TO ARCHITECTURAL PLANS FOR ACTUAL DIMENSIONS, RECESSES IN SLAB, STEP DOWNS, ETC. DISOWAY DESIGN GROUP OR MARK DISOWAY, P.E. IS NOT RESPONSIBLE FOR DIMENSION ERRORS ON THIS PLAN.
FN-2	CONTRACTOR SHALL VERIFY NEED FOR INTERIOR BEARING IN ALL AREAS BY REVIEWING THE ROOF TRUSS PLAN (BY THE SUPPLIER) BEFORE FINALIZING FOUNDATION PLAN.
FN-3	THE SLAB SHALL BE 4" CONCRETE SLAB REINFORCED W/ 6X6-1/4" I-4 WELDED WIRE MESH PLACED ON CHAIRS @ 1/2" DEPTH ON FIBER MESH CONCRETE. CMU POLY VAPOR BARRIER W/ 6" LAPS SEALED W/ POLY TAPE OVER TERMITES. TREATED & COMPACTED FILL (ALSO, ANY OTHER CODE-APPROVED TERMITES TREATMENT METHOD CAN BE USED INSTEAD).

TALL STEM WALL TABLE:

The table assumes 40 ksi for #5 rebar and 60 ksi for #7 & #8 rebar with 6" hook in the footing and bent 24" into the reinforced slab at the top. The vertical steel is to be placed toward the tension side of the CMU wall (away from the soil pressure, within 2" of the exterior side of the wall). If the wall is over 8' high, add Duowall ladder reinforcement at 16" OC vertically or a horizontal bond beam with #5 continuous at mid height. For higher parts of the wall 12" CMU may be used with reinforcement as shown in the table below.

STEM WALL HEIGHT (FEET)	UNBALANCED BACKFILL HEIGHT	VERTICAL REINFORCEMENT FOR 8" CMU STEM WALL (INCHES O.C.)			VERTICAL REINFORCEMENT FOR 12" CMU STEM WALL (INCHES O.C.)		
		#5	#7	#8	#5	#7	#8
3.3	3.0	96	96	96	96	96	96
4.0	3.7	96	96	96	96	96	96
4.7	4.3	88	96	96	96	96	96
5.3	5.0	56	96	96	96	96	96
6.0	5.7	40	80	96	80	96	96
6.7	6.3	32	56	80	56	96	96
7.3	7.0	24	40	56	40	80	96
8.0	7.7	16	32	48	32	64	80
8.7	8.3	8	24	32	24	48	64
9.3	9.0	8	16	24	16	40	48

MASONRY NOTE:
MASONRY CONSTRUCTION AND MATERIALS FOR THIS PROJECT SHALL CONFORM TO ALL REQUIREMENTS OF "SPECIFICATION FOR MASONRY STRUCTURES" (ACI 530.1/ASCE 6/TMS 602). THE CONTRACTOR AND MASON MUST IMMEDIATELY, BEFORE PROCEEDING, NOTIFY THE ENGINEER OF ANY CONFLICTS BETWEEN ACI 530.1-62ND THESE DESIGN DRAWINGS. ANY EXCEPTIONS TO # 530.1-62 MUST BE APPROVED BY THE ENGINEER IN WRITING.

ACI 530.1-62 Section	Specific Requirements
1.4A Compressive strength	8" block bearing walls $F_m = 1500$ psi
2.1 Mortar	ASTM C 270, Type N, UNO
2.2 Grout	ASTM C 476, admixtures require approval
2.3 CMU standard	ASTM C 90-02, Normal weight, Hollow, medium surface finish, 8"x8"x16" running bond and 12"x12" or 16"x16" column block
2.3 Clay brick standard	ASTM C 216-02, Grade SW, Type FB5, 8"x8"x16" running bond
2.4 Reinforcing bars, #3 - 1	ASTM A 615, Grade 40, $F_y = 40$ ksi, Lap splices min 40 bar dia. (25" for #5)
2.4F Coating for corrosion protection	Anchors, sheet metal ties completely embedded in mortar or grout, ASTM A 525, Class G60, 0.60 carbon or 304SS
2.4F Coating for corrosion protection	Joint reinforcement in walls exposed to moisture or wire ties, anchors, sheet metal ties not completely embedded in mortar or grout, ASTM A 153, Class B2, 1.50 carbon or 304SS
3.3.E.2 Pipes, conduits, and accessories	Any not shown on the project drawings require engineering approval.
3.3.E.7 Movement joints	Contractor assumes responsibility for type and location of movement joints if not detailed on project drawings.

BOTTOM OF EXTERIOR FOOTINGS SHALL BE A MINIMUM OF 12" BELOW UNDISTURBED SOIL OR ENGINEERED FILL

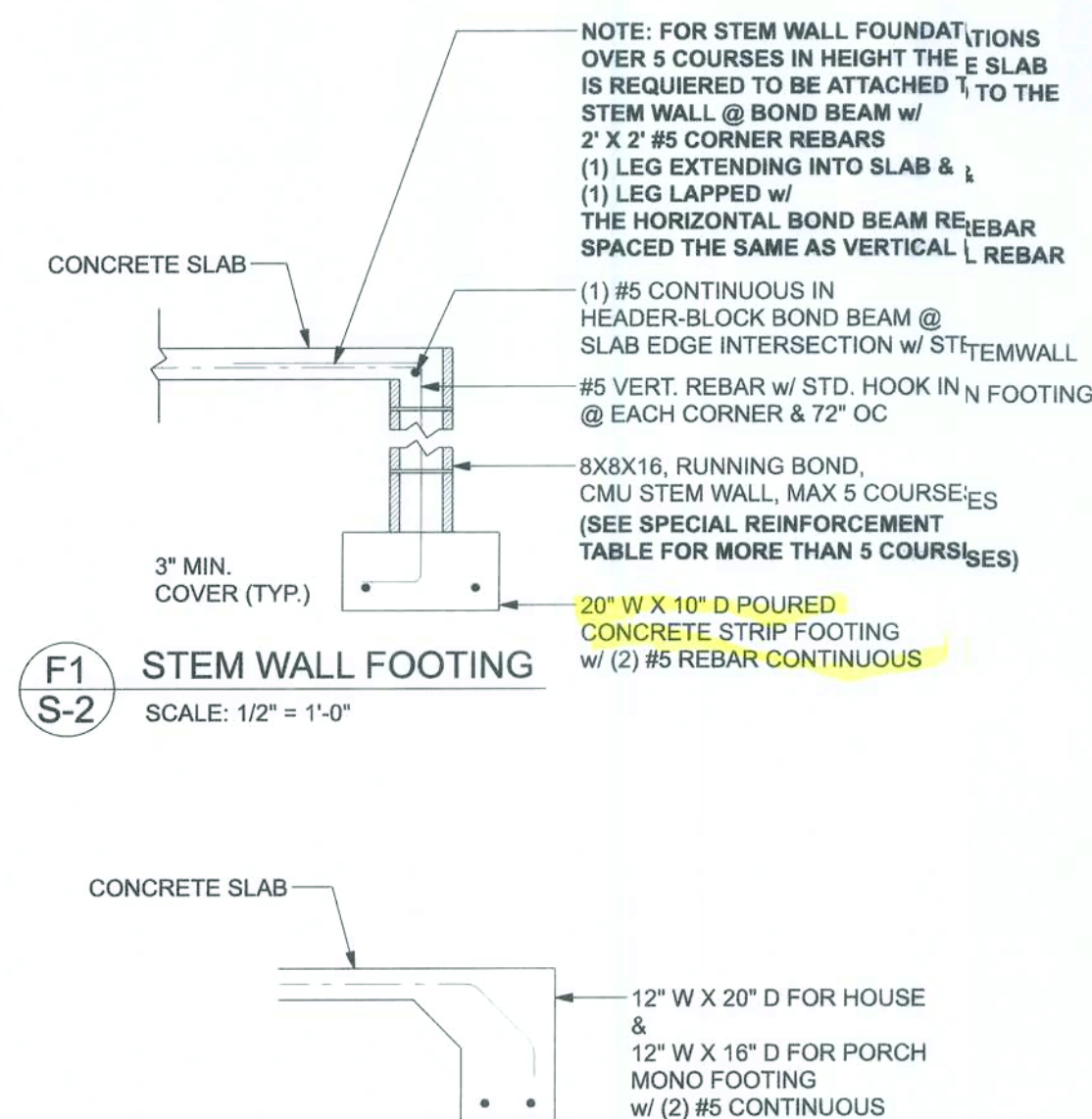

OPTIONAL MONOLITHIC FOOTING

SCALE: 1/2" = 1'-0"

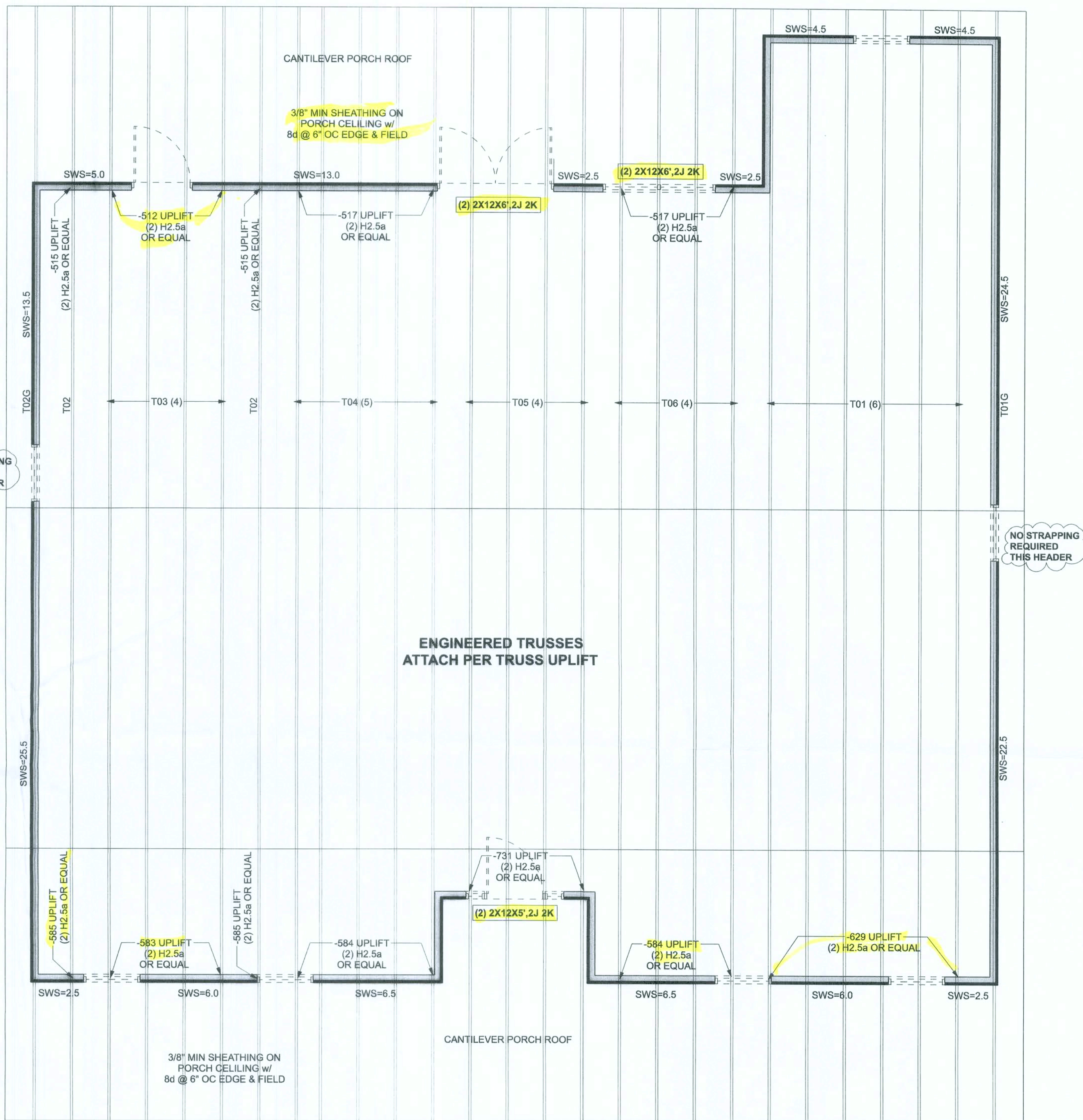

STRUCTURAL PLAN

SCALE: 1/4" = 1'-0"

STRUCTURAL PLAN NOTES

- SN-1 ALL LOAD BEARING FRAME WALL & PORCH HEADERS SHALL BE A MINIMUM OF (2) 2X6 SP #2 (U.N.O.)
- SN-2 ALL LOAD BEARING FRAME WALL HEADERS SHALL HAVE (1) JACK STUD & (1) KING STUD EACH SIDE (U.N.O.)
- SN-3 ALL HEADERS w/ UPLIFT TO BE STRAPPED DOWN @ EACH SIDE WITH (1) LSTA24, 14-10d @ TOP & BOTTOM OF WALL WRAP UNDER BOTTOM PLATE & OVER TOP PLATE 1/2" X 10" ANCHOR BOLT w/ 3" X 3" X 1/4" WASHER MUST BE LOCATED WITHIN 8" OF KING STUD @ ALL DOOR LOCATIONS (U.N.O.)
- SN-4 USE ONE JACK STUD GIRDER SUPPORT PER 2500 LB LOAD
- SN-5 DIMENSIONS ON STRUCTURAL SHEETS ARE NOT EXACT. REFER TO ARCHITECTURAL FLOOR PLAN FOR ACTUAL DIMENSIONS
- SN-6 PERMANENT TRUSS BRACING IS TO BE INSTALLED AT LOCATIONS AS SHOWN ON THE SEALED TRUSS DRAWINGS. LATERAL BRACING IS TO BE RESTRAINED PER BCSI-1-03, BCSI-B1, BCSI-B2, & BCSI-B3. BCSI-B1, BCSI-B2, & BCSI-B3 ARE FURNISHED BY THE TRUSS SUPPLIER, WITH THE SEALED TRUSS PACKAGE

HEADER LEGEND

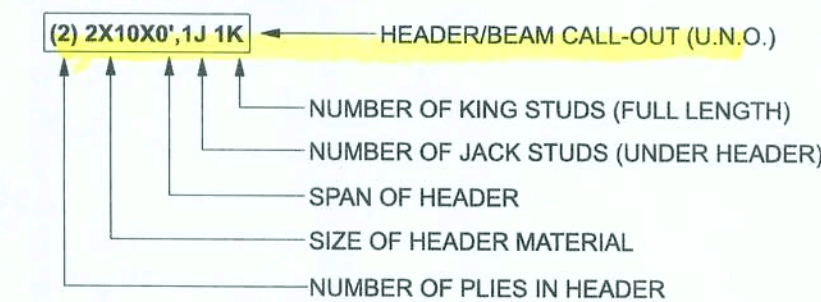

ACTUAL vs REQUIRED SHEARWALL

	TRANSVERSE	LONGITUDINAL
ACTUAL	34056 LBF	24552 LBF
REQUIRED	15457 LBF	15371 LBF

CONNECTIONS, WALL, & HEADER DESIGN IS BASED ON REACTIONS & UPLIFTS FROM TRUSS ENGINEERING FURNISHED BY BUILDER. BUILDERS FIRST SOURCE JOB #2652828

Woodman Park Builders, Inc.

Whitnell Res.

PROJECT ADDRESS:
719 SW Happy Jack Tr.
Lake City, FL 32024

DIMENSIONS: Stated dimensions supersede scaled dimensions. Refer all questions to Mark Disoway, P.E. for resolution. Do not proceed without clarification.

COPYRIGHTS AND PROPERTY RIGHTS: Mark Disoway, P.E. hereby expressly reserves its common law copyrights and property right in these instruments of service. This document is not to be reproduced, altered or copied in any form or manner without the express written permission and consent of Mark Disoway.

CERTIFICATION: I hereby certify that I have examined this plan, and that the applicable portions of the plan, relating to wind engineering comply with the 7th Edition Florida Building Code Residential (2020) to the best of my knowledge.

LIMITATION: This design is valid for one building, at specified location.

MARK DISOWAY P.E. 53915

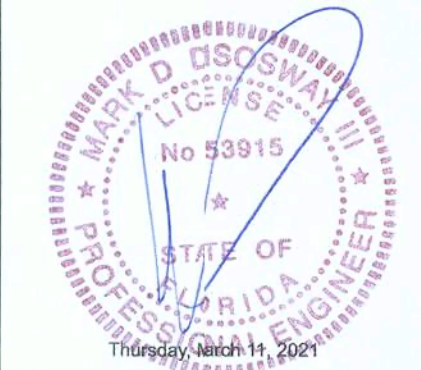

Mark Disoway P.E.
163 SW Midtown Place
Suite 103
Lake City, Florida 32025
386.754.5419
disowaydesign@gmail.com

JOB NUMBER:

210380

S-2

OF 2 SHEETS