

# COLUMBIA COUNTY

## Property Appraiser

Parcel 27-4S-16-03199-309

### Owners

ANDERSON CLARENCE  
ANDERSON MARVYNELL  
540 SW DANTE TERRACE  
LAKE CITY, FL 32024

### Parcel Summary

Location	540 SW DANTE TER
Use Code	0100: SINGLE FAMILY
Tax District	3: COUNTY
Acreage	.5370
Section	27
Township	4S
Range	16
Subdivision	SPRGFIELD
Exemptions	01: HOMESTEAD (196.031a&b) (100%)

### Legal Description

LOT 9 SPRINGFIELD ESTATES PHASE 2.  
  
ORB 735-372,



### Working Values

	2025
Total Building	\$140,806
Total Extra Features	\$2,532
Total Market Land	\$28,000
Total Ag Land	\$0

	2025
Total Market	\$171,338
Total Assessed	\$106,090
Total Exempt	\$50,722
Total Taxable	\$55,368
SOH Diff	\$65,248

## Value History

	2024	2023	2022	2021	2020	2019
Total Building	\$132,010	\$121,807	\$107,036	\$100,898	\$85,191	\$79,768
Total Extra Features	\$2,532	\$2,532	\$2,532	\$2,532	\$2,532	\$2,532
Total Market Land	\$22,000	\$22,000	\$22,000	\$18,000	\$18,000	\$14,122
Total Ag Land	\$0	\$0	\$0	\$0	\$0	\$0
Total Market	\$156,542	\$146,339	\$131,568	\$121,430	\$105,723	\$96,422
Total Assessed	\$103,100	\$100,097	\$97,182	\$94,351	\$93,048	\$90,956
Total Exempt	\$50,000	\$50,000	\$50,000	\$50,000	\$50,000	\$50,000
Total Taxable	\$53,100	\$50,097	\$47,182	\$44,351	\$43,048	\$40,956
SOH Diff	\$53,442	\$46,242	\$34,386	\$27,079	\$12,675	\$5,466

## Document/Transfer/Sales History

Instrument / Official Record	Date	Q/U	Reason	Type	V/I	Sale Price	Ownership
<u>WD</u> 0735/0372	1990-10-26	<u>Q</u>		WARRANTY DEED	Improved	\$59,000	Grantor: CRAWFORD CONSTRUCTIO Grantee: CLARENCE ANDERSON

## Buildings

### Building # 1, Section # 1, 83867, SFR

Type	Model	Heated Area	Gross Area	Repl Cost New	YrBltd	Year Eff	Other % Dpr	Normal % Dpr	% Cond	Value
<u>0100</u>	<u>01</u>	1560	1956	\$216,625	1990	1990	0.00%	35.00%	65.00%	\$140,806

## Structural Elements

Type	Description	Code	Details
EW	Exterior Wall	19	COMMON BRK
EW	Exterior Wall	31	VINYL SID



Type	Description	Code	Details
RS	Roof Structure	08	IRREGULAR
RC	Roof Cover	03	COMP SHNGL
IW	Interior Wall	05	DRYWALL
IF	Interior Flooring	14	CARPET
IF	Interior Flooring	08	SHT VINYL
AC	Air Conditioning	03	CENTRAL
HT	Heating Type	04	AIR DUCTED
BDR	Bedrooms	3.00	
BTH	Bathrooms	2.00	
FR	Frame	01	NONE
STR	Stories	1.	1.
AR	Architectual Type	05	CONV
COND	Condition Adjustment	03	03
KTCH	Kitchen Adjustment	01	01

### Sub Areas

Type	Gross Area	Percent of Base	Adjusted Area
<u>BAS</u>	1,560	100%	1,560
<u>FOP</u>	180	30%	54
<u>FOP</u>	216	30%	65

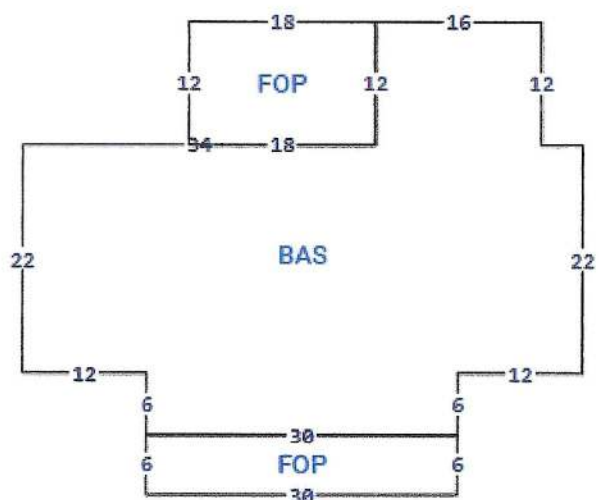

### Extra Features

Code	Description	Length	Width	Units	Unit Price	AYB	% Good Condition	Final Value
0166	CONC,PAVMT	12	74	888.00	\$1.50	0	100%	\$1,332
0190	FPLC PF			1.00	\$1,200.00	0	100%	\$1,200

### Land Lines

Code	Description	Zone	Front	Depth	Units	Rate/Unit	Acreage	Total Adj	Value
0100	SFR	<u>RSF/MH-2</u>	105.00	223.00	1.00	\$28,000.00/LT	0.54	1.00	\$28,000

## Personal Property

None

## Permits

None

## TRIM Notices

2024

2023

2022

## Disclaimer

All parcel data on this page is for use by the Columbia County Assessor for assessment purposes only. The summary data on this page may not be a complete representation of the parcel or of the improvements thereon. Building information, including unit counts and number of permitted units, should be verified with the appropriate building and planning agencies. Zoning information should be verified with the appropriate planning agency. All parcels are reappraised each year. This is a true and accurate copy of the records of the Columbia County Assessor's Office as of June 16, 2025.

Copyright © 2022 Columbia County. All rights reserved.