

COLUMBIA COUNTY

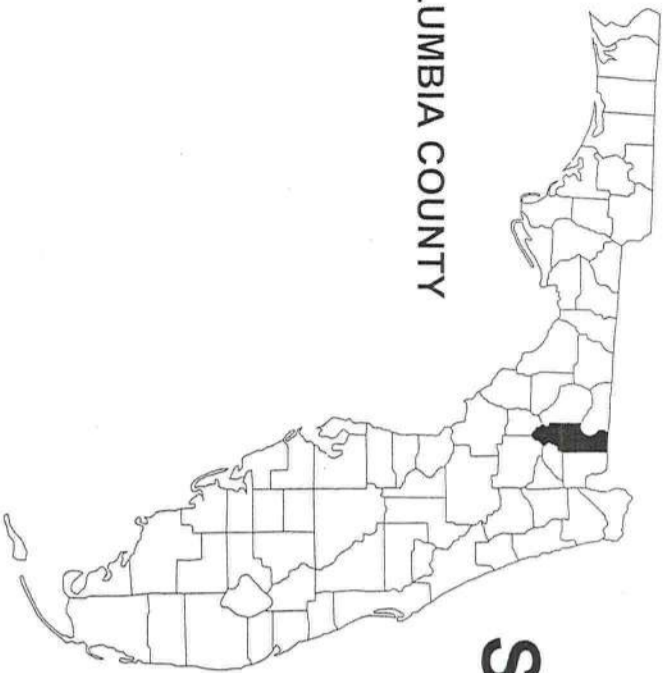

MINI STORAGE SITE EXPANSION 2 COLUMBIA COUNTY, FL SECTION 18, TOWNSHIP 4S, RANGE 17E



PROJECT LOCATION

PLANS PREPARED FOR:

MINI STORAGE & RECORD STORAGE OF LAKE CITY
442 SW SAINT MARGARET ST
LAKE CITY, FL 32025
386-752-7092



THE ABOVE NAMED PROFESSIONAL ENGINEER SHALL BE RESPONSIBLE FOR THE
FOLLOWING SHEETS IN ACCORDANCE WITH RULE 61G15-23.004, F.A.C.

ON THE DATE ADJACENT TO THE SEAL
PRINTED COPIES OF THIS DOCUMENT ARE NOT
CONSIDERED SIGNED AND SEALED. THE
SIGNATURE MUST BE VERIFIED IN THE
ELECTRONIC DOCUMENTS.
NORTH FLORIDA PROFESSIONAL SERVICES, INC.
P.O. BOX 3823
LAKE CITY, FL 32056
CERTIFICATE OF AUTHORIZATION: 29011
GREGORY G. BAILEY, P.E. NO. 43858

THIS DOCUMENT HAS BEEN DIGITALLY SIGNED AND
SEALED BY:

SHEET INDEX

COVER SHEET	1
NOTES	2
EXISTING CONDITIONS	3
OVERALL SITE PLAN	4
SITE PLAN	5
STORMWATER PLAN	6
GRADING PLAN	7
LANDSCAPE PLAN	8
EROSION CONTROL PLAN	9
MISC. DETAILS	10
FIRE DEPARTMENT PLAN	NA

FOR COUNTY SUBMITTAL ONLY
NOT FOR CONSTRUCTION
1/9/20

GENERAL NOTES

1. THE CONTRACTOR SHALL VERIFY ALL EXISTING CONDITIONS AND DIMENSIONS AT THE JOB SITE TO INSURE THAT ALL NEW WORK WILL FIT IN THE MANNER INTENDED ON THE PLANS. SHOULD ANY CONDITIONS EXIST THAT ARE CONTRARY TO THOSE SHOWN ON THE PLANS, THE CONTRACTOR SHALL NOTIFY THE ENGINEER AND THE COLUMBIA COUNTY, FLORIDA (DEPARTMENT OF GROWTH MANAGEMENT) OF SUCH DIFFERENCES IMMEDIATELY AND PRIOR TO PROCEEDING WITH THE WORK.
2. THE CONTRACTOR SHALL COMPLY WITH ALL CONDITIONS AS SET FORTH BY THE ISSUED SUWANNEE RIVER WATER MANAGEMENT DISTRICT ENVIRONMENTAL RESOURCE PERMIT.
3. THE CONTRACTOR SHALL MAINTAIN THE CONSTRUCTION SITE IN A SECURE MANNER, ALL OPEN TRENCHES AND EXCAVATED AREAS SHALL BE PROTECTED FROM ACCESS BY THE GENERAL PUBLIC.
4. BOUNDARY INFORMATION SHOWN, WAS OBTAINED FROM A BOUNDARY SURVEY PREPARED BY BRITT SURVEYING.
5. ANY PUBLIC LAND CORNER WITHIN THE LIMITS OF CONSTRUCTION SHALL BE PROTECTED. IF A CORNER MONUMENT IS IN DANGER OF BEING DESTROYED AND HAS NOT BEEN PROPERLY REFERENCED, THE CONTRACTOR SHOULD NOTIFY THE ENGINEER.
6. THE SITE IS LOCATED IN SECTION 18, TOWNSHIP 4 SOUTH, RANGE 17 EAST, COLUMBIA COUNTY, FLORIDA.
7. THE CONTRACTOR SHALL IMPLEMENT ALL COMPONENTS OF THE EROSION AND SEDIMENTATION CONTROL PLAN PRIOR TO ANY EARTH DISTURBING ACTIVITIES. ALL COMPONENTS SHALL BE MAINTAINED BY THE CONTRACTOR UNTIL ALL VEGETATION IS ESTABLISHED, THE ENTIRE PROJECT AREA IS STABILIZED AND THE OWNER HAS ACCEPTED OPERATION AND MAINTENANCE.
8. ALL DISTURBED AREAS NOT SODDED SHALL BE SEEDED WITH A MIXTURE OF LONG-TERM VEGETATION AND QUICK GROWING SHORT-TERM VEGETATION FOR THE FOLLOWING CONDITIONS. FOR THE MONTHS FROM SEPTEMBER THROUGH MARCH, THE MIX SHALL CONSIST OF 70 POUNDS PER ACRE OF LONG-TERM SEED AND 20 POUNDS PER ACRE OF WINTER RYE. FOR THE MONTHS OF APRIL THROUGH AUGUST, THE MIX SHALL CONSIST OF 70 PER ACRE OF LONG-TERM SEED AND 20 POUNDS PER ACRE OF MILLET.
9. THE LOCATION OF THE UTILITIES SHOWN IN THE PLANS ARE APPROXIMATE ONLY. THE EXACT LOCATION SHALL BE DETERMINED BY THE CONTRACTOR DURING CONSTRUCTION. CONTRACTOR SHALL PROTECT ALL UTILITIES WITHIN THE PROJECT AREAS.
10. ALL SITE CONSTRUCTION SHALL BE IN ACCORDANCE WITH THE COLUMBIA COUNTY LAND DEVELOPMENT REGULATIONS.
11. CONTRACTOR SHALL REVIEW AND BECOME FAMILIAR WITH ALL REQUIRED UTILITY CONNECTIONS PRIOR TO BIDDING. CONTRACTOR SHALL PROVIDE ALL WORK AND MATERIALS REQUIRED TO COMPLETE CONNECTION TO THE EXISTING UTILITIES. THIS INCLUDES BUT IS NOT LIMITED TO MANHOLE CORING, WET TAPS, PAVEMENT REPAIRS AND DIRECTIONAL BORING.
12. CONTRACTOR SHALL COORDINATE ALL WORK WITH OTHER CONTRACTORS WITHIN PROJECT AREA.
13. CONTRACTOR SHALL PROVIDE ACTUAL INVERT ELEVATIONS ON ALL DRAINAGE STRUCTURES, INCLUDING CULVERTS, PRIOR TO PLACING ANY BASE MATERIAL. DEVIATIONS FROM THE PLANS SHALL BE APPROVED BY THE ENGINEER BEFORE CONTINUING WORK.
14. THIS PROJECT IS TO BE CONSTRUCTED IN ACCORDANCE WITH THE F.D.O.T. STANDARD SPECIFICATIONS FOR ROAD AND BRIDGE CONSTRUCTION (CURRENT EDITION) AND THE F.D.O.T. DESIGN STANDARDS (CURRENT EDITION), AWWA SPECIFICATIONS, AND COLUMBIA COUNTY DEVELOPMENT STANDARDS UNLESS OTHERWISE NOTED.
15. IF UNSUITABLE MATERIAL IS ENCOUNTERED DURING GRADING, CONTRACTOR SHALL REMOVE UNSUITABLE MATERIAL TO A DEPTH OF 24" BELOW FINISHED GRADE WITHIN THE CONSTRUCTION LIMITS.
16. THE CONTRACTOR SHALL NOTIFY THE COUNTY AT LEAST 48 HOURS PRIOR TO BEGINNING OF CONSTRUCTION.
17. CONTRACTOR SHALL PROVIDE AN AS-BUILT SURVEY MEETING THE REQUIREMENTS OF CHAPTER 61G17 F.A.C. FOR THE STORMWATER MANAGEMENT SYSTEMS. INCLUDE HORIZONTAL AND VERTICAL DIMENSIONAL DATA SO THAT IMPROVEMENTS ARE LOCATED AND DELINEATED RELATIVE TO THE BOUNDARY. PROVIDE SUFFICIENT DETAILED DATA TO DETERMINE WHETHER THE IMPROVEMENTS WERE CONSTRUCTED IN ACCORDANCE WITH THE PLANS. A COPY OF THE AS-BUILT SURVEY (IN PAPER AND DIGITAL AUTOCAD FORMAT) MUST BE SUBMITTED TO THE ENGINEER.
18. IF DURING CONSTRUCTION OR OPERATION OF THE STORM WATER MANAGEMENT SYSTEM, A STRUCTURAL FAILURE IS OBSERVED THAT HAS THE POTENTIAL TO CAUSE THE DIRECT DISCHARGE OF SURFACE WATER INTO THE FLORIDIAN AQUIFER SYSTEM, CORRECTIVE ACTIONS DESIGNED OR APPROVED BY A REGISTERED PROFESSIONAL SHALL BE TAKEN AS SOON AS PRACTICAL TO CORRECT THE FAILURE. A REPORT PREPARED BY A REGISTERED PROFESSIONAL MUST BE PROVIDED AS SOON AS PRACTICAL TO THE DEPARTMENT FOR REVIEW AND APPROVAL THAT PROVIDES REASONABLE ASSURANCE THAT THE BREACH WILL BE PERMANENTLY CORRECTED.

EROSION CONTROL NOTES

1. THIS EROSION AND SEDIMENTATION CONTROL PLAN COMPLIES WITH THE REQUIREMENTS OF THE "FLORIDA DEVELOPMENT MANUAL" AND THE "FLORIDA EROSION AND SEDIMENT CONTROL INSPECTOR'S MANUAL".
2. THE CONTRACTOR SHALL ADHERE TO COLUMBIA COUNTY, SRWMD, AND OTHER GOVERNING AUTHORITIES FOR EROSION AND SEDIMENT CONTROL REGULATIONS. IF THE CONTRACTOR NEEDS TO CHANGE THIS PLAN TO MORE EFFECTIVELY CONTROL EROSION AND SEDIMENTATION, THE CONTRACTOR SHALL USE BMP'S FROM THE "FLORIDA EROSION AND SEDIMENT CONTROL INSPECTOR'S MANUAL".
3. THE CONTRACTOR SHALL ADJUST AND REVISE THIS PLAN TO MEET ACTUAL FIELD CONDITIONS. ANY REVISIONS SHALL BE APPROVED BY THE REVIEWING AGENCIES.
4. SEDIMENT AND EROSION CONTROL FACILITIES, STORM DRAINAGE FACILITIES AND DETENTION BASINS SHALL BE INSTALLED PRIOR TO ANY OTHER CONSTRUCTION.
5. EROSION CONTROL MEASURES SHALL BE INSPECTED WEEKLY AND AFTER EACH RAINFALL AND REPLACED AS NECESSARY.
6. SEDIMENT AND EROSION CONTROL MEASURES SHALL NOT BE REMOVED UNTIL ALL CONSTRUCTION IS COMPLETE AND UNTIL A PERMANENT GROUND COVER HAS BEEN ESTABLISHED.
7. ALL OPEN DRAINAGE SWALES SHALL BE GRASSED AND RIPRAP SHALL BE PLACED AS REQUIRED TO CONTROL EROSION.
8. SILT FENCES SHALL BE LOCATED ON SITE TO PREVENT SEDIMENT AND EROSION FROM LEAVING PROJECT LIMITS.
9. CONTRACTOR SHALL PLACE A DOUBLE ROW OF SILT FENCE IN AREAS WHERE RUNOFF FROM DISTURBED AREAS MAY ENTER WETLANDS.
10. DURING CONSTRUCTION AND AFTER CONSTRUCTION IS COMPLETE, ALL STRUCTURES SHALL BE CLEANED OF ALL DEBRIS AND EXCESS SEDIMENT.
11. ALL GRADED AREAS SHALL BE STABILIZED IMMEDIATELY WITH A TEMPORARY FAST-GROWING COVER AND/OR MULCH.
12. A PAD OF RUBBLE RIP RAP SHALL BE PLACED AT THE BOTTOM OF ALL COLLECTION FLUMES AND COLLECTION PIPE OUTLETS. GRANITE OR LIMESTONE RIPRAP IS REQUIRED, NO BROKEN CONCRETE WILL BE ACCEPTED.
13. ALL SIDE SLOPES STEEPER THAN 3:1 SHALL BE ADEQUATELY PROTECTED FROM EROSION THROUGH THE USE OF HAY BALES OR SODDING.
14. ALL STABILIZATION PRACTICES SHALL BE INITIATED AS SOON AS PRACTICABLE IN AREAS OF THE JOB WHERE CONSTRUCTION ACTIVITIES HAVE TEMPORARILY OR PERMANENTLY STOPPED, BUT IN NO CASE SHALL THE DISTURBED AREA BE LEFT UNPROTECTED FOR MORE THAN SEVEN DAYS.
15. ALL WASTE GENERATED ON THE PROJECT SHALL BE DISPOSED OF BY THE CONTRACTOR IN AREAS PROVIDED BY CONTRACTOR.
16. LOADED HAUL TRUCKS SHALL BE COVERED WITH TARPS.
17. EXCESS DIRT SHALL BE REMOVED DAILY.
18. THIS PROJECT SHALL COMPLY WITH ALL WATER QUALITY STANDARDS. PERMIT REQUIRED FROM SRWMD HAS BEEN OBTAINED.
19. QUALIFIED PERSONNEL SHALL INSPECT THE AREA USED FOR STORAGE OF STOCKPILES, THE SILT FENCE AND STRAW BALES, THE LOCATION WHERE VEHICLES ENTER OR EXIT THE SITE, AND THE DISTURBED AREAS THAT HAVE NOT BEEN FINALLY STABILIZED, AT LEAST ONCE EVERY SEVEN CALENDAR DAYS AND WITHIN 24 HOURS OF THE END OF A STORM OF 0.5 INCHES OR GREATER.
20. SITES THAT HAVE BEEN FINALLY STABILIZED WITH SOD OR GRASSING SHALL BE INSPECTED AT LEAST ONCE EVERY WEEK.

NOTES

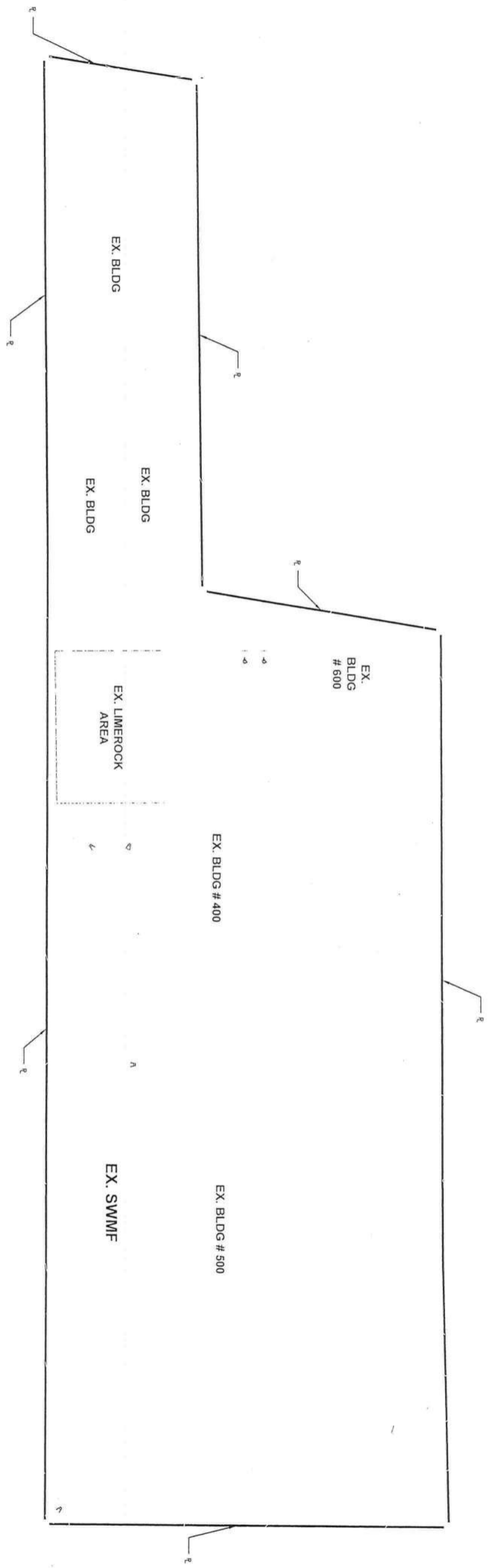

SITE DATA TABLE				
MINI STORAGE SITE EXPANSION				
PARCEL ID NUMBER	18-4S-17-08479-005			
ZONING	COMMERCIAL INTENSIVE			
LAND USE	COMMERCIAL			
CITY COUNCIL DISTRICT NUMBER	5			
PHYSICAL ADDRESS	2529 STATE ROAD 47			
PROJECT PROPERTY BOUNDARY		SQ. FT.	ACRES	% OF SITE
TOTAL PROPERTY BOUNDARY AREA	344560	7.91	100.00%	100.00%
PROJECT AREA / LIMITS OF CONSTRUCTION (LOC)	344560	7.91	100.00%	100.00%
BOTH ON-SITE & OFF-SITE	344560	7.91	100.00%	100.00%
EXISTING IMPERVIOUS AREA ON-SITE				
EXISTING ASPHALT PAVEMENT	81102	1.86	23.54%	23.54%
EXISTING CONCRETE	3356	0.08	0.97%	0.97%
EXISTING BUILDING	45175	1.04	13.11%	13.11%
EXISTING STORMWATER MANAGEMENT FACILITY	65308	1.50	18.95%	18.95%
TOTAL EXISTING IMPERVIOUS AREA ON-SITE	194941	4.48	56.58%	56.58%
PROPOSED IMPERVIOUS AREA ON-SITE				
EXISTING ASPHALT PAVEMENT TO REMAIN	81102	1.86	23.54%	23.54%
EXISTING CONCRETE TO REMAIN	3356	0.08	0.97%	0.97%
EXISTING BUILDING TO REMAIN	45175	1.04	13.11%	13.11%
EXISTING STORMWATER MANAGEMENT FACILITY TO REMAIN	65308	1.50	18.95%	18.95%
PROPOSED ASPHALT PAVEMENT	42315	0.98	12.34%	12.34%
PROPOSED CONCRETE	240	0.01	0.07%	0.07%
PROPOSED BUILDING	50400	1.16	14.63%	14.63%
PROPOSED STORMWATER MANAGEMENT FACILITY	0	0.00	0.00%	0.00%
TOTAL PROPOSED IMPERVIOUS AREA ON-SITE	286095	6.61	83.61%	83.61%
REQUIRED PARKING LANDSCAPE AREA ON-SITE	56484	1.30	16.39%	16.39%
PROPOSED PARKING LANDSCAPE AREA ON-SITE	4252	0.10	1.23%	1.23%
REQUIRED PARKING	9000	0.21	2.61%	2.61%
PROVIDED PARKING				
	34 SPACES + 0 H.C. SPACES			
	34 SPACES + 0 H.C. SPACES			

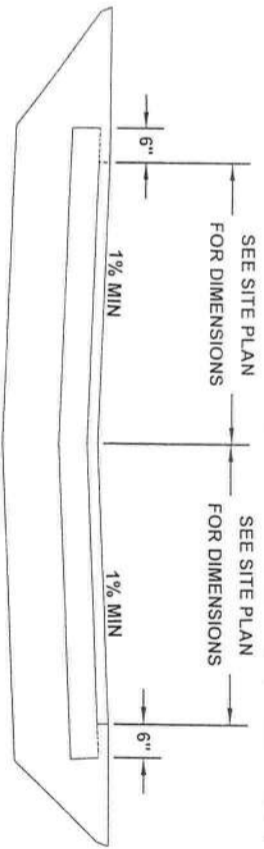

PARKING APRON TYPICAL SECTION
2" TYPE SP 9.5 ASPHALTIC CONCRETE
6" LIMEROCK BASE COURSE
12" COMPACTED SUBGRADE
MINIMUM L.B.R. 40

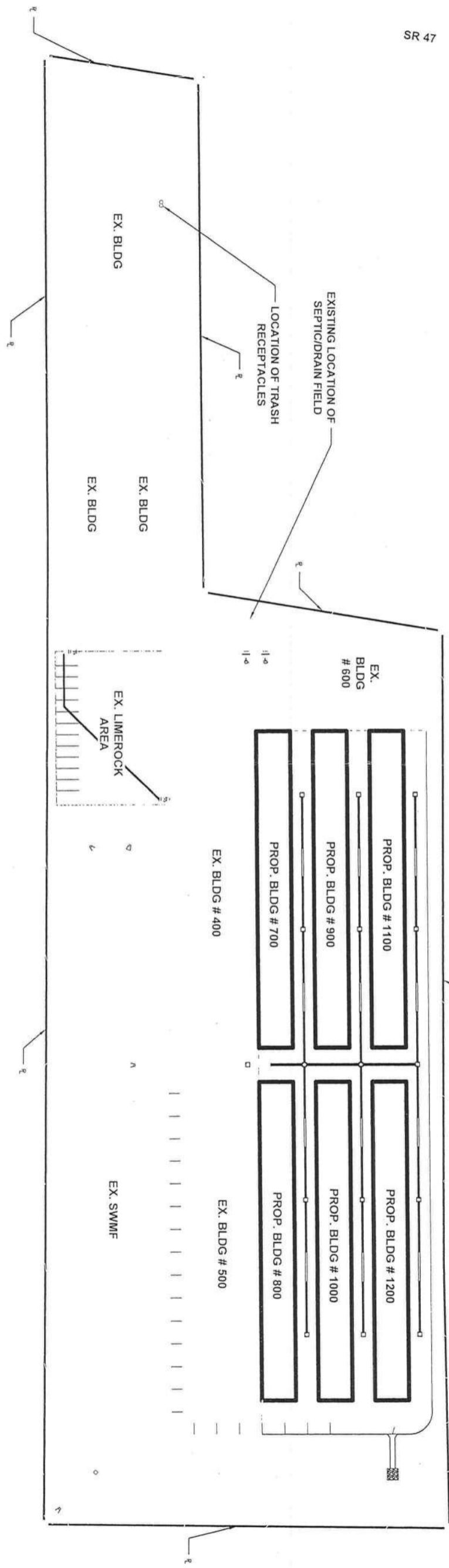
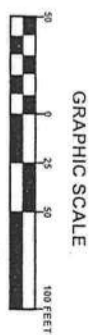

OVERALL SITE PLAN

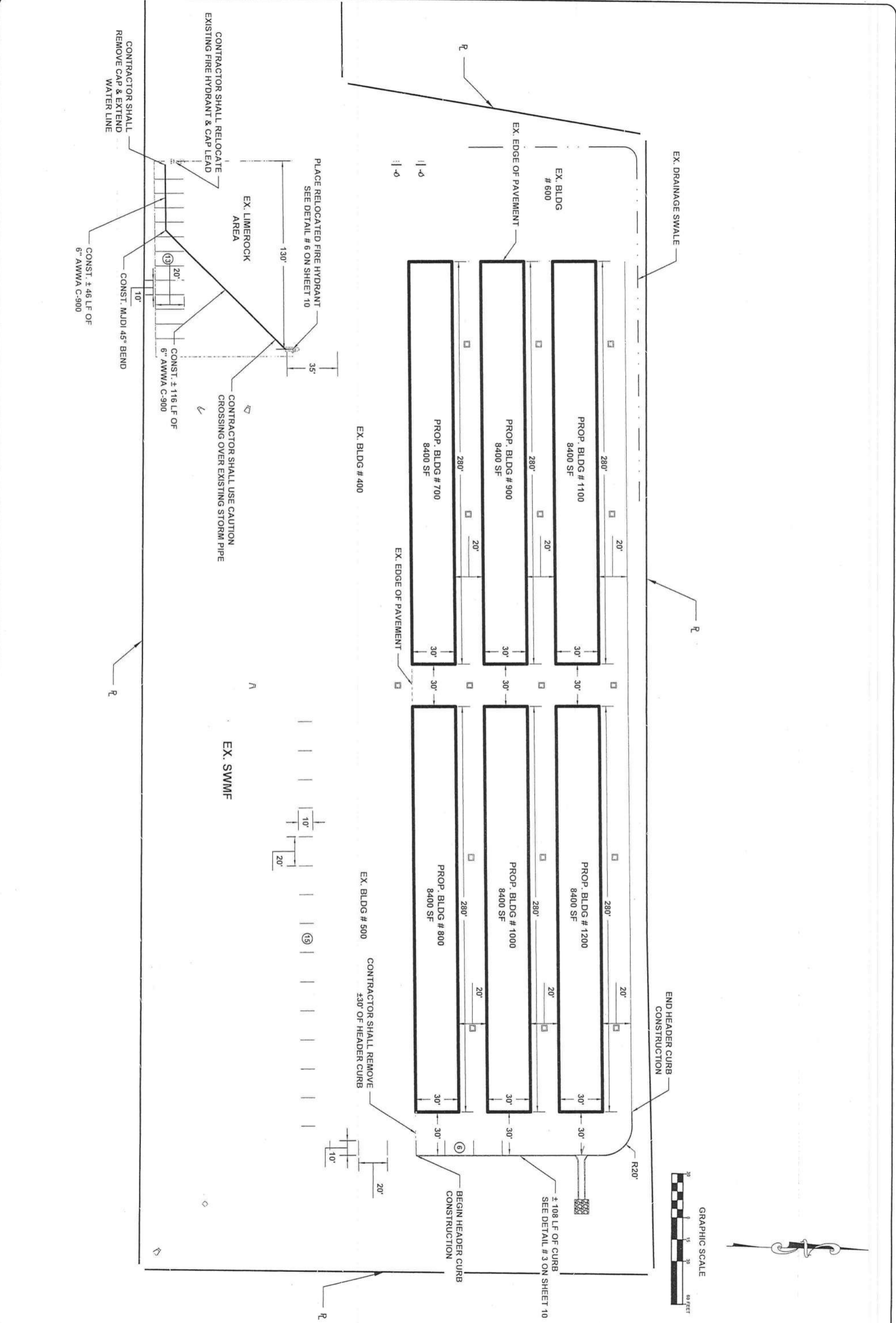

NOTE:



* CONTRACTOR SHALL VERIFY EXISTING PAVEMENT ELEVATION ALONG BUILDING PERIMETER. ACTUAL FFE SHALL BE ADJUSTED TO PROVIDE 0.06' - 0.10' LIP.

TC = TOP OF CURB
EP = EDGE OF PAVEMENT
→ = FLOW ARROW

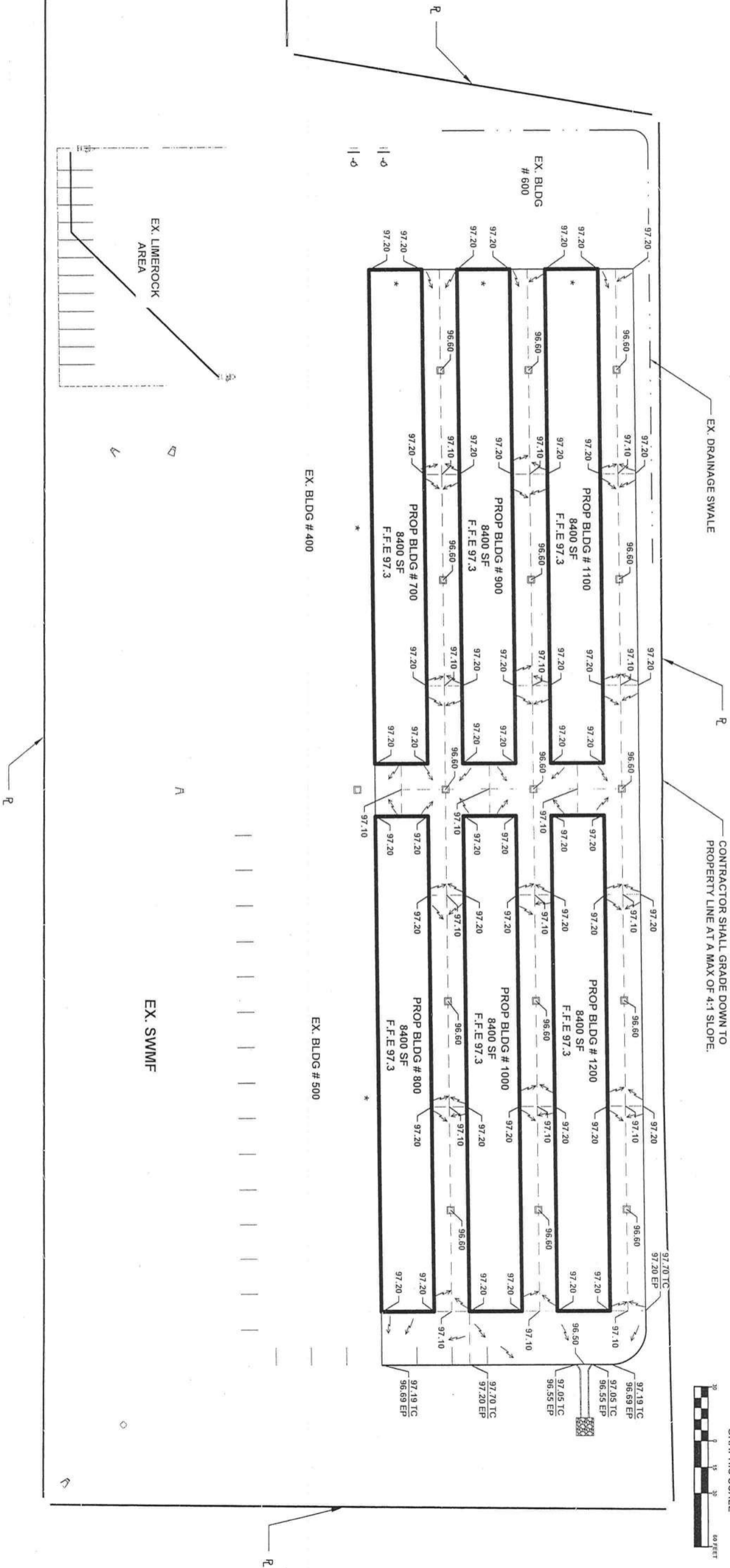

GRADING PLAN

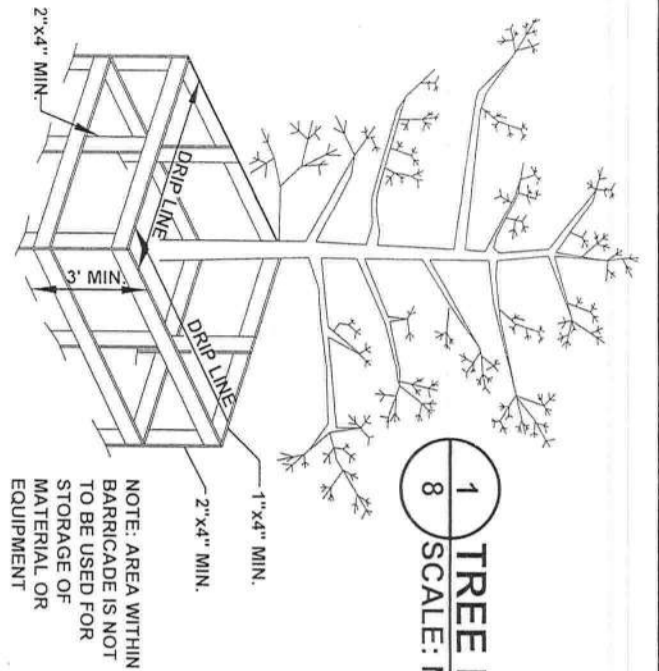

1 TREE BARRICADE DETAIL
8 SCALE: N.T.S.

TREE AND SHRUBBERY REQUIREMENTS				
MAP SYMBOL	COMMON NAME	SCIENTIFIC NAME	NO.	NOTES
	SODGRASS	--	--	
	CREPE MYRTLE	LAGERSTROEMIA	5	
	SWEET VIBURNUM	VIBURNUM ODORATISSIMUM	141	

LANDSCAPE REQUIREMENTS
REQUIRED OFF STREET LANDSCAPE AREA = 4,252 SF
PROPOSED OFF STREET LANDSCAPE AREA = 9,000 SF
REQUIRED # OF 4" TREES = 1/200 SF REQUIRED
LANDSCAPED AREA 4,252 SF / 200 = 21 TREES
TREES PROVIDED = 146

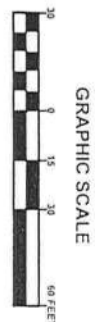

CONTRACTOR SHALL CONSTRUCT ± 700 LF OF PRIVACY FENCE IN ACCORDANCE WITH SECTION 4.2.13.2 OF THE COLUMBIA COUNTY LAND DEVELOPMENT REGULATIONS.

EX. BLDG # 600

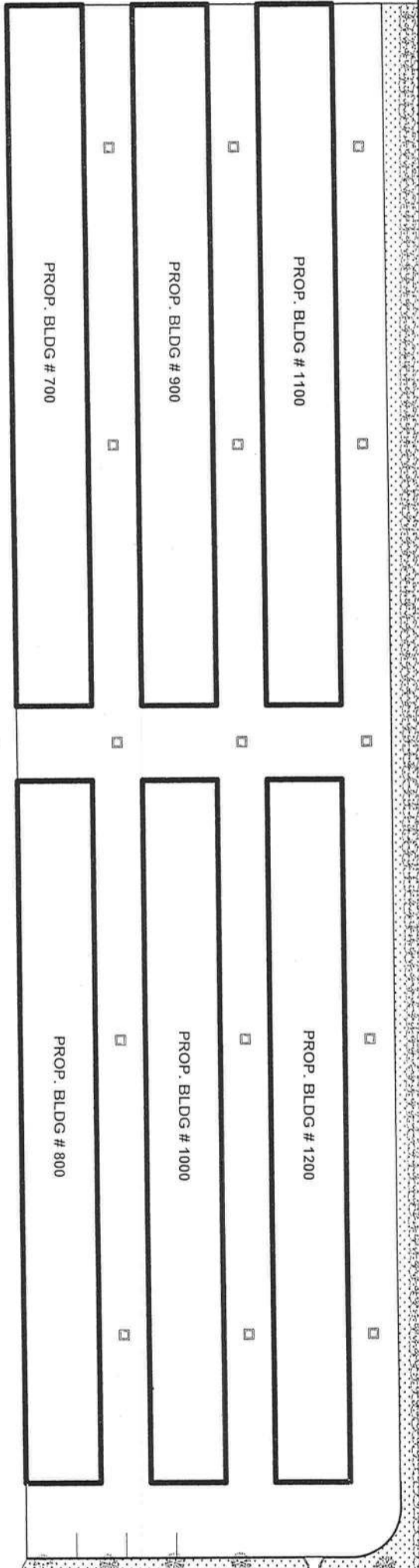

EX. LIMEROCK AREA

EX. SWMP

LANDSCAPE PLAN

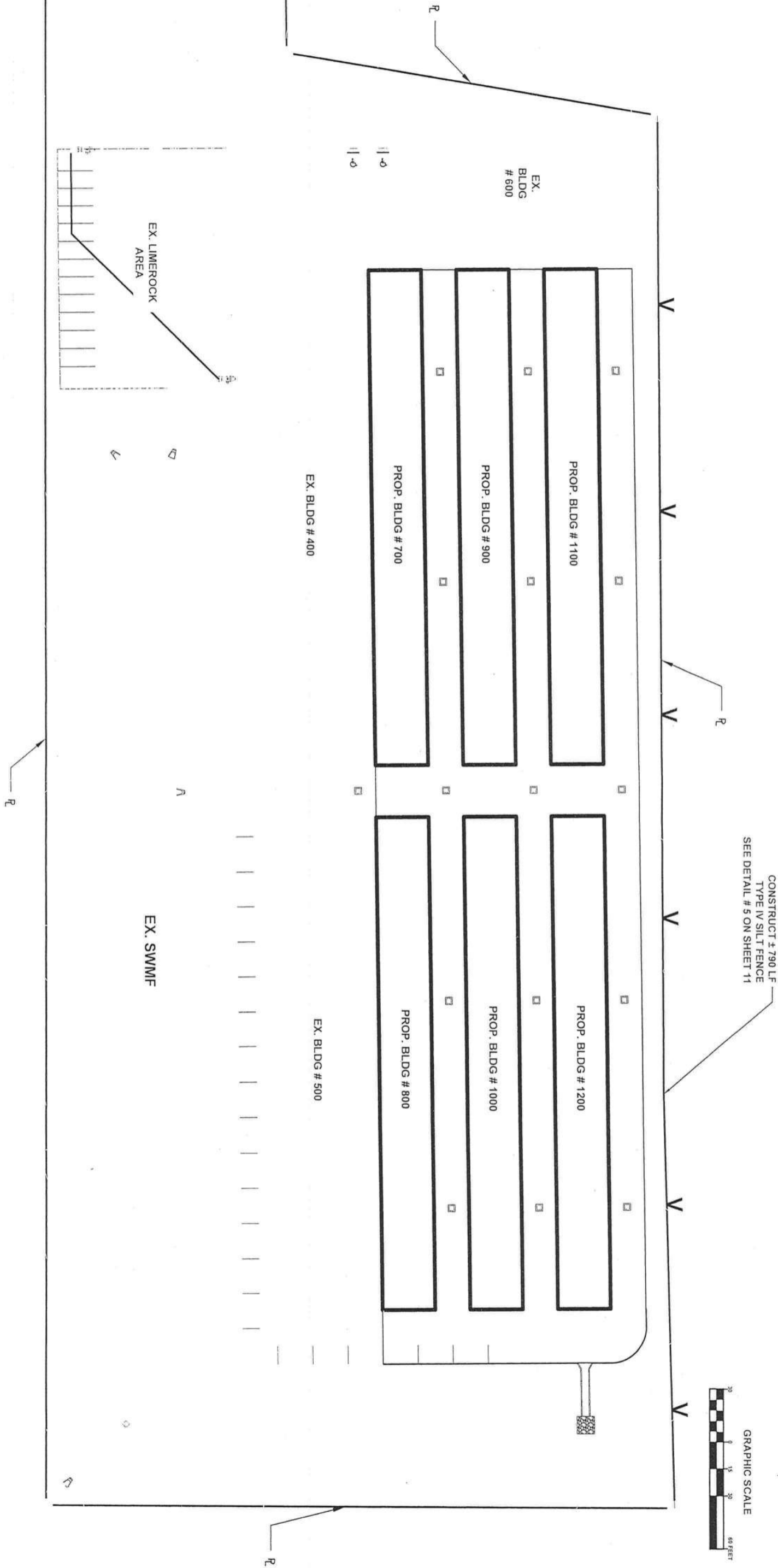

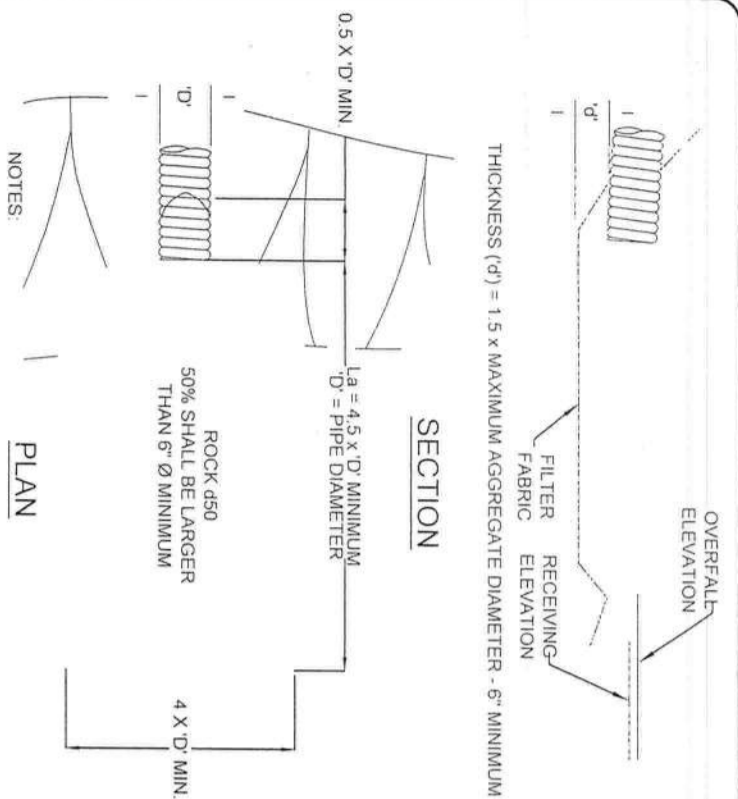

1 ENERGY DISSIPATER DETAIL

10 SCALE: N.T.S.

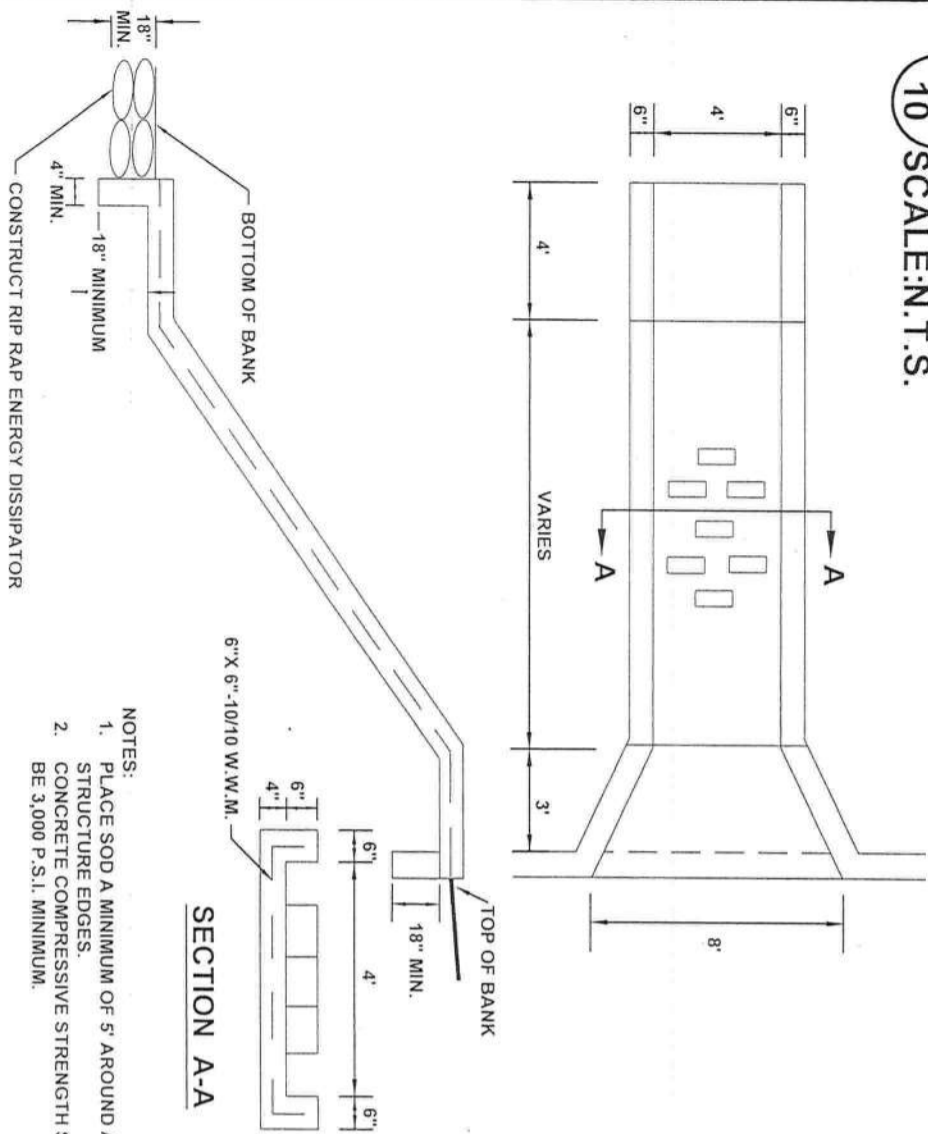

2 HEADER CURB DETAIL

10 SCALE: N.T.S.

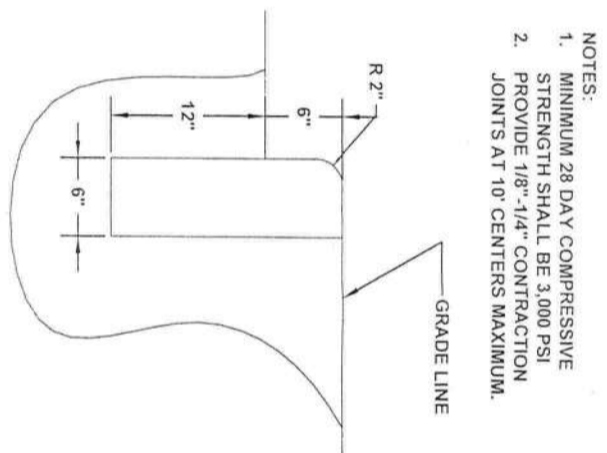

3 TRENCH AND BACKFILL DETAILS

10 SCALE: N.T.S.

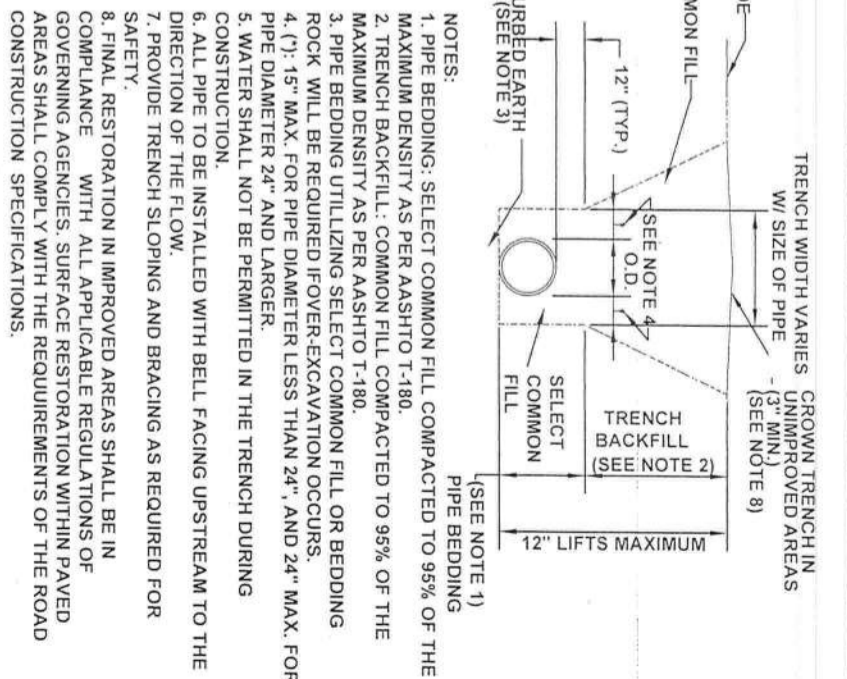

MISC. DETAILS

North Florida Professional Services, Inc.

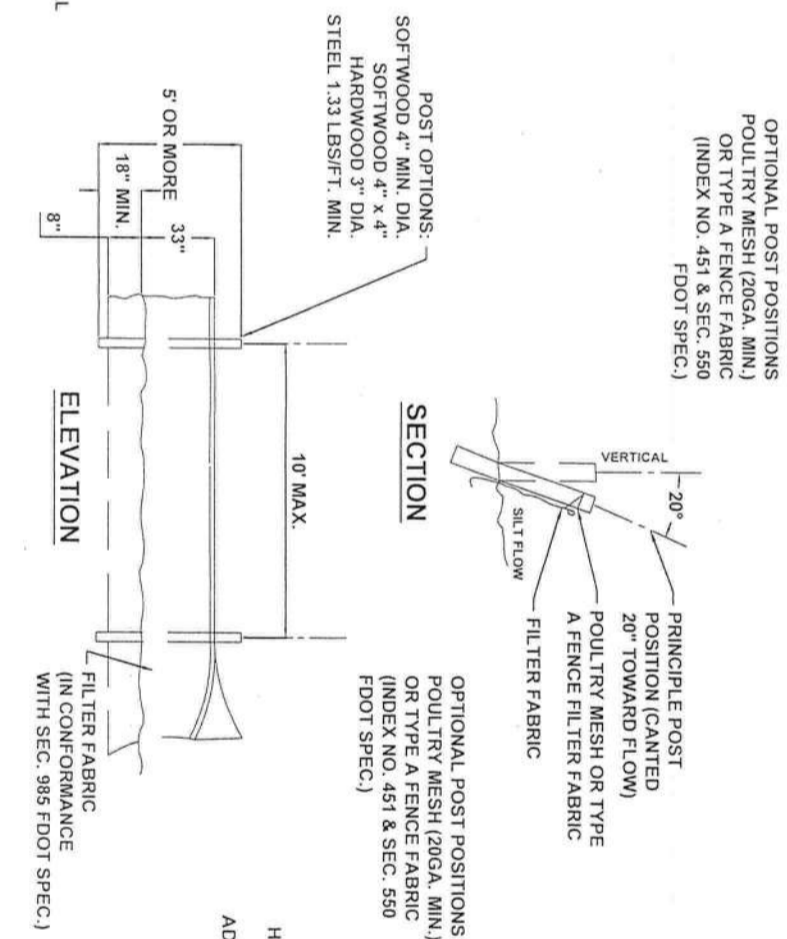

4 CONCRETE SPILLWAY DETAIL

10 SCALE: N.T.S.

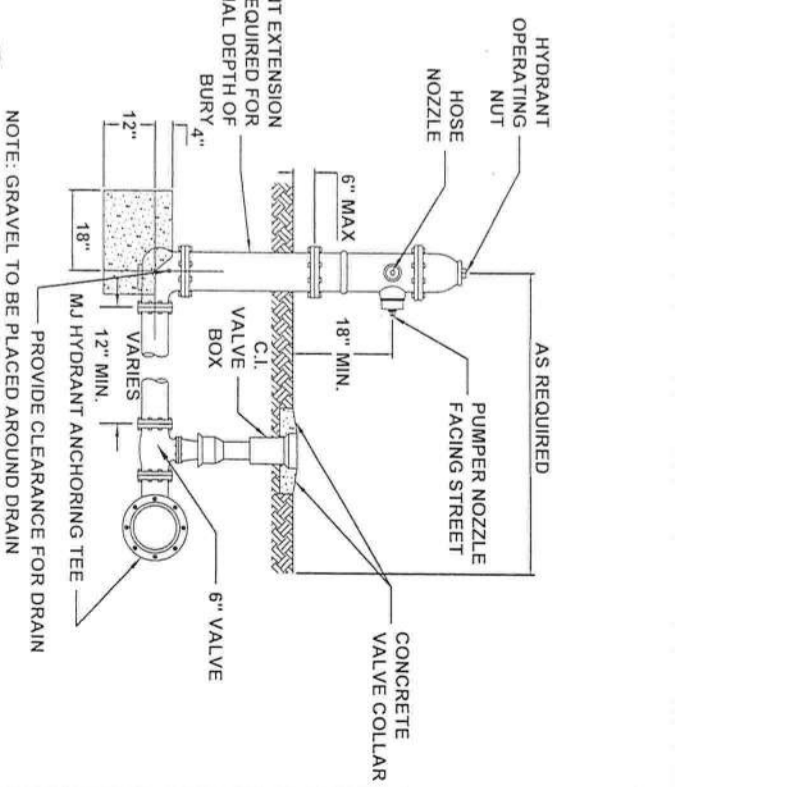

MISC. DETAILS

North Florida Professional Services, Inc.



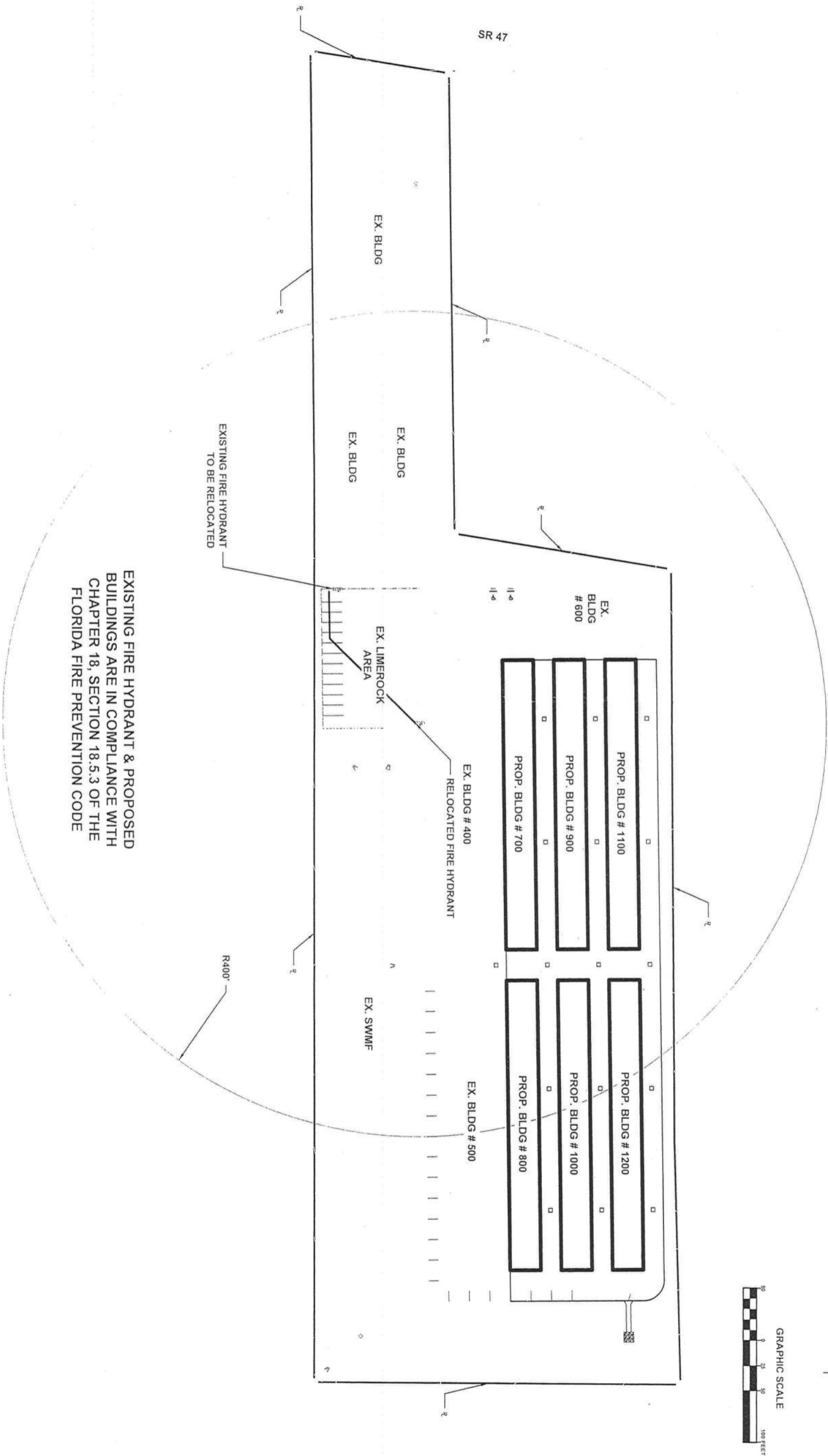

EXISTING FIRE HYDRANT & PROPOSED BUILDINGS ARE IN COMPLIANCE WITH CHAPTER 18, SECTION 18.5.3 OF THE FLORIDA FIRE PREVENTION CODE

COLUMBIA
COUNTY

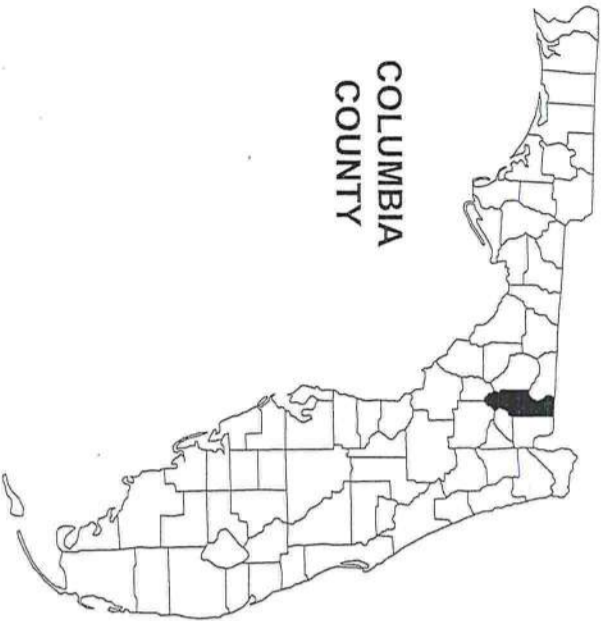

CONSTRUCTION DOCUMENTS FOR: LAKE CITY MINI-STORAGE COLUMBIA COUNTY, FLORIDA SECTION 18, TOWNSHIP 4S, RANGE 17E

Sheet List Table	
SHEET TITLE	SHEET NUMBER
COVER	01
GENERAL NOTES	02
3 ELECT. - FIREWALL PLAN BLDG. 1100 & 1200	03

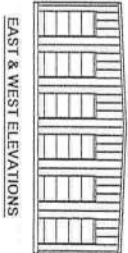
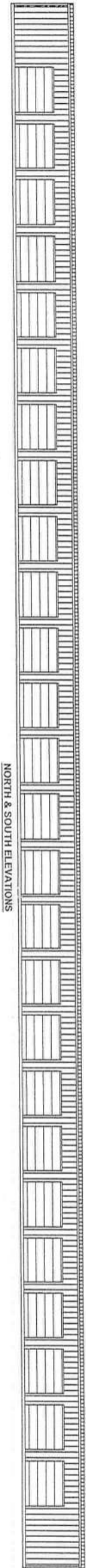

BUILDING NOS. 1100 & 1200 ELEVATIONS

PLANS PREPARED FOR:

MINI-STORAGE AND RECORD
STORAGE OF LAKE CITY
442 SW SAINT MARGARET ST
LAKE CITY, FL 32025
(386) 752-7092



REVISIONS
DESCRIPTION



NORTH FLORIDA PROFESSIONAL SERVICES, INC.
P.O. BOX 3823
LAKE CITY, FL 32056
PH: 386-752-4675
LIC NO. LB8356

2551 BLAIRSTONE PINES DR.
TALLAHASSEE, FL 32301
WWW.NFPS.NET
CAF# 29011

JOB NUMBER:
L180115-1BP
EOR:
ROBERT PHILLIP
BISHOP, JR.
P.E. NO.:
38546

COVER
LAKE CITY MINI-STORAGE
COLUMBIA COUNTY, FLORIDA

SHEET
NO.
01

GENERAL CONSTRUCTION NOTES

GENERAL NOTES

1. CONTRACTOR SHALL VERIFY ALL DIMENSIONS AND DETAILS SHOWN, NOTIFY THE ENGINEER OF ANY CHANGES OR MODIFICATIONS TO THE PLANS.
2. ALL CONSTRUCTION, EQUIPMENT AND FINISHES SHALL MEET OR EXCEED ALL LOCAL CODES, FLORIDA BUILDING CODE, NFPA 101 LIFE SAFETY CODE AND ALL OTHER GOVERNING CODES AND REVISIONS.
3. DO NOT USE ANY MATERIALS CONTAINING ASBESTOS.
4. THE CONTRACTOR SHALL VERIFY ALL DIMENSIONS AND DETAILS SHOWN AND NOTIFY THE ENGINEER OF ANY CHANGES OR MODIFICATIONS.
5. THE CONTRACTOR SHALL VERIFY ALL EXISTING CONDITIONS AND DIMENSIONS AT THE JOB SITE TO INSURE THAT ALL NEW WORK WILL FIT IN THE MANNER INTENDED AND ON THE PLANS. SHOULD ANY CONDITIONS EXIST THAT ARE CONTRARY TO THOSE SHOWN ON THE PLANS, THE CONTRACTOR SHALL NOTIFY THE ENGINEER OF SUCH DIFFERENCES IMMEDIATELY AND PRIOR TO PROCEEDING WITH THE WORK.
6. ANY WOOD OR TIMBER THAT COMES IN CONTACT WITH CONCRETE OR MASONRY SHALL BE PRESSURE TREATED.
7. SEE STRUCTURAL DRAWINGS FOR ALL SIZES, SHAPES AND CONDITIONS OF ALL STRUCTURAL MEMBERS, CONNECTIONS FOOTINGS, BRACING, AND REINFORCING
8. ALL INTERIOR FINISHES SHALL MEET THE REQUIREMENTS OF THE FLORIDA BUILDING CODE AND LIFE SAFETY CODE, NFPA 101 SECTION 7.14.
9. ALL FLOOR FINISHES SHALL BE LEVEL AND SHALL AVOID ANY CHANGES IN ELEVATION GREATER THAN 1/2" INCLUDING DOOR THRESHOLDS AND STEP DOWNS AT EXTERIOR AND INTERIOR DOORS.
10. FOUNDATION WATER-PROOFING AND MOISTURE BARRIER TO CONSIST OF 6-MIL PLASTIC POLYETHYLENE. ALL LAPS SHALL BE A MINIMUM OF 12".
11. FINAL LOCATION, SIZE AND PLACEMENT OF ALL PLUMBING, ELECTRICAL AND MECHANICAL COMPONENTS SHALL BE DETERMINED BY A LICENSED ELECTRICAL OR MECHANICAL CONTRACTOR IN ACCORDANCE WITH CHAPTER 471 FLORIDA STATUTES.

STRUCTURAL NOTES

- STRUCTURAL DESIGN CRITERIA
1. ALL WORK HAS BEEN DESIGNED FOR THE FOLLOWING LOADS AND SPECIFICATIONS APPLIED IN ACCORDANCE WITH THE LATEST EDITIONS OF THE FLORIDA BUILDING CODE AND ACI 318.
 2. DESIGN LOADS:
2.1 WIND LOAD = 120 MPH



REVISIONS	
DATE	DESCRIPTION
	<div><div><div><div><div><div></div></div></div><div><div></div></div></div><div><div></div></div></div><div><div></div></div></div> <div><div></div></div> <div><div></div></div> <div><div></div></div> <div><div></div></div> <div><div></div></div> <div><div></div></div> <div><div></div></div> <div><div></div></div> <div><div></div></div> <div><div></div></div> <div><div></div></div> <div><div></div></div> <div><div></div></div> <div><div></div></div> <div><div></div></div> <div><div></div></div> <div><div></div></div> <div><div></div></div> <div><div></div></div> <div><div></div></div> <div><div></div></div> <div><div></div></div> <div><div></div></div> <div><div></div></div> <div><div></div></div> <div><div></div></div> <div><div></div></div> <div><div></div></div> <div><div></div></div> <div><div></div></div> <div><div></div></div> <div><div></div></div> <div><div></div></div> <div><div></div></div> <div><div></div></div> <div><div></div></div> <div><div></div></div> <div><div></div></div> <div><div></div></div> <div><div></div></div> <div><div></div></div> <div><div></div></div> <div><div></div></div> <div><div></div></div> <div><div></div></div> <div><div></div></div> <div><div></div></div> <div><div></div></div> <div><div></div></div> <div><div></div></div> <div><div></div></div> <div><div></div></div> <div><div></div></div> <div><div></div></div> <div><div></div></div> <div><div></div></div> <div><div></div></div> <div><div></div></div> <div><div></div></div> <div><div></div></div> <div><div></div></div> <div><div></div></div> <div><div></div></div> <div><div></div></div> <div><div></div></div> <div><div></div></div> <div><div></div></div> <div><div></div></div> <div><div></div></div> <div><div></div></div> <div><div></div></div> <div><div></div></div> <div><div></div></div> <div><div></div></div> <div><div></div></div> <div><div></div></div> <div><div></div></div> <div><div></div></div> <div><div></div></div> <div><div></div></div> <div><div></div></div> <div><div></div></div> <div><div></div></div> <div><div></div></div> <div><div></div></div> <div><div></div></div> <div><div></div></div> <div><div></div></div> <div><div></div></div> <div><div></div></div> <div><div></div></div> <div><div></div></div> <div><div></div></div> <div><div></div></div> <div><div></div></div> <div><div></div></div> <div><div></div></div> <div><div></div></div> <div><div></div></div> <div><div></div></div> <div><div></div></div> <div><div></div></div> <div><div></div></div> <div><div></div></div> <div><div></div></div> <div><div></div></div> <div><div></div></div> <div><div></div></div> <div><div></div></div> <div><div></div></div> <div><div></div></div> <div><div></div></div> <div><div></div></div> <div><div></div></div> <div><div></div></div> <div><div></div></div> <div><div></div></div> <div><div></div></div> <div><div></div></div> <div><div></div></div> <div><div></div></div> <div><div></div></div> <div><div></div></div> <div><div></div></div> <div><div></div></div> <div><div></div></div> <div><div></div></div> <div><div></div></div> <div><div></div></div> <div><div></div></div> <div><div></div></div> <div><div></div></div> <div><div></div></div> <div><div></div></div> <div><div></div></div> <div><div></div></div> <div><div></div></div> <div><div></div></div> <div><div></div></div> <div><div></div></div> <div><div></div></div> <div><div></div></div> <div><div></div></div> <div><div></div></div> <div><div></div></div> <div><div></div></div> <div><div></div></div> <div><div></div></div> <div><div></div></div> <div><div></div></div> <div><div></div></div> <div><div></div></div> <div><div></div></div> <div><div></div></div> <div><div></div></div> <div><div></div></div> <div><div></div></div> <div><div></div></div> <div><div></div></div> <div><div></div></div> <div><div></div></div> <div><div></div></div> <div><div></div></div> <div><div></div></div> <div><div></div></div> <div><div></div></div> <div><div></div></div> <div><div></div></div> <div><div></div></div> <div><div></div></div> <div><div></div></div> <div><div></div></div> <div><div></div></div> <div><div></div></div> <div><div></div></div> <div><div></div></div> <div><div></div></div> <div><div></div></div> <div><div></div></div> <div><div></div></div> <div><div></div></div> <div><div></div></div> <div><div></div></div> <div><div></div></div> <div><div></div></div> <div><div></div></div> <div><div></div></div> <div><div></div></div> <div><div></div></div> <div><div></div></div> <div><div></div></div> <div><div></div></div> <div><div></div></div> <div><div></div></div> <div><div></div></div> <div><div></div></div> <div><div></div></div> <div><div></div></div> <div><div></div></div> <div><div></div></div> <div><div></div></div> <div><div></div></div> <div><div></div></div> <div><div></div></div> <div><div></div></div> <div><div></div></div> <div><div></div></div> <div><div></div></div> <div><div></div></div> <div><div></div></div> <div><div></div></div> <div><div></div></div> <div><div></div></div> <div><div></div></div> <div><div></div></div> <div><div></div></div> <div><div></div></div> <div><div></div></div> <div><div></div></div> <div><div></div></div> <div><div></div></div> <div><div></div></div> <div><div></div></div> <div><div></div></div> <div><div></div></div> <div><div></div></div> <div><div></div></div> <div><div></div></div> <div><div></div></div> <div><div></div></div> <div><div></div></div> <div><div></div></div> <div><div></div></div> <div><div></div></div> <div><div></div></div> <div><div></div></div> <div><div></div></div> <div><div></div></div> <div><div></div></div> <div><div></div></div> <div><div></div></div> <div><div></div></div> <div><div></div></div> <div><div></div></div> <div><div></div></div> <div><div></div></div> <div><div></div></div> <div><div></div></div> <div><div></div></div> <div><div></div></div> <div><div></div></div> <div><div></div></div> <div><div></div></div> <div><div></div></div> <div><div></div></div> <div><div></div></div> <div><div></div></div> <div><div></div></div> <div><div></div></div> <div><div></div></div> <div><div></div></div> <div><div></div></div> <div><div></div></div> <div><div></div></div> <div><div></div></div> <div><div></div></div> <div><div></div></div> <div><div></div></div> <div><div></div></div> <div><div></div></div> <div><div></div></div> <div><div></div></div> <div><div></div></div> <div><div></div></div> <div><div></div></div> <div><div></div></div> <div><div></div></div> <div><div></div></div> <div><div></div></div> <div><div></div></div> <div><div></div></div> <div><div></div></div> <div><div></div></div> <div><div></div></div> <div><div></div></div> <div><div></div></div> <div><div></div></div> <div><div></div></div> <div><div></div></div> <div><div></div></div> <div><div></div></div> <div><div></div></div> <div><div></div></div> <div></div>

NORTH FLORIDA PROFESSIONAL SERVICES, INC.

P.O. BOX 3823
LAKE CITY, FL 32056
PH. 386-752-4675
LIC NO. LTB3356

2551 BLAIRSTONE PINES DR.
TALLAHASSEE, FL 32301
WWW.NFPS.NET
CA# 23011

JOB NUMBER:
L180115-1BP

EOR:
ROBERT PHILIP
BISHOP, JR
P.E. NO.:
38546

GENERAL NOTES

LAKE CITY MINI-STORAGE

COLUMBIA COUNTY, FLORIDA

SHEET
NO.

02

CODE DATA:
FLORIDA BUILDING CODE 2017 6TH EDITION
DESIGN WIND SPEED: 120 MPH
RISK CATEGORY: II
EXPOSURE: B

NOTE: SEE SITE PLAN FOR BUILDING
LOCATION & ORIENTATION

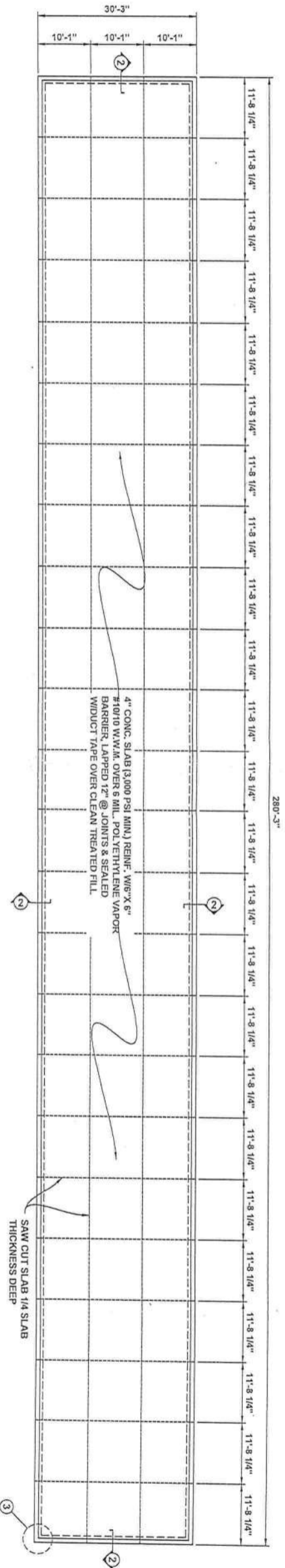

FOUNDATION PLAN BUILDING NOS. 1100 & 1200
SCALE: NTS

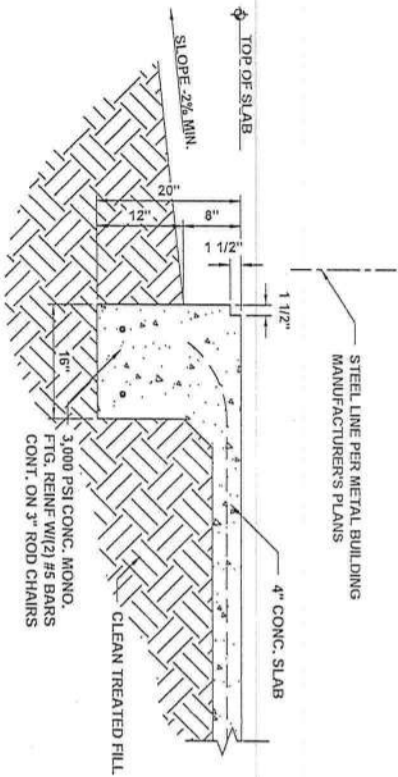

1 FOOTING SECTION
SCALE: 1/2" = 1'-0"

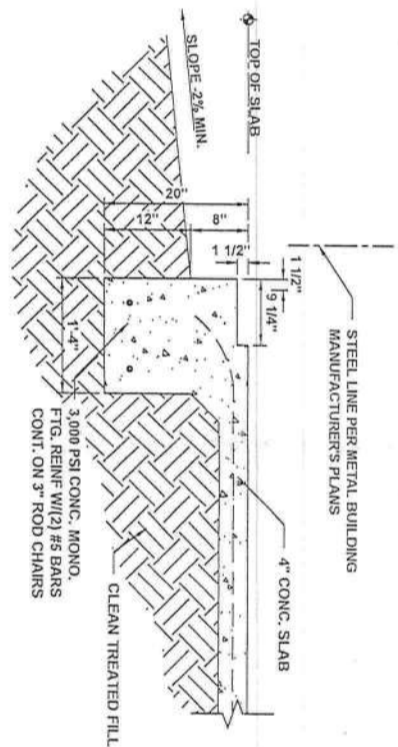

2 FOOTING SECTION
SCALE: 1/2" = 1'-0"

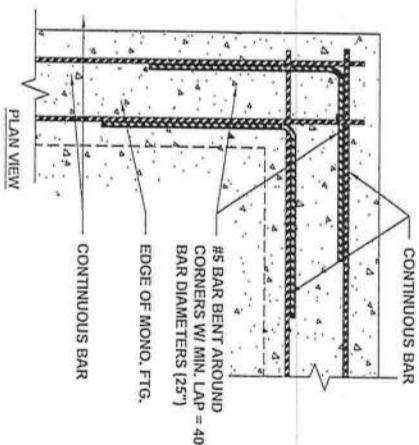

3 REBAR CORNER LAP DETAIL (TYP.)
SCALE: 1/2" = 1'-0"



REVISIONS		DATE	DESCRIPTION
NO.	DESCRIPTION		
04	FOUNDATION		

FOUNDATION PLAN
LAKE CITY MINI-STORAGE
COLUMBIA COUNTY, FLORIDA

JOBS:
L180115-1BP
FOR: ROBERT PHILIP BISHOP, JR.
P.E. NO.: 38545

CONTACT:
NORTH FLORIDA PROFESSIONAL SERVICES, INC.
P.O. BOX 3823
LAKE CITY, FL 32056
PH. 386-752-4675
WWW.NFPS.NET
LIC NO. LB8356

2551 BLAIRSTONE PINES DR.
TALLAHASSEE, FL 32301
WWW.NFPS.NET
CA# 29011

1/18/2024 4:32:48 PM

K:\2018\180115\MINI-STORAGE\FOUNDATION.dwg FOUNDATION

- ELECTRICAL NOTES:
1. WIRE, CONDUIT, & PANEL SIZES TO BE DETERMINED BY ELECT. CONTRACTOR.
 2. EXTERIOR LIGHT FIXTURES AS CHOSEN BY OWNER.

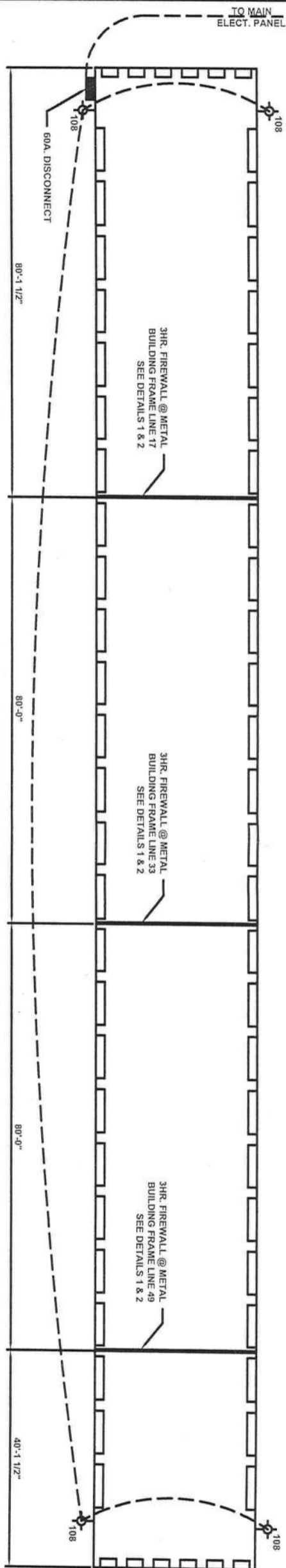

ELEC. - FIREWALL PLAN BLDG NOS. 1100 & 1200
SCALE: NTS

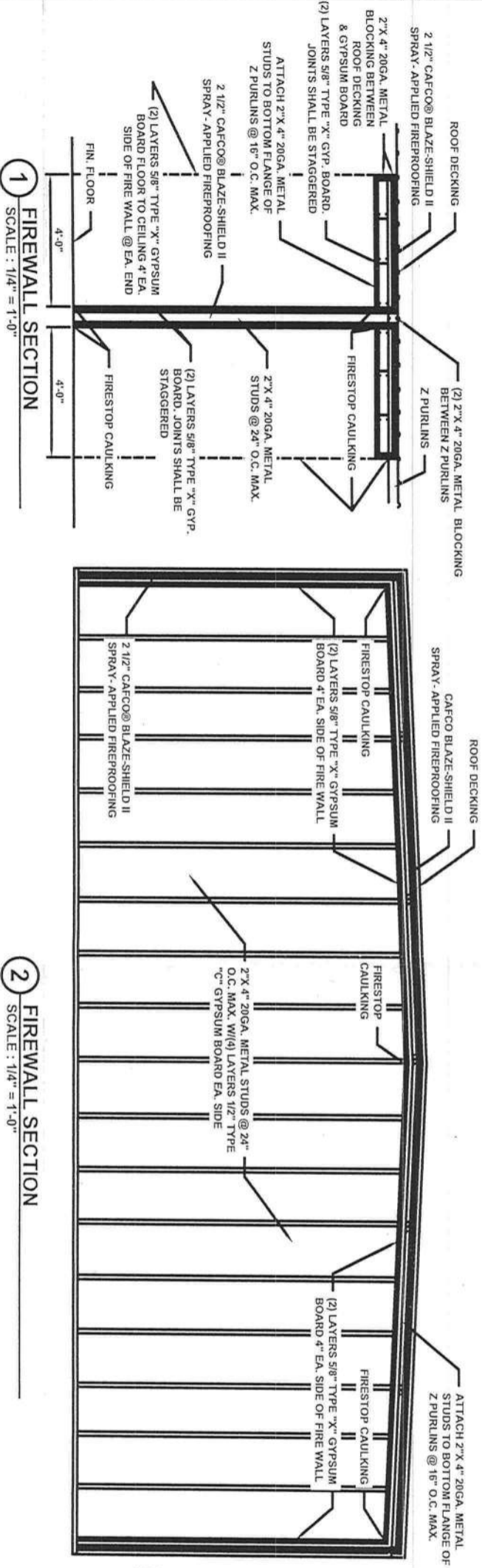

2 FIREWALL SECTION
SCALE: 1/4\"/>

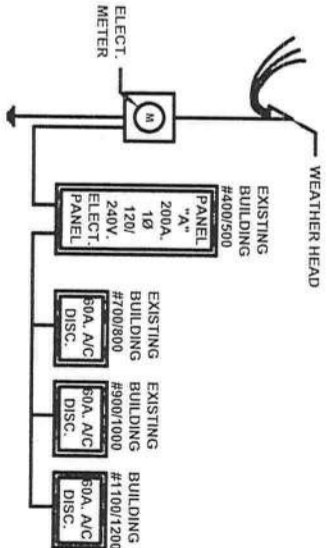

DATE	REVISIONS
	DESCRIPTION



NORTH FLORIDA PROFESSIONAL SERVICES, INC.
P.O. BOX 3823
LAKE CITY, FL 32056
PH. 386-752-4675
LIC NO. LB8356

JOB NUMBER:
L180115-1BP
EOR:
ROBERT PHILIP
BISHOP, JR
P.E. NO.:
38546

ELECT. - FIREWALL PLAN BLDG 1100 & 1200
LAKE CITY MINI-STORAGE
COLUMBIA COUNTY, FLORIDA

SHEET NO.
03

DESIGN NOTE:
THIS BUILDING IS DESIGNED WITH IMPORTANCE FACTORS REQUIRED FOR MINOR STORAGE FACILITIES. MINOR STORAGE FACILITIES ARE THOSE WHICH REPRESENT A LOW HAZARD TO HUMAN LIFE IN THE EVENT OF FAILURE. THIS PROJECT IS STATED TO BE A MINOR STORAGE MINI-WAREHOUSE FACILITY AND CERTAIN STORAGE FACILITIES ARE ACCEPTABLE UNDER THE LOW HAZARD DEFINITION. IT IS THE RESPONSIBILITY OF THE CUSTOMER TO VERIFY THIS IS ACCEPTABLE TO LOCAL CODE AUTHORITIES HAVING JURISDICTION. MANUFACTURER BEARS NO RESPONSIBILITY FOR USE OF REDUCED LOAD IMPORTANCE FACTORS.

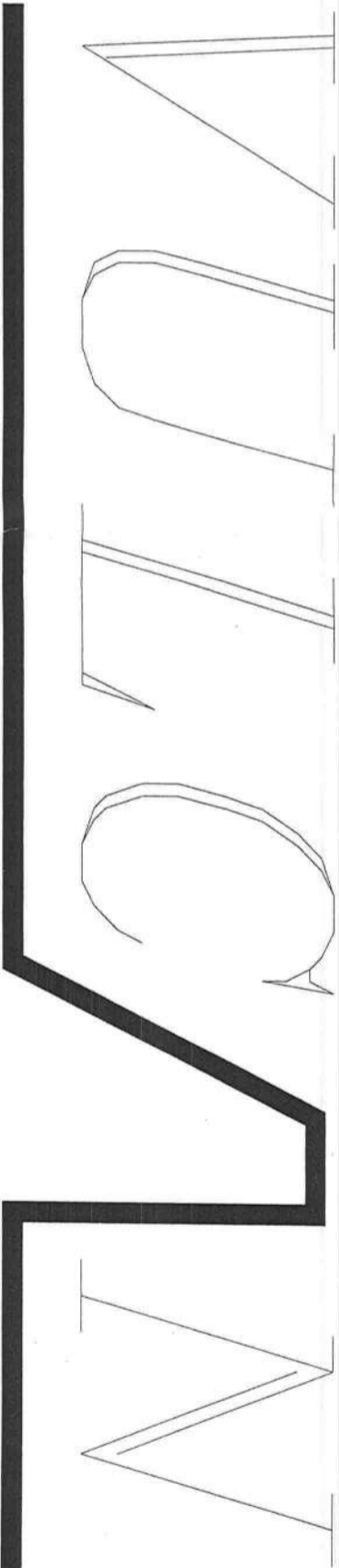

S T O R A G E S Y S T E M S
A division of Vulcan Steel Structures, Inc.
500 Vulcan Parkway Adel, Georgia 31620

CUSTOMER: MINI STORAGE & RECORD STORAGE of LAKE CITY

JOB NUMBER: 28303

STREET ADDRESS: 2529 SW STATE ROAD

CITY, STATE, ZIP LAKE CITY, FL 32025

PROJECT NAME: 30X280X10 MINIS

NOTE : 2 IDENTICAL BUILDINGS

DESIGN LOADS

BUILDING CODE:	FBC 23
FRAME SELF WEIGHT:	INCLUDED
ROOF DEAD LOAD:	2.000 psf
COLLATERAL LOAD:	0.5 psf
ROOF LIVE LOAD:	20.00 psf
WIND	
WIND SPEED: (3-sec Gusts):	110 mph (Vult)
(3-sec Gusts):	85 mph (Vosd)
WIND EXPOSURE:	B
CLOSURE "C, O, P" :	Closed
INTERNAL PRESSURE COEFF. :	0.18 / -0.18
RISK CATEGORY:	1 - Low Hazard

FLOOD ZONE CATEGORIZATION: X (Unshaded)

SEISMIC

SEISMIC IMPORTANCE FACTOR: $I_e = 1.00$
MAPPED SPECTRAL RESPONSE ACC., $SS: 0.098$
MAPPED SPECTRAL RESPONSE ACC., $SI: 0.055$
SPECTRAL RESPONSE COEFF: $SDS = 0.1045$
(2 SEC PERIOD)
SPECTRAL RESPONSE COEFF: $SDI = 0.088$
(1.0 SEC PERIOD)

SEISMIC DESIGN CAT.: B
SEISMIC COEFFICIENT $C_s: 0.037$
SITE CLASS (ASSUMED): D

DESIGN BASE SHEAR: $V = 1.44$
BASIC SEISMIC-FORCE RESISTING SYSTEM
SHEAR DIAPHRAGM

BUILDING DESCRIPTION

WIDTH	30	DESCRIPTION	QTY	SIZE
LENGTH	280	FACTORY F/O-LEW	none	
EAVE HEIGHT/FRONT	10	FACTORY F/O-FSW	(28)	8 W x 7 H
EAVE HEIGHT/BACK	10	FACTORY F/O-REW	none	
ROOF SLOPE/FRONT	0.5:12	FACTORY F/O-BSW	(28)	8 W x 7 H
ROOF SLOPE/BACK	0.5:12			
BAY / UNIT SIZES:				
LEV		ROLL - UP DOORS	(56)	8 W x 7 H
FSW	(28) 10 W x 20 D	WALK DOORS	--	--
REV		WINDOWS	--	--
BSW	(28) 10 W x 10 D	OTHER	--	--

PANELS, TRIM & ACCESSORIES

DESCRIPTION	SIZE / TYPE	COLOR
ROOF PANELS	26 PR	Galvalume
WALL PANELS	26 PR	Light Stone
PARTITION PANELS	29 PR	Galvalume
MULTION PANELS	26 PR	Light Stone
RAKE TRIM	26 GA	Burnished State
GUTTER	26 GA	Burnished State
DOWNSPOUTS	26 GA	Burnished State
CORNER TRIM	26 GA	Burnished State
FRAMED OPENINGS	26 GA	Light Stone
ROLL-UP DOORS	BY VSS/W/50	--
WALK DOORS	--	--
WINDOWS	--	--

FASTENERS

APPLICATION	TYPE	LONG LIFE	COLOR
ANCHOR BOLT	1/2" x 3 3/4" KWIK BOLTS	-	N/A
ROOF MEMBER	#12 x 1 1/4" L.L.S.D. w/ WASHER	Y	Galvalume
ROOF STITCH	#14 x 7/8" L.L.S.D. w/ WASHER	Y	Galvalume
WALL MEMBER	#12 x 1 1/4" S.D. w/ WASHER	N	Light Stone
WALL STITCH	#14 x 7/8" S.D. w/ WASHER	N	Light Stone
TRIM MEMBER	#12 x 1 1/4" S.D. w/ WASHER	N	Burnished State
TRIM STITCH	#14 x 7/8" S.D. w/ WASHER	N	Burnished State
FRAMING	#12 x 1 1/4" S.D. w/o WASHER	N	PLAIN
PARTITION	#12 x 1 1/4" S.D. w/o WASHER	N	PLAIN
PARTITION STITCH	#14 x 7/8" S.D. w/o WASHER	N	PLAIN

DRAWING INDEX

SHEET NO.	DESCRIPTION
CS	COVER SHEET
F1	REACTIONS & CONG. NOTCH PLAN
E1 OF 10	FLOOR PLAN
E2 OF 10	ROOF PLAN
E3, E4	FRONT SIDEWALL ELEV.
E5, E6	BACK SIDEWALL ELEV.
E7	LEFT ENDWALL ELEV.
E8	RIGHT ENDWALL ELEV.
E9	PART. FRAMING
E10	ROOF INSULATION

ENGINEER'S STAMP

THE PROJECT DESIGNER IS NOT THE ME BUILDING MANUFACTURER, THE METAL BUILDING DESIGNER OR THE METAL BUILDING ENGINEER WHOSE SEAL APPEARS ON THE METAL BUILDING PLANS IS A SPECIALTY ENGINEER AND NOT THE PROJECT DESIGNER OR THE PROJECT ENGINEER OF RECORD. ENGINEER WHOSE SEAL APPEARS ON THE METAL BUILDING PLANS DOES NOT HAVE FAMILIARITY WITH THE PHYSICAL JOBSITE LOCATION AND THEREFORE CANNOT BE IDENTIFIED AS, SERVE AS OR QUALIFY AS THE PROJECT DESIGNER.

DATE	1 / 9,
SHEET	CS
DRN. BY	MF

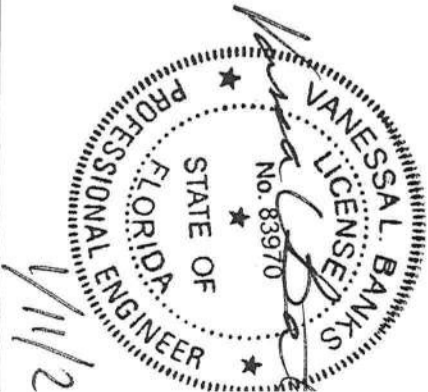

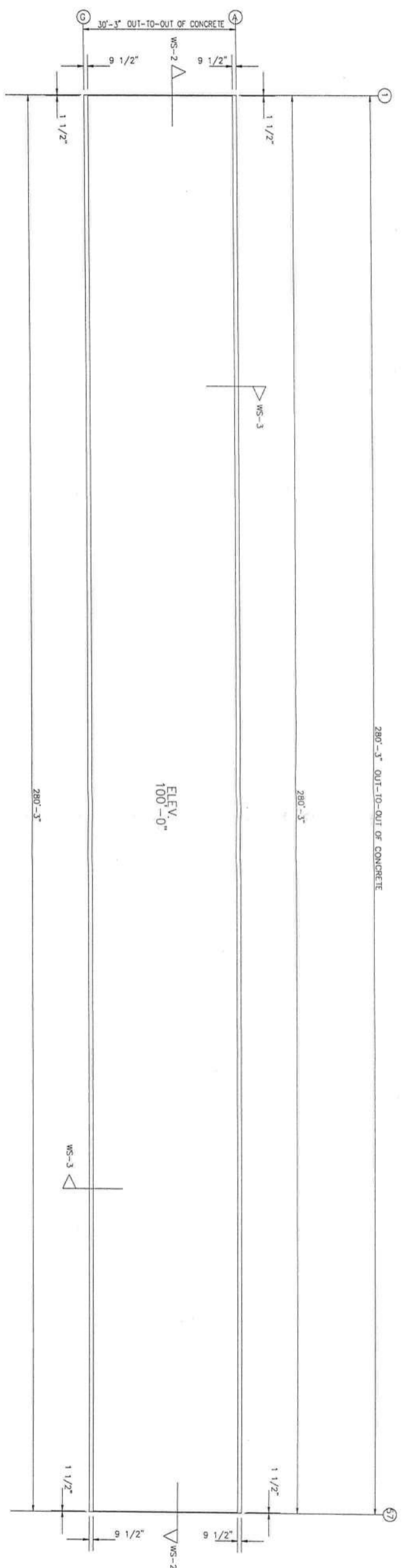

ANCHOR PLAN

WALL COLUMN: MAXIMUM REACTIONS

Frm Line	Col Line	Load Id	Column Reactions (k)		Load Id	Reactions (k)	
			Hmax	Vmax		Hmin	Vmin
1	A	7	0.0	0.0	2	0.0	-0.1
		3	0.0	0.3	4	0.0	-0.1
1	G	7	0.0	0.0	2	0.0	-0.1
		3	0.0	0.3	4	0.0	-0.1
57	G	7	0.0	0.0	2	0.0	-0.1
		3	0.0	0.3	4	0.0	-0.1
57	A	7	0.0	0.0	2	0.0	-0.1
		3	0.0	0.3	4	0.0	-0.1
1	B-F	5	0.3	-0.2	2	-0.3	-0.1
		3	0.0	0.6	4	-0.2	-0.2
3-55	G	3	0.0	0.6	4	0.0	-0.2
57	B-F	5	0.3	-0.2	2	-0.3	-0.1
		3	0.0	0.6	4	-0.2	-0.2
3-55	A	3	0.0	0.6	4	0.0	-0.2
2-56	B-F	1	0.2	-0.2	2	-0.2	-0.3
		3	0.0	1.2	4	-0.2	-0.5

NOTES FOR REACTIONS

- All loading conditions are examined and only maximum/minimum H or V and the corresponding H or V are reported.
- For vertical loads, upward is positive and downward is negative. For horizontal reactions to the right is positive and to the left is negative. Foundation loads are in opposite directions to the brocced boy. The vertical reaction is downward.
- Brocced reactions are in the plane of the brace with the H pointing away from the brocced boy.
- Building reactions are based on the following building data:

Width (ft)	=	30.0
Length (ft)	=	280.0
Eave Height (ft)	=	10.0/10.0
Roof Slope (rise/12)	=	0.5/-0.5
Dead Load (psf)	=	2.0
Collateral Load (psf)	=	0.5
Live Load (psf)	=	20.0
Wind Speed (mph)	=	110.0
Wind Code	=	IBC
Exposure	=	B
Closed/Open	=	C
Importance Wind	=	1.00
Importance Seismic	=	1.00
Seismic Zone	=	B
Seismic Coeff (Fa/Ss)	=	0.14

5. Loading conditions are:

- 0.60DL+0.60WR2+0.60WS
- DL+CL+0.60WP+0.60L.nWind1
- DL+CL+LL
- 0.60DL+0.60WP+0.60L.nWind1
- 0.60DL+0.60WR1+0.60WS
- 0.60DL+0.60WP+0.60L.nWind2
- DL+CL+0.75SL+0.45WR2+0.45WS
- DL+CL+0.60WP+0.60L.nWind2

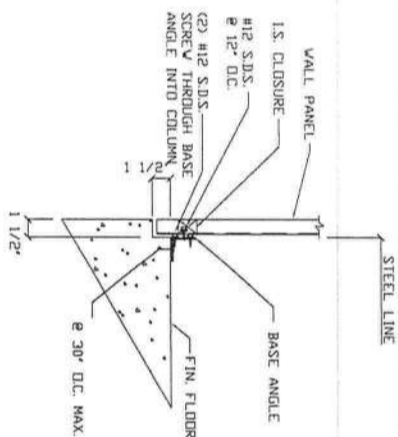

SECTION WS-2

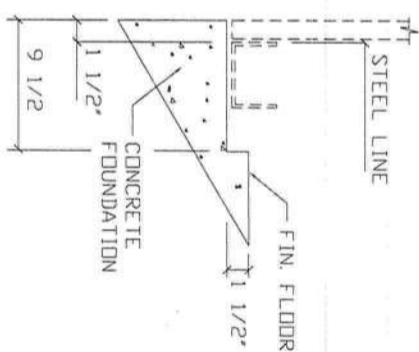

SECTION WS-3

REVISIONS		DATE	DLR	DATE	CHKR	APPD
REV.	DESCRIPTION					

DRAWING STATUS	
<input type="checkbox"/> FINAL ERECTION	
<input type="checkbox"/> FOR CONSTRUCTION	
<input type="checkbox"/> FOR APPROVAL	
<input type="checkbox"/> OTHER, EXPLAIN	

VULCAN STEEL STRUCTURES, INC.	
PROJECT	30X280X10 MINIS
ID	28303
PROJECT ADDRESS	2529 SW STATE ROAD

MINI STORAGE & RECORD SITE	
ANCHOR PLAN	
DESIGN	DRAT: MF
DATE: 1/9/24	CHECK
	SHEET
	F1

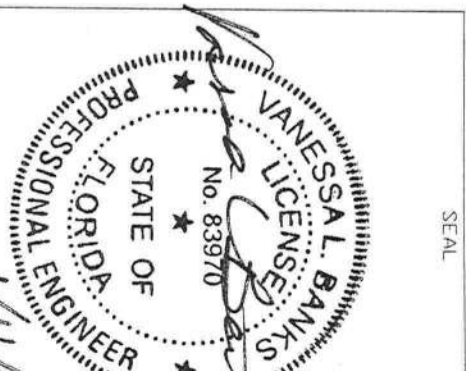

MEMBER TABLE		
MARK	PART	LENGT
S-1	4X20C16	10'-2"
S-2	4X20C16	10'-4"
S-3	4X20C16	10'-7"
S-4	4X20C16	10'-1"

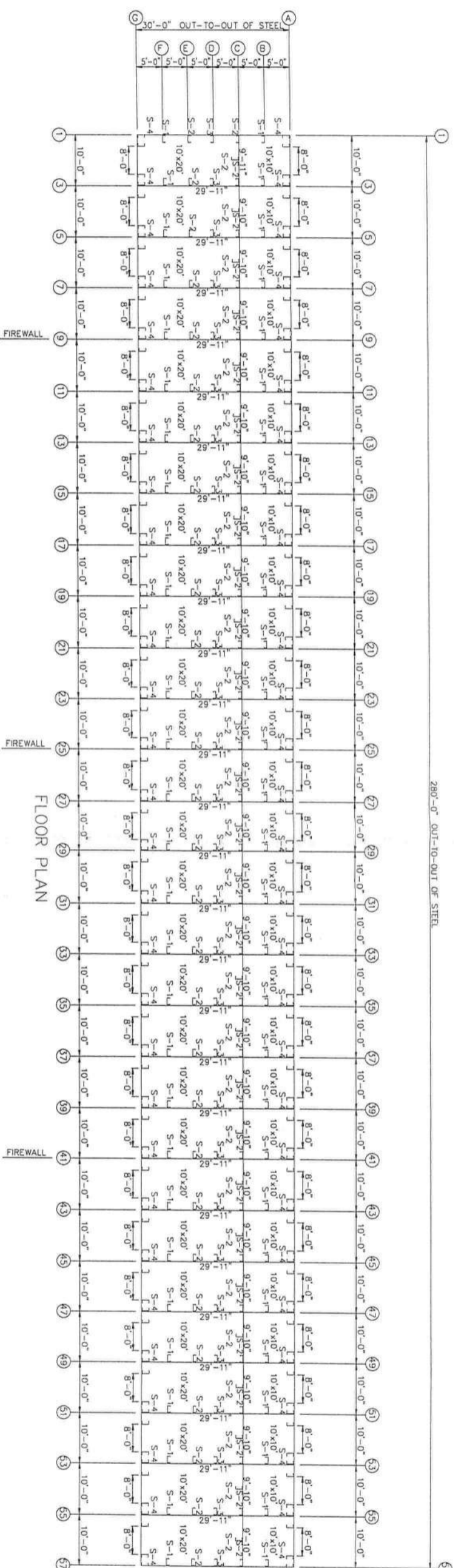

```
ALL (PC-*) COLUMNS ARE 4X20C16
ALL (DJ-*) COLUMNS ARE 4X20C16
SA1 = 2X4X16GA ANGLE
PA1 = 2X4X16GA ANGLE
```

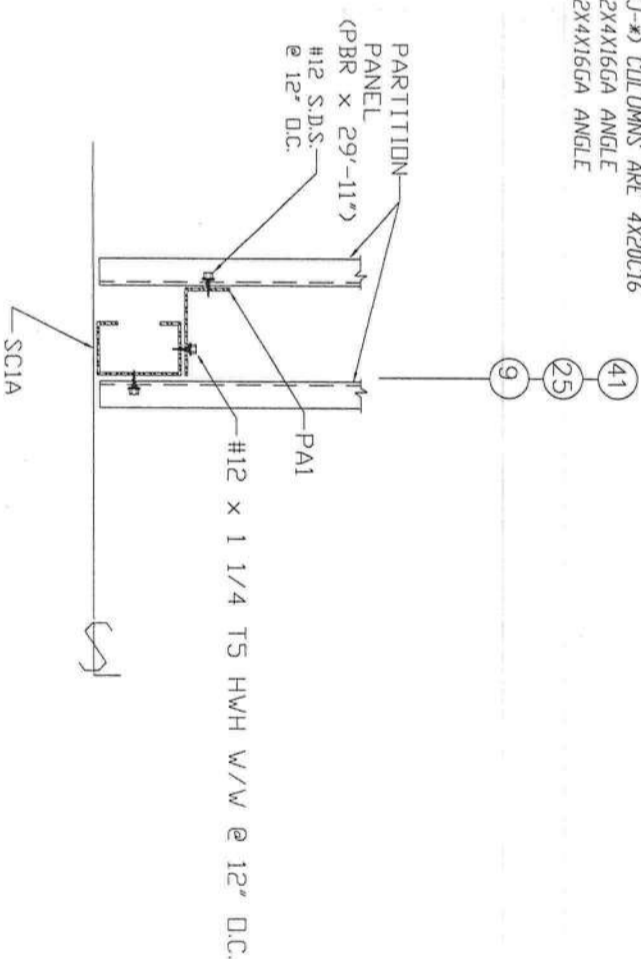

NOTE: SEE WALL ELEVATIONS
FOR FRAME PART MARKS

DETAIL AT FIREWALL

REVIEWS						DRAWING STATUS		VULCAN STEEL STRUCTURES, INC		MINI STORAGE & RECORD STG			
REV.	DESCRIPTION	DATE	DLR	DATE	CHKR	APRD	<input type="checkbox"/> FINAL ERECTION <input checked="" type="checkbox"/> FOR CONSTRUCTION <input type="checkbox"/> FOR APPROVAL <input type="checkbox"/> OTHER, EXPLAIN	PROJECT ID	ADDRESS	FLOOR PLAN	DRAFT: MF	CHECK: E	SHEET
								28303	2529 SW STATE ROAD				

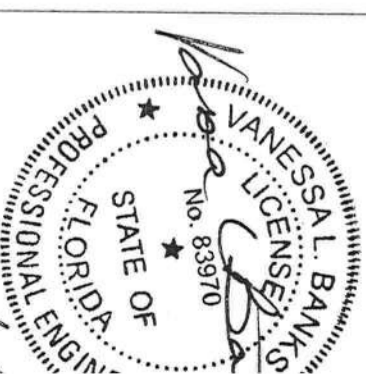

MEMBER TABLE				
QUAN	MARK	PART	LENGT	
2	TC-1	4X25CH16	19'-10"	
24	TC-2	4X25CH16	19'-11"	
2	TC-3	4X25CH16	20'-0"	
10	P-1	4X20Z16	20'-5"	
60	P-2	4X20Z16	21'-0"	

MEMBER TABLE

QUAN	MARK	PART	LENGT
2	TC-1	4X25CH16	19'-10"
24	TC-2	4X25CH16	19'-11"
2	TC-3	4X25CH16	20'-0"
10	P-1	4X20Z16	20'-5"
60	P-2	4X20Z16	21'-0"

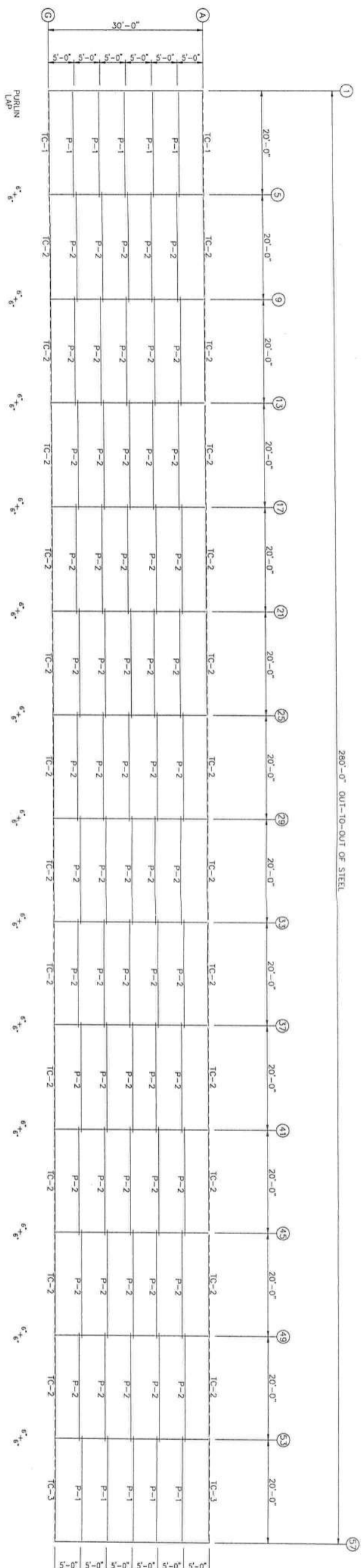

ROOF FRAMING

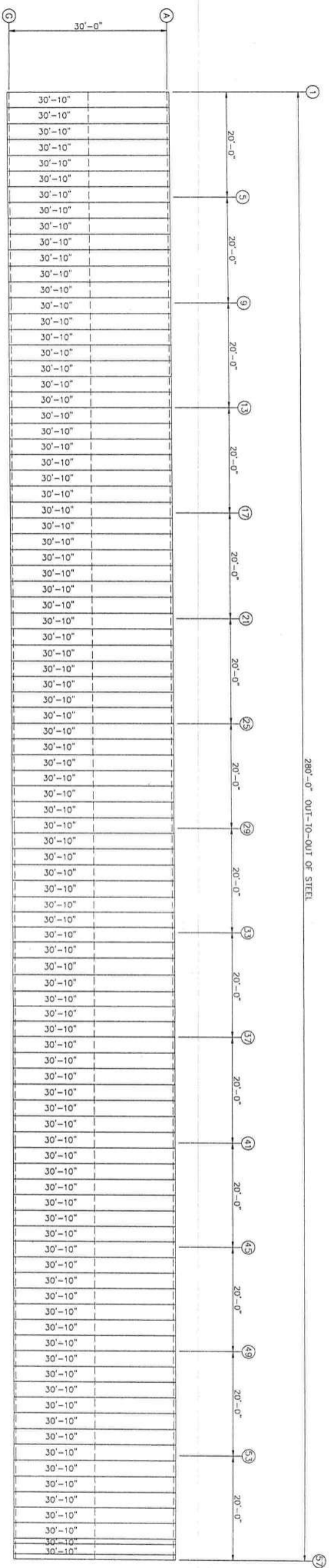

ROOF SHEETING & TRIM

PANELS: 26 Gd. PR - Galvolum

REVISONS						DRAWING STATUS	VULCAN STEEL STRUCTURES, INC.
REV.	DESCRIPTION	DATE	DLR	DATE	CHKR	APPD	
							<input type="checkbox"/> FINAL ERECTION <input checked="" type="checkbox"/> FOR CONSTRUCTION <input type="checkbox"/> FOR APPROVAL <input type="checkbox"/> OTHER, EXPLAIN
							PROJECT ID 28303
							PROJECT ADDRESS 2529 SW STATE ROAD

ORIGINAL SIGNATURE REQUIRED

MINI STORAGE & RECORD STI

ROOF DRAWING

DESIGN:	DRAFT: MF	CHECK:
---------	-----------	--------

DATE: 1/ 9/24	SHEET E
---------------	---------

SEAL

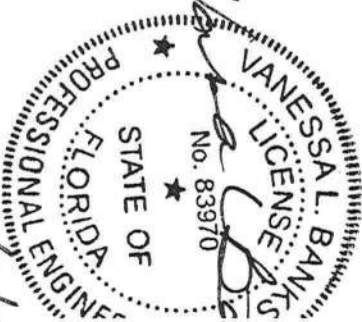

112

