

SHEATHING NAILING DETAIL
SCALE: N.T.S.

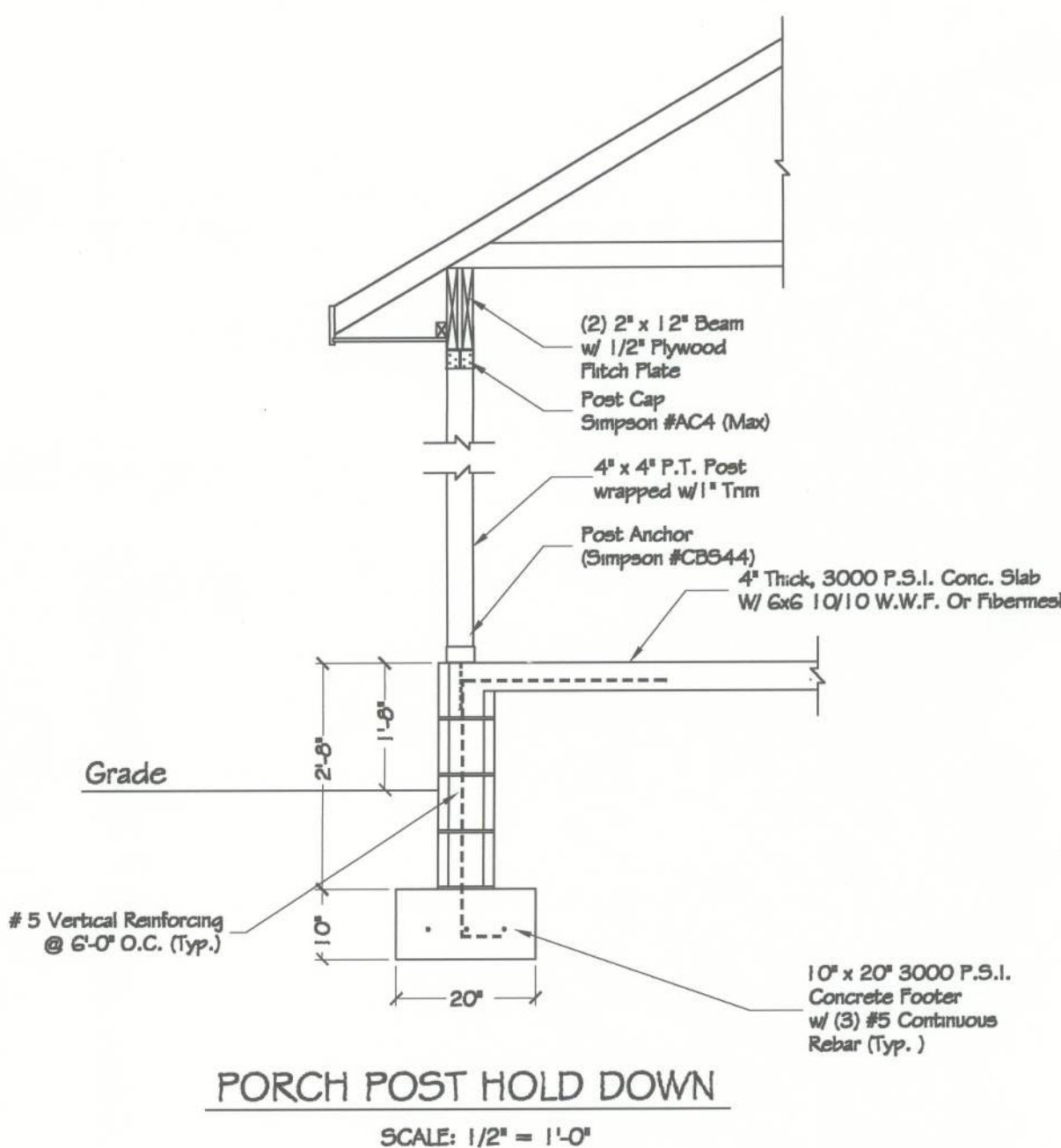

NOTE:
ALL WORK SHALL COMPLY WITH LATEST GOVERNING CODES, LIFE SAFE CODES, ADA CODES, NEC CODES, AND ALL APPLICABLE CITY AND COUNTY CODES.
DIMENSIONS ON PLANS TO BE CONFIRMED IN FIELD. DETAIL DIMENSIONS SUPERSEDES SMALLER SCALE DRAWINGS.

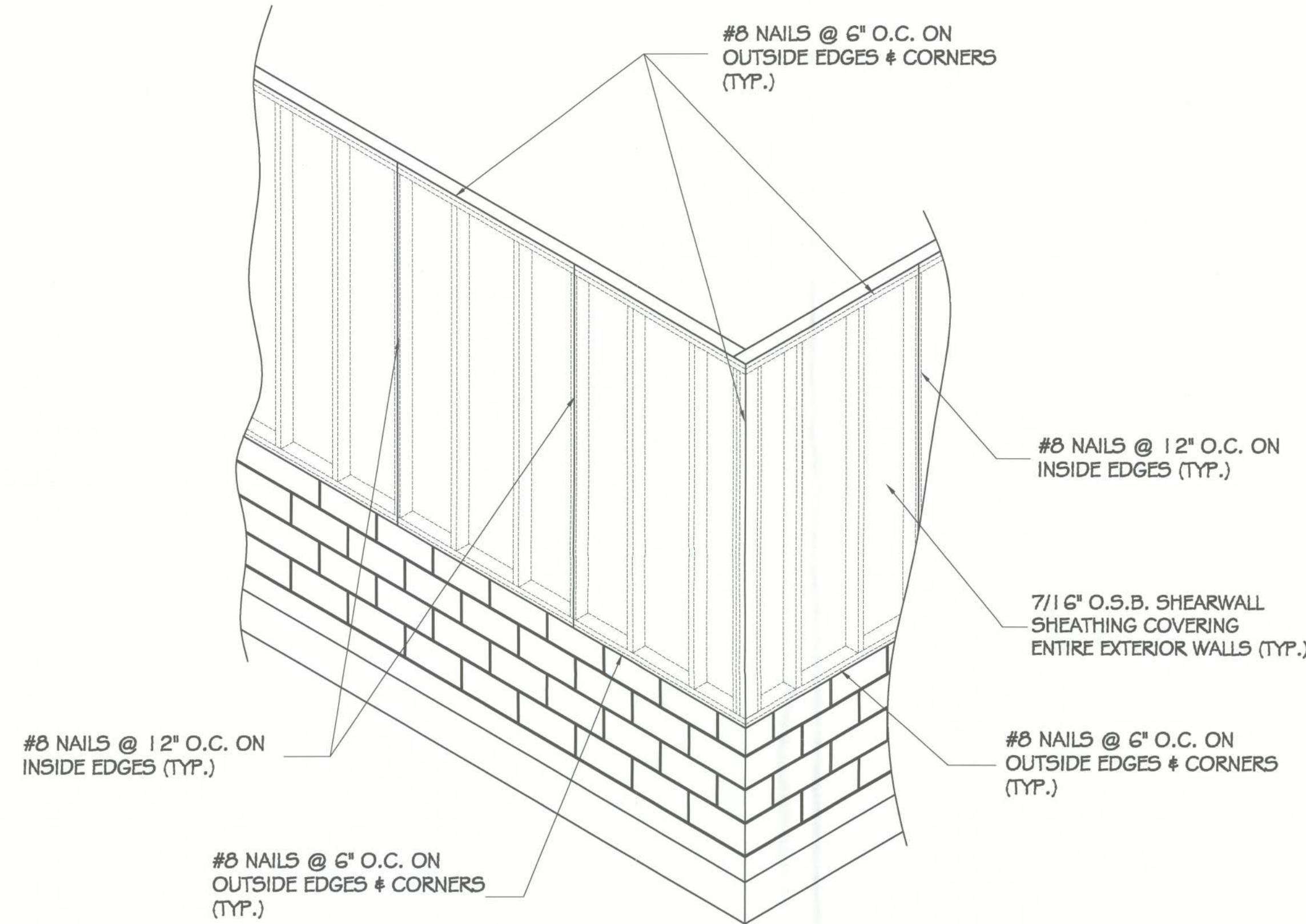

SHEARWALL NAILING DETAIL
SCALE: N.T.S.

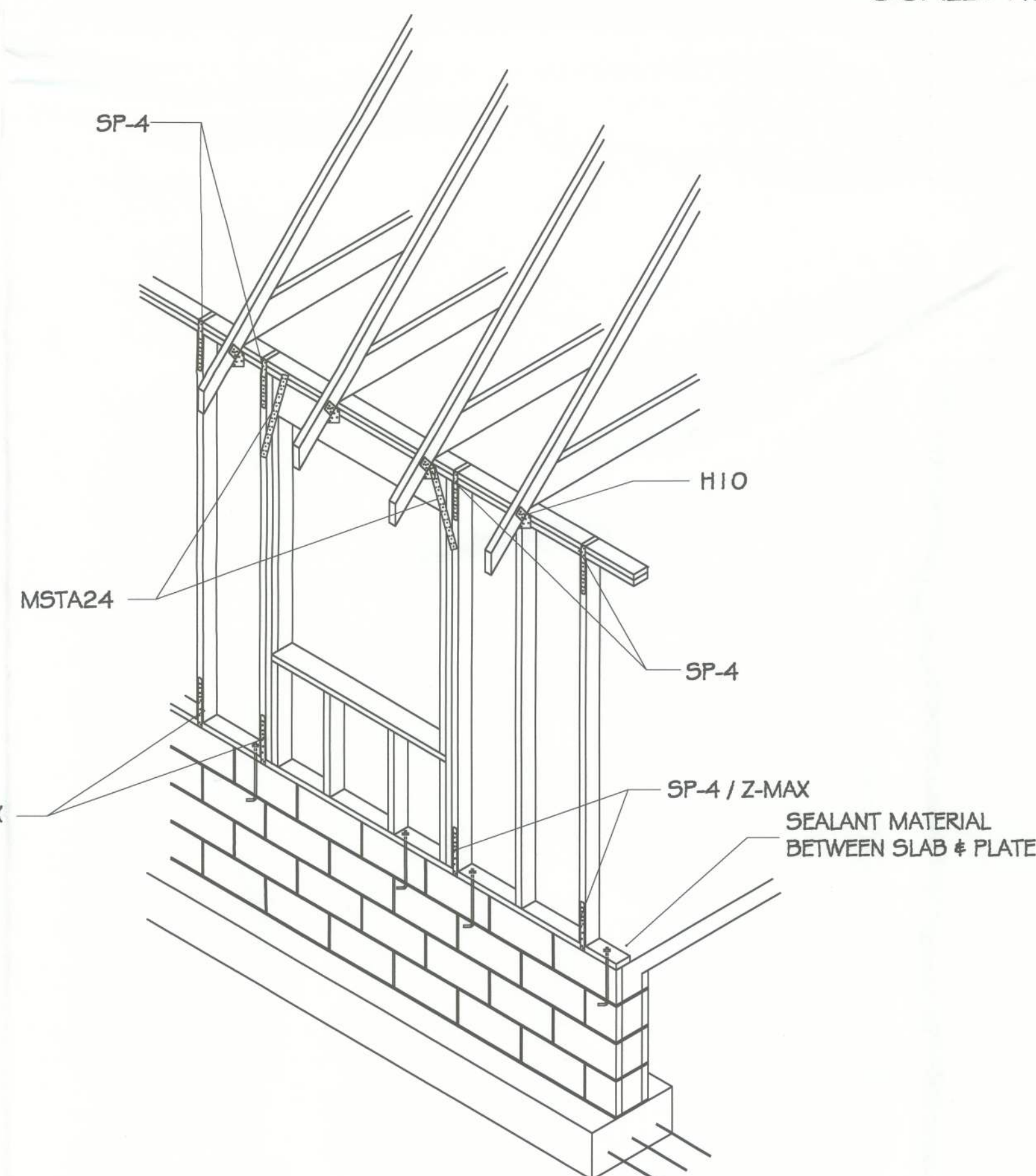

ISOMETRIC DETAIL
SCALE: N.T.S.

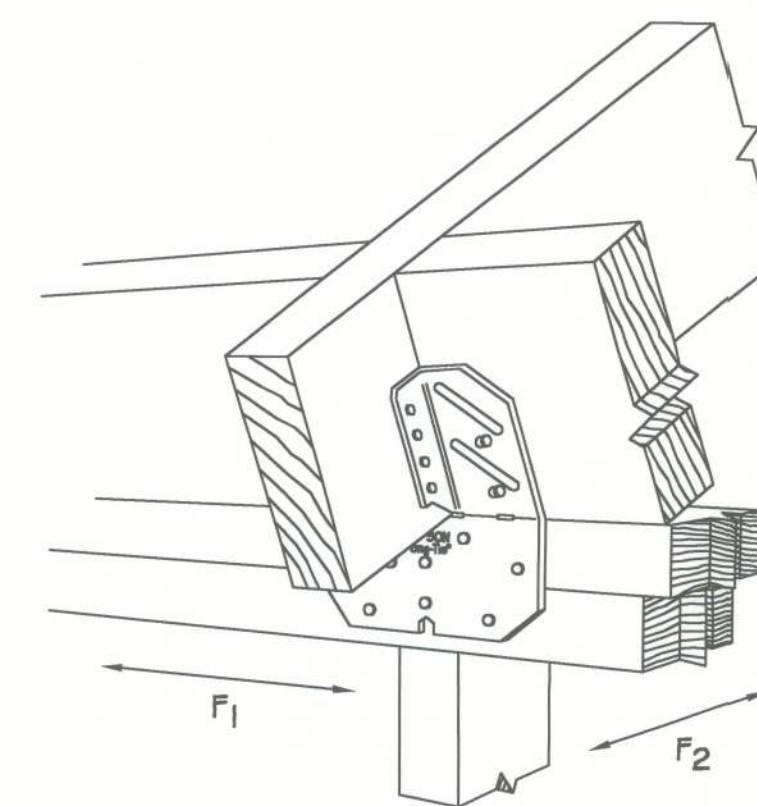

SIMPSON "H10"
SCALE: N.T.S.

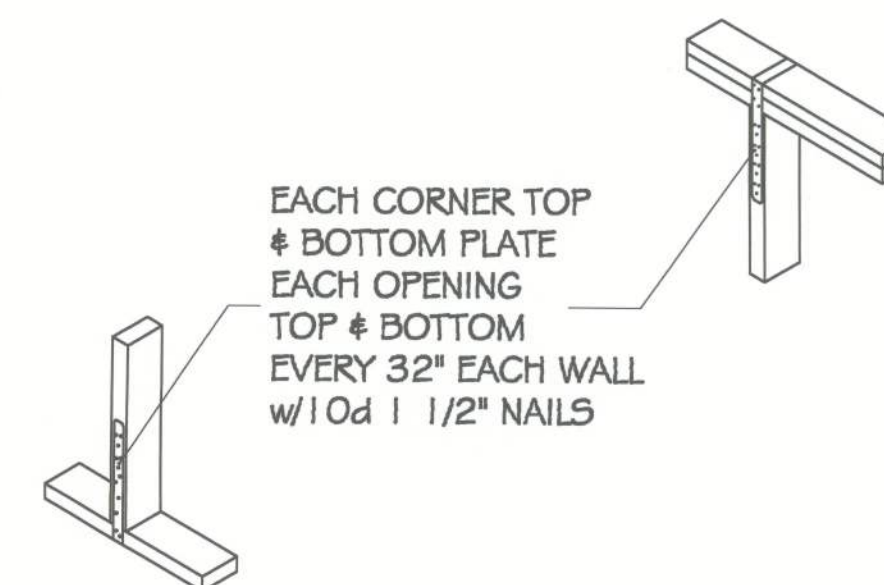

SP4 & SP4/Z-MAX
SCALE: N.T.S.

NO SUBSTITUTIONS

All framing hardware shown on these plans, unless otherwise indicated, is Simpson Strong-Tie. No substitutions are approved or authorized.

Due to the relationship of framing hardware to the other components of the structure, any framing hardware substitutions will render these plans null and void, and result in the installer/contractor assuming responsibility for the design and performance of the entire system.

GENERAL NOTES:

DESIGN LOAD

1. Live Load = 40 PSF
2. Dead Load = 10 PSF
3. Wind Loads
Basic Wind Speed 110 MPH (3 SEC. Gust)
Importance (I) = 1.0
Wind Exposure = "B"
Internal pressure = 50 +/- PSF
Roof Components and cladding = 50 +/- PSF
Wall Components and cladding = 50 +/- PSF

SPECIFICATIONS

Design material and workmanship shall be in accordance with The current editions of the following standards, unless Otherwise modified on the drawings:

- ASCE 7 minimum design load for buildings and other Structures.
- ACI 318 building code requirements for reinforced concrete.
- AC315 manual of standard practice for detailing concrete Structures.
- ACI 301 specifications for structural concrete for buildings.
- CRSI recommend practice for placing reinforcing steel.
- ACI 530/ASCE 5/TMS 402 Building code for masonry structures.
- 2001 Florida Building Code 2002 REV.

BUILDING MATERIAL

1. Roof
A.) Roof Sheathing shall be 1/2 inch APA rated sheathing w/8d Nails spaced 6" maximum at supported edges. Space nails Maximum 12" along intermediate framing members. Fasteners Shall be located 3/8" from panel edges. Minimum nail penetration Shall be 1-3/8" typical
B.) Nail spacing shall be 4" O.C. with 8d common nails along Roofing member over gable end truss.
C.) Per APA, Structural diaphragm capacity = 240 PSF (Not Including 40 % increase per FBC 2323.24)

2. Trusses

- A.) Trusses shall be pre-engineered according to design Load.
- B.) Trusses shall be braced per truss plate institute

3. Interior Finishes

- A.) All gypsum board shall have a minimum thickness of 1/2 inch.

4. Masonry Walls

- A.) Assumed maximum compressive strength = 1500 PSI (Grouted Hollow concrete units-Grade N)
- B.) Vertical reinforcing in walls shall be 5 rebar spaced 48" O.C. (TYP)

- C.) Horizontal reinforcing in walls shall be ladder type Joint reinforcing (grade 40).

- D.) The reinforcing shall be a minimum Grade 40.

- E.) Provide cleanouts in the bottom course of masonry for Each grout pour, when the grout pour exceeds 5 ft., Construct cleanouts adjacent to each vertical bar.

5. Concrete footing and slab

- A.) Concrete shall have a minimum compressive strength of 3000 PSF in 28 days,

- B.) Reinforcing steel shall conform to ASTM A615 Grade 40. Welded wire mesh shall conform to ASTM A185.

- C.) Provide a minimum cover of 3" for reinforcing steel when Concrete is placed directly against the ground. Concrete Exposed to earth or weather shall have a minimum cover of 1/2 inch
- D. Welded wire fabric shall have a minimum yield strength Of 65,000 PSI.

- E.) Minimum WWF for slab on grade shall be 6x6-W1.4x1.4.

- F.) A vapor retarder consisting of 6 mil minimum Polyethylene with joints lapped 6" and sealed with 2" Approved tape or mastic, or other approved materials having A maximum perm rating of 0.5.

6. Soil Preparation and Properties

- A.) Area under footings, foundations, and concrete slabs Shall have all vegetation, stumps, roots, and foreign Matters removed prior to their construction.
- B.) Fill material shall be free of vegetation and foreign Material.
- C.) Allowable bearing pressure = 1000 PSF.

SPECIFICATIONS

SCALE: 1/4" = 1'-0"

DATE: 07-02-2010

DRAWN BY: DON CASON

DRAWING NUMBER

A-2

SHEET 3 OF 8

A NEW RESIDENCE FOR

MR. & MRS. ACOSTA
Columbia County, Florida

DONALD E. CASON
DESIGN & DRAFTING SERVICES

611 Cotton Avenue
Lake Park, Georgia 31686
Office: 1-229-561-2606 e-mail: donald_cason@yahoo.com