

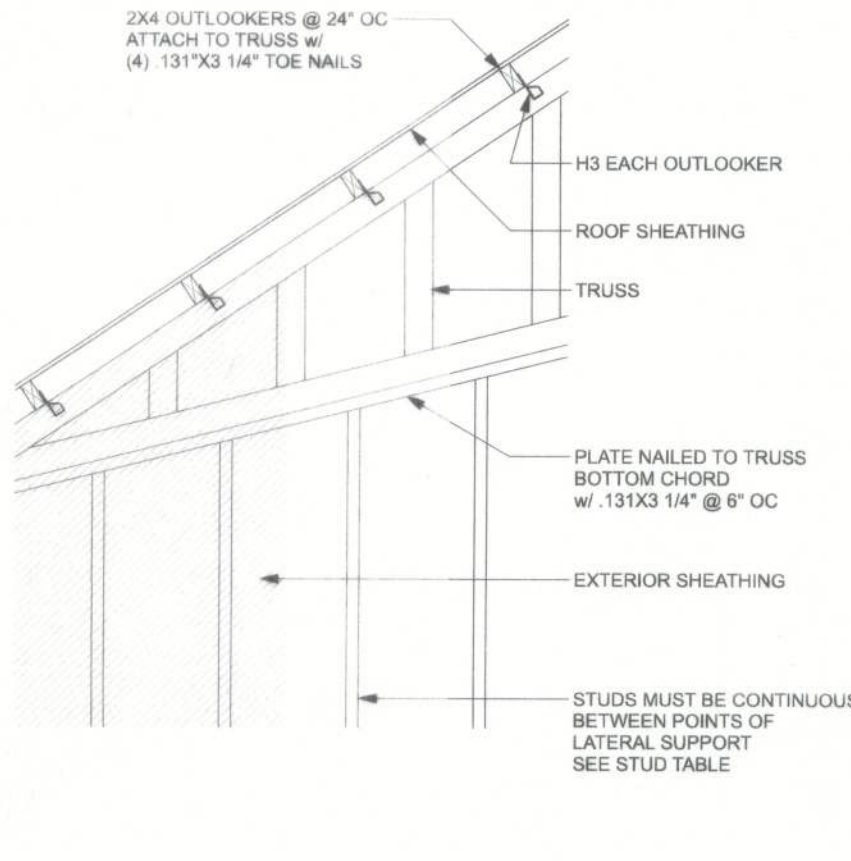

SPACE RAT RUN & DIAGONAL BRACE 6'-0" O.C.  
FOR GABLE HEIGHT UP TO 25'-0" 130 MPH, EXP. C, ENCLOSED



**EXTERIOR WALL STUD TABLE FOR SPF #2 STUDS:**

GRADE & SPECIES TABLE			
		Fb	E
2x8	SP #2	925	1.4
2x10	SP #2	800	1.4
2x12	SP #2	750	1.4
GLB	24F-V3 SP	2600	1.9
LSL	TIMBERSTRAND	1700	1.7
LVL	MICROLAM	2950	2.0
PSL	PARALAM	2900	2.0

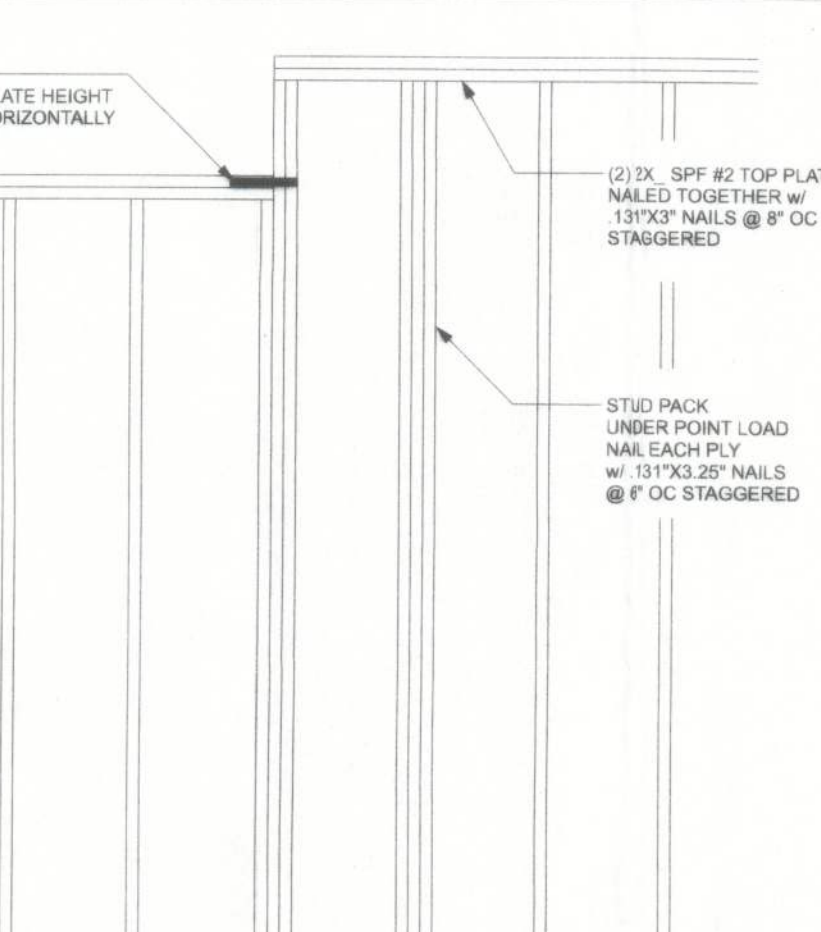

2X6 SP #2 DOOR BUCK

BRACKET



ANCHOR BOLTS: A-307 ANCHOR BOLTS WITH MINIMUM EMBEDMENT AS SPECIFIED IN DRAWINGS BUT NO LESS THAN 7" IN CONCRETE OR REINFORCED BOND BEAM OR 15" IN GROUTED CMU.

**ROOF SYSTEM DESIGN:**

THE SEAL ON THESE PLANS FOR COMPLIANCE WITH FBQR, IS BASED ON RETENTIONS, UPLIFTS, AND BEARING LOCATIONS IN TRUSS ENGINEERING SUBMITTED TO THE WIND LOAD ENGINEER. IT IS THE RESPONSIBILITY OF THE BUILDER TO CHECK ALL DETAILS OF THE COMPLETE ROOF SYSTEM DESIGN SUBMITTED TO THE WIND LOAD ENGINEER AND HAVE IT SIGNED, AND SEALED BY A DESIGN PROFESSIONAL. THE BUILDING OF FBQR REQUIRED COMPLIANCE TO LOADS AND ANY SPECIAL LOADS. THE BUILDER IS RESPONSIBLE TO REVIEW EACH INDIVIDUAL TRUSS MEMBER AND THE TRUSS ROOF SYSTEM AS A WHOLE TO PROVIDE PROPER BRACING FOR THE ROOF. BRACING THE BUILDER SHOULD USE CARE CHECKING FOR ANY LATERAL DESIGN BECAUSE THE WIND LOAD ENGINEER IS SPECIFICALLY NOT RESPONSIBLE FOR THE LAYOUT OF THE TRUSS. THE BUILDER, THE TRUSS MANUFACTURER AND THE TRUSS DESIGNER ALSO DENIES RESPONSIBILITY FOR THE LAYOUT PER NOTES ON THEIR SEALED TRUSS SHEET.

COMPONENT & CLADDING DESIGN PRESSURES 130 MPH (EXP C)				
EFFECTIVE WIND AREA (FT <sup>2</sup> )	ZONE 4 INTERIOR		ZONE 5 END 4' FROM ALL OUTSIDE CORNER	
0 - 20	+25.6(Vasd)	-27.8(Vasd)	+25.6(Vasd)	-34.2(Vasd)
0 - 20	+42.6(Vult)	-46.2(Vult)	+42.6(Vult)	-57(Vult)
GARAGE DOOR DESIGN PRESSURES 130 MPH (EXP C)				
9x7 GARAGE DOOR	+22.6(Vasd)	-25.5(Vasd)		
16x7 GARAGE DOOR	+21.7(Vasd)	-24.1(Vasd)		

B&amp;B Homes

Josh & Jessica Robinson Res.

**PROJECT ADDRESS:**  
Columbia County, FL



FL PE 53915



Friday, September 15, 2023

**DIMENSIONS:**  
Stated dimensions supercede scaled dimensions. Refer all questions to Mark Disosway, P.E. for resolution. Do not proceed without clarification.

**COPYRIGHTS AND PROPERTY RIGHTS:** Mark Disosway, P.E. hereby expressly reserves its common law copyrights and property right in these instruments of service. This document is not to be reproduced, altered or copied in any form or manner without first the express written permission and consent of Mark Disosway.

CERTIFICATION: I hereby certify that I have examined this plan, and that the applicable portions of the plan, relating to wind engineering, comply with the 7th Edition Florida Building Code Residential (2020) to the best of my knowledge.

**LIMITATION:** This design is valid for one building, at specified location.

---

Mark Disosway P.E.  
163 SW Midtown Place

Suite 103  
Lake City, Florida 32025

386.754.5419  
disoswaydesign@gmail.com

LOAN NUMBER

JOB NUMBER:  
231112

**S-1**

OF 3 SHEETS