

FLORIDA BUILDING CODE R4501

THE POOL CONTRACTOR IS RESPONSIBLE FOR FURNISHING ALL DETAIL DESIGN REQUIREMENTS FOR EACH INDIVIDUAL POOL IN ACCORDANCE WITH THE FLORIDA BUILDING CODE, ALL APPLICABLE CODES INCLUDING PLUMBING, ELECTRICAL AND GAS. PIPING SHALL BE SCH. 40 PVC, NSFDF, AND PRESSURE VELOCITY 10 FPS, SECTION 6 FPS. THE POOL PLAN SHALL SHOW THE DESIGN PLUMBING AS PER THE SAMPLE WITH THE INFORMATION REQUIRED SHOWN. MAIN DRAIN PIPING SHALL BE 1 1/2" DIA. SCH. 40 PVC, NSFDF, WITH APPROVED ANTI-SWASH A112.18-2009 COVERS, AS PLACED ON THE APPROVED DRAINS MAY BE PLACED ON THE APPROVED PLANES. THE TWO DRAINS SHALL HAVE A COMMON SUCTION LINE. SUCTION GRATES MAY BE USED IF APPROVED AT A MAXIMUM OF 1 1/2 FPS AND THE SUCTION PIPING IS RECESSED FROM THE GRATE THE DISTANCE EQUAL TO THE SUCTION PIPE LENGTH. SKIMMERS DO NOT REQUIRE PROTECTION AND SKIMMERS DO NOT REQUIRE LABEL MARKER TAPE AT THE FILTER LOCATION: PIPES, VALVES, PUMPS) OFF SWITCH.

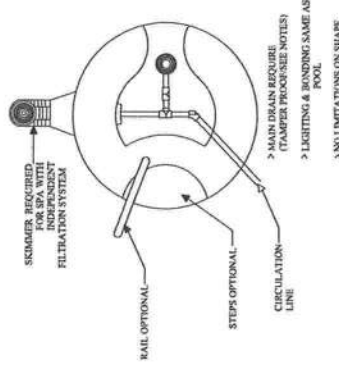

GENERAL SPA PLAN
N.T.S.

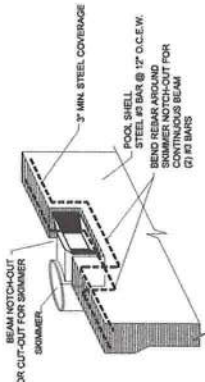

STEEL AT SKIMMER BEAM DETAIL
N.T.S.

DETERMINE SYSTEM FLOW RATE:
Minimum Flow Rate Required: 35gpm per skimmer (Required: 1 Skimmer per 800 sq ft)
Pool Volume: 500 gal ft x 4' ave depth x 7.481 gal/ft³ = 15,000 gallons
Turnover Time in Hours: 6 hours x 60 min/hr = 360 minutes
Flow Rate: 15,000 gallons / 360 minutes = 42 gpm

PIPE SIZING CHART (MAXIMUM)

PIPE SIZE	SECTION	PERMISSIBLE
1 1/2"	35 GPM	45 GPM
2"	60	105
2 1/2"	115	230
4"	255	596

FOR POOLS WITH VOLUME $\le 15,000$ GALS
PUMP: STARTS INSIDE OR HAYWARD SHIPPER
1/2 HP 42 GPM 66 TURB
TURN-OVER RATE = 6 HOURS - 560 MINS
FILTER: STABITE PFM 50, 50 GPM OR
MAIN HAND CSDI, 50 GPM CAPACITY
MAIN DRAIN: HAYWARD VEHICLE
CLEANER: HAYWARD VAC LOC
MAIN SUCTION PIPE SIZE: 2"
SKIMMER SUCTION PIPE SIZE: 2"
CLEANER/VAC PIPE SIZE: 1 1/2"
RETURN SUCTION PIPE SIZE: 1 1/2"

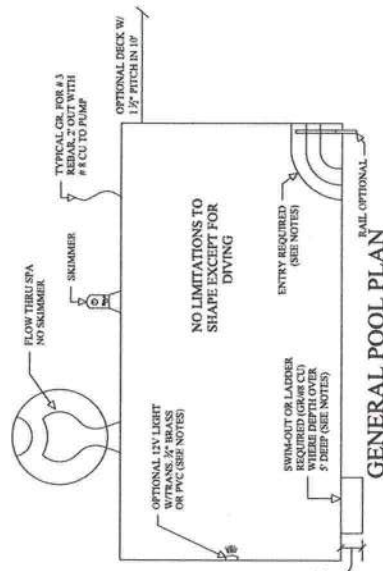

GENERAL POOL PLAN
N.T.S.

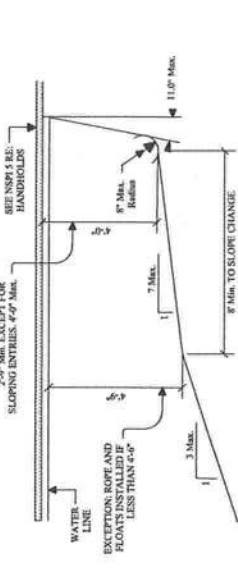

POOL SECTION DETAIL
N.T.S.

SEE 6-204-07
FOR BONDING AND GROUNDING SYSTEMS FOR SWIMMING POOLS, THE USE OF AN UNDERGROUND BONDING CONDUCTOR MADE OF 18 AWG. BARE SOLID COPPER WIRE BURIED TO A MINIMUM DEPTH OF 4 INCHES BELOW SUBGRADE, AND 18 TO 24 INCHES FROM INSIDE WALL OF A SWIMMING POOL OR SPA, IS DEEMED A PERMISSIBLE ALTERNATIVE OR EQUIVALENT TO COMPLIANCE WITH 1.680.2(6) OF THE NATIONAL ELECTRICAL CODE.

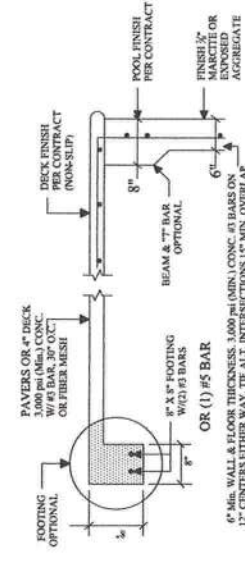

POOL/SPA, DECK, BEAM, WALL, FLOOR
N.T.S.

Structural subject to suitable soil conditions.

SPECIAL SPA REQUIREMENTS:

- MAXIMUM WATER DEPTH 4'; MAXIMUM SEAT DEPTH 24" MAX.
- FLOOR SLOPE 1:12
- SEAT: MIN. TREAD 10" X 12", 7" MIN. RISER, 12" MAX. RISER EXCEPT THE BOTTOM STEP MAY BE 14" IF IT IS BE UNIFORM. IF THE SPA IS OPERATED INTERMITTENTLY IT SHALL HAVE A ONE HOUR TURN-OVER PER HOUR TURN-OVER.
- MAXIMUM TEMPERATURE 104 DEGREES.
- MEET ANS/ASPI/ICC XVII, SAFETY.
- INSTRUMENTATION/SAFETY SIGNS.
- PRESSURE TEST PIPING AT 35 PSI FOR 15 MINUTES OR MEET LOCAL CODE IF GREATER.

GENERAL DESIGN REQUIREMENTS

- DESIGN, CONSTRUCTION AND WORKMANSHIP SHALL BE IN CONFORMITY WITH THE REQUIREMENTS OF APSP/ICC 3, APSP/ICC 4, APSP/ICC 5, AND APSP/ICC 6 AND APSP/ICC BASED ON THE REQUIREMENTS OF APSP/ICC 3, APSP/ICC 4, APSP/ICC 5, AND APSP/ICC 6.
- SEE NSP FOR DIVING WATER ENVELOPES.
- SLIDERS SHALL MEET THE MANUFACTURER'S INSTALLATION REQUIREMENTS.
- ALL POOLS WHETHER PUBLIC OR PRIVATE SHALL BE PROVIDED WITH A LADDER OR STEPS IN THE SHALLOW END WHERE THE WATER DEPTH EXCEEDS 24 INCHES (610 MM) THERE SHALL BE LADDERS STAIRS OR STEPS (1524 MM) THERE SHALL BE LADDERS STAIRS OR STEPS UNDER WATER BENCHES: SWIM-OUTS IN THE DEEP END, WHERE MANUFACTURED SWIM-OUTS IS TO BE USED, BENCHES OR SWIM-OUTS SHALL BE RECESSED OR LOCATED IN A CORNER.
- CIRCULATION SYSTEMS, COMPONENTS AND INSTALLATION SHALL COMPLY WITH NSF 90 AND NSF 99 AND THE MAXIMUM WATER PRESSURE SHALL NOT EXCEED 150 PSI. FILTERS SHALL HAVE AN AIR RELEASE AND PRESSURE GAGE.
- PUMPS 3 HP AND LESS SHALL MEET ANS/UL181 CORROSION RESISTANT WITH STRAINER AND MEET THE REQUIRED FLOW.
- ALL SKIMMERS SHALL MEET NSF 99 AND THERE SHALL BE A SCREEN FOR EVERY 800 SQUARE FEET OF SURFACE AREA.
- APPROVED MANUFACTURED INLET FITTINGS FOR THE RETURN OF RECIRCULATED POOL WATER SHALL BE PROVIDED ON THE BASIS OF AT LEAST ONE PER 300 SQUARE FEET (28 m2) OF SURFACE AREA. SUCH INLET SHALL BE AN ADEQUATE SEAL TO BE CONSTRUCTED TO INSURE AN ADEQUATE SEAL TO THE SUCTION LINE AND SHALL INCORPORATE A CONVENIENT MEANS OF SEALING FOR PRESSURE TESTING OF THE POOL.
- CIRCULATION PIPING, WHEN MORE THAN ONE INLET IS REQUIRED, THE SHORTEST DISTANCE BETWEEN ANY TWO REQUIRED INLETS SHALL BE AT LEAST 10 FEET (3048 MM). HOWEVER SHALL MEET ANS/21.56 OR UL 1261 WITH UL 551.
- DISINFECTANT EQUIPMENT SHALL COMPLY WITH NSF 50.
- PRESSURE TEST PIPING AT 35 PSI FOR 15 MINUTES OR MEET LOCAL CODE IF GREATER.
- RESIDENTIAL SWIMMING BARRIER REQUIREMENTS TO MEET SECTION 6901.17.
- WASTE DISPOSAL TO COMPLY WITH SECTION 454.2.10

R403.10 (MANDATORY)

POOLS & PERMANENT SPA ENERGY CONSUMPTION
- THE ENERGY CONSUMPTION OF POOLS AND PERMANENT SPAS SHALL BE IN ACCORDANCE WITH SECTIONS R403.10.1 THROUGH R403.10.5.

IT HAS BEEN CERTIFIED THAT THESE DESIGN REQUIREMENTS ARE IN COMPLIANCE WITH THE FLORIDA BUILDING CODE 7TH EDITION, R4501 ANS/ASPI/ICC 3, ANS/ASPI/ICC 4, ANS/ASPI/ICC 5, AND ANS/ASPI/ICC 6 AND ANS/ASPI/ICC 7, ANS/ASPI/ICC 14, ANS/ASPI/ICC 15.

COMPLIES WITH FLORIDA BUILDING CODE, 7TH EDITION (2020)

G.B. COLLINS ENGINEERING P.A.
CERTIFICATE OF AUTHORIZATION 27934
COPYRIGHT PROTECTED: VA 2-284-184, VA 2-278-832
32707 US HIGHWAY 19 N
PALM HARBOR, FL 34684
gb.collins@verizon.net
(727)442-8443

HARTZOG RESIDENTS
310 SW DEER RUN DR
FT WHITE FL 32038
Standard Residential Pool
and/or Spa Design



Samuel A
Liberatore
2022.10.28
14:15:55 -0400
SAMUEL A. LIBERATORE
OCTOBER 27