

REVISIONS	

SOFTPLAN
ARCHITECTURAL DESIGN SOFTWARE

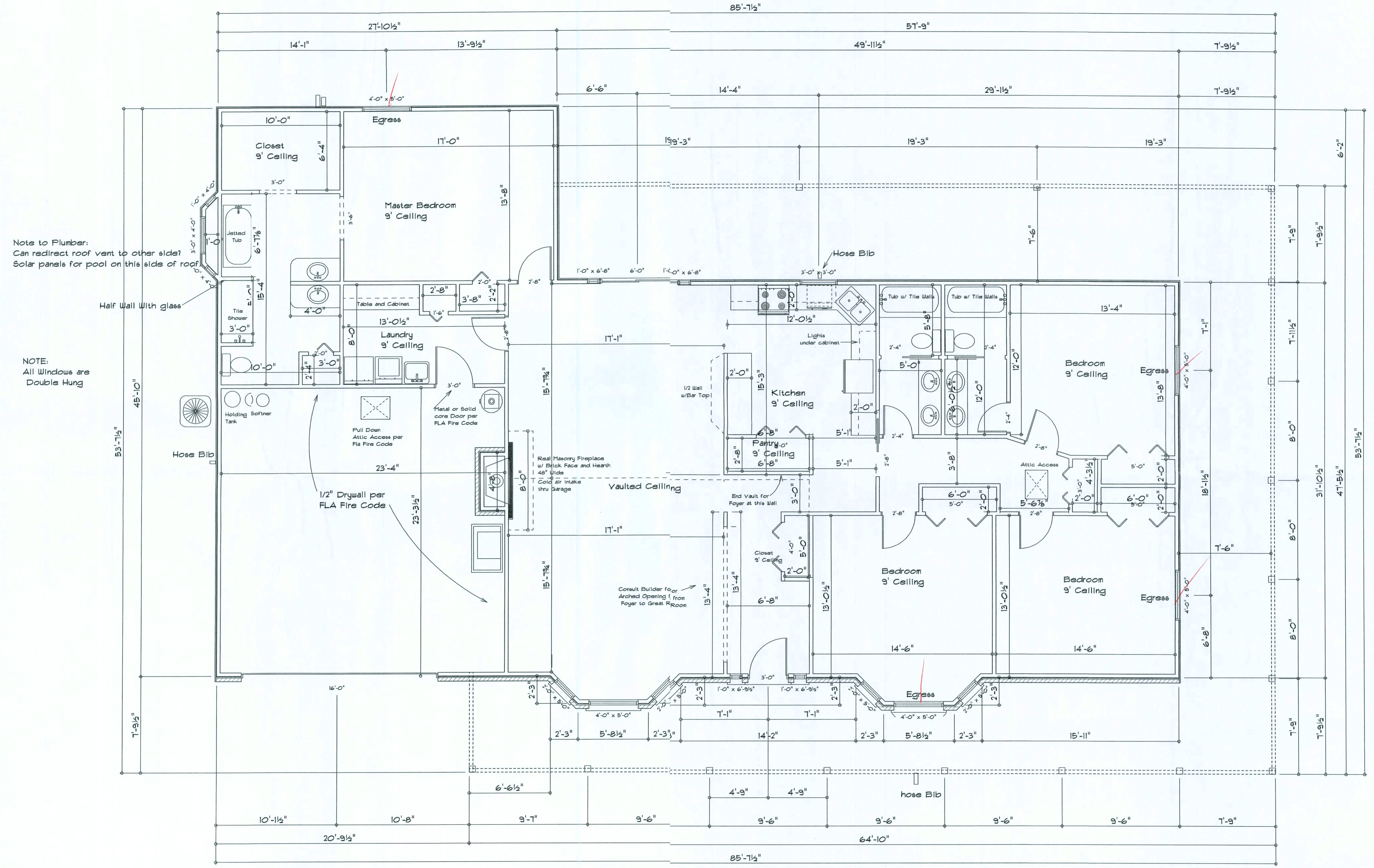

Note to Plumber:
Can redirect roof vent to other side?
Solar panels for pool on this side of roof

NOTE:
All Windows are
Double Hung

AREA SUMMERY

Living Area	2342 S.F.
Garage Area	564 S.F.
Porch Area	1168 S.F.
Total Area	4074 S.F.

RESIDENCE

Mortensen
250 SW Vargas
Ft. White, FL 32038

ADDRESS:
Columbia County, Florida

Woodman Park Builders, Inc.
Lake City, Florida
Phone: (386) 755 - 2411
Fax: (386) 755-8684
Email:

PRINTED DATE:

DRAWN BY: CHECKED BY:

DESIGNED BY:
Mark Hadcox

FILES DATE:

JOB NUMBER:

DRAWING NUMBER

A-1

REVISIONS		

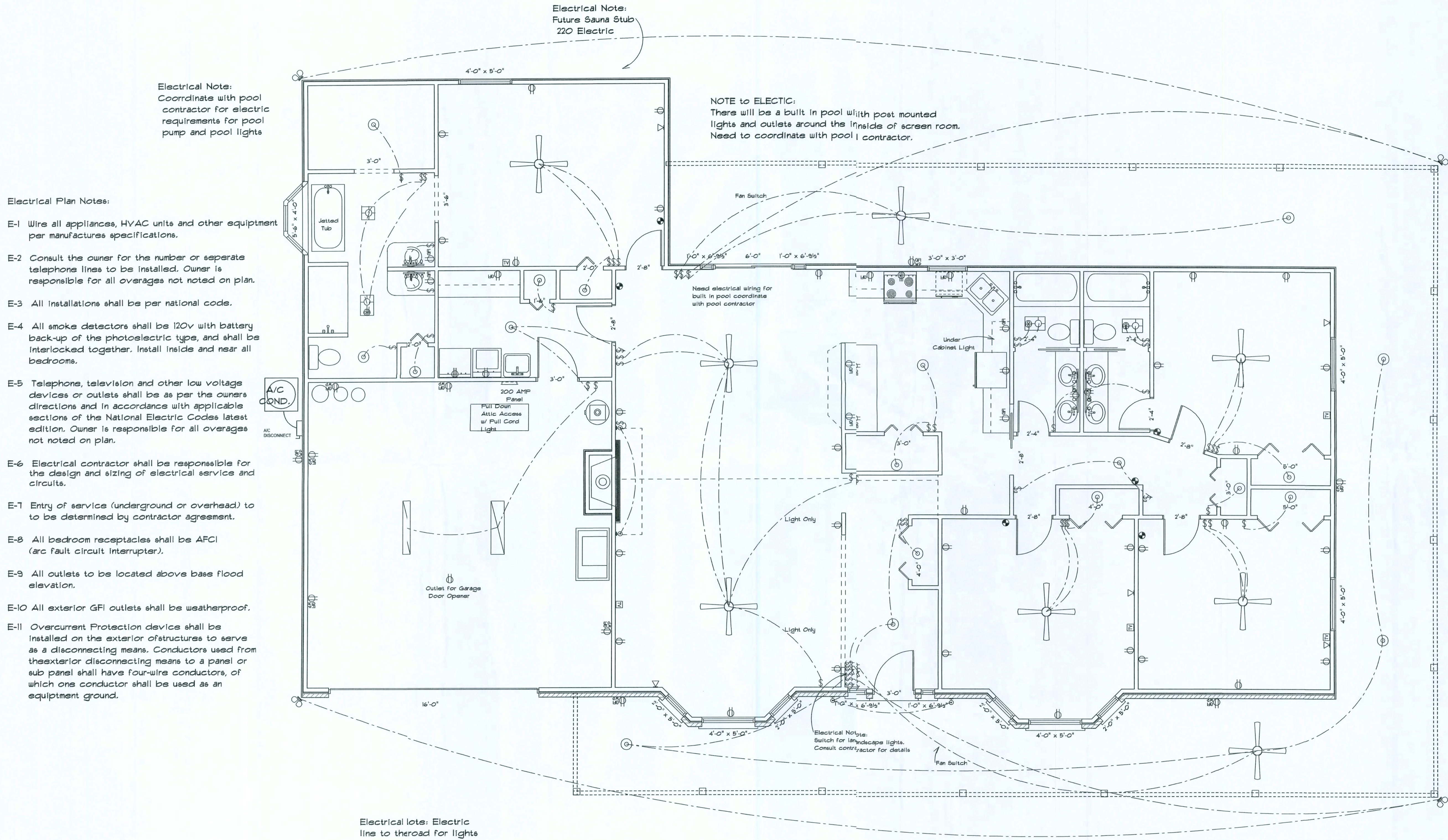

ELECTRICAL	SYMBOL
ceiling fan globe 1	
ceiling globe light	
double spotlight	
fluorescent fixture	
vanity bar light	
wall sconce	
electrical panel	
AC Disconnect	
Outlet WP GFI	
cable tv outlet	
fan	
light	
outlet	
outlet 220v	
outlet gfi	
smoke detector	
switch	
switch 3 way	
telephone	

RESIDENCE

ADDRESS:

Columbia County, Florida

Woodman Park Builders, Inc.

Late City, Florida

Phone (386) 755 - 2411

Fax:(386) 755-8684

Email:

PRINTED DATE:

DRAWN BY:

CHECKED BY:

DESIGNED BY:

FINALS DATE:

JCB NUMBER:

DRAWING NUMBER

Notes:

R-1 All roof pitches shall be 6/12 unless otherwise noted.

R-2 All overhangs shall be 24" except on eaves 18".

R-3 Provide attic ventilation in accordance with code requirements (1/300th insulated attic).

Chimneys shall extend at least 3 ft. above the highest point where they pass through the roof of this building and at least 2 ft. higher than any portion of the roof or building located within 10 ft. horizontally of any such chimney.

REVISIONS

SOFTPLAN
ARCHITECTURAL DESIGN SOFTWARE



Double Hung Windows

Front Elevation



Rear Elevation



Left Elevation



Right Elevation

RESIDENCE

Mortensen
50 SW Vargas
Ft. White, FL 32038

ADDRESS:
Columbia County, Florida

Woodman Park Builders, Inc.
Lake City, Florida
Phone: (386) 755 - 2411
Fax: (386) 755-8684
Email:

PRINTED DATE:

DRAWN BY: CHECKED BY:

DESIGNED BY:

Mark Haddock

FINAL DATE:

JOB NUMBER:

DRAWING NUMBER

A-3

REVISIONS	

SOFTPLAN
ARCHITECTURAL DESIGN SOFTWARE

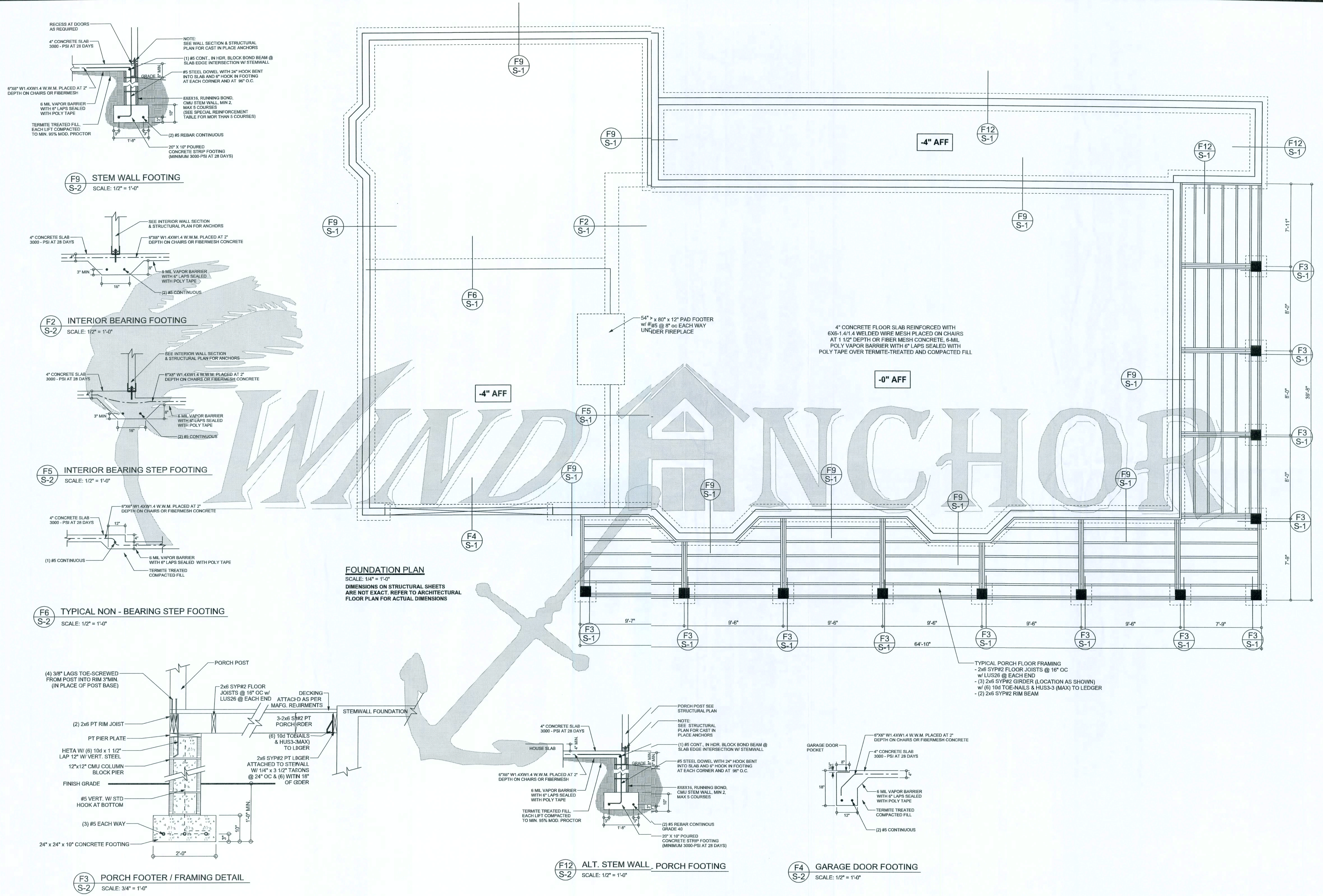

WINDLOAD ENGINEER: Mark Disoway, P.E. No. 53915, P.O. Box 868, Lake City, FL 32056, 386-754-5415

DIMENSIONS:
Stated dimensions supercede scaled dimensions. Refer all questions to Mark Disoway, P.E. for resolution. Do not proceed without clarification.

COPYRIGHTS AND PROPERTY RIGHTS:
Mark Disoway, P.E. hereby expressly reserves its control over copyright and property right in these instruments of service. This document is not to be reproduced, altered or copied in any form or manner without first the express written permission and consent of Mark Disoway.

CERTIFICATION: I hereby certify that I have examined this plan, and that the applicable portions of the plan, relating to wind engineering comply with section 1301.2.1, Florida building code residential 2004, to the best of my knowledge.

LIMITATION: This design is valid for one building, 4 specified locations.

MARK DISOWAY
P.E. 53915

Mark Disoway
27 Aug 07
SEAL

Woodman Park Builders

Mortensen Residence

ADDRESS:
250 SW Vargas
Ft. White, FL 32038

Mark Disoway P.E.
P.O. Box 868
Lake City, Florida 32056
Phone: (386) 754 - 5419
Fax: (386) 269 - 4871

PRINTED DATE:
August 27, 2007

DRAWN BY: STRUCTURAL BY:
Evan Beamsley

FINAS DATE:
Aug 17, 2007

JOB NUMBER:
708171a

DRAWING NUMBER
S-2
OF 3 SHEETS

REVISIONS

SOFTPLAN
ARCHITECTURAL DESIGN SOFTWARE

MSTA30, 10-106 (1700B)
(5) NAILS EACH SIDE OF STUD
(OR STRAP STUD TO HEADER 20-106)

LTT208, 10-164 (1750B)
1/2" ANCHOR w/ 6" EMBEDMENT U.N.O., SIMPSON
AT (MAY BE RECESSED BELOW FINISHED FLOOR)

**ALTERNATE WALL TIE CONNECTION WHERE
 THREADED ROD CANNOT BE PLACED IN WALL**
 SCALE: 1/2" = 1'-0"

**USE H2.5A (480lb) FOR ALL TRUSS TO WALL FRAME AND PORCH BEAM
 CONNECTIONS UNLESS NOTED OTHERWISE**

STRUCTURAL PLAN
 SCALE: 1/4" = 1'-0"



STRUCTURAL PLAN NOTES

- SN-1** ALL LOAD BEARING FRAME WALL & PORCH HEADERS
 SHALL BE A MINIMUM OF (2) 2X12 SYP#2 (U.N.O.)
- SN-2** ALL LOAD BEARING FRAME WALL HEADERS
 SHALL HAVE (1) JACK STUD & (1) KING STUD
 EACH SIDE (U.N.O.)
- SN-3** DIMENSIONS ON STRUCTURAL SHEETS
 ARE NOT EXACT. REFER TO ARCHITECTURAL
 FLOOR PLAN FOR ACTUAL DIMENSIONS
- SN-4** PERMANENT TRUSS BRACING IS TO BE INSTALLED AT
 LOCATIONS AS SHOWN ON THE SEALED TRUSS DRAWINGS.
 LATERAL BRACING IS TO BE RESTRAINED PER BCSI-03,
 BCSI-B1, BCSI-B2, & BCSI-B3. BCSI-B1, BCSI-B2, & BCSI-B3
 ARE FURNISHED BY THE TRUSS SUPPLIER, WITH THE SEALED
 TRUSS PACKAGE







WALL LEGEND

SWS = 0'	1ST FLOOR EXTERIOR WALL
SWS = 0'	2ND FLOOR EXTERIOR
IBW	1ST FLOOR INTERIOR BEARING WALLS SEE DETAILS ON SHEET S-1
IBW	2ND FLOOR INTERIOR BEARING WALLS SEE DETAILS ON SHEET S-1

THREADED ROD LEGEND

-  INDICATES LOCATION OF:
 1ST FLOOR 1/4" A307 ALL THREADED ROD
-  INDICATES LOCATION OF:
 2ND FLOOR 1/4" A307 ALL THREADED ROD

HEADER LEGEND

-  HEADER/BEAM CALL-OUT (U.N.O.)
-  NUMBER OF KING STUDS (FULL LENGTH)
-  NUMBER OF JACK STUDS (UNDER HEADER)
-  SPAN OF HEADER
-  SIZE OF HEADER MATERIAL
-  NUMBER OF PLYS IN HEADER

TOTAL SHEAR WALL SEGMENTS

SWS = 0.0' INDICATES SHEAR WALL SEGMENTS

	REQUIRED	ACTUAL
TRANSVERSE	23430 #	36537 #
LONGITUDINAL	12302 #	38894 #

CONNECTIONS, WALL, & HEADER DESIGN IS BASED
 ON REACTIONS & UPLIFTS FROM TRUSS ENGINEERING
 FURNISHED BY BUILDER. BUILDERS FIRST SOURCE
 JOB #L250868

WINDLOAD ENGINEER: Mark Dossway
 P.E. No. 63915, FCB 985, Lake City, FL
 32056, 386-754-5419

DIMENSIONS:
 Stated dimensions supersede scaled
 dimensions. Refer all questions to
 Mark Dossway, P.E. for resolution.
 Do not proceed without clarification.

COPYRIGHTS AND PROPERTY RIGHTS:
 Mark Dossway, P.E. hereby expressly reserves
 all common law copyrights and property right in
 these instruments of service. This document is
 not to be reproduced, altered or copied in any
 form or manner without first the express written
 permission and consent of Mark Dossway.

CERTIFICATION: I hereby certify that I have
 examined this plan, and that the applicable
 portions of the plan, relating to wind engineering
 comply with section R01.2.1, Florida building
 code (residential 2004) to the best of my
 knowledge.

LIMITATION: This design is valid for one
 building, at specified location.

MARK DOSSWAY
 P.E. 63915

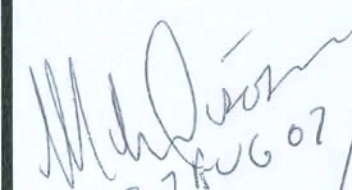
 27 AUG 07
 S.A.L.

Woodman Park Builders

Mortensen Residence

ADDRESS:
 250 SV Vargas
 Ft. White, FL 32038

Mark Dossway P.E.
 P.O. Box 868
 Lake City, Florida 32056
 Phone: (386) 754 - 5419
 Fax: (386) 269 - 4871

PRINTED DATE:
 August 7, 2007

DRAWN BY: STRUCTURAL BY:
 Evan Beamley

FINALS DATE:
 Aug 27, 2007

JOB NUMBER:
 708171a
 DRAWING NUMBER

S-3
 OF 3 SHEETS