

## Columbia County Property Appraiser

Jeff Hampton

Parcel: &lt;&lt; 15-4S-16-03000-231 (13718) &gt;&gt;

2024 Working Values

updated: 5/30/2024

## Owner &amp; Property Info

Result: 1 of 1

Owner	MCDONALD ROBERT G MCDONALD JUDITH B 113 SW BLACKPINE TER LAKE CITY, FL 32024		
Site	113 SW BLACKPINE TER, LAKE CITY		
Description*	LOT 1 BLOCK C FOREST COUNTRY 4TH ADDITION. ORB 861-1882, 972-449 & LIFE ESTATE 1214-1752		
Area	0.73 AC	S/T/R	15-4S-16
Use Code**	SINGLE FAMILY (0100)	Tax District	3

\*The Description above is not to be used as the Legal Description for this parcel in any legal transaction.

\*\*The Use Code is a FL Dept. of Revenue (DOR) code and is not maintained by the Property Appraiser's office. Please contact your city or county Planning and Zoning office for specific zoning information.

## Property &amp; Assessment Values

2023 Certified Values		2024 Working Values	
Mkt Land	\$28,000	Mkt Land	\$30,000
Ag Land	\$0	Ag Land	\$0
Building	\$220,739	Building	\$231,262
XFOB	\$7,560	XFOB	\$7,560
Just	\$256,299	Just	\$268,822
Class	\$0	Class	\$0
Appraised	\$256,299	Appraised	\$268,822
SOH Cap [?]	\$70,014	SOH Cap [?]	\$76,948
Assessed	\$186,285	Assessed	\$191,874
Exempt	HX HB \$50,000	Exempt	HX HB \$50,000
Total Taxable	county:\$136,285 city:\$0 other:\$0 school:\$161,285	Total Taxable	county:\$141,874 city:\$0 other:\$0 school:\$166,874

## Sales History

Sale Date	Sale Price	Book/Page	Deed	V/I	Qualification (Codes)	RCode
5/13/2011	\$1,000	1214/1752	LE	I	U	30
1/10/2003	\$22,900	0972/0449	WD	V	Q	
6/30/1998	\$20,000	0861/1882	WD	V	Q	

## Building Characteristics

Bldg Sketch	Description*	Year Blt	Base SF	Actual SF	Bldg Value
Sketch	SINGLE FAM (0100)	2003	1972	3096	\$231,262

\*Bldg Desc determinations are used by the Property Appraisers office solely for the purpose of determining a property's Just Value for ad valorem tax purposes and should not be used for any other purpose.

## Extra Features &amp; Out Buildings

Code	Desc	Year Blt	Value	Units	Dims
0186	CONC,PAVMT	2003	\$4,000.00	2000.00	0 x 0
0252	LEAN-TO W/O FLOOR	2007	\$200.00	1.00	0 x 0
0294	SHED WOOD/VINYL	2007	\$3,360.00	240.00	12 x 20

## Land Breakdown

Code	Desc	Units	Adjustments	Eff Rate	Land Value
0100	SFR (MKT)	1.000 LT (0.730 AC)	1.0000/1.0000 1.0000/ /	\$30,000 /LT	\$30,000

Search Result: 1 of 1

Aerial Viewer Pictometry Google Maps

© 2023 © 2022 © 2019 © 2016 © 2013 Sales

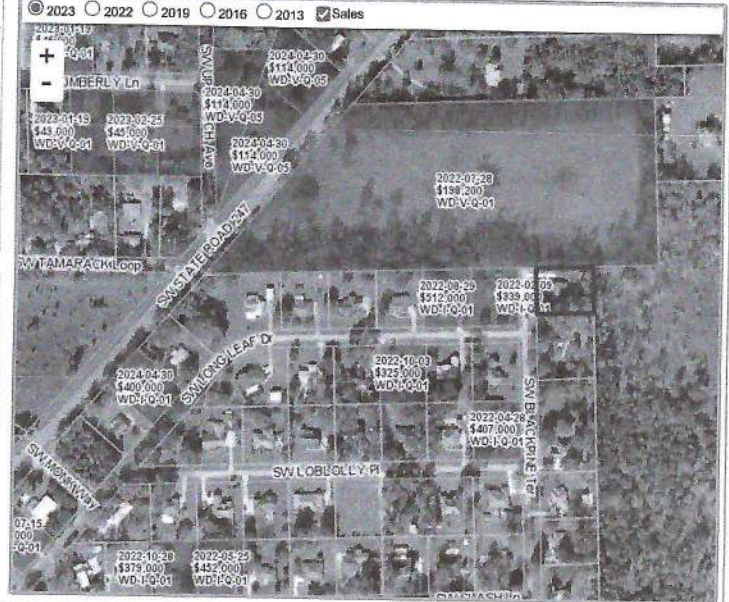

© Columbia County Property Appraiser | Jeff Hampton | Lake City, Florida | 386-758-1083

by: GrizzlyLogic.com

The information presented on this website was derived from data which was compiled by the Columbia County Property Appraiser Office solely for the governmental purpose of property assessment. This information should not be relied upon by anyone as a determination of the ownership of property or market value. No warranties, expressed or implied, are provided for the accuracy of the data herein, its use, or its interpretation. This website was last updated: 6/30/2024 and may not reflect the data currently on file at our office.