

Legend

SectionTownshipAndRange

2018 Flood Zones

0.2 PCT ANNUAL CHANCE

A

AE

AH

SRWMD Wetlands

SRWMD Wetlands

Roads

Roads

others

Dirt

Interstate

Main

Other

Paved

Private

Parcels

DevZones1

others

A-1

A-2

A-3

CG

CHI

CI

CN

CSV

ESA-2

I

ILW

MUD-1

PRD

PRRD

RMF-1

RMF-2

RO

RR

RSF-1

RSF-2

RSF-3

RSF/MH-1

RSF/MH-2

RSF/MH-3

DEFAULT

2018Aerials

LidarElevations

X

Columbia County, FLA - Building & Zoning Property Map

6

Printed: Mon Aug 31 2020 10:52:54 GMT-0400 (Eastern Daylight Time)

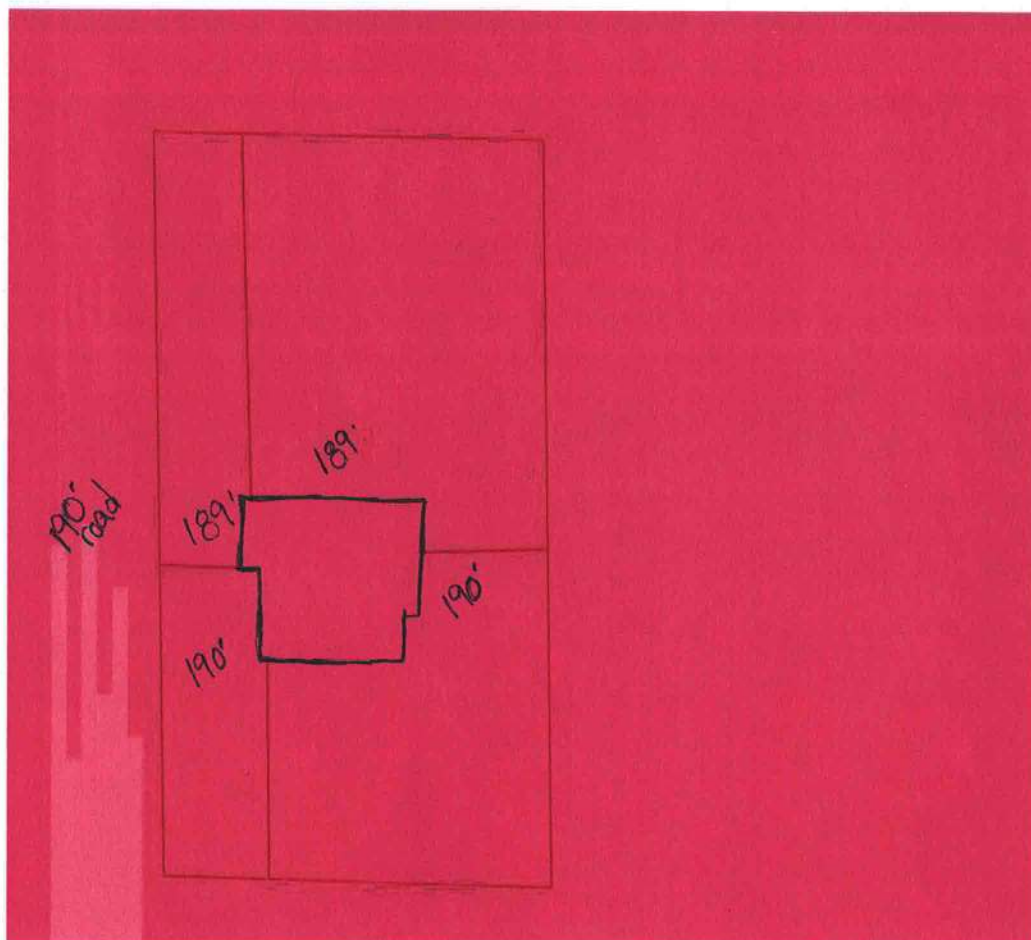

Parcel Information

Parcel No: 30-3S-17-05842-102

Owner: GOEL SONEY &

Subdivision: SUNSET MEADOWS & ADDITION

Lot: 2

Acres: 0.5030599

Deed Acres:

District: District 1 Ronald Williams

Future Land Uses: Residential - Low

Flood Zones:

Official Zoning Atlas: RSF/MH-2

All data, information, and maps are provided "as is" without warranty or any representation of accuracy, timeliness of completeness. Columbia County, FL makes no warranties, express or implied, as to the use of the information obtained here. There are no implied warranties of merchantability or fitness for a particular purpose. The requester acknowledges and accepts all limitations, including the fact that the data, information, and maps are dynamic and in a constant state of maintenance, and update.