

Legend

DUDA



Water Lines

Others

CANAL / DITCH

CREEK

STREAM / RIVER

Roads

Roads

others

Dirt

Interstate

Main

Other

Paved

Private

LidarElevations



Columbia County, FLA - Building & Zoning Property Map

Printed: Wed Sep 02 2020 14:28:35 GMT-0400 (Eastern Daylight Time)

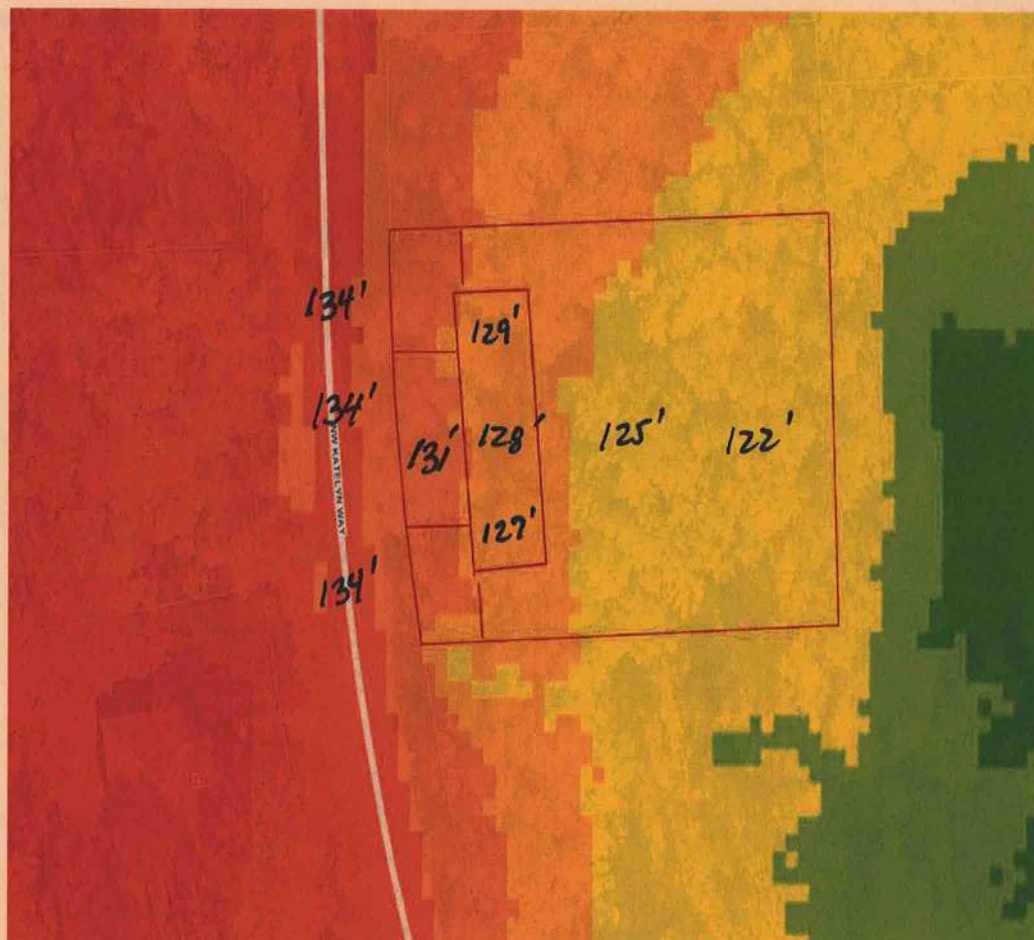

Parcel Information

Parcel No: 28-3S-16-02377-128

Owner: WARD HENRY MATTOX III &

Subdivision: MAGNOLIA HILLS

Lot: 28

Acres: 0.505537868

Deed Acres:

District: District 3 Bucky Nash

Future Land Uses: Residential - Low

Flood Zones:

Official Zoning Atlas: RSF/MH-2

All data, information, and maps are provided "as is" without warranty or any representation of accuracy, timeliness of completeness. Columbia County, FL makes no warranties, express or implied, as to the use of the information obtained here. There are no implied warranties of merchantability or fitness for a particular purpose. The requester acknowledges and accepts all limitations, including the fact that the data, information, and maps are dynamic and in a constant state of maintenance, and update.