



STATE OF FLORIDA
DEPARTMENT OF HEALTH
ONSITE SEWAGE TREATMENT AND DISPOSAL
SYSTEM

APPLICATION FOR CONSTRUCTION PERMIT

CR # 10-5790

PERMIT NO. 14-0043
DATE PAID: 1/28/14
FEE PAID: 388.88
RECEIPT #: 1132259

APPLICATION FOR:

☒ New System ☐ Existing System ☐ Holding Tank ☐ Innovative
☐ Repair ☐ Abandonment ☐ Temporary ☐

APPLICANT: JOSEPH WOOD / STEPHANIE HALL

AGENT: WENDY GRENNELL

TELEPHONE: (386) 288-2428

MAILING ADDRESS: 3104 SW OLD WIRE RD.

FT. WHITE

FL 32038

TO BE COMPLETED BY APPLICANT OR APPLICANT'S AUTHORIZED AGENT. SYSTEMS MUST BE CONSTRUCTED BY A PERSON LICENSED PURSUANT TO 489.105(3)(m) OR 489.552, FLORIDA STATUTES. IT IS THE APPLICANT'S RESPONSIBILITY TO PROVIDE DOCUMENTATION OF THE DATE THE LOT WAS CREATED OR PLATTED (MM/DD/YY) IF REQUESTING CONSIDERATION OF STATUTORY GRANDFATHER PROVISIONS.

PROPERTY INFORMATION

LOT: 2 BLOCK: N/A SUBDIVISION: WEST LAKE CITY HILLS ADD. 2 PLATTED: _____

PROPERTY ID #: 27-3S-16-02345-022 P/O ZONING: RES I/M OR EQUIVALENT: ☐ NO ☐

PROPERTY SIZE: 0.500 ACRES WATER SUPPLY: ☒ PRIVATE PUBLIC ☐ ≤ 2000 GPD ☐ > 2000 GPD

IS SEWER AVAILABLE AS PER 381.0065, FS? ☐ NO ☐ DISTANCE TO SEWER: N/A FT

PROPERTY ADDRESS: 133 NW WILTON WAY Lake City FL 32055

DIRECTIONS TO PROPERTY: 90 WEST PAST I-75 TURN RIGHT ON LAKE CITY AVE. TURN RIGHT ON AMANDA ST. TURN LEFT ON NW WILTON WAY 2ED LOT ON RIGHT.

BUILDING INFORMATION ☒ RESIDENTIAL ☐ COMMERCIAL

Unit No.	Type of Establishment	No. of Bedrooms	Building Area Sqft	Commercial/Institutional System Design Table 1, Chapter 64E-6, FAC
1	<u>MOBILE HOME</u>	<u>3</u>	<u>1,568</u>	
2				
3				
4				

☐ Floor/Equipment Drains ☐ Other (Specify) _____

SIGNATURE: Wendy Grennell

DATE: 1/24/14

Application for Onsite Sewage Disposal System
Construction Permit. Part II Site Plan

Permit Application Number: 14-0043 6

ALL CHANGES MUST BE APPROVED BY THE COUNTY HEALTH UNIT

CR# 10-5790

TBM IN
POWER
POLE
ACROSS
RD.

VACANT

NORTH

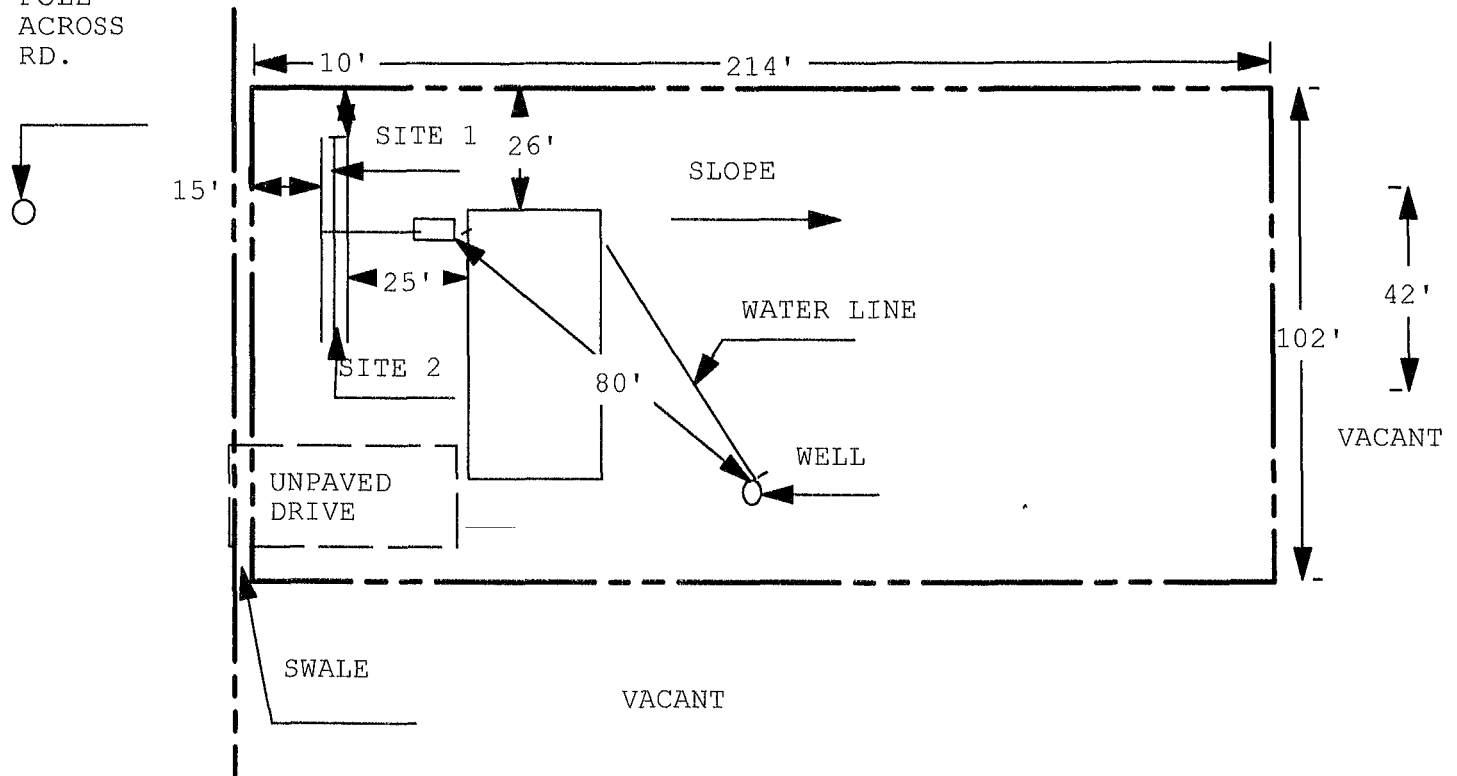

1 inch = 40 feet

Site Plan Submitted By Paul D. Ray Date 1/23/14
Plan Approved ☒ Not Approved ☐ Date 1/31/14

By [Signature] Celina CPHU

Notes: [Signature]