

As required by Florida Statute 553.842 and Florida Administrative Code 9B-72, please provide the information and approval numbers on the building components listed below if they will be utilized on the construction project for which you are applying for a building permit. We recommend you contact your local product supplier should you not know the product approval number for any of the applicable listed products. Statewide approved products are listed online @ www.floridabuilding.org

Category/Subcategory	Manufacturer	Product Description	Approval Number(s)
1. EXTERIOR DOORS			
A. SWINGING	Jeld-Wen	Entry Door	13541.6
B. SLIDING			
C. SECTIONAL/ROLL UP			
D. OTHER			
2. WINDOWS			
A. SINGLE/DOUBLE HUNG			
B. HORIZONTAL SLIDER			
C. CASEMENT			
D. FIXED	Pella	Fixed Window	33453.1
E. MULLION			
F. SKYLIGHTS			
G. OTHER			
3. PANEL WALL			
A. SIDING			
B. SOFFITS			
C. STOREFRONTS			
D. GLASS BLOCK			
E. OTHER			
4. ROOFING PRODUCTS			
A. ASPHALT SHINGLES			
B. NON-STRUCTURAL METAL			
C. ROOFING TILES			
D. SINGLE PLY ROOF			
E. OTHER			
5. STRUCTURAL COMPONENTS			
A. WOOD CONNECTORS			
B. WOOD ANCHORS			
C. TRUSS PLATES			
D. INSULATION FORMS			
E. LINTELS			
F. OTHERS			
6. NEW EXTERIOR			
ENVELOPE PRODUCTS			

The products listed below did not demonstrate product approval at plan review. I understand that at the time of inspection of these products, the following information must be available to the inspector on the jobsite; 1) copy of the product approval, 2) performance characteristics which the product was tested and certified to comply with, 3) copy of the applicable manufacturers installation requirements.

Further, I understand these products may have to be removed if approval cannot be demonstrated during inspection.



Contractor OR Agent Signature

7/29/2025

Date

NOTES: _____

FLORIDA DEPARTMENT OF
Business & Professional Regulation



[DBPR HOME](#) | [ABOUT DBPR](#) | [DBPR DIVISIONS](#) | [CONTACT DBPR](#)

[BCIS Home](#) | [Log In](#) | [User Registration](#) | [Hot Topics](#) | [Submit Surcharge](#) | [Stats & Facts](#) | [Publications](#) | [Contact Us](#) | [BCIS Site Map](#) | [Links](#) | [Search](#)



Product Approval
USER: Public User

[Product Approval Menu](#) > [Product or Application Search](#) > **Application List**

► OFFICE OF THE
SECRETARY

Search Criteria

[Refine Search](#)

Code Version	2023	FL#	33453.1
Application Type	ALL	Product Manufacturer	ALL
Category	ALL	Subcategory	ALL
Application Status	ALL	Compliance Method	ALL
Quality Assurance Entity	ALL	Quality Assurance Entity Contract Expired	ALL
Product Model, Number or Name	ALL	Product Description	ALL
Approved for use in HVHZ	ALL	Approved for use outside HVHZ	ALL
Impact Resistant	ALL	Design Pressure	ALL
Other	ALL		

Search Results - Applications

FL#	Type	Manufacturer	Validated By	Status
FL33453-R1 History	Revision	Pella Corporation FL#: FL33453.1 Model: FX-515 Description: FX-515 Vinyl Fin/Flange Picture Window, Non-Impact Category: Windows Subcategory: Fixed	Steven M. Urich, PE (717) 317-8454	Approved

*Approved by DBPR. Approvals by DBPR shall be reviewed and ratified by the POC and/or the Commission if necessary.

[Contact Us](#) :: [2601 Blair Stone Road, Tallahassee FL 32399](#) Phone: 850-487-1824

The State of Florida is an AA/EEO employer. [Copyright 2007-2013 State of Florida](#). :: [Privacy Statement](#) :: [Accessibility Statement](#) :: [Refund Statement](#)

Under Florida law, email addresses are public records. If you do not want your e-mail address released in response to a public-records request, do not send electronic mail to this entity. Instead, contact the office by phone or by traditional mail. If you have any questions, please contact 850.487.1395. *Pursuant to Section 455.275(1), Florida Statutes, effective October 1, 2012, licensees licensed under Chapter 455, F.S. must provide the Department with an email address if they have one. The emails provided may be used for official communication with the licensee. However email addresses are public record. If you do not wish to supply a personal address, please provide the Department with an email address which can be made available to the public. To determine if you are a licensee under Chapter 455, F.S., please click [here](#).

Product Approval Accepts:



PICTURE WINDOW - NON-IMPACT

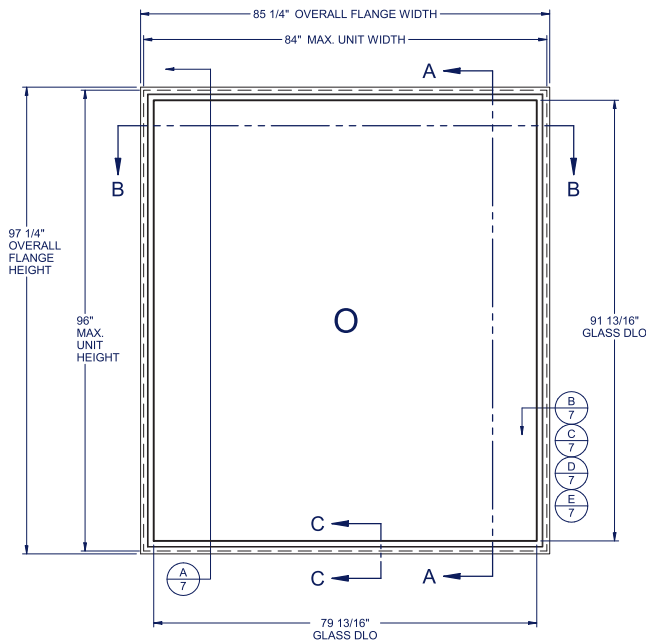

TABLE OF CONTENTS

GENERAL NOTES & ELEVATIONS.....	1
ARCHITECTURAL SHAPES.....	2
GLAZING DETAILS.....	3
SECTION VIEWS.....	4
DP CHART, BOM & EXTRUSIONS.....	5
ANCHOR SCHEDULE & NOTES.....	6
INSTALLATION DETAILS.....	7

MAX. UNIT SIZE	DESIGN PRESSURE RATING	IMPACT RATING
84" x 96"	SEE COMPARATIVE ANALYSIS CHART, SHEET 5	NONE

GENERAL NOTES:

1. THE PRODUCT SHOWN HEREIN IS DESIGNED AND MANUFACTURED TO COMPLY WITH THE FLORIDA BUILDING CODE (FBC), CURRENT EDITION.
2. GLAZING OPTIONS: (SEE SHEET 3)
3. CONFIGURATIONS: "O". ARCHITECTURAL SHAPES INCLUDE, BUT ARE NOT LIMITED TO, THOSE SHOWN ON SHEET 2.
4. DESIGN PRESSURE RATING (SEE SHEET 5):
-NEGATIVE DESIGN LOADS BASED ON, TESTED PRESSURE AND GLASS TABLES ASTM E-1300-04e01/09.
-POSITIVE DESIGN LOADS BASED ON, TESTED PRESSURE, WATER INFILTRATION TEST PRESSURE AND GLASS TABLES ASTM E-1300-04e01/09.
5. ANCHORAGE: THE 33 1/3% STRESS INCREASE HAS NOT BEEN USED IN THE DESIGN OF THIS PRODUCT. SEE SHEET 7 FOR ANCHOR DETAILS. WINDLOAD DURATION FACTOR Cd=1.6 WAS USED FOR WOOD ANCHOR CALCULATIONS.
6. NOT APPROVED FOR IMPACT RESISTANCE. IMPACT PROTECTIVE SYSTEM IS REQUIRED IN WIND BORNE DEBRIS REGION.
7. ALL FRAMES FULLY WELDED.
8. SERIES / MODEL DESIGNATION PW-8150.
9. THE DESIGNATION X AND O STAND FOR THE FOLLOWING:
O = FIXED SASH
10. SECTION CALLOUTS APPLY TO ALL ELEVATIONS IN A SIMILAR LOCATION.
11. PICTURE WINDOWS CAN BE INSTALLED IN ANY ORIENTATION

Lucas Turner
2023.08.16
15:12:15
-05'00'



515 PVC FIXED WINDOW NON-IMPACT

PROPRIETARY AND CONFIDENTIAL
THE INFORMATION CONTAINED IN THIS DRAWING IS THE SOLE PROPERTY OF CUSTOM WINDOW SYSTEMS, INC. ANY REPRODUCTION IN PART OR AS A WHOLE WITHOUT THE WRITTEN PERMISSION OF CUSTOM WINDOW SYSTEMS, INC IS PROHIBITED.

FLORIDA APPROVAL NO.:

33453



8/15/2023

LUCAS A. TURNER, P.E.
FL PE # 58201
Turner Engineering & Consulting, Inc.
2428 Old Natchez Trc Trl
Camden, TN 38320
PH. 941-380-1574

SHEET DESCRIPTION:

GENERAL NOTES AND ELEVATIONS

DRAWN BY:	DATE:
MCS	8/9/2023
DWG #:	REV.:
PEL-234	A
SCALE:	SHEET
1:20	1 OF 7

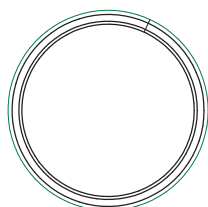

FULL CIRCLE



FULL ELLIPSE (OVAL)

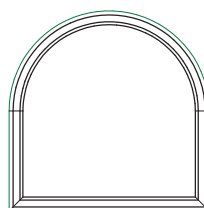

TOMBSTONE

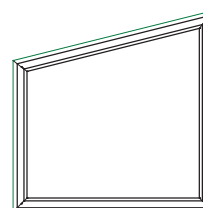

TRAPEZOID

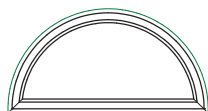

1/2 CIRCLE

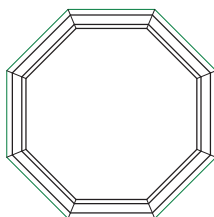

OCTAGON

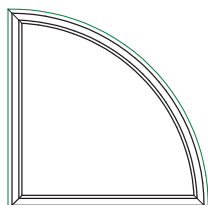

1/4 CIRCLE

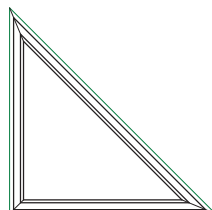

TRIANGLE

NOTES:

1. SEE SHEET 6 FOR DETAILED ANCHOR INSTALLATION REQUIREMENTS.
2. THRU FRAME - MASONRY, WOOD OR METAL OPENING.
THRU FIN - WOOD OPENING.
3. OVERALL SIZE MUST NOT EXCEED THE MAX. WIDTH AND HEIGHT OF RECTANGULAR WINDOWS ON SHEET 1.
4. ANCHOR SPACING FOR ARCHITECTURAL FLANGE AND FIN WINDOWS MUST FOLLOW THE LAYOUTS SHOWN ON SHEET 6. WITH ANCHOR SPACING MEASURED ALONG THE LENGTH OF THE PRODUCT.



**515 PVC
FIXED WINDOW
NON-IMPACT**

PROPRIETARY AND CONFIDENTIAL
THE INFORMATION CONTAINED IN
THIS DRAWING IS THE SOLE
PROPERTY OF CUSTOM WINDOW
SYSTEMS, INC. ANY
REPRODUCTION IN PART OR AS A
WHOLE WITHOUT THE WRITTEN
PERMISSION OF CUSTOM WINDOW
SYSTEMS, INC IS PROHIBITED.

FLORIDA APPROVAL NO.:
33453



8/15/2023

LUCAS A. TURNER, P.E.
FL PE # 58201
Turner Engineering &
Consulting, Inc.
2428 Old Natchez Trc Trl
Camden, TN 38320
PH. 941-380-1574

SHEET DESCRIPTION:

**ARCHITECTURAL
SHAPES**

DRAWN BY:	DATE:
MCS	8/9/2023
DWG #:	REV.:
PEL-234	A
SCALE:	SHEET
1:20	2 OF 7

**515 PVC
FIXED WINDOW
NON-IMPACT**

PROPRIETARY AND CONFIDENTIAL
THE INFORMATION CONTAINED IN
THIS DRAWING IS THE SOLE
PROPERTY OF CUSTOM WINDOW
SYSTEMS, INC. ANY
REPRODUCTION IN PART OR AS A
WHOLE WITHOUT THE WRITTEN
PERMISSION OF CUSTOM WINDOW
SYSTEMS, INC IS PROHIBITED.

FLORIDA APPROVAL NO.:

33453



8/15/2023

LUCAS A. TURNER, P.E.
FL PE # 58201
Turner Engineering &
Consulting, Inc.
2428 Old Natchez Trc Trl
Camden, TN 38320
PH. 941-380-1574

SHEET DESCRIPTION:

GLAZING DETAIL

DRAWN BY:	DATE:
MCS	8/9/2023
DWG #:	REV.:
PEL-234	A
SCALE:	SHEET
1:2	3 OF 7

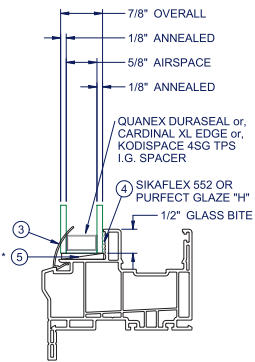

GLASS TYPE A

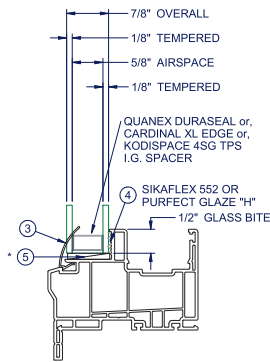

GLASS TYPE B

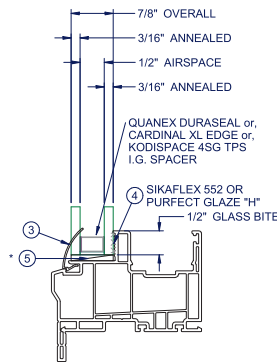

GLASS TYPE C

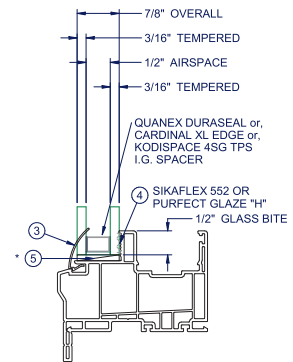

GLASS TYPE D

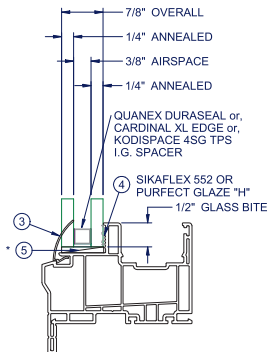

GLASS TYPE E

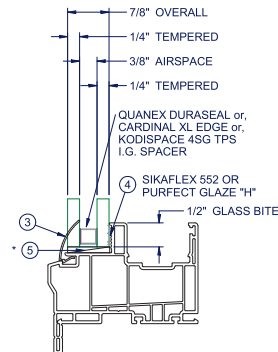

GLASS TYPE F

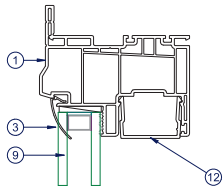

INTERIOR

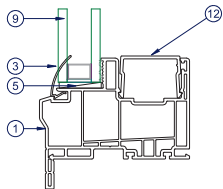

SECTION VIEW A-A

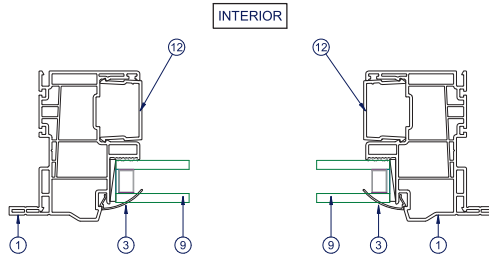

SECTION VIEW B-B

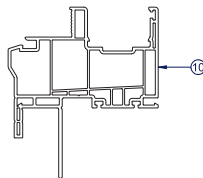

SECTION VIEW C-C
FIN/FLANGE FRAME

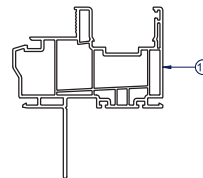

SECTION VIEW C-C
FIN ONLY FRAME



515 PVC FIXED WINDOW NON-IMPACT

PROPRIETARY AND CONFIDENTIAL
THE INFORMATION CONTAINED IN
THIS DRAWING IS THE SOLE
PROPERTY OF CUSTOM WINDOW
SYSTEMS, INC. ANY
REPRODUCTION IN PART OR AS A
WHOLE WITHOUT THE WRITTEN
PERMISSION OF CUSTOM WINDOW
SYSTEMS, INC IS PROHIBITED.

FLORIDA APPROVAL NO.:
33453

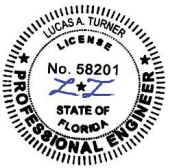

8/15/2023

LUCAS A. TURNER, P.E.
FL PE # 58201
Turner Engineering &
Consulting, Inc.
2428 Old Natchez Trc Trl
Camden, TN 38320
PH. 941-380-1574

SHEET DESCRIPTION:

SECTION VIEWS

DRAWN BY:	DATE:
MCS	8/9/2023
DWG #:	REV.:
PEL-234	A
SCALE:	SHEET
1:2	4 OF 7

"O" CONFIG. ANNEALED GLASS DESIGN PRESSURES, PSF (POSITIVE AND NEGATIVE PRESSURES ARE EQUAL)													
	GLASS TYPE	WINDOW LONG DIMENSION, UNIT SIZE (IN.)											
		18	24	30	36	42	48	54	60	66	72	78	84
WINDOW SHORT DIMENSION, UNIT SIZE (IN.)	18	A	60.0	60.0	60.0	60.0	60.0	60.0	60.0	60.0	60.0	60.0	60.0
		C	60.0	60.0	60.0	60.0	60.0	60.0	60.0	60.0	60.0	60.0	60.0
		E	60.0	60.0	60.0	60.0	60.0	60.0	60.0	60.0	60.0	60.0	60.0
	24	A	60.0	60.0	60.0	60.0	60.0	60.0	56.7	51.1	46.6	43.6	41.6
		C	60.0	60.0	60.0	60.0	60.0	60.0	60.0	60.0	60.0	60.0	60.0
		E	60.0	60.0	60.0	60.0	60.0	60.0	60.0	60.0	60.0	60.0	60.0
	30	A	60.0	60.0	60.0	60.0	60.0	60.0	57.8	50.4	44.3		
		C	60.0	60.0	60.0	60.0	60.0	60.0	60.0	60.0	60.0	60.0	60.0
		E	60.0	60.0	60.0	60.0	60.0	60.0	60.0	60.0	60.0	60.0	60.0
	36	A	60.0	60.0	60.0	60.0	60.0	60.0	54.7	49.7	45.2		
		C	60.0	60.0	60.0	60.0	60.0	60.0	60.0	60.0	60.0	60.0	60.0
		E	60.0	60.0	60.0	60.0	60.0	60.0	60.0	60.0	60.0	60.0	60.0
	42	A	60.0	60.0	60.0	60.0	60.0	59.8	53.1	48.4	44.6	41.6	
		C	60.0	60.0	60.0	60.0	60.0	60.0	60.0	60.0	60.0	60.0	60.0
		E	60.0	60.0	60.0	60.0	60.0	60.0	60.0	60.0	60.0	60.0	60.0
	48	A	60.0	60.0	60.0	60.0	59.8	52.7	46.6	43.0			
		C	60.0	60.0	60.0	60.0	60.0	60.0	60.0	60.0	60.0	58.9	54.2
		E	60.0	60.0	60.0	60.0	60.0	60.0	60.0	60.0	60.0	60.0	60.0
	54	A	60.0	60.0	60.0	60.0	60.0	53.1	46.6	42.1			
		C	60.0	60.0	60.0	60.0	60.0	60.0	60.0	60.0	60.0	55.6	51.8
		E	60.0	60.0	60.0	60.0	60.0	60.0	60.0	60.0	60.0	60.0	60.0
	60	A	60.0	56.7	57.8	54.7	48.4	43.0					
		C	60.0	60.0	60.0	60.0	60.0	60.0	60.0	60.0	55.4	51.5	48.1
		E	60.0	60.0	60.0	60.0	60.0	60.0	60.0	60.0	60.0	56.0	50.4
	66	A	60.0	51.1	50.4	49.7	44.6						
		C	60.0	60.0	60.0	60.0	60.0	60.0	60.0	55.3	51.3	47.2	44.6
		E	60.0	60.0	60.0	60.0	60.0	60.0	60.0	60.0	60.0	60.0	53.9
	72	A	60.0	46.6	44.3	45.2	41.6						
		C	60.0	60.0	60.0	60.0	60.0	60.0	55.4	51.3	47.3	43.9	41.2
		E	60.0	60.0	60.0	60.0	60.0	60.0	60.0	54.4	54.4	52.5	46.7
	78	A	60.0	43.6									
		C	60.0	60.0	60.0	60.0	60.0	58.9	55.6	51.5	47.2	43.9	41.0
		E	60.0	60.0	60.0	60.0	60.0	60.0	60.0	60.0	54.4	46.4	45.6
	84	A	60.0	41.6									
		C	60.0	60.0	60.0	60.0	60.0	54.9	54.2	54.2	51.8	48.1	44.6
		E	60.0	60.0	60.0	60.0	60.0	58.9	56.0	53.9	52.5	46.4	40.0

"O" CONFIG. TEMPERED DESIGN PRESSURES, PSF (POSITIVE AND NEGATIVE PRESSURES ARE EQUAL)													
	GLASS TYPE	WINDOW LONG DIMENSION, UNIT SIZE (IN.)											
		36	42	48	54	60	66	72	78	84	90	96	
WINDOW SHORT DIMENSION, UNIT SIZE (IN.)	36	B	60.0	60.0	60.0	60.0	60.0	60.0	60.0	60.0	60.0	60.0	
		D, F	60.0	60.0	60.0	60.0	60.0	60.0	60.0	60.0	60.0	60.0	
	42	B	60.0	60.0	60.0	60.0	60.0	60.0	60.0	60.0	60.0	57.6	
		D, F	60.0	60.0	60.0	60.0	60.0	60.0	60.0	60.0	60.0	57.6	
	48	B	60.0	60.0	60.0	60.0	60.0	60.0	60.0	60.0	57.3	52.5	
		D, F	60.0	60.0	60.0	60.0	60.0	60.0	60.0	60.0	57.3	52.5	
	54	B	60.0	60.0	60.0	60.0	60.0	60.0	60.0	58.9	53.3	48.7	
		D, F	60.0	60.0	60.0	60.0	60.0	60.0	60.0	58.9	53.3	48.7	
	60	B	60.0	60.0	60.0	60.0	60.0	60.0	60.0	56.0	50.4	45.8	
		D, F	60.0	60.0	60.0	60.0	60.0	60.0	60.0	56.0	50.4	45.8	
	66	B	60.0	60.0	60.0	60.0	60.0	60.0	60.0	53.9	48.2	43.6	
		D, F	60.0	60.0	60.0	60.0	60.0	60.0	60.0	53.9	48.2	43.6	
	72	B	60.0	60.0	60.0	60.0	60.0	60.0	54.4	54.4	52.5	46.7	42.0
		D, F	60.0	60.0	60.0	60.0	60.0	60.0	54.4	54.4	52.5	46.7	42.0
	78	B	60.0	60.0	60.0	60.0	60.0	60.0	54.4	46.4	46.4	45.6	40.8
		D, F	60.0	60.0	60.0	60.0	60.0	60.0	54.4	46.4	46.4	45.6	40.8
	84	B	60.0	60.0	60.0	58.9	56.0	53.9	52.5	46.4			
		D, F	60.0	60.0	60.0	58.9	56.0	53.9	52.5	46.4	40.0	40.0	40.0

NOTES:
1. IF SIZE INTENDED IS NOT SHOWN, USE NEXT LARGER SIZE.
2. IF SIZE IS SHADED, IT IS NOT AVAILABLE WITH THAT GLASS TYPE.

PARTS LIST			
ITEM	PART #	DESCRIPTION	MATERIAL
1	H-6222	FRAME W/FLANGE -SH	PVC
3	S-6237	GLAZING BEAD, FIXED (7/8" OA IG)	PVC
4	P-3438	PURFECT GLAZE "H" OR SIKAFLEX 552	
5	P-5612	Setting Block, .12 x 1 x 2	Rubber
7	P-5579	NFRC LABEL, BLANK, 4 X 8 LABEL	
8	P-5304	LABEL, 9X9 CWS LOGO LABEL	
9		Glass, Fixed (See Sheet 7)	
10	H-6231	FRAME W/FIN & FLANGE	PVC
12	H-6025	SASH STOP	PVC

LINE ITEMS NOT USED:
2, 6, 11

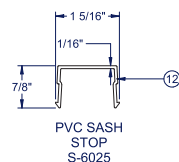
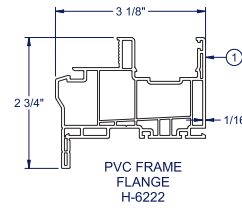
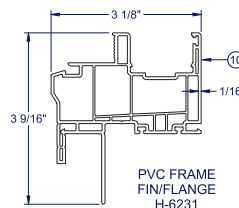

515 PVC FIXED WINDOW NON-IMPACT

PROPRIETARY AND CONFIDENTIAL
THE INFORMATION CONTAINED IN THIS DRAWING IS THE SOLE PROPERTY OF CUSTOM WINDOW SYSTEMS, INC. ANY REPRODUCTION IN PART OR AS A WHOLE WITHOUT THE WRITTEN PERMISSION OF CUSTOM WINDOW SYSTEMS, INC IS PROHIBITED.

FLORIDA APPROVAL NO.:

33453



8/15/2023

LUCAS A. TURNER, P.E.
FL PE # 58201
Turner Engineering & Consulting, Inc.
2428 Old Natchez Trc Trl
Camden, TN 38320
PH. 941-380-1574

SHEET DESCRIPTION:

DP CHART, BOM AND EXTRUSIONS

DRAWN BY:	MCS	DATE:	8/9/2023
DWG #:	PEL-234	REV.:	A
SCALE:	1:2	SHEET	5 OF 7

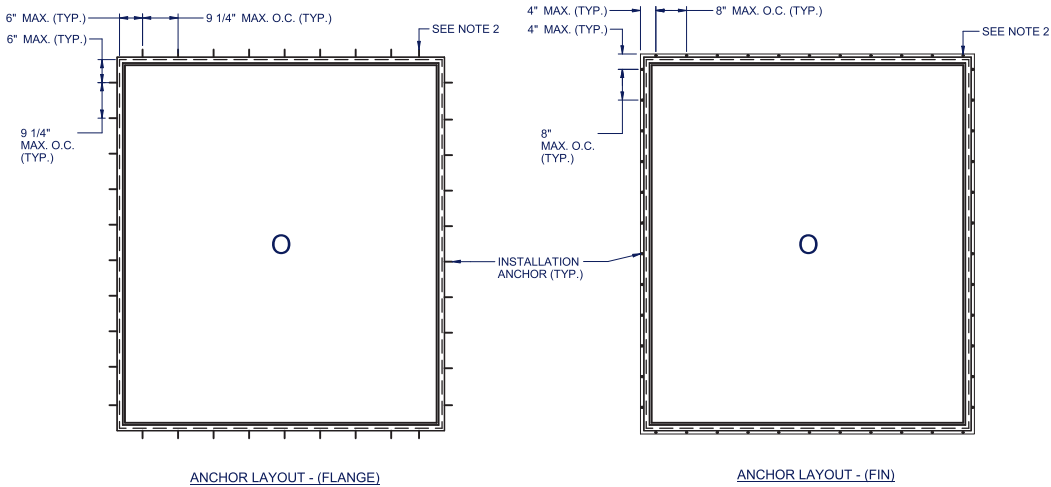

NOTES:

1. INSTALL ONE ANCHOR AT EACH INSTALLATION LOCATION. ANCHOR SPACING APPLIES TO ALL SHAPES (SEE SHEET 2) ALONG ALL FRAME EDGES. SILL ANCHOR SPACING SAME AS HEAD.
2. SHIM AS REQ AT EACH INSTALLATION ANCHOR USING LOAD BEARING SHIMS. MAX. ALLOWABLE SHIM STACK TO BE 1/4". USE SHIMS WHERE SPACE GREATER THAN 1/16" IS PRESENT. LOAD BEARING SHIMS SHALL BE CONSTRUCTED OF HIGH DENSITY PLASTIC OR BETTER. WOOD SHIMS ARE NOT ALLOWED.
3. ANCHOR TYPE, SIZE, SPACING AND EMBEDMENT SHALL BE AS SPECIFIED IN THESE DRAWINGS, SEE TABLE 1, SHEET 7.
4. ALL INSTALLATION ANCHORS MUST BE MADE OF OR PROTECTED WITH A CORROSION RESISTANT MATERIAL OR COATING. DISSIMILAR METALS OR MATERIALS IN CONTACT WITH PRESSURE TREATED WOOD MUST BE PROTECTED TO PREVENT REACTION.
5. INSTALLATION ANCHORS SHALL BE IN ACCORDANCE WITH ANCHOR MANUFACTURER'S INSTALLATION INSTRUCTIONS, AND ANCHORS SHALL NOT BE USED IN SUBSTRATES WITH STRENGTHS LESS THAN THE MINIMUM SPECIFIED IN TABLE 1, SHEET 7.
6. ANCHOR EMBEDMENT TO SUBSTRATE SHALL BE BEYOND WALL DRESSING OR STUCCO. FOR CONCRETE/CMU OPENINGS, EMBEDMENT SHALL BE BEYOND WOOD BUCKS, IF USED, INTO SUBSTRATE - 1X BUCKS ARE OPTIONAL.
7. A MINIMUM CENTER-TO-CENTER SPACING SHALL BE MAINTAINED BETWEEN ALL FASTENERS: 3" FOR MASONRY, 1" FOR WOOD AND METAL.
8. WOOD OR MASONRY OPENINGS, BUCKS AND BUCK FASTENERS SHALL BE PROPERLY DESIGNED BY THE ARCHITECT OR ENGINEER OF RECORD AND INSTALLED TO TRANSFER WIND LOADS TO THE STRUCTURE. SUBSTRATES SHALL MEET THE MINIMUM STRENGTH REQUIREMENTS AS SHOWN IN TABLE1, SHEET 7. CONCRETE AND MASONRY SUBSTRATES MAY NOT BE CRACKED.
9. SEALING AND FLASHING STRATEGIES FOR OVERALL WATER RESISTANCE OF INSTALLATION SHALL BE DONE BY OTHERS FOLLOWING THE CURRENT VERSION OF THE REFERENCE DOCUMENTS:
FMA/AAMA 100(FIN WINDOWS), FMA/AAMA 200(FLANGE WINDOWS), FMA/WDMA 250(BOX WINDOWS), FMA/AAMA/WDMA 300(EXTERIOR DOORS)



**515 PVC
FIXED WINDOW
NON-IMPACT**

PROPRIETARY AND CONFIDENTIAL
THE INFORMATION CONTAINED IN
THIS DRAWING IS THE SOLE
PROPERTY OF CUSTOM WINDOW
SYSTEMS, INC. ANY
REPRODUCTION IN PART OR AS A
WHOLE WITHOUT THE WRITTEN
PERMISSION OF CUSTOM WINDOW
SYSTEMS, INC IS PROHIBITED.

FLORIDA APPROVAL NO.:
33453



8/15/2023

LUCAS A. TURNER, P.E.
FL PE # 58201
Turner Engineering &
Consulting, Inc.
2428 Old Natchez Trc Trl
Camden, TN 38320
PH. 941-380-1574

SHEET DESCRIPTION:
**ANCHOR SCHEDULE AND
NOTES**

DRAWN BY:	DATE:
MCS	8/9/2023
DWG #:	REV.:
PEL-234	A
SCALE:	SHEET
1:25	6 OF 7

**515 PVC
FIXED WINDOW
NON-IMPACT**

PROPRIETARY AND CONFIDENTIAL
THE INFORMATION CONTAINED IN
THIS DRAWING IS THE SOLE
PROPERTY OF CUSTOM WINDOW
SYSTEMS, INC. ANY
REPRODUCTION IN PART OR AS A
WHOLE WITHOUT THE WRITTEN
PERMISSION OF CUSTOM WINDOW
SYSTEMS, INC IS PROHIBITED.

FLORIDA APPROVAL NO.:
33453

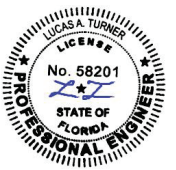

8/15/2023

LUCAS A. TURNER, P.E.
FL PE # 58201
Turner Engineering &
Consulting, Inc.
2428 Old Natchez Trc Trl
Camden, TN 38320
PH. 941-380-1574

SHEET DESCRIPTION:

INSTALLATION DETAILS

DRAWN BY:	MCS	DATE:	8/9/2023
DWG #:	PEL-234	REV.:	A
SCALE:	1:2	SHEET	7 OF 7

TYPICAL HEAD ANCHORAGE

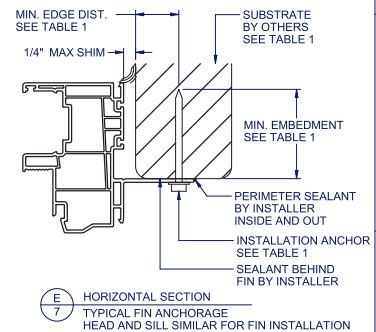
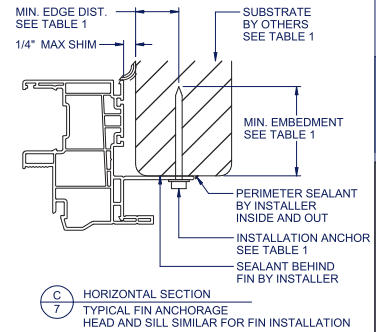
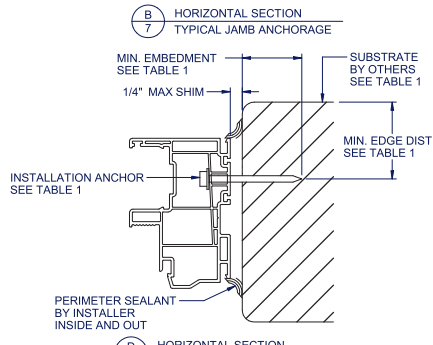
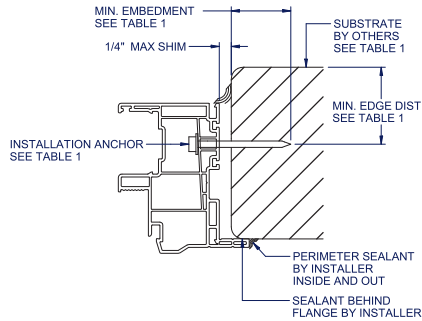
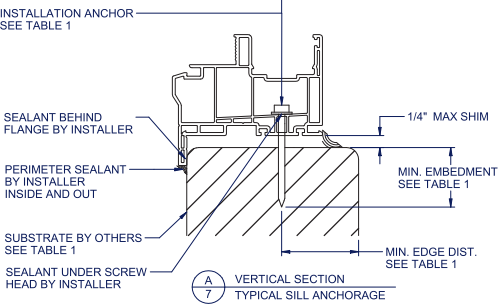
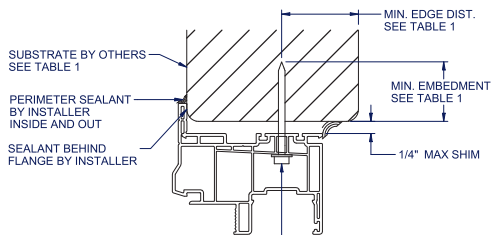

TABLE 1: APPROVED INSTALLATION FASTENERS

FRAME TYPE	SUBSTRATE TYPE	ANCHOR TYPE	MIN. EMBEDMENT	MIN. EDGE DIST.
FLANGE	CONCRETE (2.0 KSI MIN.)	3/16" ITW TAPCON	1-1/2"	1-1/8"
FLANGE	HOLLOW OR GROUT-FILLED CMU (117 PCF MIN.)	3/16" ITW TAPCON	1"	2"
FLANGE	CONCRETE (3.05 KSI MIN.)	3/16" DEWALT ULTRAACON+	1-3/4"	1"
FLANGE	HOLLOW OR GROUT-FILLED CMU (ASTM C-90)	3/16" DEWALT ULTRAACON+	1-1/4"	2-1/2"
FLANGE	2X MIN. SOUTHERN PINE (G=0.55)	3/16" ITW TAPCON OR DEWALT ULTRAACON+	1-3/8"	7/8"
FLANGE	2X MIN. SOUTHERN PINE (G=0.55)	#10 WOOD SCREW	1-3/8"	7/8"
FLANGE	16 GAUGE (0.060") MIN. STEEL STUD (33 KSI YIELD MIN)	#10-16 HILTI KWIK-FLEX OR ITW TEKS SELF-DRILLING SCREW	FULL THREAD THRU 0.060"	7/16"
FLANGE	1/8" ALUM. (6063-T5 MIN.) OR 1/8" STEEL (33 KSI MIN.)	#10 GRADE 5 SELF-TAPPING / DRILLING SCREW	FULL THREAD THRU 0.125"	7/16"
FIN	2X MIN. SOUTHERN PINE (G=0.55)	#8 WOOD SCREW	1-1/2"	7/16"

FLANGE REMOVAL NOTE: PARTIALLY OR FULLY REMOVING THE FLANGE, UP TO AND INCLUDING A BOX-FRAME APPLICATION IS ACCEPTABLE PROVIDED:

- MIN. 1/4" FILLET OF CONSTRUCTION-GRADE ADHESIVE CAULK IS APPLIED INSIDE AND OUT, FULL PERIMETER, BY INSTALLER.
- PRODUCT ANCHORAGE IS IN ACCORDANCE WITH REQUIREMENTS AS SHOWN FOR FLANGE WINDOWS.

FLORIDA DEPARTMENT OF
Business & Professional Regulation



[DBPR HOME](#) | [ABOUT DBPR](#) | [DBPR DIVISIONS](#) | [CONTACT DBPR](#)

[BCIS Home](#) | [Log In](#) | [User Registration](#) | [Hot Topics](#) | [Submit Surcharge](#) | [Stats & Facts](#) | [Publications](#) | [Contact Us](#) | [BCIS Site Map](#) | [Links](#) | [Search](#)



Product Approval
USER: Public User

[Product Approval Menu](#) > [Product or Application Search](#) > **Application List**

OFFICE OF THE
SECRETARY

Search Criteria

[Refine Search](#)

Code Version	2023	FL#	13541.6
Application Type	ALL	Product Manufacturer	ALL
Category	ALL	Subcategory	ALL
Application Status	ALL	Compliance Method	ALL
Quality Assurance Entity	ALL	Quality Assurance Entity Contract Expired	ALL
Product Model, Number or Name	ALL	Product Description	ALL
Approved for use in HVHZ	ALL	Approved for use outside HVHZ	ALL
Impact Resistant	ALL	Design Pressure	ALL
Other	ALL		

Search Results - Applications

FL#	Type	Manufacturer	Validated By	Status
FL13541-R19 History	Affirmation	Jeld-Wen FL#: FL13541.6 Model: F. Design Pro / Smooth Pro Fiberglass Description: Single with side lite(s) (X,O/ O,X/ O,X,O) Glazed Fiberglass Door, 9'-0" x 6'-8" and 9'-0" x 8'-0", Inswing and Outswing Category: Exterior Doors Subcategory: Swinging Exterior Door Assemblies	National Accreditation & Management Institute (804) 684-5124	Approved

*Approved by DBPR. Approvals by DBPR shall be reviewed and ratified by the POC and/or the Commission if necessary.

[Contact Us](#) :: [2601 Blair Stone Road, Tallahassee FL 32399](#) Phone: 850-487-1824

The State of Florida is an AA/EEO employer. [Copyright 2007-2013 State of Florida](#). :: [Privacy Statement](#) :: [Accessibility Statement](#) :: [Refund Statement](#)

Under Florida law, email addresses are public records. If you do not want your e-mail address released in response to a public-records request, do not send electronic mail to this entity. Instead, contact the office by phone or by traditional mail. If you have any questions, please contact 850.487.1395. *Pursuant to Section 455.275(1), Florida Statutes, effective October 1, 2012, licensees licensed under Chapter 455, F.S. must provide the Department with an email address if they have one. The emails provided may be used for official communication with the licensee. However email addresses are public record. If you do not wish to supply a personal address, please provide the Department with an email address which can be made available to the public. To determine if you are a licensee under Chapter 455, F.S., please click [here](#).

Product Approval Accepts:



JELD-WEN®

WINDOWS & DOORS

DESIGN PRO / SMOOTH PRO FULL LITE

NON-IMPACT

FOR USE OUTSIDE THE HIGH VELOCITY HURRICANE ZONE (HVHZ)

GENERAL NOTES:

1. THE PRODUCT SHOWN HEREIN IS DESIGNED AND MANUFACTURED TO COMPLY WITH THE CURRENT INTERNATIONAL BUILDING CODE (IBC), INTERNATIONAL RESIDENTIAL CODE (IRC), AND FLORIDA BUILDING CODE (FBC), EXCLUDING HVHZ AND HAS BEEN EVALUATED ACCORDING TO THE FOLLOWING:
 - ASTM E330-02
 - ASTM E288-04
 - AAMA 1304-02
2. ADEQUACY OF THE EXISTING STRUCTURAL CONCRETE/MASONRY OR 2X FRAMING AS A MAIN WIND FORCE RESISTING SYSTEM CAPABLE OF WITHSTANDING AND TRANSFERRING APPLIED PRODUCT LOADS TO THE FOUNDATION IS THE RESPONSIBILITY OF THE ENGINEER OR ARCHITECT OF RECORD FOR THE PROJECT OF INSTALLATION.
3. THE INSTALLATION DETAILS DESCRIBED HEREIN ARE GENERIC AND MAY NOT REFLECT ACTUAL CONDITIONS FOR A SPECIFIC SITE. IF SITE CONDITIONS CAUSE INSTALLATION TO DEVIATE FROM THE REQUIREMENTS DETAILED HEREIN, A LICENSED ENGINEER OR ARCHITECT SHALL PREPARE SITE SPECIFIC DOCUMENTS FOR USE WITH THIS DOCUMENT.
4. APPROVED IMPACT PROTECTIVE SYSTEM **IS REQUIRED** ON THIS PRODUCT IN AREAS REQUIRING IMPACT RESISTANCE.
5. GLASS MEETS THE REQUIREMENTS OF ASTM E 1300 GLASS CHARTS. SEE SHEET 4 FOR GLAZING DETAILS.
6. FIXED FULL LITE APPROVAL COVERS USE OF FRACTIONAL GLAZING, INCLUDING INTERNAL GRID, BLINDS BETWEEN GLASS, DECO, AND EXTERNAL AND INTERNAL WROUGHT IRON. RADIUS (SHAPE) LITES ARE QUALIFIED FOR 6'-8" DOORS AT DP +/-50 PSF ONLY.
7. 6-PANEL DOOR SHOWN FOR ILLUSTRATION PURPOSES. ADDITIONAL PANEL CONFIGURATIONS AND FLUSH DOORS ARE QUALIFIED.
8. NOTE: OPERATING AFCO H-497 SILL MEETS WATER INFILTRATION AT WATER TEST PRESSURE (WTP) OF 9.75 PSF. FIXED SIDEITE MEETS WATER INFILTRATION AT WTP OF 7.5 PSF. REMAINING SILLS NOT RATED FOR WATER INFILTRATION. IF AUTHORITY HAVING JURISDICTION REQUIRES THAT PRODUCT MEETS THIS REQUIREMENT, PRODUCT SHALL BE USED WHEN INSTALLED AT LOCATION PROTECTED BY OVERHANG SUCH THAT OVERHANG (OH) RATIO = OH LENGTH ÷ OH HEIGHT IS ≥ 1.0

TABLE OF CONTENTS

SHEET	REVISION	SHEET DESCRIPTION
1	A	TYPICAL ELEVATIONS, DESIGN PRESSURES, AND GENERAL NOTES
2	A	TYPICAL ELEVATIONS
3	A	TYPICAL ANCHOR LAYOUTS AND NOTES
4	A	QUALIFIED CONFIGURATIONS & GLAZING DETAIL
5	-	OPTIONAL 2X BUCK ANCHORING DETAILS
6	A	VERTICAL ASSEMBLIES
7	A	HORIZONTAL ASSEMBLIES
8	A	WOOD SUBSTRATES
9	A	CONCRETE SUBSTRATES
10	A	COMPONENTS & BILL OF MATERIALS

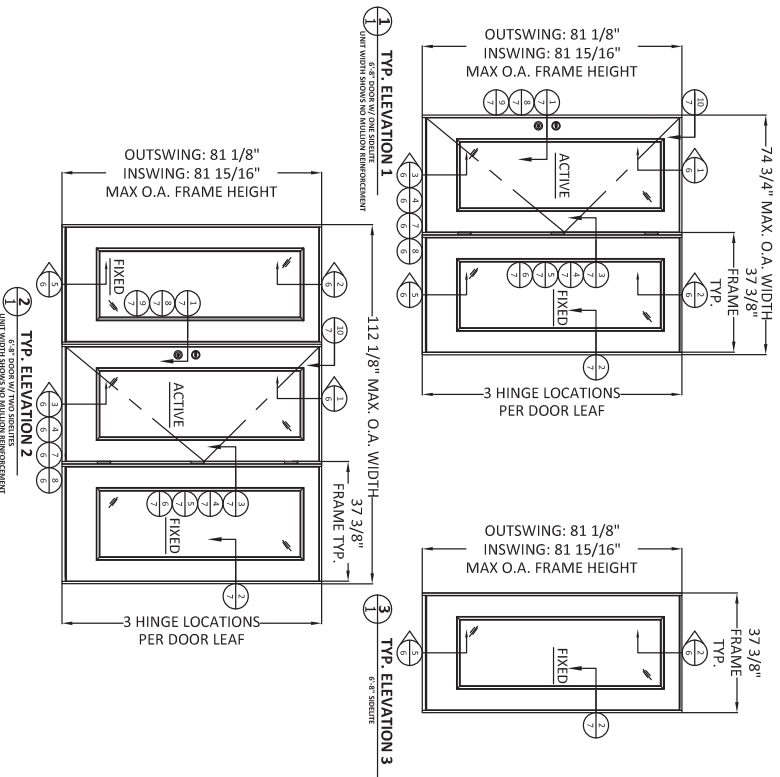

- NOTES:
1. ALL DOORS SHOWN IN CONFIGURATIONS ON THIS SHEET MAY BE LEFT HAND OR RIGHT HAND OPERATING DOORS.
 2. SIDEITE MAY BE USED IN LIEU OF DOOR IN CONFIGURATIONS SHOWN ABOVE AS LONG AS O.A. DIMENSIONS ARE NOT SURPASSED.

CONFIGURATION	MAX. OVERALL NOMINAL SIZE	DESIGN PRESSURE (PSF)								MISSILE IMPACT RATING	
		FINGER-JOINTED PINE				ALL OTHER MATERIALS					
		WIDTH	HEIGHT	INSWING	OUTSWING	INSWING	OUTSWING	INSWING	OUTSWING		
0	3'-0"	6'-8"	POS.	NEG.	POS.	NEG.	POS.	NEG.	POS.	NEG.	NON-IMPACT
O.X.O	9'-0"	6'-8"	50*	55	50*	55	50*	50	50*	50	NON-IMPACT
O.X.O VENT LITE	9'-0"	6'-8"	50*	55	50*	55	50*	50	50*	50	NON-IMPACT
O.X.O RADIUS	9'-0"	6'-8"	50*	55	50*	55	50*	50	50*	50	NON-IMPACT
0	3'-0"	8'-0"	45*	45	45*	45	45*	45	45*	45	NON-IMPACT
O.X.O	9'-0"	8'-0"	45*	45	45*	45	45*	45	45*	45	NON-IMPACT
X.O	6'-0"	6'-8"	50*	55	50*	55	50*	50	50*	50	NON-IMPACT
X.O VENT LITE	6'-0"	6'-8"	50*	55	50*	55	50*	50	50*	50	NON-IMPACT
X.O RADIUS	6'-0"	6'-8"	50*	50	50*	50	50*	50	50*	50	NON-IMPACT
X.O	6'-0"	8'-0"	45*	45	45*	45	45*	45	45*	45	NON-IMPACT

*SEE GENERAL NOTE 7, SHEET 1, FOR WATER INFILTRATION APPROVED SILLS.

PREPARED BY:



BUILDING DROPS, INC.

398 E. DANIA BEACH BLVD., STE. 138
DANIA BEACH, FL 33017
PH: (954)596-8278
FAX: (954)744-4728
WEB: www.buildingdrops.com

3737 LAKEPORT BLVD.,
KLAMATH FALLS, OR 97601
PH: (541)882-3451
FAX: (541)850-2609

JELD-WEN
WINDOWS & DOORS

TITLE: DESIGN PRO/SMOOTH PRO FULL LITE
NON-IMPACT
TYPICAL ELEVATIONS, DESIGN
PRESSURES, AND GENERAL NOTES

REMARKS BY DATE

Add Add sill, Multi-Point Lock GL 06/23/14
& Radius Lite

Reference DWG: HAD008354 AM 09/04/15

THE INSTALLATION DETAILS DESCRIBED HEREIN ARE GENERIC AND MAY NOT REFLECT ACTUAL CONDITIONS FOR A SPECIFIC PROJECT. THE USER SHALL BE RESPONSIBLE FOR OBTAINING ALL NECESSARY PERMITS AND APPROVALS FROM THE JURISDICTION HAVING AUTHORITY TO ENFORCE THE REQUIREMENTS DETAILED HEREIN. A LICENSED ENGINEER OR ARCHITECT SHALL PREPARE SITE SPECIFIC DOCUMENTS FOR USE WITH THIS DOCUMENT.

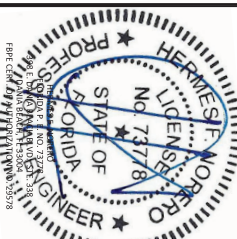

Digitally signed by Thomas F. Norero
Reason: I am approving this document
Date: 2019.10.01 19:07:00 -04'00'

DATE: 02.05.14

DWG. BY: GL/TJM
GL/TJM SS/MSS

SCALE: NTS

DWG. #: D015691

SHEET: OF 10

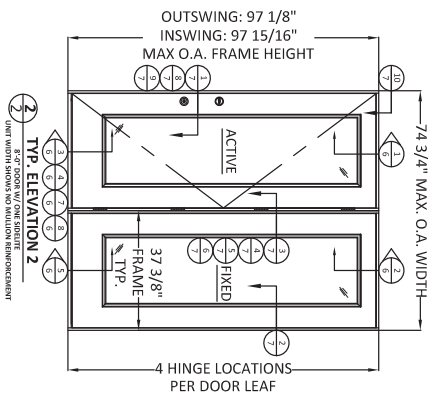

BUILDING DROPS, INC.

398 E. DANIA BEACH BLVD., STE. 338
DANIA BEACH, FL 33004
PH: (954) 399-8478
FAX: (954) 744-4738
WEB: www.buildingdrops.com

3737 LAKEPORT BLVD.,
KLAMATH FALLS, OR 97601
PH: (541)882-3451
FAX: (541)850-2609

JELD-WEN
WINDOWS & DOORS

REMARKS	BY	DATE
---------	----	------

Add ADA sill, Multi-Point Lock	GL	06/23/
& Radius Lite		

Reference DWG. #A010836A	AM	09/04/
--------------------------	----	--------

THE INSTALLATION DETAILS DESCRIBED HEREIN ARE GENERAL AND MAY NOT REFLECT ACTUAL CONDITIONS FOR A SPECIFIC SITE. IF SITE CONDITIONS CAUSE INSTALLATION TO DEVIATE FROM THE REQUIREMENTS DETAILED HEREIN, A LICENSED ENGINEER OR ARCHITECT SHALL PREPARE SITE SPECIFIC DOCUMENTS FOR USE WITH THIS DOCUMENT.

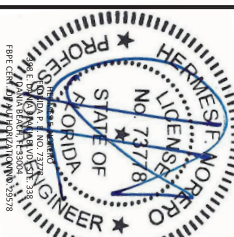

DATE: 02.05.14

DWG. BY: GL/TJM	CHK. BY: SS/MSS
--------------------	--------------------

SCALE: NTS

DWG. #: D015691

SHEET: OF-10

INSTALLATION NOTES:

- ONE (1) INSTALLATION ANCHOR IS REQUIRED AT EACH ANCHOR LOCATION SHOWN.
- SHIM AS REQUIRED AT EACH INSTALLATION ANCHOR WITH LOAD BEARING SHIMS). MAXIMUM ALLOWABLE SHIM STACK TO BE 1/4 INCH. SHIM WHERE SPACE OF 1/16 INCH OR GREATER OCCURS. SHIM(S) SHALL BE CONSTRUCTED OF HIGH DENSITY PLASTIC OR BETTER.
- MINIMUM EMBEDMENT AND EDGE DISTANCE EXCLUDE WALL FINISHES, INCLUDING BUT NOT LIMITED TO STUCCO, FOAM, BRICK VENEER, AND SIDING.
- INSTALLATION ANCHORS AND ASSOCIATED HARDWARE MUST BE MADE OF CORROSION RESISTANT MATERIAL OR HAVE A CORROSION RESISTANT COATING, AND SHALL BE INSTALLED IN ACCORDANCE WITH ANCHOR MANUFACTURER'S INSTALLATION INSTRUCTIONS.
- FOR HOLLOW BLOCK AND GROUT FILLED BLOCK, DO NOT INSTALL INSTALLATION ANCHORS INTO MORTAR JOINTS. EDGE DISTANCE IS MEASURED FROM FREE EDGE OF BLOCK OR EDGE OF MORTAR JOINT INTO FACE SHELL OF BLOCK.
- FOR 2X STUD CONSTRUCTION, ANCHORING OF THESE PRODUCTS SHALL BE THE SAME AS FOR 2X BUCK CONCRETE/MASONRY CONSTRUCTION.
- INSTALLATION ANCHOR CAPACITIES FOR PRODUCTS HEREIN ARE BASED ON SUBSTRATE MATERIALS WITH THE FOLLOWING PROPERTIES:
 - WOOD - MINIMUM SPECIFIC GRAVITY OF 0.55.
 - CONCRETE - MINIMUM COMPRESSIVE STRENGTH OF 3000 PSI.
 - GROUT-FILLED CMU - UNIT STRENGTH CONFORMS TO ASTM C-90 WITH MINIMUM COMPRESSIVE STRENGTH OF 2000 PSI AND GROUT CONFORMS TO ASTM C 476, MINIMUM GROUT COMPRESSIVE STRENGTH OF 2000 PSI.
 - HOLLOW BLOCK CMU - UNIT STRENGTH CONFORMS TO ASTM C-90 WITH MINIMUM COMPRESSIVE STRENGTH OF 2000 PSI.
- SEE SHEETS 8 AND 9 FOR MORE DETAILS OF THE INSTALLATION REQUIREMENTS, INCLUDING ANCHOR LOCATIONS, EDGE DISTANCES, EMBEDMENTS, AND SHIM SPACING.
- OPTIONALLY, ANCHORS CAN BE PLACED IN NARROW SECTION OF HEAD OR JAMB AS LONG AS MINIMUM EMBEDMENT AND EDGE DISTANCE ARE ACHIEVED.

ANCHOR TABLE								
ANCHOR TYPE	ANCHOR SIZE	SUBSTRATE	MIN. EMBEDMENT	MIN. EDGE DISTANCE	6'8" DOORS		8'0" DOORS	
					MAX. O.C. SPACING AT JAMBS	# OF ANCHORS AT HEAD/SILL CLUSTERS	MAX. O.C. SPACING AT JAMBS	# OF ANCHORS AT HEAD/SILL CLUSTERS
WOOD SCREW	#10	2X WOOD BUCK OR FRAMING	1-1/2"	3/4"	17-1/2"	4	17-1/4"	4
ITW TAPCON	3/16"	CONCRETE/CMU	1-1/4"	2-1/2"	17-1/2"	4	17-1/4"	4
ELCO ULTRACON	1/4"	CONCRETE/CMU	1-3/8" - CONC. 1-1/4" - CMU	1"	17-1/2"	4	17-1/4"	4
ITW TAPCON	3/16"	CONCRETE/CMU	1-1/4"	1"	11-5/8"	8	14-3/8"	6

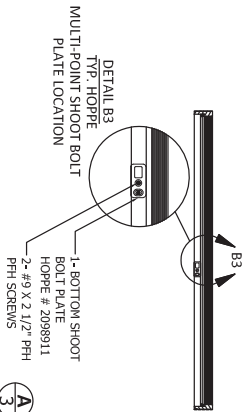

3 SILL SECTION VIEW
SEE DETAIL B3

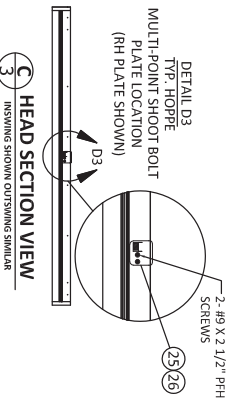

3 HEAD SECTION VIEW
SEE DETAIL D3

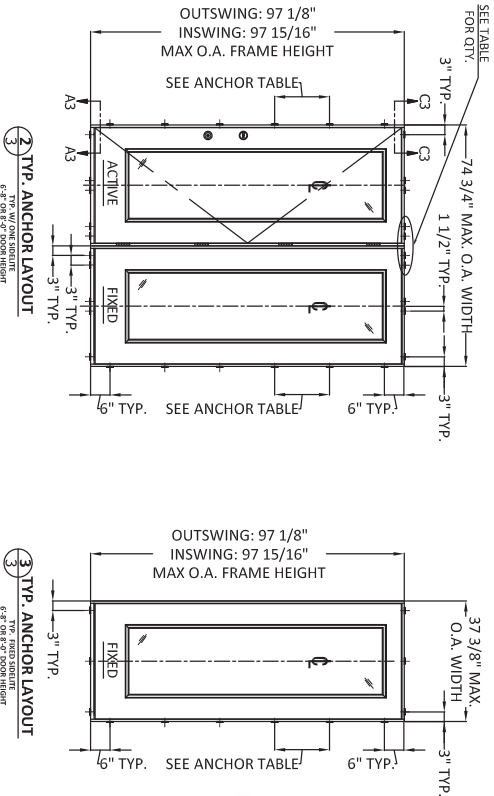
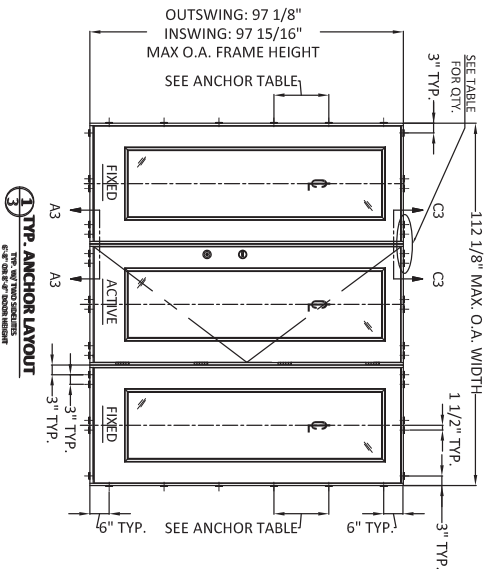

- NOTES:
- ALL DOORS SHOWN IN CONFIGURATIONS ON THIS SHEET MAY BE LEFT HAND OR RIGHT HAND OPERATING DOORS.
 - SIDELITE MAY BE USED IN LIEU OF DOOR IN CONFIGURATIONS SHOWN ABOVE AS LONG AS O.A. DIMENSIONS ARE NOT SURPASSED.

PREPARED BY:



BUILDING DROPS, INC.
398 E. DANIA BEACH BLVD., STE. 338
DANIA BEACH, FL 33004
PH: (954)734-4738
FAX: (954)734-4738
WEB: www.buildingdrops.com

3737 LAKEPORT BLVD.,
KIAMATH FALLS, OR 97601
PH: (541)882-3451
FAX: (541)850-2609

TITLE: **DESIGN PRO/SMOOTH PRO FULL LITE NON-IMPACT**
TYPICAL ANCHOR LAYOUTS AND NOTES



REMARKS	BY	DATE
Add ADA sill, Multi-Point Lock & Radius Lite	GL	06/23/14
Reference DWG. #A010836A	AM	09/04/19

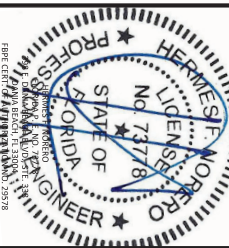

DATE: **02.05.14**
DWG. BY: **GL/TJM** CHK. BY: **SS/MSS**
SCALE: **NTS**
DWG. #: **D015691**
SHEET: **3** OF 10

PREPARED BY:



BUILDING DROPS, INC.
308 E. DANA BEACH BLVD., STE. 308
DANA POINT, CA 92629
PH: (949)389-8678
FAX: (949)744-4738
WEB: www.buildingdrops.com

3737 LAKEPORT BLVD.,
KLAMATH FALLS, OR 97601
PH: (541)882-3451
FAX: (541)850-2609



TITLE: **DESIGN PRO/SMOOTH PRO FULL LITE
NON-IMPACT
QUALIFIED CONFIGURATIONS
& GLAZING DETAIL**

REMARKS	BY	DATE
Add ADA sill, Multi-Point Lock & Radius Lite	GL	06/23/14
Reference DWG. #A010836A	AM	09/04/19

THE FIRST LISTED DRAWINGS DESCRIBED HEREIN ARE ENGINEERED AND MAY NOT REFLECT ACTUAL CONDITIONS FOR A SPECIFIC PROJECT. THE USER OF THESE DRAWINGS SHALL BE RESPONSIBLE FOR VERIFYING THE REQUIREMENTS OF THE PROJECT AND FOR OBTAINING ALL NECESSARY PERMITS AND APPROVALS FROM THE APPLICABLE JURISDICTION. THE USER SHALL BE RESPONSIBLE FOR OBTAINING ALL NECESSARY PERMITS AND APPROVALS FROM THE APPLICABLE JURISDICTION.

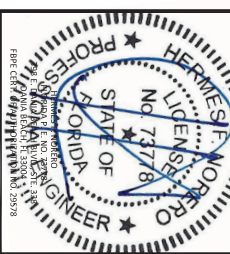

DATE: 02.05.14	CHK. BY: CH/TJM
DWG. BY: GL/TJM	SS/MSS
SCALE: NTS	
DWG. #: D015691	
SHEET: 4	OF 10

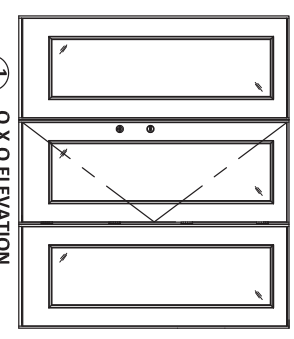

1 O.X.O ELEVATION
WITH 3/8\"/>

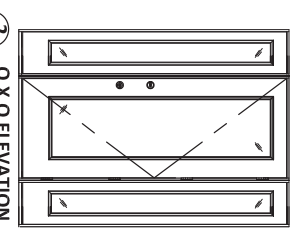

2 O.X.O ELEVATION
WITH 1 1/8\"/>

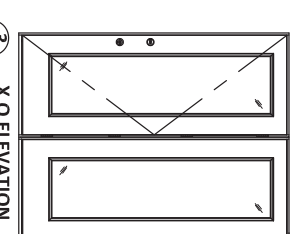

3 X.O ELEVATION
WITH 3/8\"/>

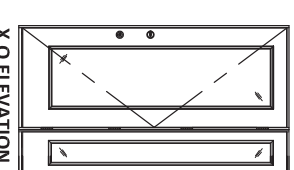

4 X.O ELEVATION
WITH 1 1/8\"/>

NOTE:
ALL DOORS SHOWN IN CONFIGURATIONS
ON THIS SHEET MAY BE LEFT HAND OR
RIGHT HAND OPERATING DOORS.

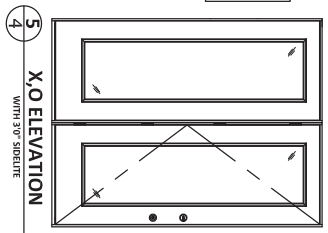

5 X.O ELEVATION
WITH 3/8\"/>

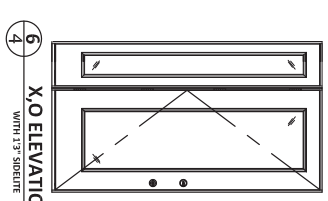

6 X.O ELEVATION
WITH 1 1/8\"/>

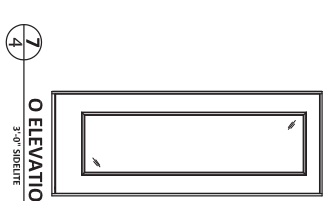

7 O ELEVATION
3/8\"/>

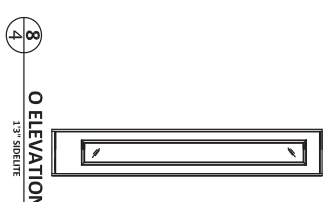

8 O ELEVATION
1 1/8\"/>

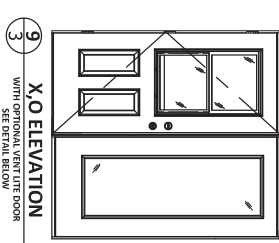

9 X.O ELEVATION
WITH SET DETAIL BELOW

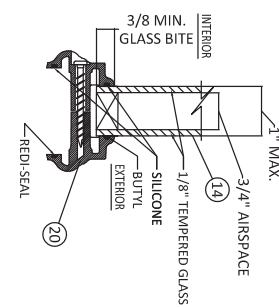

8 6'-8\"/>

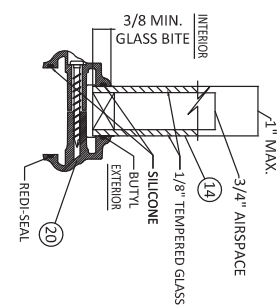

10 8'-0\"/>

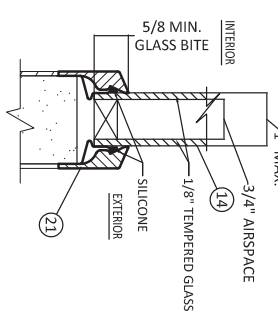

11 FLUSH GLAZE DETAIL

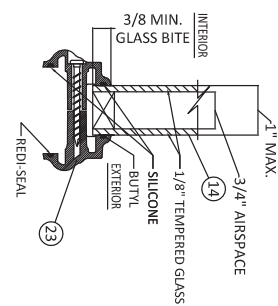

12 GLAZING DETAIL
FOR OVERALL, SMOOTH AND ROUNDED TOPS
IN 6'-8\"/>

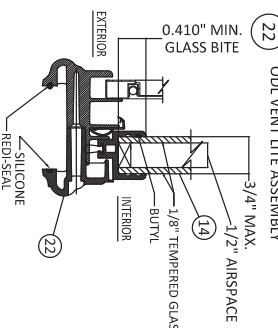

13 GLAZING DETAIL
FOR SLANT LITE VENT LITES
IN 6'-8\"/>

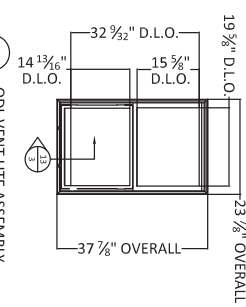

22 ODL VENT LITE ASSEMBLY

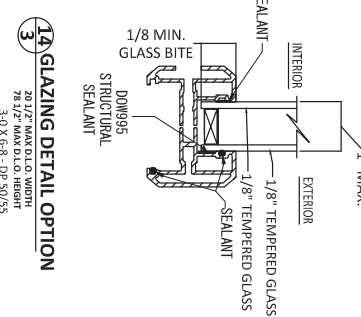

1A GLAZING DETAIL OPTION

NOTE:
FRACTIONAL GLAZING, INCLUDING INTERNAL GRID, BLINDS
BETWEEN GLASS, DECORATIVE, EXTERNAL AND INTERNAL
WROUGHT IRON AND RADIUS (SHAPED) LITES ARE APPROVED
IN ALL GLAZING DETAILS SHOWN ABOVE.

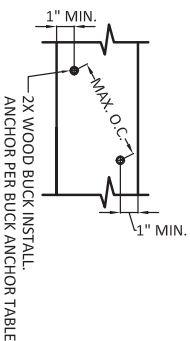
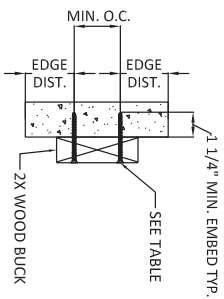
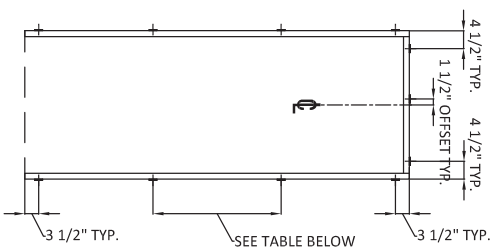
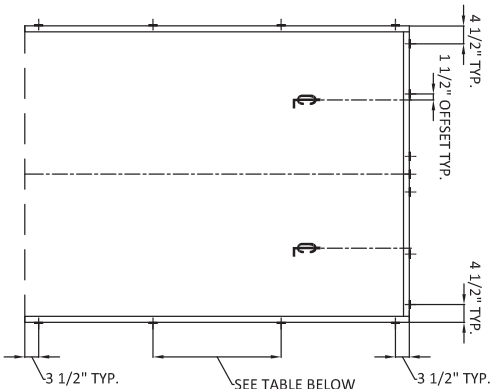
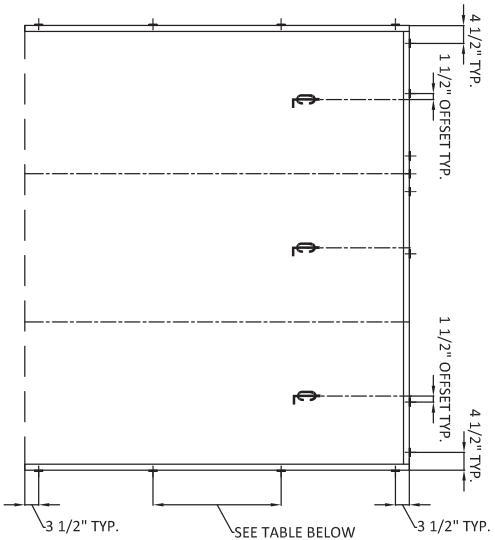

2X BUCK ANCHOR TABLE							
ANCHOR TYPE	ANCHOR SIZE	SUBSTRATE	MIN. EMBEDMENT	MIN. EDGE DIST. TO SUBSTRATE	MIN. CENTER TO CENTER DISTANCE	6" DOORS	8" DOORS
						MAX. O.C. SPACING AT JAMBS	MAX. O.C. SPACING AT JAMBS
ITW TAPCON	1/4"	CONCRETE/CMU	1-1/4"	2-1/2"	4"	25"	30-1/4"
ELCO ULTRACON	1/4"	CONCRETE/CMU	1-3/8" CONC. 1-1/4" - CMU	1"	4"	25"	30-1/4"

- NOTES:
1. 2X BUCK IS NOT FOR INSTALLATION AT SILL. THRESHOLD SHALL BE FASTENED IN ACCORDANCE WITH ANCHOR LOCATIONS SHOWN ON SHEET 3.
 2. ANCHORS MAY BE STAGGERED AS SHOWN IN DETAIL 4/5.



BUILDING DROPS, INC.
398 E. DANIA BEACH BLVD., STE. 338
DANIA BEACH, FL 33004
PH: (954) 399-8478
FAX: (954) 744-4738
WEB: www.buildingdrops.com

TITLE: *DESIGN PRO/SMOOTH PRO FULL LITE*
NON-IMPACT
 OPTIONAL 2X BUCK
 ANCHORING DETAILS

3737 LAKEPORT BLVD.,
KLAMATH FALLS, OR 97601
PH: (541)882-3451
FAX: (541)850-2609



REMARKS	BY	DATE
Add ADA sill, Multi-Point Lock	GL	06/23/14
& Radius Lite		
Reference DWG. #A010836A	AM	09/04/15

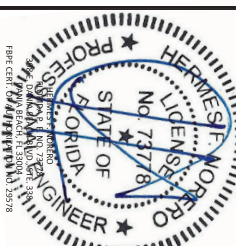

DATE:	02.05.14	
DWG. BY:	GL/TJM	CHK. BY: SS/MSS
SCALE:	NTS	
DWG. #:	D015691	
SHEET:	OF 10	



198 E. DANIA BEACH BLVD., STE.
DANIA BEACH, FL 33004
PH: (954) 399-8478
FAX: (954) 744-4738
WEB: www.buildingdrops.com

JELD-WEN
WINDOWS & DOORS

HORIZONTAL ASSEMBLIES

HINGE SCHEDULE	
DOOR HEIGHT	QUANTITY
6'-8"	3
8'-0"	4

LOCK JAMB

Diagram of a screw-in door stop. A screw is driven into a door, passing through a stop block. The stop block has a flange on the exterior side and a tapered end on the interior side. Label 1 points to the stop block, and label 3 points to the screw.

2	FIXED JAMB
7	OUTSWING SHOWN - INSWING SIMILAR

HINGE DETAIL AT JAMB:
PLACE #9 X 3-1/2" FPH SCREW
NEXT TO WEATHERSTRIP

HINGE JAMB
OUTSWING SHOWN - INSWING SIMILAR

Diagram illustrating the assembly of a finger joint. The diagram shows a cross-section of the joint with dimensions and assembly steps indicated.

Dimensions:

- Joint width: 3.00"
- Joint depth: 1.50"
- Joint thickness: 1" MIN

Assembly Steps:

- APPLY DAP ALEX PLUS OR EQUIV. ADHESIVE STRIP TO EACH END OF JOINT BEFORE MILLING
- APPLY DAP ALEX PLUS OR EQUIV. ADHESIVE STRIP TO EACH END OF JOINT BEFORE MILLING
- APPLY DAP ALEX PLUS OR EQUIV. ADHESIVE STRIP TO EACH END OF JOINT BEFORE MILLING

Joint Material: FINGER JOINT WOOD, SOLID WOOD, LVL, OR COMPOSITE

Assembly Details:

- 8# X 3" PH# SCREWS
- AT EACH MILLION 6" FROM CORNERS
- 14 1/2" O.C. TYP.

A diagram of a 1.50 inch wide board with two clips labeled 2 and 8. The board is shown in cross-section with horizontal lines. Two clips are attached to the top and bottom edges. The top clip is labeled 2 and the bottom clip is labeled 8. The board is labeled 1.50" on the left side.

4 BACK-TO-BACK JA
7 NO MULLION REINFORCEMENT

5 BACK-TO-BACK JA
7
1X MILLION REINFORCEMENT

BACK-TO-BACK JA
2X MILLION REINFORCEMENT

7 **INTEGRAL MULL**
6 **FOR 6'8" AND 8'0" UNITS**

[illegible]

NOTE:
ALL SOLID WOOD USED IN MULLION ASSEMBLIES ABOVE
TO BE PONDEROSA PINE (MIN. S.G. = 0.45) OR GREATER.

8 ROCKWELL MULTI-P
7 OUTSWING SHOWN - INSWING SIMILAR

9
7 HOPPE MULTI-POINT
OUTSWING SHOWN - INSWING SIMILAR

10 HOPPE MULTI-POINT LOCK
7 TOP REINFORCEMENT PLATE - ACTIVE PANEL ONLY

OF 10

DWG. BY: GL/TJM	CHK. BY: SS/MSS
--------------------	--------------------

SCALE: NTS

DWG. #: D015691

SHEET:

PREPARED BY:



BUILDING DROPS, INC.
398 E. DANIA BEACH BLVD., STE. 338
DANIA BEACH, FL 33004
PH: (954)726-4728
FAX: (954)726-4728
WEB: www.buildingdrops.com

3737 LAKEPORT BLVD.,
KLAMATH FALLS, OR 97601
PH: (541)882-3451
FAX: (541)850-2609

JELD-WEN
WINDOWS & DOORS

TITLE: **DESIGN PRO/SMOOTH PRO FULL LITE
NON-IMPACT
WOOD SUBSTRATES**

REMARKS	BY	DATE
Add ADA sill, Multi-Point Lock & Radius Ite	GL	06/23/14
Reference DWG. #A0108364	AM	09/04/19

THE INSTALLATION OF THESE PRODUCTS SHALL BE IN ACCORDANCE WITH THE JELD-WEN INSTALLATION INSTRUCTIONS AND MAY NOT REFLECT ACTUAL CONDITIONS FOR A SPECIFIC SITE. A SITE EVALUATION MUST BE CONDUCTED BY A JELD-WEN ENGINEER OR ARCHITECT SHALL PROVIDE SITE SPECIFIC INFORMATION TO THE JELD-WEN ENGINEER FOR PROPER PRODUCT SELECTION AND INSTALLATION.

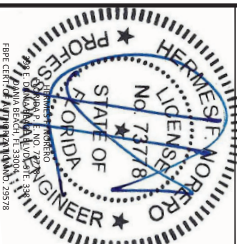

DATE: 02.05.14	CHK. BY:
DWG. BY: GL/TJM	SS/MSS
SCALE: NTS	
DWG. #: D015691	
SHEET: OF 10	

8

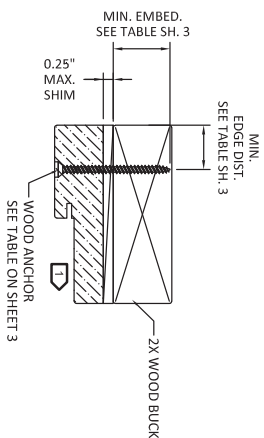

1 HEAD (TYPICAL)
8 OUTSWING SHOWN - INSWING SIMILAR

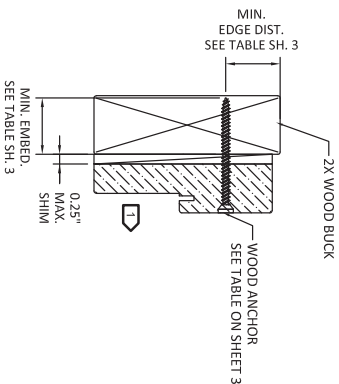

2 JAMB (TYPICAL)
8 OUTSWING SHOWN - INSWING SIMILAR

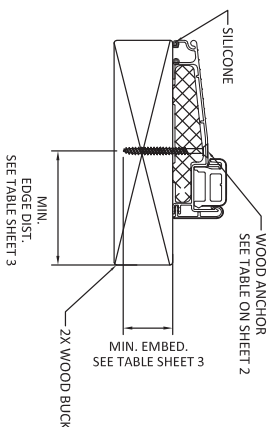

3 OPERABLE SILL
8 INSWING

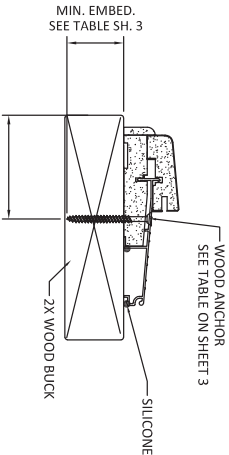

4 OPERABLE SILL
8 OUTSWING

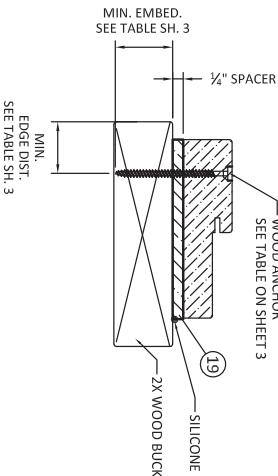

5 SIDELITE SILL (MULLED UNIT)
8 OUTSWING SHOWN - INSWING SIMILAR

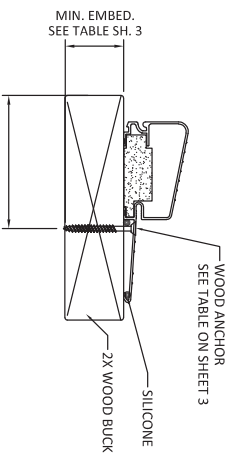

7 OPERABLE SILL
**8 HIGH BUMP OUTSWING
AFCD H-497**

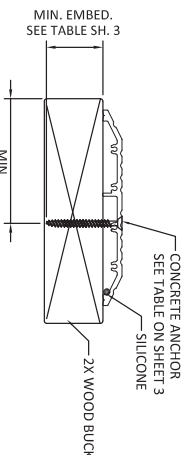

8 OPERABLE ADA SILL
8 INSWING/OUTSWING

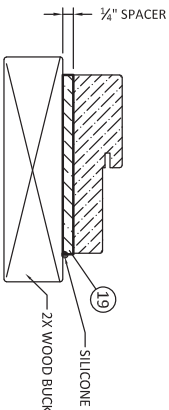

9 SIDELITE SILL (STAND-ALONE)
**8 OUTSWING SHOWN - INSWING SIMILAR
NO ANCOR REQUIRED**

OPTIONALLY, ANCHOR CAN BE PLACED IN NARROW SECTION OF HEAD OR JAMB AS LONG AS MINIMUM EMBEDMENT AND EDGE DISTANCE ARE ACHIEVED.

PREPARED BY:



BUILDING DROPS, INC.
398 E. DANIA BEACH BLVD., STE. 338
DANIA BEACH, FL 33004
PH: (541)882-3451
FAX: (541)850-2609
WEB: www.buildingdrops.com

3737 LAKEPORT BLVD.,
KLAMATH FALLS, OR 97601
PH: (541)882-3451
FAX: (541)850-2609

TITLE: **DESIGN PRO/SMOOTH PRO FULL LITE
NON-IMPACT
CONCRETE SUBSTRATES**

JELD-WEN
WINDOWS & DOORS

REMARKS

Add ADA sill, Multi-Point lock & Radius Lite

Reference DWG. #A010836A AM 09/04/19

THESE DRAWINGS HAVE BEEN PREPARED BY THE DESIGNER AND MAY NOT REFLECT ACTUAL CONDITIONS FOR A SPECIFIC SITE. A SITE CONSULTING ENGINEER MUST BE CONSULTED FOR ANY CHANGES TO THE DRAWINGS. THE DESIGNER IS NOT RESPONSIBLE FOR ANY CHANGES TO THE DRAWINGS. THE DESIGNER IS NOT RESPONSIBLE FOR ANY CHANGES TO THE DRAWINGS.

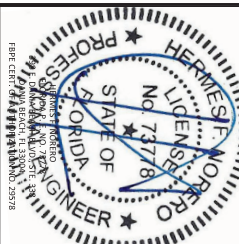

DATE: 02.05.14

DWG. BY: GL/TJM
CHK. BY: SS/MSS

SCALE: NTS

DWG. #: D015691

SHEET: OF 10

9

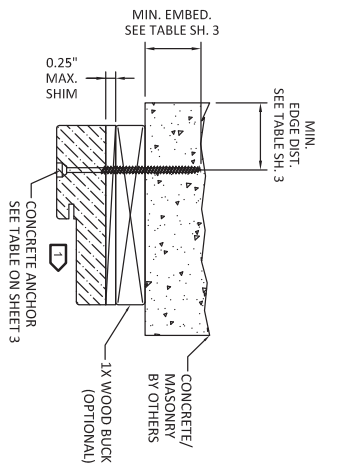

1 HEAD (TYPICAL)
9 OUTSWING SHOWN - INSWING SIMILAR

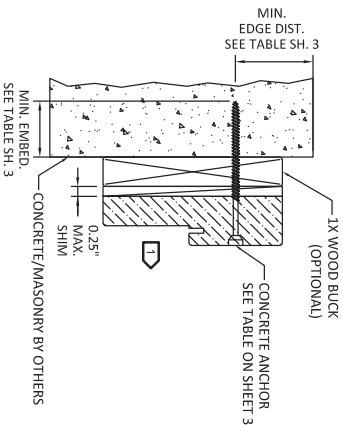

2 JAMB (TYPICAL)
9 OUTSWING SHOWN - INSWING SIMILAR

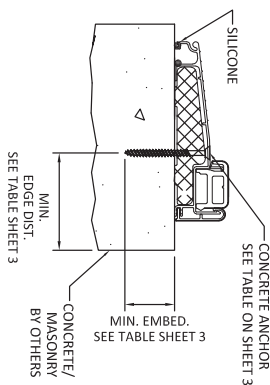

3 OPERABLE SILL
9 INSWING

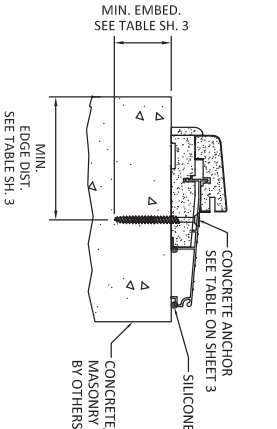

4 OPERABLE SILL
9 OUTSWING

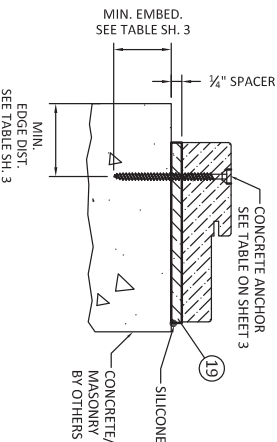

5 SIDELITE SILL (MULLED UNIT)
9 OUTSWING SHOWN - INSWING SIMILAR

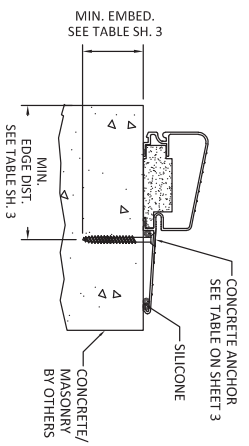

7 OPERABLE SILL
9 HIGH BUMP OUTSWING
AF-CO H-497

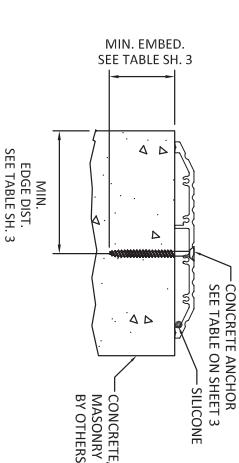

8 OPERABLE SILL
9 OUTSWING/INSWING
ADA

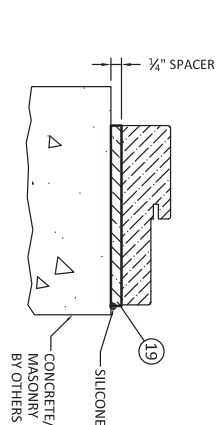

9 SIDELITE SILL (MULLED UNIT)
9 OUTSWING SHOWN - INSWING SIMILAR
NO ANCHOR REQUIRED

 OPTIONALLY, ANCHOR CAN BE PLACED IN NARROW SECTION OF HEAD OR JAMB AS LONG AS MINIMUM EMBEDMENT AND EDGE DISTANCE ARE ACHIEVED.

BILL OF MATERIALS		
ITEM#	DESCRIPTION	MATERIAL
1	FRAME HEAD/JAMBS	FINGER-JOINTED PINE
		SOLID PINE
		LAMINATED VENEER LUMBER
		COMPOSITE
		LAMINATED VENEER LUMBER
2	INTEGRAL MULL	
3	SIDELITE STOP	WOOD OR PVC
4	THRESHOLD	
5	THRESHOLD	
6	ADA THRESHOLD	
7	AFCO H-497 THRESHOLD	
8	WEATHERSTRIP	URETHANE FOAM & POLYETHYLENE COMPOSITE
9	NON-COMPRESSION SHIM (0.25" MAX. THK.)	
10	2X WOOD (S.G. MUST BE 0.55 OR GREATER)	WOOD
11	1X WOOD (S.G. MUST BE 0.55 OR GREATER)	WOOD
12	#10 WOOD INSTALLATION SCREW W/ 1 1/2" MIN. EMBEDMENT	STEEL
13	CONC./CMU ANCHOR (SEE ANCHOR TABLE SHEETS 3 & 5)	STEEL
14	1" O.A. IG TEMPERED NON-IMPACT GLASS	-
15	LOCK SERIES 400	STEEL
16	DEADBOLT SERIES 780	STEEL
17	ROCKWELL MULTI-POINT TONGUE LATCH # 73228768 6-8 UNIT	STEEL
18	ROCKWELL MULTI-POINT TONGUE LATCH #73228780 8-0 UNIT	STEEL
19	HOPPE MULTI-POINT HARDWARE HL59000 SINGLE SWING (X)	WOOD
20	PRESSURE TREATED SILL SPACER USED FOR FIXED PANEL	PLASTIC
21	ODL LITE KIT (LHM)	FIBERGLASS
21	FLUSH GLAZING LEG	
22	ODL LIP/LITE KIT (VENT LITES)	PLASTIC
23	ODL LIP/LITE KIT (RADIUS LITES)	PLASTIC
24	BUTT HINGE (SEE SCHEDULE SHEET 7)	STEEL
25	HOPPE MULTI-POINT HEAD SHOOT BOLT PLATE LH #8784091	STEEL
26	HOPPE MULTI-POINT HEAD SHOOT BOLT PLATE RH #8783923	STEEL
27	FLAT LITE KIT	ALUMINUM
28	PU DOOR CORE	

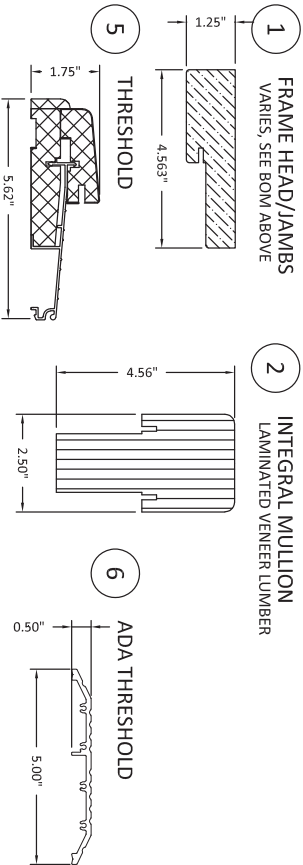

17

ROCKWELL MULTI-POINT LOCK

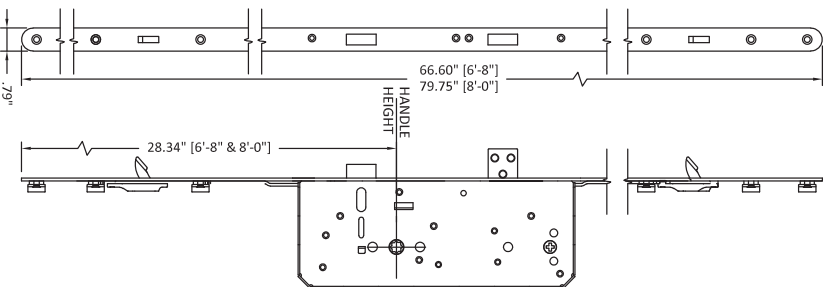

18

HOPPE MULTI-POINT LOCK
W/ SILL SHOOT BOLT PLATE #2098911

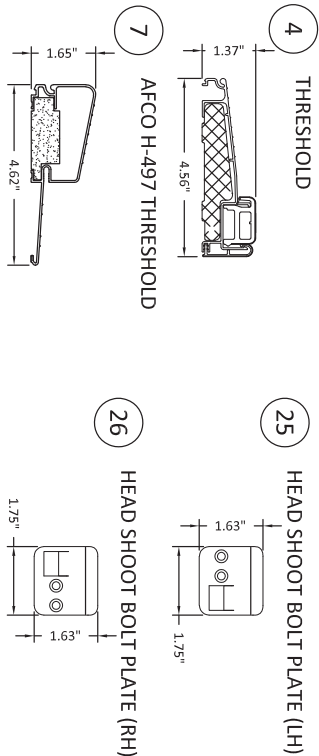
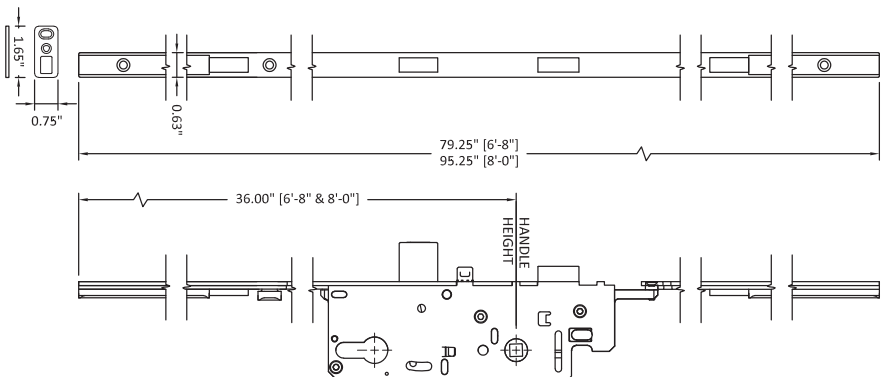

PREPARED BY:

BUILDING DROPS, INC.
398 E. DANIA BEACH BLVD., STE. 338
DANIA BEACH, FL 33004
PH: (954)399-8428
FAX: (954)399-8429
WEB: www.buildingdrops.com

TITLE:

DESIGN PRO/SMOOTH PRO FULL LITE
NON-IMPACT

COMPONENTS AND BILL OF MATERIALS

3737 LAKEPORT BLVD.,
KLAMATH FALLS, OR 97601
PH: (541)882-3451
FAX: (541)850-2609

REMARKS

BY DATE

Add ADA sill, Multi-point lock GL 06/23/14

& Radius Lite

Reference DWG: #A010836A AM 09/04/19

THESE DRAWINGS ARE THE PROPERTY OF JELD-WEN WINDOWS & DOORS, INC. AND MAY NOT BE REPRODUCED OR TRANSMITTED IN ANY FORM OR BY ANY MEANS, ELECTRONIC OR MECHANICAL, INCLUDING PHOTOCOPYING, RECORDING, OR BY ANY INFORMATION STORAGE AND RETRIEVAL SYSTEM. WITHOUT PERMISSION IN WRITING FROM JELD-WEN WINDOWS & DOORS, INC., NO PART OF THESE DRAWINGS MAY BE REPRODUCED OR TRANSMITTED IN ANY FORM OR BY ANY MEANS, ELECTRONIC OR MECHANICAL, INCLUDING PHOTOCOPYING, RECORDING, OR BY ANY INFORMATION STORAGE AND RETRIEVAL SYSTEM. WITHOUT PERMISSION IN WRITING FROM JELD-WEN WINDOWS & DOORS, INC., NO PART OF THESE DRAWINGS MAY BE REPRODUCED OR TRANSMITTED IN ANY FORM OR BY ANY MEANS, ELECTRONIC OR MECHANICAL, INCLUDING PHOTOCOPYING, RECORDING, OR BY ANY INFORMATION STORAGE AND RETRIEVAL SYSTEM.

DATE: 02.05.14

DWG BY: GL/TJM CKY BY: SS/MSS

SCALE: NTS

DWG #: D015691

SHEET: OF 10

10