

- GENERAL NOTES:**
- THESE STRUCTURAL DRAWINGS SHALL BE USED FOR THE CONSTRUCTION OF THE SHOWN STORAGE BUILDING. IN THE EVENT OF DIMENSIONAL DISCREPANCY, NOTIFY THE ENGINEER FOR RESOLUTION OF CONFLICT. ANY DEVIATION FROM THESE DRAWINGS MUST BE APPROVED BY THE ENGINEER.
  - FOOTING DESIGN BASED ON AN ALLOWABLE BEARING PRESSURE OF 2500 P.S.F.
  - THESE BARNS ARE TO BE USED AS STORAGE ONLY AND NOT FOR HABITATION
  - NAILING PATTERN FOR WALL, FLOOR AND ROOF SHEATHING TO BE 4" O.C. AT EDGES AND 4" O.C. ON ALL INTERMEDIATE SEAMS FOR WALLS AND FLOORS. NAIL WITH 2" RING SHANK OR 2" HOT DIPPED GALVANIZED NAILS. FASTENING IS IN CONFORMANCE WITH R803.2.3.1 FASTENING SCHEDULE OF THE 2023 FLORIDA BUILDING CODE
  - FOR EDGE JOINTS BETWEEN UPPER AND LOWER ROOF PANELS THE FOLLOWING APPLIES:  
1) USE EDGE CLIPS IF LOWER PANEL IS OVER 12 INCHES WIDE  
2) USE BLOCKING IF LOWER PANEL IS LESS THAN 12 INCHES WIDE
- MATERIAL NOTES:**
- ALL LUMBER TO BE NUMBER 2 GRADE SPRUCE PINE FIR OR EQUIVALENT.
  - ALL PLYWOOD SHALL CONFORM TO THE LATEST EDITION OF APA SPECIFICATIONS.
  - ALL CONNECTORS/FASTENERS AND ITS SPACING SHALL MEET THE APPLICABLE CODES.
  - ALL MATERIALS AND LABOR PER APPLICABLE LOCAL CODES
  - 7/16" O.S.B. DECKING; ORIENTED STAND BOARD AS MANUFACTURED BY LOUISIANA-PACIFIC COMPANY, PORTLAND, OR. ... RATED 24/16
  - MINIMUM 15 LB. FELT PAPER AND METAL DRIP EDGE.

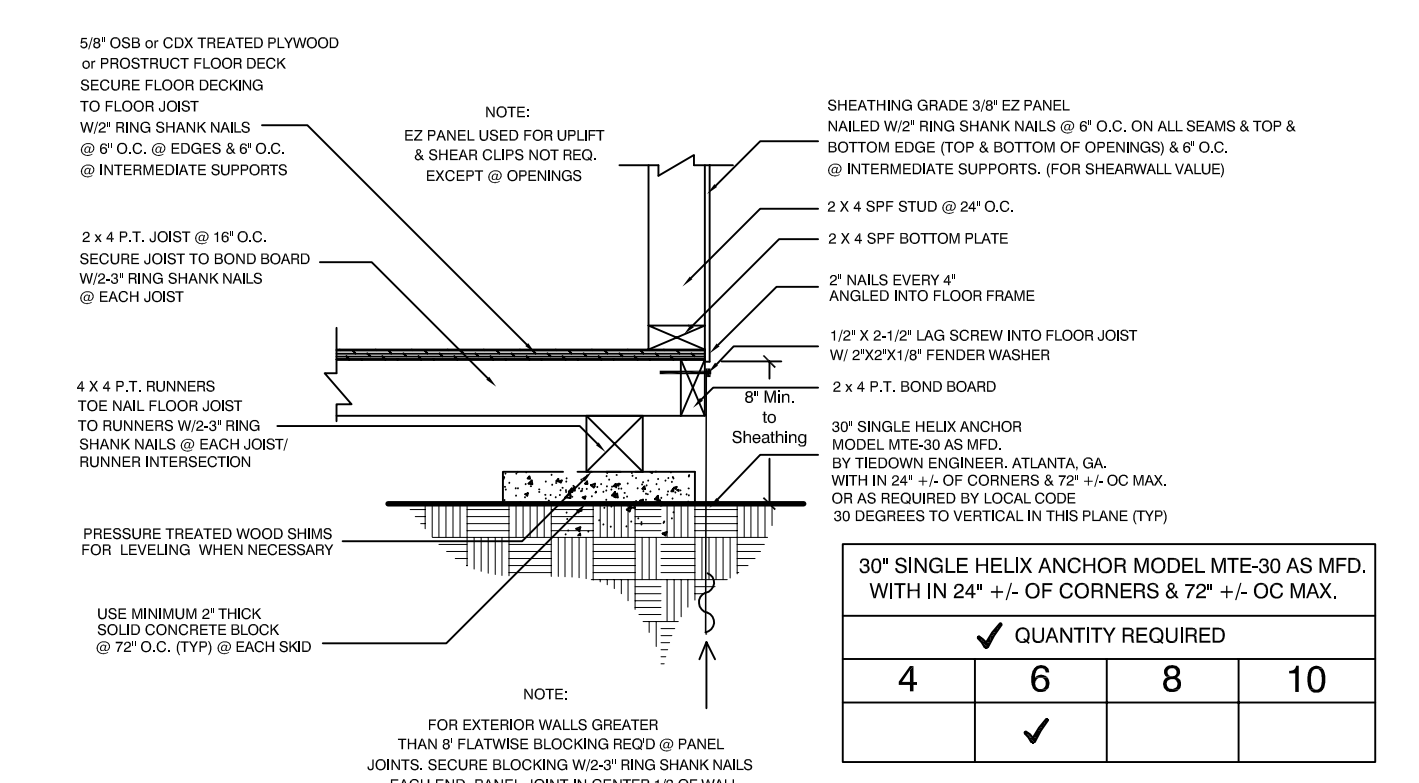
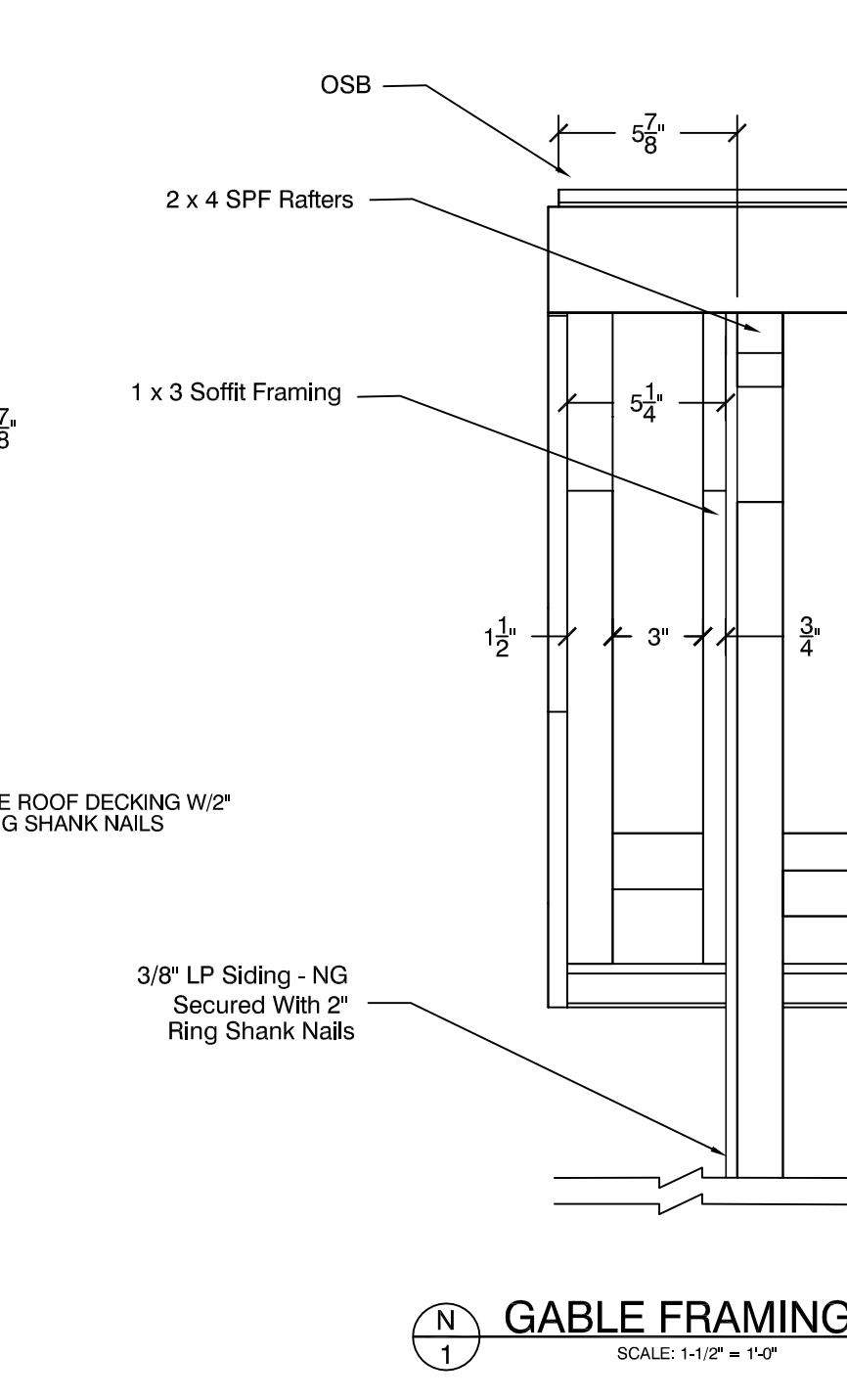
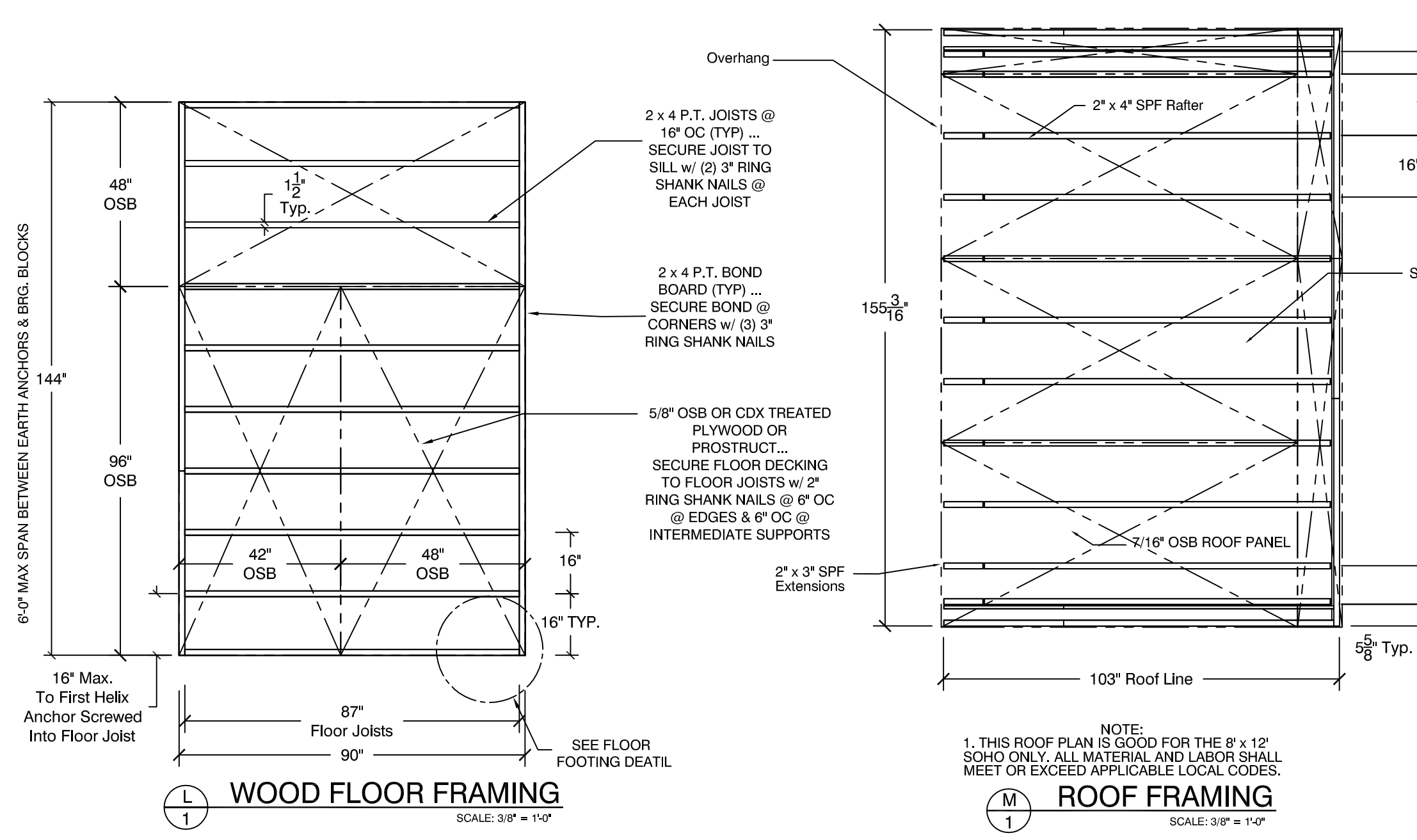

- WOOD FLOOR FOOTING NOTES:**
- WHEN MONOLITHIC SLAB IS USED, THIS FLOOR FRAMING IS NOT REQUIRED
  - ALL MATERIALS AND LABOR SHALL MEET OR EXCEED APPLICABLE LOCAL CODES.
  - ALL LUMBER TO BE NO. 2 GRADE SPRUCE PINE FIR OR EQUIVALENT
  - THIS FLOOR FRAMING PLAN IS FOR THE BACKYARD PRODUCTS, LLC. 8' x 12' SOHO ANY DEVIATION OR MODIFICATION IS STRICTLY PROHIBITED
  - IN THE EVENT OF A DIMENSIONAL OR MATERIAL DISCREPANCY, NOTIFY BACKYARD PRODUCTS, LLC.
- ROOFING NOTES:**
- APPROVED SHINGLES INSTALLED PER MANUFACTURERS INSTRUCTION/ 4 NAILS PER SHINGLE
  - H CLIPS ARE USED BETWEEN EVERY RAFTER BETWEEN THE UPPER AND LOWER ROOF PANELS.
- | 30" SINGLE HELIX ANCHOR MODEL MTE-30 AS MFD. WITH IN 24" +/- OF CORNERS & 72" +/- OC MAX. |   |   |    |  |
|---|---|---|----|--|
| ✓ QUANTITY REQUIRED   |   |   |    |  |
| 4   | 6 | 8 | 10 |  |
|   | ✓ |   |    |  |

- CONSTRUCTION NOTES:**
- PLYWOOD PANELS SHALL BE INSTALLED W/ FACE GRAIN PARALLEL TO STUDS.
  - ALL HORIZ. JOINTS SHALL OCCUR OVER FRAMING. FLATWISE BLOCKING SHALL BE USED AT ALL HORIZ. PANEL JOINTS.
  - PANELS SHALL BE ATTACHED TO BOTTOM PLATES & TOP PLATES. LOWEST PLATE SHALL BE ATTACHED TO FOUNDATION (OR BOND BEAM) W/ RING SHANK NAILS OR CONNECTORS OF SUFFICIENT CAPACITY TO RESIST THE UPLIFT DEVELOPED IN THE PLYWOOD SHEATHED WALLS.
  - WHERE WINDOWS & DOORS INTERRUPT PLYWOOD SHEATHING, FRAMING ANCHORS OR CONNECTORS SHALL BE USED TO RESIST THE APPROPRIATE UPLIFTS.

FLORIDA APPROVAL CODES: <i>(Valid in other states)</i>		QUALITY ASSURANCE EXPIRATION DATE	
Shingles:	FL 10674.1 (OC) FL 10104.1 (GAP) FL 30310.1 (KO)	01/01/2029 12/01/2025 12/31/2024	
Siding:	FL 9180.3 (LP) FL 10626.1 (GAP) FL 9777.1 (OC)	12/31/2026 12/31/2024 12/31/2024	
Windows:	FL 1786.2 (NWD)	06/01/2026	
Rollup Door:	FL 12450.9 (Janss) Vinyl Siding: FL 12500.1 (Nor) FL 15275.5 (Aluac) Vinyl Soffit: FL 15272.2 (Aluac)	12/31/2024 12/31/2026 12/31/2026 12/31/2026	
Simpson:	H2.5A LST49 SP4	FL 10466.7 FL 10456.15 FL 10456.30	12/31/2026 12/31/2026 12/31/2026

- This item has been digitally signed and sealed by Richard Kozlowski on the date adjacent to the seal.
- Printed Copies of this are not considered signed and sealed and the signature must be verified on any electronic copy.

DESIGN CRITERIA: FBC 8th Edition (2023)					Rev.	Date	By	Revision	Richard Kozlowski, P.E. 7192 GLENBURNIE LANE, CLARKSTON, MI 48346 (248) 625-3962 (248) 620-4515 FAX FLORIDA REG. # 31659			FLORIDA MODERN (SOHO) 12 x 8		
Ultimate Design Wind Speed (mph)	140	Flr. Live Ld. / Wood (psf)	36	Roof Live Load (psf)	36									
Wind Exposure	B	Flr. Dead Ld. / Wood (psf)	6	Roof Dead Load (psf)	6									
Nominal Design Wind Speed (mph)	108	Design Wind Pressure On Openings (psf)	42	Wall Dead Load (psf)	3									
Int. Pressure Coef.	0.55	Comp. & Clad. Design Pressure (psf)	42	MATERIALS:										
Risk Category	1	Roof Sheathing: 7/16" Rated 24/16		Wall Sheathing:										

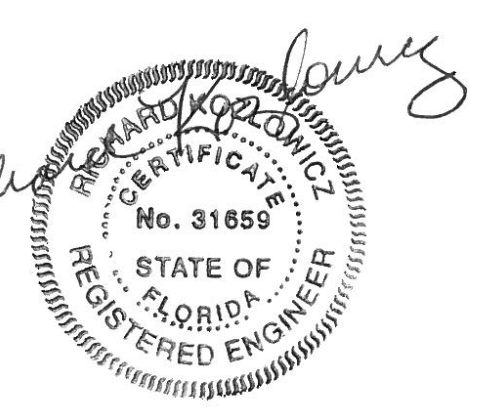
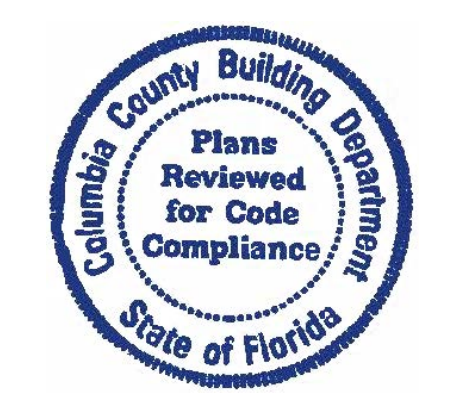

Digitally signed by  
Richard Kozlowski  
Date: 2024.04.25  
08:22:13 -04'00'