

DATE11/30/2007

Columbia County Building Permit

PERMIT000026465

This Permit Expires One Year From the Date of Issue

APPLICANTDON TODD

PHONE386-963-3433

ADDRESS1302139TH PLACE

WELBORNFL32096

OWNERWENDELL FEAGLE/(BONNIE TAYLOR M/H)

PHONE386.344.5769

ADDRESS188SE BIKINI DRIVE

LAKE CITYFL32025

CONTRACTORDON TODD

PHONE386-963-3433

LOCATION OF PROPERTY

90E. TR ON 100. TR ON 245A, TO PARADISE VILLAGE, MAIN
ENTRANCE AT DEAD END GO LEFT, R BIKINI DR, 4TH ON RIGHT

TYPE DEVELOPMENTMH.UTILITY

ESTIMATED COST OF CONSTRUCTION0.00

HEATED FLOOR AREA

TOTAL AREA

HEIGHT

STORIES

FOUNDATION

WALLS

ROOF PITCH

FLOOR

LAND USE & ZONINGAG-3

MAX. HEIGHT35

Minimum Set Back Requirments:

STREET-FRONT30.00

REAR25.00

SIDE25.00

NO. EX.D.U.1

FLOOD ZONEX

DEVELOPMENT PERMIT NO.

PARCEL ID11-4S-17-08309-000

SUBDIVISIONPARADISE VILLAGE MHP

LOT72

BLOCK

PHASE

UNIT

TOTAL ACRES

IH0000316

Culvert Permit No.

Culvert Waiver

Contractor's License Number

Applicant/Owner/Contractor

EXISTING

X07-0460

LH

JH

Y

Driveway Connection

Septic Tank Number

LU & Zoning checked by

Approved for Issuance

New Resident

COMMENTS: FLOOR ONE FOOT ABOVE THE ROAD

REPLACING EXISTING MH IN MHP, SET HOME IN SAME SPOT FOR THE EXISTING

SETBACK REQUIREMENTS, LETTER FROM FEAGLE INCLUDED

Check # or CashCASH

FOR BUILDING & ZONING DEPARTMENT ONLY

Temporary Power

Foundation

Monolithic

date/app. by

date/app. by

date/app. by

Under slab rough-in plumbing

Slab

Sheathing/Nailing

date/app. by

date/app. by

date/app. by

Framing

Rough-in plumbing above slab and below wood floor

date/app. by

date/app. by

Electrical rough-in

Heat & Air Duct

Peri. beam (Lintel)

date/app. by

date/app. by

date/app. by

Permanent power

C.O. Final

Culvert

date/app. by

date/app. by

date/app. by

M/H tie downs, blocking, electricity and plumbing

Pool

date/app. by

date/app. by

Reconnection

Pump pole

Utility Pole

date/app. by

date/app. by

date/app. by

M/H Pole

Travel Trailer

Re-roof

date/app. by

date/app. by

date/app. by

BUILDING PERMIT FEE \$0.00

CERTIFICATION FEE \$0.00

SURCHARGE FEE \$0.00

MISC. FEES \$200.00

ZONING CERT. FEE \$50.00

FIRE FEE \$0.00

WASTE FEE \$

FLOOD DEVELOPMENT FEE \$

FLOOD ZONE FEE \$25.00

CULVERT FEE \$

TOTAL FEE275.00

INSPECTORS OFFICE

CLERKS OFFICE

NOTICE: IN ADDITION TO THE REQUIREMENTS OF THIS PERMIT, THERE MAY BE ADDITIONAL RESTRICTIONS APPLICABLE TO THIS PROPERTY THAT MAY BE FOUND IN THE PUBLIC RECORDS OF THIS COUNTY. AND THERE MAY BE ADDITIONAL PERMITS REQUIRED FROM OTHER GOVERNMENTAL ENTITIES SUCH AS WATER MANAGEMENT DISTRICTS, STATE AGENCIES, OR FEDERAL AGENCIES.

"WARNING TO OWNER: YOUR FAILURE TO RECORD A NOTICE OF COMMENCEMENT MAY RESULT IN YOUR PAYING TWICE FOR IMPROVEMENTS TO YOUR PROPERTY. IF YOU INTEND TO OBTAIN FINANCING, CONSULT WITH YOUR LENDER OR AN ATTORNEY BEFORE RECORDING YOUR NOTICE OF COMMENCEMENT."

This Permit Must Be Prominently Posted on Premises During Construction

PLEASE NOTIFY THE COLUMBIA COUNTY BUILDING DEPARTMENT AT LEAST 24 HOURS IN ADVANCE OF EACH INSPECTION, IN ORDER THAT IT MAY BE MADE WITHOUT DELAY OR INCONVENIENCE. PHONE 758-1008. THIS PERMIT IS NOT VALID UNLESS THE WORK AUTHORIZED BY IT IS COMMENCED WITHIN 6 MONTHS AFTER ISSUANCE.

The Issuance of this Permit Does Not Waive Compliance by Permittee with Deed Restrictions.

26 27 28 29 30 31 V
1 2 3 4 5 6 7 8

48	47	46	45	44
49	50	51	52	53

32	33	34	35	36	37
43	42	41	40	39	38

9
10
11

108 = 108
371

63	62	61	60	59	58	57	56	55	54	53	
64	65	66	67	68	69	70	71	72	73	74	75



18 A 17 A 16 A 15 A 14 A 13 A 12 A

ESNOH BNTD

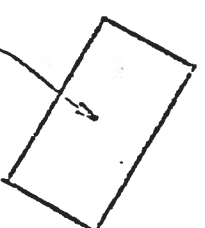
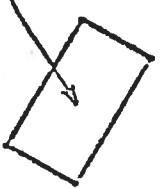

POOL GNIMINIS

PARKING



Hyd
10