

Columbia County Property Appraiser

Jeff Hampton

2023 Working Values

updated: 10/20/2022

Retrieve Tax Record

2022 TRIM (pdf)

Property Card

Parcel List Generator

Show on GIS Map

Print

Parcel: << 22-3S-16-02268-219 (7806) >>

Aerial Viewer Pictometry Google Maps

Owner & Property Info

<<

Result: 5 of 10

>>

Owner	JACKSON KEVIN JACKSON ANGELA EADIE 822 NW SCENIC LAKE DR LAKE CITY, FL 32055		
Site	822 NW SCENIC LAKE Dr, LAKE CITY		
Description*	LOT 19 WOODBOROUGH PHASE 1. 789-2073, 874-1111, WD 1027- 284, WD 1320-653, WD 1409-79		
Area	0 AC	S/T/R	22-3S-16
Use Code**	SINGLE FAMILY (0100)	Tax District	2

*The Description above is not to be used as the Legal Description for this parcel in any legal transaction.

**The Use Code is a FL Dept. of Revenue (DOR) code and is not maintained by the Property Appraiser's office. Please contact your city or county Planning & Zoning office for specific zoning information.

Property & Assessment Values

2022 Certified Values		2023 Working Values	
Mkt Land	\$99,000	Mkt Land	\$99,000
Ag Land	\$0	Ag Land	\$0
Building	\$416,997	Building	\$416,997
XFOB	\$23,504	XFOB	\$23,504
Just	\$539,501	Just	\$539,501
Class	\$0	Class	\$0
Appraised	\$539,501	Appraised	\$539,501
SOH Cap [?]	\$93,016	SOH Cap [?]	\$79,621
Assessed	\$446,485	Assessed	\$459,880
Exempt	HX HB \$50,000	Exempt	HX HB \$50,000
Total Taxable	county:\$396,485 city:\$0 other:\$0 school:\$421,485	Total Taxable	county:\$409,880 city:\$0 other:\$0 school:\$434,880

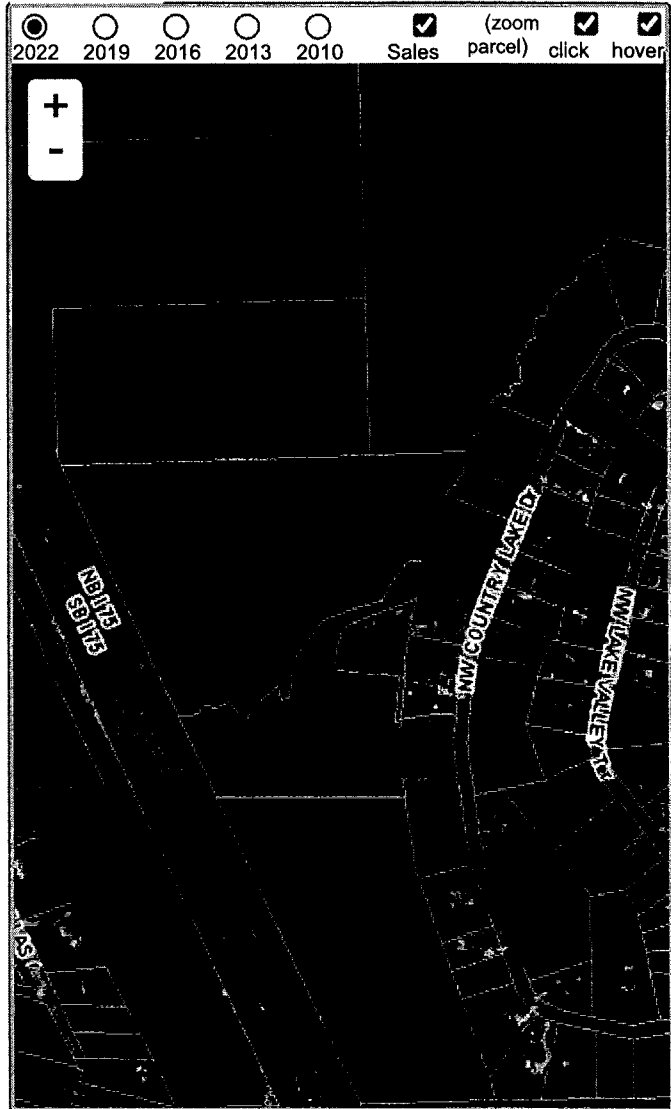

Sales History

Show Similar Sales within 1/2 mile

Fill out Sales Questionnaire

Sale Date	Sale Price	Book/Page	Deed	V/I	Qualification (Codes)	RCode
3/31/2020	\$525,000	1409/0079	WD	I	Q	01
8/12/2016	\$450,000	1320/0653	WD	I	Q	01
9/30/2004	\$459,000	1027/0284	WD	I	Q	
2/9/1999	\$381,700	0874/1111	WD	I	Q	
5/4/1994	\$56,000	0789/2073	WD	V	Q	
5/4/1994	\$56,000	0789/2073	WD	V	Q	

Building Characteristics

Bldg Sketch	Description*	Year Blt	Base SF	Actual SF	Bldg Value
Sketch	SINGLE FAM (0100)	1995	3910	5114	\$416,997

*Bldg Desc determinations are used by the Property Appraisers office solely for the purpose of determining a property's Just Value for ad valorem tax purposes and should not be used for any other purpose.